

DOLL HOUSE AND KITCHEN

Assembly & User Instructions - Please keep for future reference 9452422

Cocoland®

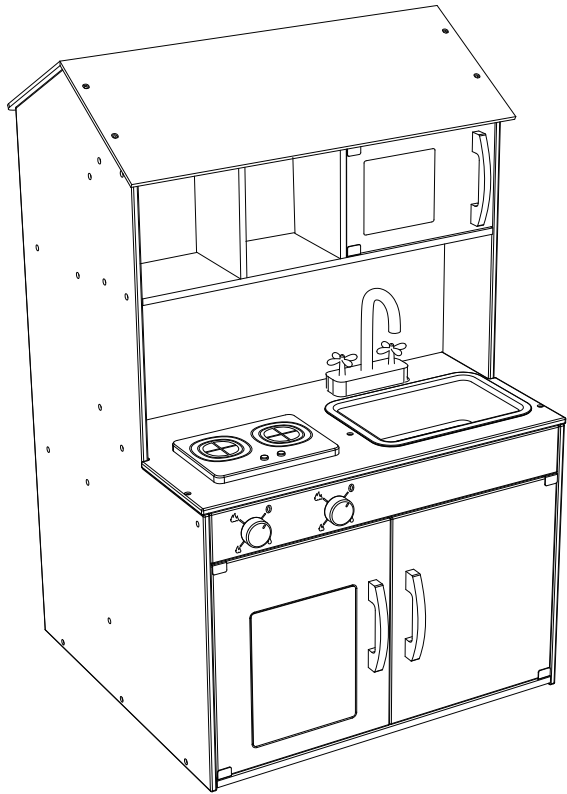

Important

Age: 3+ years

Important – Please read these instructions fully before assembly or use

These instructions contain important information which will help you get the best from your product and ensure safe and correct assembly, use and maintenance.

Issue 1 - 25/04/21

1

Parts

Please check you have all the parts and fittings listed below

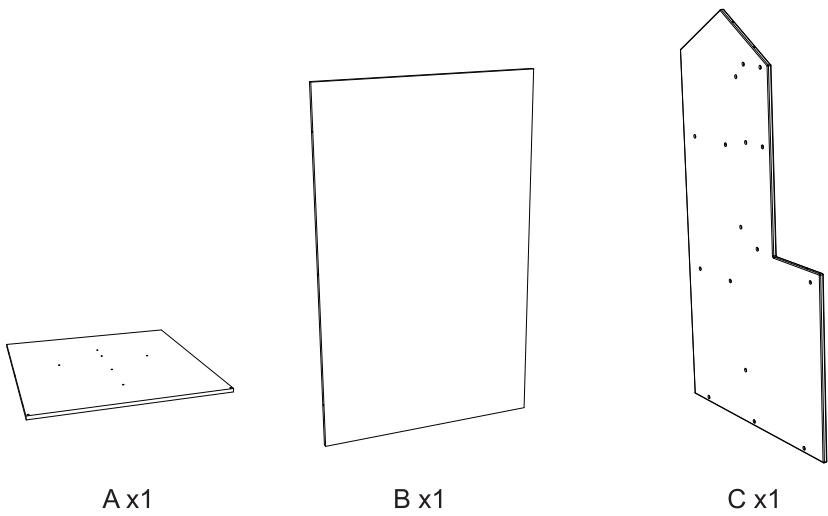

A x1

B x1

C x1

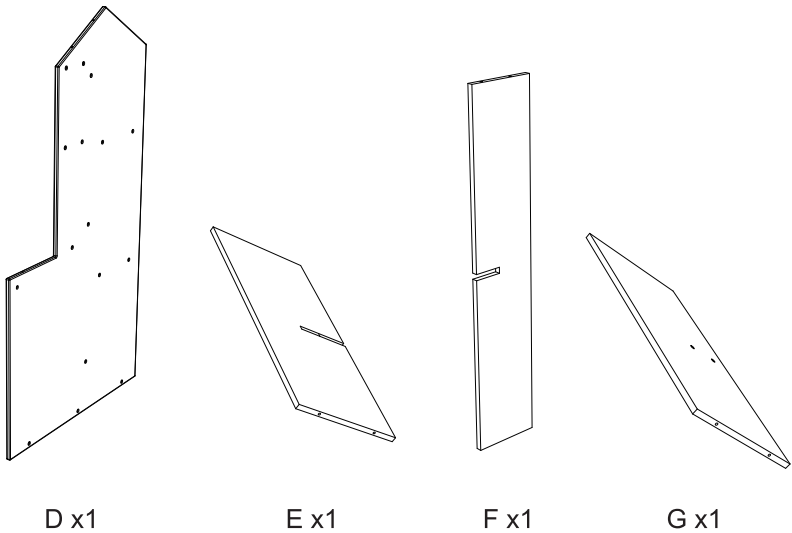

D x1

E x1

F x1

G x1

3



Safety Information

Important – Please read these instructions fully before assembly or use

General safety

- Adult assembly required!
- Before use, please ensure the item is on a stable and level surface.
- Do not use the item if any part is broken or missing.
- Keep away from fire at all times.
- Adult supervision is required as young children in play are unaware of potential hazards and dangers.

Warning

- This product contains small part which may be hazardous to your children!
- During assembly children should be kept away from the product due to possible risk of injury.
- Important: Retain these instructions for future reference.
- Assembly must be performed by two adults.
- Must be secured using a screwdriver.
- Assembly must be performed by two adults.

Batteries are NOT included



X 2 AAA-LR03
2 X 1.5V

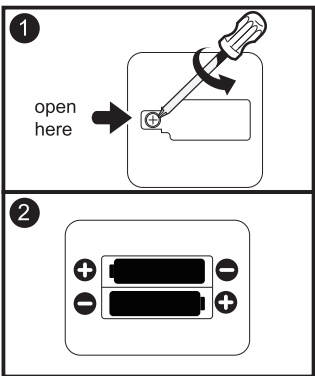

- how to remove and insert the batteries as above shown
- non-rechargeable batteries are not to be recharged;
- rechargeable batteries are only to be charged under adult supervision
- rechargeable batteries are to be removed from the toy before being charged;
- different types of batteries or new and used batteries are not to be mixed;
- batteries are to be inserted with the correct polarity;
- exhausted batteries are to be removed from the toy;
- the supply terminals are not to be short-circuited.

Disposal information

Electrical product waste should not be discarded with household waste. Please actively support us in conserving resources and protecting the environment by returning the non-working electrical products to an appropriate disposal/recycling centre (if available).



2

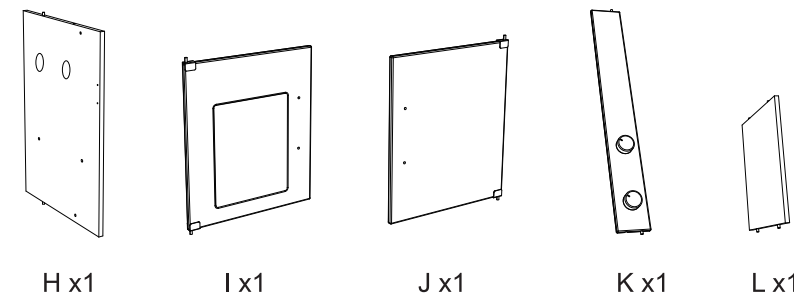

H x1

I x1

J x1

K x1

L x1

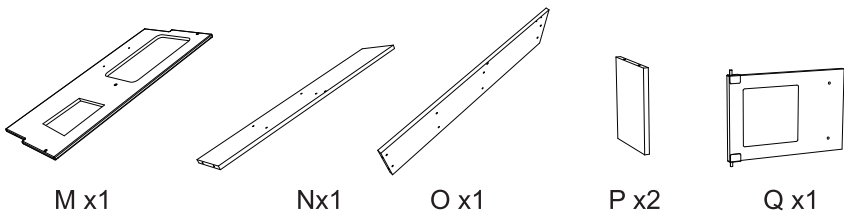

M x1

N x1

O x1

P x2

Q x1

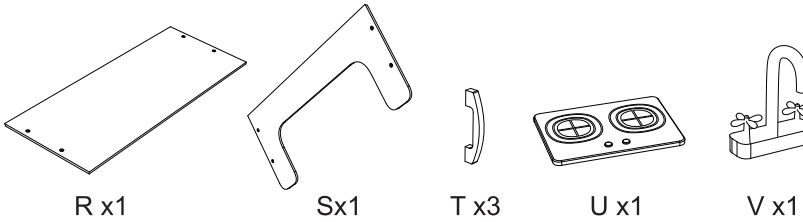

R x1

S x1

T x3

U x1

V x1

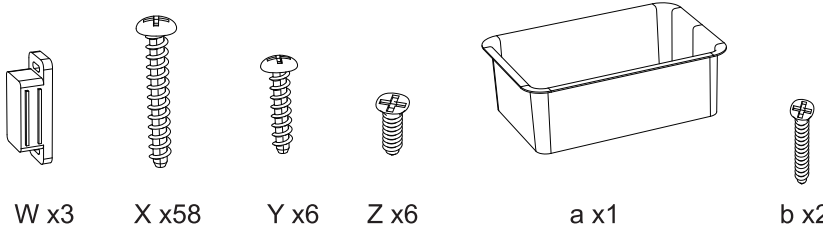

W x3

X x58

Y x6

Z x6

a x1

b x2

Note: Each style screw quantity listed above shows the correct amount to complete the assembly. In some cases more fittings may be supplied than required.

4

Assembly Instructions

Step 1:

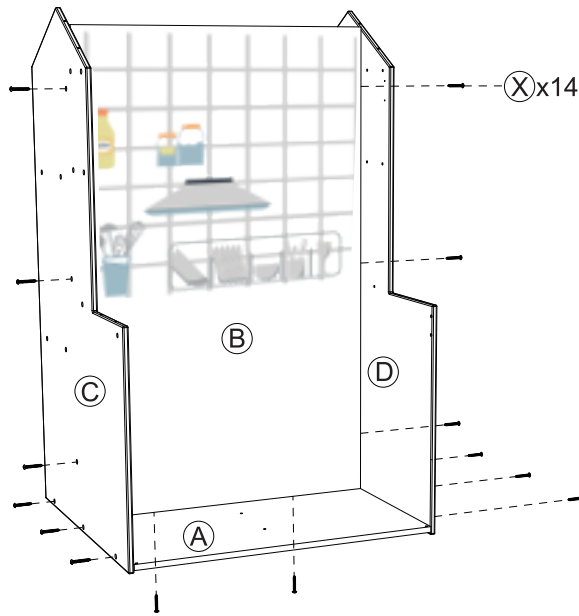

Step 2:

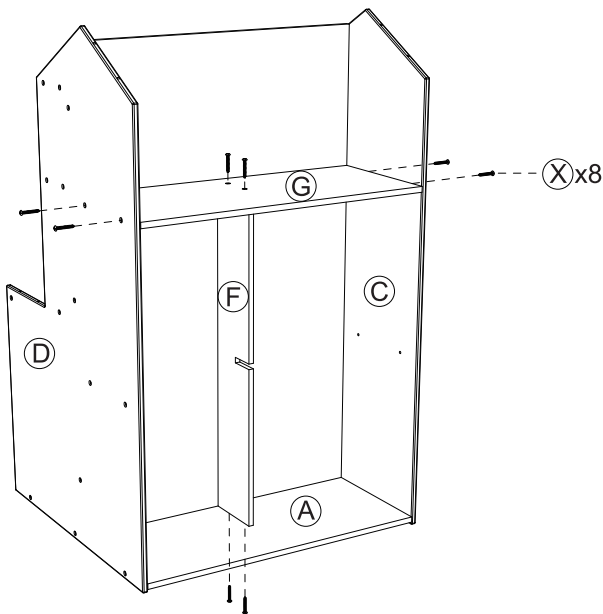

5

Assembly Instructions

Step 3:

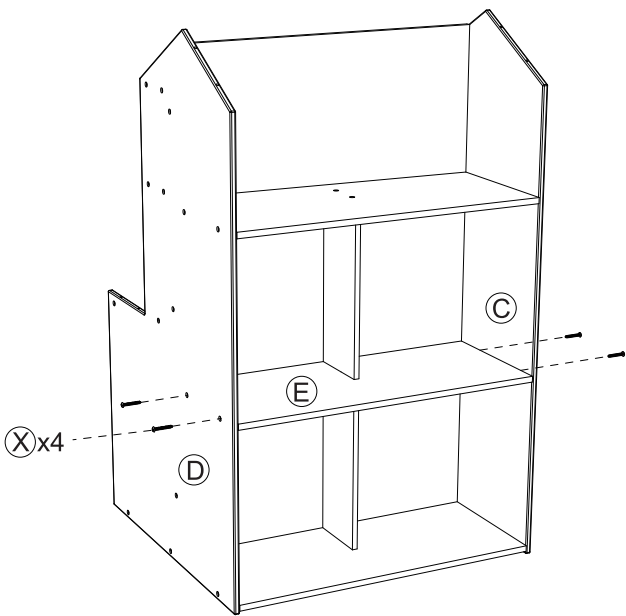

Step 4:

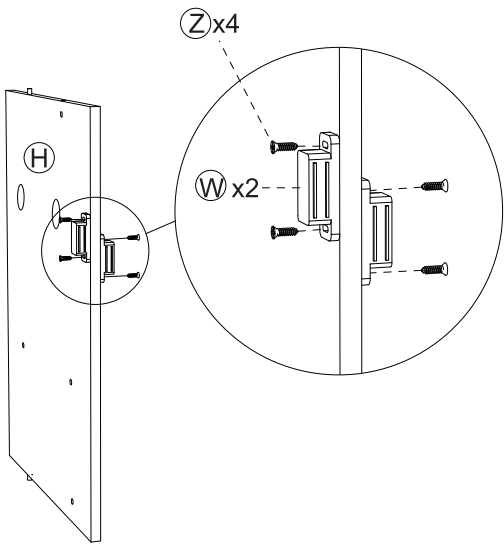

6

Assembly Instructions

Step 5:

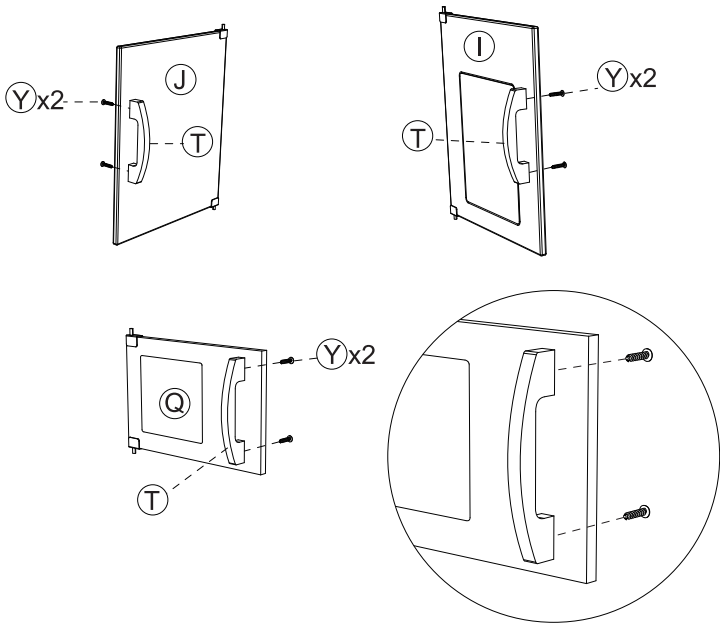

Step 6:

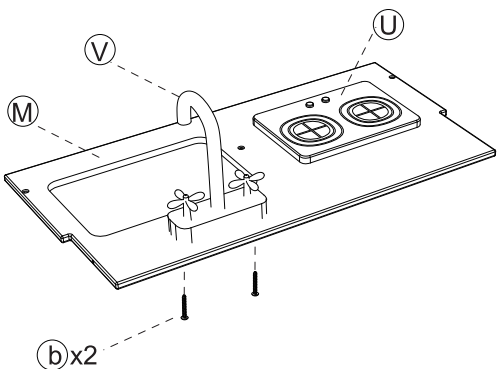

7

Assembly Instructions

Step 7:

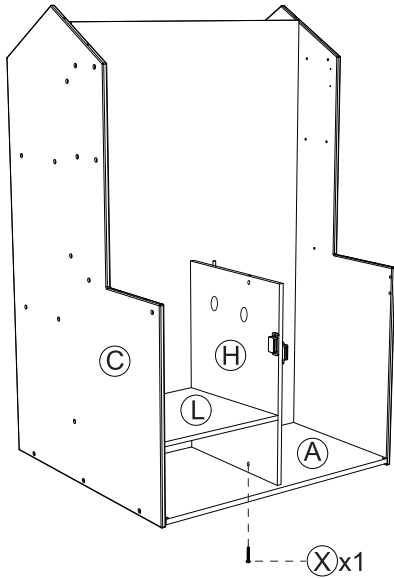

Step 8:

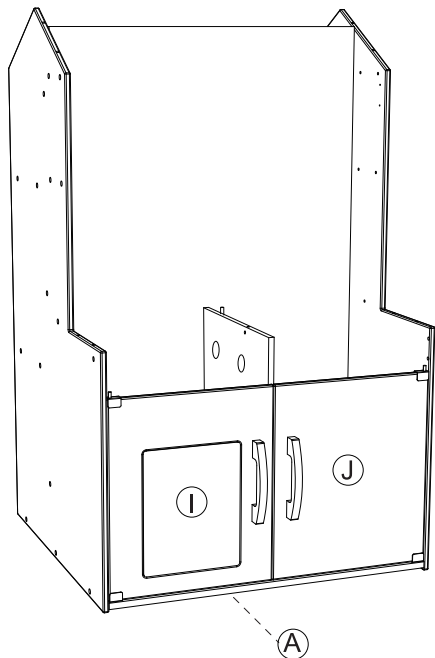

8

Assembly Instructions

Step 9:

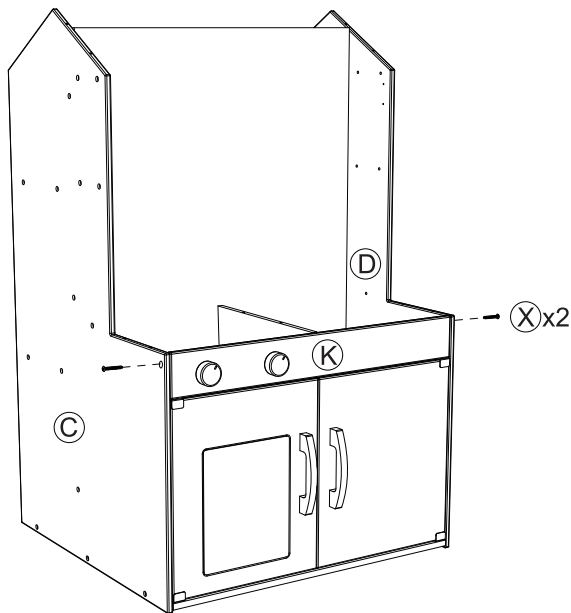

Step 10:

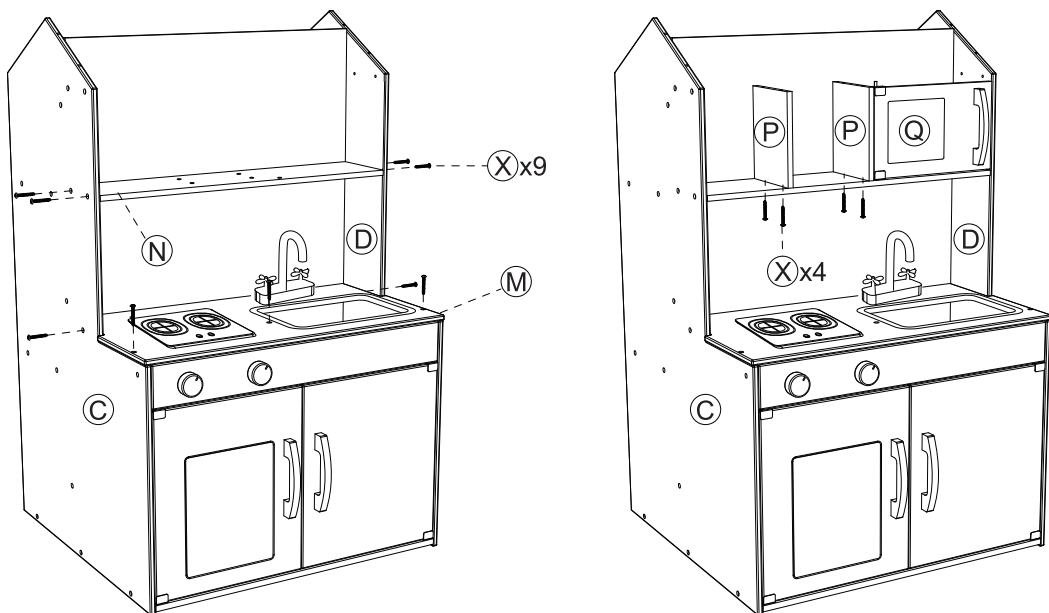

9

Assembly Instructions

Step 11:

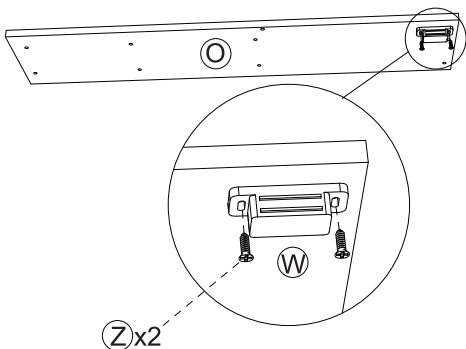

Step 12:

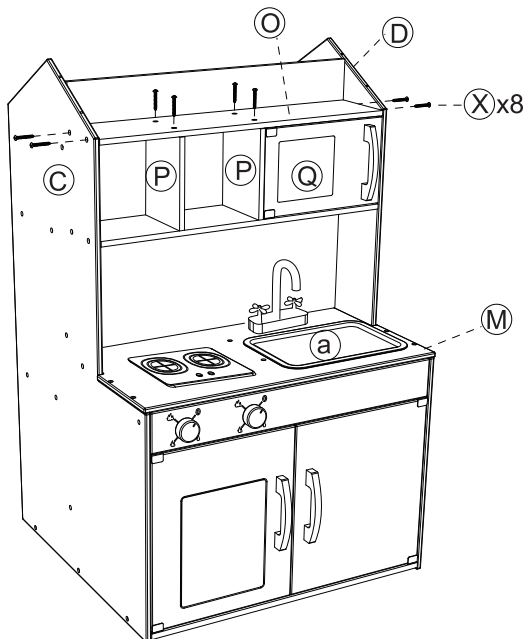

10

Assembly Instructio

Step 13:

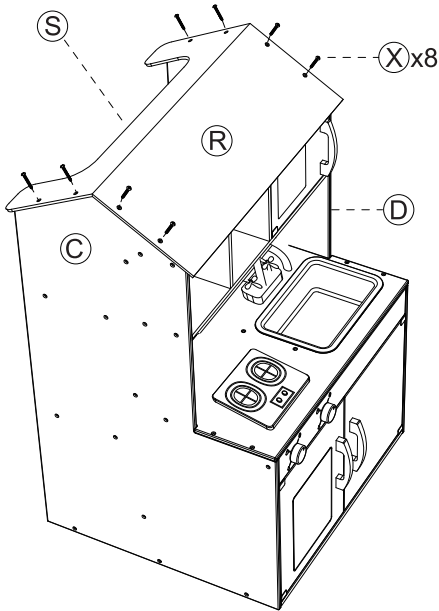

Step 14:

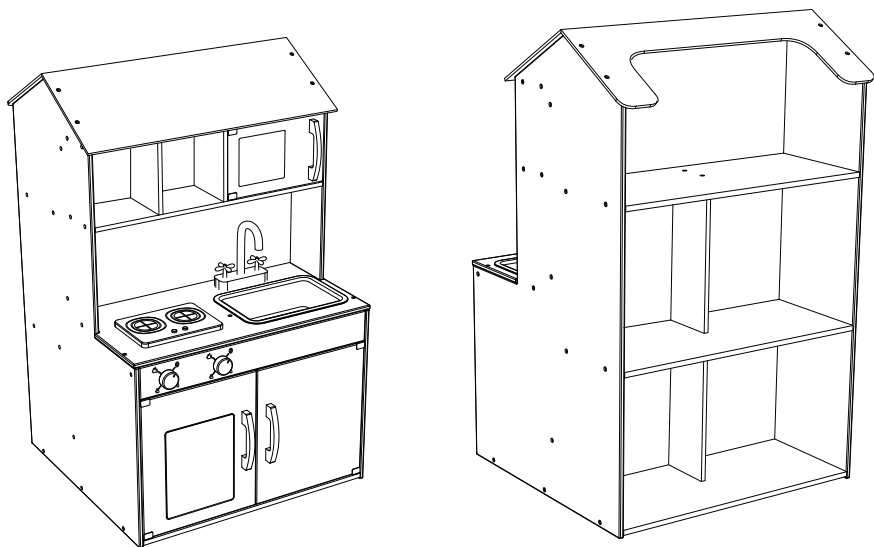

11

Care and Maintenance

- Periodically check all fittings to ensure that none have come loose.
- Any loose fittings must be tightened using the correct tool.



Not suitable for children under 3 years due to small parts, choking hazard.

If you need help or have damaged or missing parts, call the **Customer Helpline:** 0345 604 0105
Produced for Chad Valley Toys. *Country of origin:* Made in China.
Address: 489-499 Avebury Boulevard, Central Milton Keynes, MK9 2NW.
www.argos.co.uk/chadvalley

12