

**DRIFTKART**

## 24V Hyper Drift Kart Battery Powered Ride-On Vehicle

# Parent and Rider Manual

**STOP!**

**DO NOT RETURN TO STORE**

**This product cannot be returned  
for a refund after it has been  
unpacked and used.**

**Call us Toll-Free  
at 1-866-204-9737 or  
for assistance and information  
from our trained staff.**

**For product related questions  
or custom service needs please  
email [info@hypertoys.com](mailto:info@hypertoys.com)**

**VISIT US ONLINE@  
[www.hypertoys.com](http://www.hypertoys.com)**

**CAUTION! CHARGER IS A ELECTRONICALLY OPERATED PRODUCT:  
Recommended only for children between 8-14 years of age. As with all  
electric products, precautions should be observed during handling  
and use to prevent electric shock.**



**WARNING: USE AT YOUR OWN RISK. ADULT SUPERVISION IS REQUIRED**  
THIS IS A POWERFUL TOY AND IS NOT INTENDED FOR RIDERS UNDER THE AGE OF 8 YEARS OLD

Do not discard this owner's manual. Refer to the manual for important instructions before operating and to progress in skill.

No more than 1 rider at a time. Do not exceed 154lbs (70kgs) rider weight.

Do not allow riders under the age of 8 years old to use this product. Adult supervision is required.

Always wear shoes and proper protective gear, such as ANSI, SNELL, or ASTM approved helmets. Elbow and knee pads are also recommended.

Battery life may be reduced in extreme temperatures or with a maximum weight load.

Use only in safe controlled areas, not on public streets, or near motor vehicles.

Do not ride at night or in low visibility conditions.

Steep, rough, uneven, or wet surfaces can increase risk to the rider.

Be sure to check local regulations to understand how and where it is allowed to use this product.

**CONTAINS SEALED LEAD-ACID BATTERY. MUST BE RECYCLED OR DISPOSED OF SAFELY.**

FOR ASSISTANCE WITH  
YOUR ASSEMBLY CALL:  
**1-866-204-9737 TOLL FREE**

**HYPER TOY  
CO**

**DRIFTKART**

**24V Hyper Drift Kart  
Battery Powered Ride-On Vehicle**

# Parent and Rider Manual

**With directions  
for assembly and  
operation**

Please read this manual before assembly.  
Remember to save your receipt.

**DRIFTKART**

**HYPER TOY  
CO**

**24 VOLT  
ELECTRIC**

**AGE 8-14**  
MAX WEIGHT  
154 LBS



**MAX WEIGHT: 154 LBS (70 KGS)**

**MAX RIDERS: 1**

**MAX SPEED: 5 MPH (8 KPH) LOW**

**FORWARD AND BACKWARDS**

**9 MPH (14.8 KPH) HIGH**

**FORWARD ONLY**

**EASY PUSH BUTTON OPERATION**

**24 VOLT BATTERY AND CHARGER INCLUDED**

**WORKS ON HARD SURFACES AND GRASS**

**CONTAINS LEAD ACID BATTERY**

**⚠ WARNING:**

Assembly by an adult.

**⚠ WARNING:**

CHOKING HAZARD- Small parts.  
Not for children under 36 months.

FOR ASSISTANCE WITH  
YOUR ASSEMBLY CALL:  
**1-866-204-9737 TOLL FREE**

**HYPER TOY  
CO**

# Table of Contents

# *DRIFTKART*

<b>Important Information</b>	<b>1</b>
<b>Safety, Warnings and Cautions</b>	<b>2</b>
<b>Riding Safely</b>	<b>3</b>
<b>Battery Charging</b>	<b>4</b>
<b>Pre-Assembly Parts &amp; Tools</b>	<b>5-6</b>
<b>Assembly</b>	<b>7-13</b>
<b>Operation</b>	<b>14</b>
<b>Vehicle Care &amp; Pre-Ride Check</b>	<b>15</b>
<b>Troubleshooting</b>	<b>16</b>
<b>Limited Warranty</b>	<b>17</b>
<b>Product Registration</b>	<b>18</b>

## Important Information

- **ADULT ASSEMBLY AND SUPERVISION REQUIRED.**
- The battery must be charged for 12 hours before first use.  
To start charging the battery before starting assembly, see Battery Charging and Installation Information on page 4.
- Instruct children on safe operation and driving rules before they take their first ride:
  - Only one rider at a time.
  - Always wear shoes while operating this vehicle.
  - Always wear a helmet.
  - Do not allow other children around this vehicle while riding.
  - Do not place your hands, feet, any part of your body, clothing or other articles near moving parts of this vehicle while vehicle is in operation.
  - Do not sit on the rear end of this vehicles seat, it could cause vehicle to tip over.
  - Always sit in the middle of seat when riding this vehicle.
- California Proposition 65 Warning: This product contains or emits chemicals known to State of California to cause cancer and birth defects or other reproductive harm.
- Do not overload this vehicle or exceed the maximum weight capacity of 154 lbs, (70kg).  
**If you have questions please call 1-866-204-9737 toll free.**
- **Please read this manual completely** for operation and safety information **before** operating this vehicle. Keep this manual for future reference.

FOR ASSISTANCE WITH  
YOUR ASSEMBLY CALL:  
**1-866-204-9737 TOLL FREE**

## **WARNING: Electrical Hazard**

**RISK OF FIRE , DO NOT BYPASS.**

- Only use a two Hyper Toy Co. 12V lead acid batteries with this vehicle, contact customer service.
- Only use a Hyper Toy Co. 24V battery charger with this vehicle.
- Never modify the electrical system. Changes could cause a fire resulting in serious injury or death, and could also ruin the electrical system.
- The Battery can fall out and injure a child if the toy flips over.
- Never lift or carry the battery by the wires or connectors. This can damage the battery and possibly cause a fire resulting in serious injury or death, Always use the battery holder to carry it.
- The battery can be handled by adults only. The battery is heavy and contains sulfuric acid (electrolyte). Dropping the battery could cause serious injury.
- Children should never be allowed to charge the battery. Charging the battery must be done by adults only. The electricity involved in charging the battery could injure a child.
- The motors will get hot, handle carefully.
- Each time you charge the battery check the battery, charger, and their connectors for excessive wear or damage. Do not use the charger or the battery if damage or excessive wear is detected until you have replaced the worn or damaged parts.

## **WARNING: Riding Hazard**

**To reduce te risk of injury, adult supervision is required.**

- Never use in roadways, near motor vehicles.
- Never use on or near steep inclines or steps.
- Never near swimming pools or other bodies of water.
- Always wear shoes.
- Never allow more than 1 rider.
- Max weight of 154 lbs, (70 kgs).

## **WARNING: Battery Charger**

Changes or modifications to this unit not expressly approved by the party responsible for compliance could void the user's authority to operate the equipment.

**NOTE:** This equipment has been tested and found to comply with the limits for a Class B digital device, pursuant to Part 15 of the FCC Rules. These limits are designed to provide reasonable protection against harmful interference in a residential installation. This equipment generates, uses and can radiate radio frequency energy and, if not installed and used in accordance with the instructions, may cause harmful interference to radio communications.

However, there is no guarantee that interference will not occur in a particular installation. If this equipment does cause harmful interference to radio or television reception, which can be determined by turning the equipment off and on, the user is encouraged to try to correct the interference by one or more of the following measures:

- Reorient or relocate the receiving antenna.
- Increase the separation between the equipment and receiver.
- Connect the equipment into an outlet on a circuit different from that to which the receiver is connected.

Consult the dealer or an experienced radio/TV technician for help.

## **WARNING: Battery Charger**

- When fully unassembled, this package contains small parts. Adult assembly is required.
- Use the charger in dry areas only.



### **WARNING: Adult Supervision Required**

- Always Teach Safety First
- While most children can develop the physical skills necessary to operate this vehicle, it is important to remember that they do not yet have mature judgment skills. Children should never be allowed to ride this vehicle without adult supervision. Before any child rides this vehicle an adult must evaluate the child's skill levels and abilities to operate the vehicle safely. Even after instruction hazards are not always anticipated or recognized by children. So before any child operates the vehicle teach them appropriate safety rules.
- THERE IS NO SUBSTITUTE FOR DIRECT ADULT SUPERVISION.

### **WARNING: Safe Riding Rules**

To reduce the risk of injury adult supervision is required.

- Always sit on the vehicles designated seat only.
- Always wear boots or shoes when riding this vehicle.
- Never allow children between the age of 8-14 years old to operate this vehicle.
- Never have more than one rider at a time operating this vehicle.
- Do not attempt to perform racing, stunt riding, or other maneuvers, which may cause loss of control, or may cause uncontrolled rider actions or reactions.
- Never use headphones, a cell phone or text while operating this vehicle.
- Do not exceed this vehicles rider weight limit of 154 lbs (70 kgs).
- Do not operate this vehicle on the surfaces with water, sand, gravel, dirt, leaves, and other debris. Wet weather impairs traction, braking, and visibility.
- Avoid sharp bumps, drainage grates, and sudden surface changes.
- Do not operate this vehicle on or near drop-offs, obstructions, swimming pools or other bodies of water.
- Do not operate this vehicle in roadways, on the street or near moving vehicles.
- Do not operate this vehicle on or near steep inclines or steps. Use on generally level ground only.
- Do not operate this vehicle in the dark as unexpected obstacles could cause an accident.
- Do not operate this vehicle on slopes, this vehicle may accelerate or roll backwards at a unsafe speed.
- Do not allow hands, feet, hair, body parts, clothing, or similar articles to come in contact with moving parts, wheels, drive-train, or chain while this vehicles motor is running.
- Do not operate this vehicle near flammable vapors such as gasoline, paint thinner, acetone, liquid wax, etc. Electrical components can produce an internal spark when first turned on or off. Using this vehicle near flammable liquids or vapors could cause an explosion or fire resulting in serious injury or death.
- User need to follow Hyper Toy's recommendations and instructions, as well as comply with all laws and ordinances.
- Pregnant women, and people with heart conditions, and people with head, back, or neck ailments, or prior surgeries to those areas of the body shall be cautioned not to ride; People with mental or physical conditions that may make them susceptible to recognize, understand, and perform all of the safety instructions and to be able to assume the hazards inherent in unit use do not use this product.
- Before each cycle of operation, user shall do preparation checks specified by Hyper Toys.

# Battery

## Charging & Care

### Charging Battery

**⚠ CAUTION:** The battery and charger are not toys. All battery charging must be done by an adult.

**NOTE:** Your HYPER TOY COMPANY electric motorcycle may not have a fully charged battery; therefore you must charge the battery prior to first use. The initial charge time is 12 hours. Recharge time is up to 8-12 hours.

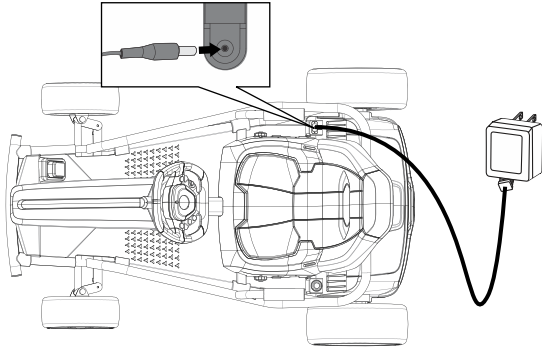

1. Insert the plug of charger into the charging port on vehicle as shown.

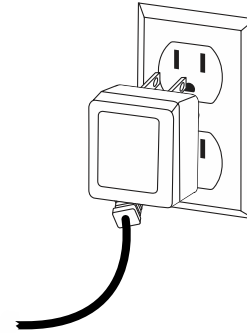

2. Make sure the power switch is in the OFF position. Plug the charger into a wall power outlet to charge the battery.

### Battery Care

- First Charge Time: 12 hours.
- Recharge Time: 8-12 hours.
- Recommended maximum charging time is 12 hours.
- Always charge the battery immediately after riding.
- Fully charge battery before storing for long periods of time.
- Unplug charger from the wall outlet when not in use.
- Failure to recharge battery periodically may result in a battery that will not accept a charge.
- Always turn OFF the vehicles ON/OFF power switch while not in use. Leaving the power switch ON for an extended period of time may damage the battery.
- Never store this vehicle in freezing or below freezing temperatures, this will damage the battery.
- Run time: Up to 1 hour. Run time may vary depending on riding conditions, rider weight, climate, and/or proper maintenance.
- This vehicle is equipped with an auto-reset fuse that takes 10 seconds to fully reset the fuse. Make sure the electric vehicle Power is switched to OFF.
- Constant stopping and starting may shorten ride time.
- Proper maintenance and usage of the unit will determine Battery Life.

### Battery Disposal

- Your vehicle's battery is a sealed lead-acid battery. You must recycle or dispose of it in an environmentally sound manner.
- Never dispose your battery in the regular, household trash. The incineration, land-filling, or mixing of a sealed lead-acid battery with your household trash is prohibited by law in most areas.
- Make sure to return exhausted batteries to a federal or state approved lead-acid battery recycler or contact Hyper Toy Company at 1-866-204-9737.
- Always remove exhausted batteries from your toy. Dispose of dead batteries properly; never burn or bury them.
- **Contact Customer Service at 1-866-204-9737 for Replacement Battery and Receive Free Shipping with Purchase of Battery.**
- To locate a battery service center, contact your local waste management company.

FOR ASSISTANCE WITH  
YOUR ASSEMBLY CALL:  
**1-866-204-9737 TOLL FREE**

**HYPER** TOY  
CO

# Parts

## Parts List

PART NO.	PART NAME	Q'ty (pcs)	REMARKS
1	Front Wheels	2	
2	Rear Wheels	2	
3	Wheel Cap	4	
4	Seat	1	
5	4x12 Flat Head Screw	12	Secures Seat and Left/Right Side Panels
6	Steering Axle	1	
7	M12 Washer	1	Steering Axle Limit Washer
8	Rear Axle	1	
9	Left/Right Side Panels	2	
10	Steering Axle Holder	1	
11	M5x25 Screw	1	Secures Steering Wheel Support Tube
12	M5 Lock Nut	2	Secures Steering Wheel and Support Tube
13	M5x50 Bolt	1	Secures Steering Wheel
14	Front Guard	1	
15	M10 Lock Nut	4	Secures Front and Rear Wheels
16	M6 Lock Nut	2	Secures Front Axle
17	M6 Washer	2	Secures Front Axle
18	M8x86 Pin	2	Secures Front Axle
19	Small Sleeve	2	Secures Front Wheels
20	M10 Washer	4	
21	Steering Wheel	1	
22	Front Axle	1	
23	Manual	1	
24	Wrench	2	
25	Battery Charger	1	

FOR ASSISTANCE WITH  
YOUR ASSEMBLY CALL:  
**1-866-204-9737 TOLL FREE**

**HYPER** TOY  
CO

# Parts

# Parts Diagram

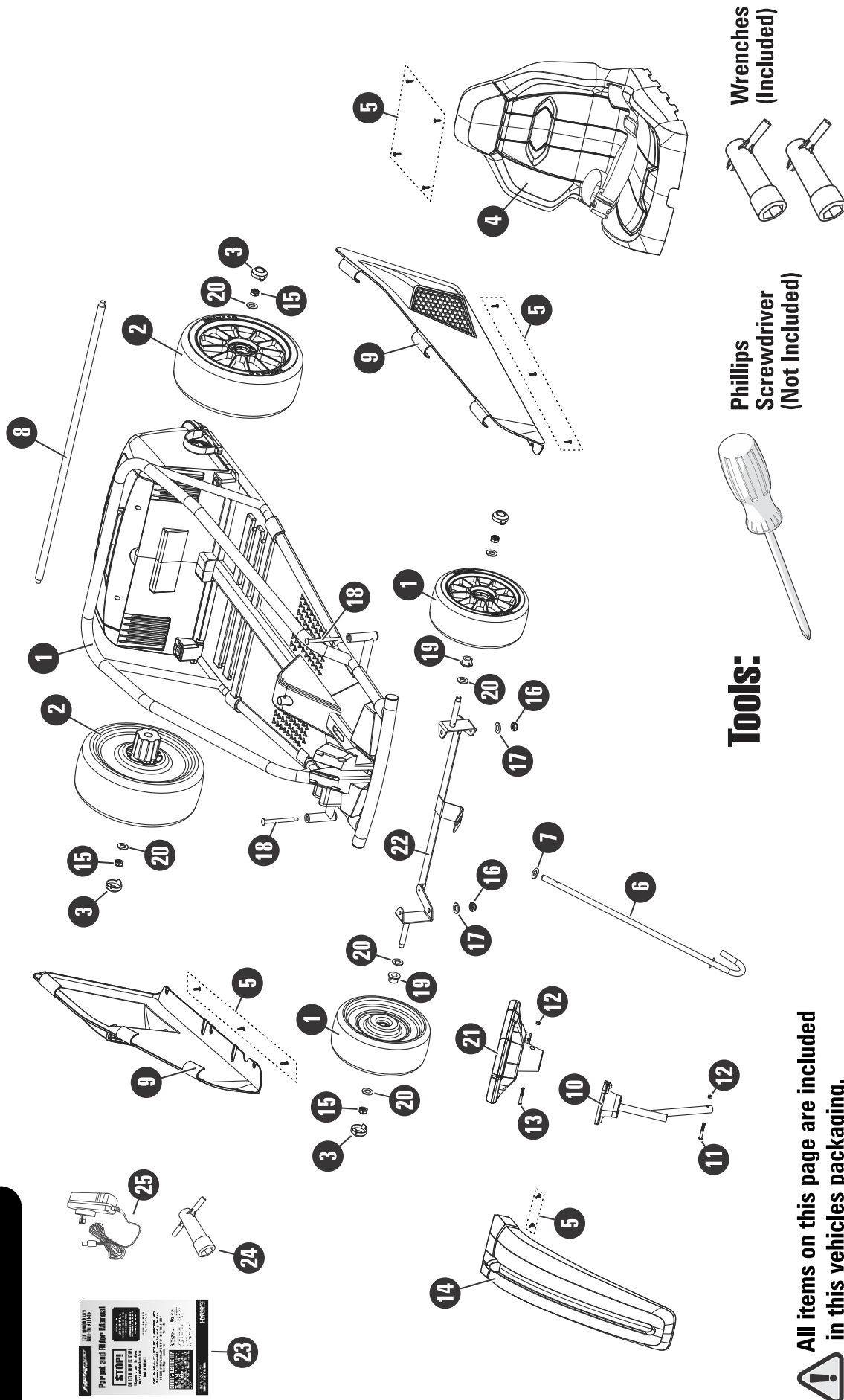

**!** All items on this page are included in this vehicles packaging.

FOR ASSISTANCE WITH YOUR ASSEMBLY CALL: **1-866-204-9737 TOLL FREE**

**HYPERCO**

# Assembly

## Rear Axle & Wheels

**⚠ WARNING:** DO NOT USE OTHER PRODUCTS WITH YOUR HYPER VEHICLE. The HYPER TOY COMPANY electric vehicle has been built to certain HYPER TOY COMPANY design specifications. The original equipment supplied at the time of sale was selected on the basis of its compatibility with this vehicle. Aftermarket products may not be compatible and will void your warranty.

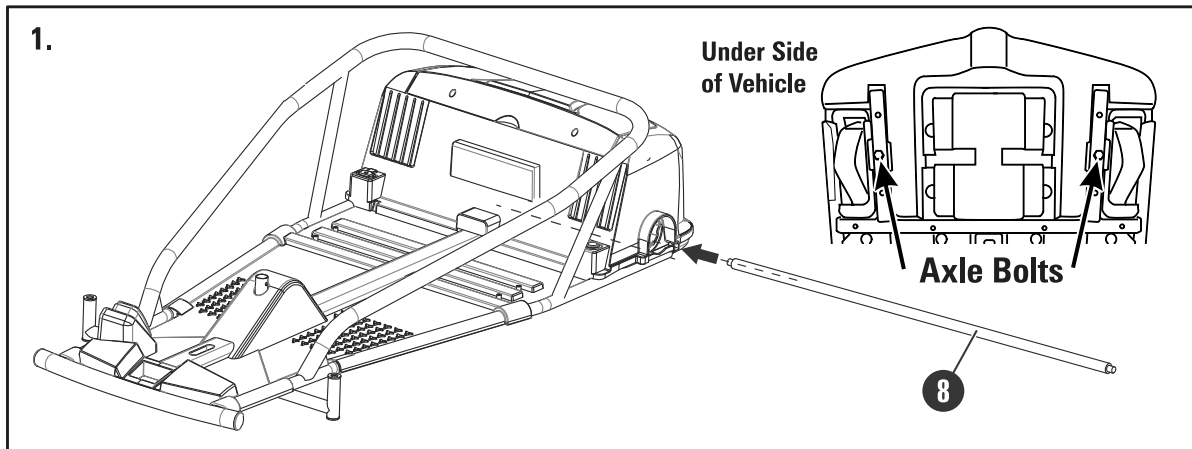

Loosen the two **Axle Bolts**, with a 10mm wrench, only enough to install the (**Rear Axle, Part#8**). Insert the **Rear Axle** into one side of the vehicle body as shown. When **Rear Axle** is fully installed there should be an equal amount of the **Rear Axle** showing on the left and right sides of the vehicle body.

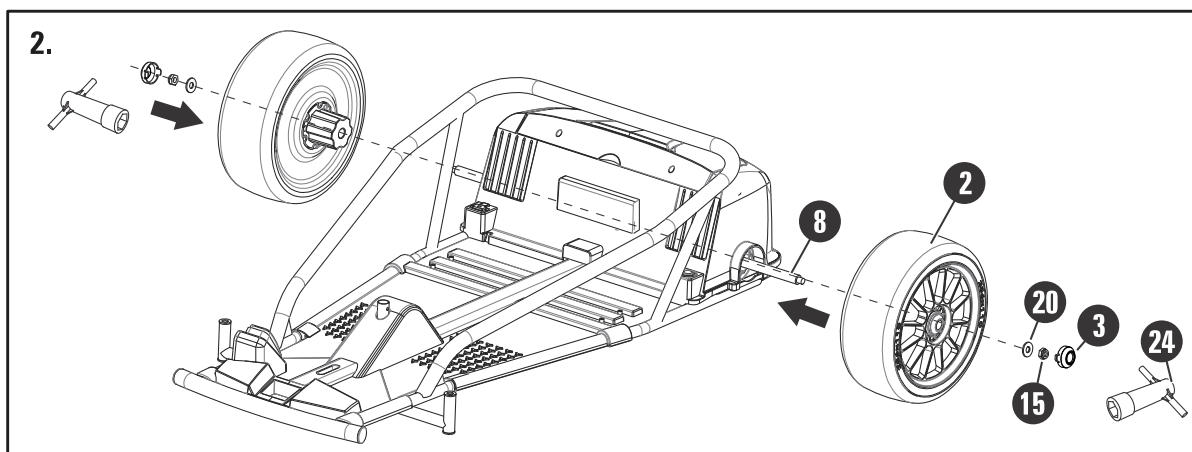

Place the center of the (**Rear Wheel, Part#2**) onto the end of the **Rear Axle**. Push **Rear Wheel** towards the vehicle body and align the back of the rear wheel gear with the drive motor inside the vehicle body as shown. Place in this order the (**M10 Washer Part#20**), (**M10 Lock Nut, Part#15**) onto the **Rear Axle**. Tighten **M10 Lock Nut** slightly by hand. Repeat this process on opposite side of vehicle. Use the two provided (**Wrenches, Part#24**) to tighten the left and right **Rear Wheel M10 Lock Nuts** until the both rear wheels are secure. Align and press left and right (**Wheel Caps, Part#3**) into center of both rear wheels.

FOR ASSISTANCE WITH  
YOUR ASSEMBLY CALL:  
**1-866-204-9737 TOLL FREE**

**HYPER** TOY  
CO

# Assembly

## Rear Axle & Front Wheels

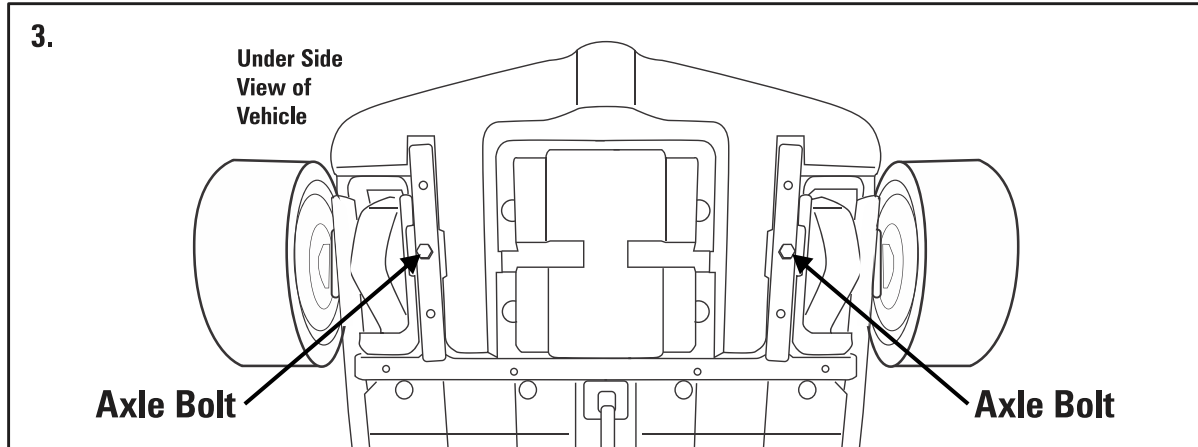

After the rear wheels are installed carefully turn the vehicle upside down and tighten the **Axle Bolts** that secure the **Rear Axle** with a 10mm wrench until **Rear Axle** is secure.

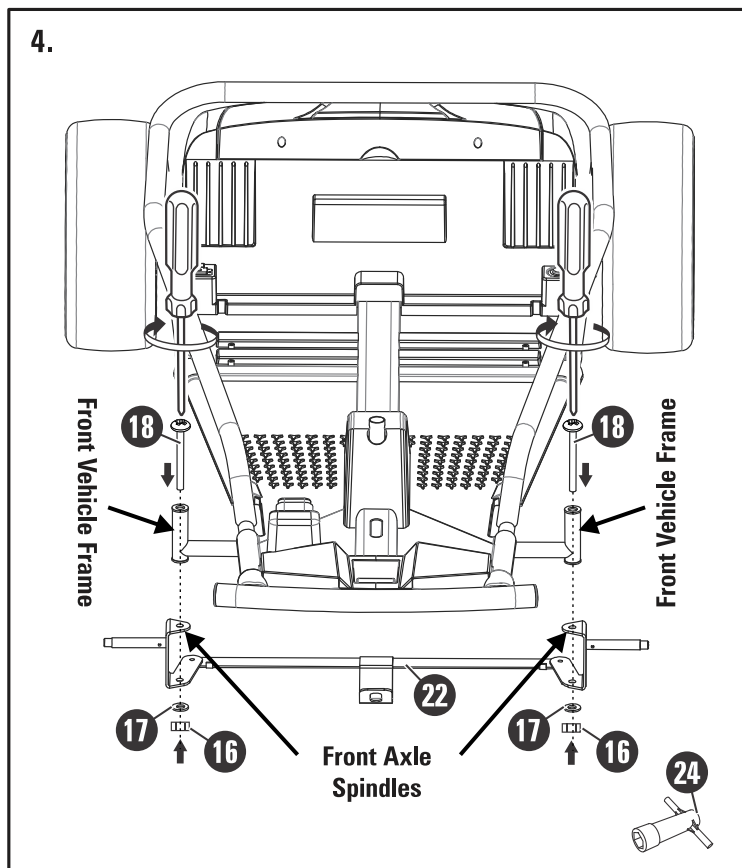

Locate the (**Front Axle, Part#22**), (**M8x86 Screw Part#18**), (**M6 Washer, Part#17**), (**M6 Lock Nut, Part#16**), and (**Wrench Part#24**) provided with this vehicle. With vehicle right side up place the **Front Axle Spindles** around the front of vehicle frame as shown. Align the holes on the **Front Axle Spindles** with the holes on the front vehicle frame as shown. From the top insert the **M8x86 Screw** completely through the **Front Axle Spindles** holes. Place the **M6 Washer** and **M6 Lock Nut** onto bottom end of the **M6 Screw**. Tighten **M6 Lock Nut** with provided **Wrench** and non-provided phillips screwdriver until the **Front Axle** is secured to the **Front Vehicle Frame**. Repeat this process on opposite side of the **Front Axle**.

FOR ASSISTANCE WITH  
YOUR ASSEMBLY CALL:  
**1-866-204-9737 TOLL FREE**



# Assembly

## Front Wheels & Steering Wheel

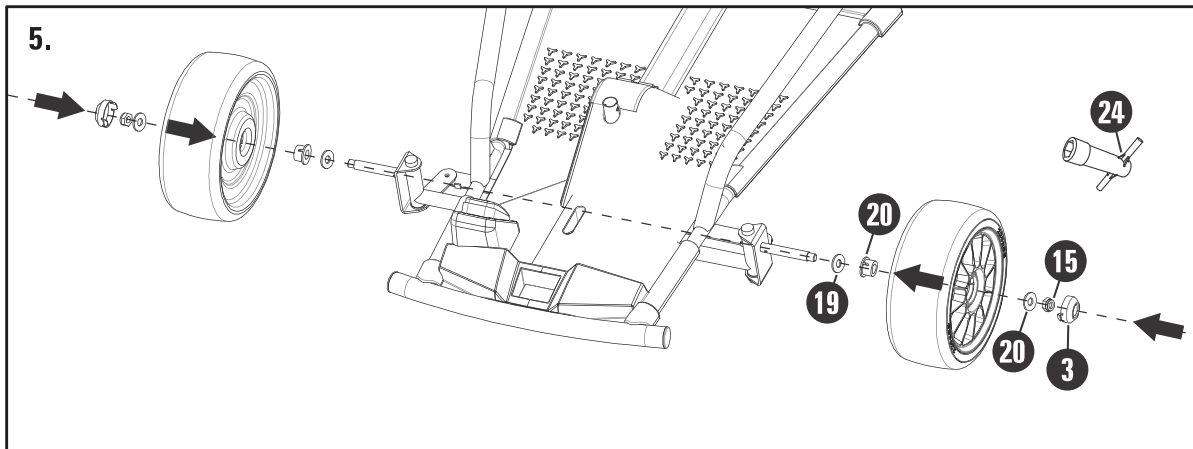

Place the **(M10 Washer, Part#20)** onto the **(Front Axle, Part#22)**. Align **(Small Sleeve, Part#19)** to the back of **(Front Wheel, Part#1)** and press together. Place **Front Wheel** onto **Front Axle**. Place **(M10 Washer, Part#20)** and **(M10 Lock Nut, Part#15)** onto **Front Axle**. Tighten **M10 Lock Nut** with provided **(Wrench, Part#23)** until **Front Wheel** is secure but still spins freely. Align and press **(Wheel Cap, Part#3)** into center of the **Front Wheel**. Repeat this process on the opposite side of the **Front Axle**.

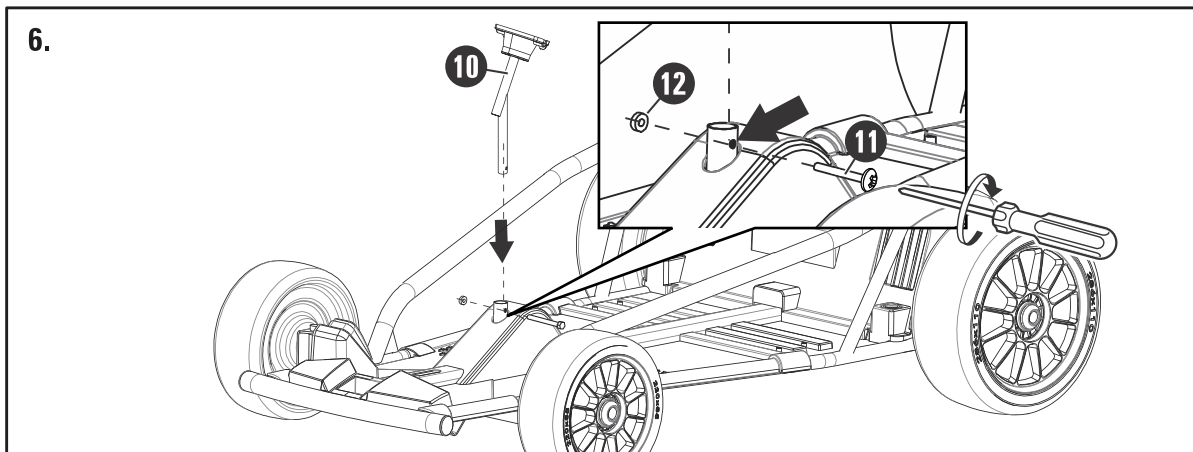

Locate the **(Steering Column, Part#10)** and insert into the vehicles frame as shown. Locate the **(M5x25 Screw Part#11)** and **(M5 Lock Nut Part#12)**. Insert the **M5x25 Screw** into the **Steering Column** hole and place the **M5 Lock Nut** on the end of the **M5x25 Screw**. Use a phillips screwdriver to tighten the **M5x25 Screw** until **Steering Column** is secure to vehicle.

FOR ASSISTANCE WITH  
YOUR ASSEMBLY CALL:  
**1-866-204-9737 TOLL FREE**

**HYPER** TOY  
CO



# Assembly

## Steering Wheel

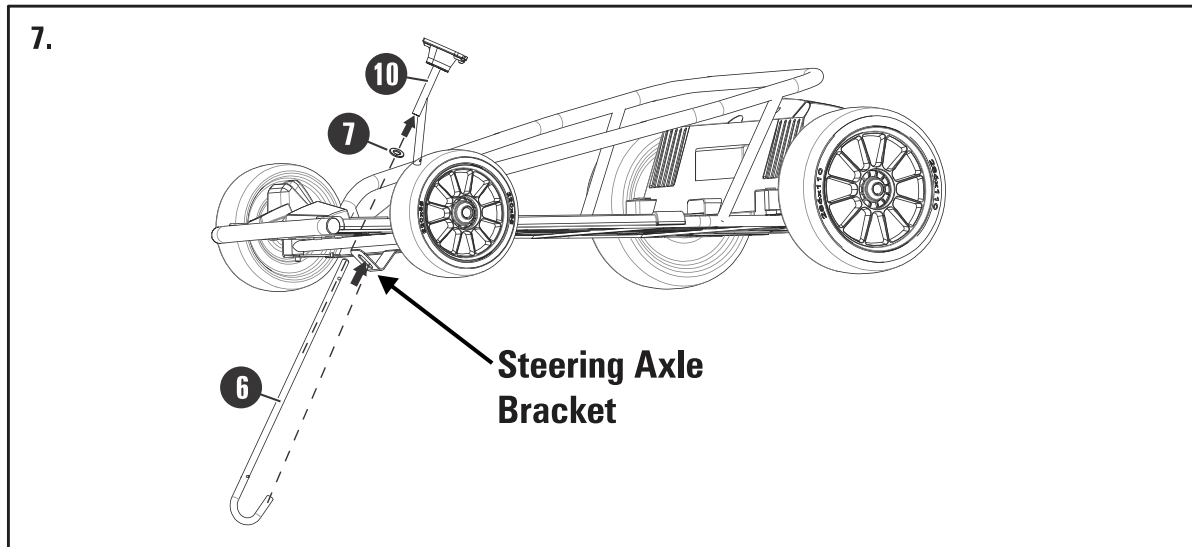

Place the **(M12 Washer, Part#7)** over the top of the **(Steering Axle, Part#6)**. Align the bottom curved part of the **Steering Axle** into the **Steering Axle Bracket** while at the same time inserting the straight section of the **Steering Axle** through the **(Steering Column, Part#10)** as shown.

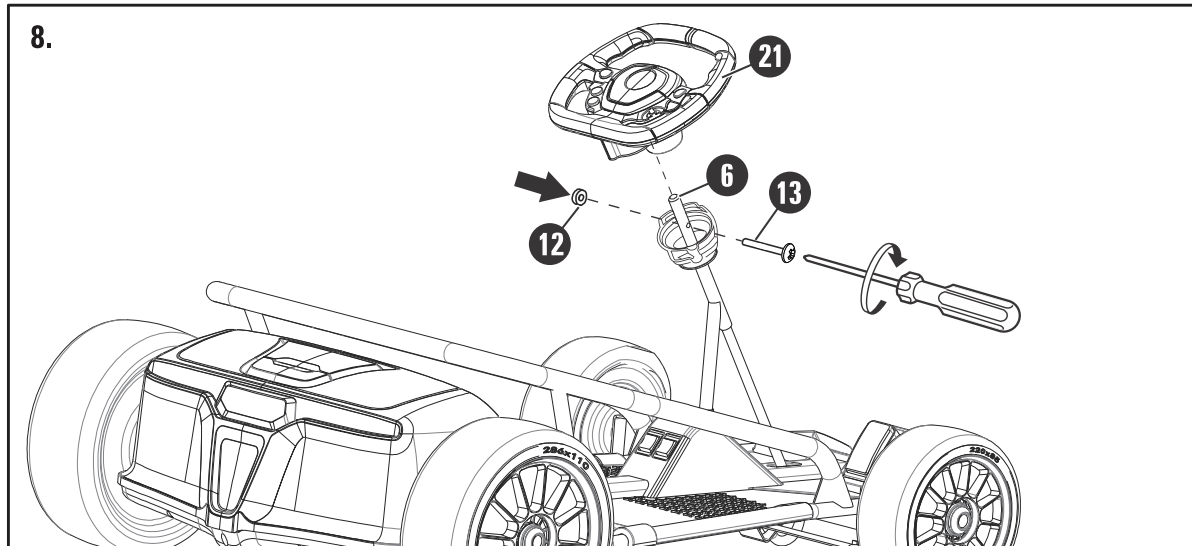

Locate the **(Steering Wheel, Part#21)** and align the center slot with the **(Steering Axle, Part#6)**. Place **Steering Wheel** onto the **Steering Axle** as shown. Align the **Steering Wheel** and **Steering Axle** holes and insert the **(M5x55 Screw, Part#13)** completely through the **Steering Wheel**. Place the **(M5 Lock Nut, Part#12)** on the end of the **M5x55 Screw** and tighten securely with a phillips screwdriver.

FOR ASSISTANCE WITH  
YOUR ASSEMBLY CALL:  
**1-866-204-9737 TOLL FREE**

**HYPER** TOY  
CO

# Assembly

## Install Front Guard & Side Panels

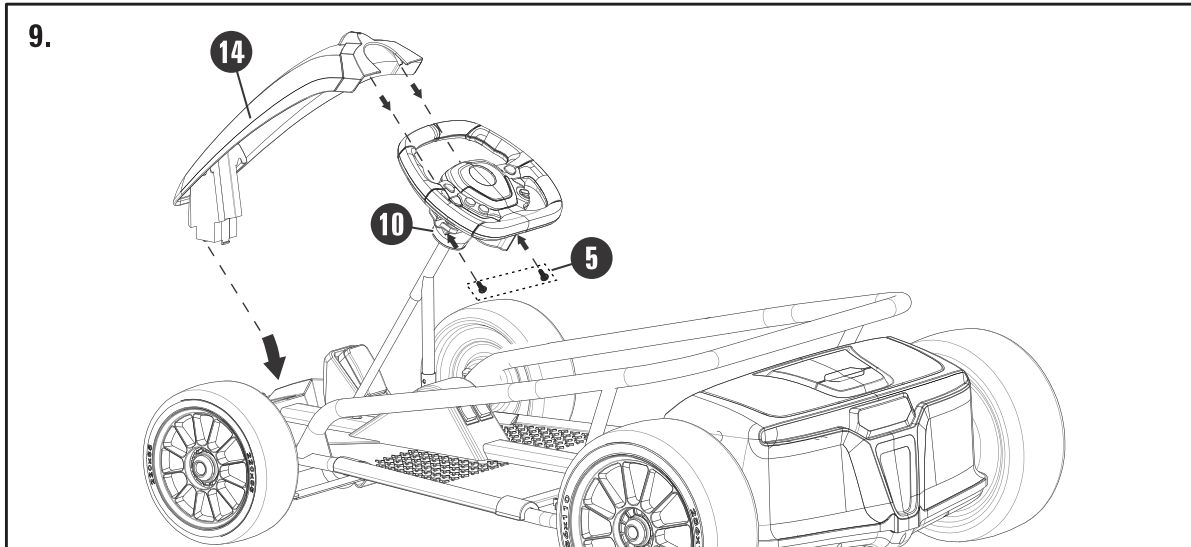

Insert the bottom (**Front Guard, Part#14**) to the car base as shown. Align the top of **Front Guard** to the top of the (**Steering Column, Part#10**). Attach **Front Guard** with the provided two (**4x12 Screws, Part#5**) and tighten with a phillips screw driver.

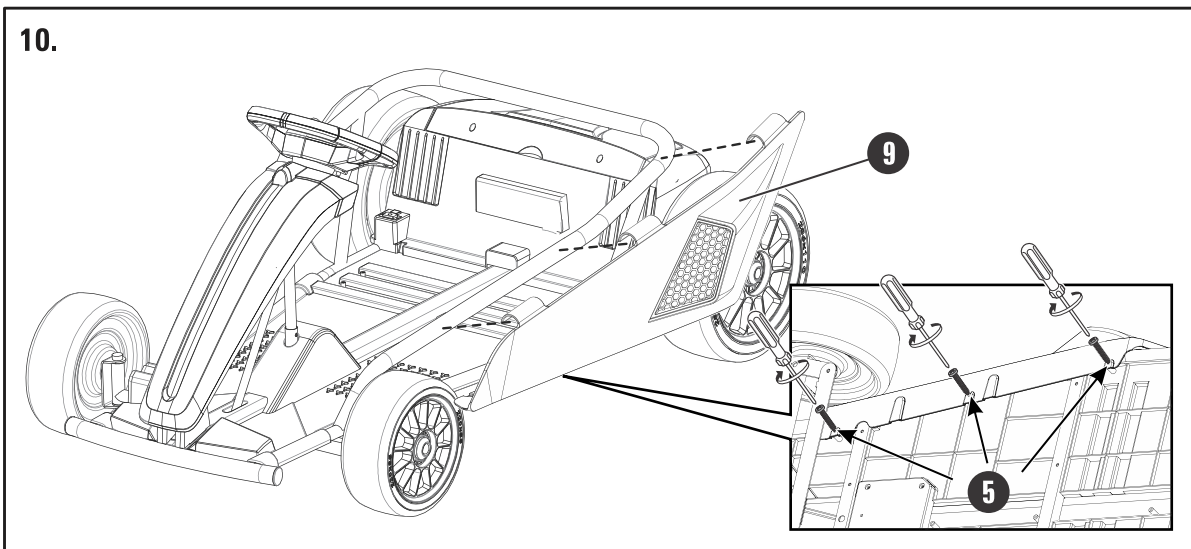

To install the (**Side Panels, Part#9**) first use the hooks on the **Side Panel** to clamp to the upper steel tube of vehicles frame as shown. Place the bottom of the **Side Panel** around the bottom of **Vehicle Body** and align the screw holes. Insert the (**4x10 Screws, Part#5**) and tighten with a phillips screwdriver until secure to the vehicle body.

FOR ASSISTANCE WITH  
YOUR ASSEMBLY CALL:  
**1-866-204-9737 TOLL FREE**

**HYPER** TOY  
CO

# Assembly

## Connect Battery Power

11.

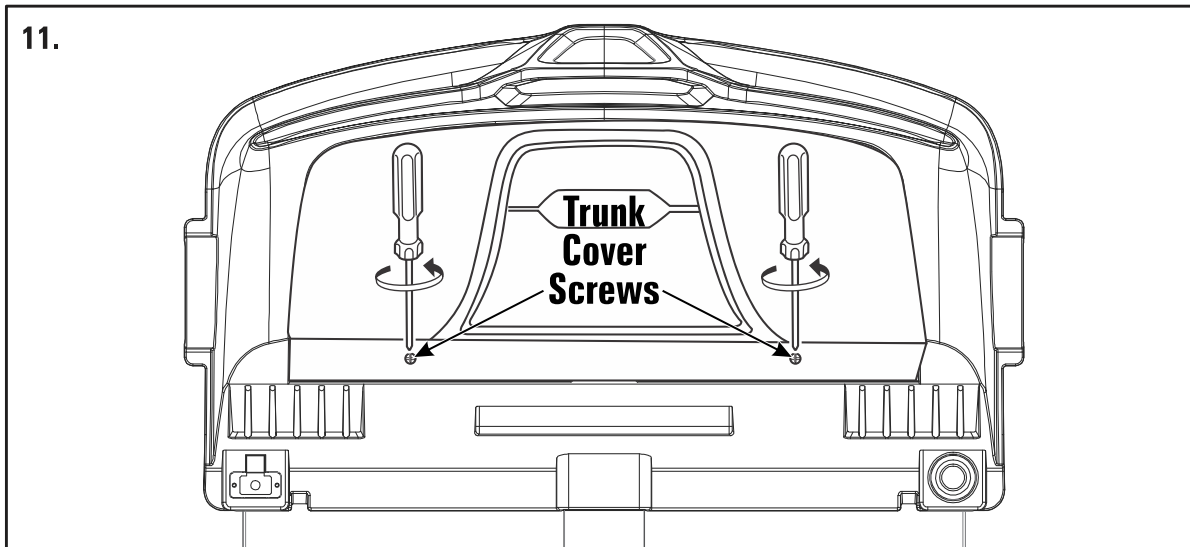

Locate and remove the two **Trunk Cover Screws** with a phillips head screwdriver as shown. Keep Trunk Cover Screws in a safe place to reinstall later.

12.

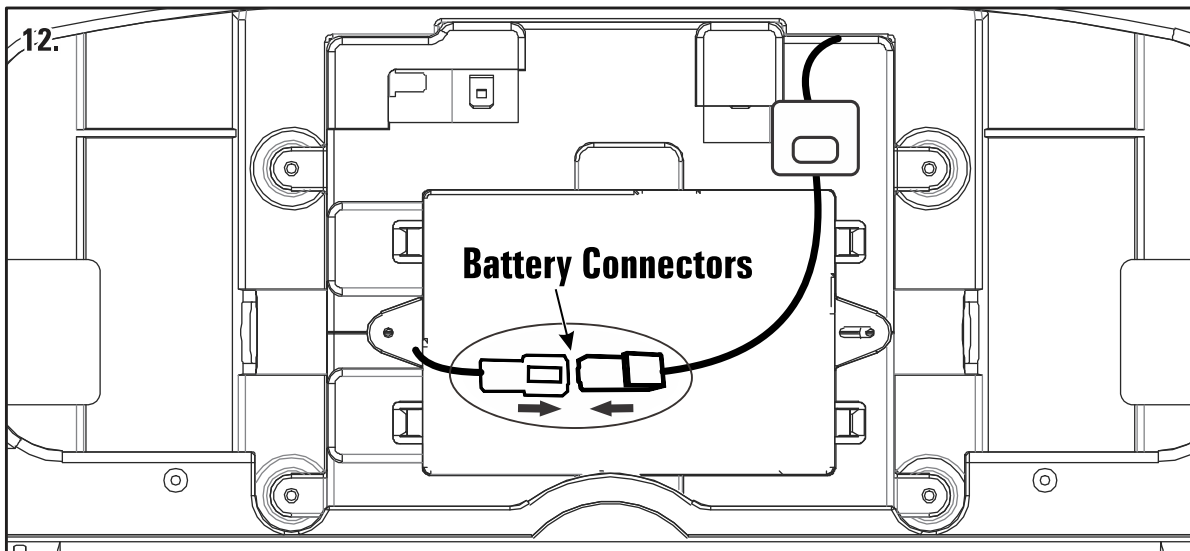

Remove **Trunk Cover** and locate the male and female **Battery Connections** inside the vehicle trunk. Locate, align, and press together the male and female **Battery Connections** until the connectors are fully installed and secure. Place the **Trunk Cover** back onto vehicle trunk and reinstall the two **Trunk Cover Screws**. Tighten both **Trunk Cover Screws** with a phillips screwdriver until the **Trunk Cover** is secured to vehicle.

FOR ASSISTANCE WITH  
YOUR ASSEMBLY CALL:  
**1-866-204-9737 TOLL FREE**

**HYPER** TOY  
CO

# Assembly

## Install Seat & Sound Control Batteries

13.

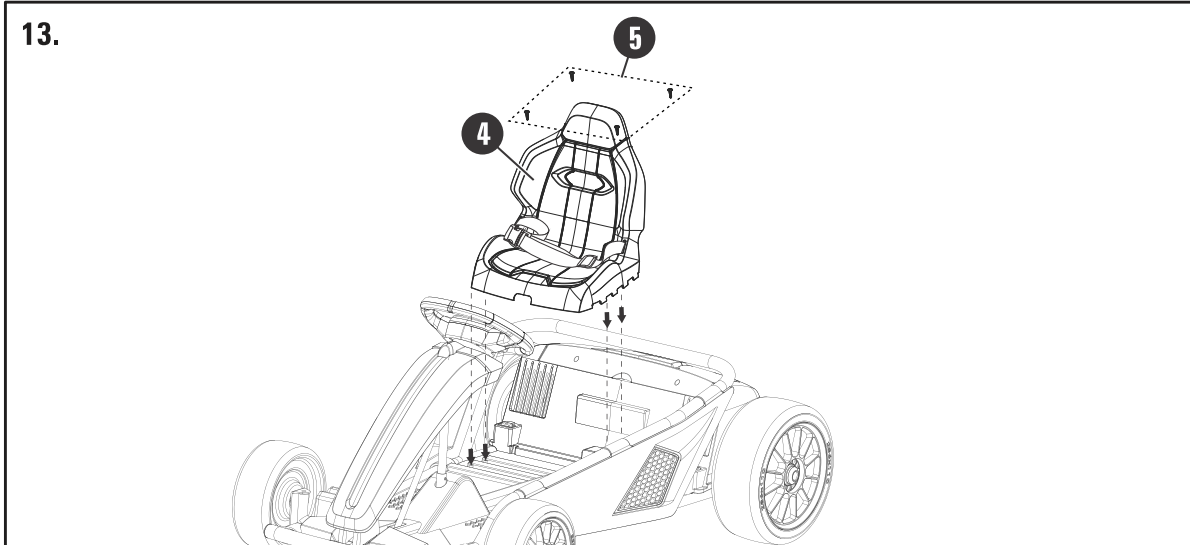

Place the **(Seat, Part#4)** onto the **Vehicle Body** as shown. Align the **Seat** screw holes with the **Vehicle Body** screw holes. Insert the **(4x12 Screws, Part#5)** and tighten with phillips screwdriver until secure.

FOR ASSISTANCE WITH  
YOUR ASSEMBLY CALL:  
**1-866-204-9737 TOLL FREE**

**HYPER** TOY  
CO

# Operation

## 24V Drifter Kart Electric Vehicle Controls

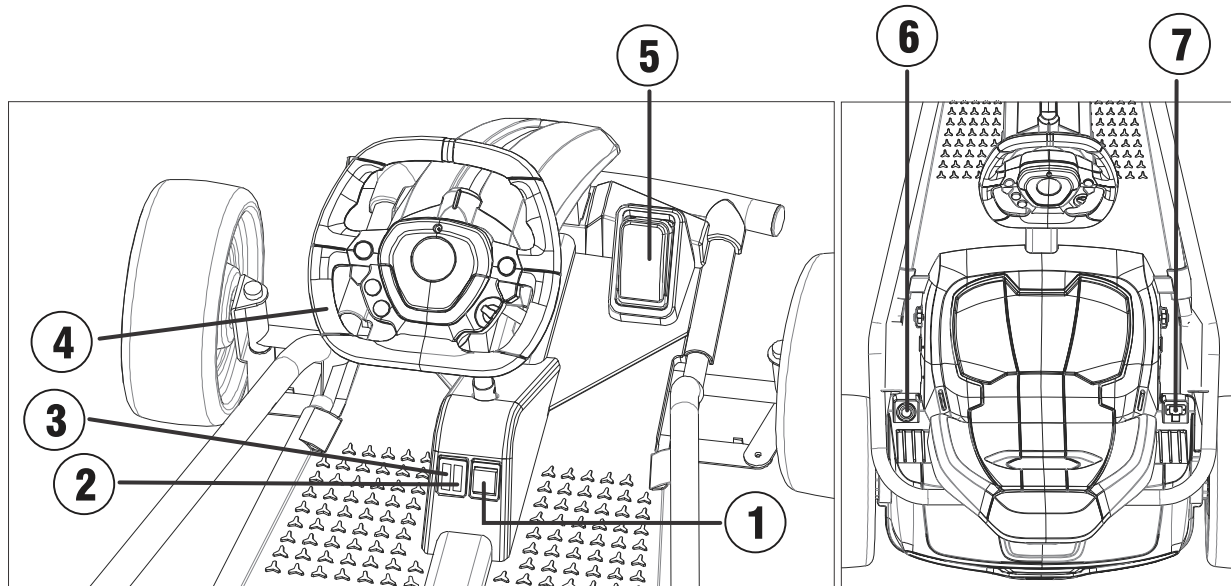

**1. Forward / Neutral / Reverse Switch:** The rider must use this to set the direction the vehicle will move when the vehicles acceleration pedal is engaged. Only change vehicle direction when this vehicle is at a complete stop.

**2. High and Low Speed Switch:** Use this switch to change the HIGH/LOW SPEED settings. Low speed, forward and reverse, is maximum 5 mph, (8 kph). High speed setting is maximum 9 mph, (14.8 kph), forward only.

**3. Drift Switch:** Use this switch to turn ON the "Drifting" operation mode. This will change how this vehicle reacts to turns. Make sure the new riders slowly become accustom to how the vehicle handles in the "Drift" mode in a safe area first.

**4. Steering Wheel:** Rider must use this to control left or right steering of the vehicle.

**5. Accelerator Pedal:** When the rider pushes the accelerator pedal with their foot it will move this vehicle forward or in reverse. When the accelerator pedal is released it will act as the brake allowing this vehicle will stop immediately.

**6. Power ON/OFF Button:** Hold down Power Button for 2 seconds to turn the vehicle ON or until the battery power indicator lights turn on. To turn vehicle power OFF hold down Power Button for 2 seconds until the vehicle power is OFF.

**7. Battery Charging Port:** Insert the provided battery charger input into the vehicle charger port.

FOR ASSISTANCE WITH  
YOUR ASSEMBLY CALL:  
**1-866-204-9737 TOLL FREE**

**HYPER** TOY  
CO

# Vehicle Care & Pre-Riding Check

**⚠ ATTENTION!** Adult supervision is always required while this vehicle is being operated, battery re-charged, assembled, or repaired.

- Check all screws, nuts, and protective coverings regularly and tighten securely.
- Check all plastic parts on a regular basis for cracks or broken pieces.
- Never use this battery powered vehicle near water or in wet weather conditions such as rain and snow.
- Never change gears with the shift lever while vehicle is still in motion. Always come to a complete stop then use shift lever to change gears.
- Never operate this vehicle in mud, sand, loose dirt, or gravel. This can cause the electric switches and motor to fail.
- Never wash this battery powered vehicle with soap and water, this can cause the electric parts of the vehicle to fail. To clean this vehicle only use a non-wax furniture polish applied to a soft micro-fiber soft cloth.
- Always store vehicle inside or under a protective cover.
- Always re-charge this vehicles battery 8 - 12 hours every month while not in regular use to extend the life of the battery.

FOR ASSISTANCE WITH  
YOUR ASSEMBLY CALL:  
**1-866-204-9737 TOLL FREE**

# Troubleshooting

<b>Problem</b>	<b>Possible Cause</b>	<b>Solution</b>
<b>Electric Vehicle Does Not Run</b>	<b>Undercharged Battery</b>	Charge the battery. A new battery should have been charged for at least 12 hours before using the electric scooter for the first time and up to 12 hours after each subsequent use. Check all connectors. Make sure the charger connector is tightly plugged into the charging port, and that the charger is plugged into the wall. Make sure power flow to the wall outlet is on.
	<b>Loose Wires or Connectors</b>	Check all wires and connectors to make sure they are tight. The fuse will reset and automatically shut off the power if the motor is overloaded.
<b>Electric Vehicle Was Running But Suddenly Stopped</b>	<b>Fuse is Resetting</b>	An excessive overload such as a heavy rider or steep hill could overheat the motor. Turn Power OFF and wait at least 10 seconds for fuse to reset itself. Avoid conditions that caused the fuse to burn out and avoid repeatedly burning out fuse (Refer to page 4 of this manual). Contact Hyper Toy Company at 1-866-204-9737 for diagnosis and repair.
<b>Short Run Time (Less than 15 minutes per charge)</b>	<b>Motor or Electrical Switch Damage</b>	Charge the battery. A new battery should have been charged for at least 12 hours before using the electric scooter for the first time and up to 12 hours after each subsequent use.
	<b>Undercharged Battery</b>	Check all wires and connectors. Make sure the battery connector is tightly plugged into the charger connector, and that the charger is plugged into the wall.
	<b>Old Battery Will Not Except Full Charge</b>	Even with proper care, a rechargeable battery does not last forever. Average battery life is 1 to 2 years depending on product use and conditions. Contact Hyper Toy Company at 1-866-204-9737 for diagnosis and repair.
<b>Electric Vehicle Runs Sluggishly</b>	<b>Riding Conditions Are Too Stressful</b>	Use only on solid, flat, clean and dry surfaces, such as pavement or level ground.
	<b>Electric Vehicle is Overloaded</b>	Make sure you do not overload the electric vehicle by allowing more than one rider at one time, exceeding the maximum weight limit, going up too steep a hill or towing objects behind the product.
<b>Electric Vehicle Sometimes Stays On and Other Times it Doesn't</b>	<b>Loose Wires or Wire Connections</b>	Check all wires around the motor and all connectors to make sure they are tight.
	<b>Electric Motor or Switch Damaged</b>	Contact Hyper Toy Company at 1-866-204-9737 for diagnosis and repair.

FOR ASSISTANCE WITH  
YOUR ASSEMBLY CALL:  
**1-866-204-9737 TOLL FREE**



# Limited Warranty

## DO NOT RETURN YOUR VEHICLE TO THE STORE

1. Product needs to be returned in original packaging and unused and as purchased from your retail store and include the ORIGINAL PURCHASE OR SALES RECEIPT to validate your limited warranty.
  2. Products must be New and Unused.
  3. Products must be shipped back with Original packing, parts, and accessories.
- If any part is found missing when returning each part cost (list on Service Manual) should be deducted from the product purchase amount.

Hyper Toy Company offers the following limitations, terms and conditions to the original owner of the Hyper Toy Company electric ride-on toy. Should this Hyper Toy Company electric ride-on toy or any part be determined defective by Hyper Toy Company to be covered by this limited Warranty, it will be repaired or replaced, at Hyper Toy Company sole option, which will be conclusive and binding. Hyper Toy Company will pay all labor cost, connected with the repair or replacement of all parts covered under this limited warranty. Under no circumstances does this limited warranty include the cost of travel or shipment to and from any retailer or consumer. Such cost, if any, shall be borne by the original or subsequent owner.

This Hyper Toy Company electric ride-on toy has not been designed or engineered for ramp riding, jumping, aggressive riding, riding in severe climates, riding over severe terrain, riding with heavy loads over (154lbs or 70kgs) or any similar activities. Such uses may damage the Hyper Toy Company electric ride-on toy, that can cause serious injury to the rider and in all cases will void this warranty.

### **6 Months From The Date Of The Purchase On Vehicle**

Hyper Toy Company electric ride-on body, display, throttle and throttle assembly, control wiring harness, wiring and wiring harness, motor and associated transmission and all components not directly associated with the 24V battery are warranted from 6 months from data of purchase to The ORIGINAL PURCHASER against any defects in material, manufacturing, and/or workmanship. If there is any evidence of consumer repair the warranty is voided. Any claim of damage under this clause cannot be due to owner abuse or neglect and must first be reported to Hyper Toy Company Customer Service and a Return Merchandise Authorization (RMA) tag to be issued.

### **3 Months From The Date Of The Purchase On Battery**

The battery must be charged for a full 12 hours but never more than 24 hours before the units first use. The 24V battery and battery charger (AC Adaptor) that is included with the original vehicle is warranted to be free from defects in material, parts and/or workmanship, again not due to owner abuse or neglect. If there is evidence of customer repair or use of other's battery or charger the warranty is voided. This limited warranty is only valid to the original purchaser and must first be reported to Hyper Toy Company Customer Services and a Return Merchandise Authorization (RMA) tag be issued.

Wheels are considered a wear and tear item and are only under warranty in the event of manufacturer defect.

Items not covered under warranty terms under any conditions

1. Damage due to failure to maintain the battery as accurately described on various product warning stickers and the products owner's manual.
2. Damage due to maintenance or the actual damage caused by the lack of maintenance.
3. Damage due to improperly assembled products.
4. Damage due to climatic or environmental damage, various cleaners and/or chemicals that may result in damaging the vehicles finish.

This warranty does not cover and is intended to exclude any liability on the part of Hyper Toy Company. Whether under this warranty or implied by law or indirect or consequential damages for breach of warranty.

This warranty gives you specific legal rights. You may also have other rights that vary from state to state and province to province. In those states that do not allow the exclusion of implied warranties or limitation of incidental or consequential damages, the above limitations or exclusions may not apply to you. This warranty applies to the United States and Canada.

**DON'T RETURN YOUR VEHICLE TO THE STORE.** Should you require service or assistance with your vehicle during the warranty period, contact our trained technical staff at Hyper Toy Company 1-866-204-9737.

FOR ASSISTANCE WITH  
YOUR ASSEMBLY CALL:  
**1-866-204-9737 TOLL FREE**

**HYPER TOY  
CO**

# Product Registration

## ***DRIFTKART***

## **HYPER** TOY **CO**

### **Note:**

**Activation of your warranty gives you FREE telephone and online technical service help. Please visit [www.hypertoys.com](http://www.hypertoys.com) to complete product registration and activate your warranty. You will need to provide the product serial number to complete registration. The location of the serial number is on the underside of the vehicle body.**

**Hyper Toy Company**  
**Customer Service Contact:**  
177 Malaga Park Dr.  
Malaga, NJ 08328

**Call Toll Free**  
**1-866-204-9737**  
Monday-Friday 8:00AM to 5:00PM (CST)

For product related questions or customer service needs please email [info@hypertoys.com](mailto:info@hypertoys.com)

**VISIT US ONLINE@**  
[www.hypertoys.com](http://www.hypertoys.com)



**WARNING:** USE AT YOUR OWN RISK. ADULT SUPERVISION IS REQUIRED  
THIS IS A POWERFUL TOY AND IS NOT INTENDED FOR RIDERS UNDER THE AGE OF 8 YEARS OLD

Do not discard this owner's manual. Refer to the manual for important instructions before operating and to progress in skill.

No more than 1 rider at a time. Do not exceed 154lbs (70kgs) rider weight.

Do not allow riders under the age of 8 years old to use this product. Adult supervision is required.

Always wear shoes and proper protective gear, such as ANSI, SNELL, or ASTM approved helmets. Elbow and knee pads are also recommended.

Battery life may be reduced in extreme temperatures or with a maximum weight load.

Use only in safe controlled areas, not on public streets, or near motor vehicles.

Do not ride at night or in low visibility conditions.

Steep, rough, uneven, or wet surfaces can increase risk to the rider.

Be sure to check local regulations to understand how and where it is allowed to use this product.

**CONTAINS SEALED LEAD-ACID BATTERY. MUST BE RECYCLED OR DISPOSED OF SAFELY.**

FOR ASSISTANCE WITH  
YOUR ASSEMBLY CALL:  
**1-866-204-9737 TOLL FREE**