

Spice Grinder

Safety first.
Never touch the blades while the appliance is plugged in.
Always read your instructions before using for the first time.

Please read all instructions carefully to familiarise yourself with the Wahl James Martin Spice Grinder before using.

THIS GRINDER IS INTENDED FOR HOUSEHOLD USE ONLY.

Save these instructions for further reference.

For any further assistance or information call customer services on

T: 01227 740066

or visit

W: www.wahl.co.uk

E: customer.services@wahl.co.uk

INDEX

GENERAL USER INFORMATION	Page 4
DESCRIPTION OF PARTS	Page 5
IMPORTANT SAFEGUARDS	Page 5
BEFORE USE	Page 8
USING YOUR SPICE GRINDER	Page 8
USING YOUR SMALL QUANTITY	
FINE GRINDING SPICE ATTACHMENT	Page 11
CLEANING AND MAINTENANCE	Page 13
WIRING	Page 13
PRODUCT REGISTRATION	Page 14
GUARANTEE	Page 14

GENERAL USER INFORMATION

Information about using the operation manual

- Before using the appliance for the first time, you must read and understand the operation manual completely.
- Consider the operation manual as part of the product and store it in a safe and accessible place.
- Include this operation manual if passing the appliance on to a third party.
- In the case of conflicts with national safety specifications or instructions, the national requirements must be followed.

Explanation of symbols and notes



DANGER

Danger of electric shock which may result in serious physical injury or death.



DANGER

Danger of explosion which may result in serious physical injury or death.



DANGER

Danger of fire which may result in serious physical injury or death.



WARNING

Warning of possible physical injury or a health risk.



CAUTION

Information about danger of material damage.



Note with useful information and tips.



Action to be taken by owner.

1.

Carry out these actions in the sequence described.

-

List

DESCRIPTION OF PARTS

- A: Cover
- B: On/Pulse Button
- C: Removable Grinding Chamber
- D: Base Unit
- E: Cord Storage Cover
- F: Small Quantity Fine Grinding Attachment

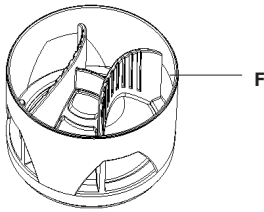

NOTE: This is an additional accessory and should only be used for fine grinding small quantities of herbs and spices.
DO NOT USE FOR COFFEE.
Remove for normal grinding, see page 8 for full instructions.

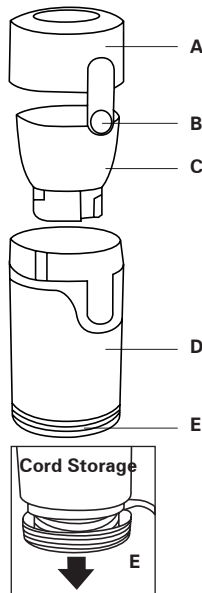

Requirements on the user

- Read the instruction manual in full to familiarise yourself with the product before the first use.
- This appliance shall not be used by children. Keep the appliance and its cord out of reach of children. This appliance can be used by persons with reduced physical, sensory or mental capabilities or lack of experience and knowledge if they have been given supervision or instruction

- Do not operate the appliance with a broken cord or plug, or if the appliance malfunctions, or is dropped or damaged in anyway.
- Any servicing or repair must be performed by Wahl (UK) Ltd or a suitably qualified professional.
- Do not use outdoors or in damp areas.
- To protect against risk of electrical shock, never immerse the unit or let it come into contact with water or any other liquids. Do not use the unit with wet hands. If the appliance should become wet, damp or fall in water, remove plug from mains socket immediately. Do not put your hands in the water.

⚠ Caution! Danger of product damage.

- Never carry the unit by its power cord.
- Use this appliance only for its intended purpose.

This appliance is intended to be used in household and similar applications such as:

- Staff kitchen areas in shops, offices and other working environments
- Farm houses
- By clients in hotels, motels and other residential type environments
- Bed and breakfast type environments

concerning use of the appliance in a safe way and understand the hazards involved. Children shall not play with the appliance.

Hazards

Please adhere to the following safety instructions!

⚠ Warning! Injuries due to incorrect handling

- Never touch or allow contact with moving parts while in motion. Keep hands, hair, clothing and other utensils away from the moving parts during operation to prevent accident, injury or damage to the appliance.
- Switch off the appliance and unplug from outlet when not in use, before putting on or taking off attachments and also before cleaning the appliance.
- Never use your appliance without paying attention! Always unplug the unit when not in use, even for a moment.
- Do not let the cord hang over the edge of the work surface or let it touch any hot surfaces.

⚠ Danger of electric shock which may result in serious physical injury.

- The use of attachments that are not supplied by the manufacturer may cause fire, electric shock or injury and damage to the appliance.

BEFORE USE

Remove all packaging and familiarise yourself with your spice grinder components as listed in the description of parts on page 4. Remove the small quantity fine grinding attachment from the grinding bowl, this as the name suggests is only required when you are fine grinding small quantities. Please read the section FINE GRINDING ATTACHMENT on page 11 before using.

⚠ WARNING: THE BLADES OF THIS GRINDER ARE EXTREMELY SHARP! DO NOT TOUCH THE BLADES.

USING YOUR SPICE GRINDER

1. Before plugging in check that the voltage matches that shown on the rating label.
2. To unwind the power cord, pull the cord cover downwards, (Fig 2) unwind the amount of cord required, (Fig 3) and secure the cord in the notch before pushing the cover back into place (Fig 4).



- Place the appliance on a level work surface.
- Remove the lid of the grinder and remove the fine grinding spice attachment. The attachment is only to be used when fine grinding small quantities, otherwise remove.

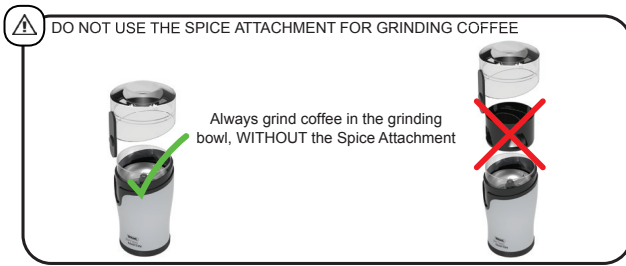

- Add coffee beans, peppercorns, spices etc. to the grinding bowl. Do not overload and do not exceed the max marking on the bowl. (Fig 5)

Fig 5



Fig 6



⚠ IMPORTANT: OVERLOADING COULD CAUSE SERIOUS DAMAGE TO YOUR GRINDER.

ⓘ NOTE: Ensure the lid is properly fitted otherwise the appliance will not function due to safety features. (Fig 6)

- Press the pulse button on the front of the grinder to operate (Fig 7). For best results, press the pulse button intermittently to chop down the chosen dried food into small pieces. This will also avoid damage to the motor and blade due to clogging. For fine grinding of smaller quantities (under 5 grams) use the fine grinding spice attachment. See fine grinding spice attachment section on page 11.



Fig 7

- This appliance is designed to be used in small bursts for short periods of time which is ideal for grinding spices and coffee beans etc. Do not press down and operate for more than 30 seconds continuously. If you do use the appliance for the maximum of 30 seconds continuously please allow the appliance to cool for 60 seconds.



Fig 8

- The grinding bowl is removable and can be easily removed by twisting anti clockwise and lifting out. (Fig 8) You can then easily dispense your ground dried food, clean the grinding bowl and replace.

- To replace, lower the grinding bowl back into the base unit and twist clockwise until locked into place and secure.

- Always unplug the unit immediately after each use.

- Place the attachment into the bowl. (Fig 10)



Fig 10

- Place the lid over the attachment and ensure that the lid is properly fitted otherwise the appliance will not function due to its safety feature.

- Press the pulse button on the front of your grinder to grind the chosen ingredient.

ⓘ NOTE: Spices should be in small manageable pieces and ground roughly by pulsing a few times before adding the attachment and grinding to a powder.

- Always remove and clean the bowl, lid and spice attachment immediately after use to help avoid staining and lingering flavours and smells.

FINE GRINDING SPICE ATTACHMENT

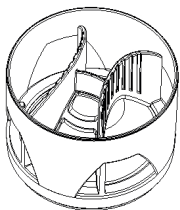

This unique spice attachment allows you to fine grind small amount of dry herbs and spices effectively. It simply reduces the capacity of the bowl so that even the smallest quantities of spices are kept in contact with the blades and therefore effectively ground.

⚠ IMPORTANT: Only use the attachment when fine grinding very small amounts of spices e.g. a teaspoon of spices. Do not fill above the level of the blades when using the attachment. Larger quantities can be done without the attachment or in two or more batches. Always roughly grind without the attachment first.

- Place the spices into the grinding bowl, do not fill above the level of the blades. (Fig 9)

Fig 9



⚠ IMPORTANT: Do not overfill. Overfilling could cause serious damage to your grinder.

CLEANING AND MAINTENANCE

1. Unplug the appliance before cleaning.
2. Wipe over the outside of the base unit with a dampened cloth and polish with a soft dry cloth.

⚠ WARNING: DO NOT IMMERSE THE BASE UNIT IN WATER OR ANY OTHER LIQUID.

3. The lid and removable bowl can be washed in warm soapy water or in a dishwasher.
Always take care when cleaning the blades.
4. Do not use scouring agents or abrasive cleaners as they may damage the surfaces.

⚠ WARNING: DO NOT PLACE THE BASE UNIT IN THE DISH WASHER.

ℹ NOTE: If water becomes trapped in the grinding chamber, stand the grinding bowl upright and allow to drip dry.

WIRING

⚠ WARNING: IF THE SUPPLY CORD IS DAMAGED IT MUST BE REPLACED BY THE MANUFACTURERS SERVICE AGENT OR A SIMILARLY QUALIFIED PERSON IN ORDER TO AVOID A HAZARD.

The wires in the mains lead of this Spice Grinder are coloured in accordance to the following code:

Blue Neutral (N) Brown live (L)

This appliance is fitted with a 3 pin plug which has a 3amp fuse fitted.

If the plug supplied is not suitable for your socket or becomes damaged, it should be cut off and disposed of, and a suitable plug fitted as detailed below.

As the colours of the wires in the mains lead of this Spice Grinder may not correspond with the colour markings identifying the terminals in your plug, proceed as follows.

The wire, which is coloured BLUE, must be connected to the terminal in the plug which is marked with the letter 'N' or coloured BLACK or BLUE.

The wire, which is coloured BROWN, must be connected to the terminal in the plug which is marked with the letter 'L' or coloured RED or BROWN.

DO NOT connect either wire to the terminal in the plug which is marked with the letter 'E' or has the Earth symbol, or coloured GREEN or GREEN/YELLOW.

PRODUCT REGISTRATION

Wahl are constantly developing and launching new products in the UK. We would like to understand your product needs and expectations and we value any comments you may have. As part of Wahl Customer Care, we are offering you the chance to be kept up to date with the latest product launches, innovations and special offers. Please take a minute to register your product online at www.wahl.co.uk.

WASTE ELECTRICAL & ELECTRONIC EQUIPMENT DIRECTIVE 2002/96/EC (WEEE)



At the end of this products life it should not be disposed of with general household waste.

Care should be taken to dispose of in a suitable manner in accordance with your Local Authority regulation.

GUARANTEE

This product is guaranteed against defects in material and workmanship for a period of 2 years from the date of original purchase or receipt as a gift. Should this product become defective during the guarantee period, return it to the store of purchase together with your proof of purchase for repair or replacement. Alternatively within the guarantee period you can return the product to Wahl (UK) Ltd who will repair any such defect or elect to replace the product or any part of it, without charge, provided that there is proof of purchase. Should a replacement be offered this will not extend the original guarantee period. The guarantee becomes invalid in the case of misuse, alteration or repair by unauthorised persons. This product is designed for domestic use only and use within a professional environment will invalidate the guarantee. This guarantee in no way affects your rights under statutory law in the United Kingdom.

Wahl (UK) Ltd
Herne Bay Trade Park
Herne Bay
Kent
CT6 8JZ
www.wahl.co.uk

Customer Service T: 01227 740066

Form No. ZB054
Rev4 03-18