



# REVOLUTION™ *PET* PRO



QUICK START/USER GUIDE  
1964, 1986, 2007 Series



More of a video person? Look for this icon and go online for an instructional how-to video at

[www.BISSELL.com](http://www.BISSELL.com)

# Built for Pet Owners



## CleanShot®

Use the on-board pretreat CleanShot® at any time while deep cleaning your carpet to target and remove tough stains and odors.

## EZ Clean Brush Roll Cover

BISSELL's first deep cleaner with a nozzle and brush roll cover that's simple to remove and clean after use.



# by Pet Owners

## New! Specialized Pet Tools

Easily vacuum and deep clean your upholstery with the new 2-in-1 Pet Upholstery Tool.

Remove Pet Hair, Stains and Odors with a single tool.



### Dry Mode:

Use the green switch to change cleaning modes. Begin with Dry Mode to vacuum and remove hair and debris. Use a raking motion to engage the rubber & attract hair to the suction channel.

### Wet Mode:

Switch to Wet Mode to deep clean. Keep the tool in contact with the surface and press the trigger to release spray while pulling the tool toward you.



# Quick Start Guide

## Assembly

### **WARNING**

Do not plug in your deep cleaner until you are familiar with all instructions and operating procedures.

Your deep cleaner comes in four easy-to-assemble components and an accessory bag.

- Base
- Upper Handle
- Clean Water Tank
- Carry Handle

A Phillips screwdriver is required for Assembly in Step 3.

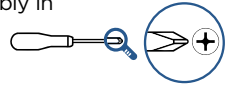

1

First, insert the (aluminum) Upper Handle at the top of the base until you hear a “click”. Do NOT put the clean tank on the machine until Step 5.

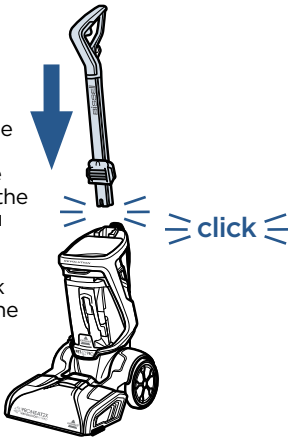

2

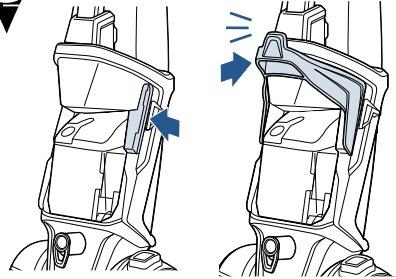

Next, align the carry handle with the slots on either side of the base (behind the power switch and cleaning mode switch). The carry handle will “click” into place.

3

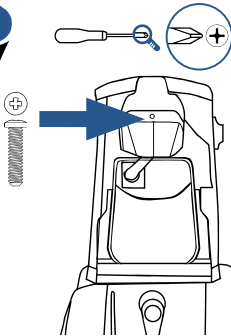

Use a Phillips screwdriver to secure the screw (found taped to upper handle) into the carry handle.

4

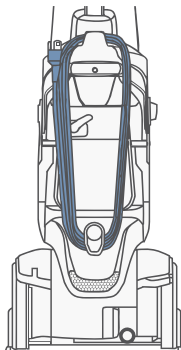

Wrap the cord around the carry handle and Quick Release™ Cord Wrap hook.

5

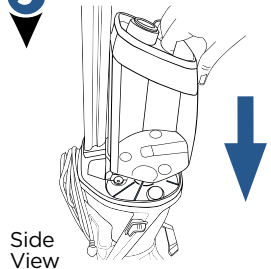

At the bottom of the upper handle, align the clean water tank with the grooves and slide the tank into place.

# IMPORTANT SAFETY INSTRUCTIONS

## READ ALL INSTRUCTIONS BEFORE USING YOUR DEEP CLEANER.

When using an electrical appliance, basic precautions should be observed, including the following:

### **⚠️ WARNING**

#### **TO REDUCE THE RISK OF FIRE, ELECTRIC SHOCK, OR INJURY:**

- » Connect to a properly grounded outlet only. See grounding instructions. Do not modify the 3-prong grounded plug.
- » Do not leave appliance when it is plugged in. Unplug from outlet when not in use and before servicing.
- » Do not expose to rain. Store indoors.
- » Do not allow to be used as a toy. Close attention is necessary when used by or near children.
- » Do not use for any purpose other than described in this User's Guide. Use only manufacturer's recommended attachments.
- » Do not use with damaged cord or plug. If appliance is not working as it should, or has been dropped, damaged, left outdoors, or dropped into water, have it repaired at an authorized service center.

- » Do not pull or carry by cord, use cord as a handle, close a door on cord, or pull cord around sharp edges or corners.
- » Do not run appliance over cord. Keep cord away from heated surfaces.
- » Do not unplug by pulling on cord. To unplug, grasp the plug, not the cord.
- » Do not handle plug or appliance with wet hands.
- » Do not put any object into openings. Do not use with any opening blocked; keep openings free of dust, lint, hair, and anything that may reduce air flow.
- » Keep hair, loose clothing, fingers, and all parts of body away from openings and moving parts.
- » Turn off all controls before plugging or unplugging appliance.
- » Use extra care when cleaning on stairs.
- » Do not use to pick up flammable or combustible materials (lighter fluid, gasoline, kerosene, etc.) or use in areas where they may be present.
- » Do not use appliance in an enclosed space filled with vapors given off by oil base paint, paint thinner, some moth proofing substances, flammable dust, or other explosive or toxic vapors.
- » Do not use to pick up toxic material (chlorine bleach, ammonia, drain cleaner, etc.).
- » Do not pick up anything that is burning or smoking, such as cigarettes, matches, or hot ashes.
- » Use only BISSELL cleaning products intended for use with this appliance to prevent internal component damage. See the Cleaning Formula section of this guide.
- » Do not immerse. Use only on surfaces moistened by the cleaning process.
- » Keep appliance on a level surface.
- » Do not carry the appliance while in use.
- » Always install float before any wet pick-up operation.
- » Unplug before connecting TurboBrush® Tool.

## SAVE THESE INSTRUCTIONS FOR FUTURE USE

This model is for household use only. Commercial use of this unit voids the manufacturer's warranty.

### **⚠️ WARNING**

Improper connection of the equipment-grounding conductor can result in a risk of electrical shock. Check with a qualified electrician or service person if you aren't sure if the outlet is properly grounded. **DO NOT MODIFY THE PLUG.** If it will not fit the outlet, have a proper outlet installed by a qualified electrician. This appliance is designed for use on a nominal 120-volt circuit, and has a grounding attachment plug that looks like the plug in the illustration. Make certain that the appliance is connected to an outlet having the same configuration as the plug. No plug adapter should be used with this appliance.

#### **GROUNDING INSTRUCTIONS**

This appliance must be connected to a grounded wiring system. If it should malfunction or break down, grounding provides a safe path of least resistance for electrical current, reducing the risk of electrical shock. The cord for this appliance has an equipment-grounding conductor and a grounding plug. It must only be plugged into an outlet that is properly installed and grounded in accordance with all local codes and ordinances.

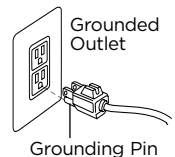

# Thanks for buying a BISSELL carpet cleaner!

We love to clean and we're excited to share one of our innovative products with you. We want to make sure your carpet cleaner works as well as it does today for years to come, so this guide has tips on using (pages 10-13), maintaining (pages 16-19), and if there's a problem, troubleshooting (page 20).

In just a few simple assembly steps, you'll be ready to deep clean. Flip to the front and let's get started!

## Package Contents

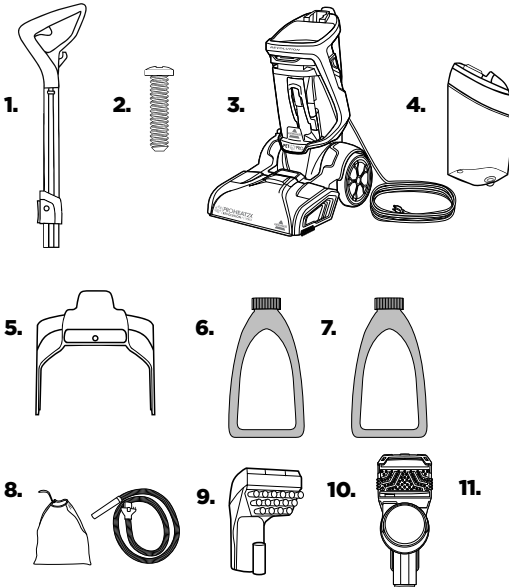

1. Upper Handle
2. 1 Screw attached to Upper Handle
3. Base with Dirty Water Tank
4. Clean Water Tank
5. Carry Handle
6. BISSELL Professional Pet Urine Eliminator + Oxy
7. BISSELL Pet Stain & Odor + Antibacterial Formula
8. Accessory bag & hose
9. Tough Stain Tool
10. 2-in-1 Pet Upholstery Tool
11. Nozzle Clean Out Tool

**NOTE:** Standard accessories may vary by model. To identify what should be included with your purchase, please refer to the "Carton Contents" list located on the carton top flap.

### Assembly: Cover/Quick Start Guide

Safety Instructions..... 5

Product View..... 7

Cleaning Formulas..... 8-9

Operations.....10-13

Hose, Tools & CleanShot® ....14-15

Maintenance & Care .....16-19

Troubleshooting .....20

Warranty .....21

Service.....21

Product Registration..... 22

Parts & Supplies ..... 22

# Getting to Know Your Deep Cleaner

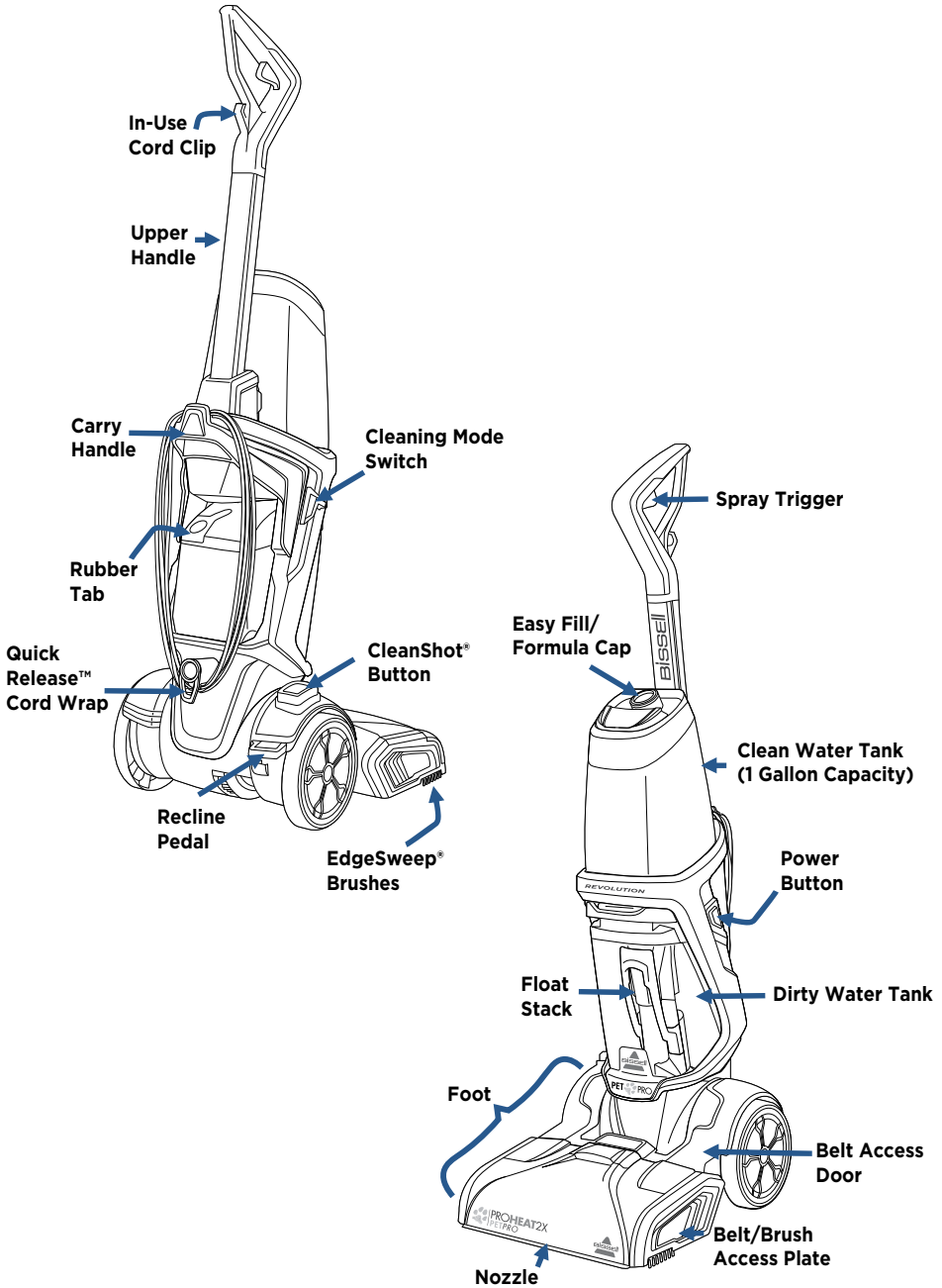

# Cleaning Formulas

## WARNING

To reduce the risk of fire and electric shock due to internal component damage, use only BISSELL cleaning fluids intended for use with the deep cleaner.

Keep plenty of genuine BISSELL formula on hand so you can clean and protect whenever it fits your schedule.

Always use genuine BISSELL deep cleaning formulas. Non-BISSELL cleaning solutions may harm the machine and may void the warranty.

<b>BOOST</b> CARPET CLEANING FORMULA ENHANCER				<b>PRETREAT</b> PRE TREAT SPOTS AND STAINS TO IMPROVE CARPET CLEANING PERFORMANCE		
						
Oxy Boost	Renew Boost	Prevent Boost	Pet Oxy Boost	Oxy Stain Destroyer	Pet Stain PreTreat	Pet PreTreat + Sanitize
Removes old, set-in stains permanently	Revives carpets to look their best	Repels stains from soaking into carpet fibers	Removes pet stains and odors permanently	Permanent Stain Removal in 30 seconds	Pre-treat to help remove tough pet stains and odors	Penetrates to loosen and sanitize tough stains

<b>easy fill</b> SYSTEM	<b>PROFESSIONAL FORMULAS</b>		<b>2X* CLEANING FORMULA</b>				<b>BARE FLOOR FORMULAS</b>
							
Pet Stain & Odor + Antibacterial	Professional Deep Cleaning	Professional Pet Urine Eliminator+Oxy	Pet Stain & Odor	DeepClean & Protect	DeepClean + Refresh	Deep Clean + Oxy	Hard Floor Solutions
Cleans and Controls odor causing bacteria.	Out cleans all other formulas <i>Includes Scotchgard™ Protector</i>	Our best formula for pet urine stains & odors <i>Includes Scotchgard™ Protector</i>	Removes tough pet stains <i>Includes Scotchgard™ Protector</i>	Deep cleans carpets and protects from future stains with Scotchgard™ Protector	Powerful cleaning with a refreshing scent	Removes deep down dirt, pet stains, & pet odor	Safe use for linoleum, vinyl, and ceramic tile; removes tough dirt and grime

ONLY BISSELL Protects from future stains with Scotchgard™ Protector.

Scotchgard™ is a trademark of 3M®.

\*2.5 fl. oz. of 2X concentrated formula is equivalent to 5.0 fl. oz. of non-concentrated formula.

## Tips Before Carpet Cleaning

- If cleaning an entire room, consider moving your furniture to another area.
- Use a dry vacuum cleaner over area before using your deep cleaner.
- Pre-treat stains with BISSELL PreTreat to improve performance on coffee stains and ground-in dirt.



# Customize Your Clean & Maximize Your Results

## ELIMINATE PET URINE, STAINS & ODORS

Our best formula for pet urine, stains, and odors. Permanently remove all three from your carpet!



## For Pet Stains & Odors:

Erase pesky stains & remove odors!

Pretreat pesky pet stains with BISSELL Pretreat spray before using your deep cleaner. Choose a BISSELL pet formula for your deep cleaner and clean as directed.



## To Clean Dark Stains:

Remove stains permanently!

Use BISSELL Deep Clean + Oxy formula or add BOOST OXY to any of your favorite BISSELL formulas to maximize the stain removal power.



## To Remove Ground-In Dirt:

Renew your carpet!

Pretreat ground-in dirt with a BISSELL Pretreat Spray. Choose BISSELL Professional Deep Cleaning formula and pair with a BISSELL Boost to enhance your cleaning.



## To Refresh Your Home:

Choose your favorite scent!

Pair your carpet cleaner with BISSELL Febreze™ formulas to give your home a clean and refreshing scent.



## For Antibacterial Clean:

Use BISSELL Pet Stain & Odor + Antibacterial formula

Use BISSELL Pet Stain & Odor + Antibacterial with the Deep Clean Mode of your machine to achieve antibacterial results.



Always use genuine BISSELL deep cleaning formulas. Non-BISSELL cleaning solutions may harm the machine and may void the warranty.

# Filling Your Clean Water Tank:

## Antibacterial Formula

1

The clean water tank is at the top of the machine.



Clean Water Tank  
(1 Gallon)

Dirty Water Tank

2

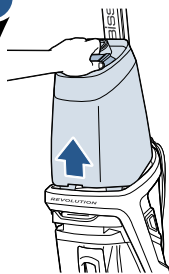

Lift the clean water tank straight up to remove from the machine.

3

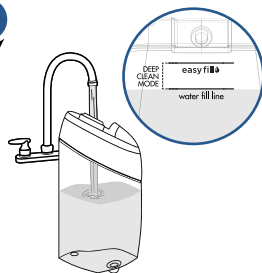

Unscrew the cap from the clean water tank. Add hot tap water to the water fill line.

4

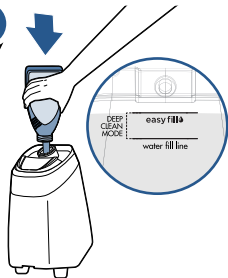

### With Trial Size Antibacterial Formula:

Pour into the clean tank up to the EasyFill line. Twist cap back on to tank.

5

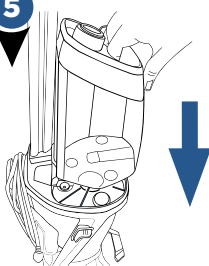

At the bottom of the upper handle, align the clean water tank with the grooves and slide the tank into place.

### For Future Use with Full Size Antibacterial Formula:

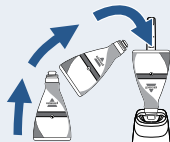

After filling the clean water tank with hot tap water, twist the yellow cap back onto the tank.

Firmly insert the full size formula bottle into the cap on the clean water tank and squeeze until formula reaches the EasyFill line.

### A few notes about filling the clean water tank:

- Fill with hot (140°F/60°C MAX) tap water and add the appropriate BISSELL solution. **DO NOT USE BOILING WATER. DO NOT HEAT WATER OR TANK IN MICROWAVE.**
- When using BISSELL Antibacterial formula: Only fill your clean water tank with the recommended amount of water and formula to achieve antibacterial benefits.

**NOTICE:** Do not over wet carpet. Be careful not to run over loose objects or edges of area rugs. Stalling the brush may result in premature belt failure.

**NOTICE:** BISSELL Antibacterial formula is only for BISSELL machines with EasyFill System™.

# Filling Your Clean Water Tank:

## 2X Concentrated Formula

1

The clean water tank is at the top of the machine.

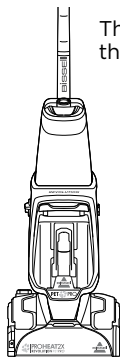

**Clean Water Tank  
(1 Gallon)**



**Dirty Water Tank**

2

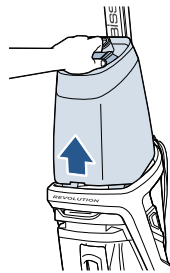

Lift the clean water tank straight up to remove from the machine.

3



### With 2X Formula:

Unscrew the cap from the clean water tank. Add hot tap water to the water fill line. Next, reference the chart below for formula amounts to add to the tank. Twist cap back into place.

4

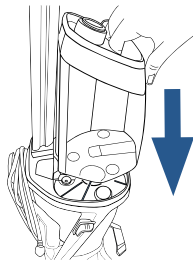

At the bottom of the upper handle, align the clean water tank with the grooves and slide the tank into place.

### FORMULA FILLING INSTRUCTIONS

#### DEEP CLEAN MODE

#### EXPRESS CLEAN MODE

BISSELL 2X Concentrated Formulas

Fill water to the **Water Fill Line** that is next to **DEEP CLEAN MODE** on the Clean Tank. Add 2.5 oz of formula.

Fill water to the **Water Fill Line** that is next to **EXPRESS CLEAN MODE** on the Clean Tank. Add 1.25 oz of formula.

**NOTE:** Fill with hot (140°F/60°C MAX) tap water and add the appropriate BISSELL solution. **DO NOT USE BOILING WATER. DO NOT HEAT WATER OR TANK IN MICROWAVE.** Do not substitute BISSELL 2X Formula cleaning solution with other household cleaning products.



### Pour in more power with BISSELL Boosts

- Fill tank with water and 2X formula (Step 3 above).
- Add 2 ounces of any BISSELL Boost per 1 gallon of water.
- The ProHeat 2X Revolution has a 1 gallon clean water tank.

# Cleaning Your Carpet

1

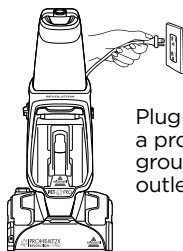

Plug into a properly grounded outlet.

2

## Select cleaning mode:

**Deep Clean** - Delivers a deep clean to your carpet.

**Express Clean** - Provides a lighter clean with about 1 hour of dry time.

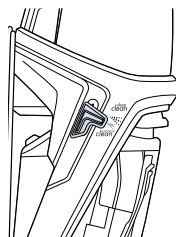

3

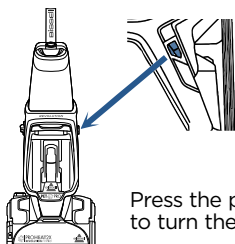

Press the power button to turn the machine on.

4

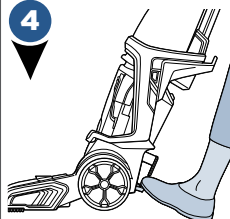

To recline your machine for use, press the recline pedal with your foot.

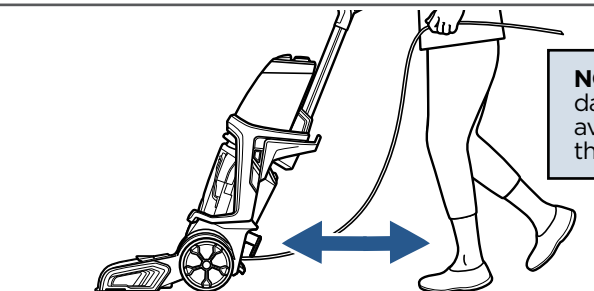

**NOTICE:** To prevent damage to Berber carpets, avoid repeated strokes in the same area.

## Deep Clean Mode:

1. Press the spray trigger to apply solution while making **2 slow wet passes** - 1 forward and 1 back.
2. Release the trigger.
3. Make **2 slow dry passes** - 1 forward and 1 back, to suck up the dirty solution. **(Do not hold down the trigger for this step.)**

**NOTE:** For best cleaning performance, clean with your machine in Deep Clean Mode.

## Deep Clean Mode:

### When using BISSELL Deep Clean + Antibacterial Formula

1. Press the spray trigger to apply solution while making **3 slow wet passes** - 1 forward, 1 back, and 1 forward again.
2. Release the trigger.
3. Make **1 slow dry pass** back, to suck up the dirty solution. **(Do not hold down the trigger for this step.)**

## Express Clean Mode:

1. Press the spray trigger to apply solution while making **2 wet passes** - 1 forward and 1 back.
2. Release the trigger.
3. Make **2 dry passes** - 1 forward, 1 back to suck up the dirty solution. **(Do not hold down the trigger for this step.)**

**NOTE:** In Express Clean Mode, the dirty tank will not get as full as when cleaning with Deep Clean Mode.

# Bare Floor Cleaning\*

\*Bare Floor Tool not included with machine.

## WARNING

WARNING: To reduce the risk of fire and electric shock when cleaning a hard floor, the BISSELL bare floor tool must be used and is only to be used with BISSELL Hard Floor Solutions formula intended for use with this appliance.

**NOTE:** The bare floor tool that is compatible with the ProHeat 2X Revolution is **not** included. It is available for purchase by contacting our team by phone or visiting us online at BISSELL.com.

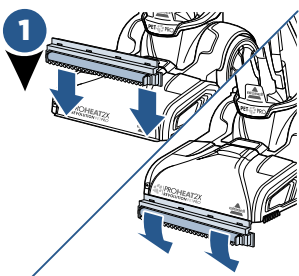

1 With the machine unplugged, attach the bare floor tool to the bottom of the machine by lining the tool to the edge of the nozzle. Rotate down until it clicks into place.

Follow filling instructions on page 10 or 11 and switch cleaning mode to Express Clean.

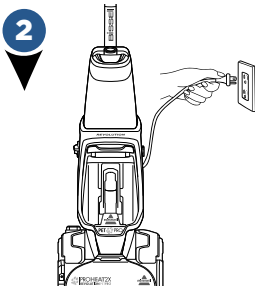

2 Plug into a properly grounded outlet and press the power button.

Clean by pressing the trigger for 1 wet pass forward, 1 wet pass back, and then release the trigger and make 1 dry pass forward, 1 dry pass back.

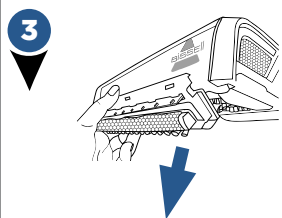

3 When finished, unplug the machine and remove the bare floor tool by rotating the tool up to unhook from the nozzle.

Rinse and let dry before storing. Refer to page 16 for emptying the dirty water tank. Refer to page 17 for cleaning your machine before storing.

# Area Rug Cleaning

**Important! Please check manufacturer's tag before cleaning area rugs for any specialized cleaning instructions. We do not recommend deep cleaning delicate, silk, wool, antique or area rugs without a manufacturer's tag.**

**Regularly clean your high-traffic area rugs in Express Clean Mode:**

- Check the manufacturer's tag.
- Select Express Clean Mode.
- When cleaning area rugs, place the rug on a sealed surface to test for colorfastness in an inconspicuous area. Your cleaner should not be used on unsealed surfaces.
- **Important:** Keep the foot of the deep cleaner perpendicular to the rug's edge with each cleaning pass to prevent damage.

# Cleaning with Hose & Tool

1

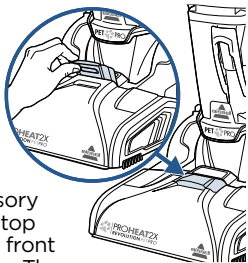

Lift the accessory hose door on top of foot on the front of the machine. The door flips toward the machine to open.

- Keep hair, loose clothing, fingers, and all parts of body away from openings and moving parts. Brushroll continues to rotate when in the upright position.
- Brushroll continues to turn while product is turned on and handle is in upright position. To avoid damage to carpet, rugs, furniture and flooring, avoid tipping cleaner or setting it on furniture, fringed area rugs, or carpeted stairs during tool use.
- The brushroll remains on while cleaning with the hose and tool. Do not allow cleaner to sit in one location for an extended period of time, as damage to floor can result.

2

Insert the hose and snap into place. Be sure the colored hose release clip is facing out, away from machine.

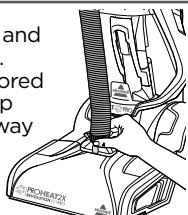

4

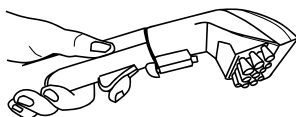

Press the spray trigger button to spray the soiled area, then slowly move tool back and forth over the area.

Release the trigger to suck up the dirty solution. Work in small sections until the area is clean.

When finished cleaning, turn the machine on to suction up warm clean water to rinse the inside of the hose and tool. Detach the hose and tool and close the accessory hose door. Let the hose and tool air dry before storing.

3

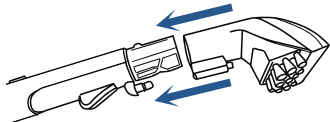

Attach the tool to the end of the hose. (Tools may vary by model.) Press the power button to turn machine on.

**NOTE:** If using the **Deep Reach Tool** or **Pet Stain Tool** be sure the needles of the tool are pressed down into the carpet so the spray gets into the carpet fibers.

# Cleaning with CleanShot®

1

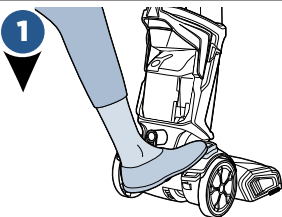

Press the CleanShot® button with your foot. The window of the button will be green and show an "I" symbol when it is on.

2

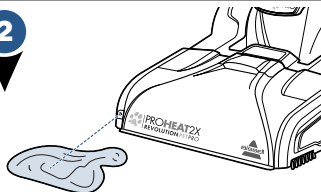

Spray will continue until you turn it off. To turn CleanShot® off, press the button with your foot. The window of the button will be red and show an "O" symbol when it is off.

Completely cover the stain with CleanShot® spray. Allow the stain to soak. To extract, maneuver the foot of the machine over the stain to brush and remove.

# NEW! 2-in-1 Pet Upholstery Tool

\*Make sure your clean tank has water & formula to use the tool in wet mode.

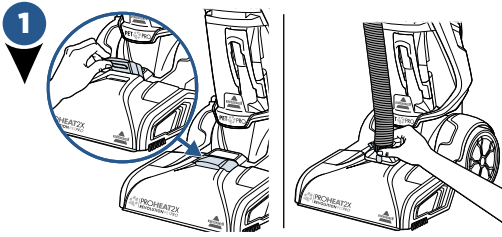

Follow hose plug-in instructions from steps 1 & 2 on page 14.

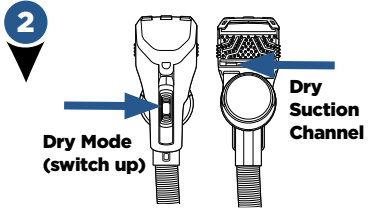

Attach the tool and select dry mode to first pick up dry debris and pet hair. The suction will be at the lower part of the tool, near the dry cup.

**DRY MODE NOTE:** Use a “raking” motion to clean. Start with the tool farthest away and rake in small increments as you bring the tool toward you. The rubber nubs will help attract hair to the suction channel.

**3** Empty the cup when it fills with hair and debris.

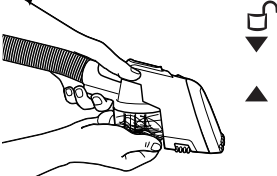

Turn off the machine. Hold the cup and twist counterclockwise line up the arrow with the unlock symbol and remove.



Take off the cup to empty hair and debris.



Remove hair that may wrap around the filter.

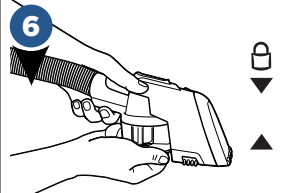

To reattach the cup, line up the cup to the tool indents, and rotate clockwise. The arrow will line up with the locked icon when secured.

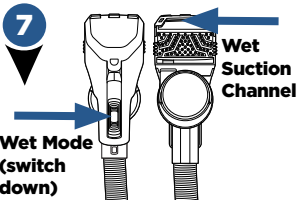

To Deep Clean, move the switch to wet mode. Press the trigger to spray your water and formula; use the top of the nozzle to extract stains and odors.

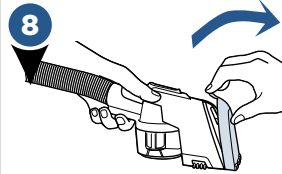

To remove any hair or trapped debris from the nozzle, first turn off the machine. Pull the nozzle tab away from the tool to remove and rinse under running water.

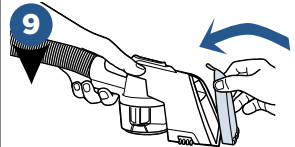

Replace to the tool by lining up the nozzle edge and snap into place. Before storing, make sure all hair is removed from the dry cup and nozzle has been rinsed under running water.

**WET MODE NOTE:** Start from the area farthest away. Hold the trigger down, and pull the tool toward you. Keep the tool in contact with the surface as you pull. You will see extraction through the nozzle.

# Empty Dirty Water Tank

## WARNING

To reduce the risk of fire, electric shock or injury, turn power OFF and disconnect plug from electrical outlet before performing maintenance or troubleshooting.

1

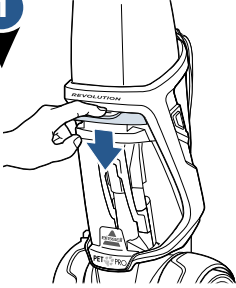

To release dirty water tank, press down on the colored tank handle.

2

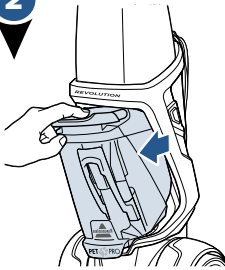

Tilt the tank slightly toward you.

3

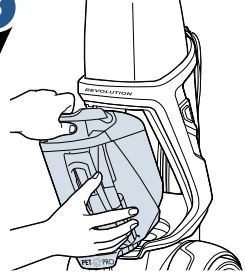

Grab the handle and tank with both hands and pull the dirty water tank up and away to remove.

4



### For quick empty:

Pull the rubber tab and tilt to pour. (Located at the corner of the top of the tank.)

When closing the rubber tab, make sure all edges are sealed tight.

5

Clean the red filter below the dirty tank by wiping off any remaining dirt or debris.

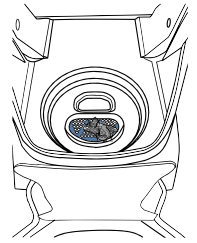

### For final clean and rinse:

Unscrew the ring at the bottom of tank.

Gently remove the float stack, rinse, and clean. Once clean, return float stack into the tank by lining up the arrows so they point at each other. This is the only way the float stack will fit into the tank.

With the arrows aligned, the float stack should lock into place.

Return the ring and twist to lock. Water may leak if the ring is not fully tightened.

6

**To return the dirty tank:** Angle the tank and insert bottom first. Then tilt the tank toward the machine and push the top in until it clicks into place.

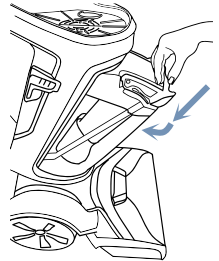

### Did You Know?

The Float Stack is what prevents your dirty tank from overflowing.

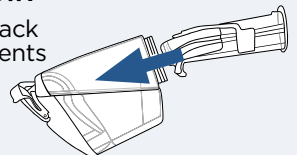



# Cleaning Machine After Use

## ⚠️ WARNING

To reduce the risk of electric shock, turn power switch off and disconnect plug from electrical outlet before performing maintenance or troubleshooting checks.



First, fill the clean water tank with warm tap water and then empty it all to rinse. Then fill again with warm tap water and return the tank to the machine. Twist cap back on tightly.

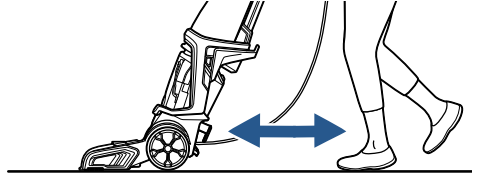

**To flush and rinse the machine:** Turn the machine on and press the trigger for 15 seconds while making back and forth passes on a section of carpet.

Finally, release the trigger and extract the water.

See page 16 to clean the dirty tank from the water that was just extracted. Empty the clean water tank and let dry before storing.

Wipe your machine's exterior with a soft cloth.

Store machine in a protected dry area.

## Brush Roll & Nozzle Care

**NOTE:** Be sure to clean the brush rolls and nozzle before storing your machine. Follow these steps if your nozzle becomes clogged with hair or debris.

1

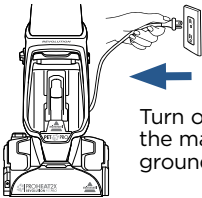

Turn off and unplug the machine from the grounded outlet.

2

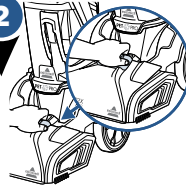

Remove the nozzle from the foot: scoop and grip the Accessory Hose Door. Pull up to remove the nozzle.

3

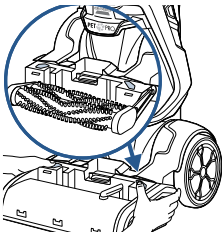

Next, remove the next layer, the brush roll cover, to reveal the brush rolls. Press on the two release buttons and lift straight up.

4



At this point, the nozzle and brush roll cover can be rinsed under running water and the nozzle clean out tool can be inserted to unclog hair or debris.

**NOTICE:** To reduce the risk of a leaking condition, do not store unit where freezing may occur. Damage to internal components may result.

## Brush Roll & Nozzle Care (Continued)

5

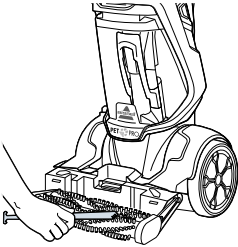

Use the comb to brush out the debris or hair from the brush rolls.

6

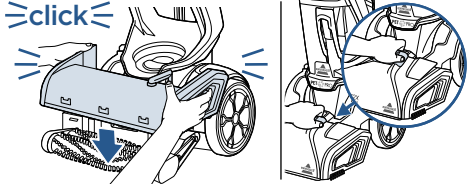

When finished, return the brush roll cover by pushing it straight down. You will here a click on each "push" button when the cover is pushed down into place. Line up the nozzle from the edge near the floor and rotate to snap back into place.

## Replacing Belts & Brush Rolls

What you will need: 1 Phillips screwdriver & 1 flathead screwdriver

1

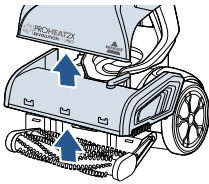

While the machine is upright, unplug the machine and remove both tanks. Remove the nozzle and brush chamber cover (see steps in Brush Roll & Nozzle Care). Press the recline pedal and lay the machine on its back.

2

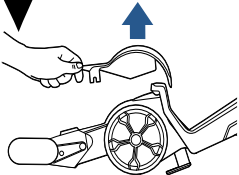

Use a flathead screwdriver and press it into the slot at the back **and then front** of the belt access door. Lift to remove the Belt Access Door.

3

Turn the machine on its side and use a Phillips screwdriver to remove the screw just underneath the wheel. Slide the wheel down to remove.

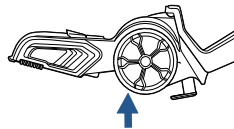

4

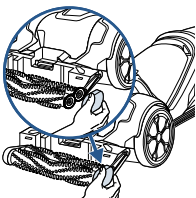

Lay the machine back down on its back. Use a Phillips-head screwdriver to remove the screw on the brushroll end cap.

5

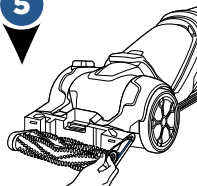

If the Gear Belt is broken, gently remove it. If you are replacing your brush rolls, gently remove the belt.

# Replacing Belts & Brush Rolls (Continued)

6

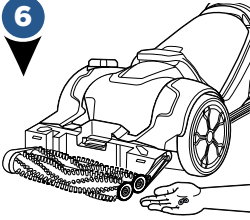

There are washers at the ends of the brush rolls, be careful that these do not fall off or get lost.

**NOTE:** To replace brush rolls, remove them from the metal posts and replace. Make sure the metal post goes completely through the end of the brush roll. The brush roll bristles should be aligned in a 'V' pattern as pictured.

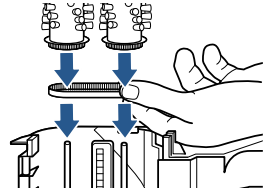

Align brush rolls with belt at other end. To ensure alignment, hold the end of one brush roll and twist. The other brush roll rotates with it. **Check that washers are in place.** Reassemble the belt and end cap, securing with screws you removed.

7

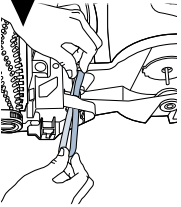

If the flat belt is broken, gently remove the belt. If it needs replacing for any reason, the gear belt should already be removed before removing the flat belt. Rotate the machine back to its side. Feed the new flat belt through the opening so that it wraps around the red pulley.

8

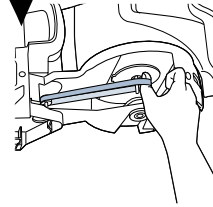

Keep it wrapped on the red pulley and adjust the machine so it is laying on it's back again. Use your thumb to stretch the flat belt back to wrap around the metal axle.

9

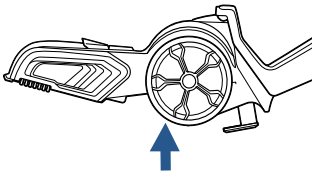

**Resecure the Wheel and Belt Access Door:**

Slide the wheel up back into the slot and secure with the screw that was removed.

10

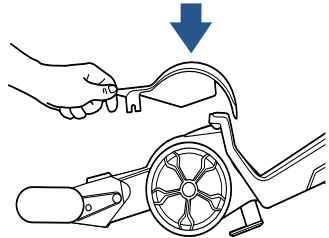

Snap the Belt Access Door back down into place.

**NOTE:** See **Step 6 on page 18** for how to put the brush roll cover and nozzle back in place.

# Troubleshooting



## WARNING

To reduce the risk of electric shock, turn power switch off and disconnect plug from electrical outlet before performing maintenance or troubleshooting checks.

Problem	Possible causes	Remedies
<b>Reduced or No Spray Through Foot of Machine</b>	Clean water tank may be empty	Refill tank
	Clean water tank may not be seated completely	Turn power OFF; remove and reseat tank
<b>No spray through hose &amp; tool</b>	The hose to your machine is not primed or may have lost prime	<ol style="list-style-type: none"> <li>1. With the machine off and unplugged, remove the nozzle from the foot. Place a ball point pen in the black cylinder next to the screw. When water bubbles up, remove the pen. Reassemble the nozzle and hose</li> <li>2. Hold end of hose below water level in tank to prime</li> <li>3. With the clean tank full of water, the machine OFF and RECLINED, press the CleanShot® button ON and wait for the CleanShot® to drain for a few seconds; This will re-prime the machine</li> </ol>
	Clean Water tank may be empty	Refill the Clean Water Tank
	Clean Tank may not be seated properly	Turn power OFF; Remove and reseat the clean water tank
<b>No Spray Through CleanShot®</b>	Clean Water tank may be empty	Refill the Clean Water Tank
	Clean Tank may not be seated properly	Turn power OFF; Remove and reseat the clean water tank
	The machine is not reclined	Press the Recline pedal and bring the handle down to recline the machine
	Pump may have lost prime	With the machine off and unplugged, remove the nozzle from the foot. Place a ball point pen in the black cylinder next to the screw; When water bubbles up, remove the pen; Reassemble the nozzle before cleaning again
<b>CleanShot® Continues Spray When Machine is Off</b>	CleanShot® button is not in the "OFF" position	Press the CleanShot® button to turn it off. The button window will show the color red and a "O" symbol when it is in the off position
<b>Loss of suction power</b>	Dirty tank may not be seated properly	Pick up the dirty tank and reseat so it fits in the unit
	Dirty tank has picked up maximum amount of dirty water and has reached full line	Empty dirty tank
	Rubber tab on dirty water tank is not sealed tight	Check the rubber tab on the dirty water tank and press firmly on all edges to secure it tightly (see step 4 on page 16 for detail)
	Accessory hose door may not be closed tightly in place	Check the accessory hose door and make sure it is closed tightly - it should be locked into place
	Nozzle may be clogged from pet hair or debris	Use the nozzle clean out tool and follow steps on page 17 for "Cleaning Nozzle"
	Brush roll cover not fully snapped into place	Remove the nozzle and brush roll cover; Follow step 6 from page 18 and make sure you hear both buttons click into place
<b>No power</b>	Cleaning mode switch mistaken for power button	Press the red power button on the left side of the machine to turn the machine on
	Outlet may not be active	Try plugging in a different device that uses a grounded outlet to test for power from the outlet
<b>Leaking tank</b>	Tank may have been over-filled	1. Make sure your tank has the water and formula in it that you've prepared
	Water may be caught in space between the tank and the tank's handle	<ol style="list-style-type: none"> <li>2. With the cap twisted ON tightly, hold your tank at an angle, over a sink or drain, so any extra water can pour out of the space</li> <li>3. Wipe the tank dry with a cloth</li> </ol>

# Warranty

This warranty gives you specific legal rights, and you may also have other rights which may vary from state to state. If you need additional instruction regarding this warranty or have questions regarding what it may cover, please contact BISSELL Consumer Care by E-mail, telephone, or regular mail as described below.

## Limited Five-Year Warranty

Subject to the \*EXCEPTIONS AND EXCLUSIONS identified below, upon receipt of the product BISSELL will repair or replace (with new or remanufactured components or products), at BISSELL's option, free of charge from the date of purchase by the original purchaser, for five years any defective or malfunctioning part.

See information below on "If your BISSELL product should require service".

This warranty applies to product used for personal, and not commercial or rental service. This warranty does not apply to fans or routine maintenance components such as filters, belts, or brushes. Damage or malfunction caused by negligence, abuse, neglect, unauthorized repair, or any other use not in accordance with the User's Guide is not covered.

BISSELL IS NOT LIABLE FOR INCIDENTAL OR CONSEQUENTIAL DAMAGES OF ANY NATURE ASSOCIATED WITH THE USE OF THIS PRODUCT. BISSELL'S LIABILITY WILL NOT EXCEED THE PURCHASE PRICE OF THE PRODUCT.

**Some states do not allow the exclusion or limitation of incidental or consequential damages, so the above limitation or exclusion may not apply to you.**

## \*EXCEPTIONS AND EXCLUSIONS FROM THE TERMS OF THE LIMITED WARRANTY

THIS WARRANTY IS EXCLUSIVE AND IN LIEU OF ANY OTHER WARRANTIES EITHER ORAL OR WRITTEN. ANY IMPLIED WARRANTIES WHICH MAY ARISE BY OPERATION OF LAW, INCLUDING THE IMPLIED WARRANTIES OF MERCHANTABILITY AND FITNESS FOR A PARTICULAR PURPOSE, ARE LIMITED TO THE FIVE YEAR DURATION FROM THE DATE OF PURCHASE AS DESCRIBED ABOVE.

Some states do not allow limitations on how long an implied warranty lasts so the above limitation may not apply to you.

**NOTE:** Please keep your original sales receipt. It provides proof of date of purchase in the event of a warranty claim.

# Service

## If your BISSELL product should require service:

Contact BISSELL Consumer Care to locate a BISSELL Authorized Service Center in your area.

If you need information about repairs or replacement parts, or if you have questions about your warranty, contact BISSELL Consumer Care.

### Website:

[www.BISSELL.com/service-centers](http://www.BISSELL.com/service-centers)

### E-mail:

[www.BISSELL.com/email-us](mailto:www.BISSELL.com/email-us)

### Call:

BISSELL Consumer Care  
1-800-237-7691  
Monday - Friday 8am - 10pm ET  
Saturday 9am - 8pm ET  
Sunday 10am - 7pm ET

## Please do not return this product to the store.

Other maintenance or service not included in the manual should be performed by an authorized service representative.

For any questions or concerns, BISSELL is happy to be of service. Contact us directly at 1-800-237-7691.

# Register your product today!

Registering is quick, easy and offers you benefits over the lifetime of your product.

## You'll receive:

### **BISSELL Rewards Points**

Automatically earn points for discounts and free shipping on future purchases.

### **Faster Service**

Supplying your information now saves you time should you need to contact us with questions regarding your product.

### **Product Support Reminders and Alerts**

We'll contact you with any important product maintenance reminders and alerts.

### **Special Promotions**

Optional: Register your email to receive notice of offers, contests, cleaning tips and more!

Visit [www.BISSELL.com/registration!](http://www.BISSELL.com/registration!)

## Visit us online at: **BISSELL.com**

When contacting BISSELL, have model number of cleaner available.

Please record your

Model Number: \_\_\_\_\_

Please record your

Purchase Date: \_\_\_\_\_

**NOTE: Please keep your original sales receipt. It provides proof of purchase date in the event of a warranty claim. See Warranty on page 21 for details.**

*We can't wait to hear from you!*

We really do read your comments, tweets, and posts.

**Rate this product on BISSELL.com**

or any of our retailer sites and let us (and millions of your closest friends) know what you think!

## Parts & Supplies

For Parts and Supplies, go to **BISSELL.com** and enter your model number in the search field.

For cleaning tips and more visit [www.BISSELL.com](http://www.BISSELL.com) or find us at:



BISSELL



BISSELLClean



BISSELLClean



BISSELL



BISSELL



©2017 BISSELL Homecare, Inc  
Grand Rapids, Michigan  
All rights reserved. Printed in China  
Part Number 161-1761 01/17  
Visit our website at: [www.BISSELL.com](http://www.BISSELL.com)  
Scotchgard is a trademark of 3M