

Assembly & Operation Instructions

HOME

HOME 17M POP UP AIRER (9190148)

Pack Included

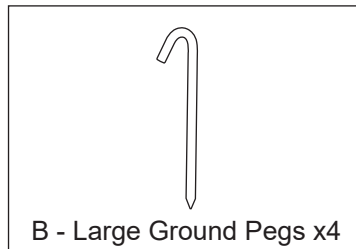
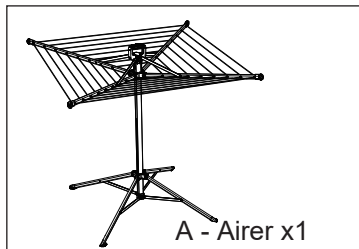

Directions for use

1. Remove all packaging.
2. Position your airer so that the arm end of the product with the handle is upwards, in a location suitable for the opened airer. Opened size is 1.32m
3. Release the Velcro line tidy strap
4. With your hand grasp the operating handle and apply downwards pressure. Your airer should open. Warning; take care not to hit yourself with the arms or get caught in the lines as the airer opens.
5. When opened fully push down to lock the retaining clips of the handle onto the ratchet of the centre pole. You should hear a click once locked.
6. Use the Ground Pegs supplied for a more secure fixing by inserting through the peg loops at the base of the airer into soft ground.

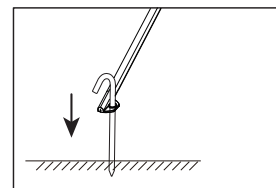

Operation

1. With your hand grasp the operation handle and squeeze to unlock the retaining clips.
2. Once the retaining clips are unlocked continue raising the handle in an upwards direction until the airer is fully closed.
3. Secure the line tidy strap to help keep the airer closed and free from line tangles.

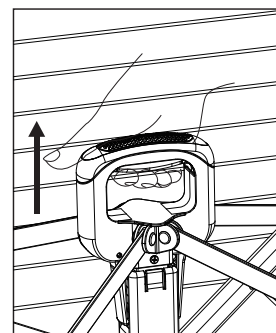

Care and use

This airer can be used indoors and outdoors also on the move (caravan/camping). If your airer has holes in the feet it can be secured to softer ground using anchor / tent pegs which may or may not be supplied.

Maximum loaded weight 15kg evenly spaced or 2 wash loads.

Store safely away from children and pets, ideally in a storage carry bag if supplied.

With one as this will also help to keep your airer clean.

Warning

This is not a children's toy. Do not allow children to play with this product.

In order not to invalidate any extended guarantee (if offered);

- Do not use in adverse weather conditions. In adverse weather conditions close and store safely.
- Do not load more than advertised maximum loading weight.

EU design registration no. 007818638-001 / 002

UK design registration no. 9007818638-001 / 002

Line Tension Clip

Occasionally the line on your rotary ailer might sag, this can be due to a number of factors; weather conditions (lines are more prone to sagging in warmer weather), tangled lines, unevenly spaced lines and the rotary operation not being locked at its highest point. Before you use the line tension clip please ensure you have eliminated all the above factors.

Warning: the line tension clip is there to be used as a last resort to re-tension your rotary washing line.

1) Pinch where arrows indicate and open

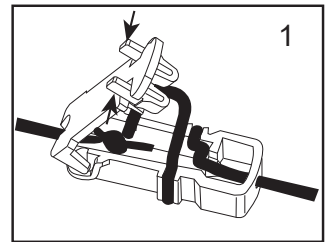

2) Unwind the loose line end
(warning - do not untie the knotted line end)

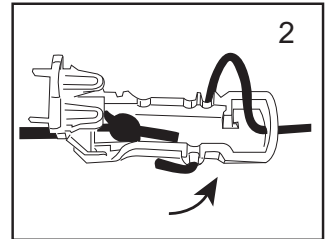

3) Pull the loose line end until it is at your desired tension

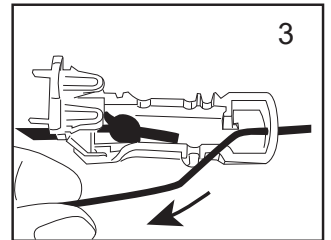

4) Rewind the loose line end

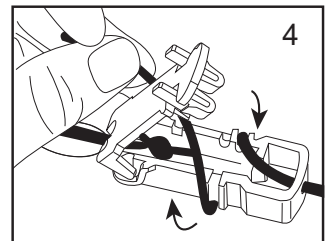

5) Secure by looping end of line back into the clip

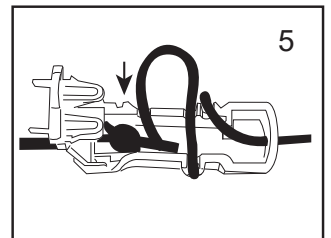

6) Close clip

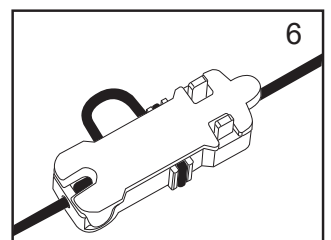

Your line should now be re-tensioned

Customer Support

☎ 0345 640 2020