

FCC COMPLIANCE

NOTE: This equipment has been tested and found to comply with the limits for a Class B digital device, pursuant to Part 15 of the FCC Rules. These limits are designed to provide reasonable protection against harmful interference in a residential installation. This equipment generates, uses and can radiate radio frequency energy and, if not installed and used in accordance with the instructions, may cause harmful interference to radio communications. However, there is no guarantee that interference will not occur in a particular installation. If this equipment does cause harmful interference to radio or television reception, which can be determined by turning the equipment off and on, the user is encouraged to try to correct the interference by one or more of the following measures:

- Reorient or relocate the receiving antenna.
- Increase the separation between the equipment and receiver.
- Connect the equipment into an outlet on a circuit different from that to which the receiver is connected.
- Consult the dealer or an experienced radio/TV technician for help.

This device complies with Part 15 of the FCC Rules. Operation is subject to the following two conditions: (1) This device may not cause harmful interference, and (2) this device must accept any interference received, including interference that may cause undesired operation.

Caution: Modifications not authorized by the manufacturer may void users authority to operate this device.

This device complies with Industry Canada license-exempt RSS-210. Operation is subject to the following two conditions: (1) This device may not cause interference, and (2) This device must accept any interference, including interference that may cause undesired operation of the device.

CAN ICES-3 (B)/NMB-3(B).

LIMITED WARRANTY

The manufacturer warrants this product to be free of manufacturing defects for a period of 90 days from the date of purchase. This Limited Warranty does not cover normal wear and tear, tires, tubes or cables, or any damage, failure or loss caused by improper assembly, maintenance, storage or use of the VIRO Rides VR550 Electric Scooter. This Limited Warranty will be void if the product is ever used in a manner other than for recreation or transportation; or modified in anyway. The manufacturer is not liable for incidental or consequential loss or damage due directly or indirectly to the use of this product.

Little Tikes does not offer an extended warranty.

For your records, save your original sales receipt with this manual, and record the product serial number on the manual for future reference.

U.S.A and Canada: For warranty service or replacement part information, please visit our website at www.littletikes.com, call 1-800-321-0183 or write to: Consumer Service, The Little Tikes Company, 2180 Barlow Road, Hudson OH 44236, U.S.A. Some replacement parts may be available for purchase after warranty expires—contact us for details.

Outside U.S.A and Canada: Contact place of purchase for warranty service. This warranty gives you specific legal rights, and you may also have other rights, which vary from country/state to country/state. Some countries/states do not allow the exclusion or limitation of incidental or consequential damages, so the above limitation or exclusion may not apply to you.



WWW.VIORIDES.COM

Please keep this manual as it contains important information.



0818-2-E

© The Little Tikes Company, an MGA Entertainment company. VIRO RIDES™ is a trademark of Little Tikes in the U.S. and other countries. All logos, names, characters, likenesses, images, slogans, and packaging appearance are the property of Little Tikes.

Little Tikes Consumer Service
2180 Barlow Road Hudson, Ohio 44236 U.S.A.
1-800-321-0183
Printed in China

MGA Entertainment UK Ltd
50 Presley Way
Crownhill
Milton Keynes
MK8 0ES
Bucks, UK
0800 521 558

www.littletikes.com
www.littletikes.co.uk



Visit our website at
www.littletikes.com
to register your product and
to enter our sweepstakes.
(No purchase necessary)

VIRO

R I D E S™

ENG

8+

SKUs: 648069 / 486364 / 648755 / 649134

VR 550E

ELECTRIC SCOOTER

USER GUIDE



Illustrations are for reference only. Styles may vary from actual contents.

Read this entire user guide thoroughly before use to ensure a safe and fun riding experience.

For more information, visit
WWW.VIORIDES.COM

SAFETY WARNINGS

⚠ WARNING:

READ AND FOLLOW ALL INSTRUCTIONS IN THIS USER GUIDE TO ENSURE A SAFE RIDE. Failure to read and understand all information in this user guide increases risk of injury due to falls or other incidents. Riding the unit takes skill and must be learned under adult supervision. By riding, users risk serious injury or death from collisions, falls or loss of control.

RIDER SPECIFICATIONS

⚠ WARNING:

NOT FOR USERS UNDER AGE 8 OR HEAVIER THAN 120 LBS (54 KG). DO NOT EXCEED THE MAXIMUM WEIGHT LIMIT OF 120 LBS (54 KG) - including backpacks and other items that might be carried. Exceeding the weight limit could injure the rider and damage the unit. Rider weight alone does not necessarily mean a person's size is appropriate to fit or maintain control of the unit. Keep this product away from small children and remember that this product is only intended for use by persons who are, at minimum, comfortable and competent while operating it.

Children under the age of 8 should not be permitted to use this product. The recommended age of 8 is only an estimate and can be affected by the rider's size, weight, maturity or skills - not every rider 8 years or older will be suited to the product. Any rider unable to fit comfortably on the unit should not ride. **A parent's decision to allow his or her child to ride this product should be based on the child's maturity, skill and ability to follow rules. It is emphasized that adults are strongly advised not to disregard this recommendation or permit young children to ride this unit.**

Because products like this scooter present potential hazards plainly associated with their use, THE NEED FOR EXERCISE OF PARENTAL RESPONSIBILITY IN SELECTING RIDING PRODUCTS APPROPRIATE TO THE AGE OF A RIDER, OR PARENTAL SUPERVISION IN SITUATIONS IN WHICH CHILDREN OF VARIOUS AGES MAY HAVE ACCESS TO THE SAME RIDING PRODUCTS, IS IMPORTANT. Not every product is appropriate for every age or size of a user, and recommendations are intended to reflect the nature of the hazards and the expected mental or physical ability, or both, of a rider to cope with the hazards.

Persons with any mental or physical conditions that may make them susceptible to injury, impair their physical dexterity or mental capabilities to recognize, understand and follow safety instructions, and/or hinder their ability to understand the hazards inherent in a product's use, should not use or be permitted to use products inappropriate for their abilities. Persons with heart conditions, head, back or neck ailments (or prior surgeries to those areas of the body), or pregnant women should not operate this product.

⚠ WARNING:

Riding any electric product can be a hazardous activity. Certain conditions may cause the equipment to fail without fault of the manufacturer. Like other electric ride-on products, this scooter is intended to move, and it is therefore possible to lose control, fall off and/or get into dangerous situations that no amount of care, instruction or expertise can eliminate. If such things occur, the user can be seriously injured or die, even when using safety equipment and other precautions. **RIDE AT YOUR OWN RISK AND USE COMMON SENSE.**

INSURANCE

⚠ WARNING:

Your insurance policies may not provide coverage for accidents involving the use of this electric ride-on product. To determine if coverage is provided, contact your insurance company prior to use.

BATTERY AND CHARGER USAGE

⚠ WARNING:

BATTERY INFORMATION

Check the battery charge before using the product. Do not ride the unit when the battery is low. The scooter may stop operating and cause you to fall. Only use the included charger to charge the battery in the unit.

USING THE CHARGER

- The charger supplied with the unit should be regularly examined for damage to the cord, plug, enclosure and other parts. In the event of such damage, the product must not be charged until the charger has been replaced.
- Use caution when charging.
- The charger is not a toy. Charger should be operated by an adult.
- Do not operate the charger near flammable materials.
- Unplug charger and disconnect from product when not in use.
- Always disconnect from the charger prior to wiping down and cleaning your product with a damp cloth.

FUTURE USE AND OTHER RIDERS

⚠ WARNING:

- Keep these instructions for future reference.
- Periodically review this information and make sure that you understand all safety warnings and instructions.
- Do not let others ride the unit until they have read this entire user guide.
- Only one rider is permitted at a time.
- Riders other than the owner are only permitted to ride the unit after they fully understand how to operate the unit and can demonstrate safe usage of all components before riding.

MAINTENANCE

Regularly examine all parts for wear or damage before use. Before inspecting, turn the unit "OFF," remove the charger plug and make sure all components have cooled off before touching. Exercise caution around exposed parts. If any parts require service or replacement, contact customer service or a reputable service center for motorized vehicles to make necessary repairs. Modifying the unit without a qualified repair technician will void the warranty and could cause damage to the unit and possible injury to the rider.

BRAKE ADJUSTMENT

Required 10mm wrench

Never ride the scooter if the brakes are not functioning properly.

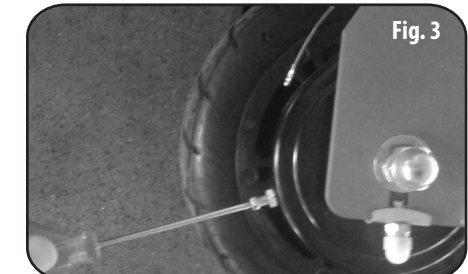

1. Hold the gate spring and reserve a 2-3mm space. Firmly tighten the brake wire and tighten the rope nut (Fig. 1).
2. Loosen the trim nut to adjust the small brake space (fixed hex nut) to make the brake more sensitive (Fig. 2).
3. Tighten the adjusting screw to finely adjust the brake space to make the brake more sensitive (Fig. 3).

NOTE: DO NOT lubricate between the brake pad (belt holding belt) and the hoop.

FRAME AND HANDLEBAR

Before each ride, check for cracks or other damage to the frame, neck and handlebars. Damage to the frame is unlikely, but bending or breaking the frame or handlebars can result from aggressive riding, like running into curbs and other objects. Always ride carefully, and inspect the scooter before each use.

HARDWARE

Check all hardware such as bolts, nuts, cables, fasteners and other parts to ensure they are secure and properly assembled. If you hear any rattling from loose parts, the unit is damaged and should not be used.

SAFE BATTERY USAGE

⚠ WARNING:

The scooter is equipped with a lead acid rechargeable battery. Please pay attention to the following cautions for safety use:

- Before recharging, allow the lead acid battery in the unit to cool for at least 10 minutes after use.
- Do not use the scooter if the battery is hot. During charging, the battery temperature should not exceed 104°F (40°C). A battery temperature that is too high or too low may indicate a problem with the battery.
- Never use the scooter if the battery is smoking or liquid is coming out of the battery. Do not touch any battery discharge.
- Do not dispose of the battery in fire or extreme heat.
- Do not use or leave the battery near a heat source such as a fire or a heater.
- Do not strike or throw the battery against hard surfaces.
- Do not immerse the battery in water, and keep the battery in a cool, dry place.
- When recharging, only use the battery charger specifically included for that purpose.
- Do not over-charge the battery.
- Do not directly solder the battery and pierce the battery with a nail or other sharp object.
- Do not disassemble or alter the battery.
- Charge the battery every month and as necessary.
- Do not transport or store the battery with metal objects such as necklaces, hairpins, etc.
- Please recycle a used battery after covering the battery terminals with insulation tape or inserting it into an individual poly bag. Check local laws and regulations for recycling and/or disposal information.
- Under the environment with electrostatic discharge, the product may malfunction and require the user to reset the product by turning it off and back on again.

NOTE

Never store the product in freezing or below freezing temperatures. Freezing will permanently damage the battery. Failure to charge the battery at least once a month may result in a battery that will no longer accept a charge.

DISPOSAL



'Let's care for the environment!'

The wheeled bin symbol indicates that the product must not be disposed of with other household waste. Please use designated collection points or recycling facilities when disposing of the item.

Do not treat old batteries as household waste. Take them to a designated recycling facility.

CONTAINS SEALED LEAD ACID BATTERIES. BATTERIES MUST BE RECYCLED.

This product uses sealed lead-acid batteries which must be disposed of and recycled in an environmentally safe manner. Do not dispose in fire, as the battery may leak or explode. Do not dispose in household trash receptacles. The incineration, land filling or mixing of sealed lead-acid batteries with household waste is prohibited by law in most areas. Return exhausted batteries to a federal or state approved lead acid battery recycling facility or a local dealer for automotive batteries. If you live in Florida or Minnesota, USA, it is prohibited by law to throw away lead acid batteries in the municipal waste stream.

CHARGING INFORMATION

The VR 550E includes a lead-acid battery, but the battery does not come fully charged. Before your first use and as needed, charge the battery according to the instructions below and the safety information on pages 2 and 3. Always charge the battery inside the unit in a clean, dry location away from direct sunlight, flames or sparks.

- 1 Plug the charger into a wall outlet.
- 2 Ensure the unit is turned OFF. Then, plug the charging cable into the port under the deck. The LED on the charger should turn red while charging. The light will turn green again when it is fully charged. Charge time is approximately 10-12 hours.
- 3 Unplug the charging cable from the unit and the wall outlet.
- 4 Turn the unit ON when you are ready to ride.

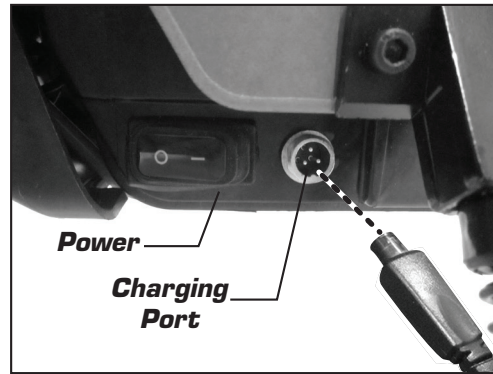
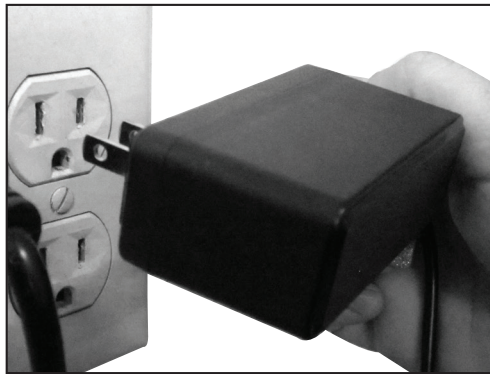

When the battery is running low or depleted, DO NOT continue driving the unit. The unit will not operate properly when the battery is too low. Continuing to ride may cause injury or damage to the unit and will negatively affect the battery life.

NOTE

A full charge will lend about 40 minutes of riding time; however, various conditions, such as the rider's weight, may increase or decrease the battery's capabilities.

Tips

- An ADULT must charge the unit each time, as the charger is not a toy.
- Only use the included charging cable or risk voiding the limited warranty.
- Always turn the unit OFF after use to conserve battery power and maintain battery capabilities.
- Always recharge the battery after each ride and before storing. Do not overcharge.
- Ensure the charging port is completely dry before charging.
- Allow the battery to cool down before recharging.
- Keep the battery and unit at room temperature when not in use. Do not use, charge or store in excessive heat, humidity or cold.
- Unplug the charging cable from the power outlet when not in use.
- Length of usage and range may vary due to riding conditions, weather, user weight and maintenance.
- Constant stopping and riding may affect the ride time.

CLEANING & STORAGE

WARNING: Prolonged exposure to UV rays, rain and the elements may damage the enclosure materials. Store indoors when not in use.

Should the unit need gentle washing due to large amounts of dirt or debris, please follow the cleaning directions below:

- 1 Prior to cleaning, always make sure the unit is OFF and the charger is unplugged.
- 2 Wipe clean with a soft cloth. DO NOT use harsh chemicals or abrasive scrubs to clean.
- 3 DO NOT use a high-powered water hose or expose the unit to excessive moisture or soap. Keep all water away from the charging port and battery.
- 4 To keep your unit in good condition, wipe clean after every use.
- 5 Store the unit indoors at room temperature below 77°F (25°C) away from direct sunlight. Keep away from moisture, humid environments, and harsh weather conditions. Cover the unit in its original packaging or under a covering to protect from dust and debris.
- 6 Do not place anything on top of the unit while storing. Do not store on a high shelf to prevent it from rolling off.
- 7 Store the unit after it has been fully charged. Always make sure the unit is OFF when storing. Charge at least every month when not in use to preserve the battery life.

SAFETY WARNINGS

OPERATIONAL SAFETY

WARNING:

Any type of wheeled activity can be hazardous. Wheels are intended to move and it is possible to get into dangerous situations and/or lose control and/or fall off. In such situations, serious injury or death may occur. Always be aware of activity around you. Only use the scooter in areas free from fixed or moving hazards. Watch your surroundings for pedestrians, animals and riders of other wheeled products or vehicles. Never use near motor vehicles.

WARNING:

- Never operate any moving product, including this unit, under the influence of drugs or alcohol.
- Ride defensively. Watch out for potential obstacles that could catch your wheel(s) or force you to swerve suddenly or lose control. Avoid pedestrians, skaters, scooters, bikes, children and animals who may cross your path, and respect the rights and property of others.
- Only use in an area that is suitable for safe operation.
- Never carry passengers or allow more than one person at a time to ride the product. Never hitch a ride with another product.
- Ensure all safety labels are in place and understood by everyone, especially the rider.
- Do not use headphones or a cell phone while riding.
- Always maintain a safe speed. Do not move faster than you are comfortable with, regardless of the unit's speed abilities.
- Do not make sharp turns while accelerating.
- Do not attempt stunts or tricks on the scooter. It is not made to withstand abuse from misuse, such as jumping, curb grinding or any other type of stunts. Racing, stunt riding, or other maneuvers also enhance the risk of losing control, or may cause uncontrolled rider actions or reactions.
- The scooter is intended for use on flat, dry surfaces, such as pavement or level ground, without loose debris, such as sand, leaves, rocks or gravel.
- Only use this product on completely smooth surfaces. Avoid obstacles and slippery surfaces, which could result in a loss of balance or traction and cause a fall.
- Avoid sharp bumps, drainage grates, and sudden surface changes.
- Do not ride the product in wet or icy weather. Do not immerse the product in water, as the electrical and drive components could get damaged by water or possibly create other unsafe conditions.
- Wet, slick, bumpy, uneven or rough surfaces may increase risks. Do not ride this product in mud, ice, puddles or water. Avoid excessive speeds that can be associated with downhill rides.
- Never use near steps or swimming pools.
- Do not ride at night or when visibility is limited.
- Be aware of your height when using the scooter. Be careful of door frames, branches, signs or lower obstructions.
- Be careful and know your limitations. Risk of injury increases as the degree of riding difficulty increases. The rider assumes all risk associated with aggressive riding activities.
- Do not allow hands, feet, hair, body parts, clothing, or similar articles to come in contact with moving parts, wheels, or drive train chain while the motor is running.

WARNING:

RISK OF FIRE: No user-serviceable parts.

Always inspect the unit prior to use. Properly inspecting and maintaining this product can reduce the risk of injury. Before use, check to confirm that any and all guards and covers originally supplied by manufacturer are in place and in serviceable condition. Check that the brake system is functioning properly, that the tires are in good condition and have sufficient tread remaining. The unit should be maintained and repaired in accordance with the manufacturer's specifications using only the manufacturer's authorized replacement parts with installation performed by dealers or other skilled persons. DO NOT open the unit, or you risk voiding the limited warranty.

HARDWARE

Before every ride, check all parts, such as nuts, bolts, fasteners, etc. to ensure they are secure and assembled correctly. There should not be any unusual rattles or sounds from loose parts or broken components. If the product is damaged, do not ride.

WHEELS

Practice riding only in wide open areas clear from curbs, parking blocks and other obstacles, including things you may fall on or into if you lose your balance. Impacting the wheels against any hard surface can damage the unit. Wheels are not covered under your limited warranty.

SAFETY GEAR AND ATTIRE

Always wear proper protective equipment, such as an approved safety helmet (with chin strap securely buckled). A helmet may be legally required by local law or regulation in your area. Elbow pads, kneepads, wrist guards, a long-sleeved shirt, long pants and gloves are recommended. Always wear athletic shoes (lace-up shoes with rubber soles) and keep shoelaces tied and out of the way of the wheels, motor and drive system. Never ride barefooted or in sandals.

LOCAL LAWS OR REGULATIONS

Follow all local laws and regulations regarding how and where to use the product legally. Follow all applicable laws for vehicles and pedestrians. Operators/riders shall adhere to all manufacturer's recommendations and instructions, as well as comply with all laws and ordinances, including: units without headlights shall be operated only with adequate daylight conditions of visibility, and owners/riders should highlight and make the scooter conspicuous, including the use of lighting, reflectors, and for low-riding units, signal flags on flexible poles.

TO MINIMIZE THE RISK OF INJURY, READ ALL SAFETY WARNINGS AND INSTRUCTIONS BEFORE YOU CONTINUE READING.

ABOUT THE VR 550E



SPECIFICATIONS

L x W x H	36.69x14.37x36.42 in. (932x365x925mm)	Motor	DC brush motor
Wheel Base	720mm	Rated Voltage	12V
Net Weight	30.45 lbs. (13.8 kg)	No Load Speed	3300±200rpm
Max. Load	120 lbs. (54 kg)	Rated Output	100W
Recommended Load	81-120 lbs. (37-54 kg)	Rated Output Torque	≤ 0.35N.m
Min. Ground Clearance	17mm	Battery Type	Lead-acid battery
Tire	7 in. solid tire	Battery Capacity	7AH
IP Rating	IPX4	Nominal Battery Voltage	12V
Operating Temp.	32°F-104°F (0°C-40°C)	Battery Working Temp.	5°F-104°F (-15°C-40°C)
Max Speed	10 mph (16 km/h)	Charger Input	100-240VAC
Range	6 mi. (9.6 km)	Charger Output	12VDC/800mA/50-60HZ
Grade Ability	4°	Charging Time	10-12 Hours
Turning Radius	4.22 ft. (1.3 m)	Charging Temp.	32°F-104°F (0°C-40°C)
Charger Manufacturer	Shenzhen Fuyuan dian Power Co., Ltd.	Charger Model	FY0171200800

ASSEMBLY

NOTE An adult must assemble the handlebar to the unit.

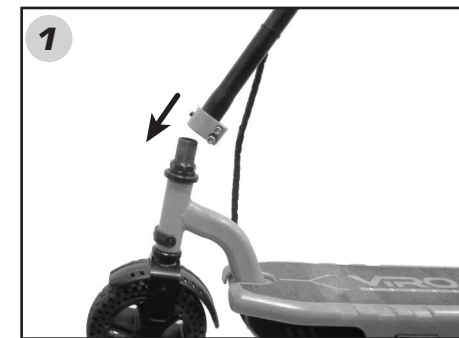

Attach the handlebar to the scooter, making sure it is inserted all the way in.



Tighten the screws with the Allen wrench.



Rotate the brake so it faces away from the handlebar.



Tighten the screw with the Allen wrench.

RIDING THE VR 550E

NOTE

- Fully charge the VR 550E before first use. Follow the charging instructions on page 6.
- Put on all recommended protective gear.
- Fully read this entire user guide before attempting to ride.
- Ask a competent adult to help you ride until you are comfortable.

1 Turn the unit ON. Release the kickstand. Place one foot flat on the floor for stability. Place your other foot on the front of the deck.



3 Push off of the ground and press the throttle button with your thumb. Bring your foot onto the back of the deck.



2 Hold both handlebars with your thumb on the throttle.

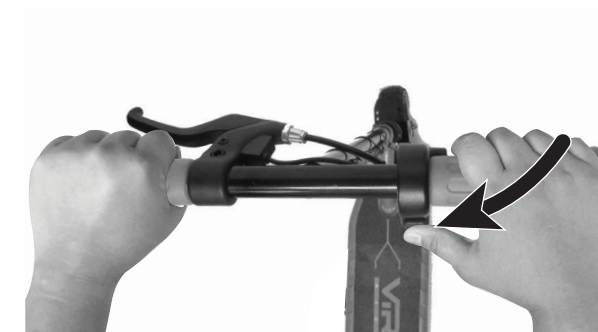

4 Turn the handlebar left to turn left and right to turn right. Slightly lean into the direction you are turning. Pull the brake toward you to slow or stop the scooter.

