

# mamas & papas

## Junior Cruiser Stroller

### Safety Notes

**EN** This item is a toy and not suitable for carrying babies, children or pets. Assembly should be carried out by an adult to prevent the item collapsing in use. Please remove all packaging attachments before giving this toy to a child. An adult should check all mechanisms of this toy regularly. Always play under adult supervision. Warning! Not suitable for children under 36 months. Strangulation hazard due to long cord and choking hazard due to small parts.

### Part List

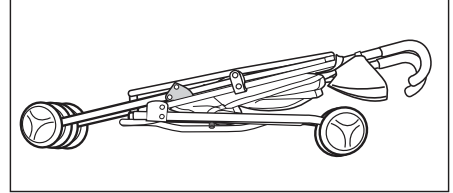

1 x Main Body Frame

### Assembly

#### To open

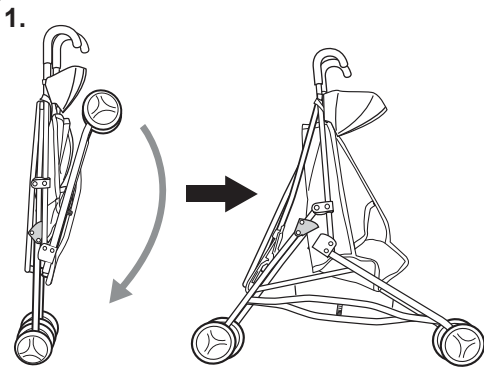

Pull down wheels in the direction shown.

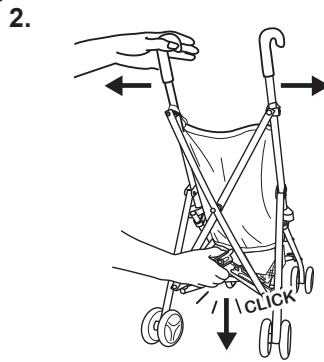

Spread the handles apart and push down safety lock at the back of the stroller until it clicks into a horizontal position.

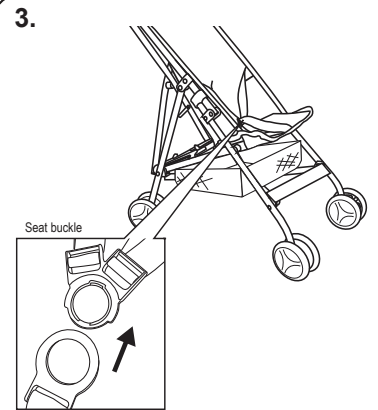

#### To close

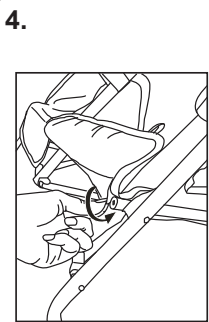

Fix the fabric on the frame as shown.

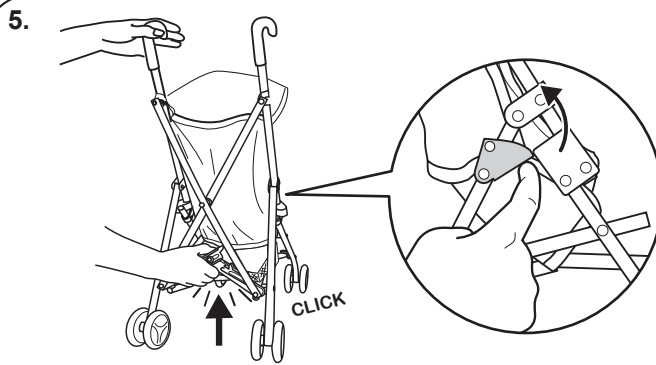

1. Push up the safety lock until it clicks open.

2. Rotate the two side locks to allow the stroller to fold.

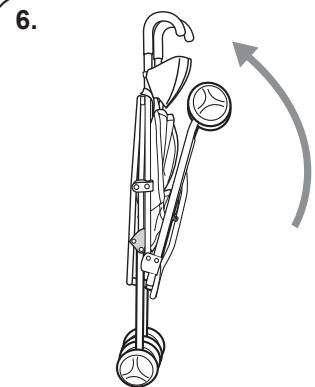

Rotate front wheels towards handles to fold flat.

### Care Notes

This fabric should not be machine-washed. Please wipe clean using a damp cloth with mild detergent if necessary.

### Contact Details

If you experience any difficulty with this item or you wish to enquire about any accessories or spare parts, please contact our customer service department on:

#### Designed and Manufactured by:

HTI Toys, Copse Road,  
Fleetwood, FY7 7NY, UK  
customerservice@htigroup.co.uk  
+44 (0)1253 775570



You are advised to keep these details for future reference.  
© Mamas & Papas is the trade mark of, and is used under license from, Mamas & Papas Limited.