

## SATURN - m08611/m08612-02

FOR CHILDREN AGED 3 TO 10 YEARS



### SAFETY GUIDELINES

#### Warnings

**Only for domestic use. This product has not been designed for commercial use in play centers, nurseries etc.**  
**Only suitable for outdoor use.**  
**Not for children with a body weight over 45kg. Only one child per seat at any one time.**  
**The total weight on the product at any one time must not exceed 145kg.**  
**Not for children under 3 years due to small component which may cause choking hazard.**

This equipment must be assembled and checked by an adult. Two adults may be required to assemble this product. Adult supervision is required at all times.

Check all nuts, bolts and fittings for tightness and tighten if required.

Check all coverings for bolts and sharp edges and replace when required.

Check swing seats, chain, ropes and other means of attachments if relevant to your product for evidence of deterioration. Replace when required in accordance with the manufacturers instructions if necessary.

Place the product on level surface at least 2 metres from any structure or obstruction such as a fence, garage, house, wall, overhanging branches, laundry line or electrical wires.

The items **MUST** be anchored firmly into the ground.

DO NOT install the product over concrete, asphalt or any hard surface.

DO NOT orientate the product directly towards the sun.

Leave all fittings finger tight until assembly is complete, for ease of construction. Then tighten firmly.

Children should not wear cycle helmets whilst on this equipment.

Do not allow children to stand on any swing seats, glider seats or slide chutes relevant to your product.

Do not allow the children to jump or climb off any moving equipment.

Do not twist swing ropes or wrap them over the top bar.

Do not allow loose, hooded or baggy clothes to be worn as children can get trapped and may be unable to free themselves.

Do not allow children to climb on parts of this equipment intended for this purpose.

Do not allow children to wander into the play area whilst the equipment is in use.

Do not allow children to slide head first down the chute, walk up the chute or jump or climb off the chute.

Glider seats and swings must not exceed an angle of 60 degrees from the ground.

Regularly check the item for wear and damage, removing the item from use when necessary until replacement parts are fitted.

Failure to assemble and maintain this item as per instruction may cause injury to the user.

The minimum clearance between the swing and ground level should be 350mm.

Please contact our customer services department if you have any problems. Do not modify this item.

Made in China to European Standards.

Conforms to EN71

ISSUE:10-2012

### SWING PARTS LIST

- 1 top bar (x1)
- 2 "left-hand" type top leg (x2)
- 3 "right-hand" type top leg (x2)
- 4 plain bottom leg (x3)
- 5 side stay bar (x2)
- 6 glider bracket (x1)
- 7 glider handle tubes (x2)
- 8 glider legs (x2)
- 9 glider seat tubes (x2)
- 10 bottom leg (x1)
- 11 glider seat (x2)
- 12 glider footrest (x2)
- 13 swing seat (x1)
- 14 spanner (x1)
- 15 allen key (x1)
- 13A Swing Bearing (x2)

### SLIDE PARTS LIST

- 16 Upper Support-Tube x 2
- 17 Lower Support Tube x 2
- 18 top ladder rung x 1
- 19 2nd ladder rung x 1
- 20 3rd ladder rung x 1
- 21 bottom ladder rung x 1
- 22 chute side stay bar x1
- 23 ladder leg x 1
- 24 ladder handle x 2
- 25 Upper Slide x 1
- 26 Lower Slide x 1
- 27 ladder handle x 1
- 28 ladder handle x 1
- 29 Support Strap x 2
- 30 Support Strap x 1
- 31 Support Strap x 1
- 32 Connector x 4
- 33 ground pegs (x5)

**IMPORTANT:** Make sure you read the safety notice on the front page and always supervise children while they are playing on the equipment. Once assembly is completed carefully check equipment. In the unlikely event that you do find any problems, please contact us. Do not allow children to use this product until the problem has been corrected.

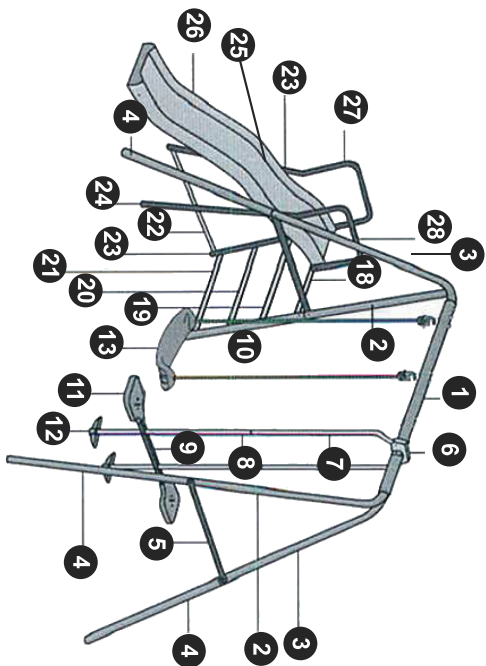

**STEP 1**  
Frame & Swing Assembly

**F1** **M8 BOLT 53mm (x2)**

**15** **ALLEN KEY**

**14** **SPANNER**

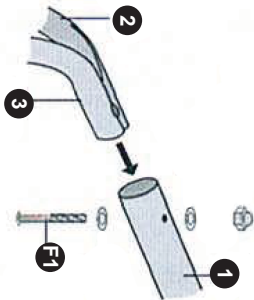

**S1**

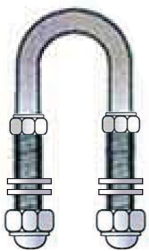

**1/8 U BOLT (x2)**

**13A**

**SWING BEARING (x2)**

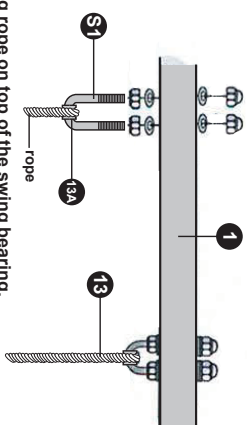

• Remember to put the swing rope on top of the swing bearing.  
Should the rope come off during use please replace back on top of the swing bearing.

**F2** **M6 BOLT 47mm (x4)**

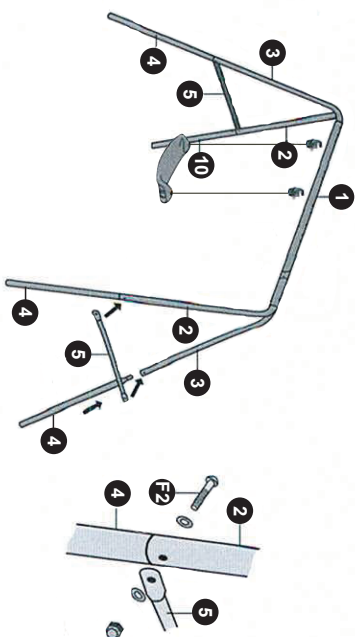

• Ensure bottom leg (10) is connected to top leg (2) and not top leg (3)"

**STEP 2**  
Glider Assembly

**G1** **M6 BOLT 42mm (x2)**

**G2** **M8 BOLT 39mm (x2)**

**G8** **THIN PLASTIC SPACER (x4)**

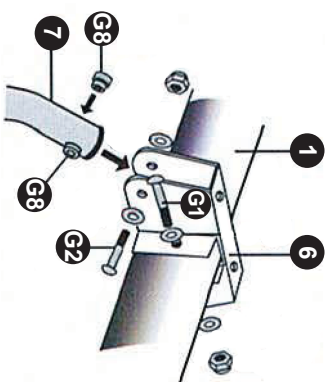
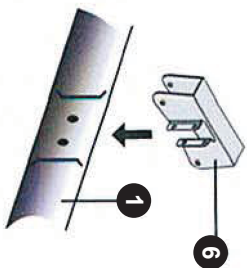

**G6**  **M6 BOLT 35mm (x4)**

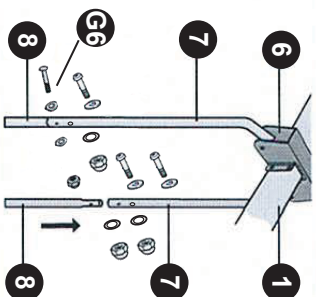

**G6**  **M6 BOLT 35mm (x8)**

**G4**  **M8 BOLT 82mm (x2)**

**G5**  **M6 BOLT 40mm (x2)**

**G9**  **THICK PLASTIC SPACER (x4)**

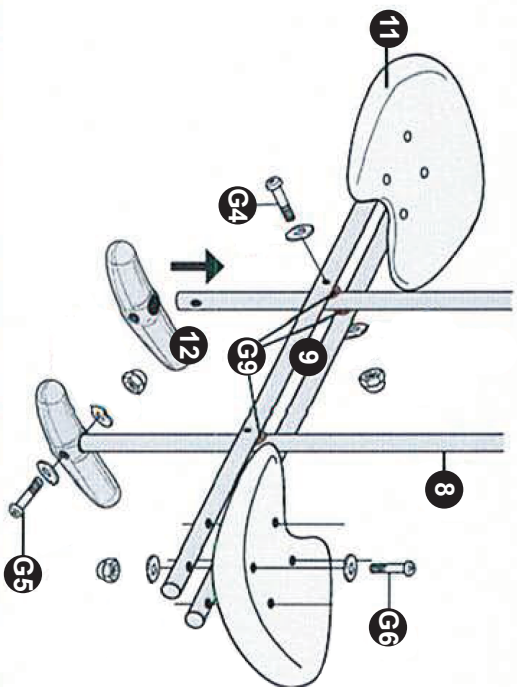

• Assemble seats (11) and attach to seat tubes (9) before tightening bolts (G4)

### STEP 3 Slide Chute Assembly

**F1a**  **32**  **Connector x 4**

M6 BOLT 20mm x 6

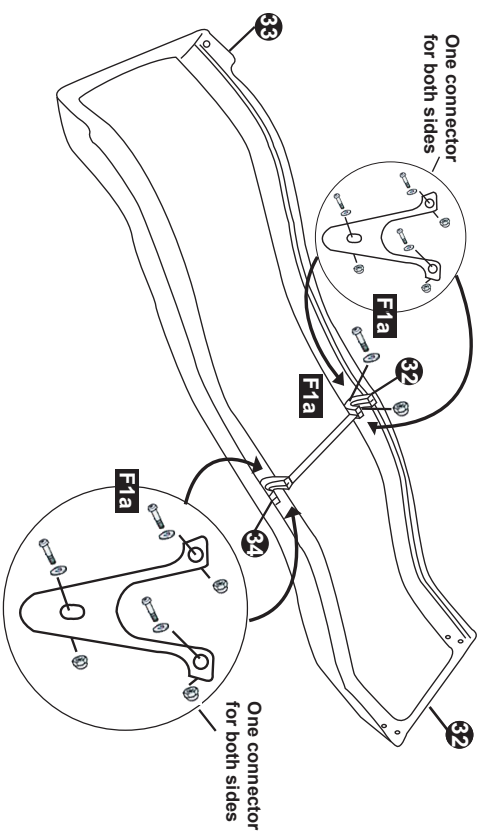

### Bracket Assembly

**F3**  **M6 BOLT 35mm (x8)**

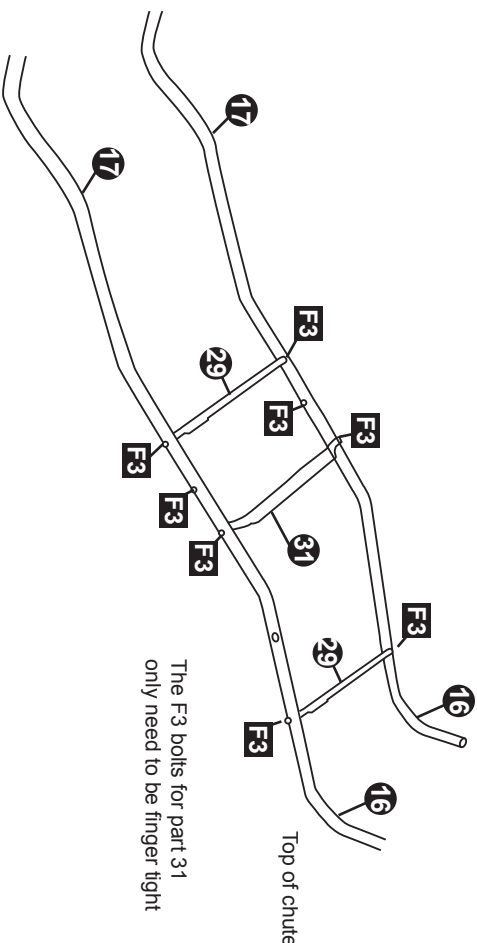



Assembly Of The Bracket Onto The Slide



M6 BOLT 17mm x 3



M6 BOLT 66mm x 2

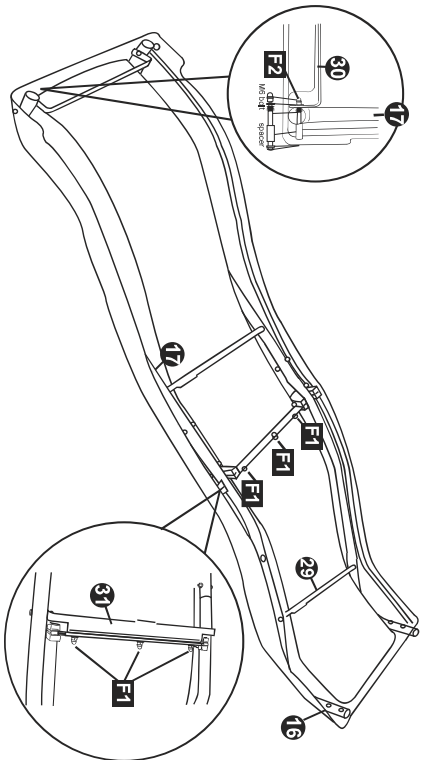

**STEP 4**  
Wavy Chute Assembly Continued



M6 BOLT 52mm (x4)



M6 BOLT 40mm (x3)



M6 BOLT 40mm (x2)



M6 BOLT 58mm (x2)



M6 BOLT 62mm (x4)

Please Note: Top ladder (18) rung is to be fitted behind ladder handle(27 & 28) and bottom leg (10)

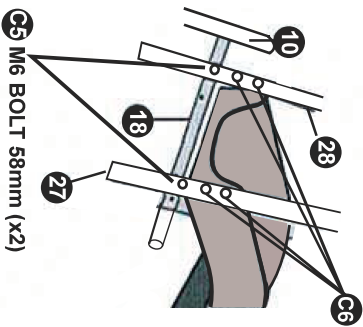

**C5** M6 BOLT 58mm (x2)

**C6** M6 BOLT 62mm (x4)

• Please assemble tube 22 Last  
• Leave the bolts loose until the chute is assembled to the ladder frame, to ease construction, then tighten firmly

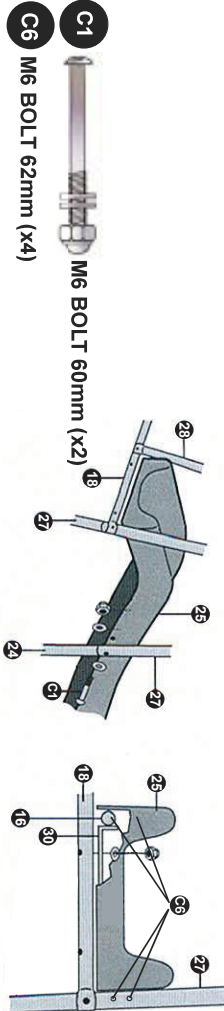
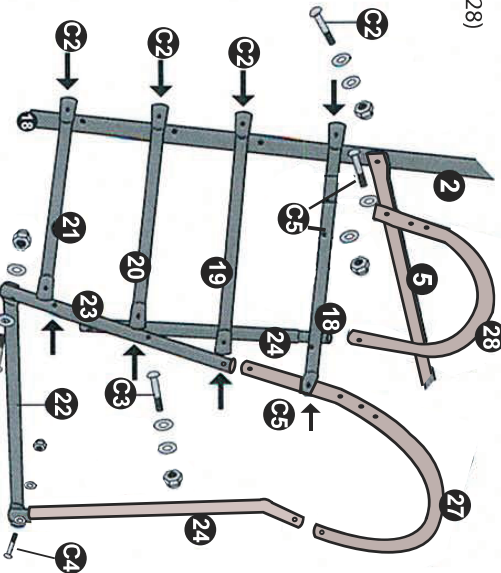

**C1** M6 BOLT 60mm (x2)

**C6** M6 BOLT 62mm (x4)

**STEP 5**  
Anchoring the Gym to the ground

**IMPORTANT:** For safety reasons this gym **MUST** be anchored into the ground. We recommend that it is concreted in. If you are uncertain about this procedure, telephone our helpline number.



M6 BOLT 58mm (x4)



M6 BOLT 47mm (x1)

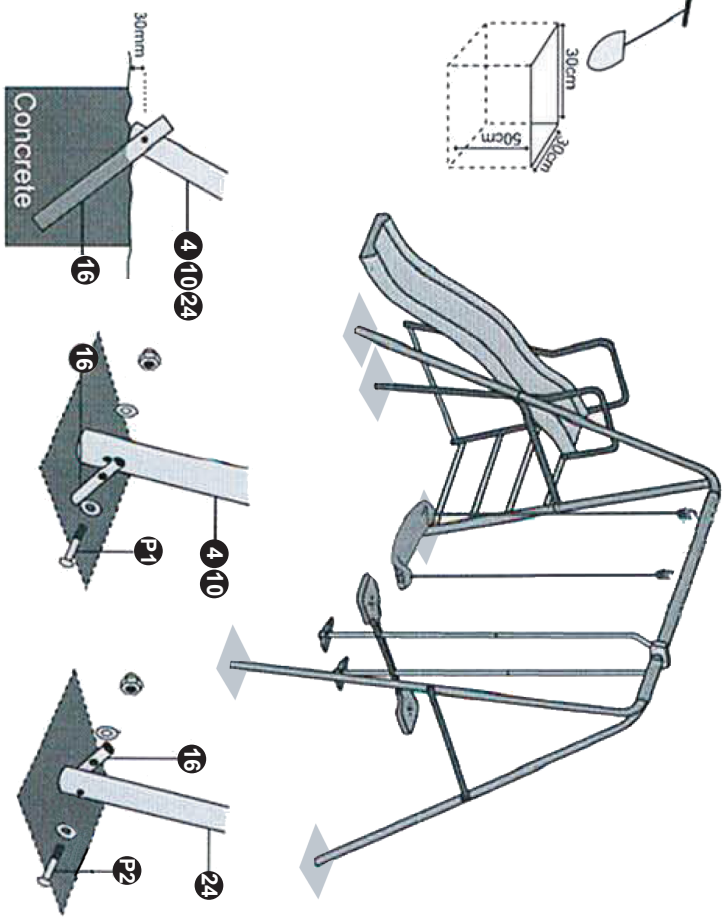
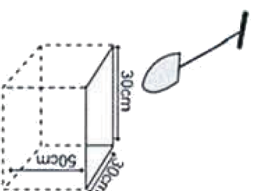

MV Sports & Leisure Ltd.  
35 Tameside Drive  
Castle Bromwich  
Birmingham B35 7AG  
United Kingdom  
email: info@mvsports.com  
www.mvsports.com

**CUSTOMER SERVICES**

MV has taken great care to ensure that this toy has reached you in good condition. Should you have a query, please contact: customer.service@mvsports.com where your query will be dealt with promptly. Alternatively you can call on 0870 8404255.



This mark denotes compliance with the standards laid down by the E.C. (European Community). It is in your best interest to keep a note of our name and address for future reference. If you find this mark on any other product, please contact the distributor at the address shown below.