

# Digital Safe

THIS MANUAL CONTAINS IMPORTANT INFORMATION REGARDING THE  
OPERATION AND MAINTENANCE OF THE SAFE READ THE MANUAL  
BEFORE SECURING ITEMS IN THE SAFE  
**SAVE THIS MANUAL FOR FUTURE REFERENCE**

MODELS: S-168E

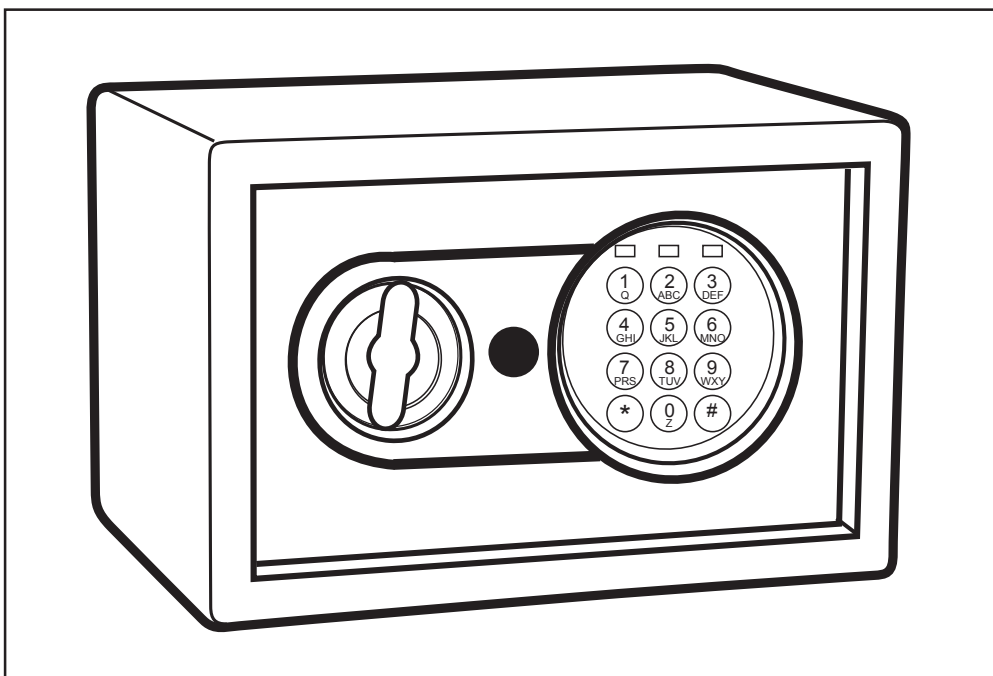

NEVER LOCK YOUR SPARE OVERRIDE KEYS OR THE INSTRUCTION MANUAL IN THE SAFE.  
ONCE THE BATTERIES DEplete, YOU WILL NEED TO USE THE KEYS TO OPEN THE SAFE.  
SPARE KEYS ARE UNAVAILABLE!



Always Read the Instruction Manual

# SAFE DIAGRAM

## ALL DIAGRAMS in this manual ARE FOR REFERENCE ONLY

NOTE: This safe & cash box are NOT fire proof.

NOTE: This safe & cash box has no cash rating.

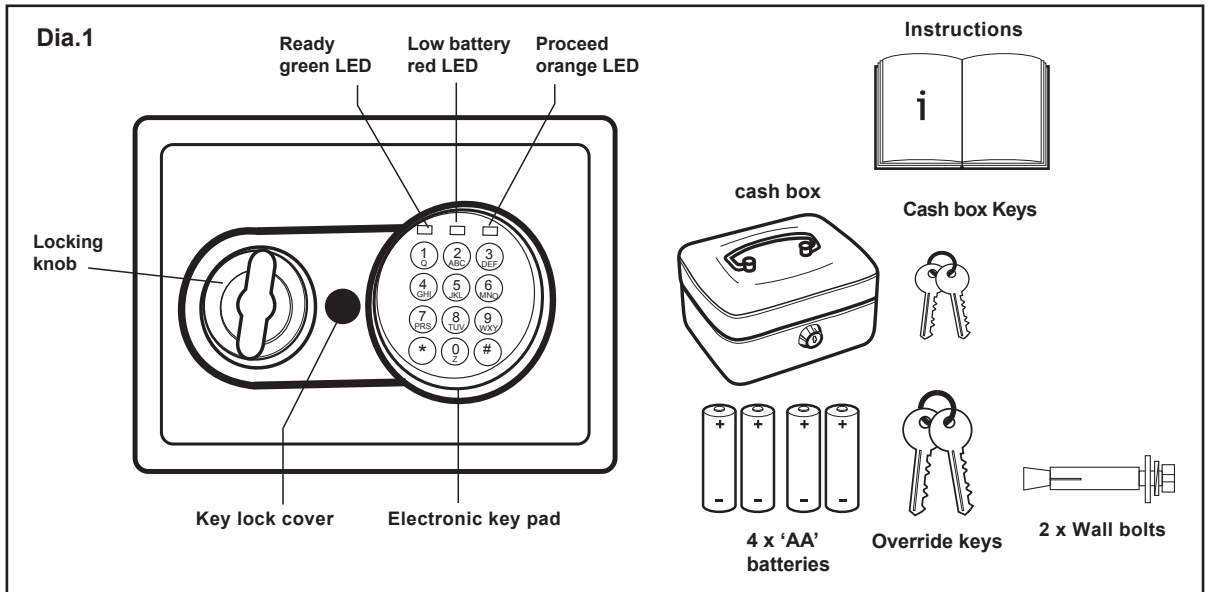

### CONTENTS

- 1x Digital safe
- 1X Instruction book
- 2X Manual override keys

- 4X 'AA' Batteries
- 2 X wall bolts
- 1x Cash box
- 2x Cash box keys

### IMPORTANT INFORMATION

**Note: Please make sure that after you have opened the safe for the first time you change the PIN for security reasons.**

#### OPERATING THE SAFE FOR THE FIRST TIME

Use the Manual override key to open the safe.

- Remove the plastic key lock cover (dia 1)
- Insert the override key. Turn it clockwise at the same time turn the locking knob clockwise and pull open the safe.
- See BATTERY REPLACEMENT
- Keep the safe door open until you have set the PIN code.

## PROGRAMMING YOUR PIN NUMBER (personal identification number)

Each time a button is pressed, a beep will be heard and the Orange LED will flash. This is a safety feature so that you will know when the safe is being accessed and cannot be switched off.

Keep PIN Codes in a safe place.

Do not use personal information like birthdays, telephone numbers etc.

- Write down your PIN code so you do not forget it. (any combination of numbers from 3 to 8 digits)
- With the door open, install 4 AA batteries provided.
- Depress the red reset button located at the back of the door.(dia.2)
- The Orange LED will light.
- You now have 20 seconds to enter your PIN.
- Key in your new PIN.
- Press the "#" or "\*" button once to finish.
- Two beeps will be heard and the Orange LED will go out.
- Your PIN has now been set.
- Screw the security cap back onto the red button. Ensure you do this for security reasons.

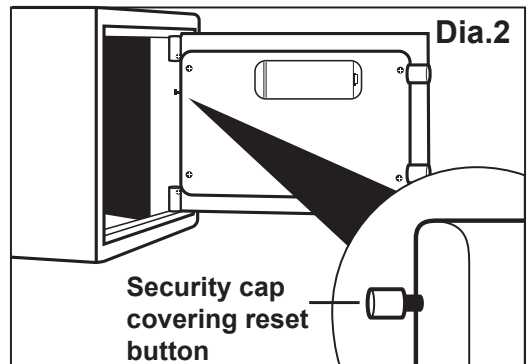

## OPENING THE DOOR USING YOUR PIN NUMBER

Each time a button is pressed, a beep will be heard and the Orange LED will flash.

- Input the PIN you set.
- Press "\*" or "#" button. The green LED will flash.
- Turn the knob clockwise to pull open the door.

While the door is open familiarise yourself with the door opening procedure and leave the door open until you are satisfied that you fully understand the opening and closing method. You can re-set the PIN at any time by following the above procedure.



If the Red and Green LED light simultaneously when the correct PIN is entered, then the batteries **MUST** be replaced immediately before closing the door as this indicates that the batteries are too low.



If an incorrect PIN is entered, the safe will not open. Three warning beeps will be heard, the Orange LED will flash and the Green LED won't light. Entering an incorrect PIN three consecutive times will freeze the locking mechanism and keypad for 20 seconds, during which time you will not be able to access the safe. After three more incorrect PIN attempts, the locking mechanism and keypad will freeze for 5 minutes during which time you will not be able to access the safe.

## OPENING THE SAFE USING THE OVERRIDE KEY

Use the Manual override key to open the safe.  
Remove the plastic key lock cover (dia 1)  
Insert the override key; turn it clockwise, at the same time  
turn the locking knob clockwise and pull open the safe.

## BATTERY REPLACEMENT

1. The digital safe uses four 'AA' type batteries (supplied).
  - Remove the battery cover on the rear of the door (dia 5).
  - Push the catch in and pull out the cover,
  - Install the 4x 'AA' batteries supplied. Ensure correct polarity.
  - Replace the battery cover.
  - Keep the safe door open until you have set the PIN code.



The battery life is approximately one year.  
Make a note of the battery replacement date.  
However, we recommend checking the batteries every 6 months just to make sure  
If batteries are removed from the safe the set PIN code will be only remain in its memory for approximately 4 hrs then it will need re-setting.

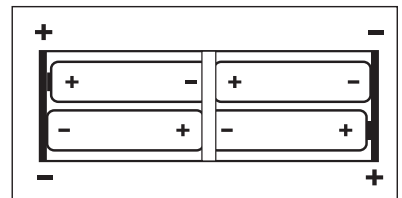
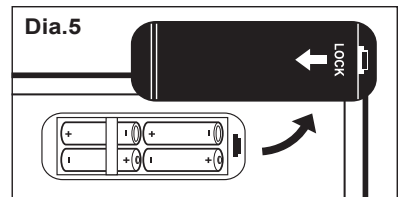
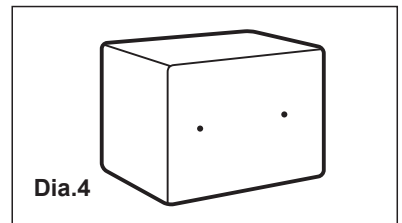

## SECURING YOUR SAFE

**ADVICE:** We strongly recommend that you secure your safe to a wall or floor using the wall bolts supplied.  
Use the holes in the safe (Dia 6) to mark where you need to drill.  
Loosely attach the wall bolts onto the safe with the nuts and washers provided. Hold the safe over the drilled holes and locate the wall bolts into these holes (Dia 6). Tighten the nuts from the inside of the safe to secure firmly.

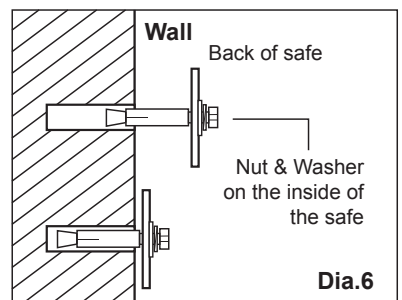

Please note that the wall bolts are only to be used in brick & cement structures.

## TROUBLE SHOOTING

	PROBLEM	CAUSE	SOLUTION
1	Can I get a replacement key/ extra key?		Replacement keys are not available due to security reasons.
2	The keypad becomes inoperable	Low or depleted batteries	Use override keys and replace batteries.
3	My PIN works and the green light lights, however, the safe won't open	Low batteries. Will operate the keypad but not the lock relay.	Use override keys and replace batteries.
4	I have lost the keys and forgotten the PIN number, can I obtain spare keys.		If the safe cannot be opened properly then you will need to forcibly open it.
5	I am experiencing problems using the back up key; it is unable to slide smoothly into the keyhole.		Spray inside the keyhole with WD40, leave for a few minutes and then try again.
6	We recently changed the batteries in the safe, the safe has reset the code itself, and the code I've been using is no longer valid?	If the batteries are completely depleted for more than a day then the safe will not retain the code.	Try the factory default code 159 or use the override key; then refer to the user manual to reset your original code or to enter a new code.
7	The Red and Green LED lights simultaneously when the correct PIN is entered.	The batteries are depleted.	Immediately replace the batteries
8	The batteries I bought don't fit the safe?	Batteries can vary in size.	Try another brand.
9	When I use the override key, I can't open the door.		Ensure that you are tuning the key clockwise, holding it in that position and then turn the locking knob clockwise to release the catch.



**Always read the  
instruction manual**



**WARNING!**

**NEVER LOCK YOUR SPARE OVERRIDE  
KEYS OR THE INSTRUCTION MANUAL  
INTO THE SAFE**

**SPARE KEYS ARE UNAVAILABLE**

This product is guaranteed for domestic use only for a period of 12 months against faulty manufacture or materials.

Any other use may invalidate the guarantee.

This product is not guaranteed for hire purposes.

This guarantee does not affect the statutory rights of the consumer.

**NOTE:**

These important safeguards and instructions cannot cover all possible conditions and situations that may occur. It must be understood that common sense and caution are factors which cannot be built into any product.

These factors must be applied by the person using this product

**Argos Ltd 489 - 499 Avebury Boulevard,  
Central Milton Keynes, MK9 2NW**