

Always there to help you
Register your product and get support at
www.philips.com/support



AJ2000



Quick start guide

PHILIPS

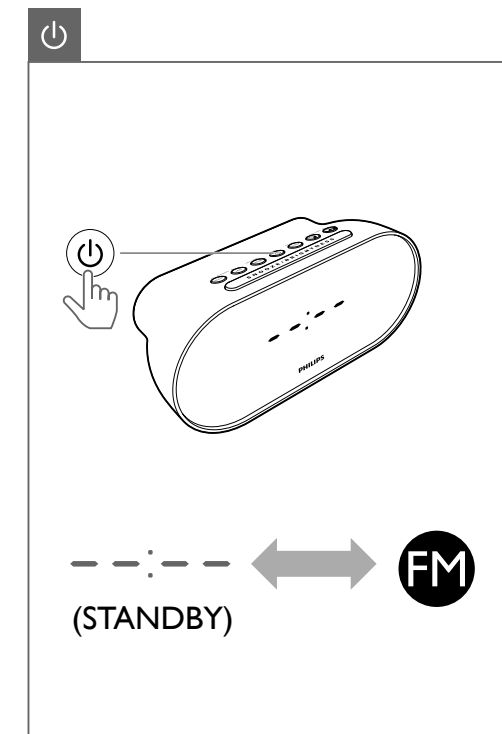
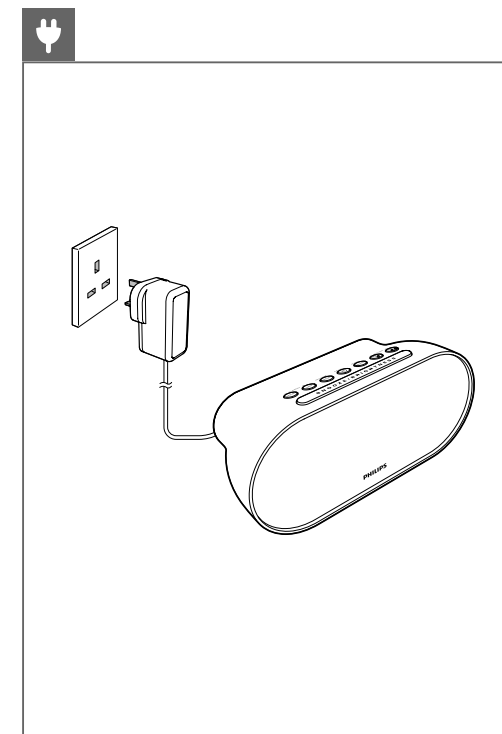
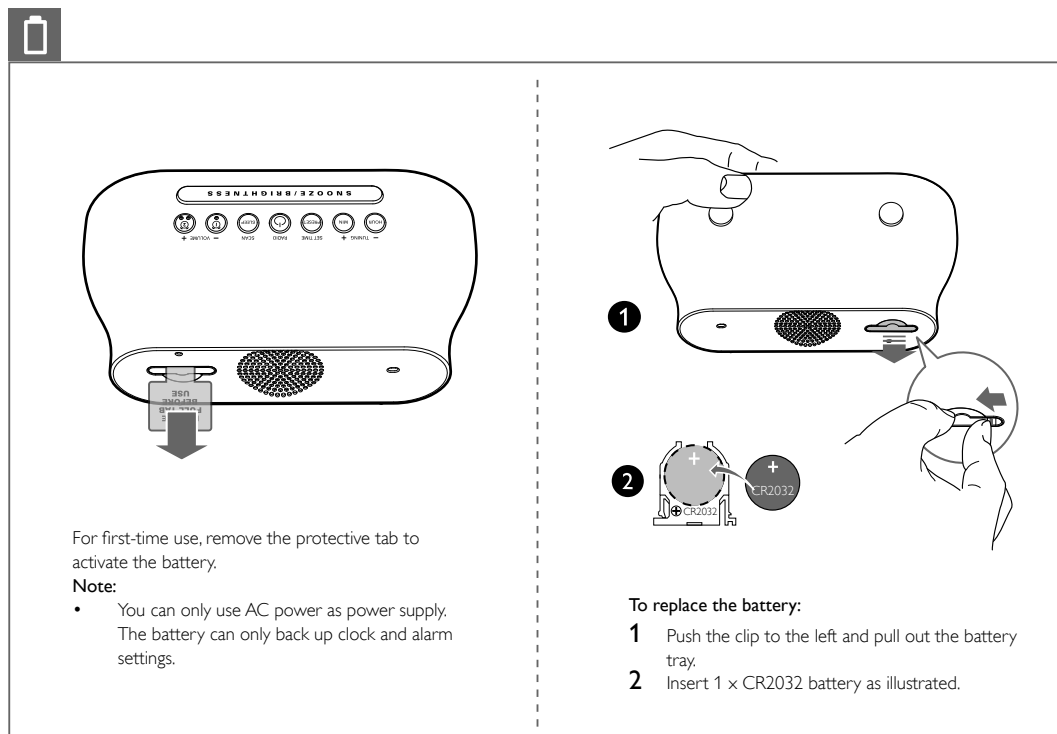
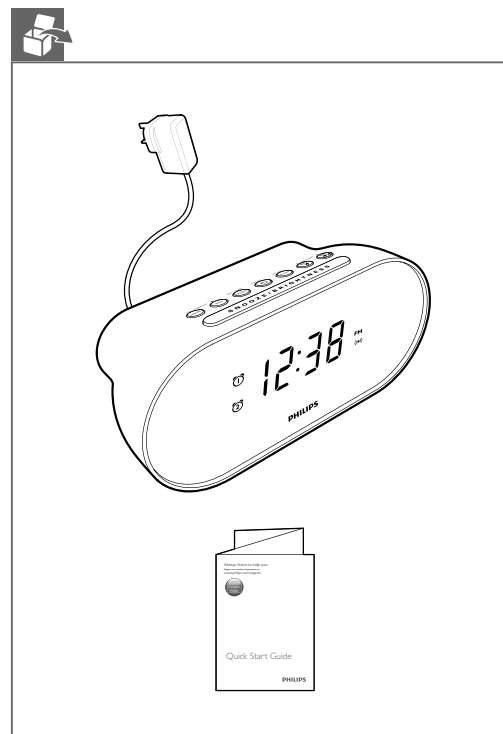

This product has been manufactured by, and is sold under the responsibility of Gibson Innovations Ltd., and Gibson Innovations Ltd. is the warrantor in relation to this product. Philips and the Philips Shield Emblem are registered trademarks of Koninklijke Philips N.V. and are used under license.



AJ2000_05_QSG_V4.0

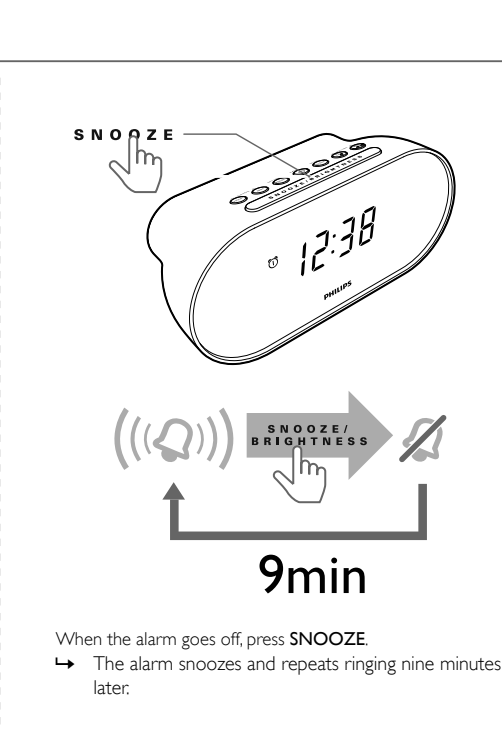
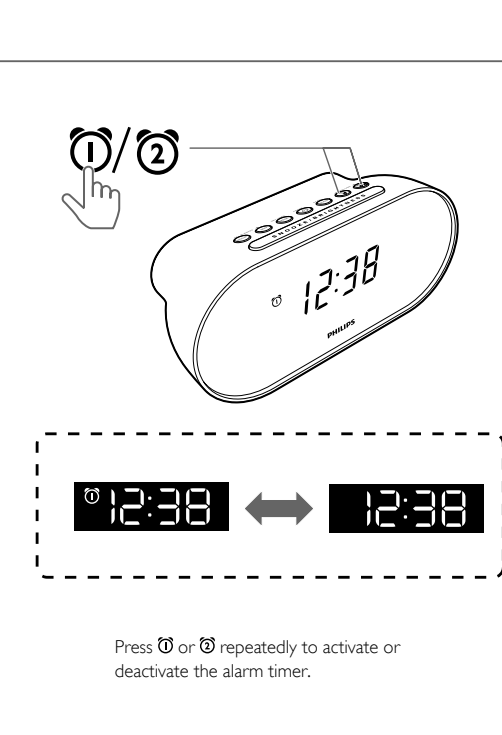
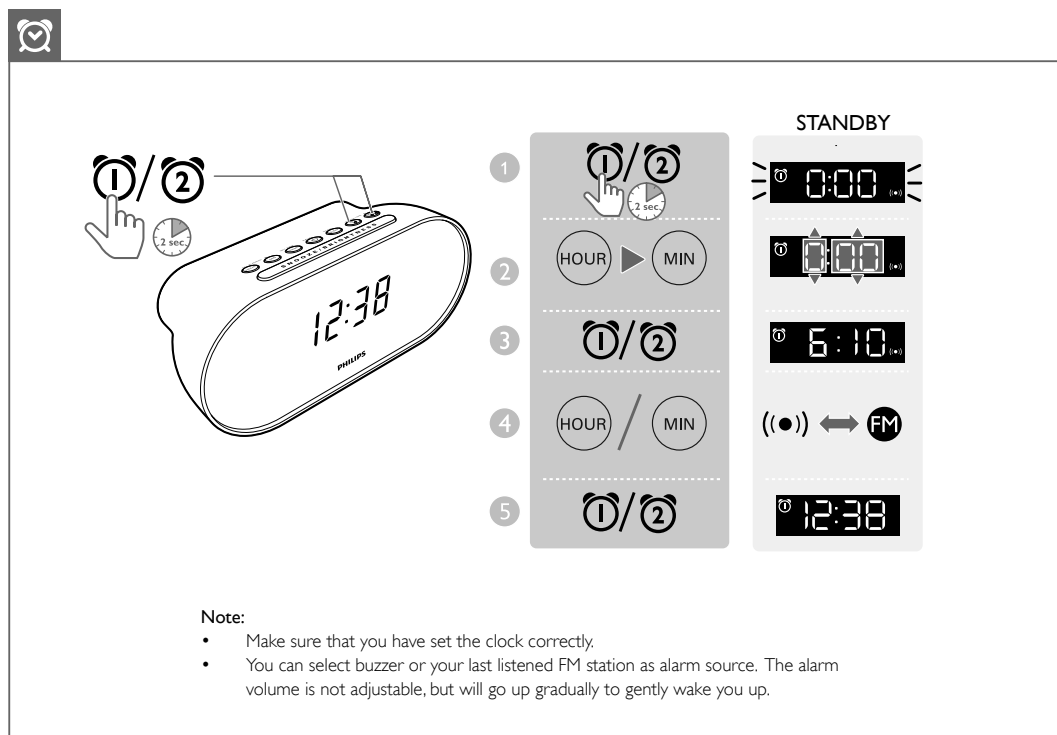
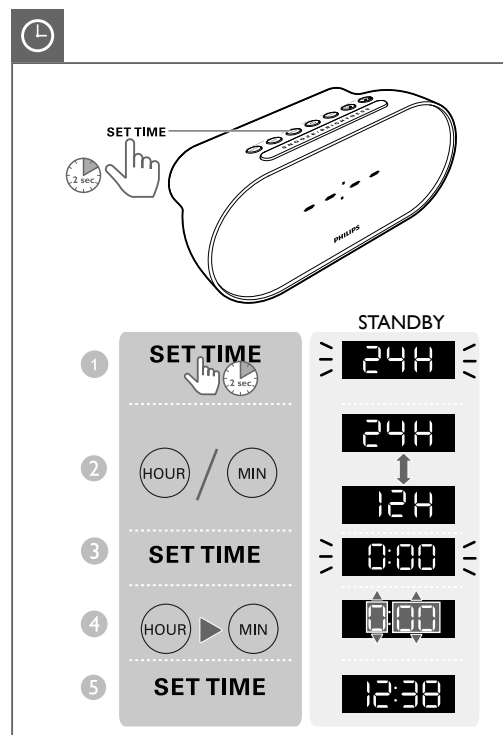

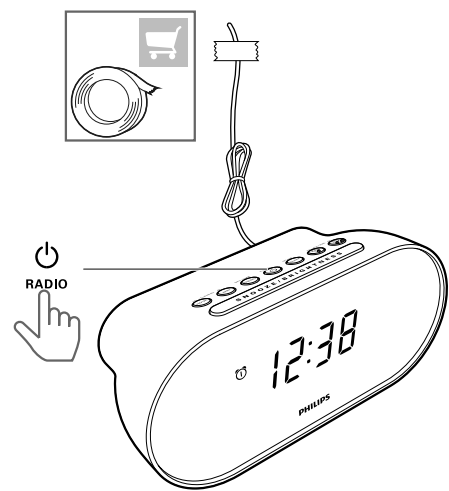

- 1 Fully extend and adjust the position of the pig-tail antenna until you find the best reception.
- 2 Fix the antenna as illustrated.

Tune to radio stations

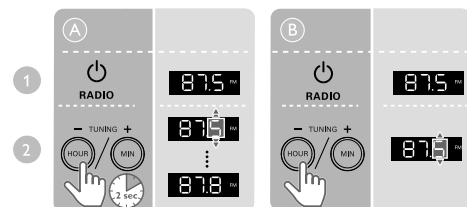

Store radio stations automatically

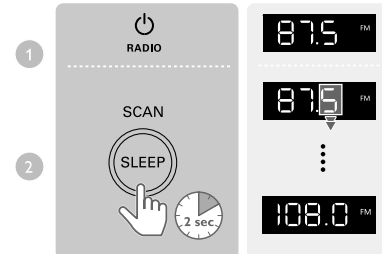

Store radio stations manually

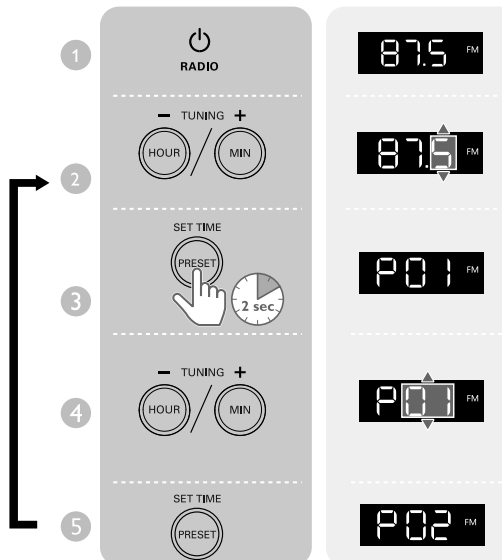

Select a preset radio station

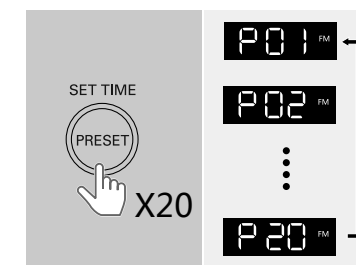

- If you suspect that a battery has been swallowed or placed inside any part of the body, seek immediate medical attention.
- When you change the batteries, always keep all new and used batteries out of reach of children. Make sure that the battery compartment is completely secure after you replace the battery.
- If the battery compartment cannot be completely secured, discontinue use of the product. Keep out of reach of children and contact the manufacturer.

Note

- The type plate is located on the bottom of the product.

2 Notice

Any changes or modifications made to this device that are not expressly approved by Gibson Innovations may void the user's authority to operate the equipment. Hereby, Gibson Innovations declares that this product is in compliance with the essential requirements and other relevant provisions of Directive 2014/53/EU. You can find the Declaration of Conformity on www.philips.com/support.

Care of the environment

Disposal of your old product and battery

Your product is designed and manufactured with high quality materials and components, which can be recycled and reused.

This symbol on a product means that the product is covered by European Directive 2012/19/EU.

This symbol means that the product contains batteries covered by European Directive 2013/56/EU which cannot be disposed of with normal household waste.

Inform yourself about the local separate collection system for electrical and electronic products and batteries. Follow local rules and never dispose of the product and batteries with normal household waste. Correct disposal of old products and batteries helps prevent negative consequences for the environment and human health.

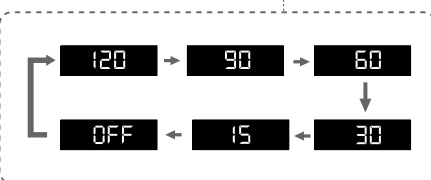
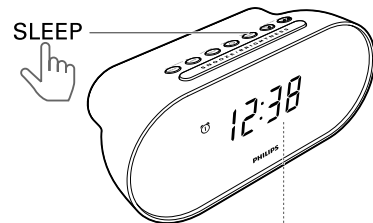

- Press **SLEEP** repeatedly to select a time period (in minutes).
- ↳ The product switches to standby mode automatically after the preset period.
 - ↳ When **[OFF]** is displayed, the sleep timer is deactivated.

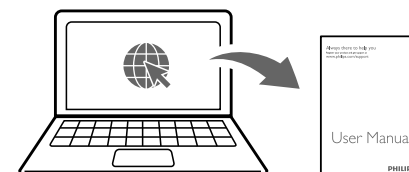
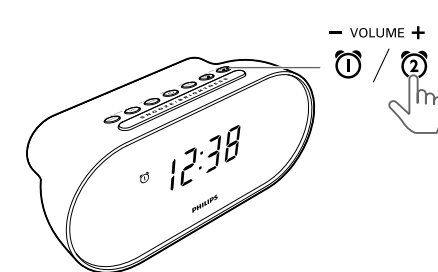
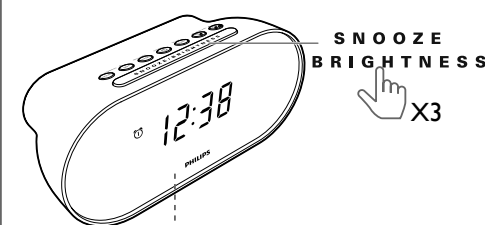

www.philips.com/support

1 Safety

- Make sure that there is enough free space around the clock radio for ventilation.
- Only use attachments/accessories specified by the manufacturer.
- Use only power supplies listed in the user manual.
- Unplug this clock radio during lightning storms or when unused for long periods of time.
- Battery usage **CAUTION** – To prevent battery leakage which may result in bodily injury, property damage, or damage to the clock radio:
 - Install the battery correctly, + and - as marked on the clock radio.
 - Remove the battery when the clock radio is not used for a long time.
 - The battery shall not be exposed to excessive heat such as sunshine, fire or the like.
- The clock radio shall not be exposed to dripping or splashing.
- Do not place any sources of danger on the clock radio (e.g. liquid filled objects, lighted candles).
- Where the plug of the Direct Plug-in Adapter is used as the disconnect device, the disconnect device shall remain readily operable.

Risk of swallowing batteries!

- The device may contain a coin/button type battery, which can potentially be swallowed. Keep the battery out of reach of children at all times! If swallowed, the battery can cause serious injury or death. Severe internal burns can occur within two hours of ingestion.

Removing the disposable batteries

To remove the disposable batteries, see battery installation section.

3 Specifications

Rated Output Power	0.7W RMS @ 10% THD
Acoustic Frequency Response	250 Hz - 13 kHz
Speaker Driver	1 x 1.5", 8 Ω
Tuner Frequency Range	FM: 87.5 - 108 MHz
Number of Preset Stations	20
Power Supply (Power Adapter)	Brand name: PHILIPS; Model: GQ05-050050-AB;
	Input: 100-240V~, 50/60 Hz, 0.3 A Max;
	Output: DC 5 V, 500 mA;
Battery	1 x CR2032 battery for time/ alarm backup
Standby Power Consumption	<1 W
Dimensions	
- Main Unit (W x H x D)	185 x 85 x 81 mm
Weight - Main Unit	0.3 kg