

BUSH

Instruction manual

Built-Under Freezer

BUCF6082





You'll soon be enjoying your new Built-Under Freezer.

It all begins here, with your instructions. Don't worry, there's nothing too technical coming up. Just simple, step-by-step guidance to get you up and running quickly. Sound good? Then let's get started.

Help and Guidance

We're here to help you get the most from your Built-Under Freezer. Should you require any guidance, a simple solution can often be found online at:

www.argos-support.co.uk

If you still require further assistance, call one of our experts on 0345 257 7271.

If you require any technical guidance or find that your product is not operating as intended, a simple solution can often be found in the **Troubleshooting** section of these instructions,

Contents

1	Safety information	5
	General warnings	6
	Safety warnings	7
2	Getting to know your Built-Under Freezer	9
3	Installing your Built-Under Freezer	13
	Installing and Operating Your Freezer	14
	Before Using Your Freezer	14
	Shipment and Repositioning	14
	Electrical Connection (For UK type plug)	15
	Installation	16
4	Functions	25
	Thermostat settings	26
5	Using your Built-Under Freezer	27
	Arranging Food in the Appliance	28
	Tips for Saving Energy	28
	Accessories	29
6	Care and maintenance	31
	Cleaning and maintenance	32
	Technical specification	33
7	Product support	35
	Help and assistance	37
	Disposal	38
	Guarantee	39



If you require any technical guidance or find that your product is not operating as intended, a simple solution can often be found in the **Troubleshooting** section of these instructions,

Safety information

1

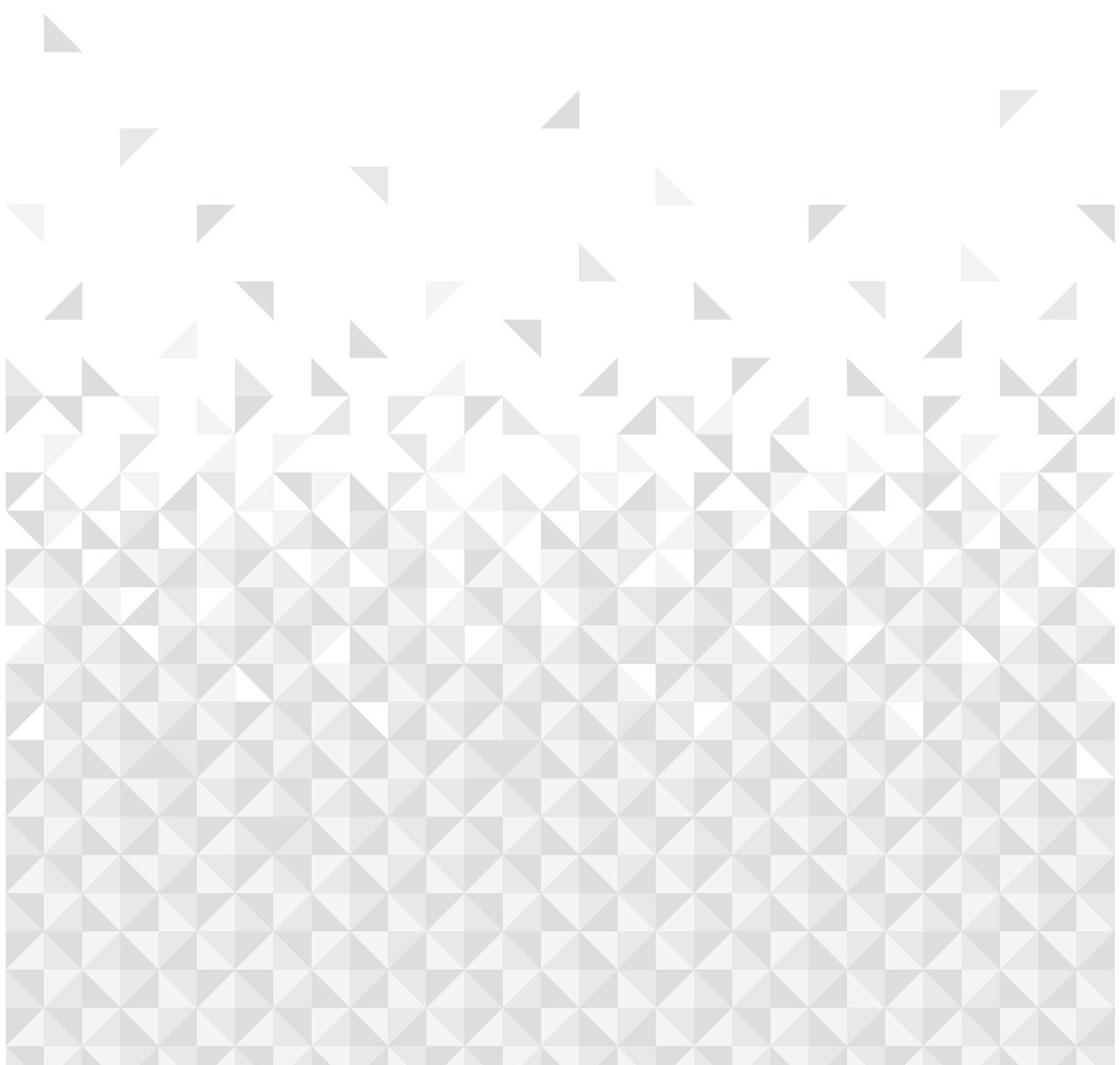



Safety information

Important - Please read these instructions fully before installing or operating

General warnings

WARNING: Keep ventilation openings, in the appliance enclosure or in the built-in structure, clear of obstruction.

WARNING: Do not use mechanical devices or other means to accelerate the defrosting process, other than those recommended by the manufacturer.

WARNING: Do not use electrical appliances inside the food storage compartments of the appliance, unless they are of the type recommended by the manufacturer.

WARNING: Do not damage the refrigerant circuit.

WARNING: To avoid a hazard due to the instability of the appliance, it must be fixed in accordance with the instructions.

- If your appliance uses R600a as a refrigerant – you can learn this information from the label on the cooler- you should be careful during shipment and installation to prevent your appliance's cooler elements from being damaged. Although R600a is an environmentally friendly and natural gas. As it is explosive, in the event of a leak due to damage to the cooler elements, move your freezer from open flame or heat sources and ventilate the room where the appliance is located for a few minutes.
 - While carrying and positioning the freezer, do not damage the cooler gas circuit.
 - Do not store explosive substances such as aerosol cans with a flammable propellant in this appliance.
 - This appliance is intended to be used in household and similar applications such as;
 - staff kitchen areas in shops, offices and other working environments
 - farm houses and by clients in hotels, motels and other residential type environments
 - bed and breakfast type environments;
 - catering and similar non-retail applications
- If the socket does not match the freezer plug, it must be replaced by the manufacturer, its service agent or similarly qualified persons in order to avoid a hazard.
 - A specially grounded plug has been connected to the power cable of your freezer. This plug should be used with a specially grounded socket of 13 amperes. If there is no such socket in your house, please have it installed by an authorized electrician.
 - This appliance can be used by children aged from 8 years and above and persons with reduced physical, sensory or mental capabilities or lack of experience and knowledge if they have been given supervision or instruction concerning use of the appliance in a safe way and understand the hazard involved. Children shall not play with the appliance. Cleaning and user maintenance, shall not be made by children without supervision.
 - If the supply cord is damaged, it must be replaced by the manufacturer, its service agent or similar qualified persons in order to avoid a hazard.



Safety information

Important - Please read these instructions fully before installing or operating

Old and out-of-order fridges and/or freezers

- If your old fridge and/or freezer has a lock, break or remove the lock before discarding it, because children may get trapped inside it and may cause an accident.
- Old fridges and freezers contain isolation material and refrigerant with CFC. Therefore, take care not to harm environment when you are discarding your old fridge and/or freezer.

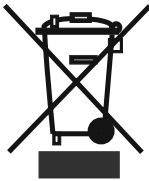

Please ask your municipal authority about the disposal of the WEEE for the reuse, recycle and recovery purposes.

Notes:

- Please read the instruction manual carefully before installing and using your appliance. We are not responsible for the damage occurred due to misuse.
- Follow all instructions on your appliance and instruction manual, and keep this manual in a safe place to resolve the problems that may occur in the future.
- This appliance is produced to be used in homes and it can only be used in domestic environments and for the specified purposes. It is not suitable for commercial or common use. Such use will cause the guarantee of the appliance to be cancelled and our company will not be responsible for the losses to be occurred.
- This appliance is produced to be used in houses and it is only suitable for cooling / storing foods. It is not suitable for commercial or common use and/or for storing substances except for food. Our company is not responsible for the losses to be occurred in the contrary case.

Safety warnings

- Do not use multiple receptacles or extension cord.
- Do not plug in damaged, torn or old plugs.
- Do not pull, bend or damage the cord.
- This appliance is designed for use by adults, do not allow children to play with the appliance or let them hang off the door.
- Do not touch the plug with wet hands as this is an electrocution risk.
- Do not place glass bottles or beverage cans in the freezer. Bottles or cans may explode.
- Do not place explosive or flammable material in your freezer for your safety. Place drinks with higher alcohol amount vertically and by closing their necks tightly in the freezer.
- When taking ice made in the freezer, do not touch it, ice may cause ice burns and/or cuts.
- Do not touch frozen goods with wet hands! Do not eat ice-cream and ice cubes immediately after you have taken them out of the freezer!
- Do not re-freeze frozen goods after they have melted. This may cause health issues like food poisoning.
- Do not put a cover over the freezer as this will affect product performance.
- Fix the accessories in the freezer during transportation to prevent damage to accessories.



If you require any technical guidance or find that your product is not operating as intended, a simple solution can often be found in the **Troubleshooting** section of these instructions,

Getting to know your Built-Under Freezer

2

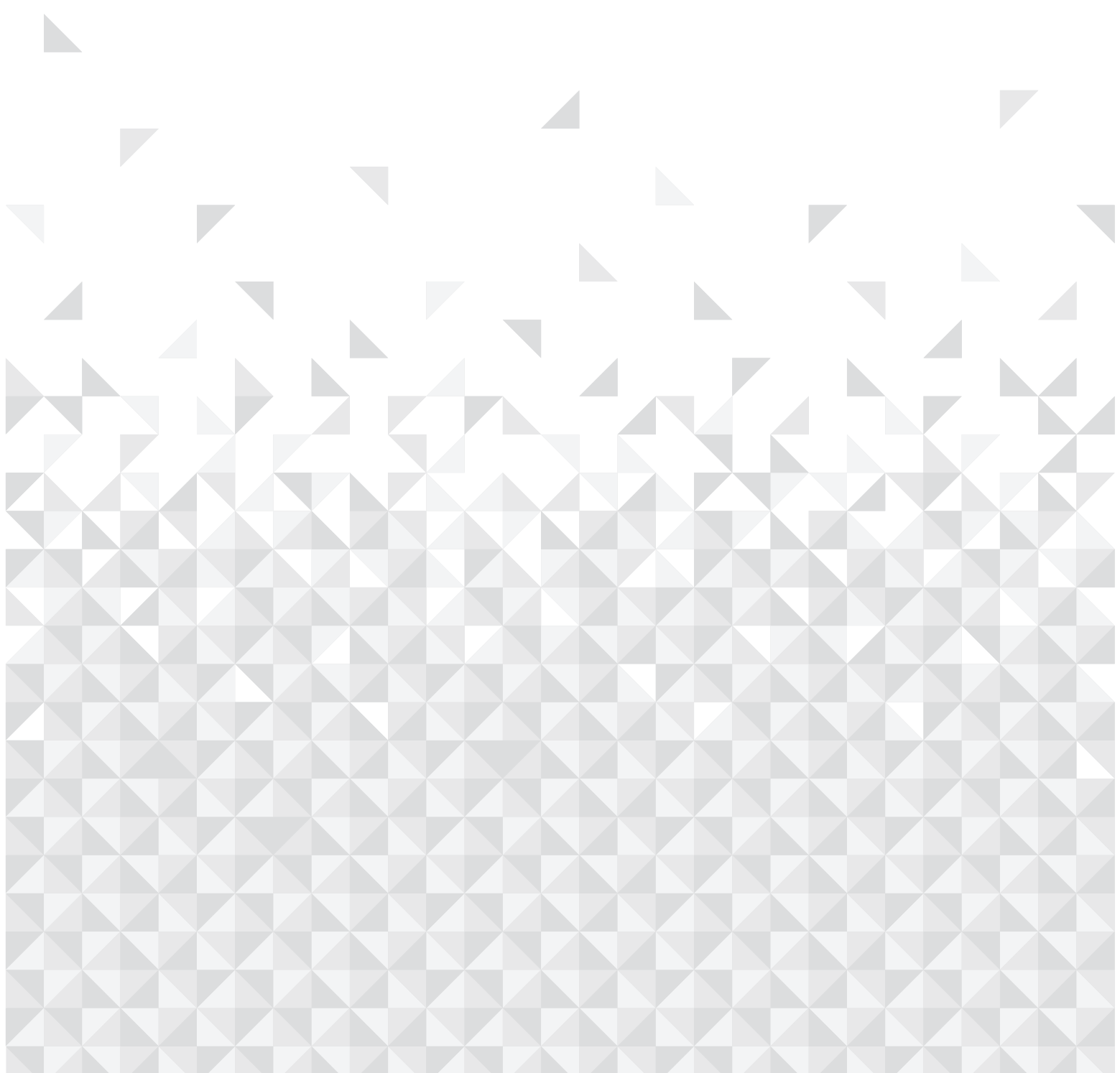

Getting to know your Built-Under Freezer

You'll be up and running in no time

Ready? Let's begin...

Please read these instructions carefully. They contain important information which will help you get the best from your Built-Under Freezer and ensure safe

and correct installation and operation.

If you require any further assistance, our technical experts are happy to help. For full details, refer to the product support section at the end of these instructions.

Getting to know your Built-Under Freezer

You'll be up and running in no time

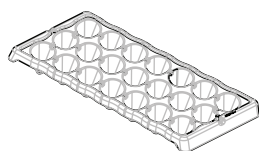

3

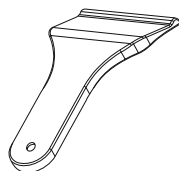

4

- 1. Freezer drawers x 3
- 2. Thermostat dial
- 3. Ice tray x 1
- 4. Plastic ice blade x 1



If you require any technical guidance or find that your product is not operating as intended, a simple solution can often be found in the **Troubleshooting** section of these instructions,

Installing your Built-Under Freezer

3

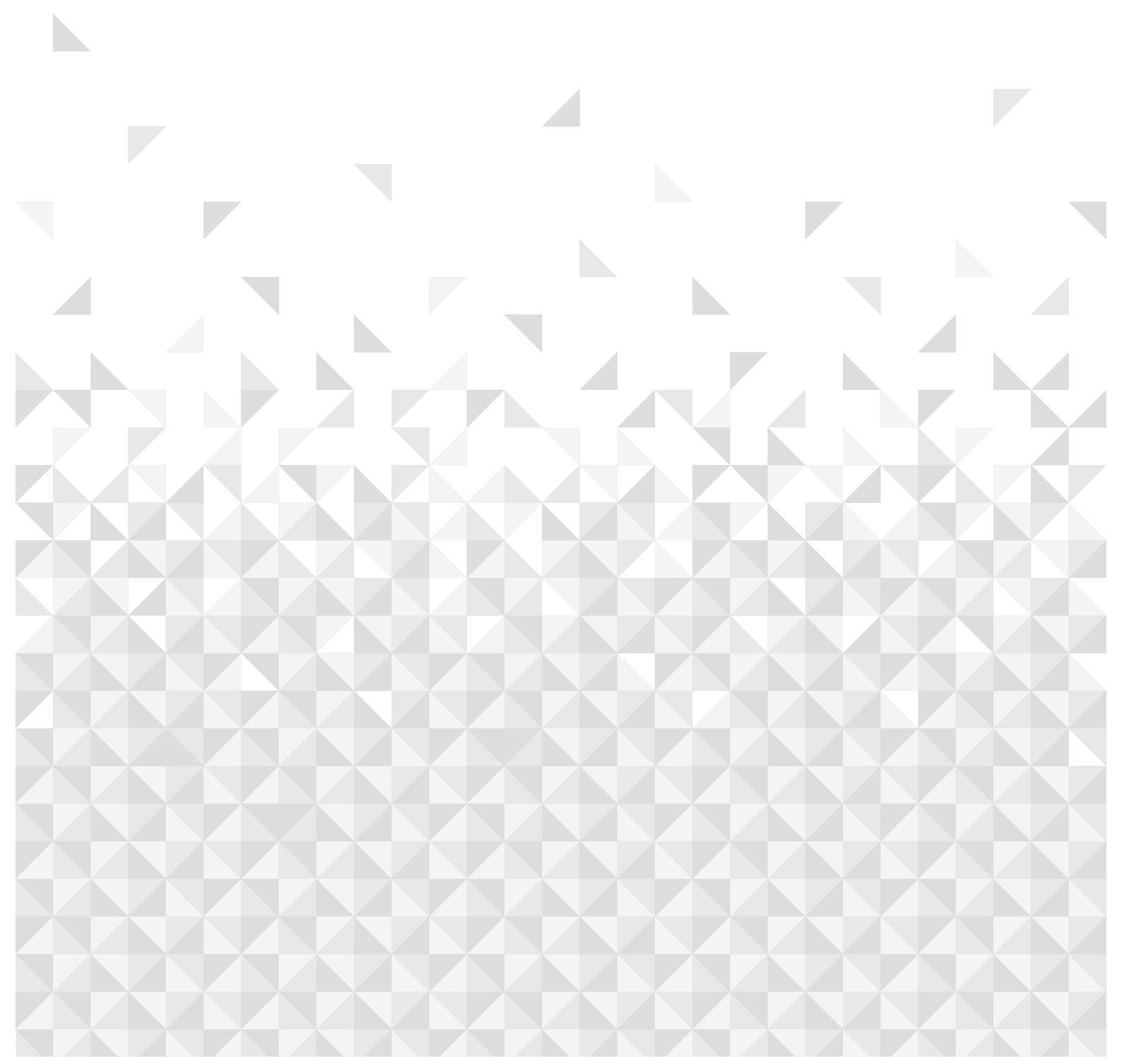

Installing your Built-Under Freezer

Bringing it all together

Installing and Operating Your Freezer

Before starting to use your freezer, you should pay attention to the following points:

- Operating voltage for your freezer is 220-240 V at 50Hz.
- We cannot be responsible for any damages that occur to this product if used incorrectly.
- Do not place your appliance in direct sunlight.
- Your appliance should be at least 50 cm away from stoves, gas ovens and heater cores, and should be at least 5 cm away from electrical ovens.
- Your freezer should never be used outdoors or exposed to rain.
- When your freezer is placed next to a deep freezer, there should be at least 2 cm between them to prevent humidity on the outer surface.
- When installing the freezer, chose a suitable place and ensure that there is a least a 15cm gap between the top of the freezer and the counter. Please do not place anything on top of the freezer.
- The adjustable front legs should be stabilized in an appropriate height to allow your freezer to operate in a stable and proper way. You can adjust the legs by turning them clockwise (or in the opposite direction). This should be done before placing food in the freezer.
- Before using your freezer, wipe all parts with warm water added with a tea spoonful of sodium bicarbonate, and then rinse with clean water and dry. Place all parts after cleaning.
- Install the distance adjustment plastic (the part with black vanes at the rear) by turning it 90° as shown in the figure to prevent the condenser from touching the wall.
- Freezer should be placed against a wall with a free distance not exceeding 75 mm.

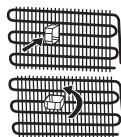

Before Using Your Freezer

- Before switching on your appliance for the first time, ensure it is positioned in its desired final location and is in its upright position for at least 3 hours before plugging in and switching on the power. Otherwise you may damage the compressor.
- You may experience an odour from the appliance when it is operated for the first time. This is normal and will fade when your appliance starts to cool.

Shipment and Repositioning

- Original package and foam may be kept for retransportation (optionally).
- You should fasten your freezer with thick package bands or strong cords and follow the instructions for transportation on the package for retransportation.
- Remove movable parts (shelves, accessories, vegetable bins etc.) or fix them into the freezer against shocks using bands during repositioning and transportation.

Carry your freezer in the upright position.

Installing your Built-Under Freezer

Bringing it all together

Electrical Connection (For UK type plug)

For your safety please read the following information

Warning: This appliance must be earthed.

This appliance operates from 220-240 volts and should be protected by a 13 amp fuse in the plug.

The appliance is supplied with a standard 13 amp 3-pin mains plug fitted with a 13-amp fuse.

Should the fuse require replacement, it must be replaced with a fuse rated at 13 amp and approved to BS1362.

If the mains plug which is fitted is unsuitable for the socket outlet in your home or is removed for any other reason, please follow the instructions below on how to wire a 13 amp 3 pin plug.

The wires in the mains lead on this appliance are coloured in accordance with the following code:

Green and Yellow – Earth

Blue – Neutral

Brown – Live

As the colours may not correspond with the markings identifying the terminals in your plug proceed as follows.

The green and yellow wire must be connected to the terminal in the plug which is marked with the letter E or with the earth symbol or coloured green and yellow.

The blue wire must be connected to the terminal marked N.

The brown wire must be connected to the terminal marked L.

You must make sure the lead is firmly secured under the cord clamp.

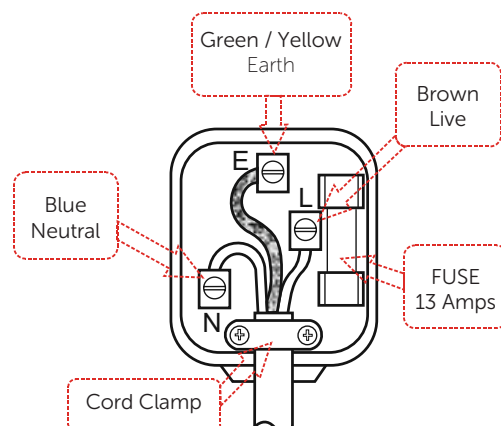

Installing your Built-Under Freezer

Bringing it all together

Installation

Installation kit contents

A. Wood screw x17

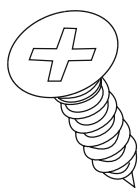

B. Door hang

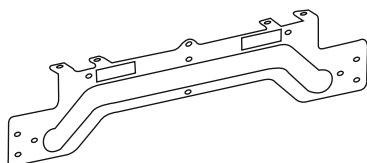

C. Door Bottom Fixings x2

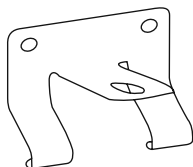

D. Hang cover

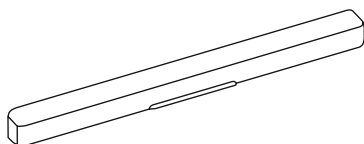

E. Screw

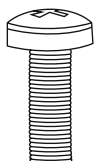

F. Top bracket

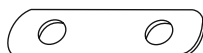

Tools required

Spirit level

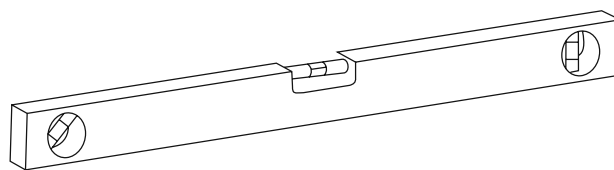

Setsquare

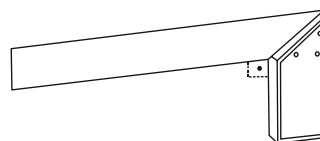

Wrench

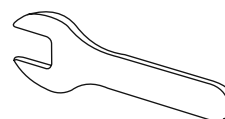

Screwdriver

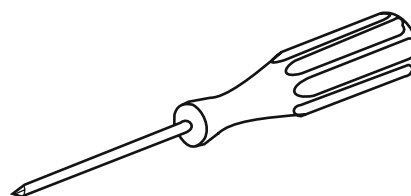

Installing your Built-Under Freezer

Bringing it all together

Dimensions for installation

Caution: 2 people are required to unpack and handle the freezer. It is recommended that gloves are worn.

- a: Carefully remove all packaging materials and dispose of correctly.
- b: Make sure that the space available for the freezer is large enough as per the dimensions (1).

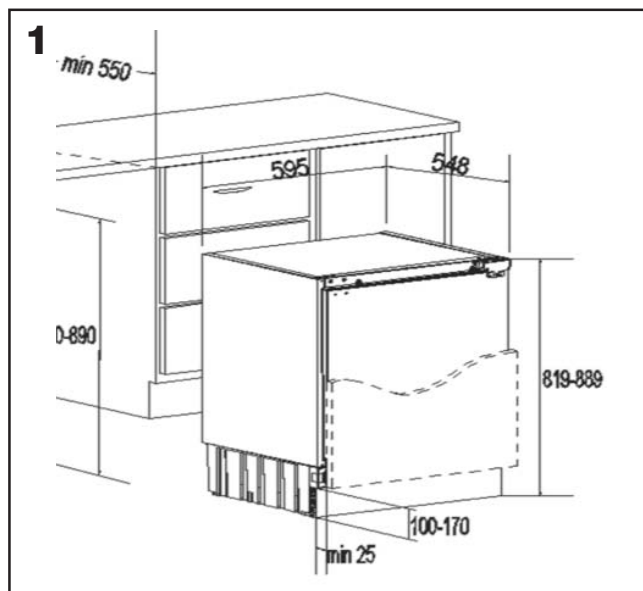

Installing top bracket

- a: Remove the screw (E) on top of the freezer, place the top bracket (F) in position and fix with the screw (E).

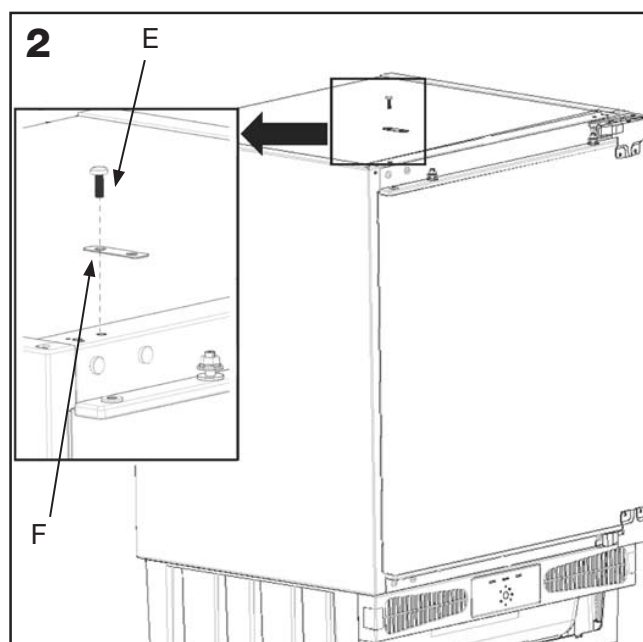

Installing your Built-Under Freezer

Bringing it all together

Fitting the door gasket

- a: Take out the gasket (G) located on the side panel, and remove the protective tape.
- b: Stick the gasket (G) on the freezer side panel, on the opposite side to the door hinges, as shown (3).

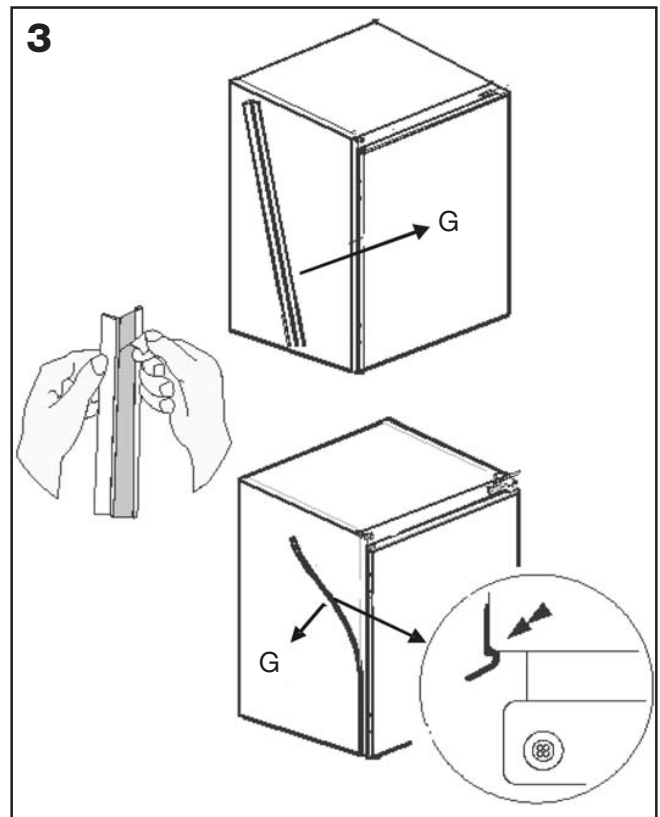

Height adjustment

- a: If necessary, the height of the freezer can be adjusted, by loosening the locking nuts on the adjustable feet and screwing the feet in or out to the desired height. A wrench may be required to undo the locking nuts.
- b: When the desired height is reached, re-tighten the locking nuts using the wrench to lock the adjustable feet in position.

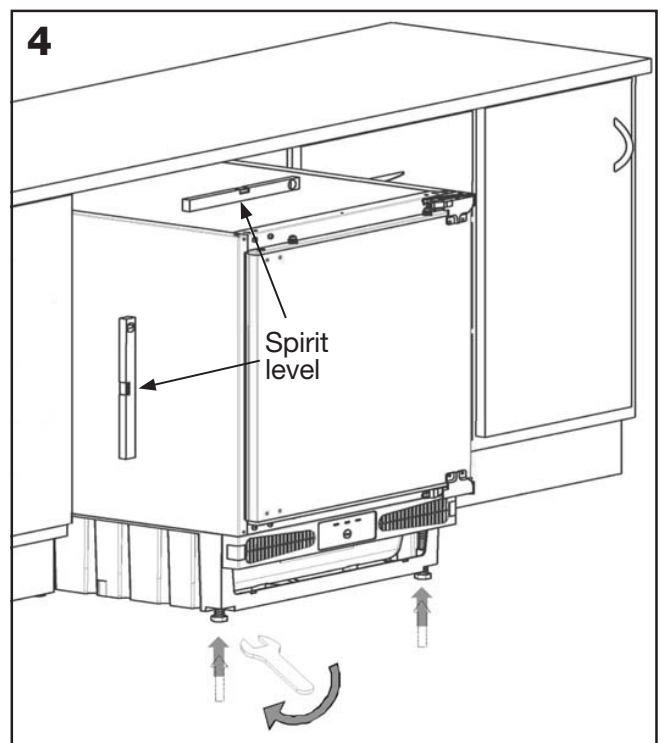

If you require any technical guidance or find that your product is not operating as intended, a simple solution can often be found in the Troubleshooting section of these instructions,

Installing your Built-Under Freezer

Bringing it all together

Position the freezer

Caution: The freezer may require 2 people to handle it when pushing it into position.

- a: Check behind the freezer to make sure there are no tools or obstructions that may cause damage.
- b: Carefully slide the freezer into position until the hinge surface is aligned with the front surface of the kitchen unit.
- c: Check that the freezer is square using the setsquare.

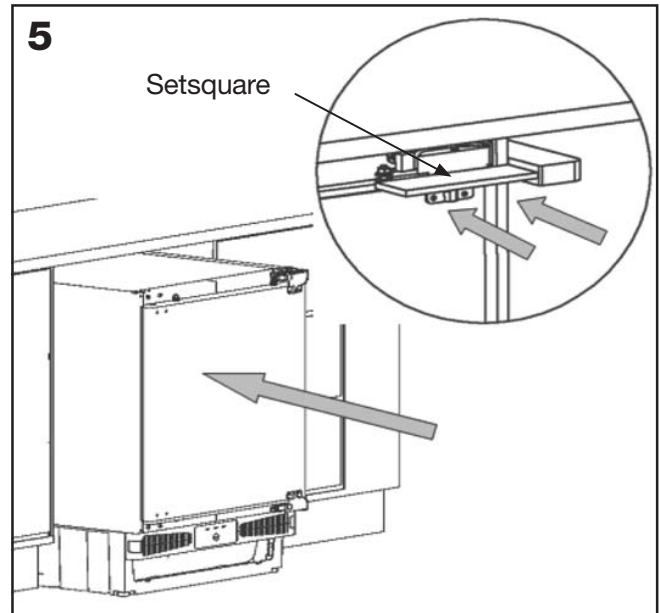

Securing the freezer

- a: Secure the freezer to the kitchen units using screws (A), through the top bracket (F) and through both the upper and lower door hinges as shown (6).

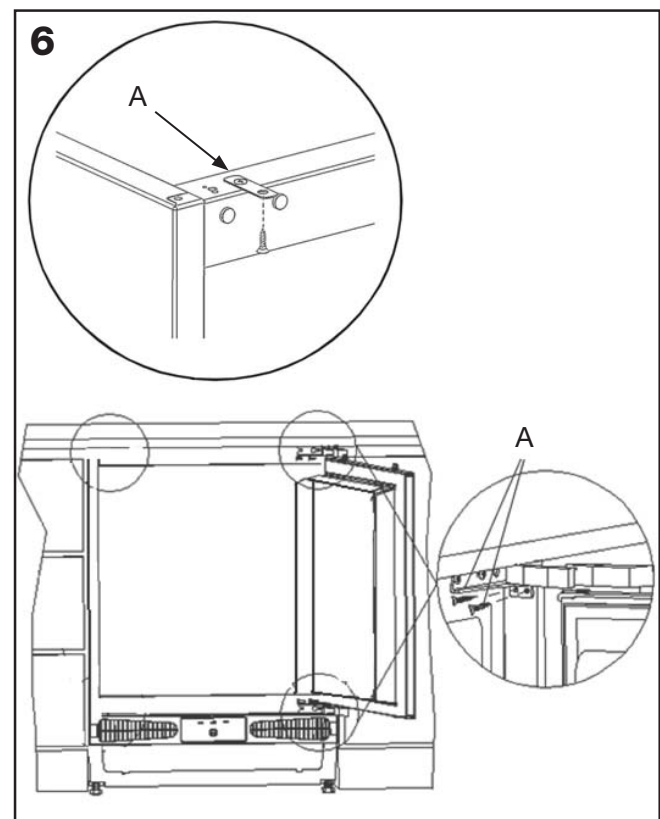

Installing your Built-Under Freezer

Bringing it all together

Fitting the cabinet door

- a: Unscrew and remove the nuts and washers from the appliance door.
- b: Place door hang on the appliance door by inserting the holes to adjustment bolts.
- c: Dimension B= Measure from the underside surface of kitchen unit to the bottom of door hang. Dimension C= Measure from the underside surface of kitchen unit to the top of next unit door.
- d: Subtract C from B and place door hang (B) using this dimension for vertical position and place to the centre for horizontal position.
- e: Screw the door hang (B) using screws (A).
- f: Place the cabinet door onto the appliance door by inserting adjustment bolts into the slots on the door hang.
- g: Place the washers and screw the nuts onto the adjustment bolts.

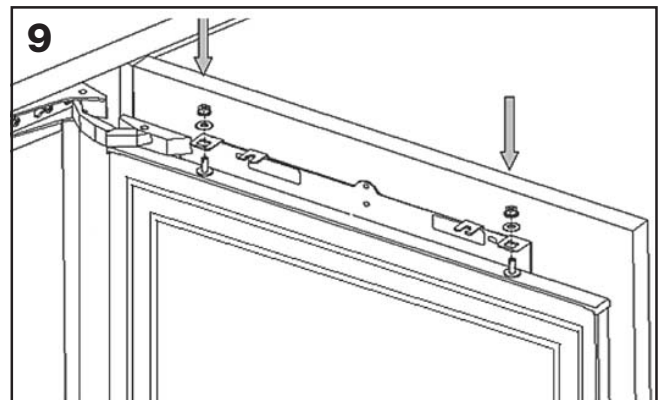
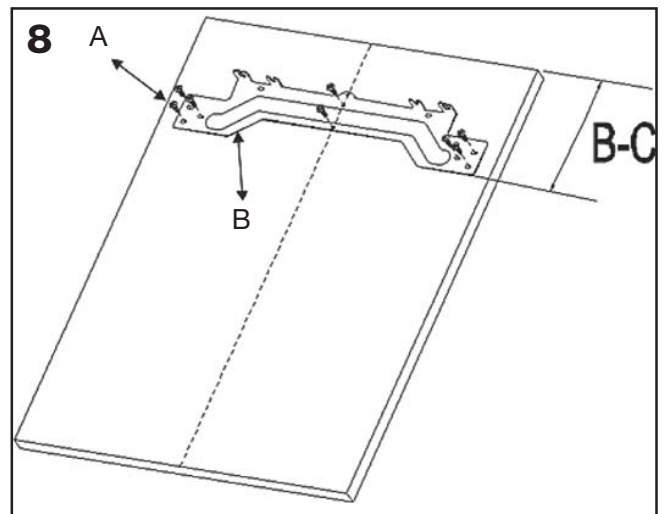
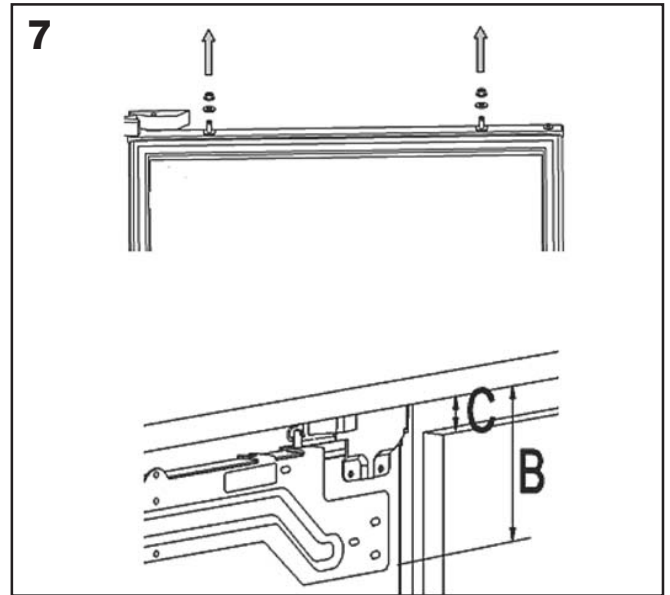

Continued on next page

If you require any technical guidance or find that your product is not operating as intended, a simple solution can often be found in the Troubleshooting section of these instructions,

Installing your Built-Under Freezer

Bringing it all together

h: Close the door and check the alignment with the other cabinet doors.

i: Make the adjustment of the unit door by screwing or unscrewing the adjustment bolts for vertical adjustment and by the help of the slots on the door hang for other directions.

j: Tighten the nuts to fix the bracket.

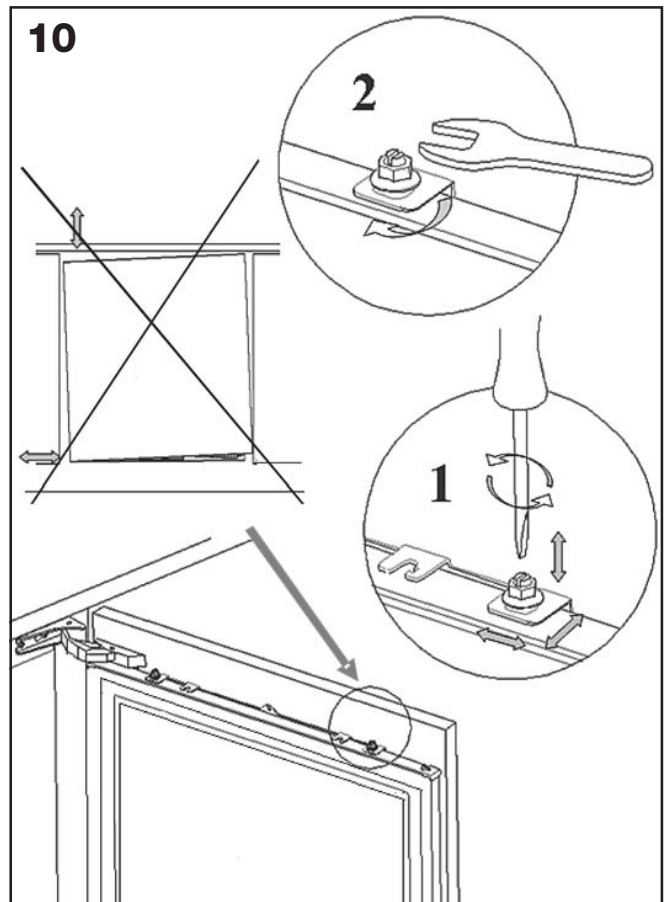

k: Remove the screws at the bottom of the appliance door.

l: Place the door bottom fixings (C) and screw the fixings to the appliance door and the cabinet door using screws (A).

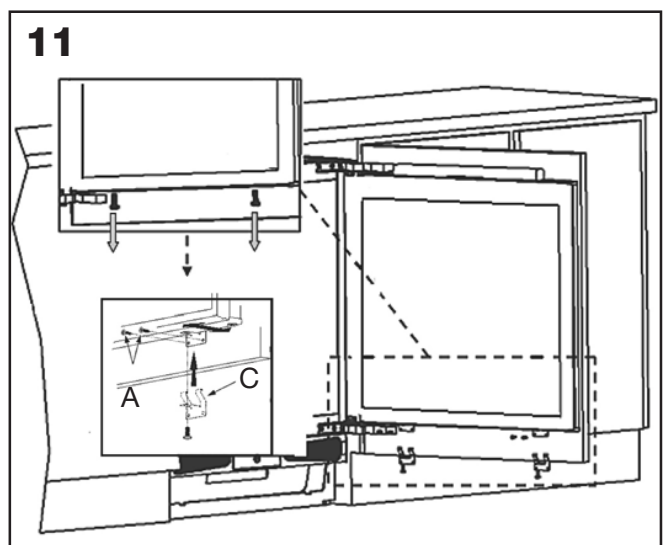

Continued on next page

Installing your Built-Under Freezer

Bringing it all together

m: Slide the hang cover (D) onto the door hang (B).

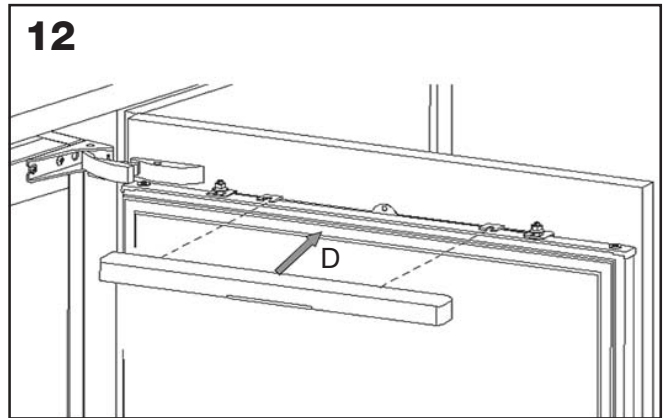

Installing the plinth

a: Position the plinth providing minimum 25 mm gap between the cabinet door and fix it.

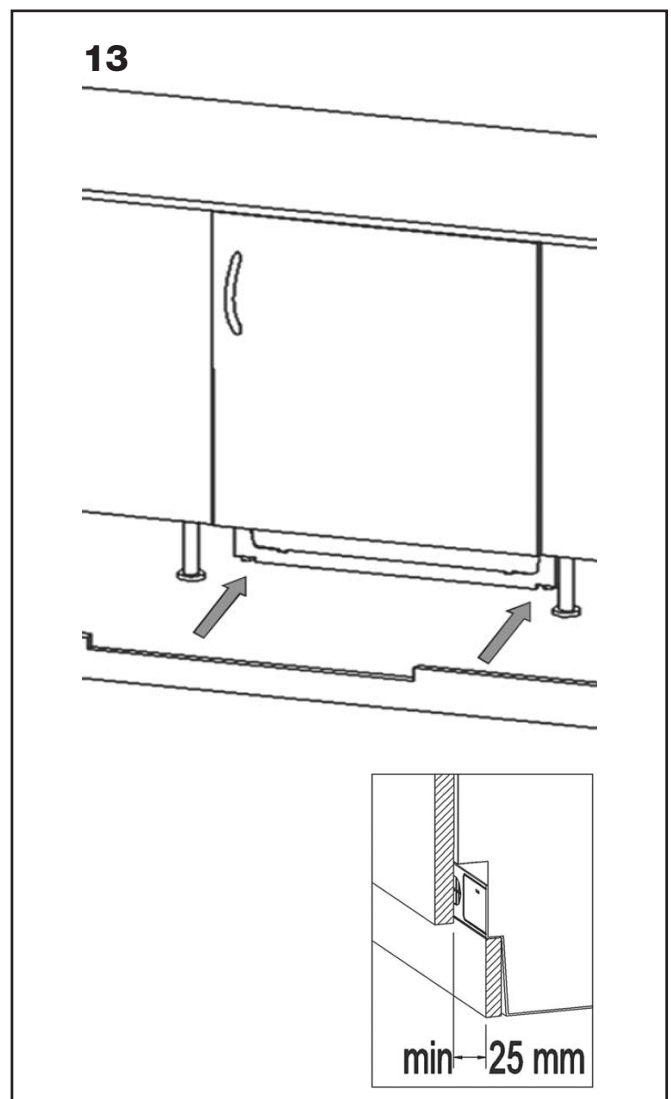

If you require any technical guidance or find that your product is not operating as intended, a simple solution can often be found in the Troubleshooting section of these instructions,

Installing your Built-Under Freezer

Bringing it all together

Reversing the door

- a: Unscrew the screws on the front surface of the appliance door. Take the appliance door to a safe place.
- b: Move the hole plugs on the appliance door's front surface, to the holes on the reverse side.
- c: Open the door upper hinge and door lower hinge, disassemble them.
- d: Move the hole plugs to opposite side.
- e: Assemble the door upper hinge and door lower hinge to the opposite corners of their original position.
- f: Assemble the appliance door.

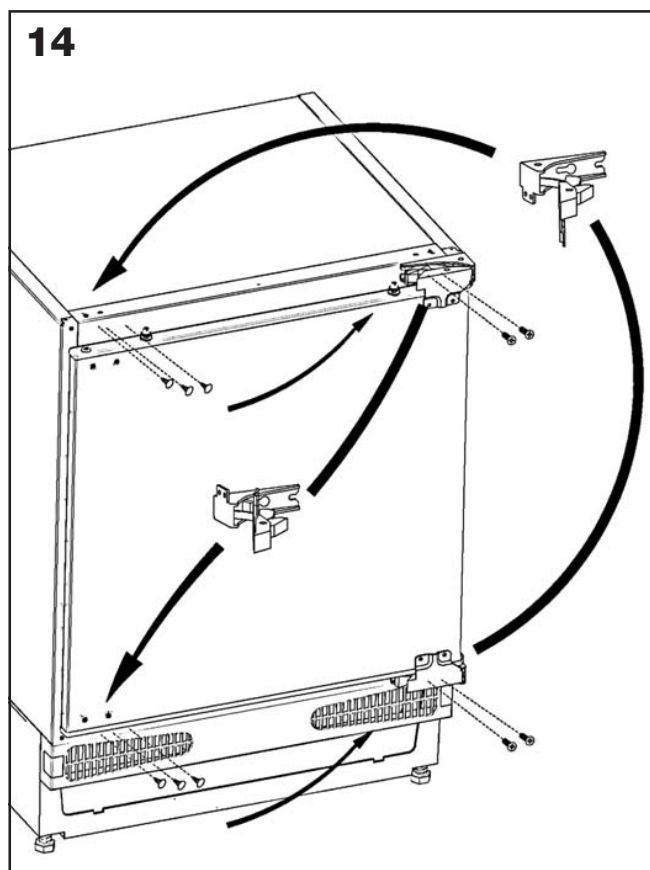



If you require any technical guidance or find that your product is not operating as intended, a simple solution can often be found in the **Troubleshooting** section of these instructions,

Functions 4

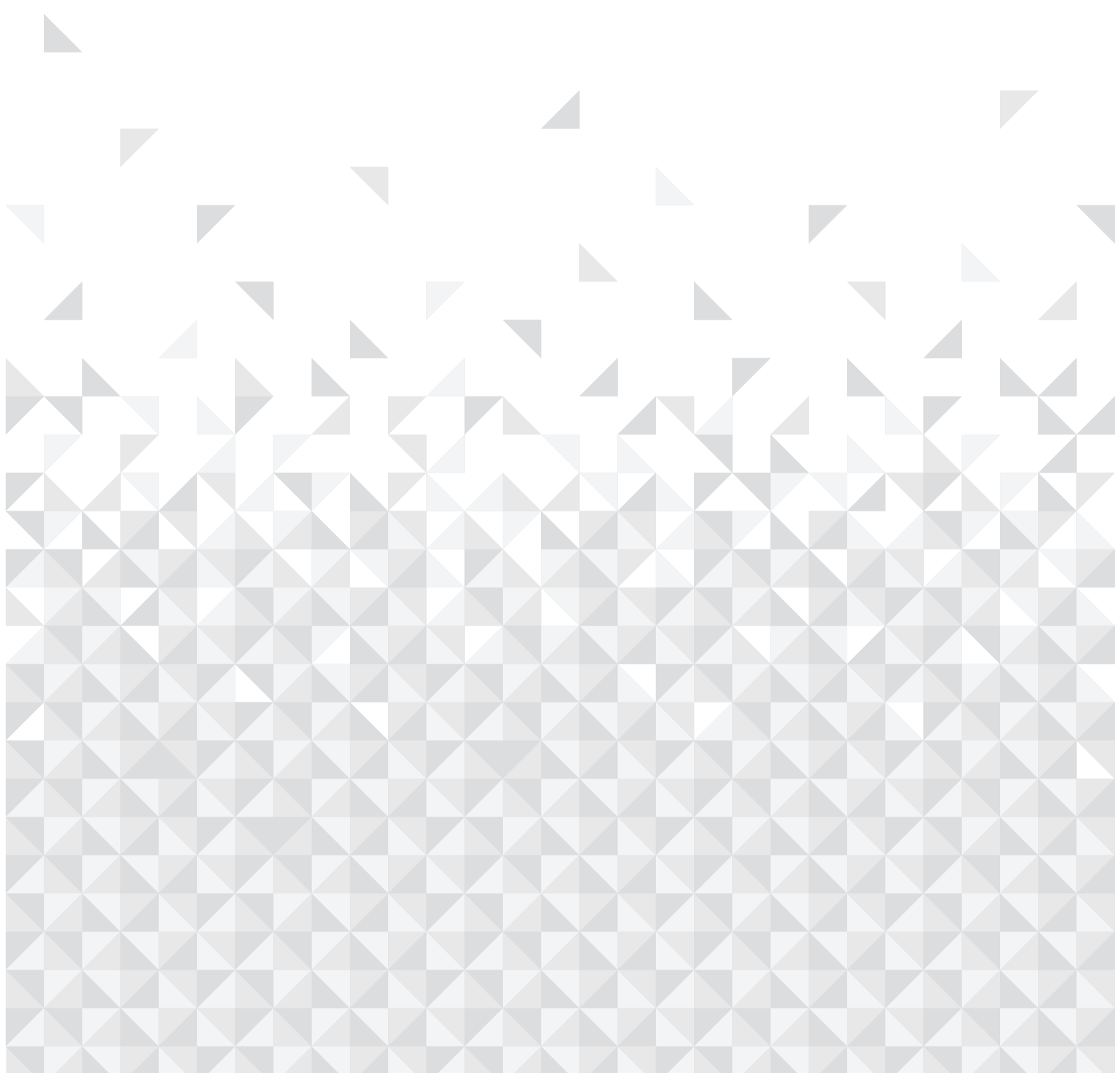

Functions

Simple everyday use

Thermostat settings

- Before switching on, place the appliance in an upright position and wait at least three hours without moving the appliance. This will give the freezing circuit time to settle and operate efficiently.
- Clean the appliance thoroughly, especially the interior, before use (see Cleaning and Maintenance).

Warning: Installation of the appliance and electrical connections must be carried out by a qualified technician in accordance with the installation manual and local regulations.

- The procedure for installation the appliance into the kitchen unit is given in the installation section of this information booklet. This product is only intended to be used in proper kitchen units.
- The appliance must be connected with a properly installed fused socket. Power supply (AC) and voltage at the operating point must comply with the details on the name plate of the appliance (the name plate is located on the inside-left of the appliance).
- Insert the plug into a socket with an efficient ground connection. If the socket has no ground contact or the plug does not match, we suggest you to call an authorised electrician for assistance.
- The manufacturer is not responsible for failure to complete the ground connection as described in this booklet.
- There can be an odour when you first switch.
- The freezer thermostat automatically regulates the inside temperature of the compartments. By rotating the knob from positions 1 to 5, colder temperatures can be obtained. The "•" position shows the thermostat is closed and no cooling will be available.

Freezer Thermostat Setting;

- : The appliance is switched off.
- 1-2: For short-term storage of food in the freezer compartment, set the knob between the minimum and medium position.
- 3-4: For long-term storage of food in the freezer compartment, set knob to the medium position.
- 5: For freezing fresh food. The appliance will run for colder temperatures.

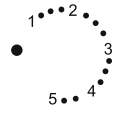

If your freezer is not cold enough

- Temperature adjustments should be made according to the frequency of door openings and the quantity of food kept inside the freezer.
- Your freezer should be operated up to 24 hours according to the ambient temperature without interruption after being plugged in to be completely cooled. Do not open door of your freezer frequently and do not place much food inside it in this period.
- During power cut, to prevent any compressor problem you should unplug the freezer. You should delay plugging in 5 – 10 minutes after your power supply returns. Of you plug out the freezer for a reason you should wait at least 5 min to replug. It is important for avoiding damage to freezer's components.
- Your freezer is designed to operate in the ambient temperature intervals according to the climate class stated on the information label. In terms of cooling effectiveness, we do not recommend operating your freezer outside of the stated temperature values.
- This equipment is designed for use at an ambient temperature within the 10°C - 32°C range.

Climate Class	Ambient Temperature °C
T	Between 16 and 43 (°C)
ST	Between 16 and 38 (°C)
N	Between 16 and 32 (°C)
SN	Between 10 and 32 (°C)

Using your Built-Under Freezer

5

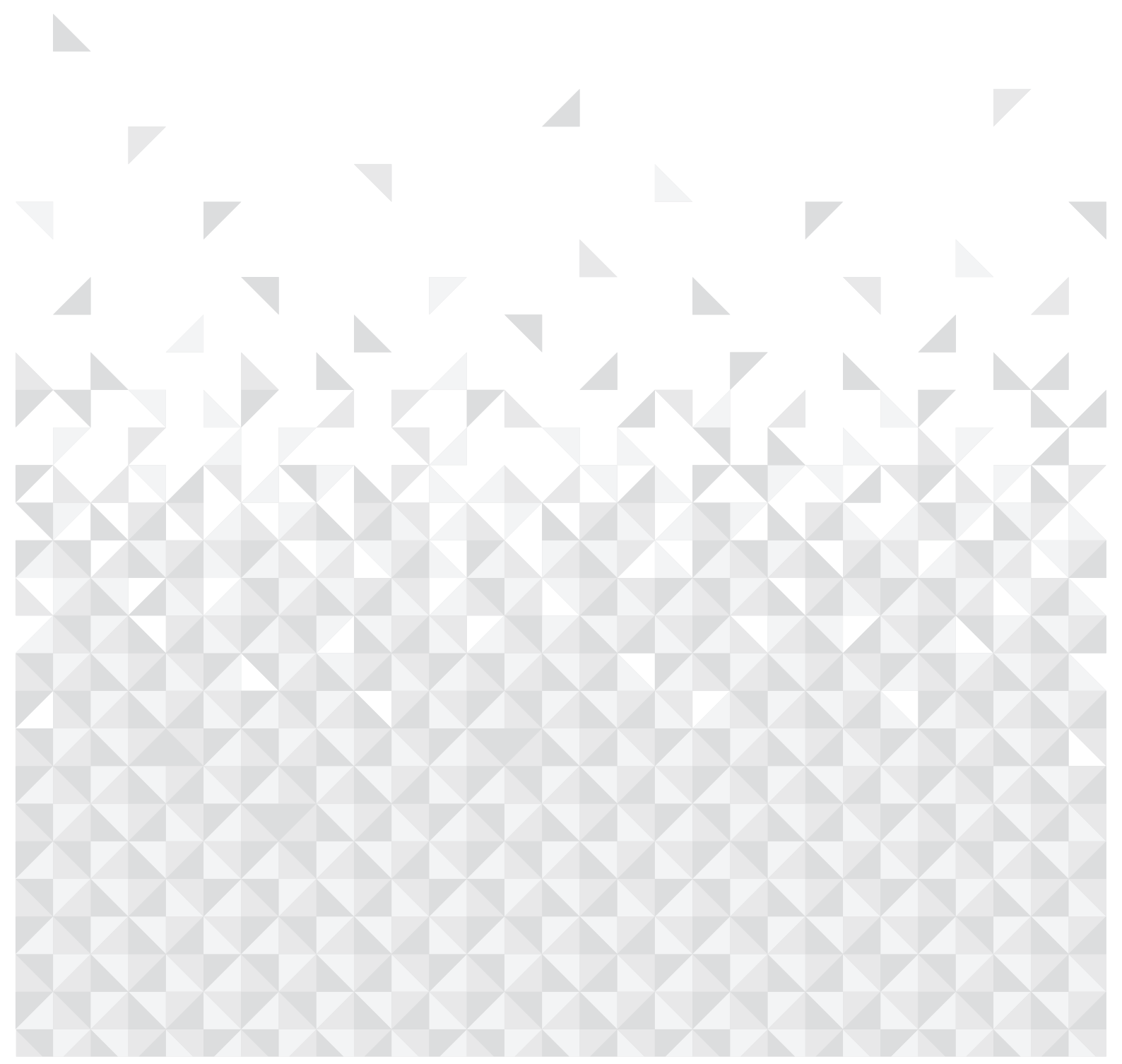

Using your Built-Under Freezer

Getting the most from your appliance

Arranging Food in the Appliance

The freezer is used for freezing fresh foods and for storing frozen foods for the period of time indicated on the packaging, and for making ice cubes.

- For freezing fresh food; wrap and seal fresh food properly - the packaging should be airtight and should not leak. Special freezer bags, aluminium foil (heavy grade; if in doubt doublewrap), polythene bags, and plastic containers are ideal.
- While freezing food, the maximum amount of fresh food (in kg) that can be frozen in 24 hours is indicated on the appliance label.
- For optimum appliance performance in maximum freezing capacity, turn knob to the "5" position when placing fresh food in the freezer.
- After placing fresh food in the freezer, the 24 hours setting on the "5" position is generally sufficient. After 24 hours, reset the thermostat to the desired position (Recommendation).

Note that; if you want to open again immediately after closing the freezer door, it will not be opened easily. It's quite normal! After reaching equilibrium condition, the door will be opened easily.

- **Attention:** in order to save energy, when freezing small amounts of food the fast freeze function can be deactivated.
- **Do not** allow fresh food to be frozen to come into contact with already frozen food.
- Always mark the date and the content on the pack and do not exceed the stated storage time.
- In case of a power failure or malfunction, the freezer compartment will maintain a sufficiently low temperature for food storage. However, avoid opening the freezer door in order to slow down the temperature rise within the freezer compartment.
- The maximum amount of fresh foods that can be loaded in the freezer within 24 hours is indicated on the name plate (see Freezing Capacity).

- Never place warm food in the freezer compartment.
- When purchasing and storing frozen food products, ensure that the packaging is not damaged.
- Storage time and recommended temperature for storing frozen food is indicated on the packaging. For storing and usage, follow the manufacturer's instructions. If no information is provided, food should not be stored for more than 3 months.
- Following purchase, place frozen food in the freezer compartment as soon as possible.
- Once food is thawed it must not be refrozen; you must cook it as quickly as possible for consumption or freeze once again.
- When making ice cubes, fill the ice tray with water and place in the freezer compartment. After the water has completely turned into ice, twist the tray to get the ice cubes out.

Storage: if you want to use the freezer's maximum net capacity, remove the drawers and store the items directly on the cooling tubes. This will enable you to make use of the entire volume of the compartment.

Tips for Saving Energy

1. Install the appliance in a cool, well ventilated room, but not in direct sunlight or near heat sources (radiators, cooker, etc....).
2. Allow warm food and drinks to cool down before placing in the appliance.
3. When placing food in the appliance they must be covered.
4. When placing food, open the appliance door as briefly as possible.
5. Keep closed the covers of any different temperature compartments in the appliance (baskets... etc).
6. Door seals should be kept clean and undamaged.

If you require any technical guidance or find that your product is not operating as intended, a simple solution can often be found in the **Troubleshooting** section of these instructions,

Using your Built-Under Freezer

Getting the most from your appliance

Accessories

Ice tray

- Fill the ice tray with water and place in freezer compartment.
- After the water has completely frozen, you can twist the tray as shown below to get the ice cubes.



Plastic scraper

After a period of time, frost will build up in certain areas in the freezer compartment. The frost, accumulated in the freezer, should be removed periodically. Use the plastic scraper provided if necessary. Do not use sharp metal objects for this operation. They could puncture the refrigerator circuit and cause irreparable damage to the unit.

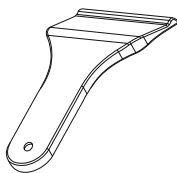



If you require any technical guidance or find that your product is not operating as intended, a simple solution can often be found in the **Troubleshooting** section of these instructions,

Care and maintenance

6

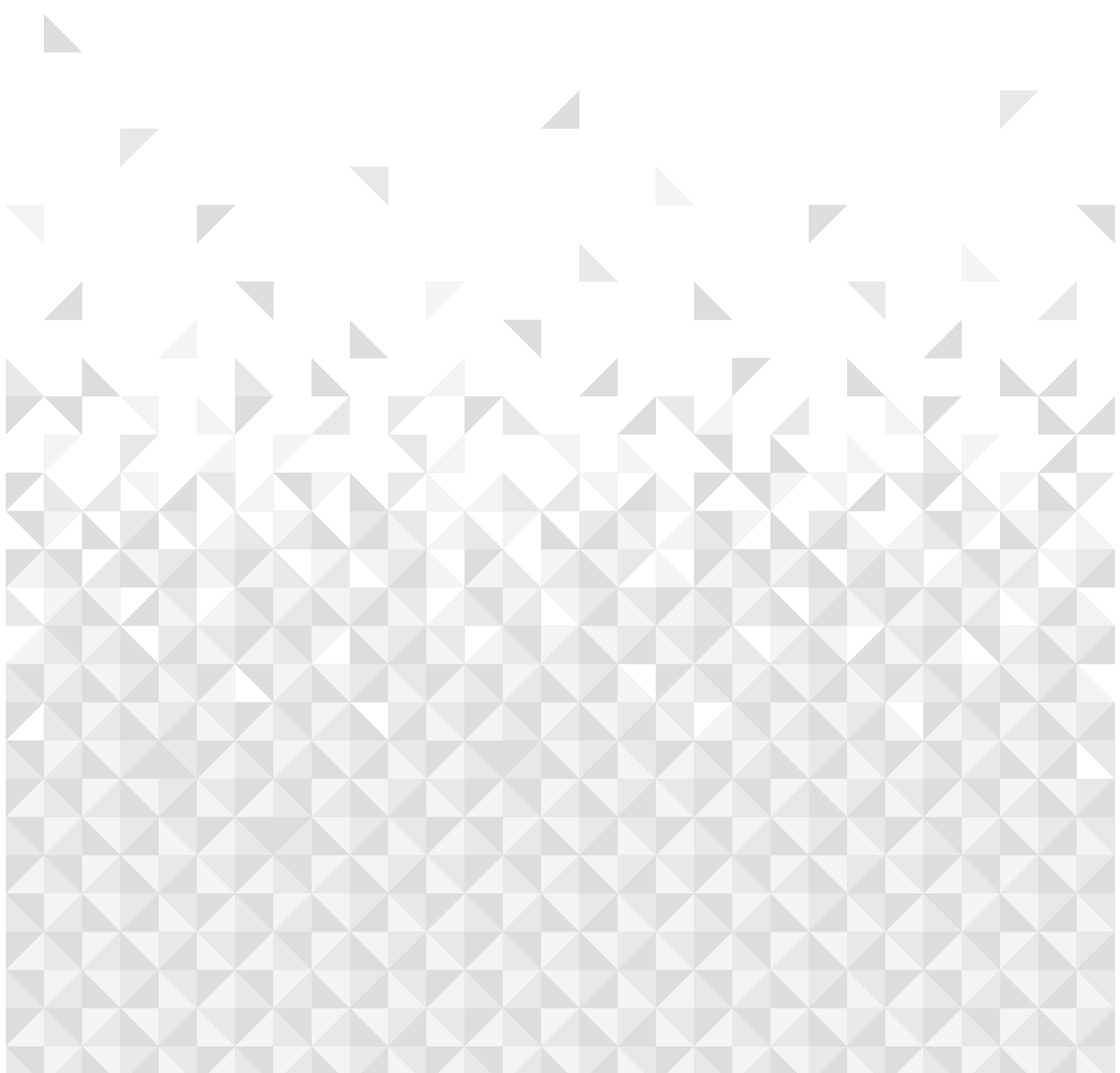

Care and maintenance

Looking after your appliance

Cleaning and maintenance

General

- Do not pour water over the appliance.
- Clean the accessories separately with soap and water. Do not put them in the dishwasher.
- Do not use abrasive products, detergents or soaps. After washing, rinse with clean water and dry carefully. When the cleaning operations have been completed, reconnect the plug with dry hands.
- **Warning:** never use sharp metal tools for this operation unless recommended by the manufacturer, as they can damage the freezing circuit.
- Clean the interior by hand with lukewarm water and a little detergent. Never use abrasive products or aggressive cleaning agents.
- Dry the inside of the unit, plug it into the mains, and set the thermostat knob to position "5". After 24 hours, reset the thermostat to the desired position.

General Defrosting the freezer

- After a period of time, frost will build up in certain areas in the freezer. The frost, accumulated in the freezer, should be removed periodically using the ice scraper (if available).
- To maintain the efficiency of the freezer, complete defrosting will become necessary if the frost layer exceeds 3-5mm.
- The day before you defrost, set the thermostat dial to position "5" to freeze the foods completely.
- During defrosting, frozen foods should be wrapped in several layers of paper and kept in a cool place. The inevitable rise in temperature will shorten their storage life. Remember to use these foods within a relatively short period of time.
- Set the thermostat knob to position "•" and switch off the appliance.
- Leave the door open to accelerate defrosting. Remove the defrosted water from the compartment.
- If there is defrosted water on the freezer floor, you can clear it away by using a sponge.

Care and maintenance

Looking after your appliance

Technical specification

Supplier's name or trademark	BUSH
Model / Item	BUCF6082
Type of appliance	BGSN1650DOD
Energy efficiency class	A+
Voltage	220-240V / 50 Hz
Energy consumption	0.484 kWh/24h - 177 kWh/year
Net storage volume of fresh food	-
Net storage volume of frozen food	93 lt.
Star rating of frozen food storage compartment	4 (****)
Power cut failure safe storage	18 hours (25°C)
Freezing capacity	9 Kg
Climate class	SN (10°C - 32°C)
Size (mm) (W x D x H)	595 x 548 x 818
Noise	44 dB (A)

We apologise for any inconvenience caused by minor change or inconsistencies in these instructions that may occur as a result of product improvements and development.





If you require any technical guidance or find that your product is not operating as intended, a simple solution can often be found in the **Troubleshooting** section of these instructions,

Product support

7

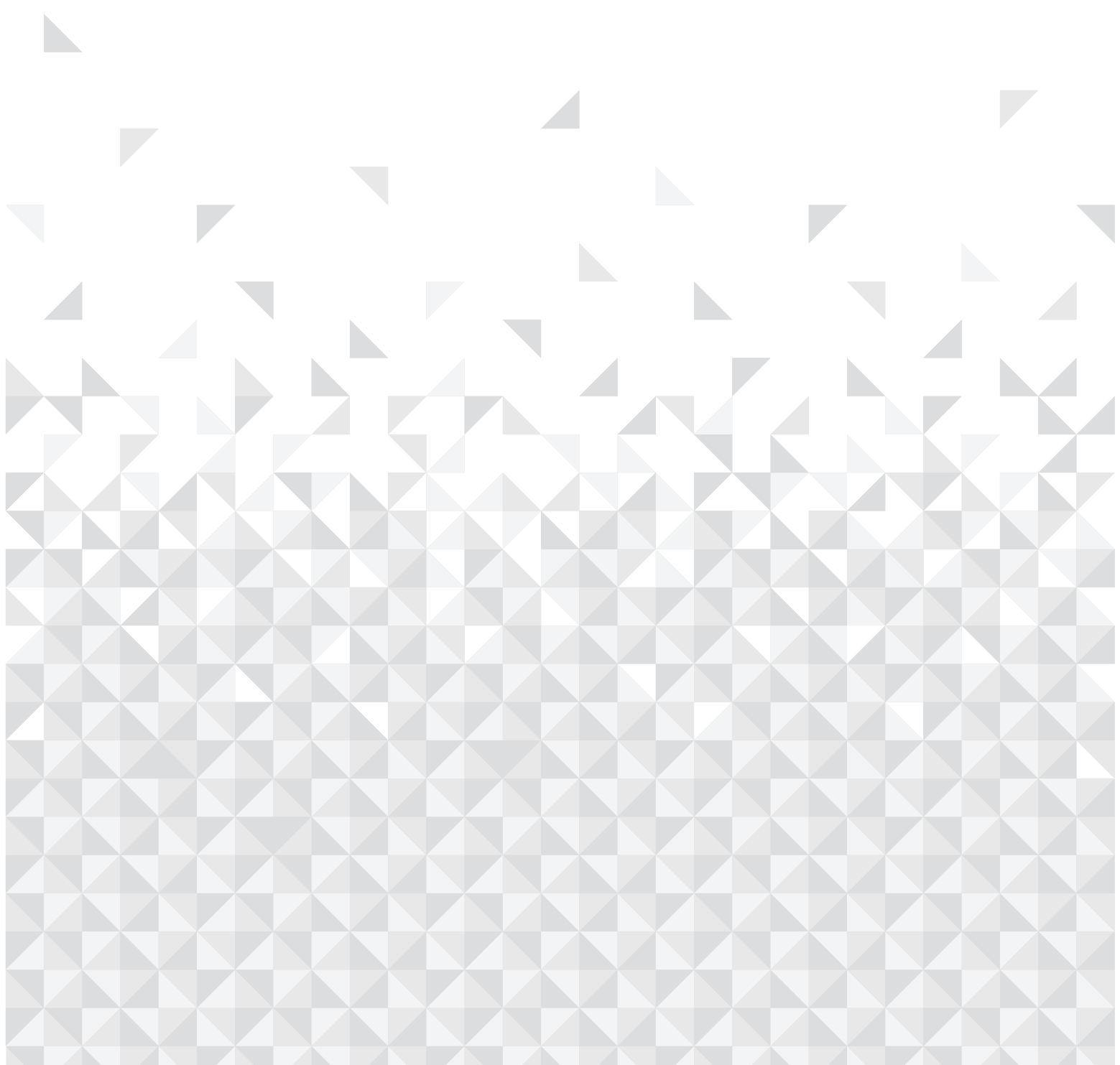

Product support

Help is always at hand

If your freezer is not working properly there may be a minor problem, therefore check the following

Problem	Possible Causes	Possible Solutions
The appliance does not operate	There is a power failure The mains plug is not properly plugged in, or is loose The thermostat setting is on position "•"	The socket is defective. To check this, plug in a fully operable appliance into the same socket
The appliance performs poorly	You have overloaded the appliance The doors are not closed perfectly	There is not sufficient ventilation around the appliance
There is a noise	The cooling gas which circulates in the freezer circuit may make a slight noise (bubbling sound) even when the compressor is not running. Do not worry, this is quite normal. If these sounds are different check if; <ul style="list-style-type: none">• The appliance is installed firmly as described in the section of this instruction manual• Objects on the appliance are vibrating	

Important notes:

- During power cut, to prevent any compressor problem you should unplug the freezer. You should delay plugging in 5 – 10 minutes after your power supply returns. If you plug out the freezer for a reason you should wait at least 5 min to replug. It is important for avoiding damage to freezer's components.
- If you will not be using your freezer for a long time (holiday, etc...), disconnect the plug from the socket. Clean your freezer as per chapter 6 of this document and leave the door open to prevent any humidification or odour formation.

Product support

Help is always at hand

Help and assistance

If you require any technical guidance or find that your Built-Under Freezer is not operating as intended, a simple solution can often be found in the **Troubleshooting** section of these instructions or online at www.argos-support.co.uk

If you still require further assistance, call one of our experts on **0345 257 7271***. To help give us give you a fast and efficient service please have the following information ready:

Model Ref.	<input type="text"/>	You can find these on the rating plate - a small information panel (usually a sticker or metal plate) on the rear of your appliance
Serial number	<input type="text"/>	
Date of purchase	<input type="text"/>	This will be shown on your receipt

Local call rates applies*

Lines open 8am-7pm Monday to Saturday and 10am-4pm Sunday.

*Calls to Argos enquiry lines may attract a charge and set up fee from residential lines depending on your call plan/tariff . Mobile and other providers costs may vary, see www.bt.com/pricing for details.

For Security and training purposes, telephone calls to and from customer service centres maybe recorded and monitored. Calls from Republic of Ireland will attract international call charges.

Product support

Help is always at hand

Disposal

- The symbol on the product or on its packaging indicates that this product may not be treated as household waste. Instead it shall be handed over to the applicable collection point for the recycling of electrical and electronic equipment.
- By ensuring this product is disposed of correctly, you will help prevent potential negative consequences for the environment and human health, which could otherwise be caused by inappropriate waste handling of this product.
- For more detailed information about recycling of this product, please contact your local city office, your household waste disposal service or the shop where you purchased the product.

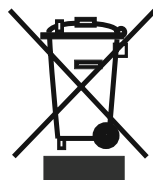

Product support

Help is always at hand

Guarantee

BUSH

Call us now and activate your 12 month guarantee

Thank you for choosing Bush. Your new product is guaranteed against faults and breakdowns for 12 months. Don't forget to register it with us today so we can provide you with our best possible after-sales service and useful updates.

www.bushregistration.co.uk

FREEPHONE*

0800 597 8548

Lines are open 8am - 8pm, 365 days a year. *Calls may be recorded and monitored.

Your Bush Guarantee

This product is guaranteed for twelve months from the date of original purchase. Any defect that arises due to faulty materials or workmanship will be repaired free of charge (or if applicable the product will be replaced or the purchase price refunded) where possible during this period by the dealer from who your purchased the unit.

The guarantee is subject to the following provisions:

- The guarantee does not cover accidental damage, misuse, cabinet parts, knobs or consumable items.
- The product must be correctly installed and operated in accordance with the instructions contained in the manual.
- It must be used solely for domestic purposes. The guarantee will be rendered invalid if the product is re-sold or has been damaged by inexpert repair.
- Specifications are subject to change without notice.
- Bush disclaim any liability for loss or damage arising from the breakdown of the product.
- This guarantee is in addition to and does not diminish your statutory or legal rights.

Important Data Protection Information

If you provide us with information about another person, you confirm that they have appointed you to act for them, to consent to the processing of their personal data including sensitive personal data and that you have informed them of our identity and the purposes (as set out in the Important Data Privacy notice displayed overleaf) for which their personal data will be processed.

You are entitled to ask for a copy of the information we hold about you (for which we may charge a small fee) and to have any inaccuracies in your information corrected.

For quality control and training purposes, we may monitor or record your communications with us.

If your personal details change, if you change your mind about any of your marketing preferences or if you have any queries about how we use your information, please let us know by contacting our Data Protection Officer, Domestic & General, Leicester House 17 Leicester Street, Bedworth, Warwickshire CV12 8JP.

Guarantor: Argos Limited - 489 - 499 Avebury Blvd. - Milton Keynes - MK9 2NW

or online at www.argos-support.co.uk If you still require further assistance, call one of our experts on 0345 257 7271.

BUSH

Contact:

www.argos-support.co.uk

Helpline: 0345 257 7271

52195626