



# TOWER®

## CARE AND USE INSTRUCTIONS

Please read carefully



Automatic soft-close lid

## 70L Dual Recycling Sensor Bin Range



\*Subject to registering your Extended Guarantee online at [www.towerhousewares.co.uk](http://www.towerhousewares.co.uk)



Dual Recycling Sensor Bin Range

## STRUCTURE OF THE SENSOR BIN

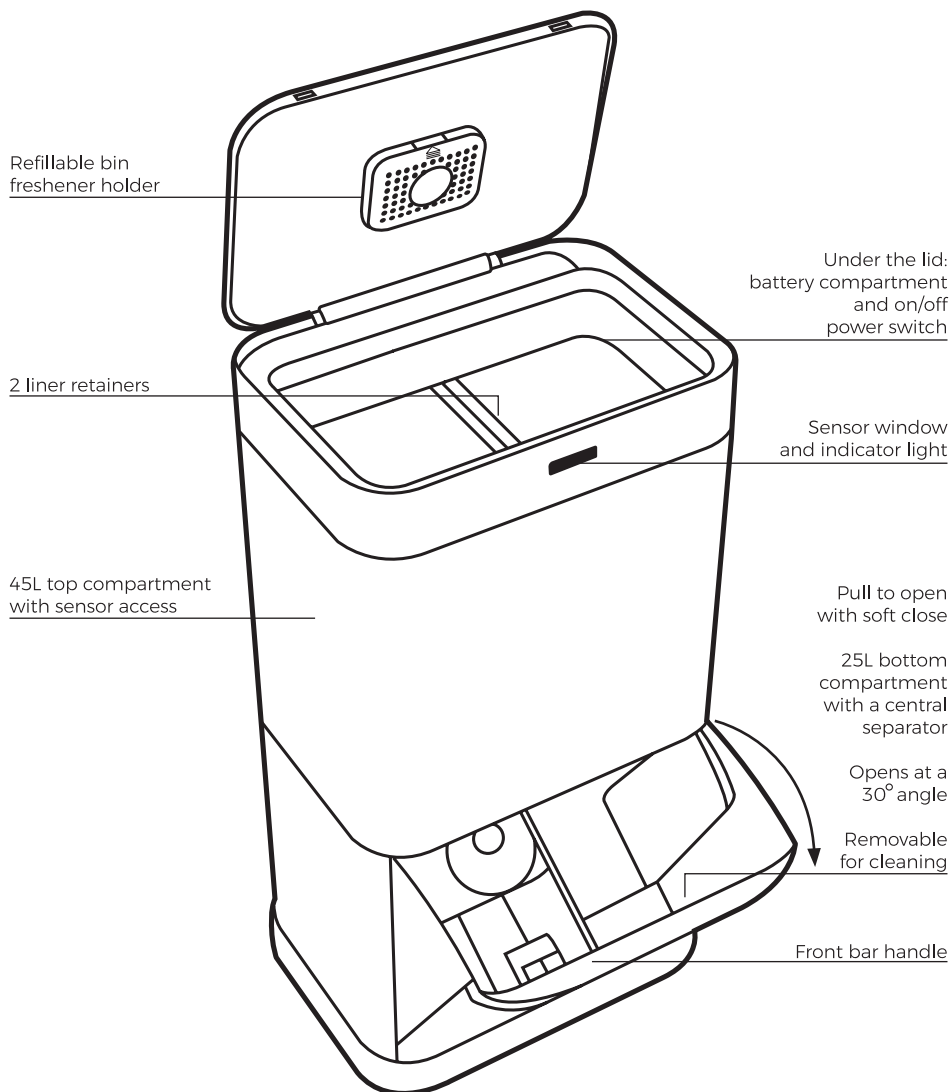



Thank you for purchasing this Tower Sensor Bin. We hope you have years of hassle-free cleanliness with your new purchase.

## OPERATING INSTRUCTIONS

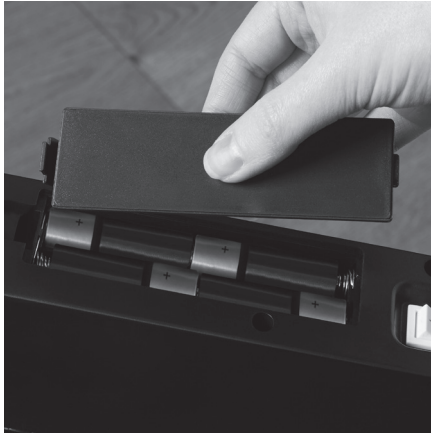

Open the cover of the battery case at the bottom of the bin lid and insert 4xAA batteries (not included). Ensure the batteries are inserted correctly (+/-) as indicated. Replace the battery cover.



Place each liner (recommended single liner size approx H55cm x W45cm) into the bin, folding 4-5cm of the top edges over the retaining ring. Push the retaining ring onto the bin body, making sure the liner edges are tucked inside the bin and are neatly concealed, and secure both retainer rings into position.

Turn on the power switch next to the battery compartment. The red indicator light will be lit for 2 seconds and then flash once every 4 seconds to show that the sensor is working and ready for use.

**NOTE:** Save these instructions for future reference. This product is intended for household use.



## Dual Recycling Sensor Bin Range



To open the bin, hold your hand 5-15cm in front of the lid and it will automatically open within half a second.

Once your hand is removed from the sensor area, it will automatically close within 5-6 seconds.

Keeping your hand within the sensor area will keep the lid open.

### INDICATOR LIGHTS

The indicator light flashes red (every four seconds).

When the lid opens, the indicator light shows green.

When the lid closes, the indicator light shows red.

### BATTERIES

The batteries can last 2-4 months based on the bin lid opening and closing 20 times a day.

### BIN FRESHENER

The freshener holder is located on the underside of the bin lid. To insert a freshener remove the lid from the body and switch the power off. Slide the freshener holder towards the lid opening side (not towards the hinge

of the lid), place your favourite scented freshener inside the holder and slide the compartment back in to place. Check the compartment is secure, switch the power on and put the lid back on the bin body.

Freshener weight limit: please do not exceed a net weight of 20g.

### REMOVAL AND CLEANING OF THE BOTTOM COMPARTMENT

To remove the bottom compartment for thorough cleaning, pull the front bar handle up when the bottom compartment is closed. Lift and remove the compartment from the body of the bin.

To refit, connect the two corresponding points (A and B), then push the compartment into position.

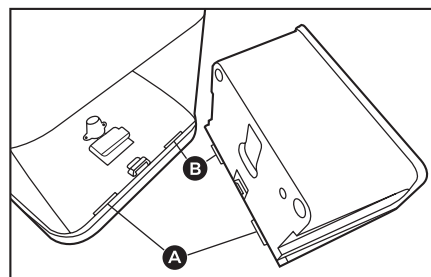



## CARE & USE

**Do not** apply any external power to the lid when it is in use.

**Do not** press on the lid when it is opening.

**Do not** manually open the lid as it may damage it.

**ONLY** use type AA batteries and remove them once they have run out to prevent leakage. If the bin fails to operate normally, it may mean the batteries are running low, or need replacing. Please avoid mixing brands, or using old batteries. Please recycle used batteries responsibly.

Avoid staying in sensing mode for an unduly long time to prolong the life of the motor and batteries

**Do Not** use water to rinse bin lid or battery compartment. You can wipe it with a slightly damp cleaning cloth when the power is off.

**DO NOT** IMMERSE IN WATER.

**Do not** use harsh abrasive detergents or scouring pads to clean the main body.

Avoid using the bin in a moist or steamy environment.

Keep the lid sensor away from direct sunlight or lamplight.

**Do not** place the bin close to high frequency electronic products, i.e: microwave ovens, energy saving lamps, or remote controls, etc.

Avoid placing the bin in a contained space and ensure that any obstacles don't block the lid sensor within a 2 metre distance.

## SPARE PARTS INFORMATION

Should you encounter problems, or require a replacement part, please consult the table below and then contact our Customer Services Department on:

**+44 (0)333 220 6066.**

CODE	DESCRIPTION
<b>TS4003S</b>	Sensor Bin Lid stainless steel
<b>TS5003B</b>	Black liner retainer ring
<b>TS5003G</b>	Green liner retainer ring

Your warranty becomes void should you decide to use non Tower spare parts.

The spare part is guaranteed for one year from the date of purchase.

Any necessary spare parts may also be purchased online from:

**[www.towerhousewares.co.uk](http://www.towerhousewares.co.uk)**



## TERMS AND CONDITIONS

The product must be returned to the retailer with proof of purchase.

The product must be installed and used in accordance with the instructions contained in this booklet.

It must be used only for domestic purposes.

It does not cover wear and tear, damage, misuse or consumable parts.

RKW has limited liability for incidental, or consequential loss or damage.

This guarantee is valid in the UK and Eire Only.

## CUSTOMER SERVICES

Should you have a problem with your appliance, or need any spare parts, please call our Customer Services Department on: +44 (0)333 220 6066

## GUARANTEE

This product is guaranteed for 12 months from the date of original purchase.

If any defect arises due to faulty materials of workmanship, the faulty products must be returned to the place of purchase.

Refund or replacement is at the discretion of the retailer.

The standard one year guarantee is only extended to the maximum available for each particular product upon registration of the product within 28 days of purchase.

If you do not register the product with us within the 28 day period, your product is guaranteed for 1 year only.

## VALIDATING YOUR 5 YEAR GUARANTEE

To validate your extended warranty, please visit:

[www.towerhousewares.co.uk](http://www.towerhousewares.co.uk)  
and register with us online.

Alternatively, call our customer registration line:

**+44 (0)333 220 6066**

Please note that length of extended warranty offered is dependent on product type and that each qualifying product needs to be registered individually in order to extend its warranty past the standard 1 year.



## YOUR RECEIPT:

Affix your store receipt to this page for safe keeping.

PLEASE AFFIX YOUR RECEIPT HERE

## MODEL NUMBER:

Please make a note of the product model number. You will find this on the packaging it came in. Please quote the model number when you contact us.

WRITE YOUR MODEL NUMBER HERE

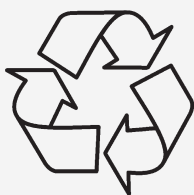

## DISPOSAL OF THE PRODUCT

Please visit **[www.recycle-more.co.uk](http://www.recycle-more.co.uk)** or **[www.recyclenow.co.uk](http://www.recyclenow.co.uk)** for access to information about recycling. Please arrange to take this product to your local Civic Amenity site for recycling, once it has reached the end of its life.



# TOWER®

over **100 YEARS** of quality



## THANK YOU

We hope you enjoy your product for many years. As a thank you for purchasing one of our fantastic products, we are offering you an extra 4 years peace of mind.

**To receive your extra 4 year guarantee, register your product online by visiting:**  
**[www.towerhousewares.co.uk](http://www.towerhousewares.co.uk)**

Should you have a problem with your product, or need any spare parts, please contact our Service Department on:  
**+44 (0)333 220 6066**

Your warranty becomes void should you decide to use non Tower spare parts.  
Spare parts can be purchased from  
**[www.towerhousewares.co.uk](http://www.towerhousewares.co.uk)**