

# morphy richards®

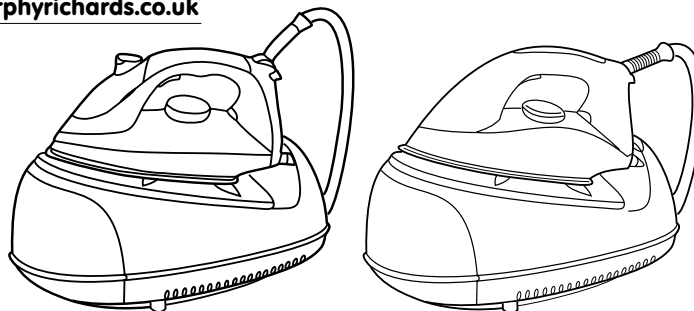

Register online for your 2 year guarantee. See back of this instruction book for details.  
(UK and Ireland customers only)  
[www.morphyrichards.co.uk](http://www.morphyrichards.co.uk)



## Steam Generator ironing system



Please read and keep these instructions

### **Getting the best from your new steam generator...**

#### **Safety first**

Caution must be used when handling this appliance as it does get very hot. Always switch off the unit and allow to cool before cleaning or storing.

#### **Water tank and spray** (certain models only)

The water tank can be removed and re-filled at any time during ironing.

#### **Performance**

To extend the performance and life of your jet stream generator, ensure that you replace the anti-scale cartridges regularly.



**To improve the life of your new product and to ensure the cleanliness of your clothes, we strongly recommend the use of distilled or demineralised water.**



RN42271 MUK Rev 5

**If you have a problem or complaint, please call our dedicated UK based helpline before returning your product to the retailer from where it was purchased.**



UK Helpline: 0844 871 0953  
Replacement Parts: 0844 873 0719  
Ireland Helpline: 1800 409 119



For details of other Morphy Richards products, plus replacement parts and accessories, please see our website:

[www.morphyrichards.com](http://www.morphyrichards.com)

## **IMPORTANT SAFETY INSTRUCTIONS**

The use of any electrical appliance requires the use of common sense and strict following of safety rules.

Primarily there is danger of injury or death and secondly the danger of damage to the appliance. These are indicated in the text by the following two conventions:

**WARNING: Danger to the person!**

**IMPORTANT:** Damage to the appliance!

In addition, we offer the following safety advice.

### **Location**

- Do not use outdoors.
- The steam generator must be used and rested on a stable surface.
- When placing the iron unit on the base unit or on its heel, ensure that the surface on which the heel or base unit is placed is stable.

### **Children**

- Children do not understand the dangers associated with operating electrical appliances. Never allow children to use, or play with, this appliance.
- Close supervision is necessary when any appliance is used near children.
- Children should be supervised to ensure that they do not play with this appliance.

### **Personal Safety**

- **WARNING: Burns can occur from touching hot metal parts, hot water or steam. Use caution when using your steam generator. If your iron is placed for a few moments on the iron rest plate, this plate may reach very high temperatures. In this instance, do not touch the iron soleplate or the iron rest plate until the iron and the iron rest have cooled down.**

- **WARNING: To protect against the risk of electric shock, do not immerse the appliance in water or in any other liquid.**

- Do not use the vertical steam feature on clothes that are being worn.
- Do not leave the steam generator unattended whilst plugged in or on an ironing board. Never allow the mains lead to overhang the work surface.
- The mains socket should always be switched off before plugging or unplugging from the socket. Never yank the cord to disconnect from the socket, instead, grasp the plug and pull to disconnect.

- This appliance is not intended for use by persons (including children) with reduced physical, sensory or mental capabilities, or lack of experience or knowledge, unless they have been given supervision or instruction concerning the use of the appliance by a person responsible for their safety.

### **Other safety considerations**

- Use the steam generator only for its intended use.
- Never hold the generator base set under the tap.
- Always disconnect the tank from the base unit when filling with water and emptying.
- Always disconnect the steam generator from the electrical supply when cleaning or when not in use.
- If the supply cord is damaged, it must be replaced by the manufacturer, its service agent or similarly qualified person(s) in order to avoid a hazard.
- Do not operate the steam generator with a damaged cord or if the iron has been dropped or if there are visible signs of damage or if it is leaking. To avoid the risk of electric shock, do not disassemble the iron or steam generator, but telephone Morphy Richards for advice. Incorrect reassembly can cause a risk of electric shock when the iron is used.

### **Special instructions**

- If your steam generator does not work, check the following points:  
Has the iron temperature control been set to the required temperature? Is the plug in its socket? Is the plug itself or the socket faulty? (Check by plugging in another appliance).
- To prevent damage to the textile being ironed, follow the temperature guide carefully. (Test on the inside of the hem of the garment).

- When ironing is complete, remove the plug from the socket, empty any remaining water from the tank, and allow to cool before storage.
- If you drop or severely knock your steam generator, this could cause internal damage even if the outside appears alright. Have it checked by a qualified electrician.
- The temperature of accessible surfaces may be high when the appliance is operating.

**WARNING: Do not use the product on a surface which could be damaged by heat or steam such as a worktop or a polished wood surface.**

**If in doubt, contact Morphy Richards.**

## **ELECTRICAL REQUIREMENTS**

Check that the voltage on the rating plate of your appliance corresponds with your house electricity supply which must be A.C. (Alternating current).

If the socket outlets in your home are not suitable for the plug supplied with this appliance, the plug should be removed and the appropriate one fitted.

**WARNING: A damaged or severed mains cable fitted with a plug should never be connected to the mains supply. It must be destroyed, as a damaged cable becomes hazardous if connected to a power socket.**





Should the fuse in the 13 amp plug require changing, a 13 amp BS1362 fuse must be fitted.

**WARNING: This appliance must be earthed.**

## **INSTRUCTIONS FOR USE**

### **Temperature guide**

Heat setting markings on the adjustable control dial of all Morphy Richards irons match those of the International Textile Care Labelling Code.

Symbol				
		(120°C Max) Cool	(160°C Max) Warm	(210°C Max) Hot
Control knob positions	Do not iron at all	●	●●	●●●
Fabric		Nylon, Acetates e.g. Acrilan Courtelle, Orlon Triacetates, e.g. Tricel/Polyester	Wool, Polyester mixtures e.g. Polyester/Cotton	Cotton, Linen Rayon, Rayon mixtures, e.g. Rayon/Linen
Ironing		Iron on wrong side, if moisture required use damp cloth (Not Acetate)		Fabrics requiring this setting usually require steam pressing for heavy cotton, denim etc.
Steaming			←—————→	
Without steam		←—————→		Dry ironing

**For details of other Morphy Richards products, please see our website: [www.morphyrichards.com](http://www.morphyrichards.com)**

## COMPONENTS OF YOUR STEAM GENERATOR

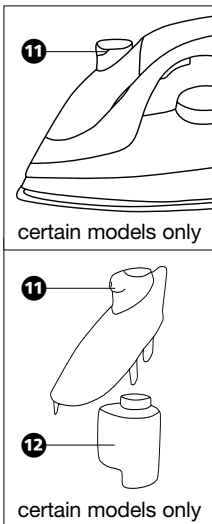
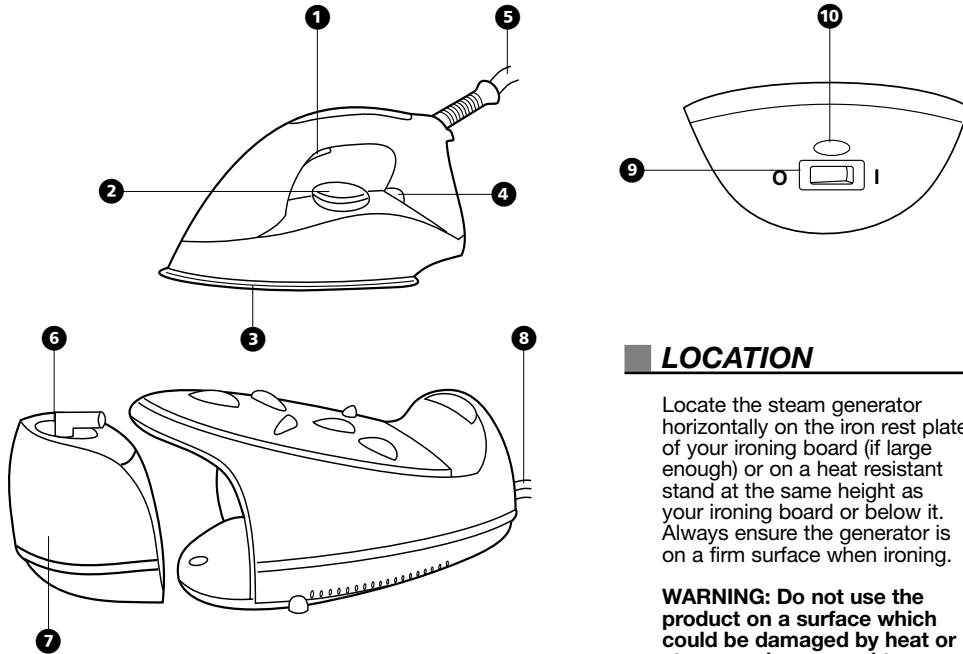

### COMPONENTS OF YOUR STEAM GENERATOR

#### Iron unit

- 1 Steam trigger
- 2 Temperature control dial
- 3 Soleplate
- 4 Temperature indicator light
- 5 Supply cord from base unit

#### Base unit

- 6 Anti-scale cartridge
- 7 Water tank
- 8 Power cord
- 9 Power switch with indicator light
- 10 Boiler temperature indicator light
- 11 Spray unit (certain models only)
- 12 Spray bottle (20ml) (certain models only)

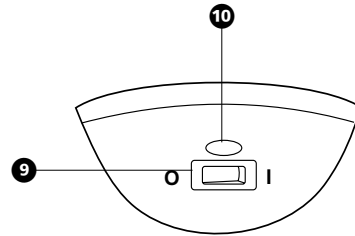

### LOCATION

Locate the steam generator horizontally on the iron rest plate of your ironing board (if large enough) or on a heat resistant stand at the same height as your ironing board or below it. Always ensure the generator is on a firm surface when ironing.

**WARNING: Do not use the product on a surface which could be damaged by heat or steam such as a worktop or a polished wood surface.**

If in doubt, contact Morphy Richards.

### BEFORE USE

Remove any protective sticker from the soleplate and the base unit, if any.

Unwind and straighten the power cord (8) and supply cord (5).

Slide out the water tank (7) and fill (see filling instructions).

Textiles and clothes are supposed to carry ironing instructions. If they don't, you should follow the fabric guide on page 3, but be sure to test the temperature by ironing the hem of the garment or similar area first.

If you turn the control dial from a hot setting to a cooler setting, wait until the iron temperature has stabilised before you continue ironing.

## FILLING

- 1 Place the steam generator on a stable ironing board or table, with the iron resting on its stand.
- 2 Release the detachable water tank by sliding outwards **A**.
- 3 Remove the anti-scale cartridge by pulling upwards **B**.
- 4 Fill the tank to the 'fill to here' line with clean tap water **C**.

**IN HARD WATER AREAS, THE USE OF DISTILLED OR DEMINERALISED WATER IS RECOMMENDED.**

**Never use battery topping up fluid or water containing any substances like starch or sugar, or defrosted water from a refrigerator.**

- 5 Re-install the anti-scale cartridge and re-position the water tank on the base unit and push securely into place. Please make sure the tank is secure **D**.
- 6 Always pour out any remaining water after use.

## Re-filling 'in use'

- 1 When the water level becomes low, the pump begins to emit a loud noise. This is due to air being pumped instead of water and is quite normal.

Refilling can be done whilst the appliance is in operation. It is not necessary to wait for the appliance to cool down.

- 2 Slide out the water tank and fill (see filling instructions).

## Steam ironing

- 1 Unwind and straighten the power cord **8** and supply cord **5**.
- 2 Slide out the water tank and fill (see filling instructions).

- 3 Connect the appliance to a suitable mains outlet, and switch on the socket. Turn the power switch **9** on the base unit to 'I' (on) and the indicator will glow.
- 4 The boiler ready indicator light **10** situated above the 'power switch' **9** will also illuminate, indicating the boiler is on its heating cycle and will extinguish when the required temperature is reached.
- 5 Turn the temperature dial on the iron in a clockwise direction, select dot-2 or dot-3 according to the recommendation of the garment label.

- 6 The iron's temperature indicator light **4** goes off when the required temperature is reached.

- 7 Depress the steam button **1** for 1 minute to clean the steam generating system (for first time use). It will be accompanied by a clicking noise which is quite normal.

- 8 Begin first time ironing with an old towel. It takes about 1 minute to reach the required temperature.

- 9 Press the steam button **1** for steam ironing.

- 10 To switch the unit off, turn the power switch on the base unit to 'O' (OFF).

## Dry ironing

- 1 Connect the appliance to a suitable mains outlet, and switch on the socket.
- 2 Turn the temperature dial on the iron in a clockwise direction, select dot-1, dot-2, or dot-3 according to the recommendation of the garment label.
- 3 The temperature indicator light glows on the iron, indicating that it is switched on.

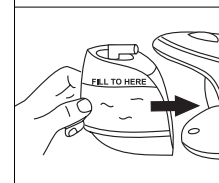
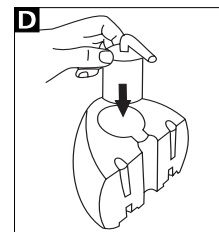
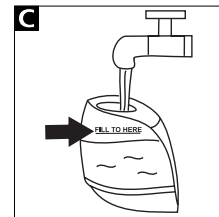
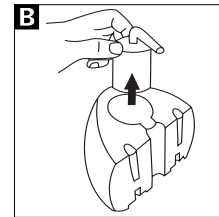
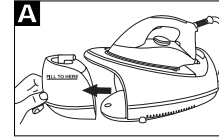

- 4 When the required temperature is reached, the temperature indicator light on the iron goes off. The iron is ready to use.

It is always a good idea to begin with 'cool' fabrics and work up to higher settings.

An iron heats up quicker than it cools down so you'll save time and electricity.

### STEAM IRONING

#### The spray unit (certain models only)

The spray unit can be used at any time and does not affect any product settings.

#### Filling the spray unit

The spray feature ① is lightly secured to the handle. To fill the water tank, pull the spray unit forward using the two moulded lugs provided.

Remove the spray bottle ② from the base of the pump and fill with water to the 'MAX' mark.

Re-fit the spray bottle, making sure the arrows (printed black) are in line.

#### To replace the spray unit

Align the spray unit with the front of the iron.

Fit the bottom location leg into the slot at the front of the handle. Pivot the spray unit towards the iron, making sure it clips firmly in place.

### ANTI-SCALE SYSTEM

The anti-scale cartridge is designed to reduce the build-up of limescale which

occurs during steam ironing. This will prolong the working life of your iron. However, please note that the anti-scale cartridge will not completely stop the natural process of limescale build-up.

#### Replacing anti-scale cartridge

How often you need to replace the anti-scale cartridge depends on how often you use your iron with its steam functions and how 'hard' your water supply is. Water hardness varies greatly from one area to another. For advice on the relative hardness of your water, contact your local water supplier.

If, on average, you spend 2 hours per week ironing, then we suggest you refill your anti-scale cartridge as shown in the table below. If you iron more or less frequently, then you should alter the interval between refills accordingly.

Water hardness	Soft	Medium	Hard
Refill interval (months)	6	3	1 1/2

#### Replacement anti-scale refills

To obtain replacement anti-scale refills, telephone our spares number on: **0844 873 0719**.

- If a new cartridge is not available, you may continue operating the appliance but scale will build up in the system. Replace the used cartridge as soon as possible.
- 1 Disconnect the appliance from the mains outlet.
  - 2 Slide out the tank and remove the antiscal cartridge **E**.
  - 3 Pull the plate from the end of the cartridge **F**.

- 4 Remove the foam pad **G** and slide out the spent antiscal sleeve **H**.
- 5 Place the refill into the cartridge, reposition the foam pad and clip the plate onto the cartridge, making sure it locks in position **H**.

### FEATURES OF YOUR STEAM GENERATOR

#### Temperature indicator light

The indicator light shows that the iron is warming up. When the required temperature is reached, the light will go out and will cycle on-off during operation.

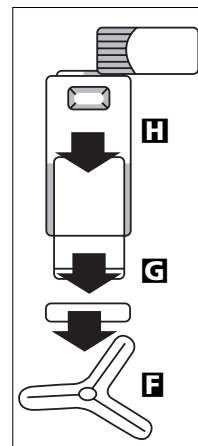
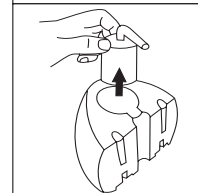
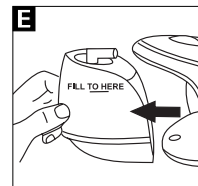

### Steam function

During the steaming process, small amounts of water may be ejected from the soleplate. This is normal and can be avoided by using the steam for short amounts of time and only when the iron is at the correct temperature (the indicator light on the iron goes out when ready).

Sudden jolts of the boiler unit can also cause water droplets on the soleplate; therefore, do not move the base unit during ironing. We recommend for the first time ironing that you iron over an old towel.

### Vertical steam

Hold the iron in a vertical position between 1cm and 2cm away from the item **I**. Press the steam trigger **Ⓢ**, this will create vertical steam.

This feature is especially useful for removing creases from hanging clothes, curtains, wall hangings, etc.

### Emptying and storing

When you have finished ironing, unplug your steam generator.

- 1 Slide out the water tank and remove the anti-scale cartridge **I**.
- 2 Empty the water in the tank by holding it upside down **K**.
- 3 Replace the anti-scale cartridge and reinstall the water tank.

Unplug the generator and leave the iron to cool off for 15 minutes minimum. The iron must be placed on the iron rest plate.

The iron and boiler can now be stored together.

### MAINTENANCE

#### To clean a stainless steel soleplate

To keep the soleplate of your iron clean and free of limescale, we recommend that you use one of the gentle chrome, silver or stainless steel cleaners that are generally available. Always follow the manufacturer's instructions. To clean off melted man-made fibres, set the iron at 3-dot position and pass it over a clean piece of cotton which will draw the deposit off the surface.

#### To clean a ceramic coated soleplate (certain models only)

In the unlikely event of any man-made fibre fusing to the soleplate, set the iron at the MAX position and pass it over a clean piece of cotton which will draw the deposit off the surface.

Do not use scouring powder or solution as this could cause damage to the coating.

**IMPORTANT: Do not descale the soleplate with descaling products, proprietary cleaning agents or vinegar when flushing out the soleplate.**

#### To clean the exterior

Allow the steam generator to cool and wipe over with a damp cloth and mild detergent, then wipe with a dry cloth.

### HELPLINE

If you have any difficulty with your appliance, do not hesitate to call us.

We are more likely to be able to help than the store from where you bought it.

Please have the following information ready to enable our staff to deal with your query quickly.

- Name of the product
- Model number and Serial number as shown on underside of the appliance.

**UK Helpline**  
0844 871 0953

**Replacement Parts**  
0844 873 0719

**Ireland Helpline**  
1800 409 119

### WEBSITE

You may also contact us through our website, or visit the site to browse and purchase appliances, spare parts and accessories from the extensive Morphy Richards range.

[www.morphyrichards.com](http://www.morphyrichards.com)

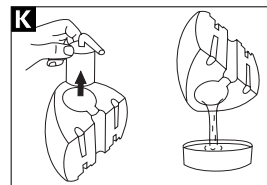
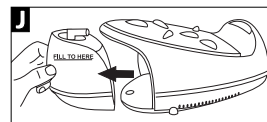
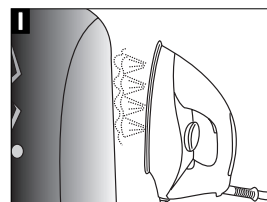

## REGISTERING YOUR TWO YEAR GUARANTEE

Your standard one year guarantee is extended for an additional 12 months when you register the product within 28 days of purchase with Morphy Richards. If you do not register the product with Morphy Richards within 28 days, your product is guaranteed for 1 year. To validate your 2 year guarantee register with us online at [www.morphyrichards.co.uk](http://www.morphyrichards.co.uk)

N.B. Each qualifying product needs to be registered with Morphy Richards individually.

**Please note that the 2 year guarantee is only available in the UK and Ireland.** Please refer to the one year guarantee for more information.

## YOUR ONE YEAR GUARANTEE

It is important to retain the retailer's receipt as proof of purchase. Staple your receipt to this back cover for future reference.

Please quote the following information if the product develops a fault. These numbers can be found on the base of the product.

**Model no.**

**Serial no.**

All Morphy Richards products are individually tested before leaving the factory. In the unlikely event of any appliance proving to be faulty within 28 days of purchase, it should be returned to the place of purchase for it to be replaced.

Morphy Richards products are intended for household use only.

Morphy Richards has a policy of continuous improvement in product quality and design. The company, therefore, reserves the right to change the specification of its models at any time.

If the fault develops after 28 days and within 12 months of original purchase, you should contact the Helpline number quoting Model number and Serial number on the product, or write to Morphy Richards at the address shown.

You may be asked to return a copy of proof of purchase.

Subject to the exclusions set out below (see Exclusions), the faulty appliance will then be repaired or replaced and dispatched usually within 7 working days of receipt.

If, for any reason, this item is replaced during the 1 year guarantee period, the guarantee on the new item will be calculated from original purchase date. Therefore it is vital to retain your original till receipt or invoice to indicate the date of initial purchase.

To qualify for the 1 year guarantee, the appliance must have been used according to the instructions supplied. For example, crumb trays should have been emptied regularly.

## EXCLUSIONS

Morphy Richards shall not be liable to replace or repair the goods under the terms of the guarantee where:

- 1 The fault has been caused or is attributable to accidental use, misuse, negligent use or used contrary to the manufacturer's recommendations or where the fault has been caused by power surges or damage caused in transit.
- 2 The appliance has been used on a voltage supply other than that stamped on the products.

- 3 Repairs have been attempted by persons other than our service staff (or authorised dealer).
  - 4 The appliance has been used for hire purposes or non domestic use.
  - 5 The appliance is second hand.
  - 6 Morphy Richards are not liable to carry out any type of servicing work, under the guarantee.
  - 7 Plastic filters for all Morphy Richards kettles and coffee makers are not covered by the guarantee.
  - 8 Batteries and damage from leakage are not covered by the guarantee.
- This guarantee does not confer any rights other than those expressly set out above and does not cover any claims for consequential loss or damage. This guarantee is offered as an additional benefit and does not affect your statutory rights as a consumer.



For electrical products sold within the European Community. At the end of the electrical products useful life, it should not be disposed of with household waste.

Please recycle where facilities exist. Check with your Local Authority or retailer for recycling advice in your country.

**morphy richards®**

**The After Sales Division  
Morphy Richards Ltd**  
Mexborough, South Yorkshire,  
England, S64 8AJ

Helplines (office hours)  
UK 0844 871 0953  
Spare Parts 0844 873 0719  
Republic of Ireland 1800 409 119

RN42271 MUK Rev 5 11/09

For details of other Morphy Richards products, plus replacement parts and accessories, please see our website:

[www.morphyrichards.com](http://www.morphyrichards.com)