



**McGreggor 12L Lawn
Spreader**

(Model: WS-5008
Cat No.: 8659903)

**Please read these
instructions fully before starting assembly**

These instructions contain important information that will help you get the best from your lawn spreader, ensuring it is assembled correctly. If you need help or have damaged or missing parts, call the Customer Helpline on **0345 640 0800**

**AFTER SALES SUPPORT
0345 640 0800**

Contents

Safety Information.....	3
Technical data.....	3
Assembly.....	3
Spreading adjustment.....	4
Instructions	4
Use.....	4



Safety Information

Important - Please read these instructions fully before operating or maintaining

The lawn spreader is not a toy and should be stored out of the reach of children.

Technical data

Parts

Model: WS-5008
Capacity: around 12 litres
Spreading width: 45cm
Dimensions: 56.5x20x109cm
Spreader settings: 10
Weight: 1.4kgs
List of components
1. Handle
2. Bottom handle
3. Wheels
4. Adjustment knob
5. Support foot

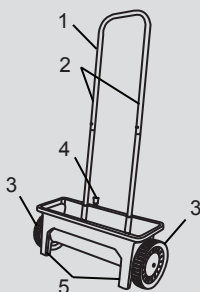

	bended tube	1PC
	straight tube	2PC
	tank with wheels and control lever	1PC

Assembly

The lawn spreader is almost ready for use on delivery. The wheels and adjustment knob are fitted at the factory.

If the adjustment knob is off, the installation method is as follows: (Keep your hand on the hinge).

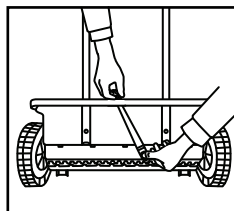
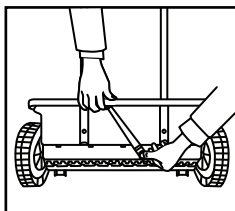
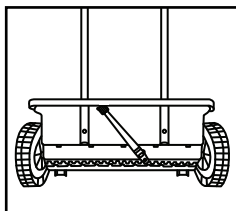
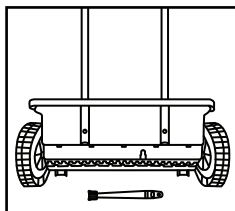

The procedure for fitting the handle is as follows:

Assembly

Insert the thick end of the tubes into the sockets on the lawn spreader. Make sure they engage. Place the upper handle on the lower handle. Make sure they engage. The lawn spreader is now assembled and ready for use.

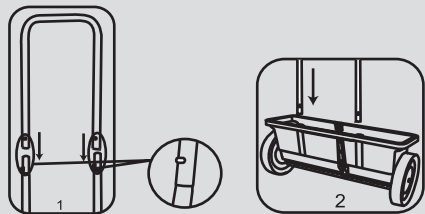

Spreading adjustment

The lawn spreader is equipped with a 10-step system that regulates the spreading amount. "0" is the lowest setting(no spreading)and "10" is the highest setting. The particle size corresponding to each gear is as follows:

Step system	1	2	3	4	5	6	7	8	9	10
Suitable particle diameter	0.5mm	1.2mm	1.8mm	2.8mm	3.8mm	5.0mm	6.0mm	7.2mm	8.0mm	8.2mm

Choose the selected setting by setting the knob to the relevant number on the lawn spreader. For most seeding and/or weed and moss killers, setting 3-4 are ideal. The actual spreading quantity depends on various factors and can only be measured in practice.

instructions

select setting "0" to avoid the material running out during filling. Fill the fertiliser spreader with the required material.

Use

Move the lawn spreader to the place where you want to spread from and adjust the spreading quantity. Carefully push the spreader over the area to be treated. The rotating axle moves the material out of the fertiliser spreader as the spreader moves forward.