

GUILD 2000W Heat Gun

Original Instruction Manual

PHG200GL

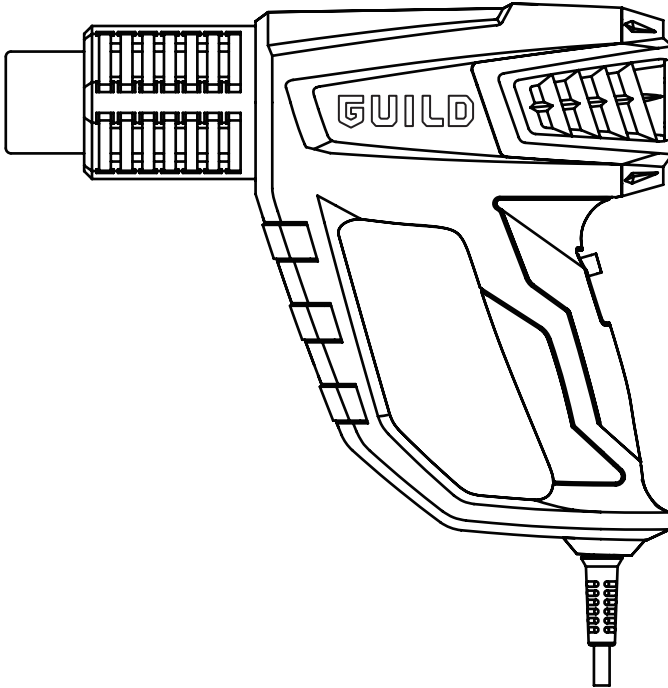

GUILD

After Sales Support

UK/Ireland +44 333 320 1989
Help@guildpowertools.co.uk

Important - Please read these instructions fully before operating or maintaining your Guild Heat Gun

These instructions contain important information that will help you get the best from your Guild Heat Gun, ensuring it remains safe to operate.

If you need help or have damaged or missing parts, call the Customer Helpline on +44 333 320 1989

Contents

Safety Information.....	3
In The Box.....	5
Accessories.....	5
Operating Instructions.....	6
Maintenance.....	10
Trouble Shooting.....	10
Technical Data.....	11
Environmental Protection.....	11
Guarantee.....	12

Produced in China for Argos Limited, London, EC1N 2HT, UK.
Argos (N.I.) Ltd, Forestside Shopping Centre, Upper Galwally,
Belfast, BT8 6FX, UK.

Safety Information

Important - Please read these instructions fully before starting assembly

Warning Symbols

The following warning symbols appear throughout this assembly manual and indicate the appropriate safety measures you should take when assembling and operating the Heat Gun.



Read operator's manual



Warning



Wear eye protection



Wear dust mask



Double insulation



Waste electrical products must not be disposed of with household waste. Please recycle where facilities exist. Check with your local authorities or retailer for recycling advice.



Conforms to relevant EU regulatory requirements



Conforms to relevant UK regulatory requirements

Safety Information

Important - Please read these instructions fully before starting assembly

General Power Tool Safety Warnings

Users can view the electronic instructions at www.argos.co.uk.



WARNING! Read all safety warnings and all instructions. Failure to follow the warnings and instructions may result in electric shock, fire and/or serious injury.

Save all warnings and instructions for future reference.

This appliance can be used by children aged from 8 years and above and persons with reduced physical, sensory or mental capabilities or lack of experience and knowledge if they have been given supervision or instruction concerning use of the appliance in a safe way and understand the hazards involved. Children shall not play with the appliance. Cleaning and user maintenance shall not be made by children without supervision.

If the supply cord is damaged, it must be replaced by the manufacturer, its service agent or similarly qualified persons in order to avoid a hazard.

ADDITIONAL SAFETY INSTRUCTIONS FOR YOUR HEAT GUN

1. A fire may result if the appliance is not used with care, therefore

- be careful when using the appliance in place where there are combustible materials;
- do not apply to the same place for a long time;
- do not use in presence of an explosive atmosphere;
- be aware that heat may be conducted to combustible materials that are out of sight;
- place the appliance on its stand after use and allow it to cool down before storage;
- do not leave the appliance unattended when it is switched on.

In The Box

Parts

- ① Nozzle
- ② Heat protection housing
- ③ Support stand
- ④ Cool air inlet
- ⑤ On/off switch
- ⑥ Power cord
- ⑦ Scraper
(1pc handle with 1pc triangle blade)
- ⑧ Concentration nozzle
- ⑨ Hook nozzle
- ⑩ Glass protection nozzle
- ⑪ Flat Nozzle

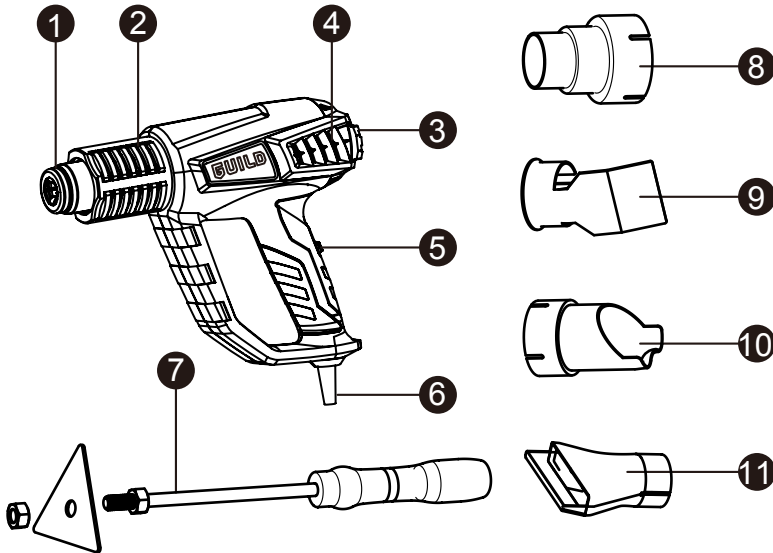

Accessories

Scraper	1
Glass protection nozzle	1
Flat nozzle	1
Hook nozzle	1
Concentration nozzle	1

Operating Instructions



NOTE: Before using the tool, read the instruction book carefully, please always wear overheating protection gloves.

Before using the tool

Before starting the job it is advisable to test the workpiece for the ideal temperature to use. The description below gives an indication of the likely heat settings required but always start with the low heat setting.

The distance between the nozzle and the workpiece will vary according to the material being worked on but this should always be at least 50mm (2inch) or more on either heat setting.

All applications, with the exception of removing paint from the window frames, can be performed without using a nozzle; however for best results nozzles are recommended.

PUTTING INTO OPERATION

1.SWITCHING ON/OFF

Switching on:

To put into operation, slide the switch (5) to position 1, 2 or 3.

Switching off:

To switch off, slide the on/off switch (5) to the stop at position 0.

After working for a longer time with high temperature, allow the unit to cool by running in the cold air setting 1 before switching off.

2. THERMO-PROTECTION SWITCH-OFF

When the heater is overloaded (e.g. as a result of restricted air flow), the unit switches it off automatically, however, the blower continues to run. When the unit has cooled to operating temperature, the heater is switched on again.

3.SETTING THE AIR FLOW AND TEMPERATURE

The switch (5) can be set to three blower steps. Suitable air flow and temperature combinations can be selected according to the applications.

1 = 50°C , 500L/min

2 = 400 °C , 250L/min

3= 600°C , 500L/min

The cold air setting 1 is suitable for cooling a warmed work piece or for the drying of paint. It is also suitable for cooling the unit before placing down or the changing of nozzles.

The air setting 2 is suitable for Bending Plastic and heating shrinking plastic.

The air setting 3 is suitable for stripping paint and defrosting pipes.

Operating Instructions

4. NOZZLES AND SCRAPER

The kit is supplied with 4 different shaped nozzles and 1 scraper, which can be used as follows:

1) CONCENTRATION NOZZLE (SEE FIG. A)

This nozzle directs a concentrated heat flow to the workpiece. It is ideal for use when removing paint in awkward corners, crevices, mouldings, beading, architraves or whenever precise paint removal is required.

2) HOOK NOZZLE (SEE FIG. B)

This nozzle disperses the heat flow evenly around the whole workpiece. It is ideal for defrosting frozen pipes, soldering pipe work, bending plastics and heat-shrinking electrical parts.

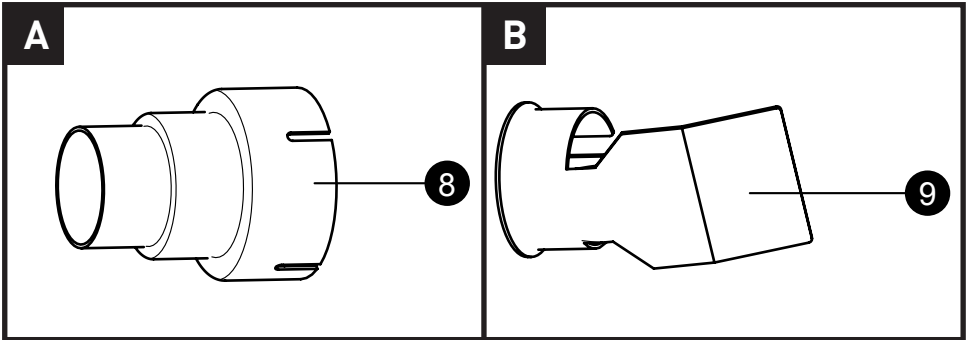

3) FLAT NOZZLE (SEE FIG. C)

This nozzle directs a long narrow heat pattern to the workpiece, and is ideal for removing paint or varnish from large flat surfaces such as skirting boards, doors, stairs etc. It should be used in conjunction with a flat scraper. Vinyl tiles can be removed by softening the tile and adhesive.

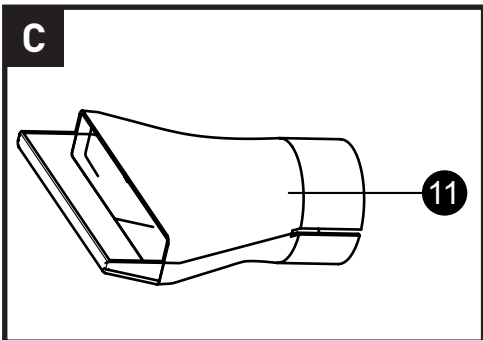

Operating Instructions

4) GLASS PROTECTION NOZZLE (SEEFIG.D)

This nozzle for deflecting air flow. On profiled surfaces, varnish can be removed using an appropriately fitting spatula and brushed off with a soft wire brush.

5) SCRAPER (SEE FIG. E)

Take the handle from the set, remove the nut from the end, and fit the triangle blade in place by refitting and tightening the nut. The triangular shave hook is ideal for stripping paint from flat wooden surface and edges.

Remember to clean the blade after use with wire wool and lightly oil before storing.

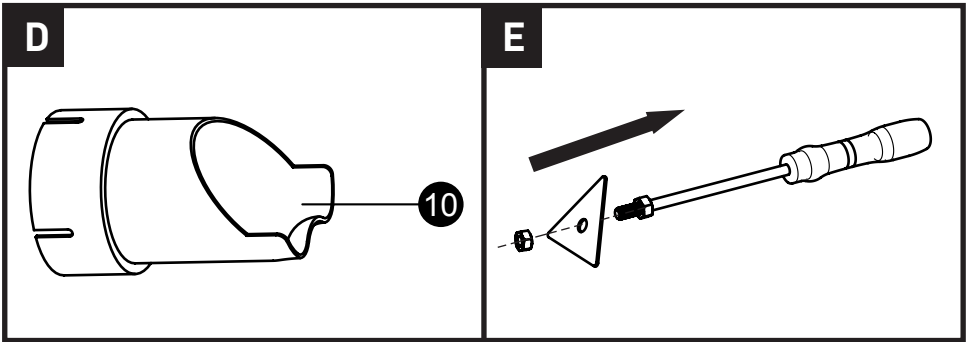

5. REMOVING PAINT(SEE FIG. F)

Choose the required nozzle and fit onto the heat outlet. Select the scraper or shave hook required. Hold the gun with the nozzle approximately 50mm (2inch) from the surface of the paintwork and start with the lower heat setting move it slowly backwards and forwards until the paint blisters and bubbles. Immediately remove the paint with the scraper or shave hook. Aim to heat the paint just ahead of the scraper so that you can develop a continuous action. Do not heat the paint for too long, as this will burn the paint making it difficult to remove. Most stickers can also be removed from paintwork by using the heat to soften the adhesive. Be careful not to direct the heat for too long if you are trying just to remove the stickers, as this will blister the paint.

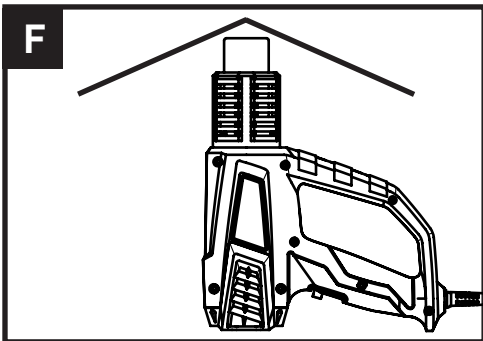

Operating Instructions

6. WHEN NOT IN USE, JUST LET THE TOOL STAND AS SHOWN IN FIG.6.

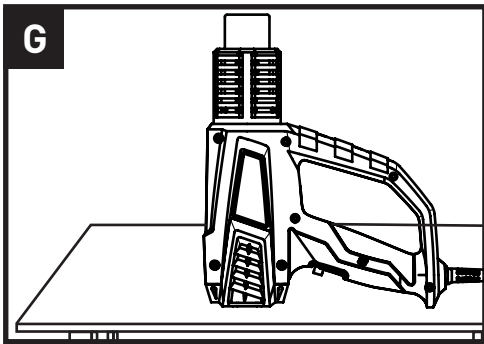

7. REMOVING PAINT FROM WINDOW FRAMES

Always use the glass protection nozzle. Ensure you have the nozzle facing the correct way to deflect the heat away from the glass before you switch on. Rotate the gun or nozzle 90° as you move to horizontal or vertical bead. Allow nozzle to cool before attempting to turn it. Paint can be removed from profile surfaces by using a shave hook and/or a soft wire brush.



WARNING: Glass can break easily.

8. DEFROSTING FROZEN PIPES

Choose the Hook nozzle and fit over the heat outlet. Always heat from one or other end of the frozen portion, not from the middle.



WARNING: Do not attempt to defrost PVC pipes. Always check that it is a water pipe and not a gas pipe. Do not heat a gas pipe.

9. SHRINK SEATING ELECTRICAL CABLES

Choose the Hook nozzle and fit over heat outlet. Select a heat-shrinkable sleeve with a diameter matching that of the workpiece. Evenly heat the sleeve.

Maintenance

Remove the plug from the socket before carrying out any adjustment, servicing or maintenance.

There are no user serviceable parts in your power tool. Never use water or chemical cleaners to clean your power tool. Wipe clean with a dry cloth. Always store your power tool in a dry place. Keep the motor ventilation slots clean. Keep all working controls free of dust. Occasionally you may see sparks through the ventilation slots. This is normal and will not damage your power tool.

If the supply cord is damaged, it must be replaced by the manufacturer, its service agent or similarly qualified persons in order to avoid a hazard.

Trouble Shooting

1. If your heat gun will not operate, check the power at the mains plug.
2. If the outlet of the heat gun very hot, please rest until cold.
3. If a fault can not be rectified return the tool to an authorized dealer for repair.

Technical Data

Technical Data Table

Rated Voltage	220-240V~50Hz
Power	2000W
Temperature/Flow rate	I = 50°C , 500L/min II = 400°C , 250L/min III = 600°C , 500L/min
Machine weight	0.8kg
Protection class	□/II

Environmental Protection



Waste electrical products should not be disposed of with household waste. Please recycle where facilities exist. Check with your Local Authority or retailer for recycling advice.

Guarantee

This product is selected for DOMESTIC USE ONLY and not for business use. This product is guaranteed against manufacturing defects for a period of 24 months. This does not cover the product where the fault is due to misuse, abuse, use in contravention of the instructions, or where the product has been the subject of unauthorised modifications or alterations, or has been the subject of commercial use. In the event of a problem with the product within the guarantee period please return it to your nearest store. If the item is shown to have an inherent defect present at the time of sale, the store will provide you with a replacement. Your statutory rights remain unaffected.

Issue, 10/2023

