

# BUSH

## Instruction manual

BFFX54152W  
BFFX54152S  
BFFX54152B

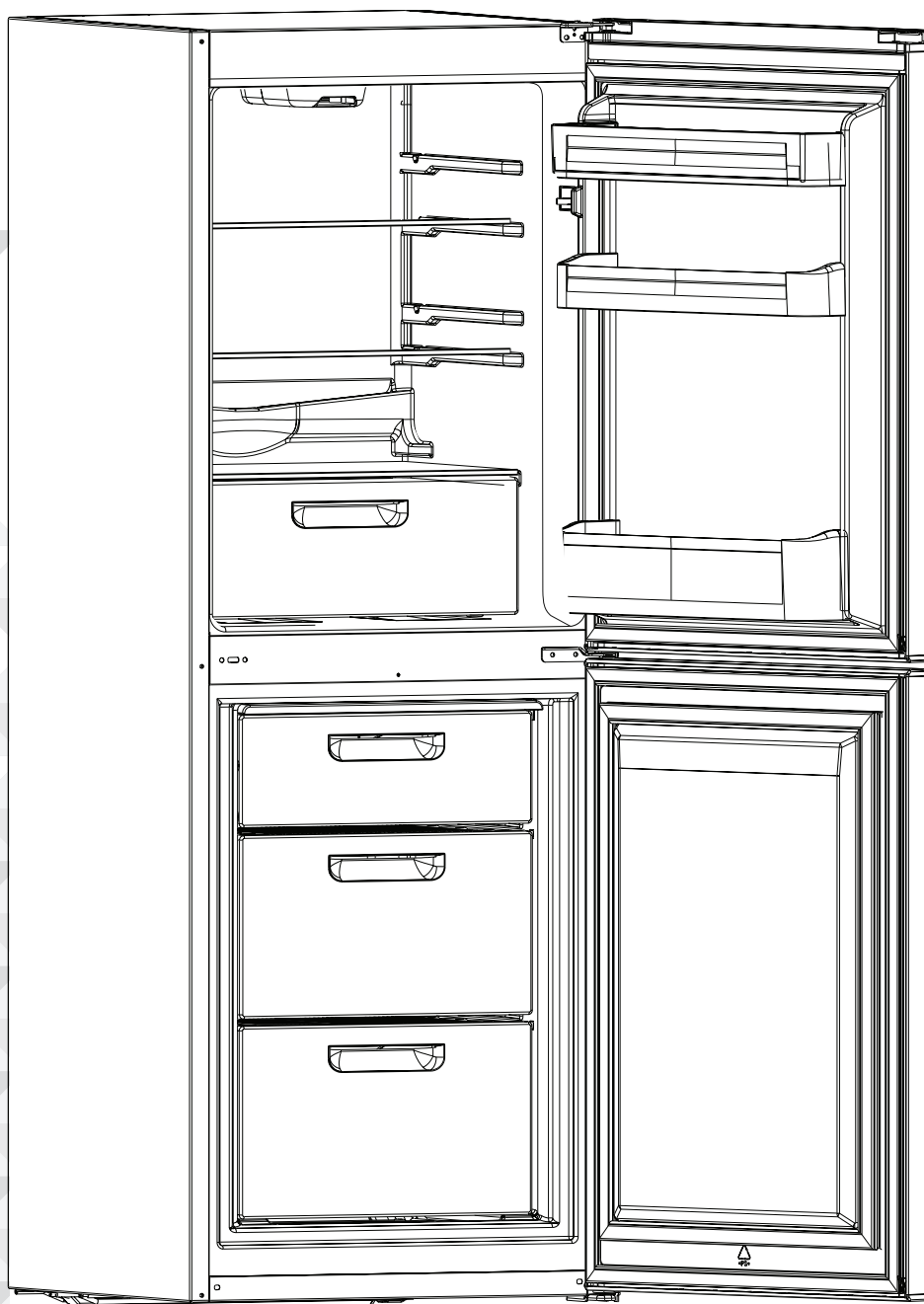



You'll soon be enjoying your new Combi Fridge-Freezer.

It all begins here, with your instructions. Don't worry, there's nothing too technical coming up. Just simple, step-by-step guidance to get you up and running quickly. Sound good? Then let's get started.

## Help and Guidance

We're here to help you get the most from your Combi Fridge-Freezer. Should you require any guidance, a simple solution can often be found online at:

[www.argos-support.co.uk](http://www.argos-support.co.uk)

If you still require further assistance, call one of our experts on 0345 257 7271

If you require any technical guidance or find that your product is not operating as intended, a simple solution can often be found in the **Troubleshooting** section of these instructions,

# Contents

|          |  |           |          |                        |           |
|----------|--|-----------|----------|------------------------|-----------|
| <b>1</b> | <b>Safety information</b>                        | <b>4</b>  | <b>7</b> | <b>Product support</b> | <b>22</b> |
|          | General warnings                                 | 5         |          | Product support        | 23        |
|          | Safety warnings                                  | 6         |          | Help and assistance    | 24        |
| <b>2</b> | <b>Getting to know your Combi Fridge-Freezer</b> | <b>7</b>  |          | Disposal               | 25        |
|          | Getting to know your Combi Fridge-Freezer        | 9         |          | Guarantee              | 26        |
| <b>3</b> | <b>Installing your Combi Fridge-Freezer</b>      | <b>10</b> |          |                        |           |
|          | Installing and operating your fridge             | 11        |          |                        |           |
|          | Before Using Your Fridge                         | 11        |          |                        |           |
|          | Shipment and Repositioning                       | 11        |          |                        |           |
|          | Repositioning the door                           | 11        |          |                        |           |
|          | Electrical Connection (For UK type plug)         | 12        |          |                        |           |
| <b>4</b> | <b>Functions</b>                                 | <b>13</b> |          |                        |           |
|          | Warnings about temperature adjustments           | 14        |          |                        |           |
|          | Accessoires                                      | 15        |          |                        |           |
|          | Information on the Frost Free Technology         | 15        |          |                        |           |
| <b>5</b> | <b>Using your Combi Fridge-Freezer</b>           | <b>16</b> |          |                        |           |
|          | Arranging Food in the Appliance                  | 17        |          |                        |           |
|          | The deep freeze compartment                      | 17        |          |                        |           |
| <b>6</b> | <b>Care and maintenance</b>                      | <b>19</b> |          |                        |           |
|          | Cleaning   | 20        |          |                        |           |
|          | Defrosting                                       | 20        |          |                        |           |
|          | Replacing the LED                                | 20        |          |                        |           |
|          | Technical specification                          | 21        |          |                        |           |



# Safety information

# 1





## Safety information

**Important** - Please read these instructions fully before installing or operating

### General warnings

**WARNING:** Keep ventilation openings, in the appliance enclosure or in the built-in structure, clear of obstruction.

**WARNING:** Do not use mechanical devices or other means to accelerate the defrosting process, other than those recommended by the manufacturer.

**WARNING:** Do not use electrical appliances inside the food storage compartments of the appliance, unless they are of the type recommended by the manufacturer.

**WARNING:** Do not damage the refrigerant circuit.

**WARNING:** To avoid a hazard due to the instability of the appliance, it must be fixed in accordance with the instructions.

- If your appliance uses R600a as a refrigerant – you can learn this information from the label on the cooler- you should be careful during shipment and installation to prevent your appliance's cooler elements from being damaged. Although R600a is an environmentally friendly and natural gas. As it is explosive, in the event of a leak due to damage to the cooler elements, move your fridge from open flame or heat sources and ventilate the room where the appliance is located for a few minutes.
  - While carrying and positioning the fridge, do not damage the cooler gas circuit.
  - Do not store explosive substances such as aerosol cans with a flammable propellant in this appliance.
  - This appliance is intended to be used in household and similar applications such as;
    - staff kitchen areas in shops, offices and other working environments
    - farm houses and by clients in hotels, motels and other residential type environments
    - bed and breakfast type environments;
    - catering and similar non-retail applications
- If the socket does not match the refrigerator plug, it must be replaced by the manufacturer, its service agent or similarly qualified persons in order to avoid a hazard.
  - A specially grounded plug has been connected to the power cable of your refrigerator. This plug should be used with a specially grounded socket of 13 amperes. If there is no such socket in your house, please have it installed by an authorized electrician.
  - This appliance can be used by children aged from 8 years and above and persons with reduced physical, sensory or mental capabilities or lack of experience and knowledge if they have been given supervision or instruction concerning use of the appliance in a safe way and understand the hazard involved. Children shall not play with the appliance. Cleaning and user maintenance, shall not be made by children without supervision.
  - If the supply cord is damaged, it must be replaced by the manufacturer, its service agent or similar qualified persons in order to avoid a hazard.
  - This appliance is not intended for use at altitudes exceeding 2000 m.



## Safety information

**Important** - Please read these instructions fully before installing or operating

### Old and out-of-order fridges

- If your old fridge has a lock, break or remove the lock before discarding it, because children may get trapped inside it and may cause an accident.
- Old fridges and freezers contain isolation material and refrigerant with CFC. Therefore, take care not to harm environment when you are discarding your old fridge.

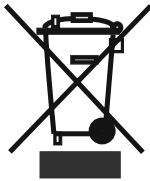

Please ask your municipal authority about the disposal of the WEEE for the reuse, recycle and recovery purposes.

### Notes:

- Please read the instruction manual carefully before installing and using your appliance. We are not responsible for the damage occurred due to misuse.
- Follow all instructions on your appliance and instruction manual, and keep this manual in a safe place to resolve the problems that may occur in the future.
- This appliance is produced to be used in homes and it can only be used in domestic environments and for the specified purposes. It is not suitable for commercial or common use. Such use will cause the guarantee of the appliance to be cancelled and our company will not be responsible for the losses to be occurred.
- This appliance is produced to be used in houses and it is only suitable for cooling / storing foods. It is not suitable for commercial or common use and/or for storing substances except for food. Our company is not responsible for the losses to be occurred in the contrary case.

### Safety warnings

- Do not use multiple receptacles or extension cord.
- Do not plug in damaged, torn or old plugs.
- Do not pull, bend or damage the cord.
- This appliance is designed for use by adults, do not allow children to play with the appliance or let them hang off the door.
- Do not plug-in or out the plug from the receptacle with wet hands to prevent electrocution!
- Do not place glass bottles or beverage cans in the freezer department. Bottles or cans may explode.
- Do not place explosive or flammable material in your fridge for your safety. Place drinks with higher alcohol amount vertically and by closing their necks tightly in the fridge department.
- When taking ice made in the freezer department, do not touch it, ice may cause ice burns and/or cuts.
- Do not touch frozen goods with wet hands! Do not eat ice-cream and ice cubes immediately after you have taken them out of the freezer department!
- Do not re-freeze frozen goods after they have melted. This may cause health issues like food poisoning.
- Do not cover the body or top of fridge with lace. This affects the performance of your fridge.
- Fix the accessories in the fridge during transportation to prevent damage to accessories.

# Getting to know your Combi Fridge-Freezer

# 2

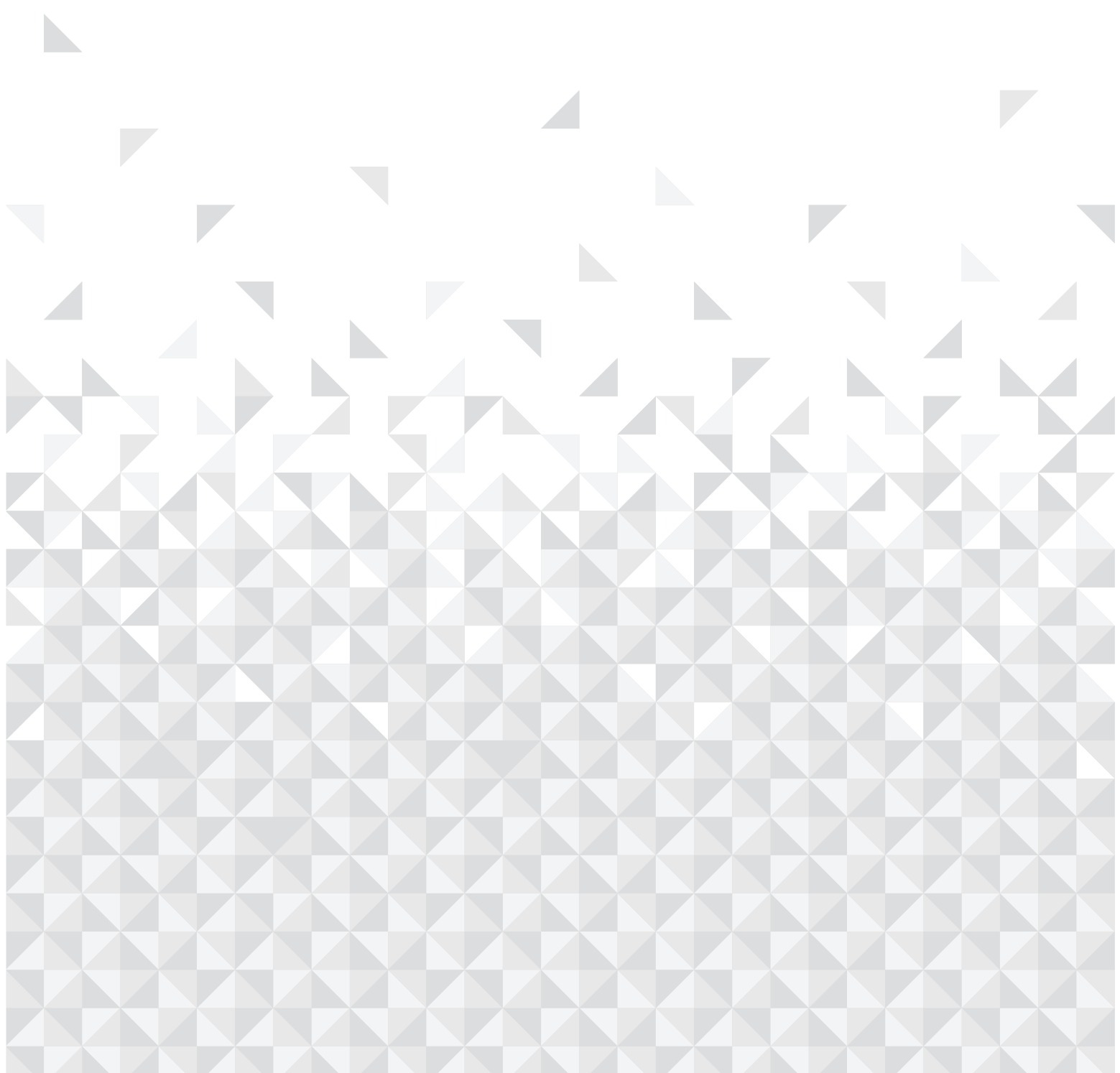

# Getting to know your Combi Fridge-Freezer

You'll be up and running in no time

## Ready? Let's begin...

Please read these instructions carefully. They contain important information which will help you get the best from your Combi Fridge-Freezer and ensure safe

and correct installation and operation.

If you require any further assistance, our technical experts are happy to help. For full details, refer to the product support section at the end of these instructions.



# Getting to know your Combi Fridge-Freezer

You'll be up and running in no time

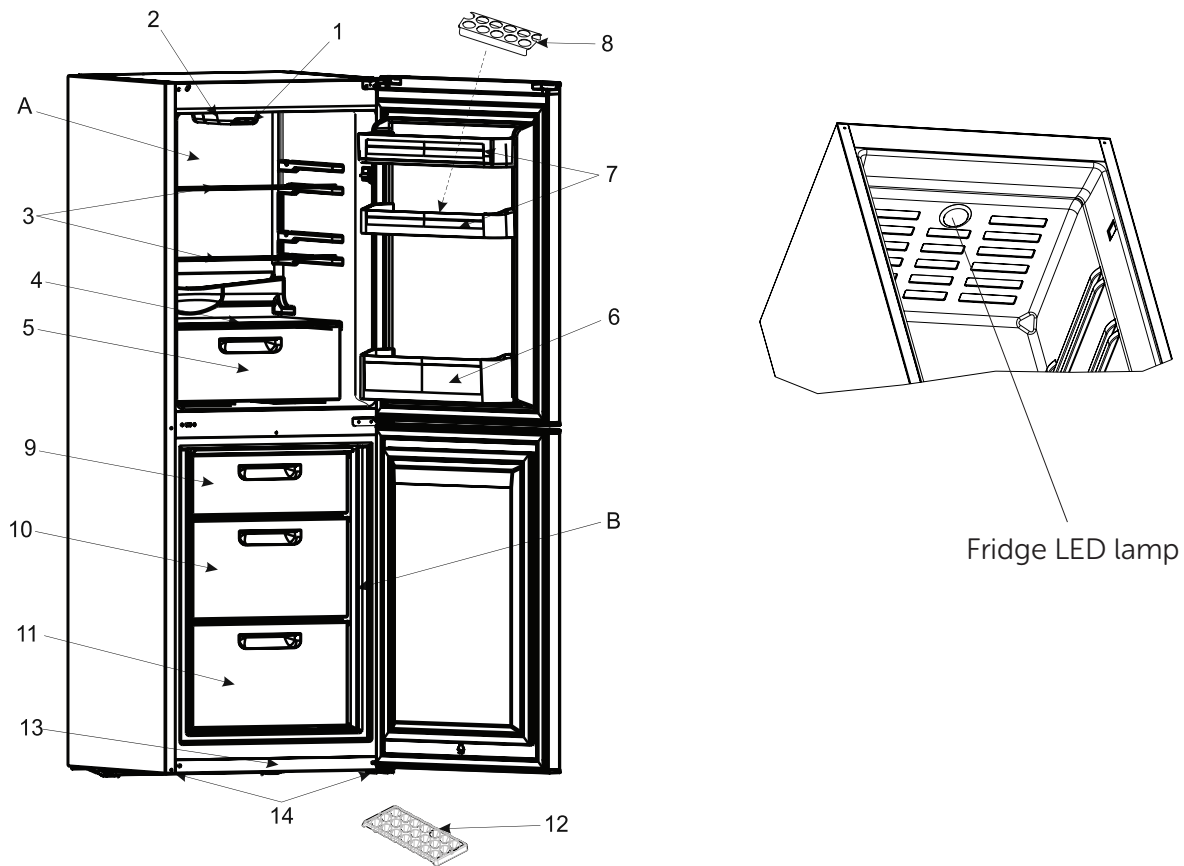

A) Fridge compartment  
B) Freezing compartment

- 1) Thermostat control
- 2) Fridge lamp & cover
- 3) Fridge shelves x2
- 4) Crisper cover x1
- 5) Crisper x1
- 6) Bottle shelf x1
- 7) Cheese - butter shelf x2
- 8) Egg holder x1
- 9) Freezer upper drawer x1
- 10) Freezer middle drawer x1
- 11) Freezer lower drawer x1
- 12) Ice tray
- 13) Kick plate
- 14) Levelling feet



# Installing your Combi Fridge-Freezer

# 3



# Installing your Combi Fridge-Freezer

## Bringing it all together

### Installing and operating your fridge

Before starting to use your fridge, you should pay attention to the following points:

- Operating voltage for your fridge is 220-240 V at 50Hz.
- We do not take the responsibility of the damages that occur due to ungrounded usage.
- Do not place your appliance in direct sunlight.
- Your appliance should be at least 50 cm away from stoves, gas ovens and heater cores, and should be at least 5 cm away from electrical ovens.
- Your fridge should never be used outdoors or left under the rain.
- When your fridge is placed next to a deep freezer, there should be at least 2 cm between them to prevent humidity on the outer surface.
- Do not place anything on your fridge, and install your fridge in a suitable place so that at least 15 cm is available on the upper side.
- The adjustable front legs should be stabilized in an appropriate height to allow your fridge to operate in a stable and proper way. You can adjust the legs by turning them clockwise (or in the opposite direction). This should be done before placing food in the fridge.
- Before using your fridge, wipe all parts with warm water added with a tea spoonful of sodium bicarbonate, and then rinse with clean water and dry. Place all parts after cleaning.
- Install the distance adjustment plastic (the part with black vanes at the rear) by turning it 90° as shown in the figure to prevent the condenser from touching the wall.
- Refrigerator should be placed against a wall with a free distance not exceeding 75 mm.

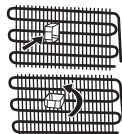

### Before Using Your Fridge

- Before switching on your appliance for the first time, ensure it is positioned in its desired final location and is in its upright position for at least 3 hours before plugging in and switching on the power. Otherwise you may damage the compressor.
- You may experience an odour from the appliance when it is operated for the first time. This is normal and will fade when your appliance starts to cool.

### Shipment and Repositioning

- Original package and foam may be kept for retransportation (optionally).
- You should fasten your fridge with thick package bands or strong cords and follow the instructions for transportation on the package for retransportation.
- Remove movable parts (shelves, accessories, vegetable bins etc.) or fix them into the fridge against shocks using bands during repositioning and transportation.

Carry your fridge in the upright position.

### Repositioning the door

- It is not possible to change the opening direction of your fridge door, if the door handles on your fridge are installed from the front surface of the door.
- It is possible to change the opening direction of the door on models without any handles.
- If the door opening direction of your fridge may be changed, you should contact the nearest Authorised Service to have the opening direction changed.

# Installing your Combi Fridge-Freezer

## Bringing it all together

### Electrical Connection (For UK type plug)

For your safety please read the following information

**Warning:** This appliance must be earthed.

This appliance operates from 220-240 volts and should be protected by a 13 amp fuse in the plug.

The appliance is supplied with a standard 13 amp 3-pin mains plug fitted with a 13-amp fuse.

Should the fuse require replacement, it must be replaced with a fuse rated at 13 amp and approved to BS1362.

If the mains plug which is fitted is unsuitable for the socket outlet in your home or is removed for any other reason, please follow the instructions below on how to wire a 13 amp 3 pin plug.

The wires in the mains lead on this appliance are coloured in accordance with the following code:

**Green and Yellow – Earth**

**Blue – Neutral**

**Brown – Live**

As the colours may not correspond with the markings identifying the terminals in your plug proceed as follows.

The green and yellow wire must be connected to the terminal in the plug which is marked with the letter E or with the earth symbol or coloured green and yellow.

The blue wire must be connected to the terminal marked N.

The brown wire must be connected to the terminal marked L.

You must make sure the lead is firmly secured under the cord clamp.

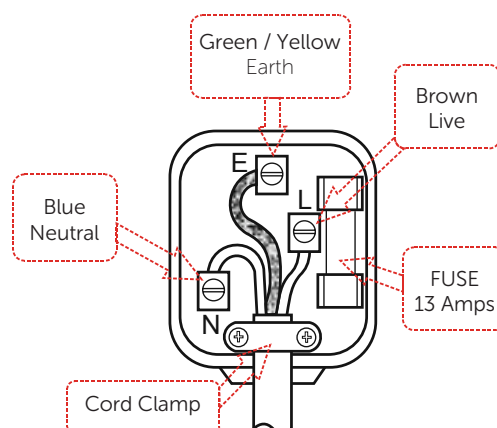

# Functions 4

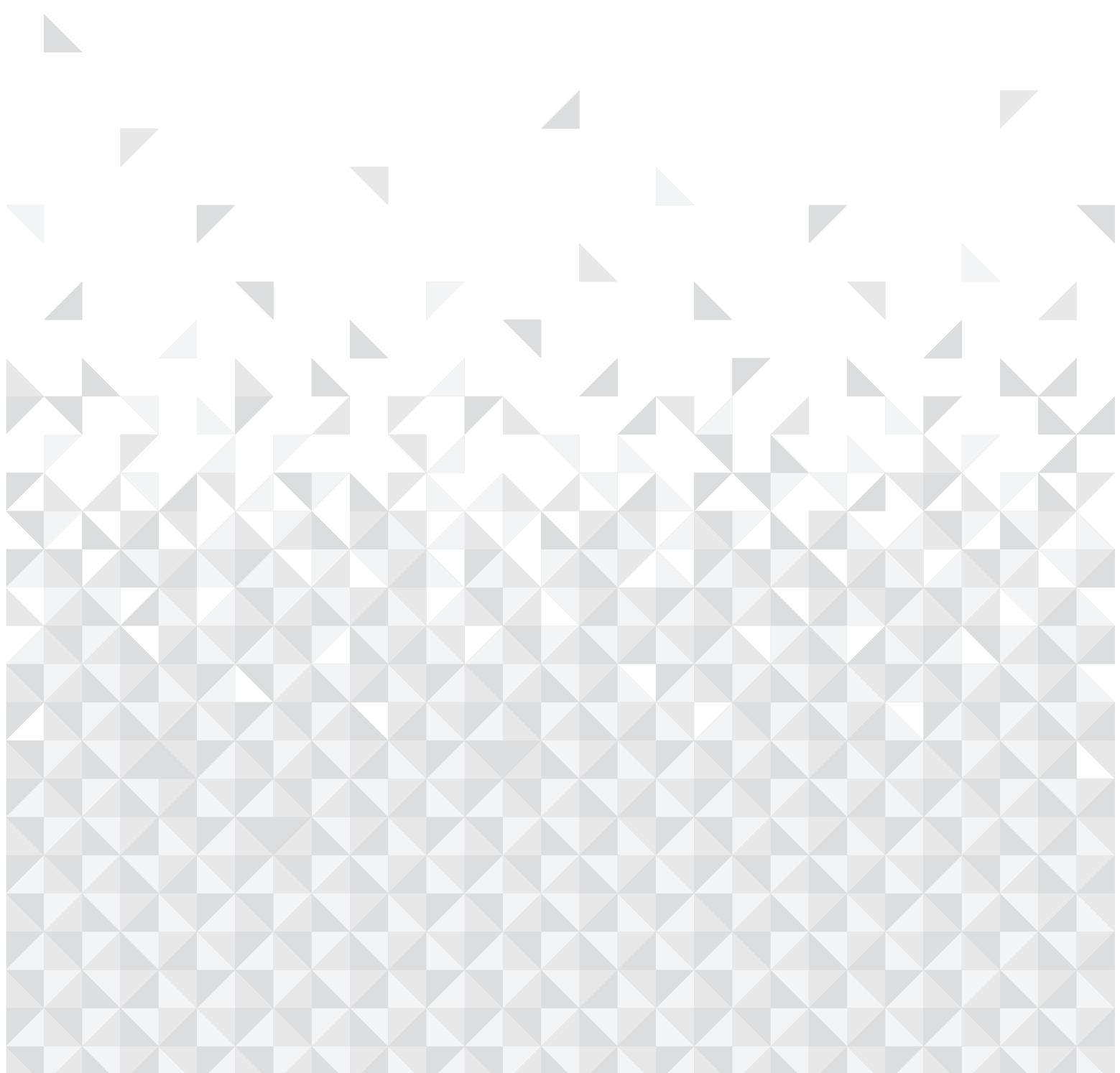

## Functions

Simple everyday use

### Display and control panel

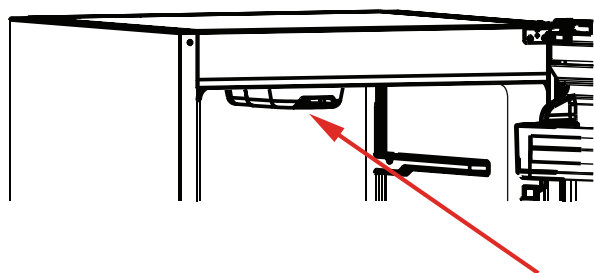

Thermostat Control

The fridge freezer thermostat automatically regulates the inside temperature of the compartments. By rotating the knob from position 1 to 5, colder temperatures can be obtained.

#### Thermostat setting;

1 – 2 : For short-term storage of food in the freezer compartment, you can set the knob between the minimum and medium position.

3 – 4 : For long-term storage of food in the freezer compartment, you can set the knob to the medium position.

5 : For freezing fresh food. The appliance will work for longer. So, after the desired condition is reached, return the knob to the previous setting.

### Warnings about temperature adjustments

- It is not recommended that you operate your fridge freezer in environments colder than 10°C in terms of its efficiency.
- Temperature adjustments should be made according to the frequency of door openings and the quantity of food kept inside the fridge freezer.
- When you first switch on the appliance, you should ideally try to run it without any food in for 24 hours and not open the door. If you need to use it straight away, try not to put a large quantity of food inside.
- A 5 minute delay function is included to prevent damage to the compressor of your fridge freezer, when you unplug it and then plug it in again to operate it, or when an energy breakdown occurs. Your fridge freezer will start to operate normally after 5 minutes.
- Your fridge freezer is designed to operate in the ambient temperature intervals stated in the standards, according to the climate class stated in the information label. It is not recommended that your fridge freezer is operated in the environments which are out of the stated temperature intervals. This will reduce the cooling efficiency of the fridge.
- This appliance is designed for use at an ambient temperature within the 16°C - 32°C range.

| Climate Class | Ambient Temperature °C |
|---------------|------------------------|
| T             | Between 16 and 43 (°C) |
| ST            | Between 16 and 38 (°C) |
| N             | Between 16 and 32 (°C) |
| SN            | Between 10 and 32 (°C) |

## Functions

Simple everyday use

### Accessoires

#### Ice tray

- Fill the ice tray with water and place in the freezer compartment.
- After the water has completely turned into ice, you can twist the tray as shown below to remove the ice cubes.

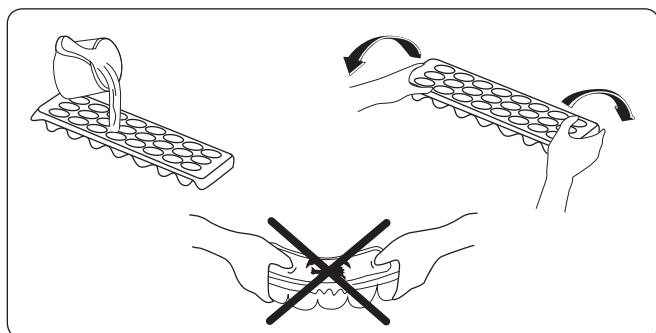

#### Bottle holder

In order to prevent bottles from slipping or falling over, you can use the bottle holder. This will also help to prevent the noise made by bottles when opening or closing the door.

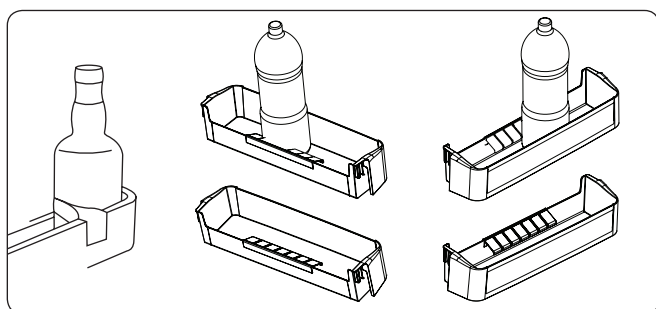

(Visual and text descriptions on the accessories section may vary according which model you have.)

### Information on the Frost Free Technology

The Frost Free refrigerators are different from the other static refrigerators in terms of their operational system.

In normal fridges, the humidity entering the fridge due to opening the door and the humidity inherent in the food causes freezing in the freezer department. To defrost the frost and ice in the freezer compartment, you are periodically required to turn off the fridge, place the food that needs to be kept frozen in a separately cooled container and remove the ice gathered in the freezer department.

The situation is completely different in no-frost fridges. Dry and cold air is blown into the fridge and freezer compartments homogeneously and evenly from several points via a blower fan. Cold air dispersed homogeneously and evenly between the shelves cools all of your food equally and uniformly, thus preventing humidity and freezing.

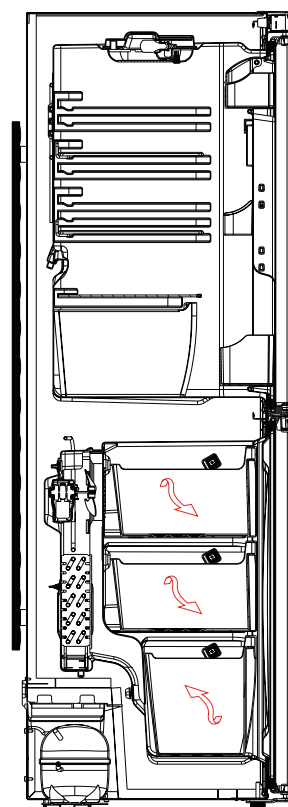



# Using your Combi Fridge-Freezer

# 5





# Using your Combi Fridge-Freezer

## Getting the most from your appliance

### Arranging Food in the Appliance

#### Cooling compartment

- The refrigerator compartment is used for storing fresh food for a few days.
- Do not place food in direct contact with the rear wall of the refrigerator compartment. Leave some space around food to allow the circulation of air.
- Do not place hot food or evaporating liquid in the refrigerator.
- Always store food wrapped, or in closed containers.
- To reduce humidity and avoid formation of frost, never place liquids in unsealed containers in the refrigerator.
- We recommend meat is loosely wrapped and placed on the glass shelf just above the vegetable bin, where the air is colder.
- Store fruit and vegetable items loose in the crisper containers.
- To avoid cold air escaping, try not to open the door too often, and do not leave the door open for a long time.

NOTE: Potatoes, onions and garlic should not be stored in the refrigerator. Meat should never be frozen after it has thawed (if it has not been cooked).

Some recommendations have been specified below for the placement and storage of your food in the cooling compartment.

#### The deep freeze compartment

- Use the deep freeze compartment of your refrigerator for storing frozen food for a long time and producing ice.
- Place the food you would like to freeze initially in the upper basket of the freezer. Please do not place food near the already frozen food. You may place your food next to the other frozen food once it has frozen (for at least 24 hours).
- You should freeze your food (meat, minced meat, fish, etc.) by dividing them into portions

in such a way that they can be consumed in portions.

- Please do not refreeze frozen food once it is thawed. It may pose a danger for your health.
- Do not place hot meals in your deep freeze before they are cold.
- When buying frozen food ensure that it has been frozen at a suitable temperature and that the packing is intact.
- When storing frozen food; the instructions shown on frozen food packaging should always be followed carefully and if no information is provided, food should not be stored for more than 3 months from the purchase date.
- Frozen food should be transported in appropriate containers and placed in the freezer as soon as possible. Do not use door shelves for freezing.
- The storage duration of frozen food changes depending on the environment temperature, the frequent opening and closing of the doors, thermostat settings, food type and the length of period that has elapsed from the time the food was bought to the time it entered the freezer. Always follow the instructions on the packaging and never exceed the storage duration.

# Using your Combi Fridge-Freezer

## Getting the most from your appliance

### Tips for Saving Energy

1. Install the appliance in a cool, well ventilated room, but not in direct sunlight or near heat sources (radiators, cooker, etc....).
2. Allow warm food and drinks to cool down before placing in the appliance.
3. When thawing frozen food, place it in the refrigerator compartment. The frozen food will help to cool the refrigerator compartment when it is thawing.
4. When placing liquids in the appliance they must be covered.
5. When placing food and drinks, open the appliance door as briefly as possible.
6. Keep closed the covers of any different temperature compartments in the appliance (crisper, chiller ...etc ).
7. Door seals should be kept clean and undamaged.

# Care and maintenance

6

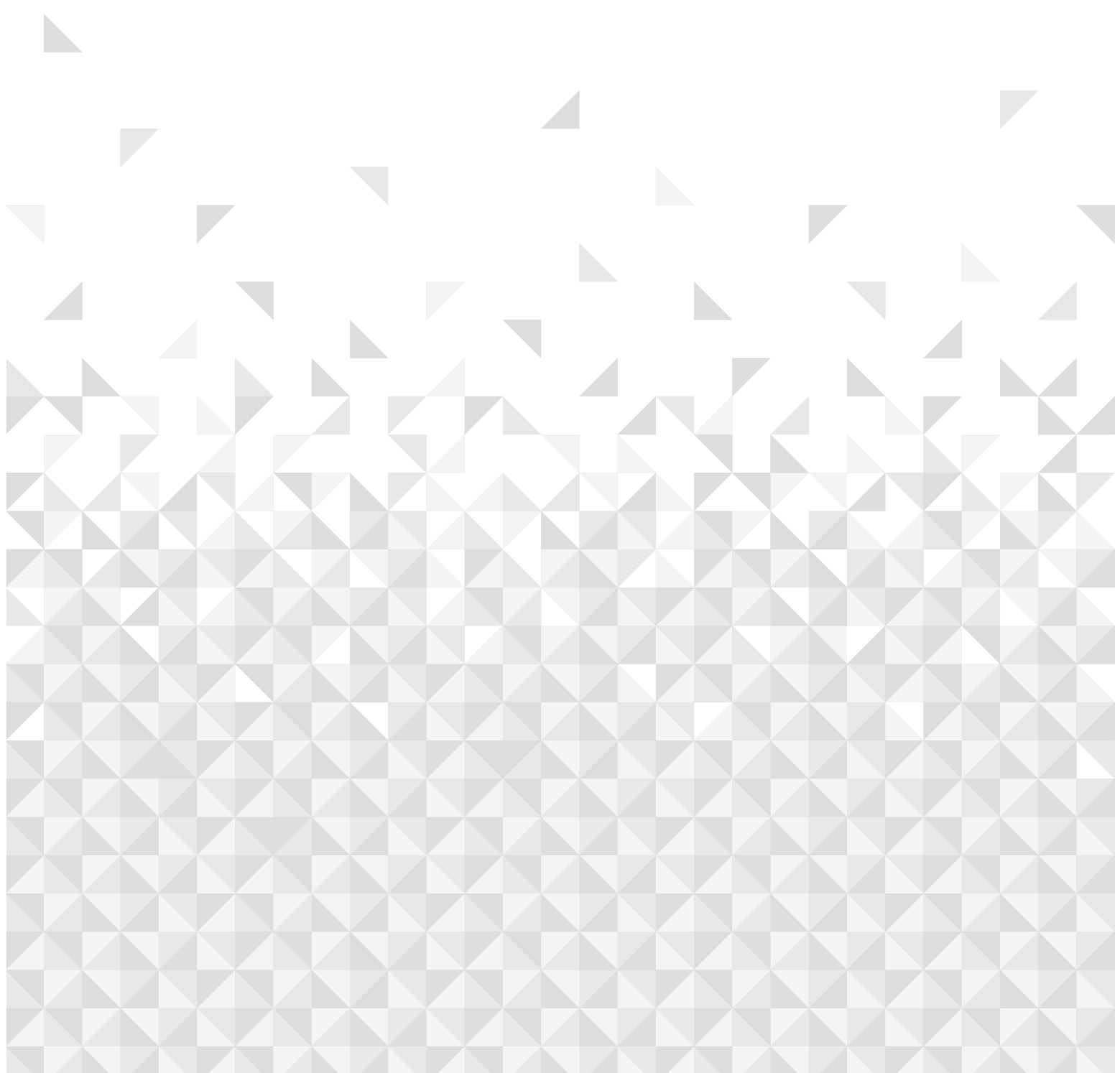

## Care and maintenance

### Looking after your appliance

#### Cleaning

- Make sure you unplug the fridge before starting to clean it.
- Do not pour water directly over your appliance.
- You can wipe the inner and outer sides with a soft cloth or a sponge using warm soapy water.
- Remove parts individually and clean by hand with soapy water. Do not place in dishwashers.
- Never use flammable, explosive or corrosive material for cleaning your appliance
- You should clean the condenser periodically to keep your appliance running efficiently.

Make sure your appliance is unplugged before cleaning.

#### Defrosting

- Your refrigerator performs fully automatic defrosting. The water formed as a result of defrosting passes through the water collection spout, flows into the vaporization container behind your refrigerator and evaporates by itself in there.
- Make sure you have disconnected the plug of your refrigerator before cleaning the drainage tray.
- Remove the drainage tray from its position by unscrewing the screws as indicated. Clean it with soapy water periodically to avoid odours and smells.

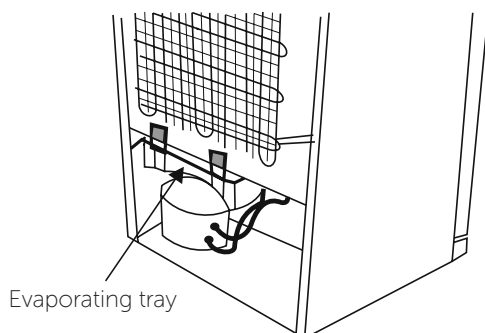

#### Replacing the LED

Contact the Bush helpline.

## Care and maintenance

Looking after your appliance

### Technical specification

|  |  |
|--|--|
| Supplier's name or trademark                   | <b>BUSH</b>                            |
| Model / Item                                   | BFFX54152W<br>BFFX54152S<br>BFFX54152B |
| Type of appliance                              | GN271S                                 |
| Energy efficiency class                        | A+                                     |
| Voltage  | 220-240V / 50 Hz                       |
| Energy consumption                             | 0.597 kWh/24h - 218 kWh/year           |
| Net storage volume of fresh food               | 124 lt.                                |
| Net storage volume of frozen food              | 60 lt.                                 |
| Star rating of frozen food storage compartment | 4 (****)                               |
| Power cut failure safe storage                 | 13 hours (25°C)                        |
| Freezing capacity                              | 3 Kg                                   |
| Climate class                                  | N (16°C - 32°C)                        |
| Size (mm) (W x D x H)                          | 540 x 610 x 1520                       |
| Noise  | 42 dB (A)                              |

We apologise for any inconvenience caused by minor change or inconsistencies in these instructions that may occur as a result of product improvements and development.



Product support

7

## Product support

Help is always at hand

### Check Warnings;

Your fridge warns you if the temperatures for cooler and freezer are in improper levels or when a problem occurs in the appliance.

### What to do if your appliance does not operate

#### Check that:

- There is no power,
- The general switch in your home is disconnected,
- The socket is not faulty. To check this, plug the appliance in to another socket which you know is working.

### What to do if your appliance performs poorly

#### Check that:

- You have overloaded the appliance,
- The thermostat setting is on position "1" (if so set the thermostat dial to a suitable value).
- The doors are closed properly,
- There is no dust on the condenser,
- There is enough space at the rear and side walls.
- If your fridge is operating too loudly

### Normal Noises

#### Cracking (Ice cracking) Noise:

- During automatic defrosting.
- When the appliance is cooled or warmed (due to expansion of appliance material).
- Heard when the thermostat switches the compressor on/off.

#### Compressor noise

- Normal motor noise. This noise means that the compressor operates normally
- Compressor may cause more noise for a short time when it starts.

#### Bubbling noise and splash:

- This noise is caused by the flow of the refrigerant in the tubes of the system.

#### Water flow noise:

- Normal flow noise of water flowing to the evaporation container during defrosting. This noise can be heard during defrosting.

#### Air Blow Noise:

- Normal fan noise. This noise can be heard in No-Frost fridges during normal operation of the system due to the circulation of air.
- If you hear any other sounds, check that:
  - The appliance is level
  - Nothing is touching the rear of the appliance
  - Items on the appliance are vibrating.

#### If there is water in the lower part of the refrigerator,

##### Check that:

- The drain hole for the water is not clogged (use the defrost drain plug to clean the drain hole).

#### Recommendations

- If you do not intend to use the appliance for long time (for example during the summer holidays) unplug and clean the appliance and leave the door open to prevent the formation of mildew and smells.
- To stop the appliance completely, unplug it from the main socket (for cleaning and when the doors are left open).
- If a problem persists after you have followed all the instructions above, please consult the nearest Authorised Service Centre.
- The lifetime of your appliance is stated and declared by the Department of Industry. The length of time for retaining parts required for the proper operation of the appliance is 10 years.

## Product support

Help is always at hand

## Help and assistance

If you require any technical guidance or find that your Combi Fridge-Freezer is not operating as intended, a simple solution can often be found in the **Troubleshooting** section of these instructions or online at [www.argos-support.co.uk](http://www.argos-support.co.uk)

If you still require further assistance, call one of our experts on 0345 257 7271\*. To help give us give you a fast and efficient service please have the following information ready:

Model Ref.

Serial number

Date of purchase

You can find these on the rating plate - a small information panel (usually a sticker or metal plate) on the rear of your appliance

This will be shown on your receipt

Local call rates applies\*

Lines open 8am-7pm Monday to Saturday and 10am-4pm Sunday.

\*Calls to Argos enquiry lines may attract a charge and set up fee from residential lines depending on your call plan/tariff . Mobile and other providers costs may vary, see [www.bt.com/pricing](http://www.bt.com/pricing) for details.

For Security and training purposes, telephone calls to and from customer service centres maybe recorded and monitored. Calls from Republic of Ireland will attract international call charges.



## Product support

Help is always at hand

## Disposal

- The symbol on the product or on its packaging indicates that this product may not be treated as household waste. Instead it shall be handed over to the applicable collection point for the recycling of electrical and electronic equipment.
- By ensuring this product is disposed of correctly, you will help prevent potential negative consequences for the environment and human health, which could otherwise be caused by inappropriate waste handling of this product.
- For more detailed information about recycling of this product, please contact your local city office, your household waste disposal service or the shop where you purchased the product.

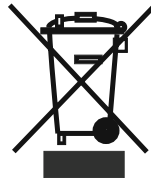

## Product support

Help is always at hand

## Guarantee

# BUSH

Call us now and activate your 12 month guarantee

Thank you for choosing Bush. Your new product is guaranteed against faults and breakdowns for 12 months. Don't forget to register it with us today so we can provide you with our best possible after-sales service and useful updates.

[www.bushregistration.co.uk](http://www.bushregistration.co.uk)

FREEPHONE\*

0800 597 8548

Lines are open 8am - 8pm, 365 days a year. \*Calls may be recorded and monitored.

## Your Bush Guarantee

This product is guaranteed for twelve months from the date of original purchase. Any defect that arises due to faulty materials or workmanship will be repaired free of charge (or if applicable the product will be replaced or the purchase price refunded) where possible during this period by the dealer from who your purchased the unit.

The guarantee is subject to the following provisions:

- The guarantee does not cover accidental damage, misuse, cabinet parts, knobs or consumable items.
- The product must be correctly installed and operated in accordance with the instructions contained in the manual.
- It must be used solely for domestic purposes. The guarantee will be rendered invalid if the product is re-sold or has been damaged by inexpert repair.
- Specifications are subject to change without notice.
- Bush disclaim any liability for loss or damage arising from the breakdown of the product.
- This guarantee is in addition to and does not diminish your statutory or legal rights.

## Important Data Protection Information

If you provide us with information about another person, you confirm that they have appointed you to act for them, to consent to the processing of their personal data including sensitive personal data and that you have informed them of our identity and the purposes (as set out in the Important Data Privacy notice displayed overleaf) for which their personal data will be processed.

You are entitled to ask for a copy of the information we hold about you (for which we may charge a small fee) and to have any inaccuracies in your information corrected.

For quality control and training purposes, we may monitor or record your communications with us.

If your personal details change, if you change your mind about any of your marketing preferences or if you have any queries about how we use your information, please let us know by contacting our Data Protection Officer, Domestic & General, Leicester House 17 Leicester Street, Bedworth, Warwickshire CV12 8JP.

**Guarantor:** Argos Limited - 489 - 499 Avebury Blvd. - Milton Keynes - MK9 2NW

If you require any technical guidance or find that your product is not operating as intended, a simple solution can often be found in the **Troubleshooting** section of these instructions,



# BUSH

**Contact:**

[www.argos-support.co.uk](http://www.argos-support.co.uk)

Helpline: 0345 257 7271

52234150