

vax™

Air™ Lift
STEERABLE

**POWERFUL UPRIGHT
WITH LIFT OUT CYLINDER**

LET'S GET STARTED.

**UCPESHV1
UCPMSHV1
UCUESHV1
UCSUSHV1**



Let's talk safety



Basic safety precautions

This vacuum cleaner is intended for household use only and NOT for commercial or industrial use.

- This vacuum cleaner can be used by children aged from 8 years and above and persons with reduced physical, sensory or mental capabilities or lack of experience and knowledge if they have been given supervision or instruction concerning use of the vacuum cleaner in a safe way and understand the hazards involved. Children shall not play with the vacuum cleaner. Cleaning and user maintenance shall not be made by children without supervision.



Don'ts

- Don't use the vacuum cleaner if it has been dropped, damaged or left outdoors.
- Don't run over the power cord or use the vacuum cleaner if the power cord or plug is damaged. If the power cord is damaged, it must be replaced by the manufacturer, its service agent or similarly qualified persons in order to avoid a hazard.
- Don't handle the plug or use the vacuum cleaner with wet hands.
- Don't pull or carry the vacuum cleaner by the power cord. Don't use the power cord as a handle, pull the power cord around corners, sharp edges or close a door over the power cord. Don't unplug the vacuum cleaner by pulling on the power cord.



Do's

- Turn off all controls on the vacuum cleaner before disconnecting or connecting the plug from the mains socket.
- Always keep the power cord away from the brushes during use. After use always wrap the power cord around the cord hooks provided.
- Always make sure both the pre-motor/post-motor filters are in place before use.
- Hold the lift out cylinder by the carry handle at all times when the lift out cylinder is detached for stair and above floor cleaning.
- Always make sure the brushbar is set to hard floor when using the hose and accessories or when using on the stairs. Take extra care when positioning the vacuum cleaner on the stairs.
- Always switch off the vacuum cleaner before disconnecting or connecting the hose and accessories.

- Only use the vacuum cleaner indoors on dry surfaces and keep the area you're cleaning well lit.
- Keep fingers, hair and loose clothing away from moving parts and openings whilst using the vacuum cleaner.
- Only Vax recommended tools should be used with the vacuum cleaner, use of non-branded Vax accessories/tools will invalidate your warranty.
- Unplug and switch off the vacuum cleaner before performing maintenance or troubleshooting checks. If the brushbar has been obstructed, the brush bar motor protection sensor may have been activated. The brushbar will stop and the light on the floorhead will illuminate red.

- Don't vacuum up hard or sharp objects such as glass, nails, screws or coins etc.
- Don't vacuum up any flammable or combustible materials (lighter fluid, petrol, kerosene etc) or use the vacuum cleaner in an area with explosive vapours or liquid.
- Don't vacuum up hot coals, cigarette butts, matches or smoking hot burning items or use in an area where there may be harmful fluids (chlorine, bleach, and ammonia drain cleaner).
- Don't attempt to remove blockages with sharp objects as this may cause damage to the vacuum cleaner, remove blockages only as instructed in this guide.
- Don't use the vacuum cleaner with incorrect voltage as this may result in damage or injury to the user. The correct voltage is listed on the ratings label.

- Keep all openings clear and free from debris as this may affect the airflow/suction.
- Always replace the fuse in the plug with a British 13amp fuse. Always protect the power cable from heated surfaces and open flames.
- Use only CE approved 13amp extension cords, non-approved extension cords may overheat. Care should be taken to arrange the extension cord as it can be a trip hazard.
- Always check the floorhead and accessories are free from damage, dirt and debris before use.
- Store the vacuum cleaner in a cool, dry area. If the filters have been cleaned as per user the guide instructions ensure they are thoroughly dry before storing away.

PLEASE KEEP INSTRUCTIONS FOR FURTHER USE AND USE ONLY AS INSTRUCTED IN THIS GUIDE.

Thank you for buying this Air™ Lift Steerable.

Taking care of your carpets and hard floors

The Air™ Lift Steerable is designed to make vacuuming carpets and hard floors regularly, as effective and efficient as possible and this user guide will help you get the most out of your machine.

Maintaining your carpets and hard floor will ensure they keep their appearance for longer. You've chosen the carpets and hard floors for your home for a reason and Vax will help you take good care of them.

Taking care of your Air™ Lift Steerable

Also inside this guide are instructions on maintaining your new machine, so that it's always ready when you are to tackle your carpets and hard floors.

We're here if you need us

Instead of taking me back to the shop, simply visit our online support:

vax.co.uk/support

Still need to get in touch?

Our UK based Customer Care Team are here to support you. For help with assembly, operational or performance problems, or buying and fitting new accessories, you can find all our contact details at **vax.co.uk/contact**

This user guide can be found online at: **vax.co.uk/support**

The Vax logo is displayed in a bold, orange, sans-serif font. The letters 'V' and 'A' are significantly larger than the 'X'. A small 'TM' trademark symbol is positioned to the upper right of the 'X'. The logo is set against a white background within an orange-bordered speech bubble.

Contents

- Let's talk safety
- Getting to know your machine
- Getting started
- Using your machine
- Taking care of your machine
- Let's talk technical
- What to do if it goes wrong
- Getting in touch
- Accessories
- Notes

Initial Setup for normal operation

1. Use the base accessories.
 - Shortest hose.
 - Extension tube set to shortest practicable length.
2. Clean filters installed.
3. Dust receptacle empty.
4. All Bleeds must be closed.
5. Floorheads/tools set to Carpet Mode for carpet cleaning.
6. Floorheads/tools set to Hard floor Mode for hard floor cleaning.

Air™ Lift Steerable Pet

Included with all models



3-in-1 Tool
(Crevice, Dusting
and Upholstery Tool)



TurboTool



Hard Floor Adaptor

Air™ Lift Steerable Pet Max

As per Air™ Lift Steerable Pet, plus



Fur 'n' Fluff Tool

Air™ Lift Steerable Pet Pro

As per Air™ Lift Steerable Pet
(but excludes 3-in-1 tool), plus



2-in-1 Crevice Tool
and Dusting Brush



Flat Upholstery Tool

Air™ Lift Steerable Advance

As per Air™ Lift Steerable Pet, plus



Mattress Tool



Fur 'n' Fluff Tool



Soft Dusting Brush



High Angle Tool

Getting to know your machine

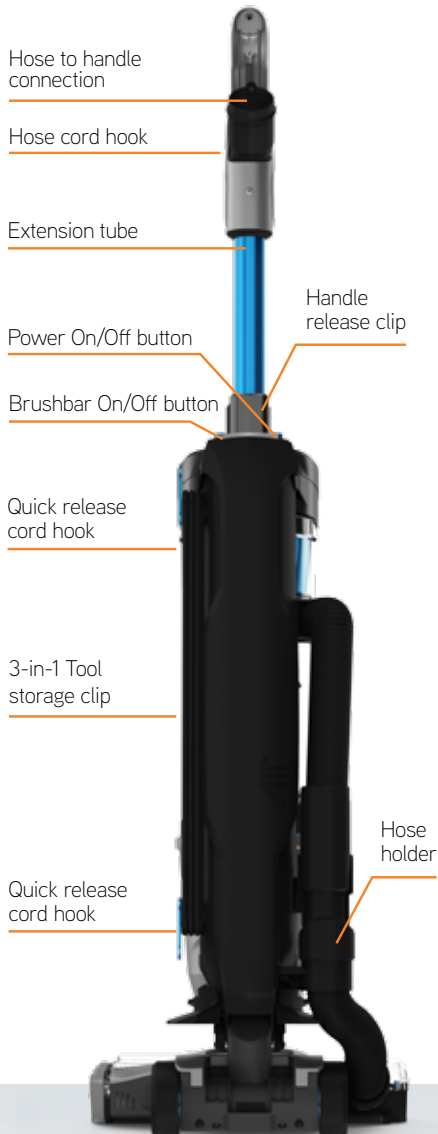

Technical Specification

Name **Air™ Lift Steerable Series**

Voltage **220-240V**

Wattage **Full product: 850W**
Lift out: 750W

Frequency **50Hz**

Cord length **9m**

Subject to technical change without notice.

Accessories & Consumables

Filter Kit (Type 90)
1-1-134227

Belt
1-7-139141

Pro Cleaning Kit (Type 2)
1-1-133326

TurboTool
1-9-136064

3-in-1 Tool
1-1-129167

Fur 'n' Fluff Tool
1-1-131392

Mattress Tool
1-1-133837

To purchase consumables and accessories, please visit vax.co.uk

PLEASE READ 'LET'S TALK SAFETY' AT THE BEGINNING BEFORE USE

Before you begin cleaning

WARNING: Always switch off the vacuum cleaner before connecting or disconnecting the lift out cylinder/ hose/attachments or removing and emptying the dirt container.

IMPORTANT: The vacuum cleaner is equipped with a thermal cut-out. If for any reason the vacuum cleaner does overheat the thermostat will automatically turn the vacuum cleaner off. If this happens switch the vacuum cleaner off and unplug from electrical socket. Remove and empty the dirt container also check the vacuum cleaner for blockages. If the vacuum cleaner is blocked, switch off and unplug before removing the blockage. Allow the vacuum cleaner to cool for approximately 1 hour (if you have cleaned the filters please wait 24 hours for the filters to fully dry before putting back into the machine).

For best cleaning results, filters should be tapped over a bin every 4-6 uses to remove dirt and debris and washed every 3 to 6 months (depending on the level of use).

Assembling your upright



Place the lift out cylinder onto the back panel and floorhead.



In a hinge like manner push the lift out cylinder backwards until it clicks into place.



Push the handle with extension tube into the back panel of the vacuum cleaner. The handle will click into position when correctly fitted.



Place the 3-in-1 tool onto the storage clip.

Using your machine - The full unit

Using with the lift out cylinder attached



Twist the quick release cord hooks and release the power cord.



Plug the vacuum cleaner into the mains and switch on.



Hook the cord onto the handle cord hook so that the cord does not get pulled, caught or tangled in the machine during use.



Place foot on the floorhead and pull the handle backwards to recline.



Press the On/Off button to switch the vacuum cleaner on.



Press the brushbar button to activate the brushbar. The brushbar should be ON for carpets and OFF for hard floors.



Slide the air vent cover open to reduce suction, if required on high piled carpets.



For maximum cleaning on hard floors, close the air vent cover.

When the vacuum is reclined with the brushbar switched on, never leave the vacuum in one position for any long period of time.

CAUTION



Whilst using the whole unit, don't forget to use the handle cord hook so that the cord doesn't get pulled, caught or tangled in the machine.



Using your machine - The full unit

Using the hose/extension tube/accessories with the lift out cylinder attached

Always switch off the vacuum cleaner before connecting or disconnecting the hose/ tools.

Hold the lift out cylinder by the carry handle at all times when using the hose and accessories. For easier cleaning detach the lift out cylinder for stair and above floor cleaning.



Press the hose end clip and pull to remove the hose from the hose holder.

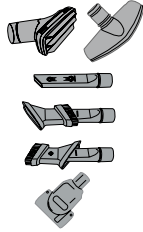

Choose an accessory.



Attach the tool to the end of the hose.



For hard to reach areas remove the handle, attach to the hose and add the chosen tool.



Press the On/Off button to switch the vacuum cleaner on.

Always make sure the brushbar is set to hard floor when using the hose and accessories or when using on the stairs. Take extra care when positioning the vacuum cleaner on the stairs.



Using your machine

Using the hard floor adaptor

IMPORTANT: Always check that the adaptor, wheels and brushbar are free from any dirt or debris before use. Do not use the hard floor adaptor if it has become damaged or worn. Remove any sharp objects from the floor that could become trapped and may scratch or damage the surface. The hard floor adaptor should be removed to vacuum carpets.



Lie the vacuum cleaner on its back exposing the brushbar. Make sure the hard floor adaptor is the correct way round with the wheels on the adaptor facing down and towards the front of the vacuum when fitted.



Line up the adaptor with the base of the vacuum. Hook the curved clips on the back of the adaptor under the wheels on the base of the vacuum.



Push the hard floor adaptor onto the base of the vacuum until the front clips on the adaptor click securely into place.



To remove the adaptor, pull the front clips to unlock.



Pull and lower the adaptor, unhooking the curved clips from the wheels on the base of the vacuum.

Using your machine - The lift away

Using the hose/extension tube/accessories with the lift out cylinder detached

CAUTION: Hold the lift out cylinder by the carry handle at all times when the lift out cylinder is detached for stair and above floor cleaning. Only attach the hose to the vacuum cleaner with the lift out cylinder attached.



Hold the carry handle and press the lift out release button.



Lift and remove the lift out cylinder body off the back panel and floorhead.



Press the hose end clip and pull to remove the hose from the hose holder.

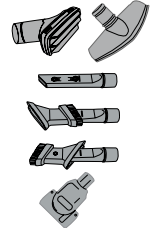

Choose an accessory.



Attach the tool to the end of the hose.



For hard to reach areas remove the handle, attach to the hose and add the chosen tool.



Press the On/Off button to switch the vacuum cleaner on.

Hold the lift out cylinder by the carry handle at all times when the lift out cylinder is detached for stair and above the floor cleaning.

CAUTION



Taking care of your machine

IMPORTANT: The motor is equipped with a thermal cut-out. If for any reason the machine should overheat, the thermostat will automatically turn the machine off. Switch off and unplug the vacuum cleaner. Check the machine for blockages and clean the filters. Wash the filters with warm water (40°C max) and leave for 24 hours or until fully dry before replacing into the machine.

For best cleaning results, filters should be tapped over a bin every 4-6 uses to remove dirt and debris and washed every 3 to 6 months (depending on the level of use). Don't use your vacuum cleaner without all of the filters in place.

Emptying and cleaning the dirt container



Press the dirt container release buttons located the side of the carry handle.



Pull and remove the dirt container off the vacuum cleaner.



Hold the dirt container over a bin, press the dirt release button to open and allow the dirt to fall out.

Don't over fill the dirt container to avoid blocking the air flow through the vacuum cleaner and replace filters every 6-9 months.



Cleaning the pre-motor filter



Lift the dirt container lid release clip. In a hinge like manor lift the dirt container lid.



Pull the pre-motor filter tab and remove the filter from the dirt container.

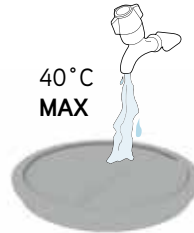

Tap the filter over a bin to remove any dirt/debris. Wash the filter under running water (40 degrees max).

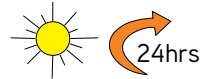

Leave for 24hrs or until fully dry before replacing.

Taking care of your machine

Cleaning the separator



Lift the dirt container lid release clip. In a hinge like manor lift the dirt container lid.



Pull the pre-motor filter tab and remove the filter from the dirt container.



Lift and remove separator out of dirt container. Using a soft brush remove any dirt/debris from separator.



Re fit the separator making sure the semi circular tab on the separator fits into the groove on the dirt container.

Post-motor filter maintenance

IMPORTANT: The post-motor filter is designed to offer long life with no maintenance. The filter should be checked periodically and when heavily discoloured it should be replaced. Please do not wash, scrub or brush the filter as this will damage the filter.



Twist the post-motor filter cover anti clockwise and remove.



Lift and remove the post-motor filter.



Check the post-motor filter for any discolouration.



Don't use your vacuum cleaner without all of the filters in place.

CAUTION



Let's talk technical

IMPORTANT: Unplug and switch off vacuum cleaner before performing maintenance or troubleshooting checks. If the brushbar has been obstructed, the brush bar motor protection sensor may have been activated. The brushbar will stop and the light on the floorhead will illuminate red.

Resetting/removing debris from the brushbar



The brushbar indicator light will illuminate red and the brushbar will stop spinning if the brushbar is obstructed.



Press the On/Off button to switch the vacuum cleaner off. Unplug from the mains.



Lie the vacuum cleaner on its back. Using a pair of scissors remove any threads or hair caught around the brushbar.



Plug in to the mains and recline.



Press the On/Off button to switch the vacuum cleaner on.



Press the brushbar button to activate the brushbar.

Changing the brushbar/advanced brushbar cleaning



Using a crosshead screwdriver, remove 3 screws from the belt cover on the side of the floorhead.



Pull to remove the belt cover and brushbar location plate. Remove belt.



Lift and separate brushbar side cover.



Pull brushbar through side cover to remove. Using a pair of scissors remove any threads or hair caught around the brushbar before refitting.

Changing the belt



Using a crosshead screwdriver, remove 3 screws from the belt cover on the side of the floorhead.



Pull to remove the belt cover.



Pull to remove the brushbar location plate. Remove belt.



Clean any debris from spindle. Place new belt onto spindle, lining up teeth on the belt over and onto the cog.

Removing a blockage from the hose



Press the dirt container release buttons located the side of the carry handle.



Pull and remove the dirt container off the vacuum cleaner.



Pull and remove the hose from the hose holder.



Pull and stretch the hose, any blockage in the hose should then be visible.

Using a broom handle or similar blunt instrument, push into the stretched out hose to remove blockage.



Removing dirt/debris from TurboTool



Slide the locking ring to remove.



Lift and separate the housing. Using a pair of scissors remove any threads or hair caught around the brushbar.



Line up the tabs on front of housing and re-fit. Slide locking ring into groove to secure.

What to do if it goes wrong

Problem

Solution

There is an accessory missing

- Check the 'This pack contains' panel on the box to make sure the part is included with your vacuum cleaner.

Why does my vacuum cleaner have no power?

- The plug may not be fully pushed into the electrical socket.
- Check the fuse in the plug if this needs replacing, always replace with a 13amp British fuse.
- The motor thermostat may have tripped. If this has happened, unplug the vacuum cleaner. Remove and empty the dirt container and check the hose for blockages. Clean the filters and allow the vacuum cleaner to cool for approximately 1 hour (if you have washed the filters you will need to wait 24 hours for the filters to fully dry before putting them back into the vacuum cleaner).

Why won't the vacuum cleaner pick up?

- The dirt container may not be fitted correctly, remove the dirt container and re-attach making sure it is clicked firmly into place.
- The air vent is open on the floorhead, reducing the suction. Go to 'Using your machine - The full unit'.
- The dirt container may be blocked, empty the dirt container and clean the filters. Go to 'Taking care of your machine'.
- There may be a blockage in the hose. Check and clear any blockages. Go to 'Let's talk technical'.
- The brushbar may not be turning. Go to 'Why isn't my brushbar rotating?' below.
- If the accessory/tool will not pick up, check and clear any blockages. Go to 'Let's talk technical'.
- The filters may need cleaning or replacing. Go to 'Taking care of your machine'.

Why isn't my brushbar rotating?

- The brushbar may not have been activated. Go to 'Using your machine - The full unit'.
- The vacuum cleaner may not be reclined. Go to 'Using your machine - The full unit'.
- The lift out cylinder may not be correctly assembled to the back panel and floorhead. Go to 'Assembling your upright'.
- The brushbar may be obstructed. Go to 'Let's talk technical'.
- The brushbar may need resetting. Go to 'Let's talk technical'.
- The belt may be broken. Go to 'Let's talk technical'.

Why is there a red light on my floorhead?

- If the brushbar has been obstructed, the brushbar motor protection sensor may have been activated. The brushbar will stop and the light on the floorhead will illuminate red. Check the brushbar and clear any hair or debris. Go to 'Let's talk technical'.

Why is dust escaping from the vacuum?

- The filters may not be correctly fitted. Go to 'Taking care of your machine'.
- The dirt container may be full or blocked. Go to 'Taking care of your machine'.
- The filters may need cleaning or replacing. Go to 'Taking care of your machine'.
- There may be a blockage in the hose. Go to 'Let's talk technical'.

It's quick and easy to
register for your **FREE**

**2 year
guarantee[†]**

Online at: **vax.co.uk/registration**

Please retain your original receipt for proof of purchase.

we're here if you need us
vax.co.uk/support

Don't forget your accessories!

Order at: www.vax.co.uk/spares-and-solutions

Pro Cleaning Kit (Type 2)

1-1-133326

All our best tools all in one kit that makes cleaning your home quicker, easier and with even better results. We've taken care of cleaning all of the hard to reach areas such as on top of cupboards and in between blinds to the dust that collates behind and within the radiator.



Filter Kit (Type 90)

1-1-134227





GET IN TOUCH

@ info@vax.co.uk  vax.co.uk

EU Statement of Compliance: Manufacturer/EU importer: Vax Limited, hereby on our own responsibility, declare that the UCPESHV1, UCPMSHV1, UCUESHV1 and UCSUSHV1 are manufactured in compliance with the following Directives:
Safety: 2014/35/EU Low Voltage Directive. **EMC:** 2014/30/EU Electromagnetic Compatibility Directive.

Waste electrical products should not be disposed of with household waste. Please recycle where facilities exist. Check with your Local Authority or retailer for recycling advice.

© 2017 Vax Limited. All rights reserved. The VAX trade mark and Vax lozenge is the property of Techtronic Floor Care Technology Ltd and is registered in the EU and may be pending or registered in other countries.

