

Fellowes

Let your
productivity flow



REFLEX™
Single Monitor Arm

REFLEX™

Single Monitor Arm

Features:

- Experience greater freedom and space to thrive with our value monitor arm range.
- Easily adjust monitor height and depth for a comfortable workspace that reduces your risk of eye, neck and back strain.
- Free up valuable desk space using our easy to install clamp or grommet attachments.
- Holds one screen up to 8kg and 32".
- Supports up to 32"/7kg curved screen.
- Simple design with built-in cable management to keep you tangle free.
- Made from 45% recycled and 97% recyclable materials.
- Independently tested to meet ergonomic requirements outlined in European Health and Safety Legislation: EN ISO 9241-5.



Specification:

Code	8502501
Colour	Black: RAL 9017
Maximum Monitor Size	32" (81.28cm) diagonally / 832mm (H)
Maximum Curved Monitor Size	32" (81.82 cm) diagonally, 1000R/1500R/ 1800R
Weight Capacity (kg)	8 kg
Weight Capacity (kg)	7 kg
Pole Height	450mm
Height Adjustment Range	58 - 416mm
Reach Range	63.5 - 422mm
Rotation	360°
Pan	± 90° (180°)
Tilt	± 45° (90°)
Arm Swivel	180°
VESA	75 x 75 / 100 x 100
Clamp: Desk Thickness	10 - 88mm
Grommet: Desk Thickness	10 - 75mm
Grommet: Diameter	10.5 x 70mm
Product Dimensions (H x W x D)	550 x 116 x 490mm
Product Weight	3.39kg
Retail Packaging Dimensions (H x W x D)	114 x 165 x 473mm
Retail Packaging Weight	3.84kg
Outer Carton Dimensions (H x W x D)	140 x 184 x 486mm
Outer Carton Weight	4.15kg
Retail Barcode (UPC)	043859748471
Outer Carton Barcode (SCS)	50043859748476
Quantity per Outer Carton	1
Country of Origin	China
Warranty	5 Year Limited

Environmental:

Product	Product Material Breakdown		Product Recycled Content		
	Weight (g)	Weight (%)	Pre-Consumer Recycled Content (g)	Post Consumer Recycled Content (g)	Total Recycled Content (%)
Aluminium	254.71	8%	-	254.71	100%
Steel	3052.82	90%	-	1282.18	42%
Plastic	85.20	3%	-	-	-
Total	3392.73	100%	-	1536.89	45%

Packaging	Product Material Breakdown		Product Recycled Content		
	Weight (g)	Weight (%)	Pre-Consumer Recycled Content (g)	Post Consumer Recycled Content (g)	Total Recycled Content (%)
Paper / Card / Corrugated	736.64	97%	-	217.40	30%
LDPE (4) plastic bag	20.44	3%	-	-	-
Total	757.08	100.00%	-	217.40	29%

Pre-Consumer Recycled Content: Waste material that was created during the process of manufacturing or delivering goods prior to their delivery to consumers.

Post-Consumer Recycled Content: Waste material created by consumers. This material is diverted from landfills and utilised in the production of other commodities.

Recyclability:

Percentage of the product and packaging that can be easily separated for recycling.

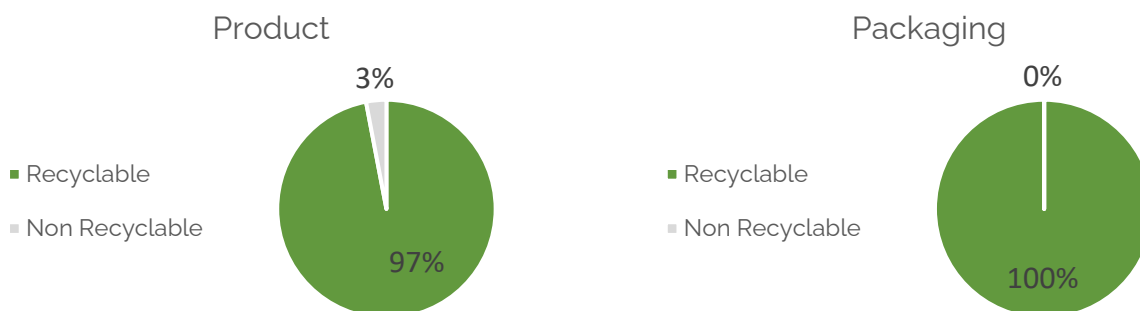

Ergonomic Working:



ZONE 3

RELIEVE NECK STRAIN

Achieve comfortable viewing.
Ensure your eyes are in line with
the top of your screen.

How to use a monitor arm

- 1. Arms Reach:** Whether sitting or standing check that your monitor is positioned so you can touch the screen with your fingertips and that you can easily read what is on your screen without straining.
- 2. Eye level:** Adjust the monitor arm until the top of your monitor/s are roughly level with your eyes.
- 3. Tilt:** Tilting the screen slightly upwards can help achieve a more neutral posture and reduce glare.
- 4. Multiple screens:** If you're using more than one monitor make sure:
 - The tops of each screen are level and positioned side by side;
 - You sit in the middle or in front of your main screen to reduce twisting and turning.

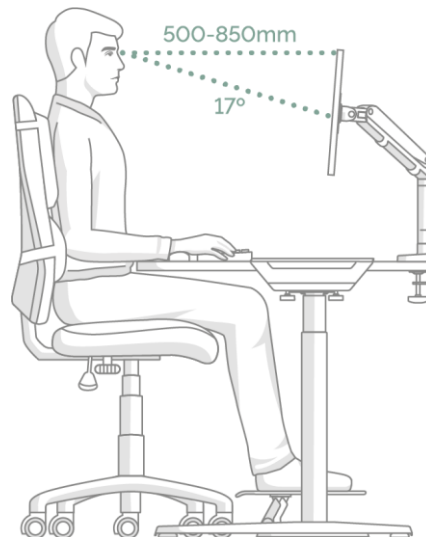

Certifications:

EN ISO 9241-5 1999 Ergonomic requirements for office work with visual display terminals (VDT's): part 5: 1999. workstation layout and postural requirements.

ANSI / BIFMA x5.5 – 2014 Desk/Table Products. Clause 22, 23, 24.

SCS Global Services Indoor Advantage™ Gold: Indoor Air Quality Certified to SCS-105 v4.2



Aftercare:

Servicing: Check joint parts regularly to make sure the screws have not loosened.

Spare Parts: Available. Contact CS-UK@Fellowes.com or telephone 00800 18101810.

Cleaning: Wipe over with a damp microfibre cloth. Do not use any cleaning solutions.

Handling & Storage: Read and follow all instructions and warnings before use. This product is intended for indoor use only.

Dimensional Drawings:

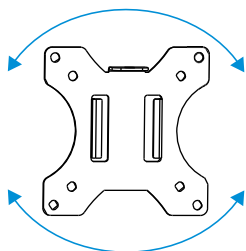
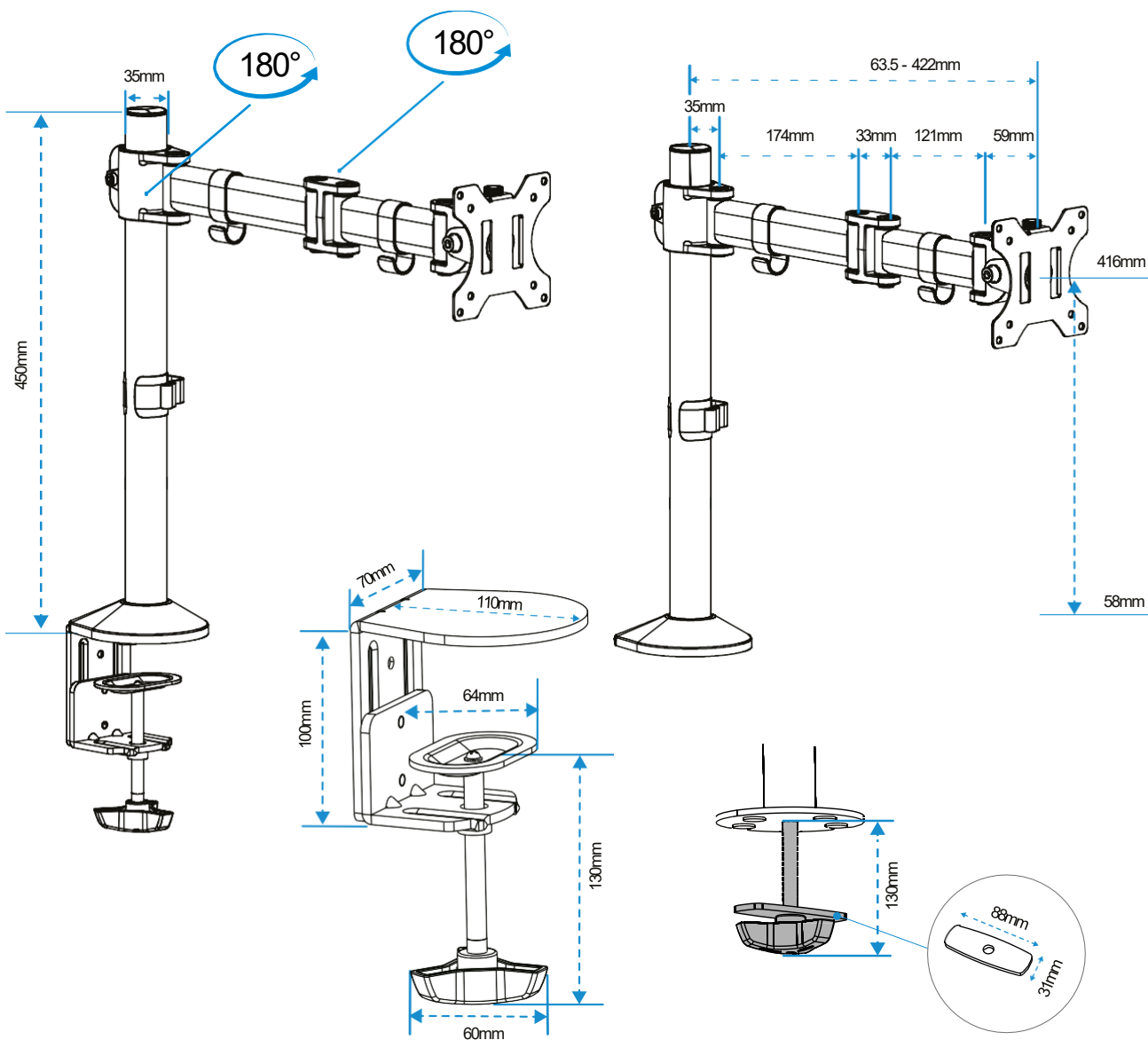

Rotation
360°

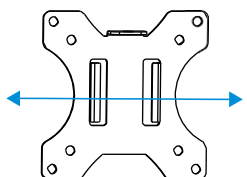

Pan
±90° (180°)

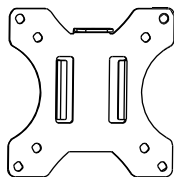

Tilt
±45° (90°)

Every effort has been made to ensure that information provided in this document is up to date and accurate. However, Fellowes cannot guarantee and assumes no legal liability or responsibility for the accuracy or completeness of the information provide. In case of any query please contact us as www.Fellowes.com/locations.