

In association with

**St John**  
Ambulance



  
**kinetik**  
WELLBEING

# - Quick Start Guide -

ET-100D

Inner Ear  
Thermometer



1

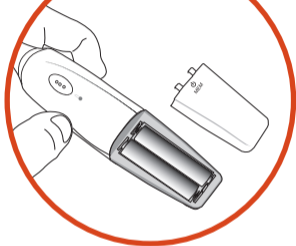

Unpack thermometer  
and  
insert batteries.

2



Condition thermometer at ambient room temperature for 30 mins before operating.

3

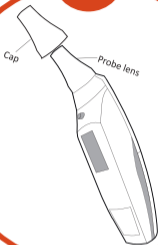

Remove protective cap  
covering probe lens.

4

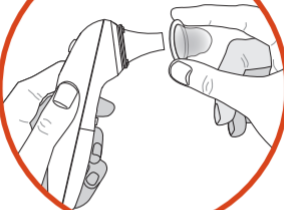

Use a new probe cover with each and every measurement - ensure probe cover is fitted on firmly before use.

5



Press the 'on/recall' button to turn on the thermometer.

6/A

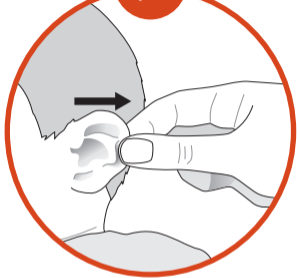

Straighten the ear canal by pulling the outer ear up and back to give a clear view of the eardrum.

For ages:  
Newborn to 1 year.



6/B

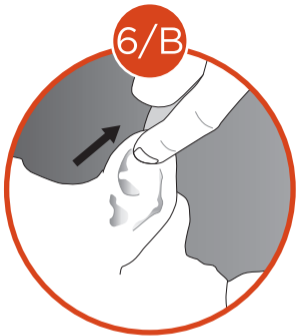

Straighten the ear canal by pulling the outer ear up and back to give a clear view of the eardrum.

For ages:  
1 year to adult.

7



While pulling the outer ear,  
insert the probe into the  
ear canal - insert as deep as  
is comfortable.

8



Press and immediately release the 'SCAN' button.

Do not remove the thermometer from the ear until you hear the beep sound - this beep means that the measurement is complete.

9



Remove the thermometer  
from the ear.

The display shows the  
measured temperature.



for more information visit :  
**[kinetikwellbeing.com](http://kinetikwellbeing.com)**