

## OWNER'S MANUAL

### Model AC315

Baby Video, Sound and  
Movement Monitor



### Cord Safety

Ensure the Camera is at least 1 metre away from your baby's cot.

For assistance, FAQs or guidance with your monitor  
please visit our Customer Support page at [angelcare.co.uk](http://angelcare.co.uk)

## TABLE OF CONTENTS

 WARNINGS.....	2
Setup requirements.....	3
Charging the Parent Unit (9 hours).....	4
Positioning the movement Sensor Pad.....	5
Setting up the Camera.....	7
Turning on your monitor .....	7
Getting to know your monitor.....	9
Activating and deactivating additional functions .....	12
Adding accessories.....	16
Troubleshooting .....	17
Limited warranty.....	18
Technical specifications.....	18

## OWNER'S MANUAL

KEEP YOUR OWNER'S MANUAL FOR FUTURE REFERENCE.

PLEASE READ THE WARNINGS AND INSTRUCTIONS CAREFULLY BEFORE ASSEMBLING & USING THE PRODUCT.

FAILURE TO FOLLOW THE WARNINGS AND THE INSTRUCTIONS COULD RESULT IN SERIOUS INJURY OR DEATH OR DAMAGES TO THE PRODUCT.

THE SENSOR PAD FEATURE IS NOT FOR USE WITH ADULTS, CHILDREN OR INFANTS OLDER THAN 24 MONTHS.

THE SENSOR PAD IS NOT INTENDED TO BE USED TO DETERMINE IF A CHILD IS OUT OF THE COT.

## ⚠ WARNING

Adult assembly required.

Keep small parts away from children when assembling.

We, at Angelcare®, stand behind all of our products.

If you are not completely satisfied or have any questions,

**United States and Canada:** Please contact us at: angelcare@cdccinc.ca

**Other countries:** Please contact your local distributor.

## ⚠ WARNINGS

**1. THIS PRODUCT CANNOT REPLACE RESPONSIBLE ADULT SUPERVISION.** This product is designed to aid in the monitoring of your child. When using the monitor, you must still provide the supervision necessary for the continued safety of your child. Monitoring of premature babies, or those considered to be at risk, should always be carried out under the supervision of a health professional. This monitor SHOULD NOT be used as a medical device, nor as a device to prevent Sudden Infant Death Syndrome (SIDS).

**2. WARNING Strangulation Hazard —** Children have STRANGLED in cords. Keep adapter cords out of the reach of children (more than 1 metre away). NEVER use Wired Sensor Pad(s) without the protective cord covering. Check protective cord covering before each use. Immediately discontinue use of Wired Sensor Pad(s) if protective covering is damaged or broken.



**3. Never use extension cords with adapters. ONLY use the adapters provided.**

**4. When an adapter is plugged into an electrical outlet, DO NOT touch the exposed end.**

**5. ALWAYS be sure that both the transmitter and receiver are working properly and are within range of each other. Test the monitor before first use, periodically and when changing location of the Camera.**

**6. ALWAYS be sure to immediately check on baby whenever an alarm sounds.**

**7. DO NOT use monitor near water (such as bath tub, sink, etc.).**



**8. Keep monitor AWAY from heat sources (such as stoves, radiators, etc.).**

**9. ALWAYS place both the Camera and the Parent Unit on a flat surface in an upright position and allow for proper ventilation. DO NOT place on sofas, cushions, beds, etc. which may block ventilation.**

**10. This monitor uses public airwaves to transmit signals. The Parent Unit may pick up signals or interference from other nursery monitors in your area. Your monitor may even be picked up by other households. To protect your privacy, make sure both units are turned OFF when not in use.**

**11. This product is NOT a toy. DO NOT allow children to play with it.**

**12. This product contains small parts. Adult assembly required. Exercise care when unpacking and assembling the product and keep small parts away from children.**

**13. When using the monitor, the room temperature should be between 10°C and 40°C.**

## ⚠ BATTERY WARNING

**14. The Parent Unit battery is a replaceable Li-Ion battery. Only use the Angelcare recommended replacement battery. Danger of explosion if the wrong battery is used or if replaced incorrectly. Refer to your user manual for correct battery installation. DO NOT short circuit supply terminals. Only use the Angelcare provided power adapter to charge the battery. Remove the battery from your Parent Unit if product is to be stored for an extended period of time. Dispose of batteries according to your local ordinances. ALWAYS keep all batteries away from children.**

## 15. IMPORTANT SAFETY INSTRUCTIONS

**15.1** Heed all warnings – All warnings on the product and in the operating instructions should be adhered to.

**15.2** Follow all instructions – All operating and use instructions should be followed.

**15.3** Water and moisture – DO NOT use this apparatus near water. For example, near a bath tub, wash bowl, kitchen sink, laundry tub, in a wet environment or near a swimming pool and the like. Care should be taken so that objects DO NOT fall onto units and that liquids are not spilled into either unit or Sensor Pad through its openings.

**15.4** Cleaning – Disconnect all units before cleaning. DO NOT immerse in water any part of the monitor. Clean only with dry cloth.

**15.5** Ventilation – DO NOT block any ventilation openings. Allow for proper ventilation when units are in use. DO NOT cover the Camera or the Parent Unit with any object such as a blanket. DO NOT place it in a drawer or in any location which would muffle the sound or interfere with the normal flow of air.

**15.6** Heat sources – DO NOT install near any heat sources such as radiators, heat registers, stoves, TVs or other apparatus (including amplifiers) that produce heat. Heat can damage the case or electrical parts.

**15.7** Power cord protection – Protect the Sensor Pad cord and Adapter's power cord from being walked on or pinched by furniture or other items – Power supply cords should be routed so that they are not likely to be walked on or pinched by items upon or against them, paying particular attention to cords and plugs, convenience receptacle, and the point where they exit from the product. The socket outlet shall be installed near the equipment and shall be easily accessible. Make sure to plug the adapter to the socket outlet nearest to the equipment and that is easily accessible. To disconnect from mains, unplug the adapter.

**15.8** Accessories – Only use attachments/accessories specified by the manufacturer. DO NOT place this product on an unstable cart, stand, tripod, bracket or table. The product may fall, causing serious injury to a child or adult and serious damage to the product. Use ONLY with a cart, stand, tripod, bracket or table recommended by the manufacturer or sold with the product. Any mounting of the product should follow the manufacturer's instructions.

**15.9** Unplug this appliance during lightning storms or when not used for long periods of time.

**15.10** Servicing – DO NOT attempt to service this product yourself as opening or removing covers (except battery door) may expose you to dangerous voltage or other hazards.

**15.11** Replacement parts – When replacement parts are required, be sure the replacement parts specified by the manufacturer have the same characteristic as the original part. Unauthorized substitution may result in fire, electric shock or other hazards.

**15.12** Usage – This baby monitor is intended as an aid. It is NOT a substitute for responsible and proper adult supervision and should not be used as such. Use this appliance ONLY for its intended use as described in this manual.

**15.13** Power Sources – Operate this product only from the type of power source indicated on the type plate of the adaptor. If you are unsure of the type of power supply to your home, consult your dealer or local power company.

**15.14** Overloading – DO NOT overload wall outlets, extension cords or integral convenience receptacles as this can result in a risk of fire or electric shock.

**15.15** Object and Liquid Entry – NEVER push objects of any kind into this product through casing slots as they may touch dangerous voltage points or short out parts that could result in a risk of fire or electric shock. NEVER spill liquid of any kind on the product.

**15.16** Antenna – The antenna used for this transmitter must be installed to provide a separation distance of at least 20 cm from all persons and



must not be collocated or operating in conjunction with any other antenna or transmitter.

**15.17 Power Lines** - An outside antenna system should NOT be located in the vicinity of overhead power lines or other electric light or power circuit, or where it can fall into such power lines or circuits as contact with them may be fatal.

**15.18 Vibration Source** - When the monitor is in use, DO NOT use a bedside crib, cot mobile or other cot accessories that may produce vibrations. Other sources of vibrations may include fans, washing machines, loud music, etc. These sources of vibration may interfere with the performance of your Angelcare® monitor and the alarm will not sound if it continues to detect any movement other than your baby's. Be sure all vibration sources are eliminated before using the monitor.

**15.19** You may experience false alarms for several reasons. The most common reason is the Camera has not been turned **OFF** after you have removed your baby from the cot. Another reason is the Sensor Pad has not been placed under the mattress properly. Be sure the Sensor Pad is on a flat, firm surface with the Angelcare® logo side facing up. The sensitivity level may also need to be adjusted. Refer to **Step 5.1**. Always be sure to immediately check on baby whenever an alarm sounds.

**15.20 Sensor Pad** - Your Sensor Pad can be used in any cot that is stationary. If the cot has a spring or slat base, place a hard board between the cot base and the Sensor Pad measuring at least 33 x 33 cm and 6 mm thick. Only use your Angelcare® monitor in a stationary sleeping environment such as a cot where the Sensor Pad can rest on a completely flat, firm surface. The Sensor Pad is made of plastic and does not permit the air to circulate. Therefore, mildew build up could develop underneath the mattress in the Sensor Pad area. We suggest rotating the mattress regularly to prevent any mildew.

#### 16. IMPORTANT SAFETY INSTRUCTIONS RELATED TO USE OF BATTERIES

**16.1** Use ONLY the type and size of battery specified in the owner's manual. There is a risk of explosion if battery is replaced with an incorrect type.

**16.2** Charge the battery for 9 hours prior to first use. Be sure to have the monitor in the **OFF** position during this period. ONLY use the adapters included with your monitor.

**16.3** DO NOT use these adapters with any other equipments.

**16.4** When unplugging the adapter from the Camera, be sure it is switched to the **OFF** position.

**16.5** DO NOT dispose of batteries in fire. They may explode. Check with local regulations for possible special disposal instructions.

**16.6** Exercise care in handling batteries in order not to short out the batteries with conducting materials such as rings, bracelets and keys. Overcharging, short circuiting, reverse charging, mutilation, or incineration of batteries must be avoided to prevent one or more of the following occurrences: release of toxic materials, release of hydrogen and/or oxygen, gas and rise in surface temperature.

**16.7** DO NOT attempt to rejuvenate the battery provided with or identified for use with this product by heating them. Sudden release of battery electrolyte may occur, causing burns or irritation to eyes or skin.

**16.8** If and when necessary, the battery must be replaced with identical new ones or equivalent (volts and size).

**16.9** Remove the battery from the Parent Unit if you store the product over 30 days because the battery could leak and damage the product.

**16.10** Discard 'dead' batteries as soon as possible since 'dead' batteries are more likely to leak in a product. If a battery has leaked or vented, it should be replaced immediately using protective gloves.

**16.11** DO NOT store this product, or the battery provided with or identified for use with this product, in high-temperature areas.

## SETUP REQUIREMENTS

### INCLUDED:



Touch control Parent Unit



Camera

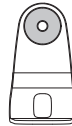

Tabletop stand with removable wall mount metal ball (for Camera)



Hardware (Screwdriver required for wall mounting)



Wired movement Sensor Pad  
\* Always place Angelcare logo side up \*

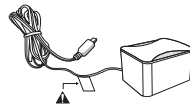

AC adapter (for Parent Unit)



Lithium ion battery pack (for Parent Unit)

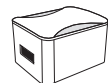

AC adapter (for Camera)

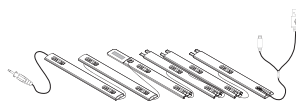

6 Pre-threaded cord covers with Split USB cable



## STEP 1 - CHARGING THE PARENT UNIT (9 HOURS)

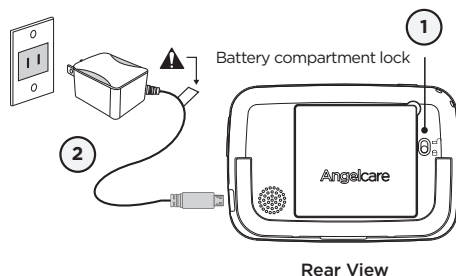

- 1) Unlock the battery compartment on the rear and remove the cover. Insert the provided rechargeable battery into the compartment. Contacts of the battery and the contacts in the compartment must be aligned.
- 2) Connect the USB plug to the Parent Unit and connect the power adapter with an electrical outlet.
- 3) Charge the unit for **9 continuous hours prior to first use.**

### PARENT UNIT:

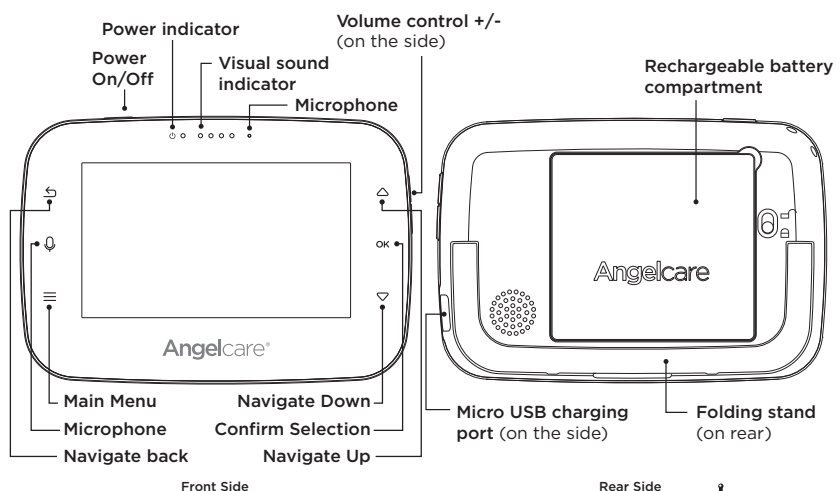

## ⚠ WARNING

### STRANGULATION HAZARD.

Children have STRANGLED in cords:

- Keep adapter cords out of the reach of children (more than 1 metre away).
- Because of the serious strangulation risk to infants and toddlers, parents and caregivers should never place the Camera within 1 metre of a cot.
- **NEVER** use Sensor Pad without the cord covers. Check cord covers before each use to ensure it is securely placed under the leg of the cot. Discontinue use of Sensor Pad if any cord covers are damaged or broken.
- **NEVER** use extension cords with adapters. **ONLY** use the adapters provided. This product is not a toy. Never allow children to play with it.





## STEP 2 - POSITIONING THE MOVEMENT SENSOR PAD

### 2.1 - SELECT A LOCATION FOR THE CAMERA

Camera can be installed on the wall (see included parts) or using the tabletop stand. Depending on the position you choose, you'll need to remove the metal ball from the stand to wall mount Camera.

#### IMPORTANT

Place the cot near a supporting wall and far from air currents. Install the Camera on a flat, stable surface facing the cot at a distance of at least **1 metre**. Make sure to plug the adapter to the socket outlet nearest to the equipment and that is easily accessible.

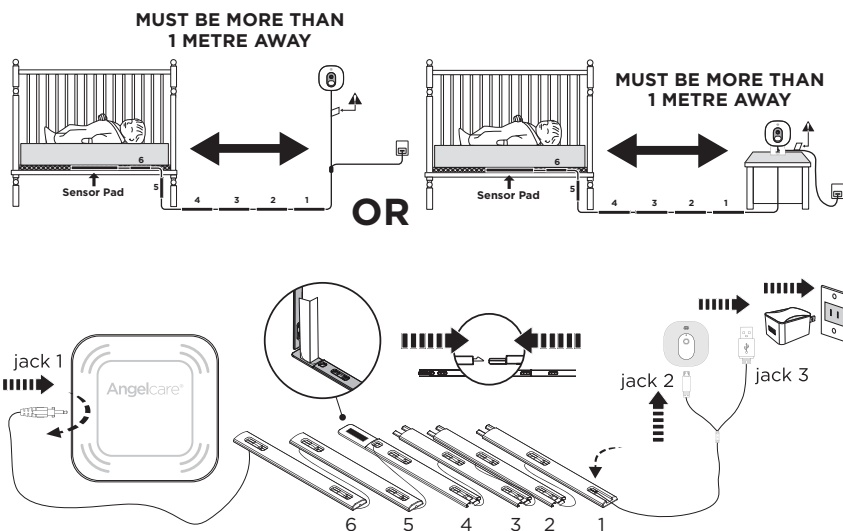

- 1) Insert **jack 1** into the Sensor Pad and twist it clockwise to lock it.

### 2.2 - SELECT THE COT LEG TO SECURE THE CORD COVERS

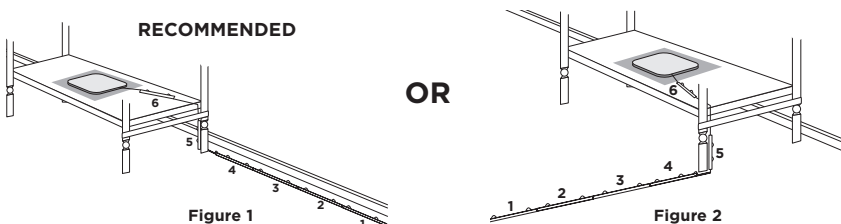

Use the cot leg by the wall closest to the Camera (**Figure 1**). In cases where the Camera is across the room, use the leg closest to the Camera to position the covered wire (**Figure 2**). It is always preferable that the covered cord run along a wall.



## 2.3 - INSTALL THE SENSOR PAD ON THE MATTRESS SUPPORT

### IMPORTANT

If your cot does not have a solid, stable surface for the Sensor Pad, you will need to place a support under it, to ensure correct operation of the system.

This hardboard support should be at least 6 mm thick and should have minimum dimensions of 33 cm x 33 cm. This support board must be larger than the Sensor Pad surface area.

The Sensor Pad functions with any size and type of mattress except memory-foam mattresses, hollow frame mattresses and water beds. The hardboard maintains a constant pressure on the Sensor Pad, enabling it to detect the baby's movements even when the baby is at the edges of the cot.



Hardboard

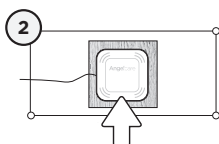

Sensor Pad

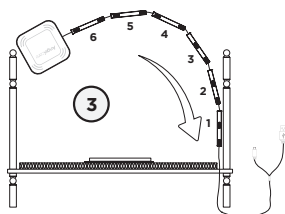

- 1) Remove the mattress from the cot.
- 2) Place the Sensor Pad - **Angelcare logo side up** - on top of the hardboard.
- 3) Run the connection pin, warning label and the first 5 cord covers down along the backside of the cot leg, **between the mattress support and the inside edge of the cot**.

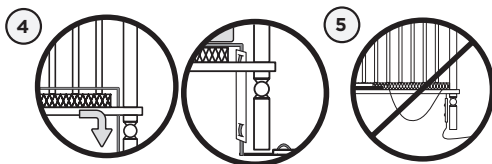

- 4) Bring the first 4 cord covers down the floor, and keep the 5th cord cover vertically, along the backside of the cot leg, **between the mattress and the inside edge of the cot**.

- 5) Remove any cord slack to make sure no parts of the cord are loose.

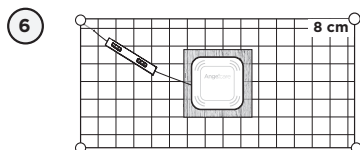

- 6) Place the 6th cord cover approximately **8 cm** from the edge of the mattress support.

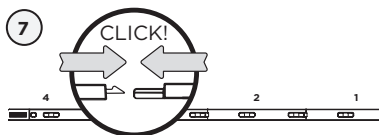

- 7) Snap together the remaining cord covers that will run along the floor.

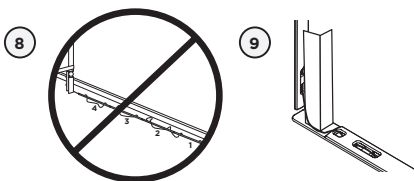

- 8) Remove any cord slack to make sure no parts of the cord are loose.

- 9) Peel off the double-sided tape on the 4th cord cover and place it securely under the cot leg.

- 10) Check to make sure the Sensor Pad has not moved from position and place the mattress back inside the cot.





## **WARNING** **STRANGULATION HAZARD**

- Remove all slack from Sensor Pad Cord.
- When lowering the mattress support as your child grows, slide the vertical Cord Cover downward so it remains approximately in the center between the mattress support and the floor. Slide the Sensor Pad Cord through the Floor Cover to eliminate any additional slack

- The Sensor Pad is not designed for use with adults, children or infants older than 24 months.
- Discontinue use of the Sensor Pad when baby is older than 24 months. Remove Sensor Pad from cot and store for future use.
- **BEFORE FIRST TIME USE:** To test that the unit is ready for use, refer to instruction manual on how to test that the installation has been done correctly.

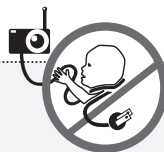

## STEP 3 - SETTING UP THE CAMERA

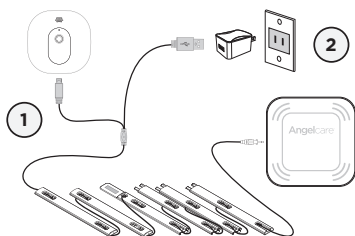

- 1) Connect the USB plug to the Camera.
- 2) Connect the USB plug with the power adapter and then with an electrical outlet.
- 3) Adjust the Camera using the magnetic mount to get the best view of baby in the cot.

**Note:** Each time you power **ON** your Camera, the internal thermometer will need to calibrate to ensure accuracy. This automatic process will take approximately 30 minutes. The colour changing temperature display, by default, will be turned "**OFF**". You may turn this feature "**ON**" in the settings mode on your Parent Unit.

## CAMERA

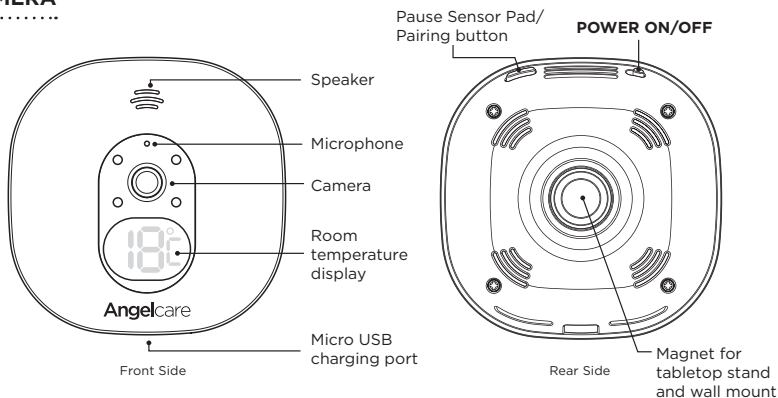

## STEP 4 - TURNING ON YOUR MONITOR

Your Camera and Parent Unit come pre-paired.

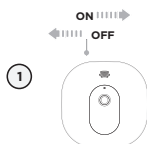

- 1) Slide the Camera **ON/OFF** switch to the **ON** position.



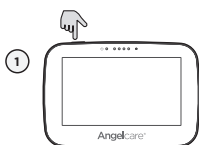

- 1) Press and hold the Parent Unit **ON/OFF** button for 2 seconds until LCD screen is turned **ON**. Angelcare's logo will be shown for 1 second.



The Camera connection signal strength icon will appear in the status bar.



When Parent Unit is turned **ON** and Camera is **OFF**, Parent Unit will display **Out-of-Range** icon.

If there is a lost connection between the two units after 15 seconds, the **Out-of-Range** alarm will sound on the Parent Unit (refer to **Troubleshooting** section):

- The **Out-of-Range** icon will appear on the screen and on the info bar.

## INFO BAR IMPORTANT ICONS

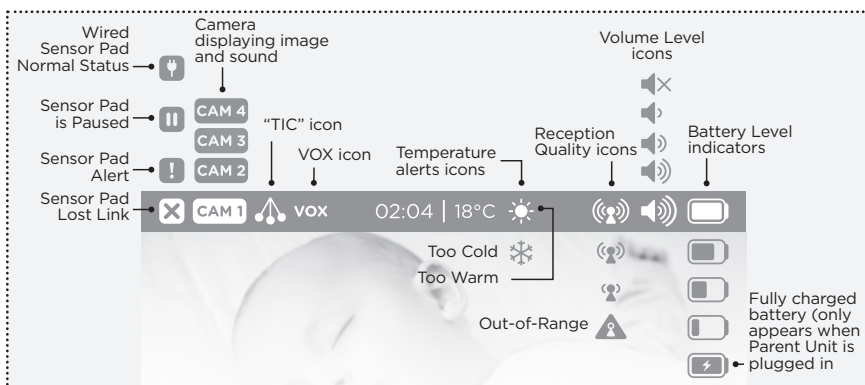

## 4.1 - HOW TO SET THE DATE

When activating the Parent Unit for the first time, you'll be asked to set the date and time in order to record movement & temperature data. If you choose to skip this step, you can always go back later by accessing the settings menu ⚙️.

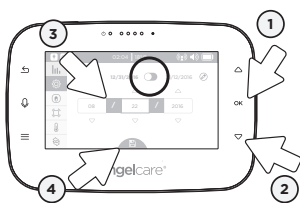

- 1) Press **OK** to switch between Month/Day/Year and Day/Month/Year display.
- 2) Press the **down arrow** ▾ once and then **OK** to set the date.
- 3) Set the day with the **up/down arrows** △ ▾ and confirm with **OK**. Do the same for the month and year and confirm with **OK**.
- 4) Press the **down arrow** ▾, the **Save** icon at the bottom is highlighted in blue then Press the **OK** button to save the settings.

## 4.2 - HOW TO SET THE TIME

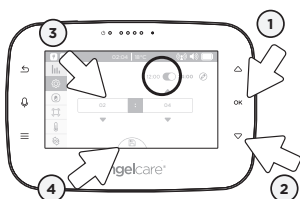

- 1) Press **OK** to switch between 12 h and 24 h mode.
- 2) Press the **down arrow** ▾ once and then **OK** to set the time.
- 3) Set the hours with the **up/down arrows** △ ▾ and confirm with **OK**. Do the same for the minutes and **am/pm** display and confirm with **OK**.
- 4) Press the **down arrow** ▾, the **Save** icon at the bottom is highlighted in blue then Press the **OK** button to save the settings.





**IMPORTANT**

The Sensor Pad will be automatically **ACTIVATED** when the screen returns to video display view. If no movement is detected on the surface of the Sensor Pad after 20 seconds, a series of loud beeps will emit from the Parent Unit & Camera - this is the movement alarm. When activating any functions on your monitor, to prevent this alarm either:

- 1) Gently tap the surface of the pad
- 2) De-activate the movement function, see below for information

**STEP 5 - GETTING TO KNOW YOUR MONITOR****TOUCH CONTROL KEYS**

Access to the different operation settings



Exit or to go back to main menu when in sub-menu



Navigate the different functions



Confirm a selection or setting and allows you to access to a quick menu

The Angelcare® monitor can be used with the pre-programmed factory settings or you can also customize your settings to your preference.

**IMPORTANT**

When in menu or sub-menu modes, sound transmission between the Parent Unit and the Camera will be temporarily deactivated. ONLY movement-detection alarm will remain active (if function is activated).

**5.1 - SENSOR PAD****TO ACTIVATE/DEACTIVATE THE SENSOR PAD:**

- 1) In the Sensor Pad settings, press the **OK** button to activate/deactivate the Sensor Pad (when activated the toggle will turn blue).
- 2) Press the **down arrow** ▾ till the **Save** icon at the bottom will be highlighted in blue then Press the **OK** button to save the settings.

**TO TEST THE SENSOR PAD:****IMPORTANT**

- Test your monitor before first use.
- Test your monitor regularly to ensure it is functioning correctly.
- Test your monitor every time you move the Sensor Pad to a different place.



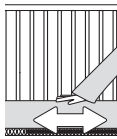

- 1) After activating the Sensor Pad, the alarm will sound after 20 seconds.
- 2) Rub your hand over the mattress to confirm the alarm stops.

#### MOVEMENT ALARM

- If NO movement is detected after 15 seconds you will hear a single 'TIC' pre-alarm sound from the Camera.
- If after a further 5 seconds there is still NO movement detected both the Parent Unit and Camera speakers will emit loud continuous beeps. - this is the movement alarm.
- Movement Alarm icon will show on the LCD screen.



#### IF THE ALARM DOES NOT SOUND

- Avoid contact with the cot while Sensor Pad is in operation.
- Place the cot near a supporting wall to reduce vibrations.
- Adjust the Sensor Pad sensitivity level.
- Turn **OFF** cot mobile, fans, loud music or anything else that may cause vibration.

#### PAUSING AND RESTARTING THE SENSOR PAD:

Allows you to pause the Sensor Pad if you remove baby from the cot, e.g. for feeding or comforting.

PAUSE/UNPAUSE Sensor Pad Buttons

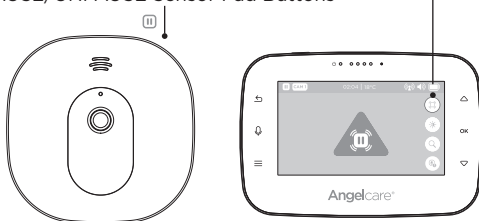

#### IMPORTANT

- If you do not pause the Sensor Pad, the alarm will sound if there is no movement after 20 seconds/if baby is removed from the cot.
- Ensure to unpause the Sensor Pad before putting baby in the cot.

#### TO ACTIVATE/DEACTIVATE TIC FUNCTION:

Allows you to detect baby's movements as well as hear a TIC sound.



- 1) In the Sensor Pad settings, press the **OK** button to activate/deactivate the Tic function (when activated the toggle will turn blue).
- 2) Press the **down arrow** ▾ until the **Save** icon at the bottom is highlighted in blue then Press the **OK** button to save the settings.

#### TO ADJUST THE SENSOR PAD SENSITIVITY LEVEL:

To ensure adequate monitoring of your child's movements, you can adjust the sensitivity of the Sensor Pad in the main settings menu. Set a high sensitivity for a newborn and a lower sensitivity as the child grows and gains weight. A thicker mattress will also need a higher sensitivity.



- 1) In the Sensor Pad settings, select the Sensor Pad sensitivity bar.
- 2) Use the **up/down arrows** △ ▽ to adjust the sensitivity level and confirm by pressing **OK**.
- 3) Press **down arrow** ▾ until the **Save** icon at the bottom is highlighted in blue then Press the **OK** button to save the settings.





## 5.2 - SOUND

### TO ADJUST/MUTE SOUND:



Press the **Volume up** / **Volume down** button to adjust the sound level.



To mute the sound level press the **Volume down** button until the mute symbol is displayed.

## 5.3 - BATTERY

### HOW TO CHECK THE BATTERY:

Unplug the adapter from the Parent Unit and check the battery level indicator.

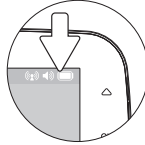

1/4 full



1/2 full



3/4 full



full



### HOW TO CHARGE THE BATTERY IN THE PARENT UNIT:

Leave the Parent Unit plugged in to fully charge the unit. Although the battery at 1/4 capacity works normally, we recommend that you fully recharge it.

#### PARENT UNIT BATTERY ALERT

- Alert activates when the battery needs to be recharged.
- Parent Unit will emit a beep sound every 30 seconds.
- Battery Alert** icon will show on LCD screen.

# YOU ARE NOW READY TO USE YOUR MONITOR

## DEFAULT SETTINGS

	Parent Unit Volume:	Level 3 (of 4)
	Camera Speaker Volume:	Level 3 (of 4)
	Movement Mode:	ON
	Sensor Pad Sensitivity:	Level 2 (of 4)
	"TIC" Function	OFF
	Temperature Unit:	Celsius
	Temperature Alert:	OFF
	Camera Temperature Indicator:	ON
	Camera Colour Changing Mode:	OFF (White color)
	Movement and Temperature Monitoring:	OFF
<b>VOX</b>	Voice Activation (VOX):	ON
	VOX Sensitivity:	Level 2 (of 4)
	Screen Saver Timer:	30 seconds
	LCD Brightness:	Level 3 (of 5)



## STEP 6 - ACTIVATING AND DEACTIVATING ADDITIONAL FUNCTIONS

### 6.1 - TWO WAY TALK

Your Parent Unit is equipped with **Two Way Talk**. This feature allows you to talk to baby without being in the nursery.

#### TO ACTIVATE TWO WAY TALK:



Press the **Microphone** button  to activate/deactivate the **Two Way Talk**.

The Microphone icon appears in the Screen when the microphone is active.

### 6.2 - VOICE ACTIVATION (VOX) OR CONTINUOUS SOUND MODE

Allows you to select your option on how your monitor sound. Your monitor is preset to 'Sound Activated' (**VOX ON**). This means that it will transmit sounds only when it detects them, based on the setting of the sensitivity level. To save power, after 10 seconds, the sound transmission will stop if no sound is detected. Once sound is detected transmission will automatically activate.



Or, you can switch to '**Continuous Sound**' (**VOX OFF**). The sound monitoring is continuously **ON**, picking up all sounds.

#### NOTE:

By deactivating **VOX**, **Continuous Sound** setting will turn **ON**.



#### TO ACTIVATE/DEACTIVATE VOX:



- 1) In the Camera settings, press the **down arrow**  to the VOX toggle and press **OK** to activate/deactivate the VOX function.
- 2) Press the **down arrow**  until the **Save** icon at the bottom is highlighted in blue then Press the **OK** button to save the settings.



#### TO ADJUST THE CAMERA SPEAKER VOLUME:



- 1) In the Camera settings, adjust the Camera speaker volume level with the **up/down arrows**   and confirm by pressing **OK**.
- 2) Press the **down arrow**  until the **Save** icon at the bottom is highlighted in blue then Press the **OK** button to save the settings.

#### TO ADJUST THE SOUND SENSITIVITY (VOX):



- 1) In the Camera settings, adjust the microphone sensitivity level with the **up/down arrows**   and confirm by pressing **OK**.
- 2) Press the **down arrow**  until the **Save** icon at the bottom is highlighted in blue then Press the **OK** button to save the settings.





## 6.3 - ROOM TEMPERATURE DISPLAY

### TO ACTIVATE THE ROOM TEMPERATURE ALERT:



- 1) In the temperature settings menu, select the alarm settings by pressing **OK**.



- 2) Press **OK** to switch the temperature alarm **ON/OFF**.
- 3) Press the **down arrow** ▽ until the **Save** icon at the bottom is highlighted in blue then Press the **OK** button to save the settings.

### TO SET THE ROOM TEMPERATURE RANGE:

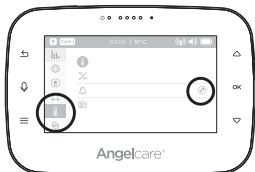

- 1) In the temperature settings menu, select the alarm settings by pressing **OK**.



- 1) Set the lower temperature limit with the **up/down arrows** △▽ and confirm with **OK**. Do the same for the upper limit and confirm with **OK**.
- 2) Press the **down arrow** ▽, the **Save** icon at the bottom is highlighted in blue then Press the **OK** button to save the settings.

### TO ACTIVATE/DEACTIVATE THE CAMERA TEMPERATURE DISPLAY AND COLOR CHANGING MODE:

Allows you to set the LCD display on your Camera. You can completely turn **OFF** the display, or set the color temperature color display on the Camera. With this option the Camera digits light up in colour when the temperature goes above or below your preferences. The Camera LCD will turn to red if temperature is too hot, blue if too cold and white if correct.

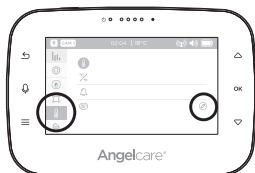

- 1) In the temperature settings menu, select the Camera LCD display setting menu.



- 2) Press **OK** to turn the LCD display mode activate/deactivate then press the **down arrow** ▽ once and then **OK** to turn the colour changing mode activate/deactivate.
- 3) Press the **down arrow** ▽, the **Save** icon at the bottom is highlighted in blue then Press the **OK** button to save the settings.





## TO CHANGE BETWEEN CELSIUS AND FAHRENHEIT:



- 1) In the temperature settings menu, select the temperature unit setting.



- 2) Press **OK** to switch between °C and °F.
- 3) Press the **down arrow** ▾ until the **Save** icon at the bottom is highlighted in blue then Press the **OK** button to save the settings.



### TEMPERATURE ALERT

- Alert activates when temperature reaches maximum or minimum set temperature.
- Parent Unit will emit 4 consecutive beeps, every 5 seconds.
- **Temperature Alert** icon will show on LCD screen.

## 6.4 - SCREEN SAVER



- 1) In the general settings menu, select the screen saver settings menu.



- 2) Press **OK** to switch the screen saver **ON** or **OFF**.
- 3) Press the **down arrow** ▾ once and then **OK** to set the time after the screen saver will be activated.
  - Select between 30 seconds to 3 minutes.
- 4) Press the **down arrow** ▾, the **Save** icon at the bottom is highlighted in blue then Press the **OK** button to save the settings.

### MANUAL SETTING:

To manually activate the Screen Saver Mode, quickly press & release the Parent Unit **POWER ON/OFF** button.

#### NOTE:

The LCD screen will turn black when video is in **Screen Saver** mode. Press any button to return to **Video** mode.

## 6.5 - MOVEMENT AND TEMPERATURE MONITORING

Activity analysis and room temperature tracking give you insight into your little one's activity level during sleep, helping you to better adapt routines and respond to their needs. The movement monitoring records data every ten seconds. Three times every hour the system compiles the collected data and a "movement activity report" can be viewed on the Parent Unit.





## TO ACTIVATE OR DEACTIVATE MOVEMENT AND TEMPERATURE MONITORING:

### IMPORTANT

In order to record the movement and temperature data, ensure you have set the date and time in **STEPS 4.1** and **4.2**.

The graphing function is not available during the first 20 minutes of use as the system is collecting the first set of data that will be displayed. During this time, the graphing icon  will not be operational.



- 1) In the general settings menu, select the monitoring settings.

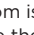

- 2) Press **OK** to select monitoring **ON** or **OFF** toggle.
- 3) Press the **down arrow** , the **Save** icon at the bottom is highlighted in blue then Press the **OK** button to save the settings.

## DELETE GRAPHING DATA:

This option will not be available until 20 minutes from activation of this function.





- 1) In the general settings menu, select the graph delete menu.



- 2) Press the **down arrow**  and then **OK** to delete previously saved graph data.

## NAVIGATING MOVEMENT AND TEMPERATURE REPORTS:



- 1) In the movement & temperature reports, press **OK** to highlight/select the first set of arrows. Use the **up/down arrows**   to navigate page by page.



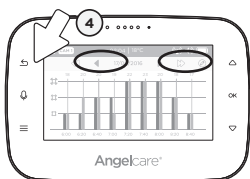

- 2) Press **OK** to highlight/select the second set of arrows (double arrows). Use the **up/down arrows**  $\triangle \nabla$  to navigate day by day.
- 3) Press **OK** to deselect the arrows.
- 4) Press the **arrow back**  $\leftarrow$  to go back to the Menu.

## MONITORING IMPORTANT BUTTONS AND ICONS

### Navigation Icons:

$\triangleleft$  Go to previous page    $\triangleright$  Go to next page    $\triangleleft$  Go to previous day    $\triangleright$  Go to next day

**Temperature indicator:** The blue bar indicates the temperature in the room.

**Sensor Pad Movement Levels:** The red bar indicates the amount of movement from your Sensor Pad.

Low Movement 0-20 movements   Medium Movement 20-30 movements   High Movement Over 30 movements

### Graphing Icons:

Indicates an alert during the period   Indicates the system was turned **OFF** during the period

## 6.6 - DIGITAL PAN AND ZOOM



- 1) Select the zoom function.
- 2) Press **OK** to activate the zoom.



- 3) Use the **up/down arrows**  $\triangle \nabla$  to zoom in on what you want to see more closely. Press **OK** to switch between vertical and horizontal movement.
- 4) Press the **arrow back**  $\leftarrow$  to switch back to normal viewing mode. Zoom is deactivated.

## 6.7 - LCD SCREEN BRIGHTNESS



- 1) Select the brightness control and Press **OK**.
- 2) Use the **up/down arrows**  $\triangle \nabla$  to decrease / increase the brightness level.

## STEP 7 - ADDING ACCESSORIES

Your Angelcare monitor allows you to add additional Cameras. Please contact your local distributor to check availability in your country.





**IMPORTANT**

- If you have a Sensor Pad connected to your Angelcare Monitor, it can **ONLY** be paired with Camera 1.
- You will only be able to hear audio from one camera at a time. When in split screen, the sound transmitted from the Parent Unit will be from the Camera number highlighted in the info bar.



**TROUBLESHOOTING****TAKING CARE OF YOUR RECHARGEABLE BATTERY**

- Ensure that you fully charge your battery for 9 hours before its first use.
- To maintain maximum battery life it is recommended that you fully discharge your battery periodically. If your Parent Unit is not in use, please turn it **OFF**.

**LOSS OF CONNECTIVITY**

- If your Camera becomes un-paired from your Parent Unit, please follow the steps below to re-pair them.

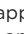

- 1) Select the pairing settings menu and then **OK** to access it.
- 2) Press the **down arrow**  once and press **OK** to select/highlight CAMERA (the Edit icon will turn to blue). Press **OK** to delete the paired camera as the Trash icon  appears, and then Press **OK** to confirm. The  icon will appear, then Press **OK** to re-pair the camera.



The Parent Unit Power Indicator will flash to indicate it's in linking mode.



- 3) Plug in and turn your Camera **ON**.
- 4) Press and hold the **Pause / Pairing** button on the top right of the Camera for 2-3 seconds.
- 5) When the **Trash can** icon  shows up, the Camera is now paired.

**NO SOUND IS BEING TRANSMITTED**

- Check the volume level on the Parent Unit and the Camera to ensure they are set to an appropriate level.
- Try bringing the Parent Unit closer to the Camera to see if you get sound.
- Charge the Parent Unit.

**WEAK RECEPTION**

- Bring units closer together.
- Change the position of one or both units.
- Place units on a flat surface away from baby's reach.
- Recharge the Parent Unit.

**STATIC, DISTORTION, INTERFERENCES  
(FROM OTHER MONITORS, WIRELESS PHONES, WALKIE-TALKIES, ETC.)**

- Rotate Parent Unit or move it away from source of interference.

**FEEDBACK (LOUD NOISES EMITTED FROM THE PARENT UNIT)**

- Move units farther apart (at least 3 metres).
- Decrease volume on Parent Unit.



## THE PARENT UNIT SCREEN IS BLACK (PARENT UNIT IS OFF)

- Turn the Parent Unit back **ON** by pushing and holding the **POWER ON/OFF** button for 2 seconds.
- Recharge the Parent Unit.

## FALSE ALARMS

- Turn **OFF** the Camera.
- Verify the connection between the Sensor Pad and the Camera. Unplug and reconnect the cord.
- Make sure there is no bedding between the mattress and the Sensor Pad.
- If the cot has a spring or slat base, place a hardboard between the cot base and the Sensor Pad measuring at least 33 cm x 33 cm x 6 mm thick.
- Make sure the Sensor Pad is positioned as described under the setup requirements. Sensitivity may need to be adjusted. Refer to **STEP 5.1** for more information.

## ALARM WILL NOT SOUND

- Avoid contact with the cot when the monitor is **ON**.
- Place cot near a solid supporting wall to avoid Sensor Pad from detecting movement from outside the cot.
- You may need to decrease the sensitivity. Refer to **STEP 5.1** for more information.

## THE PARENT UNIT DOESN'T SHOW MOVEMENT AND TEMPERATURE REPORTS

- Make sure the time and date is set up. Refers to **STEP 4.1 & 4.2**.
- Make sure the movement and temperature function is activated. Refers to **STEP 6.5**.

### LIMITED WARRANTY

Angelcare® warrants to the original owner of this product that Angelcare® monitor is free from any material and workmanship defects for the term of the warranty period (see warranty table below to determine the warranty for your country). If this monitoring system fails to function properly when used as directed under normal conditions and during the warranty period, Angelcare® will either repair or replace the product, at our discretion, free of charge. Please contact your local distributor to validate warranty and warranty period.

The product must be accompanied by a proof of purchase, either a bill of sale or other proof that the monitoring system is within the warranty period. Angelcare® will bear the cost of repairing or replacing the product and shipping it back to you.

**This warranty does not apply to a product which has been damaged as a result of improper maintenance, an accident, improper voltage supply or any other form of misuse. The warranty is also void if the owner repairs or modifies the product in any way. Angelcare® is not liable for any incidental or consequential damages with regard to this product. The warranty also excludes any liability other than what is stated above. No other warranty is given.**

This warranty does not cover products and accessories which are not Angelcare-branded, or any problems that result from usage that is not in accordance with product instructions, failure to follow the product instructions, or problems caused by using accessories, parts or components not supplied by Angelcare.

LEGAL RIGHTS VARY FROM COUNTRY TO COUNTRY. SOME COUNTRIES DO NOT ALLOW THE EXCLUSION OR LIMITATION OF INCIDENTAL OR CONSEQUENTIAL DAMAGES, SO THE ABOVE LIMITATIONS MAY NOT APPLY TO YOU.

WE ARE NOT IN ANY WAY RESPONSIBLE FOR ANY OUTCOME RESULTING FROM THE USE OF THIS PRODUCT.

**IMPORTANT!** This Angelcare® monitor is a personal care product. Please do not return this product to the store. If you have questions or need help, please call your distributor before returning this product.

#### WARRANTY TERM PER COUNTRY

North America	1 year
UK, South Africa, Russia	1 year
Other countries	2 years

## TECHNICAL SPECIFICATIONS

### Range:

Open field (Open area without obstructions): up to 250 metres.

### Number of Channels:

USA/Canada: 24 channels.  
Europe: 24 channels.

### Power Supply:

1 included rechargeable Li-Ion battery (Parent Unit)  
100 - 240 VAC / 5 VDC adapter for the Parent Unit  
100 - 240 VAC / 5 VDC adapter for the Camera

**Caution:** To reduce the risk of electric shock, do not expose this product to rain or moisture.

Danger of explosion if batteries are incorrectly replaced. The battery included for the Parent Unit is a user replaceable Li-Ion rechargeable battery, manufactured by manufactured by Icon Energy System (Shenzhen) Co Ltd. Only use the Angelcare recommended replacement battery. To obtain information on replacement batteries please contact Angelcare customer service: [www.angelcarebaby.com](http://www.angelcarebaby.com) or contact your local distributor. Instructions will be included with the replacement battery. Dispose of exhausted batteries properly according to your local ordinances. Keep all batteries away from children.

### Transmission:

Transmission between the Parent Unit and the Camera is made on 2.4 GHz frequency for Europe/Asia/Africa/Australia.

Asia/Africa/Australia

Maximum RF Power Transmitted:

• 20dBm (100mW) between Camera and Parent Unit

Hereby, Angelcare Monitors Inc., declares that this Baby Monitor is in compliance with Directive 2014/53/EU The full text of the EU declaration of conformity is available at the following internet address:  
[www.angelcarebaby.com](http://www.angelcarebaby.com)

### ErP Compliance

USE ONLY THE FOLLOWING ANGELCARE® BRAND POWER SUPPLY

MODEL NUMBERS:

EU (INCLUIDG GERMANY) - MODEL NUMBER: K05S050100G

UK - MODEL NUMBER: K05S050100B

## PROTECT THE ENVIRONMENT

This electronic equipment contains reusable material and must not be disposed with domestic waste. Please take it to a collecting point for electric and electronic equipment (ask your local authorities for details).





Angelcare Sassy

## EC DECLARATION OF CONFORMITY



**Issue Date:** February 22, 2016

**Device (s):** Angelcare Model numbers as listed below

**Description:** Baby Monitors as described in Device list below

**Manufacturer:** Angelcare Monitors Inc  
201 boul. De L'industrie Local 104  
Canidac, QC J5R 6A6 Canada

We declare under our own responsibility that the products herein are in accordance with the essential requirements of the relevant Union harmonization legislation –

**The Radio Equipment Directive (RED) 2014/53/EU.**

Relevant Harmonized standards used:

**Article 3.1(a) – Health & Safety**

EN60950-1:2006+A11:2009+A1:2010+A12:2011+A2:2013

EN 62479:2010

EN 50566:2013

EN 62311:2008

**Article 3.1(b) - EMC**

EN301 489-1 V1.9.2 (2011-09)

EN301 489-17 V2.2.1 (2012-09)

**Article 3.2 – Radio**

EN 300 328 V1.9.1 (2015-02)

**Device List –**

**Model No. AC417 – Baby Movement Monitor with 4.3" Touchscreen Display and Wireless Sensor Pad**

**Model No. AC310 – Baby Video Monitor with 4.3" Touch Control Display**

**Model No. AC315 – Baby Movement Monitor with 4.3" Touch Control Display and Wired Sensor Pad**

**Model No. AC510 – Baby Video Monitor with 5" Touchscreen Display**

**Model No. AC517 – Baby Movement Monitor with 5" Touchscreen Display and Wireless Sensor Pad**

Authorized Signature: 

Ben Bierlein, Global Quality Director, Angelcare Monitors Inc





..... For assistance, FAQs or guidance with your monitor please visit  
our Customer Support page at [Angelcare.co.uk](http://Angelcare.co.uk)

[www.angelcarebaby.com](http://www.angelcarebaby.com)



1M315-INT-270917

