

CV 6V POWERED 3 WHEEL SCOOTER

Assembly & User Instructions - Please keep for future reference

798/6488

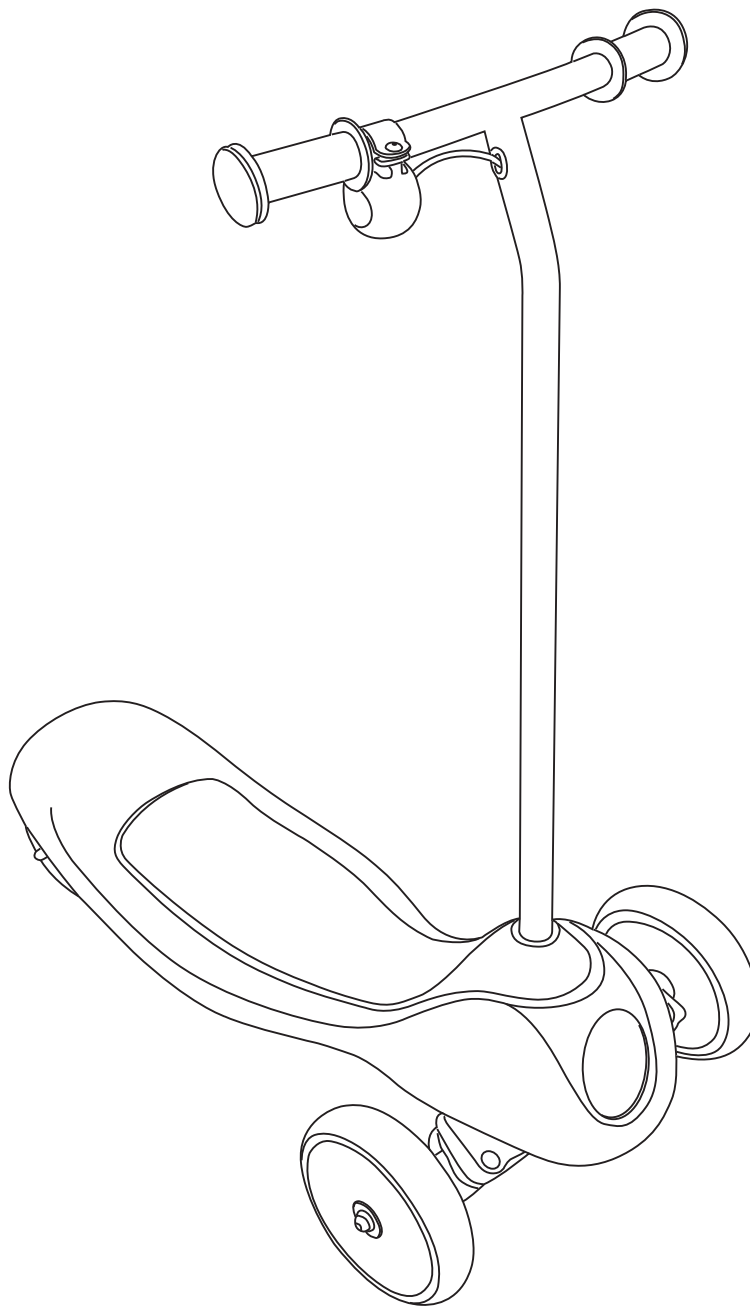

Important

**Age: 6 Years +
Maximum user
weight: 40kg**

Warning!

1. Not Suitable for children under 36 months. Choking hazard due to small parts
2. Not to be used in traffic
3. Adult assembly required
4. Protective equipment should be worn
5. This toy is unsuitable for children under 6 years due to its maximum speed.

Important – Please read these instructions fully before assembly or use

These instructions contain important information which will help you get the best from your product and ensure safe and correct assembly, use and maintenance.

Table of Contents

Safety and Warnings	1-2
Before You Start	3
Assembly	4-6
Before You Ride	7
Riding	7
Hardware Maintenance	7
Disposal Of Battery	8
Troubleshooting	9

Safety and Warnings

Assembly & User Instructions - Please keep for future reference

⚠️ WARNING: Riding an electric scooter can be a dangerous activity. Certain conditions may cause components to fail without fault of the manufacturer. Scooter can and is intended to move and it is therefore possible to lose control, fall off and/or get into dangerous situations that no amount of care, instruction or expertise can eliminate. If such a thing does occur you can become seriously injured or die, even when using safety equipment and other safety precautions. **RIDE AT YOUR OWN RISK AND ALWAYS USE COMMON SENSE.**

This manual contains many warnings and cautions concerning the consequences of failing to inspect, maintain or properly use your electric scooter. Since any incident can result in serious injury or even death, we do not repeat the warning of possible serious injury or death each time such a possibility is mentioned in this manual.

APPROPRIATE RIDING ATTIRE

Always wear proper protective equipment such as:

- Approved safety helmet. (Helmet may be legally required by local law or regulation in your area.)
- Elbow pads and knees pads
- Long sleeved shirt, long pants
- Gloves
- Lace up shoes with rubber soles, never ride barefooted or in sandals, and insure that shoelaces are tied and kept out of the way of the wheels and drive system.

RIDER USE AND PARENTAL SUPERVISION

RIDER MUST NOT EXCEED THE WEIGHT LIMIT OF 40 kg. Rider weight does not always mean a person's size is appropriate to fit or maintain control of the scooter.

This manual contains extremely important safety information. It is your responsibility to completely review this information and make sure that all riders understand all warnings, cautions, instructions and safety topics and assure that all riders are able to safely and responsibly use this scooter. We advise that you periodically review and reinforce all information in this manual with all riders, and that you inspect and maintain your scooter to insure their safety.

The recommended rider age is 6 and older. Any rider that is unable to fit comfortably on the scooter should never attempt to ride it. A parent's decision to allow their child to use scooter should be based

on the child's maturity, skill and their ability to follow rules.

This scooter is intended for use only by persons who are, at a minimum, completely competent and comfortable while operating this product.

⚠️ WARNING:

RIDING PRACTICES AND CONDITIONS

Read the instruction carefully and assemble the scooter accordingly prior to use.

This scooter must be assembled by an adult!

Special care should be taken to instruct children in safely riding this scooter.

Check and secure all fasteners before every ride.

To reduce the risk of injury, **CHILDREN MUST BE SUPERVISED BY AN ADULT WHILE RIDING THIS SCOOTER.**

Ride on smooth, level paved surfaced away from motor vehicles. Do not ride on streets or roadways.

Be sure the rider keeps both hands on the handlebars for proper control.

Do not allow the rider to wear anything that obstructs hearing, visibility or function.

Do not allow the scooter to be operated on or near sloped driveways, alleys, hills, ditches, swimming pool areas, near steps, sand, gravel, dirt, leaves or any other hazardous area.

Avoid sharp bumps, drainage grates and sudden surface changes which may cause scooter to be suddenly stopped.

Do not ride at night or times of limited visibility.

Obey all local traffic and scooter riding laws and regulations.

Do not use scooter in public lanes

Safety and Warnings

Assembly & User Instructions - Please keep for future reference

Use protection equipment: helmet, gloves, kneepads, and elbow pads.

Be cautious when using the product, as it requires much skill in order to avoid accidents brought about by falls or collisions by the users or third parties.

Do not touch the motor when in use or directly after use as it can become very hot.

Keep your finger and other body parts away from the motor, gear, wheels and all other moving components.

Do not use the scooter in wet weather. Never ride on it through water, and never immerse it in water; electrical and drive could be damaged by water or create other possible unsafe conditions.

For safety use, it is not suitable for children under 6 years.

User weight more than 40kg may damage the scooter.

Be sure the rider keeps both hands on the handlebars and stand on the center of the deck at all times while riding.

Only use the charger specified by the manufacturer.

Do not activate the go button unless you are on the scooter and in a safe environment that is suitable for riding.

Do not attempt or perform stunts or tricks on this electric scooter. This product is not made to withstand abuse from jumping, curb grinding or any other type of misuse or stunts.

Never allow more than one person at a time to ride the scooter.

Never use near steps, water, or swimming pools.

Never ride while using a cell phone or wearing headphones.

Never hitch on to or with another vehicle or pull anyone or anything.

Never immerse the scooter in water; electrical and drive components could be damaged by water or create other possible unsafe conditions.

Ride only on flat, dry surfaces such as pavement or level ground without loose debris, such as sand, leaves, rocks or gravel. Water, mud, ice, bumpy, uneven, slick, or rough surfaces could impair traction and contribute to possible loss of control. Avoid excessive speeds that can occur from downhill rides which could cause loss of control. Do not ride at night or in areas of limited visibility.

Before each ride the following checks will need to be performed to the scooter:

- That all components are properly secured and are functioning according to manufactures specifications.
- Components shall be maintained and repaired in accordance with the manufacturers authorized replacement parts with installation performed by dealers or other skilled individuals.

USING THE BATTERY CHARGER

The battery charger should be regularly examined for damage to the cord, plug, enclosure and other parts. In the event of such damage, if any is found, the scooter should not be charged until the battery charger has been repaired or replaced.

Use only with the supplied recommended battery charger.

Always pay attention to the charger when charging.

The battery charger is not a toy and should be operated by an adult.

Never operate battery charger near flammable materials or liquids.

Disconnect the battery charger and unplug from scooter when not in use.

Do not exceed recommended charging time.

Always disconnect the battery charger from the scooter prior to wiping down and cleaning with any liquid.

FAILURE TO HEED TO THE WARNINGS LISTED ABOVE INCREASES RISK OF POTENTIAL SERIOUS INJURY. USE THE APPROPRIATE CAUTION WHEN RIDING AND ALWAYS WEAR PROTECTIVE GEAR.

THERMAL FUSE

This product is equipped with a built in thermal fuse that will activate if the motor is overloaded. This self-resetting fuse will automatically reduce power to the motor when it becomes overloaded. Overloading of the fuse can occur from any one or a combination of the following:

- Rider exceeds the maximum weight limit
- Riding up steep inclines
- Running into fixed Objects
- Pulling or towing anything behind the scooter

⚠ WARNING: Any changes or modifications to this unit not expressly approved by the party responsible for compliance could void the user's authority to operate the equipment.

Before You Start

⚠ WARNING: This scooter must be assembled by an adult! Remove all packing and items from the display box.

Estimated Assembly Time

- Allow up to 20 minutes for assembly, not including initial charge time.
- Allow up to 10 hours for the initial charge (see page 6 for charging information).



battery charger
(included)

Required Tools

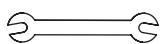

10mm wrench
(included)

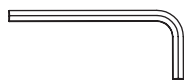

5mm hex wrench
(included)

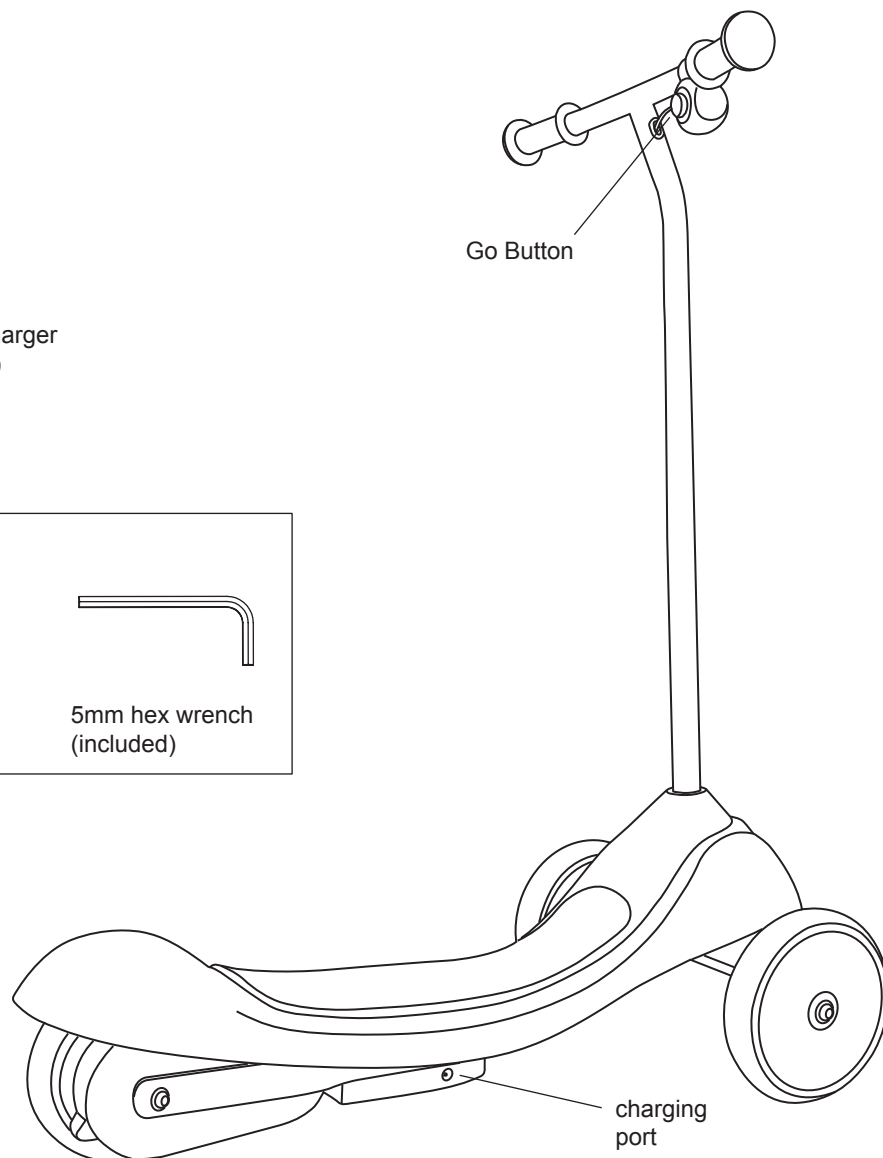

Go Button

charging
port

Assembly Instructions

Handlebar Steer Tube Assembly

Tools required : 5mm hex wrench, 10mm wrench



Step 1

Remove deck cap cover removing 4 tabs from slots underneath the deck.

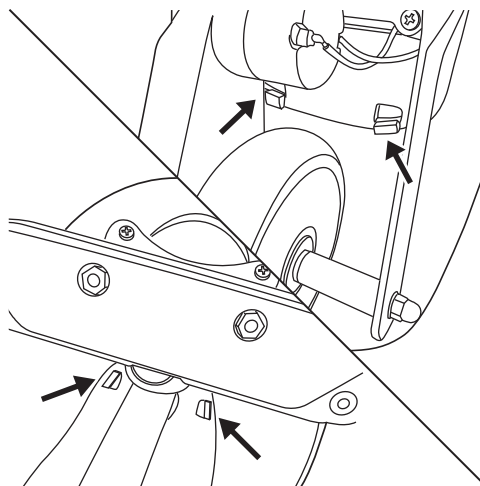

Step 2

Release the bolt and nuts from scooter

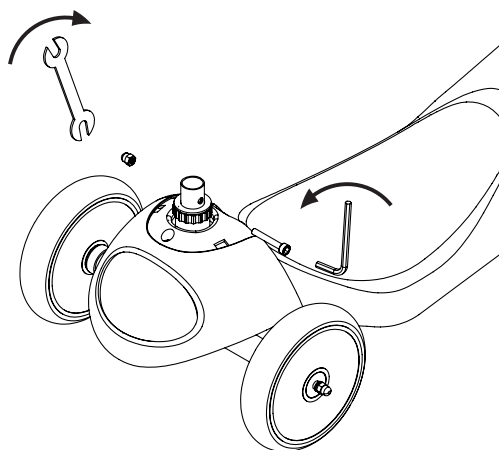

Step 3

Slide deck cap cover (A) onto stem tube (B). Insert stem tube (B) into steer tube (C) and align holes (D).

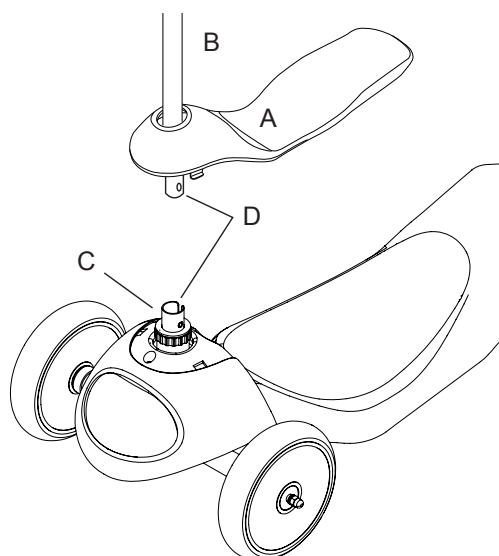

Assembly Instructions

Step 4

Install bolt and nut hardware into steer/stem tube hole and tighten securely with the supplied 10mm wrench and 5mm hex wrench.

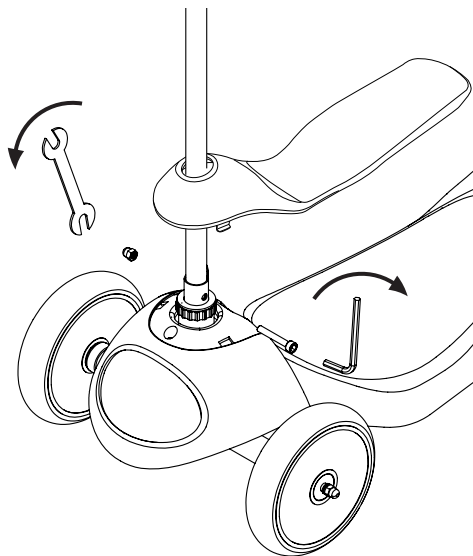

Step 5

Connect wire plug "a" to wire plug "b".

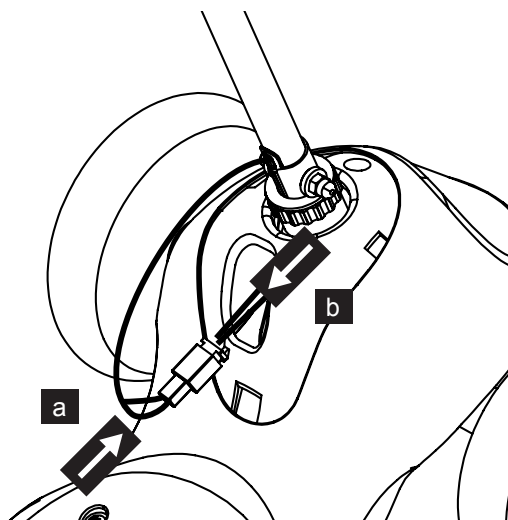

Step 6

Slide deck cap cover down onto deck and insert the 4 tabs into the deck slots.

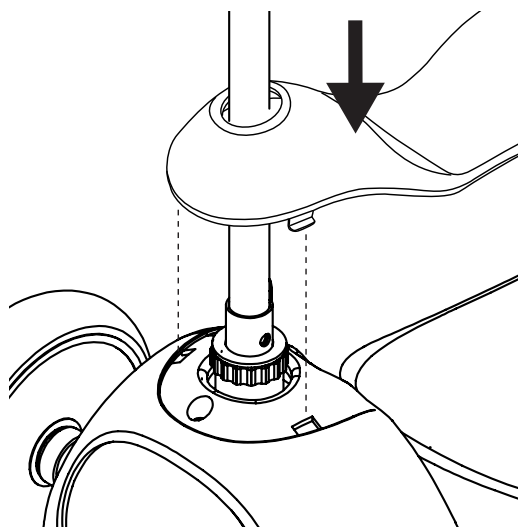

Assembly Instructions

⚠ WARNING: Batteries must be fully charged before you ride your electric scooter.

Battery and Charging

Required components: Battery charger

- Initial battery charge time- 10 hours
- Recharges after initial charge- Up to 8 hours
- When scooter is not in regular use batteries need to be charged on a monthly basis to maximize performance.

Step 7

Plug the battery charger (c) into a wall power outlet. The light on the battery charger housing should illuminate.

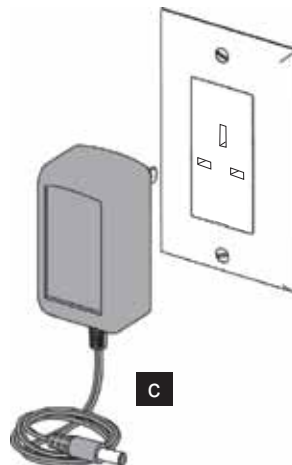

Step 8

Plug charger into scooter port (d).

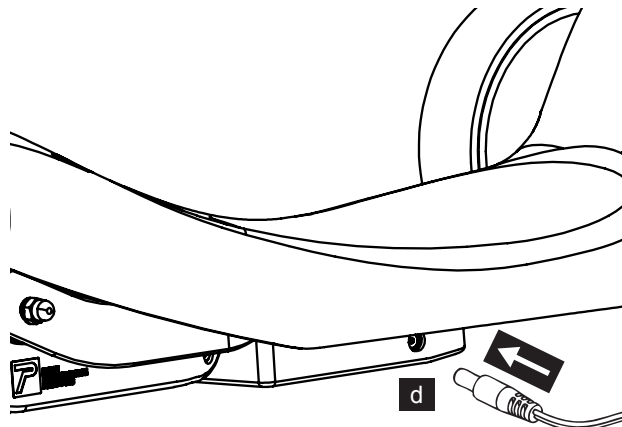

⚠ WARNING: Do not use this product for the first time until you have charged the battery for at least 10 hours. Failure to follow these instructions may damage your product and void your warranty.

LED light that indicates the charge status. Refer to the illustration on the charger unit for the actual "charging" and "charged" status indication. Your charger may get warm during use; this is normal and is no cause for concern.

Note: Batteries must be recharged at least once a month even when the scooter is not in use. Failure to do so may result in batteries that will no longer accept a charge.

Before You Ride

Before you ride always check and for the following:

Safety Gear

Always wear proper protective gear such as:

- Approved safety helmet. (Helmet may be legally required by local law or regulation in your area.)
- Elbow pads and knees pads
- Long sleeved shirt, long pants
- Gloves
- Lace up shoes with rubber soles.

Riding

Go Button

Make sure that before Go Button is pressed that you are in an open and safe area to ride, you are balanced on the scooter and have both hands on the handlebar controls.

Press Go Button to engage motor, release Go button to stop.

Hardware Maintenance

Frame, Fork and Handlebars

Check for cracks or broken connections. Although broken frames are rare, it is possible for aggressive rider to run into a curb or wall and bend or break a frame. Get in the habit of inspecting your scooter on a regular basis.

Tires

Periodically inspect the wheels for excess wear.

Safety Gear

Always wear proper protective gear such as an approved safety helmet.

Elbow pads and knee pads are recommended. Always wear athletic shoes (lace up shoes with rubber soles), never ride barefooted or in sandals, and keep shoelaces tied and out of the way of the wheels, motor and drive system.

Battery

Never store the product in freezing or below freezing temperatures! Freezing will permanently damage the battery.

 **WARNING:** Always ensure that you are in a safe open area to ride before you press the Go Button. Never press the Go Button without being on the scooter in a balanced, ready to ride position with both hands on the handlebars; once the button is pressed the scooter will move.

Failure to follow these instructions may damage your scooter and void your warranty.

Disposal Of Battery

- Your sealed lead-acid battery must be recycled or disposed of in an environmentally sound manner.
- Do not dispose of your lead-acid battery in a fire. The battery may explode or leak.
- Do not dispose of a lead-acid battery in your regular, household trash. The incineration, land filling or mixing of sealed lead-acid batteries with household trash is prohibited by law.
- Return an exhausted battery to your local approved lead-acid battery recycle, such as a local seller of automotive batteries.
- Contact your local waste management officials for other information regarding the environmentally sound recycling and disposal of lead-acid batteries.
- The battery must be charged only by adult .Please charge the product before using!
- The toy should not be connected to excessive powers (more than the quantity specified herein), and it should not be operated during charging process.
- Any rechargeable battery must only be charged under adult's supervision.
- Battery charger shall regularly check the wires, plugs. casing and other parts for damage and found damage should stop using and restored.
- Open the battery cover on the remote control, and put two pieces of batteries,paying attention to batteries polarity. Replace the battery cover and lock with screws (please replace the battery according to the above steps and should be done by adult) .
- All batteries should be inserted with the correct polarity.
- Non-rechargeable battery should not be charged, please remove any running-off battery from the toy.
- Do not use old and new batteries together, or mix different types of batteries.
- The battery charger used with the toy are to be regularly examined for damage to the cord, plug, enclosure and other parts, and in the event of such damage, they must not be used until that damage had been repaired.

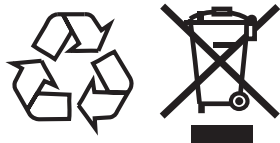

Troubleshooting

Problem	Possible Cause	Solution
Scooter will not run.	Battery is not charged.	Fully charge the battery. First charge should be 10 hours and up to 8 hours for recharges.
	Wires or connectors are loose or unplugged.	Check to ensure that charger is tightly plugged into both the wall and the scooter. Check all scooter plugs and connections are correctly attached.
Scooter run time is short.	Battery requires charging.	Fully charge the battery. First charge should be 10 hours and up to 8 hours for recharges. Check to ensure that battery charger is tightly plugged into both the wall and the scooter.
	Battery will not accept full charge.	Make sure power flow to the wall outlet is on. Battery may need to be replaced. Even with proper care, rechargeable batteries do not last forever. The average rechargeable battery life is 1 to 2 years depending on scooter conditions and use.
Scooter suddenly stops working.	Loose plug or wire.	Check all wires and connectors to make sure they are connected and tight.
Scooter runs sluggishly.	Scooter is overloaded.	Make sure you do not overload the scooter by exceeding the 40 kg. Maximum weight limit, going up steep inclines or towing objects behind the scooter. Avoid overloading the scooter as this will prematurely wear out the batteries and components.
	Unsuitable riding conditions.	Ride only on solid, flat, clean and dry surfaces such as pavement or level ground.
	Thermal Fuse activated.	The Thermal Fuse will automatically activate via a power reduction when the motor is overloaded. An excessive overload (steep incline or too heavy of a rider) could have caused the motor to overheat and activated the Thermal Fuse. Scooter may run sluggishly but will return to full power after a few moments.

If you need help or have damaged or missing parts, call the **Customer Helpline: +44(0)1253775570**
 Produced for Chad Valley Toys. *Country of origin:* Made in China
 Address: 489 - 499 Avebury Boulevard, Central Milton Keynes, MK9 2NW.
www.argos.co.uk/chadvalley

