

RN305000 MUK Rev1

morphy richards
smart ideas for your home



SATURNSTEAM

* Register at www.morphyrichards.co.uk/support
UK and Ireland customers only

Pressurised Steam Iron



Please read and keep these instructions for future use

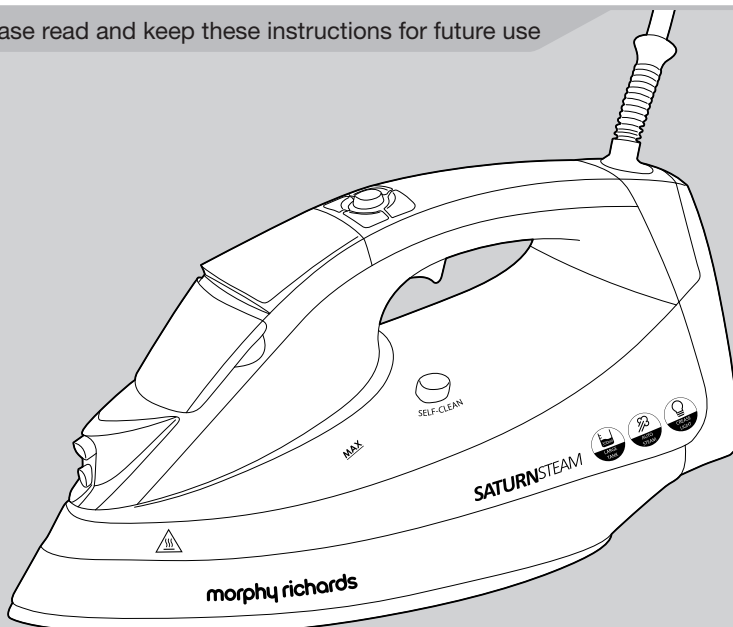

Register your guarantee online: www.morphyrichards.co.uk/support

We'll keep you updated with special offers, competitions and important product information.

If you experience any problems with this iron, do not return to the store.

Please contact our help line who will be happy to help:

UK: 0344 871 0944 IRE: 1800 409 119

We do stock spare filler lids for this iron, so if you need a replacement please call **0344 873 0710**.



IMPORTANT: To prevent limescale damage we recommend a combination of 50% tap water and 50% distilled, deionised or demineralised water. This is particularly important if you live in a hard water area.

Never use battery topping up fluid or water containing any substances like starch, sugar, fragrant additives or defrosted water from a refrigerator.



Failure to maintain your iron will invalidate your guarantee.

www.morphyrichards.com

Important safety instructions

The use of any electrical appliance requires the following common sense safety rules.
Please read these instructions carefully before using the product.

- **WARNING: Disconnect from the mains supply before carrying out any routine maintenance.**
- This appliance can be used by children aged from 8 years and above and persons with reduced physical, sensory or mental capabilities or lack of experience or knowledge if they have been given supervision or instruction concerning use of the appliance in a safe way and understand the hazards involved.
- Children shall not play with the appliance.
- Cleaning and user maintenance shall not be made by children without supervision.
- Keep the iron and its cord out of reach of children less than 8 years of age at all times.
- The iron must not be left unattended while it is connected to the supply mains.
- The plug must be removed from the socket before filling the iron with water.
- The iron must be used and rested on a stable surface.
- When placing the iron on its heel, ensure that the surface on which the heel is placed is stable.
- The iron is not to be used if it has been dropped, if there are visible signs of damage or it is leaking.
- The filling aperture must not be opened during use.
- Do not operate with a damaged grommet, it must be replaced by the manufacturer, its service agent or similarly qualified person in order to avoid a hazard.

-  **CAUTION - HOT:** Burns can occur from touching hot parts.
-  **WARNING:** Do not discharge the steam towards people or animals. Danger of scalding.
- **WARNING:** To avoid electric shock, do not immerse appliance in water / liquid.
- **WARNING:** Misuse of the appliance could cause personal injury.

Electrical requirements and mains cable

- Check that the voltage on the rating plate of your appliance corresponds with your house electricity supply which must be A.C. (Alternating current).
 - Do not let the mains lead come into contact with the hot soleplate of the iron.
 - Should the fuse in the mains plug require changing, a 13 amp BS1362 fuse must be fitted.
 - **WARNING: This appliance must be earthed.**
- PLEASE READ ALL INSTRUCTIONS AND KEEP FOR REFERENCE**

Contents

Important safety instructions	2
Electrical requirements	3
Steam iron overview / Features	4
Digital display overview	5
Temperature guide	6
Before first use	6
Location	6
Usage tips	6
Using the iron	7 & 8
Features	9
Maintaining your iron	10
Troubleshooting	11
Guarantee	12
Contact us	12

Steam iron overview

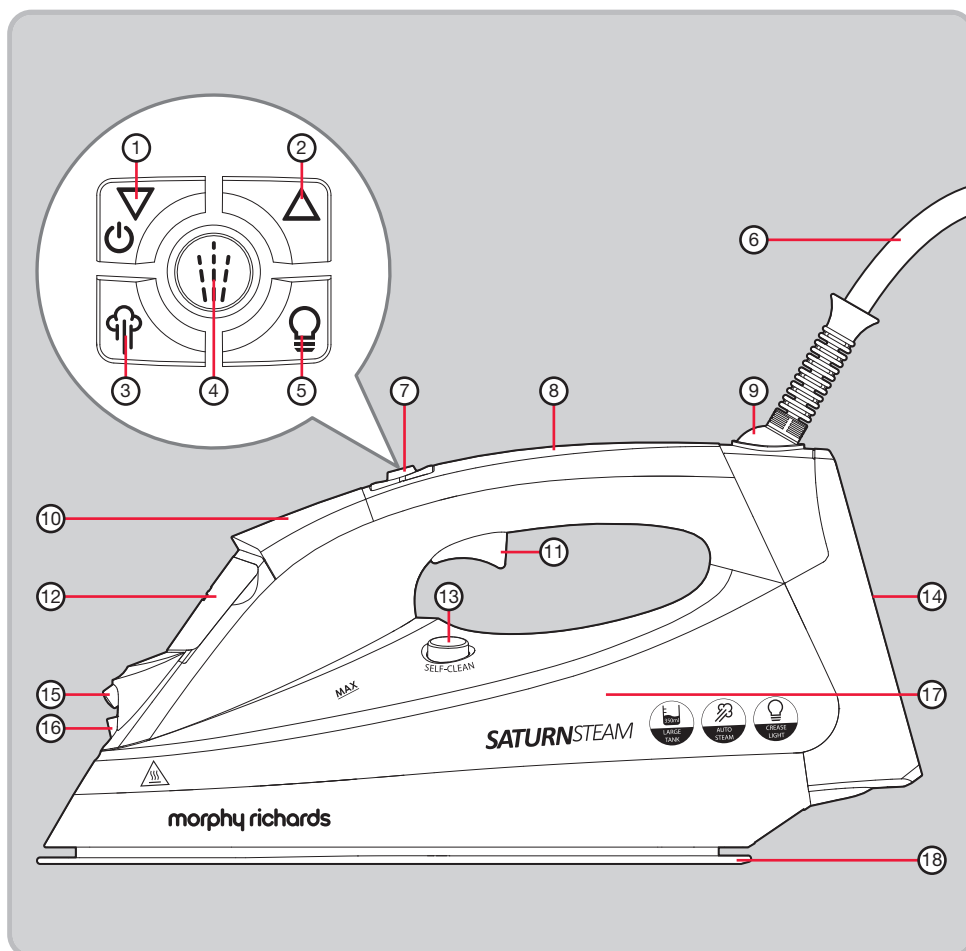

- | | |
|--|-----------------------------------|
| (1) On-off / temperature decrease button | (10) Digital display (see page 5) |
| (2) Temperature increase button | (11) Steam trigger |
| (3) Auto Steam button | (12) Filling cap |
| (4) Water spray button | (13) Self clean button |
| (5) Crease light button | (14) Iron heel |
| (6) Power cord | (15) Crease light |
| (7) Controls | (16) Water spray nozzle |
| (8) Iron handle | (17) Water tank |
| (9) Cable pivot | (18) Soleplate |

Digital display (10) overview

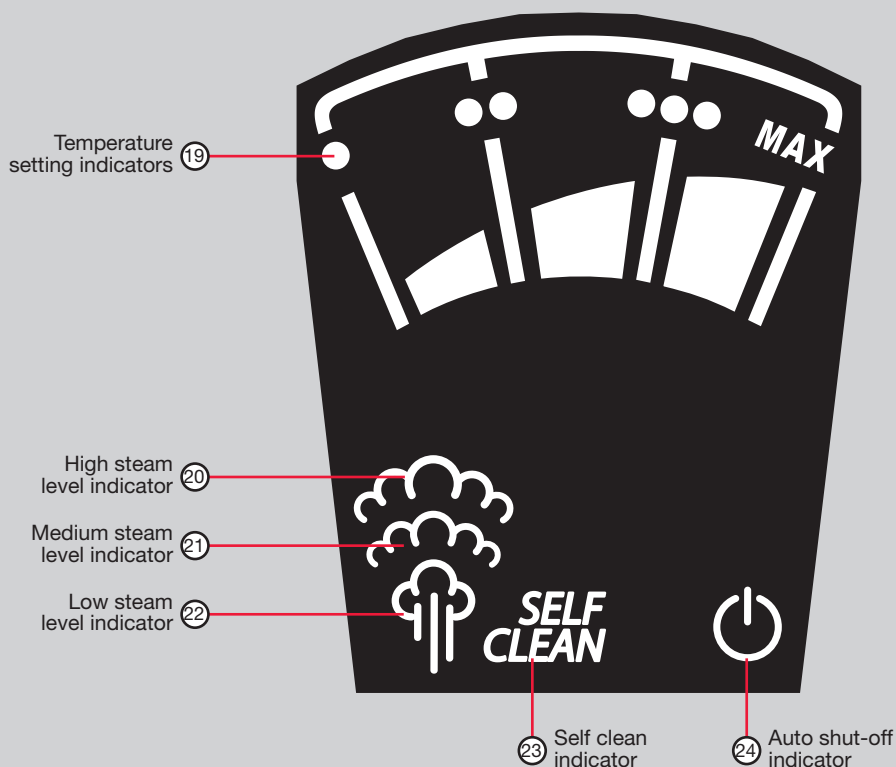

Temperature setting indicators (19)

The temperature indicators correspond with the International Textile Care Labelling Code as shown on the labels of your garments (see 'Temperature guide' on page 6).

Steam level indicators (20/21/22)

The steam level is automatically adjusted to suit the selected temperature setting. The steam level indicators change when you select your desired temperature level.

Self Clean indicator (23)











This indicator will illuminate when the system requires cleaning.

Auto shut-off indicator (24)

This indicator illuminates if the appliance has entered auto shut-off mode after not being used or moved for 1 minute if sat horizontally, or 8 minutes if stood upright on its heel.

Temperature guide

Heat setting markings on the temperature dial of all Morphy Richards irons match those of the International Textile Care Labelling Code

Symbol	(120°C Max) Cool	(160°C Max) Warm	(210°C Max) Hot	MAX setting
				
Temperature level settings	Do not iron	•	••	•••
Steam level setting (see step 5 of 'Using the iron' on page 8)	No steam (see 'Dry ironing' on page 9)	Low	Medium / High	High
				
Fabric	Nylon, Acetates, synthetic fabrics	Wool, Polyester mixtures	Cotton, Linen Rayon, Rayon mixtures	
Ironing	Iron on wrong side, if moisture required, use damp cloth (not Acetate)		Fabrics requiring this setting usually require steam pressing.	
Steaming				
Without steam				

Before first use

Remove all packaging and any protective cover from the soleplate (18), if any. Unwind and straighten the power cord (6).

We recommend for first time ironing that you iron over an old towel.

Location

Stand the iron on its heel (14) and locate it on the iron rest plate of your ironing board (if large enough) or on a heat resistant stand at the same height as your ironing board or below it. Always ensure the iron is on a firm surface when ironing.

WARNING: Do not use the product on a surface which could be damaged by heat or steam such as a worktop or a polished wood surface.

If in doubt, contact Morphy Richards.

Usage tips

Unwind and straighten the power cord (6).

Textiles and clothes carry ironing instructions. If not, follow the temperature guide above, but test the temperature by ironing the hem of the garment or other discreet area first.

It is advised to begin with 'cool' fabrics (see above) and work up to higher settings. An iron heats up quicker than it cools down so you'll save time.

If you turn the temperature level down from a hot setting to a cooler setting, wait until the temperature setting indicator (19) stops flashing (indicating the correct temperature has been reached) before you continue ironing.

Using the iron

1) Filling the tank

Make sure the iron is not plugged in. Fill the water tank (11) via the filling hole (6) to the MAX graphic on the side of the water tank, this shows the MAX level of water that the tank can hold and should be checked whilst filling and the iron is tilted.

TO PROLONG THE LIFE OF THIS IRON, WE RECOMMEND A MIX OF 50% TAP WATER AND 50% DISTILLED, DEIONISED OR DEMINERALISED WATER, ESPECIALLY IN HARD WATER AREAS.

Never use battery topping up fluid or water containing any substances like starch, sugar, fragrant additives or defrosted water from a refrigerator.

NOTE: Please see point 2 of 'Exclusions' on page 12.

Re-filling during use

If the water level is too low, the unit will not produce steam. If this happens, open the filling cap (12) and refill with water.

2) Temperature Selection

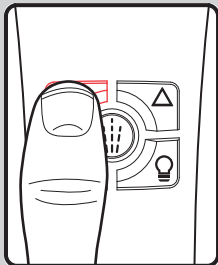

Plug the appliance into a mains outlet, a beep will be heard. Press the on-off / temperature decrease button (1) to switch the product on. The 1-dot temperature setting indicator (19) on the digital display (10) will flash until the temperature is reached, at which point the 1-dot temperature setting indicator will remain constant and two beeps will be heard.

3)

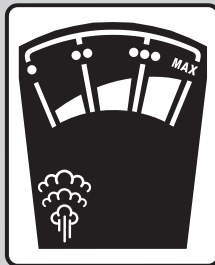
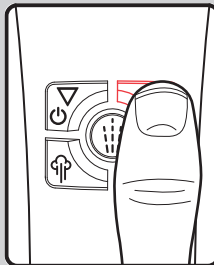

If a different temperature is required to suit the garment (see 'Temperature guide' on page 6), you may adjust the temperature as follows: press either the temperature increase (2) or temperature decrease button (1) repeatedly until the required temperature setting indicator (19) is displayed.

4)

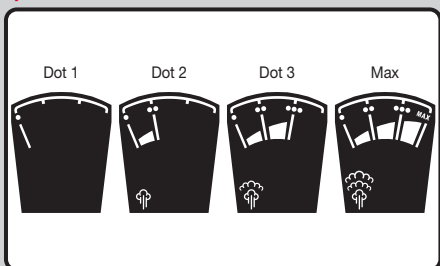

The appropriate temperature setting indicator (19) will flash until the desired temperature is reached, at which point two beeps will be heard. Begin ironing when the temperature indicator illuminates constantly. If you turn the temperature down, wait until the temperature indicator stops flashing before continuing ironing.

WARNING: Keep hands and body away from the hot soleplate (18).

NOTE: The temperature setting will reset between each use. When the iron is plugged in it will require switching on and the required temperature selecting.

Using the iron (continued)

5) Auto Steam button

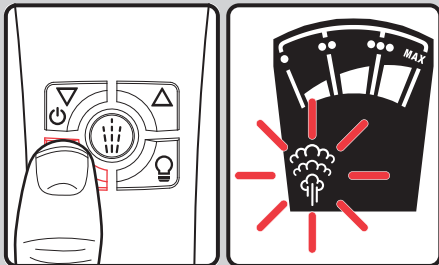

The steam level is automatically adjusted to suit the selected temperature setting. This is denoted by the steam level indicators (20/21/22) on the digital display (10), which will change along with the temperature setting indicators (19) when you select your desired temperature level.

To activate the steam pump and have steam constantly emitted from the soleplate (18) during ironing, press the Auto Steam button (3). The steam level indicator will flash indicating that the pump is operating and steam is being produced. To stop the pump producing steam, press the Auto Steam button again, the steam level indicator will stop flashing and remain constantly illuminated.

We recommend switching off the steam when resting the iron on its heel. This is to slow the water usage down and save time on refilling.

7) Water spray

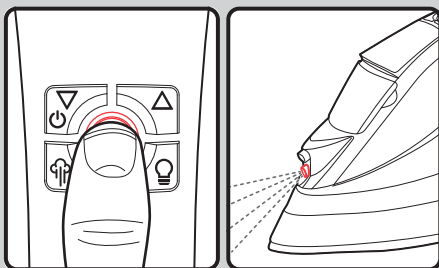

To help remove stubborn creases, you may use the water spray function. Aim the water spray nozzle (16) at the difficult area on the garment and firmly press and hold the water spray button (4).

Pressing the water spray once will dispense a set amount of water.

6) Steam boost

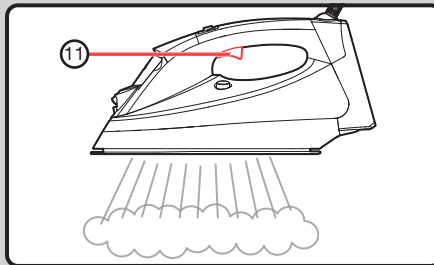

The steam boost function is ideal for relaxing the fibres of tougher fabrics (like jeans and linen) and getting rid of those stubborn, hard to reach creases.

To produce an extra boost of steam during ironing, press and hold the steam trigger (11).

NOTE: Steam cannot be produced on the 1-Dot setting - this is highlighted by no steam level indicators (20/21/22) being visible on the digital display (10) whilst the 1-Dot setting is selected.

NOTE: For optimum steam quality, do not operate the shot more than three times in succession.

8) Switching off

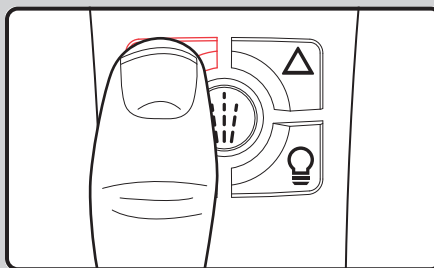

When you have finished ironing, turn off the appliance by pressing and holding the on-off / temperature decrease button (1) for two seconds. Two beeps will be heard and all indicators on the digital display (10) will switch off.

Disconnect the plug from the mains outlet.

Features

Crease light

To enable clearer vision in difficult to see areas, press the crease light button (5) to switch on the crease light (15), press again to switch off.

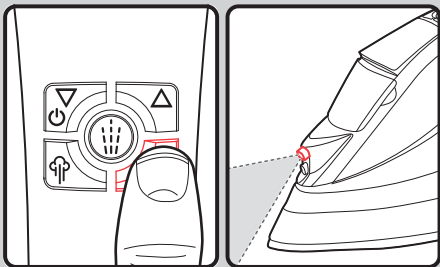

Dry ironing

To use your iron as a dry iron only, follow steps 2, 3, and 4 of 'Using the iron' on page 7. Do not press the Auto Steam button (3) to operate the steam pump. You do not need to put water in the water tank (17).

Vertical steam

Vertical steam is useful for removing creases from hanging clothes, curtains, upholstery, etc. Hold the iron between 1cm and 2cm away from the item and press the steam trigger (11).

Hold the iron vertically and turn on the Auto Steam function for a constant flow of steam. Simply allow the steam to pass lightly over the item of clothing in question to help the creases soften away. To generate a powerful shot of steam for stubborn creases, press the steam trigger. You can also use vertical steaming to clean and refresh the upholstery around your home.

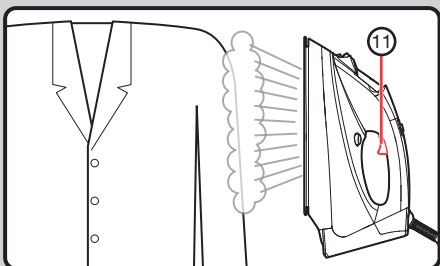

WARNING: Do not use the vertical steam feature on clothes that are being worn.

Auto shut-off

If the iron is not moved or any buttons on the controls (7) are unused for 1 minute if sat horizontally, or 8 minutes if stood upright on its heel, the product will automatically turn off for safety and to save energy. When this happens, the auto shut-off indicator (24) will flash and beep once.

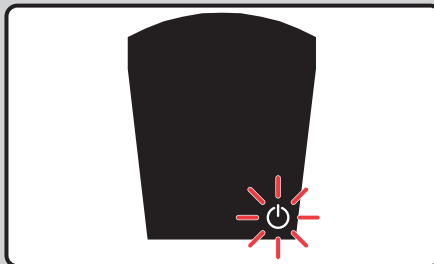

To restart, either move the iron or press any buttons on the controls (7) and wait for the temperature to rise again.

NOTE: The appliance is not turned off completely in auto shut-off mode. To switch the product off, press and hold the on-off / temperature decrease button (1) until all indicators in the digital display (10) extinguish, then unplug the product from the mains outlet.

Maintaining your iron

Emptying and storing

When you have finished ironing, press and hold the on-off / temperature decrease button (1) to switch the product off, then unplug and empty all water from your iron. When cool, store the iron on its heel (14) with the power cord (6) wrapped loosely around the heel.

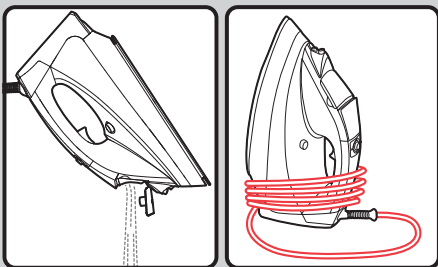

NOTE: Please see point 3 of 'Exclusions' on page 12.

Cleaning the soleplate

To clean a coated soleplate

Do not use scouring powder or solution as this could cause damage to the coating.

If any man-made fibres fuse to the soleplate (18), set the iron at the MAX setting and pass it over a clean piece of cotton to draw the deposit off the surface.

To clean the exterior

Allow the unit to cool and wipe over with a damp cloth and mild detergent, then wipe dry.

Removing limescale

Your iron has a built in self clean system designed to keep the water valve, steam chamber and steam vents clear of lint and loose mineral deposits.

When the self clean icon (23) appears on the digital display (10), the self clean function must be operated.

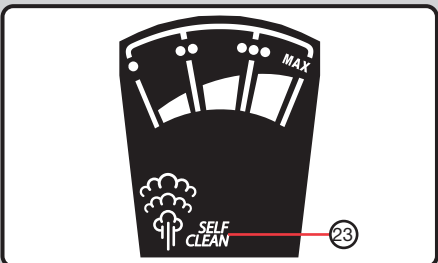

- 1 Half fill the iron with water.
- 2 Connect to a mains supply outlet.
- 3 Set the temperature to the MAX setting. Wait for the temperature to be reached - the temperature setting indicator (19) will illuminate constantly.
- 4 Press and hold the on-off / temperature decrease button (1) to switch the product off.
- 5 Disconnect the iron from the mains supply outlet.
- 6 Whilst the iron is still very hot, hold the iron horizontally over a sink.

CAUTION: The soleplate will still be hot, so ensure the power cord and plug are kept away from it and the sink.

- 7 Press and hold the self-clean button (13).

WARNING: Steam and boiling hot water will drain from the holes in the soleplate. Keep hands and body away from the hot water. This washes away the scale and minerals that have built up inside the steam chamber.

- 8 Whilst still holding the self-clean button, gently move the iron back and forth until the water tank is empty.
- 9 When steam and hot water ceases to be released from the soleplate, release the self-clean button.
- 10 When the process is complete, re-connect to a mains supply outlet, switch on and allow to heat up - this will dry the soleplate.
- 11 Disconnect the iron from the mains supply outlet.
- 12 Rest your steam iron on its heel (14) and allow to fully cool down.
- 13 Wipe the soleplate with a cold, damp cloth. After this cleaning operation, empty out any remaining water.

IMPORTANT: Do not attempt to descale the soleplate with descaling products.

Troubleshooting

Problem	Solution
<ul style="list-style-type: none"> No power or not heating up. 	<ol style="list-style-type: none"> 1. Check the fuse and the fuse rating (should be 13amp). 2. Try a different appliance in the socket as it may be the socket that is at fault. 3. Check that the auto shut off has not operated. 4. Ensure the iron is switched on by pressing the on-off / temperature decrease button (1).
<ul style="list-style-type: none"> Overheating or not getting hot enough. 	<ol style="list-style-type: none"> 1. Adjust the temperature to ensure the setting matches that recommended on the garment or refer to the “temperature guide” section. 2. Allow the iron to reach temperature and stabilise for 1-2 minutes if it has just been plugged in, or has just been woken up from auto shut off.
<ul style="list-style-type: none"> Not steaming or poor steam. 	<ol style="list-style-type: none"> 1. Ensure the temperature is set within the steam band and that the steam level is set to the correct level (refer to the “temperature guide” section). 2. Check that there is enough water in the tank. 3. If the auto shut off feature has activated, wake up the iron and allow it to reach temperature before using steam. 4. Perform a self-clean to clear away limescale inside the iron (refer to “Removing limescale” section). 5. Please remember the iron does not steam on the 1-dot setting.
<ul style="list-style-type: none"> The product occasionally produces a pumping sound during steam ironing. 	<ol style="list-style-type: none"> 1. This is normal and is caused by water being pumped through the steam pump. 2. If the pumping sound suddenly becomes louder or the steam diminishes, check and refill the water tank if it has become empty.
<ul style="list-style-type: none"> Dripping from the holes in the soleplate. 	<ol style="list-style-type: none"> 1. Use the steam for short amounts of time. 2. Perform a self-clean to clear away limescale inside the iron (refer to “Removing limescale” section). 3. If the auto shut off feature has activated, wake up the iron and allow it to reach temperature before using steam.
<ul style="list-style-type: none"> Tripping Electrics. 	<ol style="list-style-type: none"> 1. Try using a different socket. 2. Ensure there are no other appliances being used on the same set of sockets as the iron.
<ul style="list-style-type: none"> The filler cap is broken or does not close properly. 	<ol style="list-style-type: none"> 1. Call our helpline to order a new replacement filler cap to be sent out. 2. Please note, there may appear to be a gap between the digital screen and filler cap, as long as the cap clicks shut, water should not leak out.
<ul style="list-style-type: none"> Steam is triggered when I press the water spray button. 	<ol style="list-style-type: none"> 1. This is normal, a small amount of steam may appear when pressing the water spray button.

RN305000 MUK Rev1 10/17

Registering your guarantee

Your standard 1 year guarantee is extended for an additional 2 years when you register the product within 28 days of purchase with Morphy Richards. If you do not register the product with Morphy Richards within 28 days, your product is guaranteed for 1 year. To validate your 3 year guarantee, register with us online at

www.morphyrichards.co.uk/support

Or call our customer registration line

UK 0344 871 0242

IRE 1800 409 119

N.B. Each qualifying product needs to be registered with Morphy Richards individually.

Please note that the 3 year guarantee is only available in the UK and Ireland. Please refer to the 1 year guarantee for more information.

Your 1 year guarantee

It is important to retain the retailer's receipt as proof of purchase. Staple your receipt to this back cover for future reference.

Please quote the following information if the product develops a fault. These numbers can be found on the base of the product.

Model no.

Serial no.

All Morphy Richards products are individually tested before leaving the factory. In the unlikely event of any appliance proving to be faulty within 28 days of purchase, it should be returned to the place of purchase for it to be replaced.

If the fault develops after 28 days and within 12 months of original purchase, you should contact the Helpline number quoting Model number and Serial number on the product, or write to Morphy Richards at the address shown.

You may be asked to return a copy of proof of purchase.

Subject to the exclusions (see Exclusions), the faulty appliance will then be repaired or replaced as appropriate and dispatched usually within 7 working days of receipt.

If, for any reason, this item is replaced or repaired during the 1 year guarantee period, the guarantee on the new item will be calculated from original purchase date. Therefore it is vital to retain your original till receipt or invoice to indicate the date of initial purchase.

To qualify for the 1 year guarantee, the appliance must have been used according to the instructions supplied.

Exclusions

Morphy Richards shall not be liable to replace or repair the goods under the terms of the guarantee where:

- 1 The fault has been caused or is attributable to accidental use, misuse, negligent use or used contrary to the manufacturer's recommendations or where the fault has been caused by power surges or damage caused in transit.
- 2 The fault is caused by limescale build-up.
- 3 The cables are damaged due to wrapping too tightly or excessive kinking.
- 4 The appliance has been used on a voltage supply other than that stamped on the products.
- 5 Repairs have been attempted by persons other than our service staff (or authorised dealer).
- 6 The appliance has been used for hire purposes or non domestic use.
- 7 The appliance is second hand.
- 8 Morphy Richards reserves the right not to carry out any type of servicing under the guarantee at its discretion.

- This guarantee does not confer any rights other than those expressly set out above and does not cover any claims for consequential loss or damage. This guarantee is offered as an additional benefit and does not affect your statutory rights as a consumer. Morphy Richards products are intended for household use only. See usage limitations within the location safety instructions.

Disclaimer

Morphy Richards has a policy of continuous improvement in product quality and design. The company, therefore reserves the right to change the specification of its models at any time.



For electrical products sold within the European Community. At the end of the electrical products useful life, it should not be disposed of with household waste.

Please recycle where facilities exist. Check with your Local Authority or retailer for recycling advice in your country

Contact us

Helpline

If you are having a problem with your appliance, please call our Helpline, as we are more likely to be able to help than the store you purchased the item from. Please have the product name, model number and serial number to hand when you call to help us deal with your enquiry quicker.

UK Helpline: **0344 871 0944**

IRE Helpline: **1800 409 119**

Spares: **0344 873 0710**

Talk to us

If you have any questions or comments, or want some great tips to help you get the most out of your products, join us online:

Blog: www.morphyrichards.co.uk/blog
 Facebook: www.facebook.com/morphyrichardsuk
 Twitter: [@loveyourmorphy](https://twitter.com/loveyourmorphy)
 Website: www.morphyrichards.com
 Address: **The After Sales Division
 Morphy Richards Ltd
 Mexborough,
 South Yorkshire,
 England, S64 8AJ**

