

WATER LIMBO

Assembly & User Instructions - Please keep for future reference

797/1675



Assembly

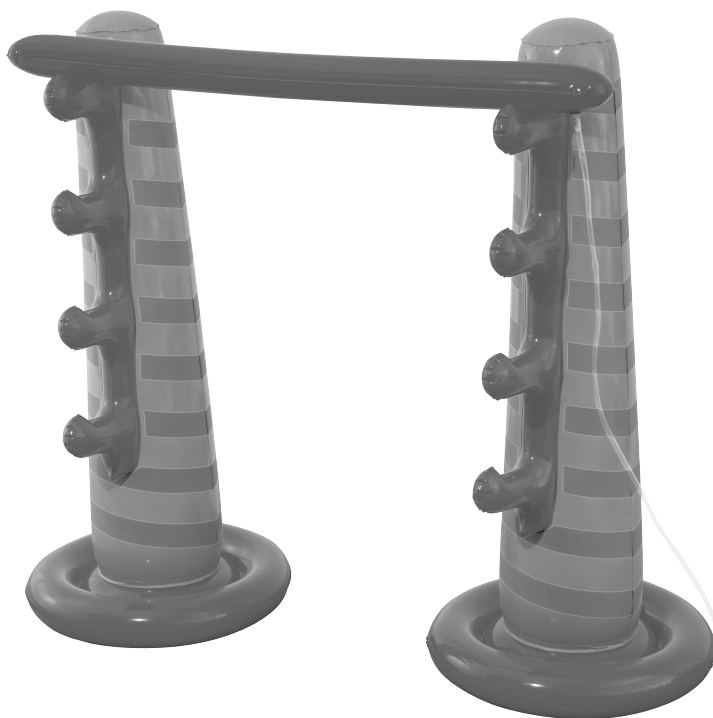

Important

Age: 3 + years

The dimension of assembled product: L175 * W71 * H150CM

Important – Please read these instructions fully before assembly or use

These instructions contain important information which will help you get the best from your product and ensure safe and correct assembly, use and maintenance.

P-S-004841



Safety Information

Important – Please read these instructions fully before assembly or use

OWNER'S MANUAL

WARNING

- Only for domestic use. Only for outdoor use.
- The product shall not be installed over concrete, asphalt or any other hard surface.
- Place the product on a level surface at least 2m from any structure or obstruction such as a fence, garage, house, overhanging branches, laundry lines or electrical wires.
- Recommend back towards the sun when playing.
- Keep assembly and installation instructions for further reference.
- Before using the product, carefully check if there are any leaks or broken parts.
- Do not place on stones, sticks or any sharp objects that may puncture the product.
- Do not kick, throw or sit on the product.
- Keep away from flames and fires.
- Use only under competent supervision.
- Adult assembly required.

NOTE: Air pump not included.

Assembly

1. Open the 3-interconnecting valve to fill water in the water chamber and close the first cap, then inflate the same chamber with air pump (not included), close the valve after inflation and press it into the air chamber.

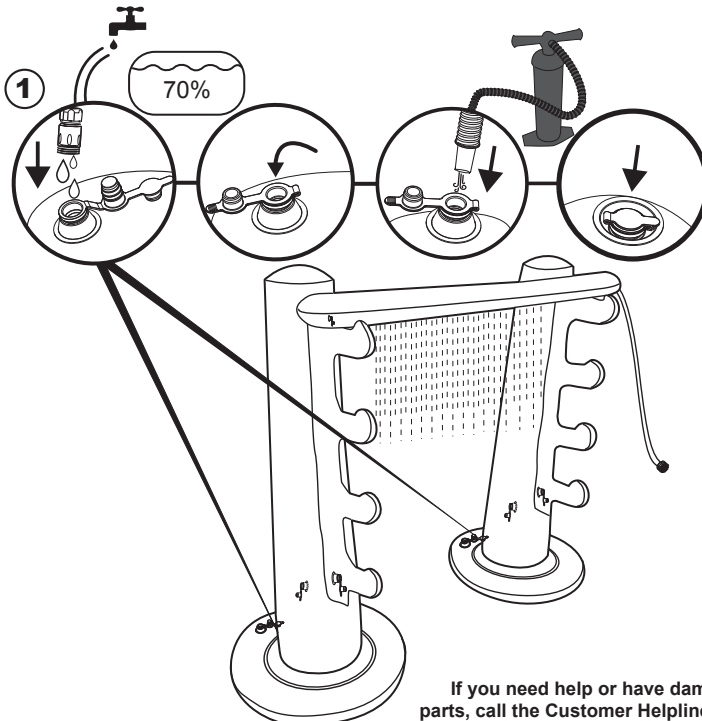

If you need help or have damaged or missing parts, call the Customer Helpline: 0345 6400 800.

P-S-004841

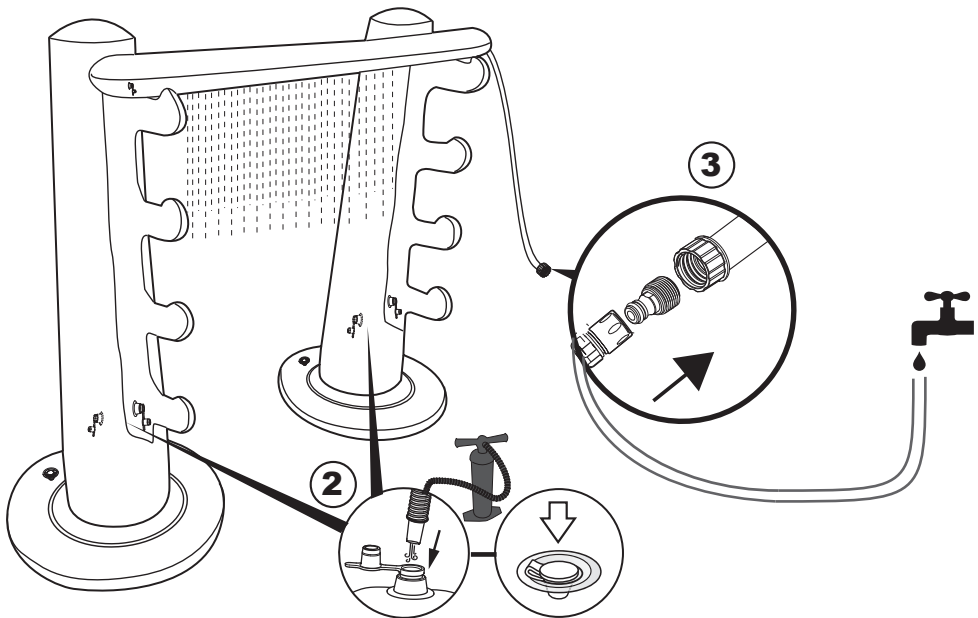

2. Open the safety valves and inflate the parts one by one. Be sure to close the valves after inflation.
NOTE: Do not over inflate. Do not use either an air compressor or compressed air.
3. Connect your garden hose to the Hose Adapter. **NOTE:** Hose adapter included.



Cleaning and Maintenance

1. After use, use a damp cloth to gently clean all surfaces.
NOTE: Never use solvents or other chemicals that may damage the product.
2. Store in a cool, dry place and out of children's reach.
3. Check the product for damage at the beginning of each season and at regular intervals when in use.

Repair

- If a chamber is damaged, use the provided repair patch.
1. Completely deflate the product.
 2. Clean and dry the damaged area.
 3. Apply the provided repair patch and smooth out any air bubbles.



If you need help or have damaged or missing parts, call the **Customer Helpline: 0345 6400 800**.
 Produced for Chad Valley Toys Argos Ltd. *Country of origin:* CHINA.
 Address: 489-499 Avebury Boulevard, Central Millen Keynes, MK9 2NW.
www.argos.co.uk

P-S-004841