

Junior Twin Cruise Stroller dolls pushchair

Safety Notes

EN This item is a toy and not suitable for carrying babies, children or pets. Assembly should be carried out by an adult to prevent the item collapsing in use. Please remove all packaging attachments before giving this toy to a child. An adult should check all mechanisms of this toy regularly. Always play under adult supervision. Warning! Not suitable for children under 36 months. Strangulation hazard due to long cord and choking hazard due to small parts. Made in China.

Assembly

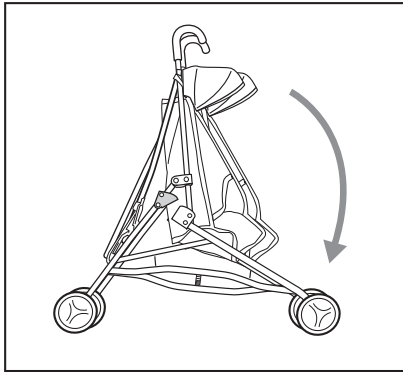

1. Open the stroller in the direction as shown

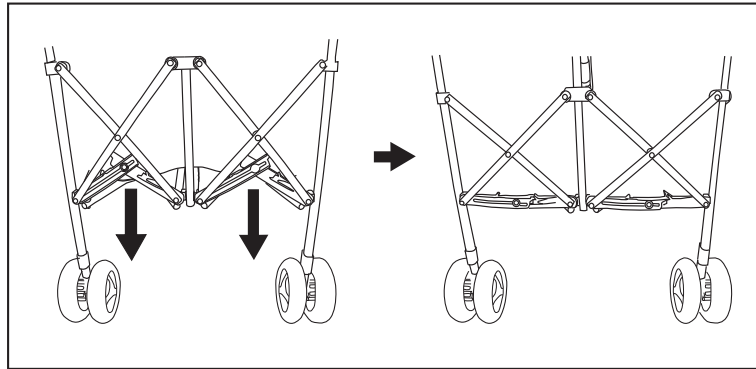

2. Press the safety lock downwards until they click in a horizontal position.

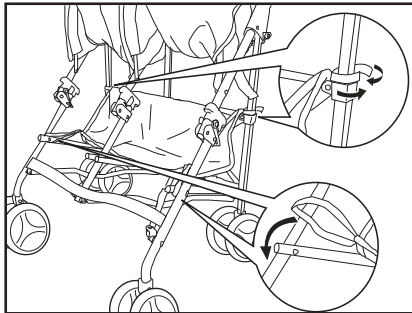

3. Fix the basket on the base frame as shown.

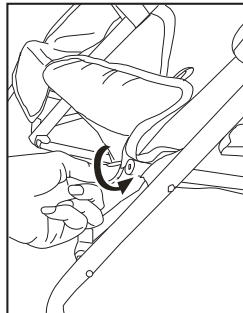

4. Fix the fabric on the frame as shown.

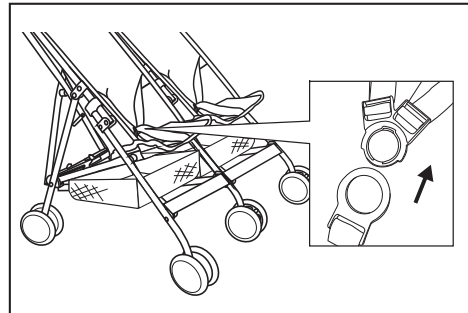

5. Seat buckle

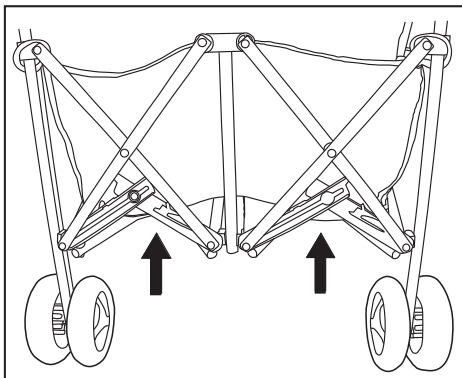

6. To fold, release the safety locks at the back.

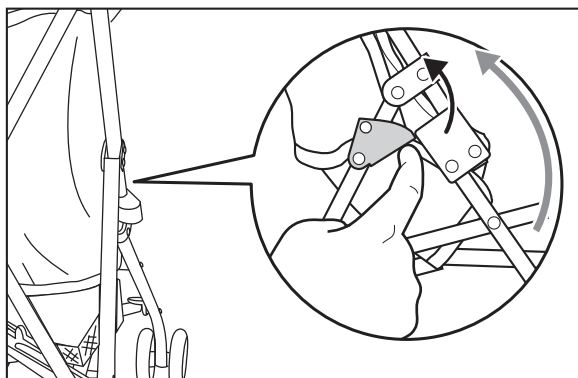

7. Rotate the two side locks to allow the stroller to fold.

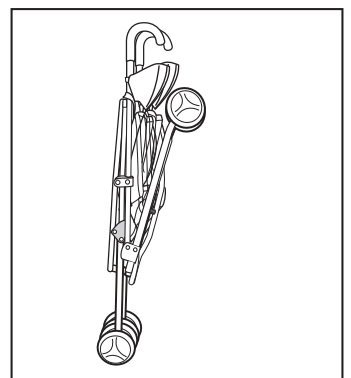

8. Rotate front wheels towards handles to fold flat.

Care Notes

Please wipe clean using a damp cloth with mild detergent if necessary.

Contact Details

If you experience any difficulty with this item or you wish to enquire about any accessories or spare parts, please contact our customer service department on:
customerservice@htigroup.co.uk
+44 (0)1253 775570

Designed and Manufactured by:



HTI Group, Eastham House,
Copse Road, Fleetwood,
FY7 7NY, UK



www.htigroup.co.uk

You are advised to keep these details for future reference.

© Mamas & Papas is the trade mark of, and is used under license from, Mamas & Papas Limited.



HTI EU Authorised Representative
The Merrion Buildings -
Iconic Offices, 18-20 Merrion Street,
Dublin 2, D02 XH98, Ireland

www.htigroup.co.uk

