

Installation Instructions

Installation guides:

⚠ In case of stack installation, do not place the washing machine on a platform higher than the ground to prevent dumping and falling.

1. Do not strip the screws, you must use the attachment screws to prevent them from becoming mismatched after replacement.
2. During installation, two people must work together while keeping a safe distance from the wall.
3. Be careful to prevent the bracket and wooden support from falling out and causing injury.

Note: the pictures shown are schematic diagrams.

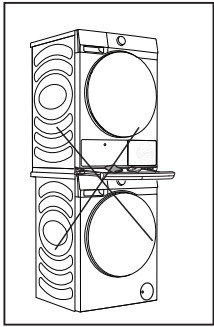

⚠ Bearing capacity exceeding 18 KG is not allowed for the support.

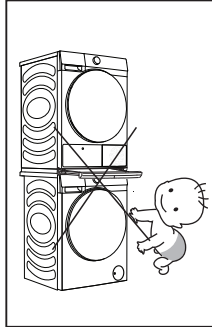

⚠ Children are not allowed to climb

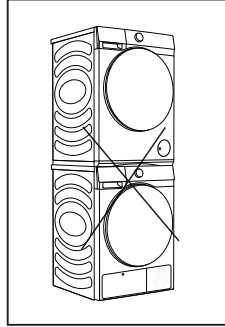

⚠ Do not place washing machine on top

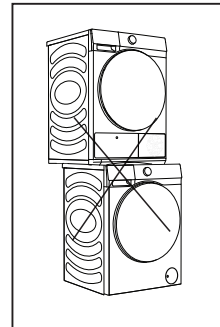

⚠ Installation in a staggered manner is not allowed

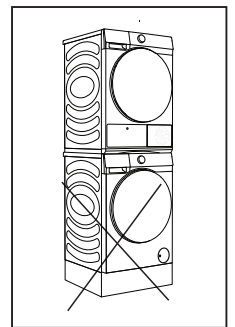

⚠ Do not use base for washing machine

Packing list

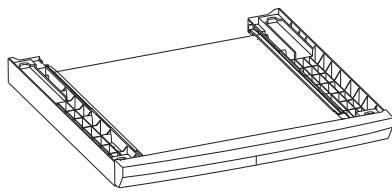

..... Support × 1



..... Left fixing clip × 1



..... Foot accessory × 4



..... Right fixing clip × 1



..... Round head screw × 8



..... 3M tape × 4



..... Instruction × 1

①

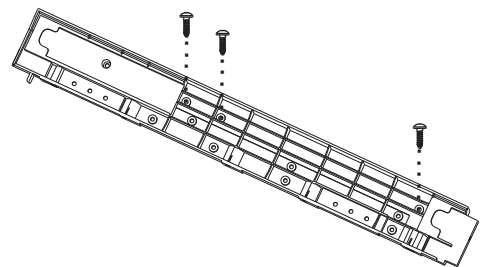
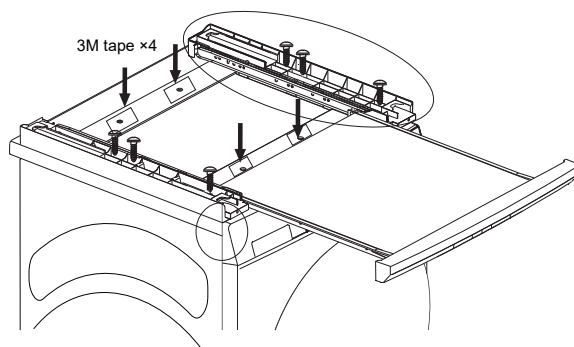
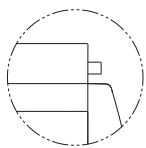

1. Place the bracket flat on the top cover of the washing machine. Align the front end of the bracket with the side panel according to the enlarged diagram on the left side. Pull out the drawer to its maximum distance to expose the two middle connecting plates. At the four screw holes on the connecting plates, as shown in the diagram, attach the four pieces of 3M tape provided in the accessories between the connecting plate and the washing machine top cover. Lean forward and press the 3M tape position for more than three minutes. Then, according to the enlarged diagram on the right side, use three round head screws to fix the bracket on the top cover of the washing machine through the outermost three screw holes of the bracket. Please NOTE: this will result in small holes being made in the top cover of the washing machine.

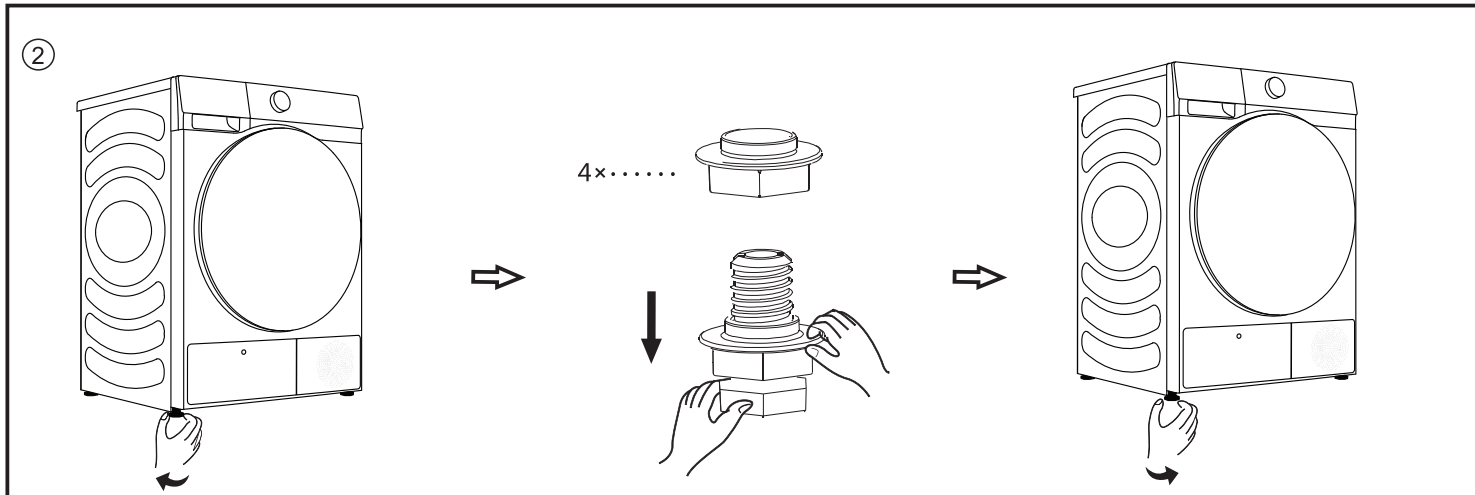

2. Unscrew the 4 feet of the clothes dryer, insert the 4 foot accessories into the feet as shown in the figure, and then reinstall the feet in place.

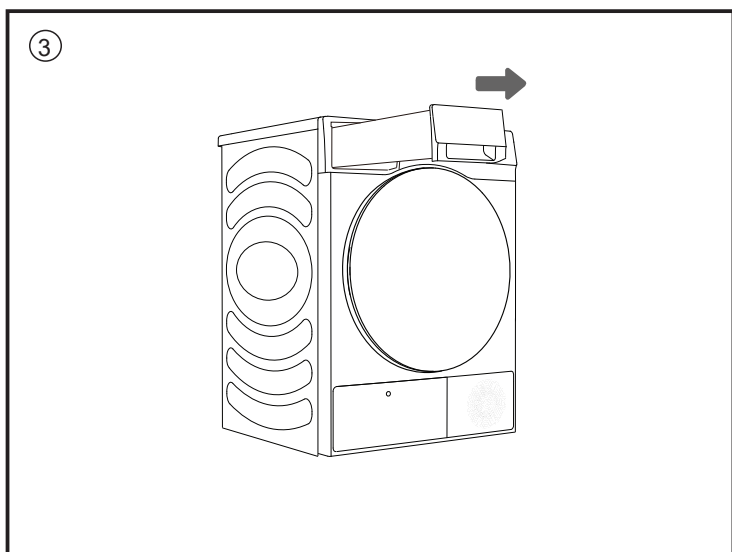

3. Draw the water box, and empty it if there is residual condensate water in it. (This step can be ignored for new machines)

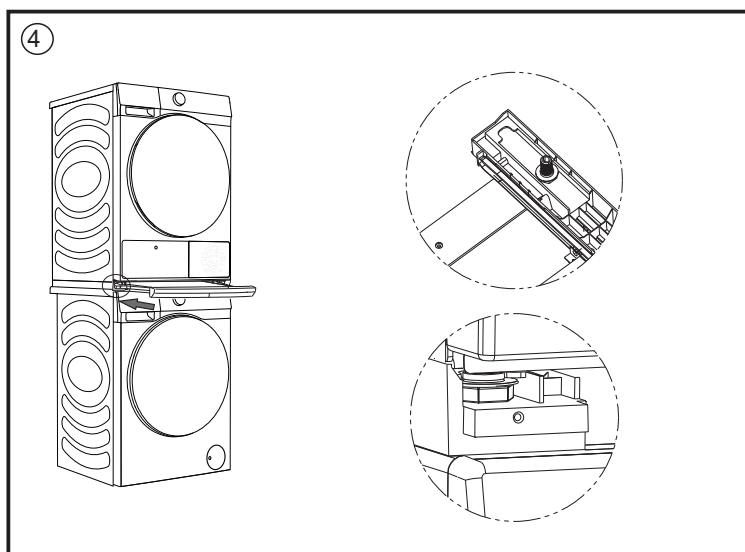

4. Take out the drawer board and place dryer on the rail of supporting bracket. Make sure that 2 feet at the back are placed according to the diagram, then push in direction of the arrow. Finally put all 4 feet in the socket of the bracket based on the diagram.

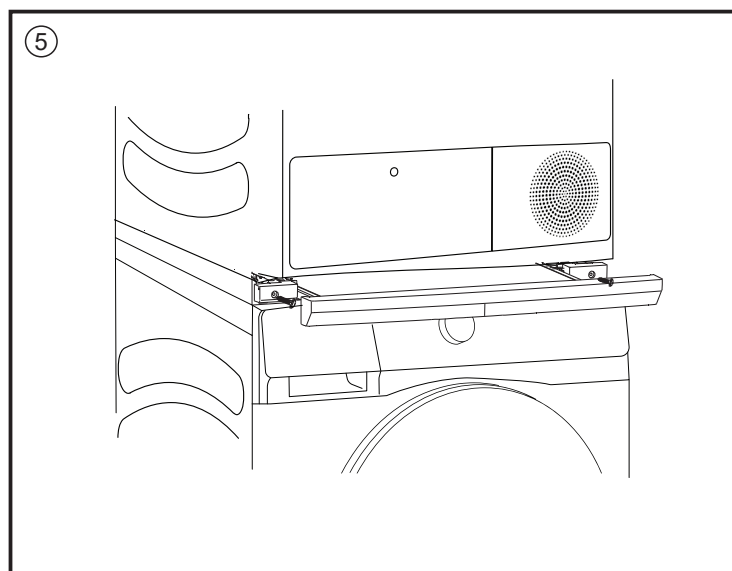

5. Install the left and right fixing clips on the left and right supports respectively as shown in the figure, and then fix them with 2 round head screws.

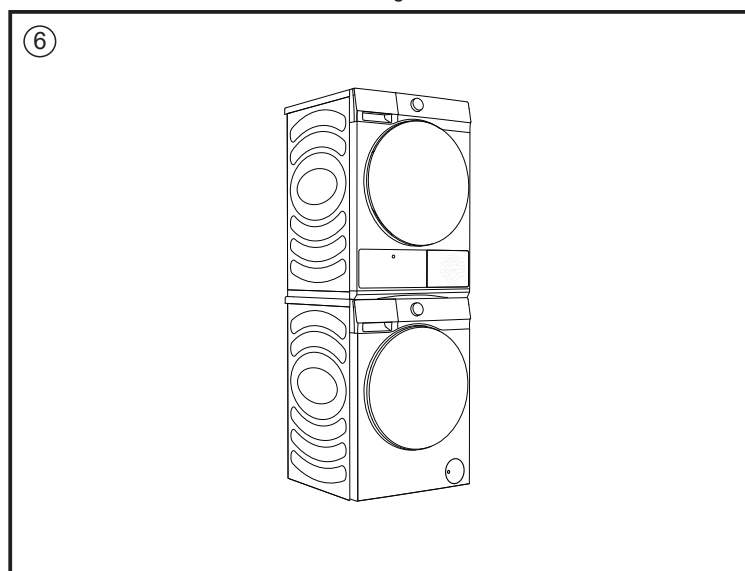

6. Check whether the whole machine is firmly installed.

After installation, you can use an additional drain pipe to connect to the original drainage pipe, floor drain or water box.