

**IMPORTANT! RETAIN THESE
INSTRUCTIONS FOR FUTURE
REFERENCES.
ASSEMBLY TO BE CARRIED OUT
BY A COMPETENT ADULT ONLY.**

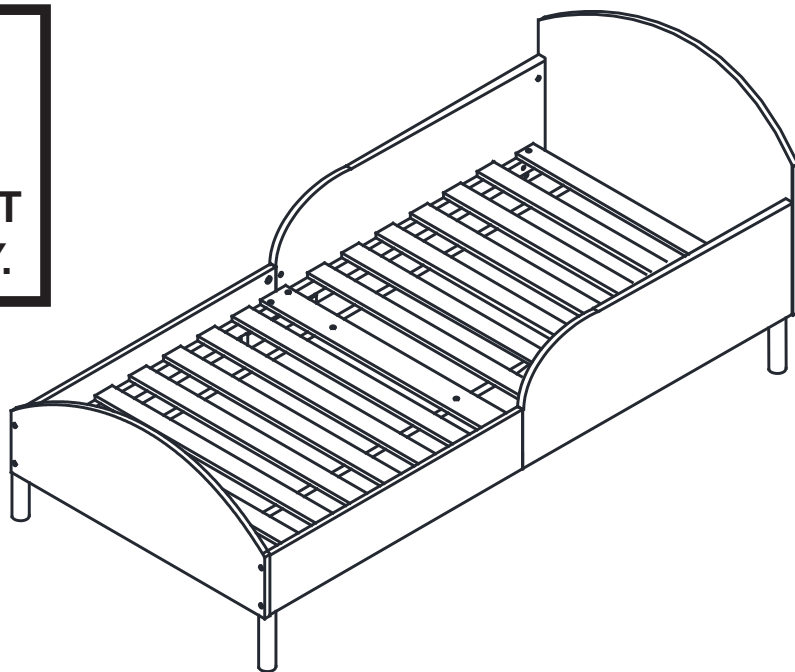

FOR USE WITH A 1400 x 700mm MATTRESS

PART LIST

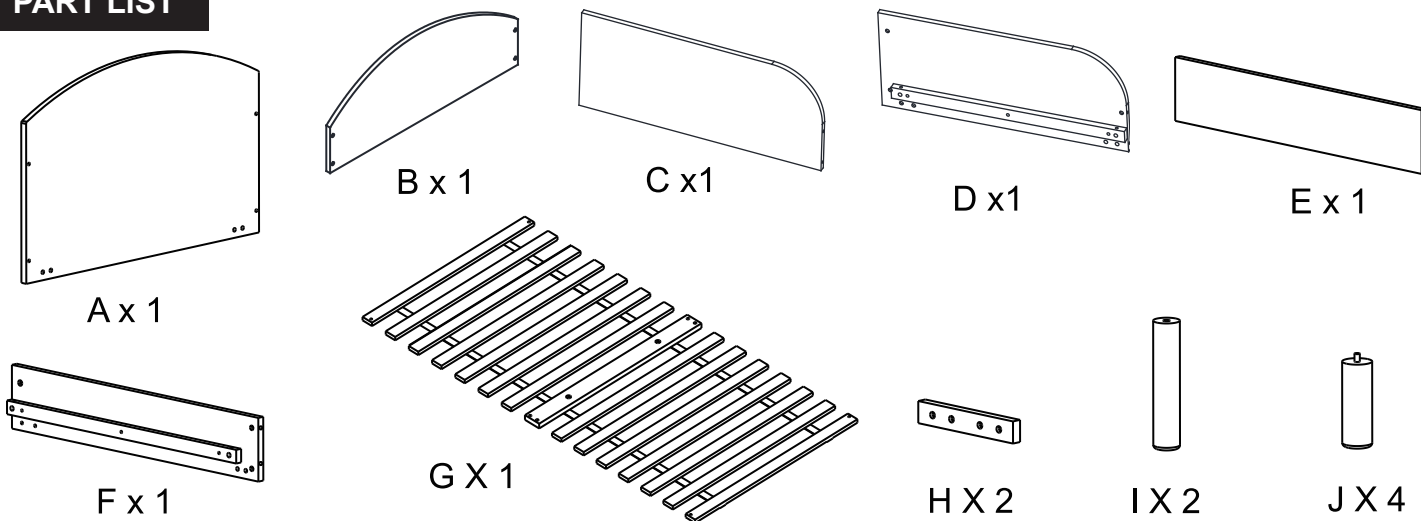

HARDWARE



TOOLS REQUIRED

1. Phillips Head Screw Driver (not supplied)
2. Flat Head Screw Driver (not supplied)



Step 1

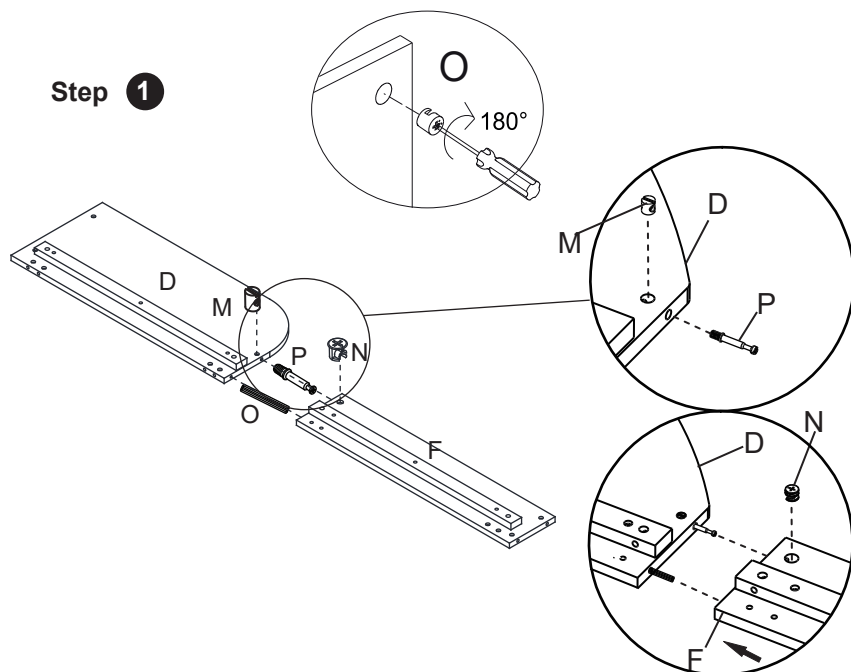

Step 2

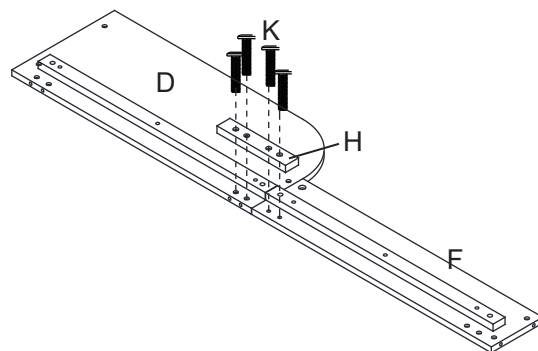

Step 3

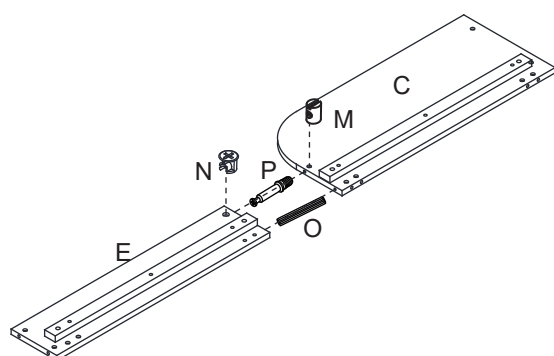

Step 4

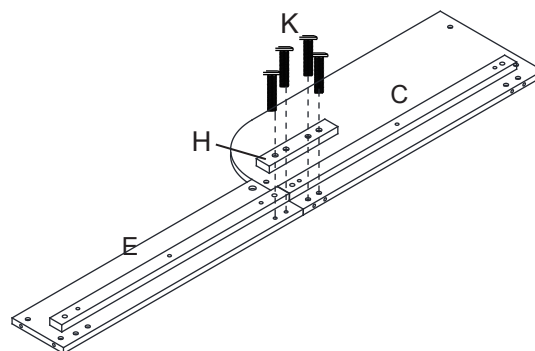

Step 5

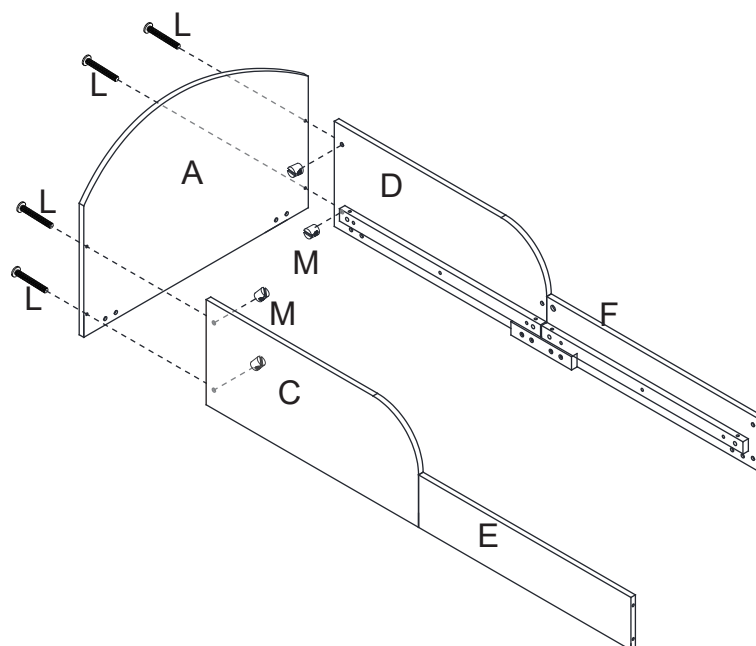

Step 6

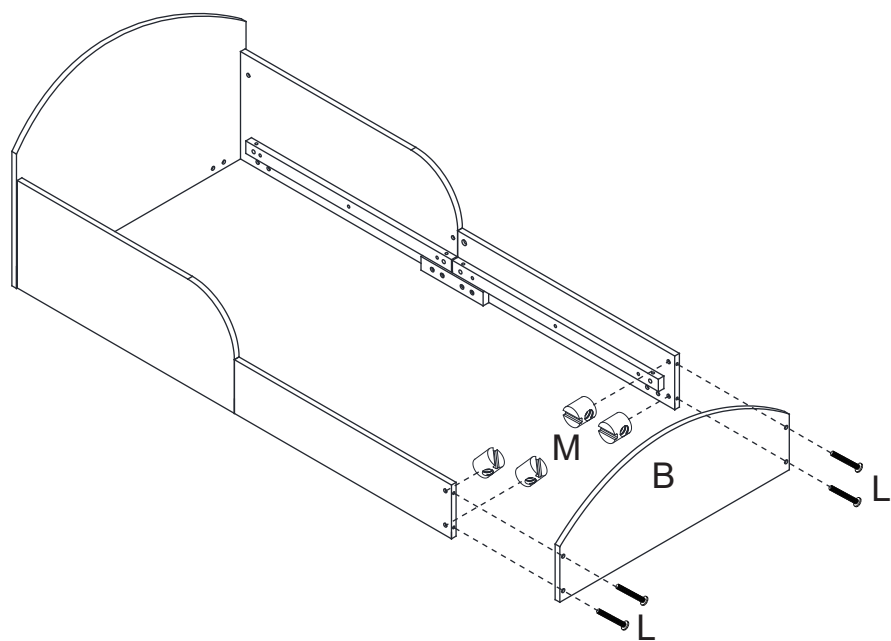

Step 7

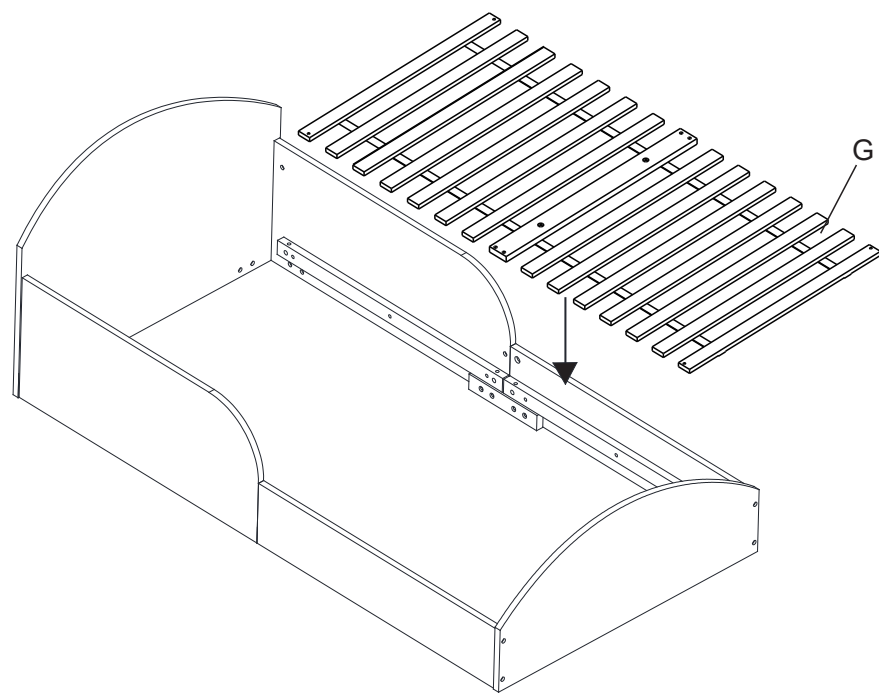

Step 8

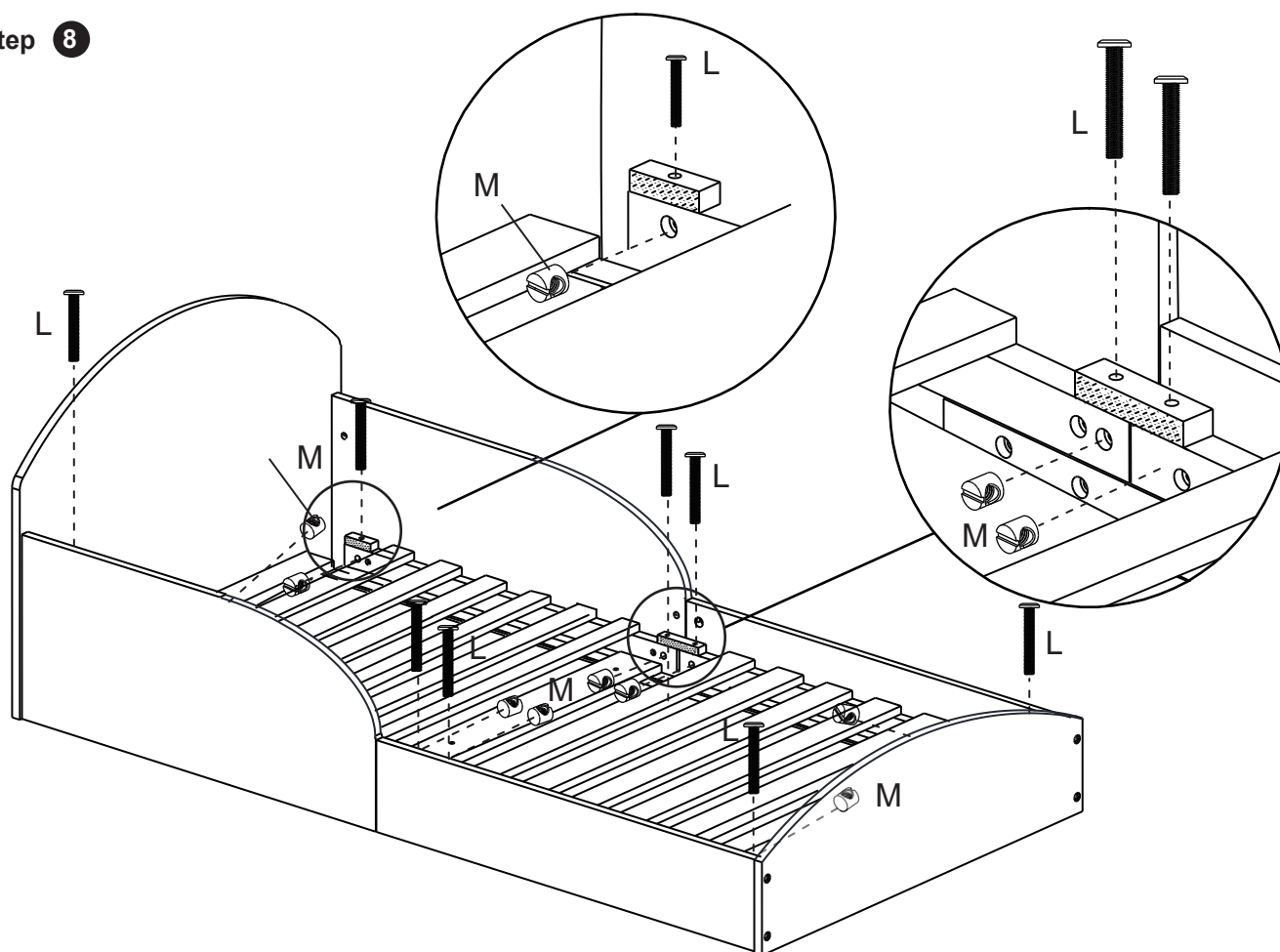

Step 9

Ensure the bracket (Q) is attached with the nut fitting facing up towards the slats.

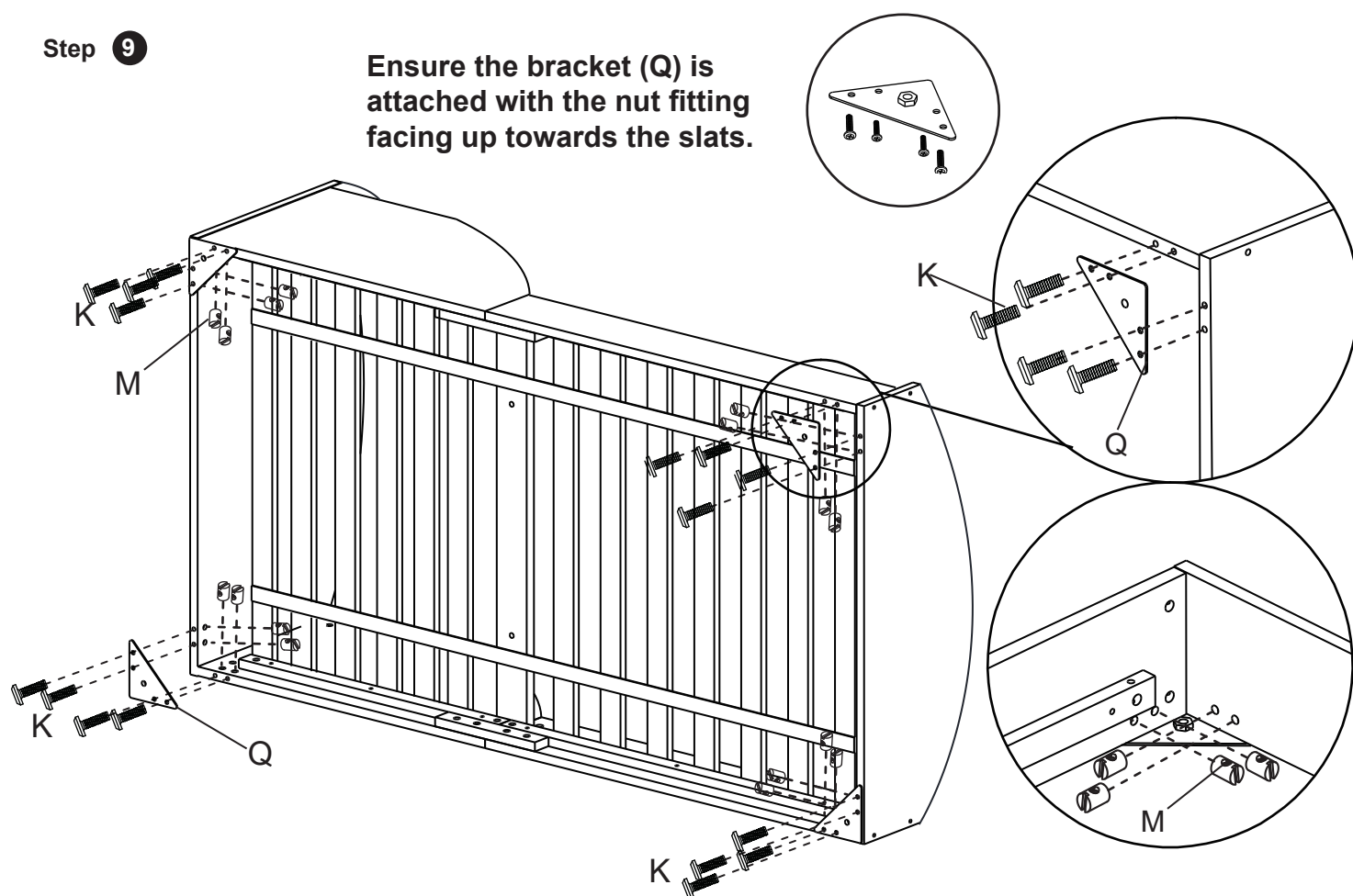

Step 10

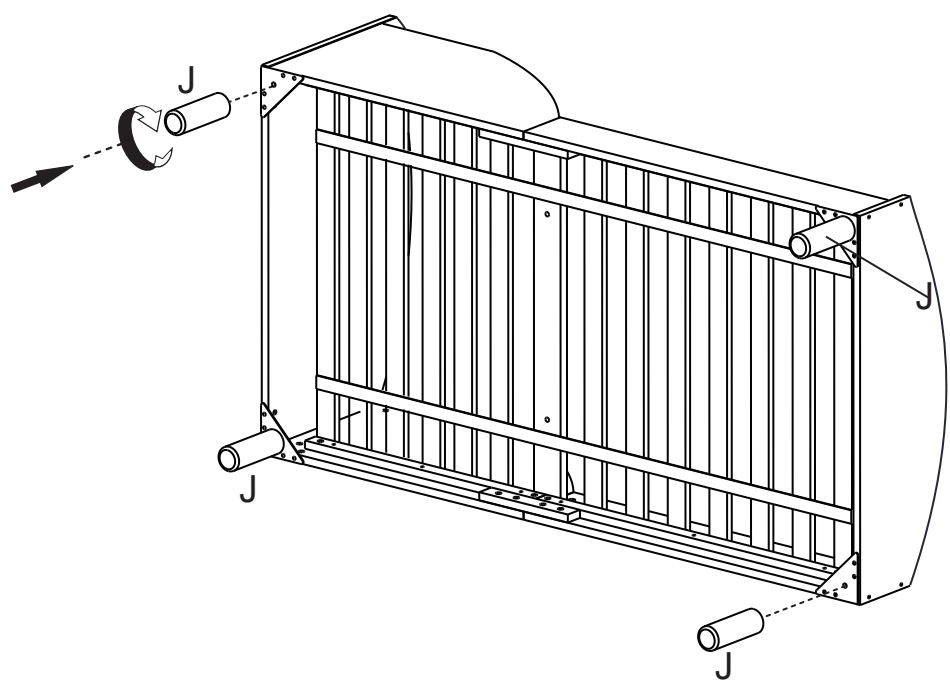

Step 11

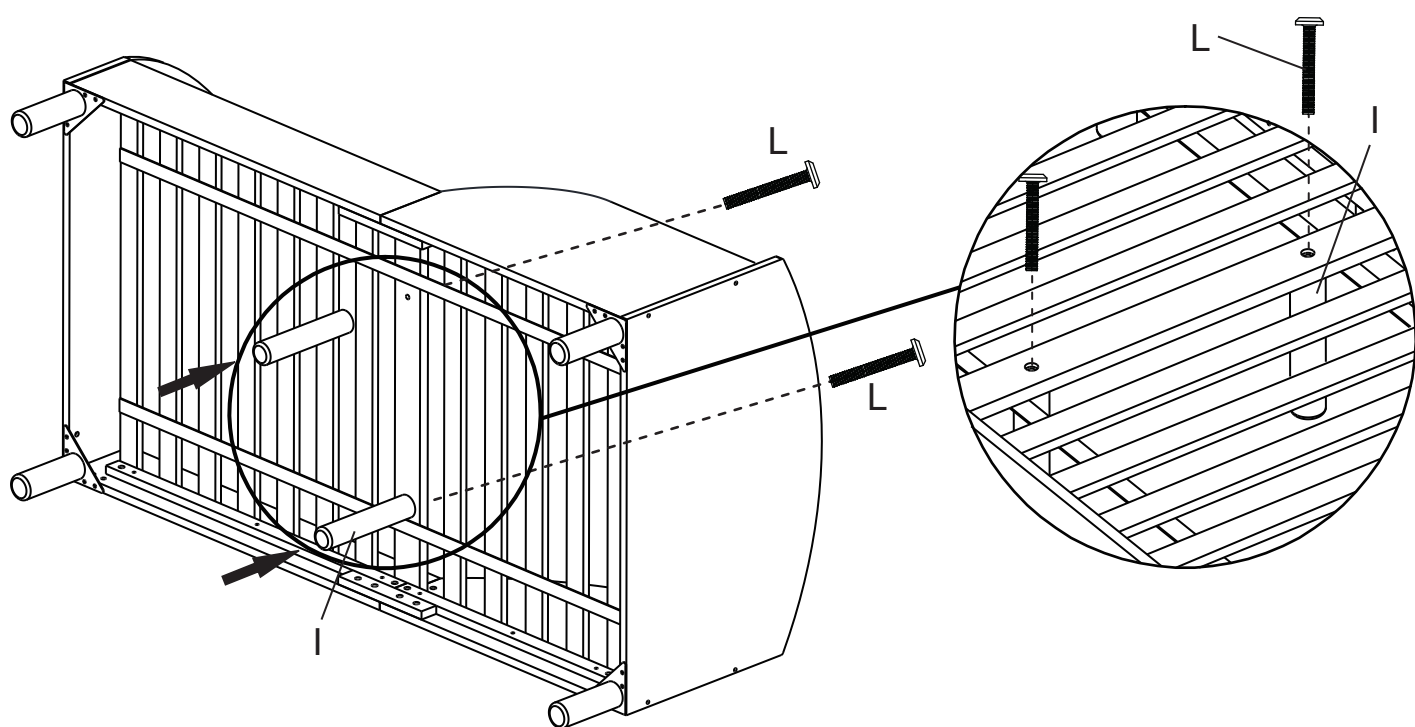

CARE/CLEANING INSTRUCTIONS

- Wipe furniture with a soft dry cloth, do not use paper as this may be abrasive to the finish.
- The unit should be cleaned with a damp cloth and dried with a dry cloth.
- DO NOT use bleach or chemical solutions to clean the product.
- DO NOT expose to sunlight or other heat sources for a prolonged period.
- DO NOT store or leave outside.
- Periodically check the tightening of legs and screws.

SAFETY TESTED

The child's bed conforms to BS 8509:2008 + A1:2011 – covering strength, durability and general safety of beds for domestic use.

WARNINGS

1. **WARNING: DO NOT** place this child's bed near to heat sources, windows and other furniture. Please be aware of the risk of Fire and strong heat sources such as electric and gas fires.
2. **WARNING: DO NOT** use this child's bed if any part is broken, torn or missing. Please contact your supplier and spare parts can be supplied – please use only parts approved by the manufacturer.
3. **WARNING:** Children are likely to play, bounce, jump and climb on beds. The bed should not be placed too close to other furniture or windows, blind cords, curtain pulls or other strings or cords.
4. Bed should be placed either tight to any wall or have a gap of 300mm between the wall and the side of the bed.
5. **DO NOT** leave the bed close to another product or surface that could provide a foothold or present danger of choking.
6. Please keep children away from the work area during assembly of this bed – due to small parts.
7. Once assembled, toddler bed is **NOT** designed to be dismantled, transported and reassembled.
8. This bed is designed for use with only one mattress.
9. Dispose of all packaging carefully and responsibly.
10. This product is suitable for children in the age range of 18 months to 5 years old.
11. The maximum loading weight of the product is 35 KG.