



EN User manual



Smart Dehumidifier

01.368112.02.001

A



B

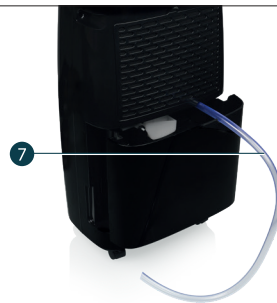
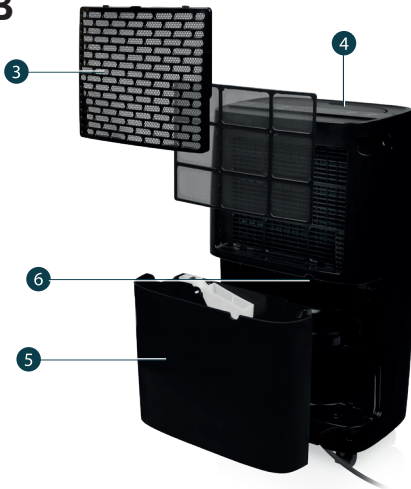

Smart Dehumidifier

FOREWORD

About this document

This user manual contains all the information for correct, safe, and efficient use of the appliance. Ensure you have fully read and understood the instructions in this user manual before you use the appliance. Always store this user manual in a safe place near the appliance for future reference.

Original instructions

This manual is originally written in English. All other languages are translated documents.

Support

For spare parts and more information about the appliance, please visit www.princesshome.eu/en-gb

General symbols

Symbol	Description
	Ensure you have fully read and understood the instructions in this user manual before you use the appliance.
	This product complies with conformity requirements of the applicable European regulations or directives.
	The Green Dot is the registered trademark of Der Grüne Punkt – Duales System Deutschland GmbH and is protected as a trademark worldwide. The logo may only be used by customers of DSD GmbH holding a valid trademark usage contract or by engaged waste management companies within the Federal Republic of Germany. This also applies to reproduction of the logo by third parties in a dictionary, an encyclopaedia or an electronic database containing a reference manual.
	The universal recycling symbol, logo, or icon is an internationally recognized symbol used to designate recyclable materials. The recycling symbol is in the public domain and is not a trademark.
	Applicable in France: The product or packaging can be recycled and components must be disposed of separately. Follow the local regulations.
	Applicable in Italy: The product or packaging can be recycled and components must be disposed of separately. Follow the local regulations.
	Waste electrical products should not be disposed of with household waste. Please recycle where facilities exist. Check with your local authority or local store for recycling advice.

APPLIANCE DESCRIPTION

About this appliance

The Princess 01.368112.02.001 is a smart dehumidifier which you can control with your smartphone, your preferred voice assistant, or manually. The dehumidifier removes unwanted moisture from the air to create a more comfortable environment in your home or office. It can be conveniently moved from room to room within your home.

Main parts (see image A)





- ❶ Control panel
- ❷ Air outlet cover

Control panel (see image B)

- ❸ Filter covering
- ❹ Air filter
- ❺ Drainage tank
- ❻ Water outlet
- ❼ Drainage hose

SAFETY

Safety symbols

Symbol	Description
	Warning: Do not cover
	Risk of fire / Flammable materials
	This product complies with conformity requirements of the applicable European regulations or directives.
	Waste electrical products should not be disposed of with household waste. Please recycle where facilities exist. Check with your local authority or local store for recycling advice.
	This product complies with conformity requirements of the applicable UK Regulations.

Safety

- Please read this user's manual carefully to ensure proper use, maintenance and installation.
- By ignoring the safety instructions the manufacturer cannot be held responsible for the damage.
- The appliance is for indoor use only.
- Do not use the unit on a socket under repairs or not installed properly.
- Do not use the unit:
 - near a source of fire.
 - in an area where oil is likely to splash.
 - in an area exposed to direct sunlight.
 - in an area where water is likely to splash.
 - near a bath, a shower or a swimming pool.
- Never insert your fingers or any other object into the air outlet. Take special care to warn children of these dangers.
- Keep the unit upward while transport and storage.

- Before cleaning or moving the unit, always turn off or disconnect the power supply.
- If the supply cord is damaged, it must be replaced by the manufacturer, its service agent or similarly qualified persons in order to avoid a hazard.
- Never move the appliance by pulling the cord and make sure the cord cannot become entangled.
- The appliance must be placed on a stable, level surface.
- This appliance is only to be used for household purposes and only for the purpose it is made for.
- The appliance shall be installed in accordance with national wiring regulations.

NOTES:

- Contact the dealer or a designated repair shop if any parts are damaged;
- In case of any damage, please turn off the unit, disconnect the power supply and contact the dealer or a designated repair shop.
- In any case, the power cord shall be firmly grounded.
- This appliance shall not be used by children aged less than 8 years. This appliance can be used by children aged from 8 years and above and persons with reduced physical, sensory or mental capabilities or lack of experience and knowledge if they have been given supervision or instruction concerning use of the appliance in a safe way and understand the hazards involved. Children shall not play with the appliance. Keep the appliance and its cord out of reach of children aged less than 8 years. Cleaning and user maintenance shall not be made by children unless older than 8 and supervised.

▲ WARNING

- To protect yourself against an electric shock, do not immerse the cord, plug or appliance in the water or any other liquid.
- The appliance shall be stored in a room without continuously operating ignition sources (for example: open flames, an operating gas appliance or an operating electric heater).
- Do not pierce or burn.
- Be aware that refrigerants may not contain an odor.
- Contact authorized service technician for repair or maintenance of this unit.
- Do not pull, deform or modify the power supply cord, or

immerse it in water. Pulling or misuse of the power supply cord can result in damage to the unit and cause electrical shock.

- Compliance with national gas regulations shall be observed.
- Keep ventilation openings clear of obstructions.
- Any person who is involved with working on or opening a refrigerant circuit should hold a current valid certificate from an industry accredited assessment authority which authorizes their competence to handle refrigerants safely in accordance with an industry recognized assessment specification.
- Servicing should only be performed as recommended by the equipment manufacturer. Maintenance and repair requiring the assistance of other skilled personnel should be carried out under the supervision of a person(s) competent in the use of flammable refrigerants.
- Do not stop the unit by pulling out the power plug whilst in operation as this may cause an electric shock or fire due to heat generation unless strange sounds are heard or if strange smells or smoke appear from the unit.
- Unplug the unit if strange sounds, smell, or smoke comes from it.

⚠ CAUTION

- Please make sure the product ventilates all the time, make sure the inlet and outlet ventilation are not blocked in any way.
- Operate this unit on a horizontal surface to avoid water leakage.
- Do not operate this unit in an explosive or corrosive atmosphere.
- Operate this unit in an ambient of 35 degree centigrade or less.
- When the unit is shut off, please wait at least 3,5 minutes before restarting. This to prevent the compressor from being damaged.
- To avoid the household electricity block out, please do not use any extension cord for this unit.

Refrigerant

Specific information regarding appliances with R 290 refrigerant gas.

- Thoroughly read all of the warnings.

- When defrosting and cleaning the appliance, do not use any tools other than those recommended by the manufacturing company.
- The appliance must be placed in an area without any continuously sources of ignition (for example: open flames, gas or electrical appliances in operation).
- Do not puncture and do not burn.
- This appliance contains Y g (see rating label back of unit) of R290 refrigerant gas.
- R290 is a refrigerant gas that complies with the European directives on the environment. Do not puncture any part of the refrigerant circuit.
- If the appliance is installed, operated or stored in a non-ventilated area, the room must be designed to prevent to the accumulation of refrigerant leaks that could result in a fire risk or explosion due to ignition of the refrigerant caused by electric heaters, stoves, or other sources of ignition.
- The appliance must be stored in such a way as to prevent mechanical failure.
- Individuals who operate or work on the refrigerant circuit must have the appropriate certification issued by an accredited organization that ensures competence in handling refrigerants according to a specific evaluation recognized by associations in the industry.
- Repairs must be performed based on the recommendation from the manufacturing company. Maintenance and repairs that require the assistance of other qualified personnel must be performed under the supervision of an individual specified in the use of flammable refrigerants.
- Appliance shall be installed, operated and stored in a room with a floor area larger than 5 m².

(CE) N 842/2006: This unit contains the refrigerant R290. The amount of refrigerant is less than 1kg, and is in a closed cooling circuit. The coolant does have zero ozone depletion potential, but is a so-called greenhouse gas under the Kyoto Protocol and may thus contribute to global warming, if it is released to the atmosphere. Therefore, only trained technicians with refrigerant certificate make a filling or emptying. Your appliance does not have to be refilled with refrigerant if used properly and has an undamaged coolant circuit.
GWP: R290: 3

BEFORE FIRST USE

1. Place the unit in the correct upright position before unpacking.
2. Take the appliance and accessories out the box. Remove the stickers, protective foil or plastic from the device.



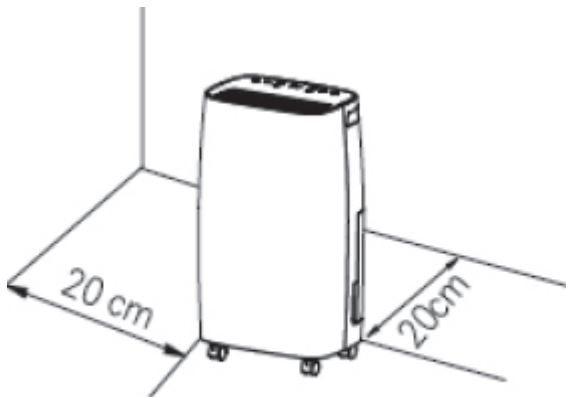

3. Before using your appliance for the first time, wipe off all removable parts with a damp cloth. Never use abrasive products.
4. Please ensure the unit is not placed against objects which will obstruct air intake e.g. furniture or curtains as this will affect its performance dramatically.
5. Please don't place or operate the unit in a narrow place.
6. Do not place the unit in full sun as it might shut down due to overheat and the color of the unit may soon fade out.
7. A distance of 20cm minimum must be kept between the unit and the wall or any other obstacles.



8. Put the power cable into the socket. (Note: Make sure the voltage which is indicated on the device matches the local voltage before connecting the device. Voltage 220V-240V 50Hz).

USING THE CONTROL PANEL

Control panel

Symbol	Description
	Power : Touch to switch the appliance on, press again to switch the appliance to standby. Power indicator : Illuminates white when the appliance is plugged in.
	Fan speed : Touch to switch between HIGH and LOW fan speeds. Fan speed indicators : Indicates the selected fan speed.
	Humidity : Touch to change the humidity level. Press this button to increase the humidity level between 40% and 80% with 5% intervals.
	When the appliance is turned on, it displays the current humidity level in the room. When the humidity level is adjusted, the selected humidity will blink shortly on the display then current humidity level be shown. When the humidity level in the room is lower than 35%, it will show "35". When the humidity level in the room is higher than 95%, it will show "95".
	When setting the timer, the timer will blink shortly in the display then be shown for a few seconds before the display reverts to showing the current humidity level. Timer : to set a scheduled time for the appliance to switch on or to standby. Timer indicator : Illuminates when the timer is activated.



Full tank indicator : When the drainage tank is full, the full tank indicator lights up, the appliance stops operating, and a beep sounds 15 times to alert the user. Empty the drainage tank by following the steps in this manual under 'Emptying the water tank'.

Power indicator: Illuminates white when the appliance is plugged in.

The timer can be set between 01-24 hours.

- To set the time for the appliance to switch on, while the appliance is on standby, touch the timer icon, the timer indicator will illuminate. Then press the timer icon again to set the time. The time in the display will blink for 5 seconds then stop. The time indicator will remain illuminated until the appliance turns on.
- To set the time for the appliance to switch off, while the appliance is in operation, touch the timer icon, the timer indicator will illuminate. Then press the timer icon again to set the time. The time in the display will blink for 5 seconds before it reverts to showing the current room humidity. The time indicator will remain illuminated until the appliance turns off.
- To cancel the timer programming press the timer icon twice, the timer indicator will go out and the timer will no longer be active.

Note: The programmed time remains unchanged if the machine stops operating due to a full tank or during defrosting.

USE

- Plug the appliance in an earthed socket. The appliance will beep once, the power indicator will illuminate.
- Touch the power icon to turn the appliance on, the fans will start operating and the current humidity level will be shown on the display.
- If desired you can follow the steps under – “Using the Control Panel” to set the timer, adjust the fan speed or the humidity level.
- Touch the power icon again to switch the appliance on standby.
- Unplug the appliance when not in use.

Low - Temperature Operation with Automatic Defrost

When the appliance is operating in a room with temp. between 5°C and 12°C it will automatically stop every 30 minutes to defrost. When the appliance is operating in a room with temp. between 12°C and 20°C, it will be stop every 45 minute to defrost.

Using the device with the Princess Home App

The item can be used manually with its built-in controls or you can use a smart phone or smart speaker to control it. Before you begin, ensure the Princess Home app is downloaded. The Princess Home app is available on Android and iOS.

Download the correct version of the Princess Home App via our website princesshome.eu/nl-nl/princess-home-app or use the QR code.



iOS™



Android™

Pair your device with the Princess Home app.

- Make sure the item is powered.
- Press the fan speed button for 5 seconds, the Wi-Fi indicator light is flashing rapidly.

- Open the Princess Home app.
- Select your country code, enter the cell phone number and tap "Get" to get a message containing the verification code.
- Enter the verification code in the message and tap "Log in" to log in to the App.
- Click "Add Device" to add a new device.
- Select the device you wanted to connect.
- Follow the instructions on the app to connect the device.

How to set local time

When the item is connected to the Princess Home App, it will automatically update the local time according to the time on the phone.

Wi-Fi information

- Wireless technology: Wi-Fi
- Operating frequency: 2400MHz~2483.5MHz
- Max. radio-frequency power: 20 dBm

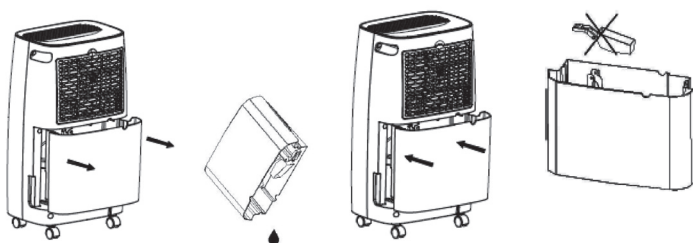

Emptying the drainage tank B

When the drainage tank **B** is full, the Water Full indicator **B** will illuminate, the operation will stop automatically and the buzzer will beep 15 times to alert the user, that the water needs to be emptied from the drainage tank.

- Lightly press on the sides of the tank **B** with both hands and gently pullout the tank.
- Remove the drainage tank **B** and empty the water.

If the drainage tank **B** is dirty, wash it with cold or lukewarm water. Do not use detergent, scouring pads, chemically treated dust cloths, gasoline,benzene, thinner, or other solvents, as these can scratch and damage the tank and cause waterleakage.

- Place the drainage tank **B** back into the appliance. When replacing the drainage tank, press the tank firmly into place with both hands. If the tank is not positioned properly, the "WATER FULL" sensor **B** will be activated, and the appliance will not operate.

CLEANING AND MAINTENANCE

1. Before cleaning, be sure to disconnect the unit from any electric supply outlet.
2. First clean the surface with a neutral detergent and wet cloth, and then wipe it with a dry cloth.
3. Do not use gasoline or other chemicals to clean the unit.

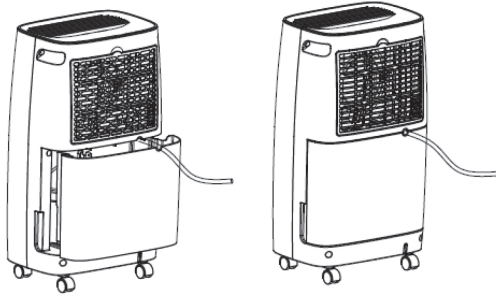

Continuous water drainage

The appliance features a continuous drainage port.

- Open the tank and attach one end of supplied hose to the water outlet inside the drainage tank and allow the collected water to drain continuously.

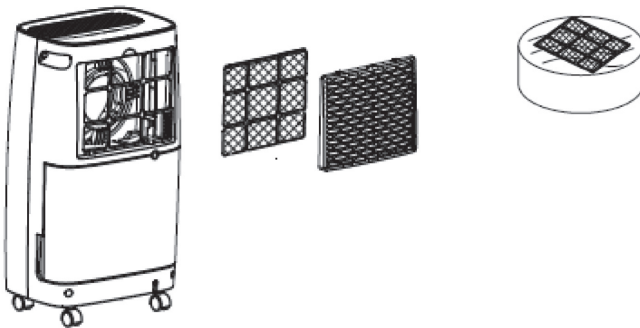

Cleaning the filter

- Unplug the appliance before cleaning.
- Open the filter covering **B3** and remove the filter **B4**.
- Gently vacuum clean the filter **B4** to remove any dirt. If the filter is exceptionally dirty, wash it with warm water and a mild cleanser and dry thoroughly.
- Fit the filter **B4** back onto the filter cover **B3** and attach it back onto the appliance.

STORAGE

- Please empty the water tank .
- Roll up the power cord.
- Clean the filter according to the cleaning instructions.
- Store the appliance in a cool and dry place.

TROUBLESHOOTING

Problem	Possible cause	Possible solution
The appliance does not work / is not working properly.	Is the power line properly connected?	Connect the plug into the socket.
	The Water Full indicator light B is on (water tank A full or not in the right place).	Drain the water in the tank.
	The room temperature is above 35 degrees or under 7 degrees.	The protection device is active and the appliance cannot be started.
The dehumidification function cannot start.	Is the filter B4 blocked?	Clean the filter according to the cleaning instructions.
	Is the air inlet or outlet blocked?	Remove the obstruction from the air inlet or outlet.
The appliance makes noise.	Is the machine tilted?	Move the machine to a flat, horizontal surface.
	Is the filter blocked?	Clean the filter according to the cleaning instructions.
No air is discharged.	Is the filter blocked?	Clean the filter according to the cleaning instructions.

EU DECLARATION OF CONFORMITY

Hereby, Smartwares Europe declares that the radio equipment type 368112 is in compliance with Directive 2014/53/EU

The full text of the EU declaration of conformity is available at the following internet address: www.princesshome.eu/doc

THE PRODUCT OR EQUIPMENT CONTAINS FLUORINATED GREENHOUSE GAS.

Art. nr.	01.368112.02.001
Coolant	R290
Quantity in kg	0,05
Global Warming Potential	3
CO2 Equivalent in tonnes	0.000135

DISPOSAL



This appliance should not be put into the domestic garbage at the end of its durability, but must be offered at a central point for the recycling of electric and electronic domestic appliances. This symbol on the appliance, instruction manual and packaging puts your attention to this important issue. The materials used in this appliance can be recycled. By recycling of used domestic appliances you contribute an important push to the protection of our environment. Ask your local authorities for information regarding the point of recollection.

SUPPORT

You can find all available information and spare parts at www.princesshome.co.uk!



IN NEED OF ACCESSORIES? VISIT WWW.PRINCESSHOME.EU/NL-NL/CUSTOMERSERVICE/ACCESSORIES-SPAREPARTS

FOR ACCESSORIES AND SPARE PARTS TO EXTEND YOUR ITEM!

© Smartwares S&L Ltd. West Point, Second Floor | Mucklow Office Park Mucklow Hill Halesowen | West Midlands | B62 8DY | United Kingdom | www.princesshome.co.uk