



RapidHot™ by Nuby

User Manual
30187 / 30206

Fast formula making





INTRODUCTION:

The Nuby RapidHot provides fast and precise formula feeding, by rapidly boiling water to the exact feed size you require. Once tap water has been added, carbon filters within the filtration system work to remove impurities in the water, allowing for a fast safe feed every time.

CONTENTS:

- 1 x RapidHot Machine
- 3 x Filters

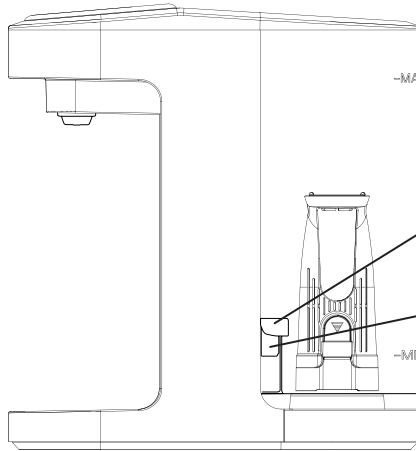
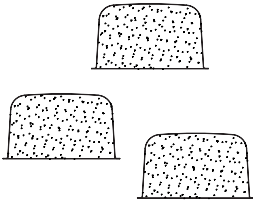

YOUR RAPIDHOT:

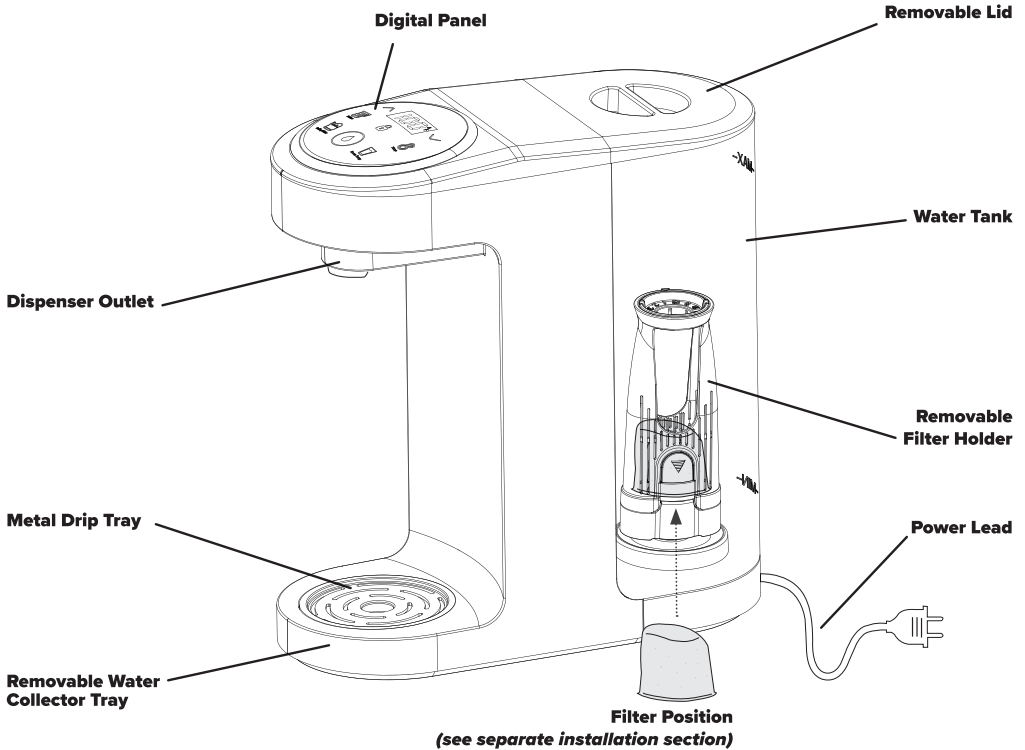



FEATURES:

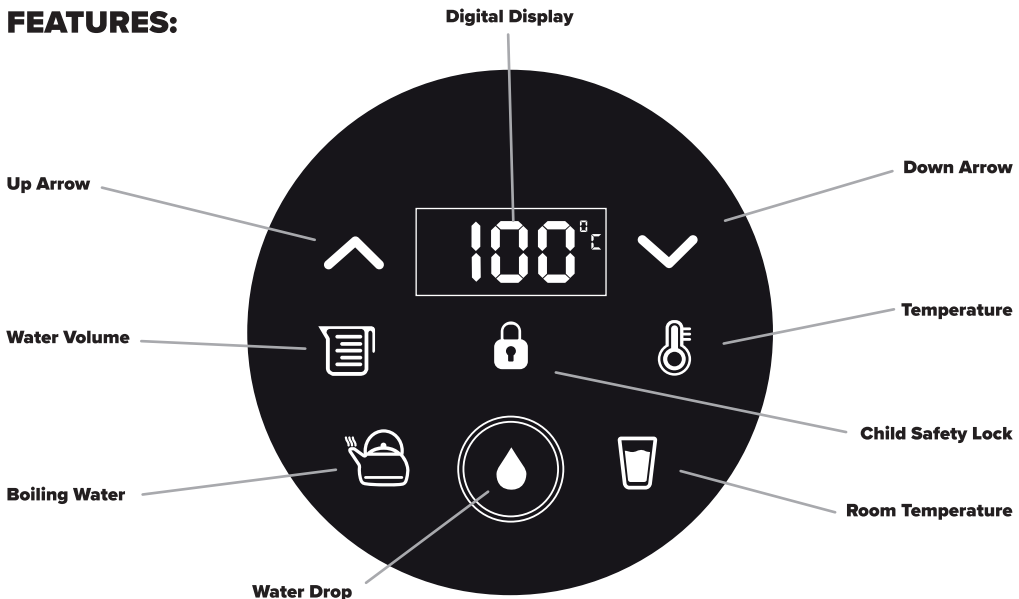

Description of Digital Control Panel

Auto Memory Feature – Once water temperature and volume has been selected the machine will automatically remember this last setting for each use until manually changed (unless unplugged from the mains).

Up / Down Arrow Icons – these icons are used to select different options on the control panel.

Child Lock Icon – the Child Lock icon automatically comes on after 30 seconds of no use. You can press the icon to unlock this. To remove the Child Lock function, press icons at the same time for 2 seconds, there will be a beep when unlocked. To restore the Child Lock function repeat these steps.

Water Drop Icon – press the Water Drop icon to dispense water and again to stop water midflow. This will not work with the Child Lock icon activated.

Volume Icon – there needs to be sufficient water in the tank to be able to dispense selected volume of water or the water will not dispense. **NOTE: When filling the RapidCool flask the maximum volume allowed is 240ml.** Press The Volume icon . Then use the Up and Down Arrows to select the required volume. Volume sizes for **millilitres** are as follows:

60ml | 90ml | 120ml | 150ml | 180ml | 210ml | 240ml | 270ml | 300ml

Volume sizes for **US fluid ounces** are as follows:

2floz | 3floz | 4floz | 5floz | 6floz | 7floz | 8floz | 9floz | 10floz | 11floz

To switch between MLs and US fluid ounces press the Up Arrow and Volume icons at the same time.

Room Temp Icon - press the Room Temp icon to select room temperature water. The volume size must be selected before dispensing. Press the Water Drop icon to dispense water.

Boiling Water Icon – this is automatically set at 100°C / 212F. You must press the Child Lock icon to allow the machine to dispense water at this temperature. This is a safety feature. Press the Boiling Water icon , the Child Lock icon will turn red, you can select the Volume whilst this is on, when you are ready to dispense water you must press the Child Lock icon again to turn this off. Press the Water Drop icon to dispense water.

Temperature Unit Switch - to switch from Celsius to Fahrenheit, press the Down Arrow and Temp icons at the same time. To switch back from Fahrenheit to Celsius repeat the process.



PRODUCT WARNINGS:

The following safety guidelines are intended to prevent unforeseen risks or damage from unsafe or incorrect operation of the appliance. Please check the packaging and appliance on arrival to ensure everything is intact for safe operation. If you find any damage, please contact our customer services team. Please note: modifications or alterations to the appliance are not allowed for your safety. Unintended use may cause hazards and loss of warranty claims.

- For domestic use only.
- Suitable for indoor use only.
- When positioning the appliance, ensure the supply cord is not trapped or damaged.
- Do not move product with water in the tank.
- Do not submerge in water or other liquids.
- For adult use only, do not allow children to use this product.
- Not suitable for a dishwasher, please see washing instructions in the CLEANING & MAINTENANCE section.
- Main unit, wipe clean only.
- Water tank, drip tray and lid, handwash only.
- Only use filter approved by manufacturer.
- Replace filter every month or when indicated on digital panel of the appliance.

INSTALLATION:

WARNING! – DO NOT lift appliance by the water tank!

1. Remove the filters, Metal Drip Tray and plastic Water Collector from inside the water tank.
2. Place the plastic Water Collector in position first then the Metal Drip Tray on top.
3. Before first use of a filter, fully submerge the filter into a bowl of cold tap water for one minute.
4. Once soaked, discard the water and insert one filter into the Filter Holder. To do this squeeze together the arrows **(a)** and pull apart **(b)**. Insert filter with flat edge facing downwards **(c)**, then assemble filter holder back together.
5. Fit the Filter Holder into the water tank with the wider part downwards.
6. Fill water tank ensuring not to go over the "max" line and attach to unit. Ensure this is attached securely before using.

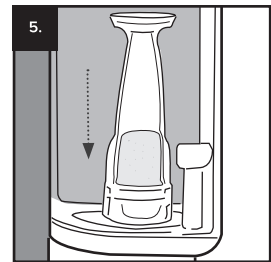
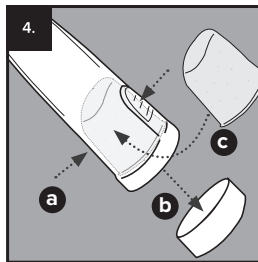
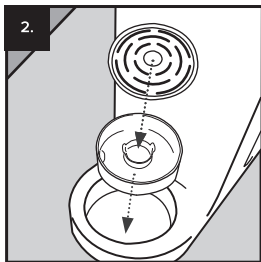

First Use Of A New Filter

- Submerge the filter into a bowl of cold tap water for one minute.
- Then follow steps 4 and 5 as stated above.

PLEASE NOTE: 1 X FILTER LASTS FOR UP TO 4 WEEKS







USER INSTRUCTIONS:

Before first use (or if the machine has not been used for more than 6 hours), always run 150ml of boiling water into a cup or jug and discard the water before making a feed. This is for general maintenance and can be done by following steps 2 to 7 as below.

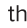
Making A Feed With A RapidCool Flask



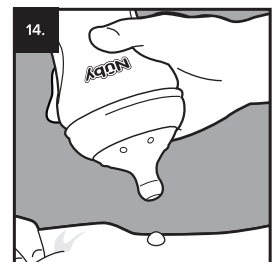
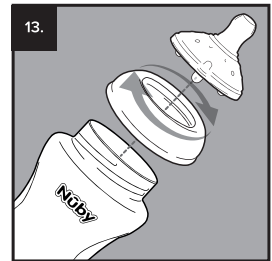
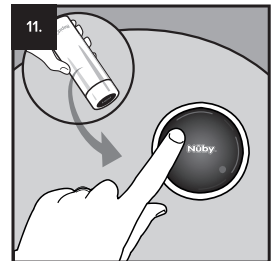
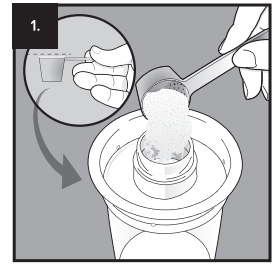

Your formula needs to be prepared before using this machine.

- Loosely fill the scoop with formula powder, according to the manufacturer's instructions, then level it using either the flat edge of a clean dry knife or the leveller provided. Empty levelled scoop into the milk powder dispenser provided with RapidCool™ flask. NOTE: Different tins come with different scoops. Only use the scoop that comes with the formula.
- Before making a feed, you will need to turn off the safety lock by holding down the **Child Lock** icon .
- Place your RapidCool™ flask on the stand under the Water Dispenser.
- Select **Volume** icon , then use the **Up and Down Arrow** icons  to select feed size.
- Select the **Boiling Water** icon .
- Unlock the Child Safety Lock again.
- Press the **Water Drop** icon  to dispense water.
- Once your RapidCool™ flask is filled immediately add your baby formula from the milk powder dispenser provided.
- Screw the digital lid onto the RapidCool™, ensuring it is fully tightened.
- Shake the RapidCool™ well to ensure the formula powder is fully dissolved.
- Before dispensing into a bottle, invert the RapidCool™ and hold it in that position for a minimum of 5 seconds to allow the integrated thermometer to adjust to the milk temperature. **To ensure an accurate temperature reading, it's essential that the water is in contact with the sensor of the digital lid.** Touch the circle on the digital screen to activate the Nuby logo.
- When the Nuby logo shows green, the feed is at the correct temperature to dispense. Empty the contents of the RapidCool™ into a clean, sterile bottle.
- Fit teat into retaining ring, taking care to avoid unnecessary contact with teat nipple, and screw retaining ring onto the bottle base.
- Test the temperature of the formula on the inside of your wrist before giving it to your baby. It should be body temperature, which means it should feel warm or cool, but not hot.
- If there is any made-up formula left in the bottle after a feed, throw it away. Clean all parts thoroughly & sterilise immediately after feeding.









Making A Filtered Drink (room temperature)

1. Turn off the safety lock by holding down the red **Child Lock** icon .
2. Place your glass or cup on the stand under the Water Dispenser.
3. Select **Volume** icon, then use the **Up and Down Arrow** icons  to select drink size.
4. Select **Room Temperature** icon .
5. Press the **Water Drop** icon  to dispense water.



Making A Filtered Drink (boiling water - perfect for tea / coffee)





1. Turn off the safety lock by holding down the red **Child Lock** icon .
2. Place your glass or cup on the stand under the Water Dispenser.
3. Select **Volume** icon, then use the **Up and Down Arrow** icons  to select drink size.
4. Select the **Boiling Water** icon .
5. Unlock the Child Safety Lock again.
6. Press the **Water Drop** icon  to dispense water.





CLEANING & MAINTENANCE:

Descaling

NOTE: If filter is less than 4 weeks old, you don't need a new one for the descaling process.

1. Continuous flashing of the **Child Lock** icon  means descaling and filter change are needed.
2. Remove the filter and filter holder, pour 250ml of white vinegar into the tank, then add 750ml of water.
3. Press the **Boiling Water** icon , press **Child Lock** icon , press **Water Drop** icon  to dispense water and continue to produce boiling water until water tank is depleted.
4. Fill the tank with 300ml of fresh water, press **Boiling Water** icon  to dispense into a cup or jug. Once complete, discard any remaining water before use.
5. After the descaling is completed, add the filter and put the filter holder into the tank. If the filter is brand new, please follow steps **4 & 5** in the INSTALLATION section of this leaflet.

When descaling is completed, press & hold the **Room Temp** icon and the **Boiling Water** icon at the same time  , this will restore the timing of the pump working and the **Child Lock**  icon will return to normal.

Refreshing The Water

If the water has been sitting in the tank for more than 48 hours, discard the water and refill before use.

Always Disconnect Appliance From Mains Power When Not In Use

If you are not using the appliance for a long period of time, turn off and unplug from the main power supply. Wait for at least 3 minutes when switching back on to allow reheating to take place. Drain any excess water and add fresh water before use.

Emptying The Water Drainage Tray

Remove the Metal Drip Tray and the plastic Water Collector Tray underneath, cleaning them both with soapy water, ensuring to wipe clean the area underneath both trays with a damp cloth.

Cleaning The Float

Remove the Float Lid & Float from tank and clean with warm soapy water. Please ensure the Float & Float Lid are re-inserted correctly (as per CONTENTS diagram on page 2). **NOTE: if the Float & Float Lid are not assembled correctly, the RapidHot will not operate correctly.**



TROUBLESHOOTING & ERROR CODES:

Use this chart to troubleshoot common problems that may occur when using this appliance.

PROBLEM	POSSIBLE REASON	SOLUTION
No water coming out of the machine	No water or too little water in the tank.	Ensure there is water in the tank. If still not working contact customer service.
No lights showing on panel	The plug is not in the socket/ switched on.	Check plug - if still not working, contact customer service.
Water is not hot	Check you have selected boiling water icon or a temperature above 50°C/122°F.	If the water is still not hot, contact customer service.
All panel lights flash	Unit has overheated.	Wait for the machine to cool down. Press the water icon to return to normal automatically.
Error Code 000 - lack of water	Water tank shortage.	Check the water level of the water tank and replenish water in time.
Error Codes E2, E3, E5, E7, E8, E9, E0, EE & EF		Contact customer services for any of these error codes.
Error Code E4 - low temperature alarm	When inlet water temperature or ambient temperature is close to or lower than 0°C, pipes may freeze.	Place the machine in an environment above 4°C.
Error Code E6 - power supply issue	Abnormal power supply (non-AC power supply or power waveform distortion).	Check the power supply and connect it to the correct AC power supply.

PRODUCT SPECIFICATION:

Item Number(s)	30187 / 30206
Rated Voltage	220 - 240V~
Rated Frequency	50Hz
Rated Power	2300W
Hot Water Capacity	20L/h(>= 90°C)
Capacity	3.0L
Product Size	309 x 143 x 320mm



DISPOSAL & RECYCLING:

Important instructions for the environment

This symbol indicates that this product shall not be disposed with other household wastes at the end of its service life. Used device must be returned to official collection point for recycling of electrical electronic devices. To find these collection systems please contact to your local authorities or retailer where the product was purchased. Each household performs important role in recovering and recycling of old appliance. Appropriate disposal of used appliance helps prevent potential negative consequences for the environment and human health.

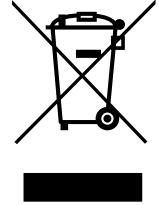

WARRANTY:

Nuby's "RapidHot" includes a one-year limited warranty against defects from the date of purchase. In the event of a malfunction or defect during the in-warranty period, Talbot's UK, at its discretion, will replace or repair the product under warranty. Upon receipt of the product and the proof of purchase with a valid date of purchase, the defective part will be immediately repaired or replaced and returned to you free of charge. Please send defective unit, proof of purchase with valid date of purchase, and a description of the problem you have encountered to:

Talbot's UK LLP, 13 Burford Way,
Boldon Business Park, Boldon Colliery,
Newcastle upon Tyne, NE35 9PZ
Freephone Number: 0800 334 5844
enquiries-uk@drtalbots.com
www.nuby.com



NOTE: No warranty extends to any problem that is caused by conditions, malfunctions, or damage not resulting from defects in material or workmanship.

© 2024 Talbot's UK LLP.

Nuby TM & Nuby logo licensed to Talbot's UK LLP by Admar International.
TMs owned by or licensed to Talbot's UK LLP.

Made in China

Design and specifications are subject to change without prior notice.

