

FIXING INSTRUCTIONS

Contents

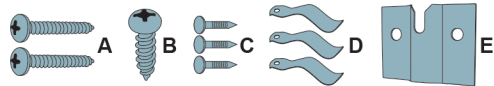

- x2 Wall screws (A)
- x3 Leaf springs (D)
- x1 Dartboard screw (B)
- x1 Large wall bracket (E)
- x3 Nails (C)

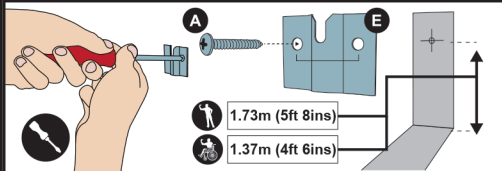

Diagram 1. Screw the large wall bracket (E) to the wall at a height of 1.73m/5ft 8ins (or 1.37m/4ft 6ins for wheelchair players); using the wall screws enclosed (A).

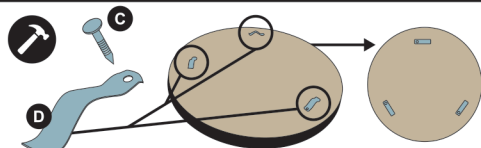

Diagram 2. Take the 3 leaf springs (D) and using the nails provided (C) fix to the back of the board as shown in diagram 2. These leaf springs (D) are designed to steady the board against the wall to prevent the board moving during play.

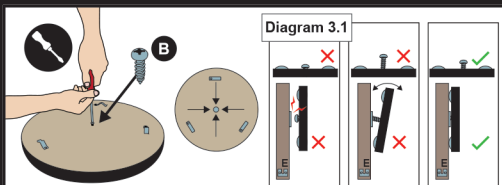

Diagram 3. Fix the dartboard screw (B) into the centre hole on the back of the dartboard; do not screw in fully as the screw is designed to slot into the bracket (E) on the wall (see diagram 3.1).

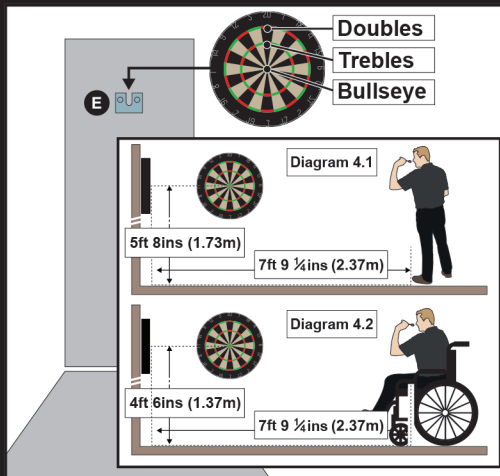

Diagram 4. Lower the dartboard onto the bracket by placing the screw into the bracket, adjust the screw as required to ensure the dartboard is tight to the wall.

Diagram 4.1 - Able Body Dartboard Setup Both feet must be behind the oche line at all times.

Diagram 4.2 - Wheelchair Dartboard Setup Both rear wheels of the wheelchair must be behind the oche line. Either or both front wheels may be in front or behind the oche line to allow an angled stance.

DARTBOARD CARE AND MAINTENANCE

For more tips and advice visit:

www.winmau.com/maintenance

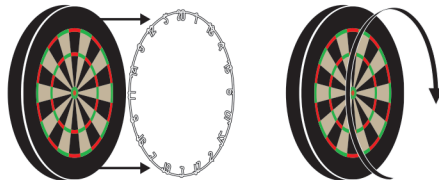

Diagram 5. The board must be turned regularly to ensure even play and to prolong the life of the dartboard. A dartboard must be kept in a cool, dry place and must not be soaked or sprayed with water.