



VOLT 200 ELECTRIC SCOOTER QUICK START GUIDE



info@hy-pro.co.uk
Hy-Pro Customer care line
Tel: 0800 731 0006
Made in China

BATTERY INFORMATION

Batteries have a capacity memory which is why the initial charge is very important for this product.

The initial charge will be memorised, therefore ZINC would like to remind you:

PLEASE CHARGE YOUR SCOOTER for a minimum of 14hrs before first use

To prolong the life of the battery in this scooter, please ensure you charge your scooter every two weeks even if it has not been used.

Before assembly:

1. Ensure you have all the required tools:

a. 1 x Spanner



1x 8mm
1x 10mm

b. 2 x hex wrench



1 x 2.5mm
1 x 5mm

Please retain for future reference



STEP 3

E
S

Power switch
OFF

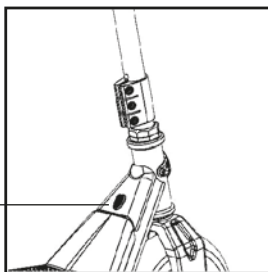

STEP 4

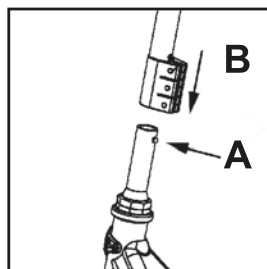

Tighten the bolts with the 5mm hex wrench, evenly and securely.

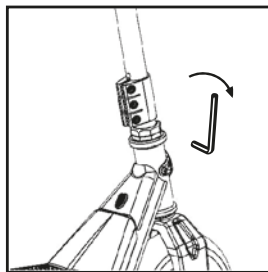

STEP 4

Handlebar/Stem Assembly

Align handlebars both vertically and horizontally (a) onto handlebar steer tube (b) install handlebar clamp and hardware (c&d) and tighten evenly and securely with 5mm hex wrench and 10mm spanner.

- insert the central screw
- install handlebar clamp
- (c&d) and **tighten evenly and securely** with the 5mm hex wrench and 10mm spanner
- ensure the accelerator grip is tightly secured

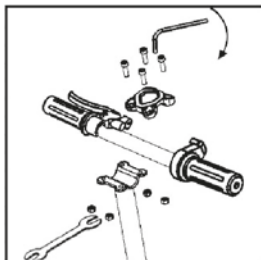

STEP5 (only if required)

Replacing/tightening the accelerator grip

- Unscrew and slide out the handle grip.
- Replace the metal ring.
- Insert the handle grip and align the holes.
- Insert and tighten the screw.

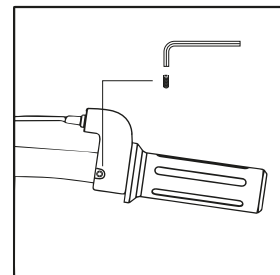

STEP 6

Charging the battery

left side

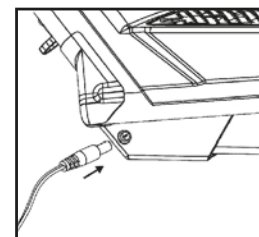

The light on the charger housing should illuminate. Red LED light indicates battery is charging and a green LED light indicates battery is fully charged.

The scooter MUST ALWAYS be switched OFF while being charged

Your electric scooter will not have a fully charged battery.

Initial battery charge time: **14** hours/ overnight

Runtime: up to 60 minutes run time

Recharge time: at least 5 hours after the initial **14** hours charge time

The reset button will automatically shut off the power if the motor is overloaded.

