

QUICK INSTALL PET BARRIER

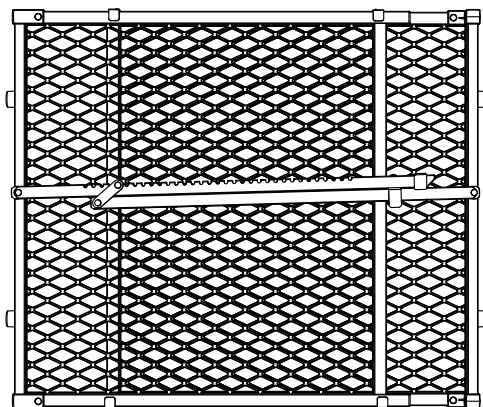

653/2651

If you need help or have damaged or missing parts, call the Argos Aftersales Helpline: 03456 400 800

IMPORTANT! READ AND FOLLOW THESE INSTRUCTIONS CAREFULLY AND KEEP FOR FUTURE REFERENCE

Introduction

Please read the instructions thoroughly to ensure proper installation.

Please immediately inspect your safety gate upon receipt. If you see any damage, or additional parts are required for this gate, do not assemble gate and please go to back page of the instruction booklet for website or Consumer Relations Representative information. We recommend that you carry out the installation away from young children as some of the smaller components may present a choking hazard when loose.

Important Information

Please check the gate on a regular basis to ensure gate and parts are all in proper working order. If the gate is used at the top of stairs, it should not be positioned below the top level. When using at top of stairs, gate must open away from stairs. If the gate is used at the bottom of the stairs, please place towards the front of the lowest stair. Ensure the gate is attached between two clean and solid surfaces. Ensure appropriate fixings are used for drywall, wood, brick, etc. If wall plugs are provided with the gate and do not secure to the wall satisfactorily, consult with a hardware store for your proper wall plug application. If additional parts are required for this gate, please go to back page of the instruction booklet for website or Consumer Relations Representative information.

Disclaimer

Any pet gate which has been subjected to misuse, abuse, abnormal use, excessive wear and tear, improper assembly, negligence, environmental exposure, alteration or accident, or has had its serial number altered or removed invalidates any and all claims against the manufacturer. Any damage to property during installation of your safety gate is the sole responsibility of the end user.

- Use only with the locking mechanism securely engaged. It is auto closing system.
- To prevent serious injury or death, securely install gate or enclosure. And use according to manufacturer's instructions.
- Periodically check all fasteners to be sure they are tight and secure.
- Adult assembly required.
- Install according to manufacturer's instructions.
- This product is intended for pet.
- This product will not necessarily prevent all accidents.
- This pet gate is for domestic use only.
- To clean: Use mild soap and wipe with a damp cloth.

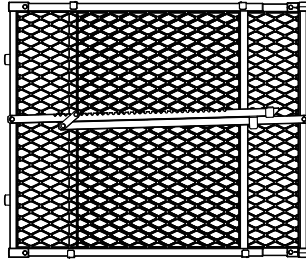

INSTALLATION:

1.Place the gate in the doorway.

NOTE:Be sure to place the gate so the locking mechanism is on the side of the gate that will be away from the pet.

2.Pull top arm up by pressing release lock using thumb and index finger and lifting into its open, unlocked position(Fig.1)

3.Slide the locking pin to the slot that will extend the gate to match your doorway opening(Fig.2)

4.Press lock button and push top arm down, onto the wooden locking bar(Fig.3)

This will secure the gate, under pressure, in the doorway. Do not overload the locking bar during set up. keep this top locking bar in line with the bottom locking bar while applying pressure.

it is normal for the vertical side boards to flex and bow slightly.

CAUTION:Avoid forcing the locking bar into position.

Minimal pressure should be used to seat top arm.

5.Check that the gate is secure in the doorway by gently pulling on the top of the gate and that there is less than 3 inches between the bottom of gate and the floor, if the gate moves,

repeat steps 2,3 and 4 until you find the right slot to secure the gate properly.

6.to open the gate, follow step 2 above

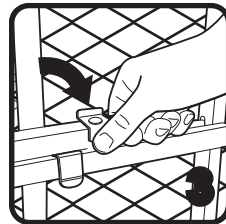
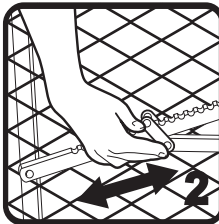

ARGOS

489-499Avebury Boulevard.

Central Milton Keynes MK9 2 NW.

Please keep all the relevant information for future reference.