

Heavy Weight Uncorded Track Fitting Instruction

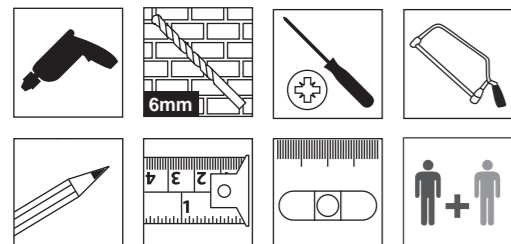

		1.5m	2.0m	2.5m
	[01]	1	1	1
	[02A]	5	6	8
	[02B]	5	6	8
	[03]	20	26	34
	[04]	5	6	8
	[05]	5	6	8
	[06]	Sold separately		

You will need



01

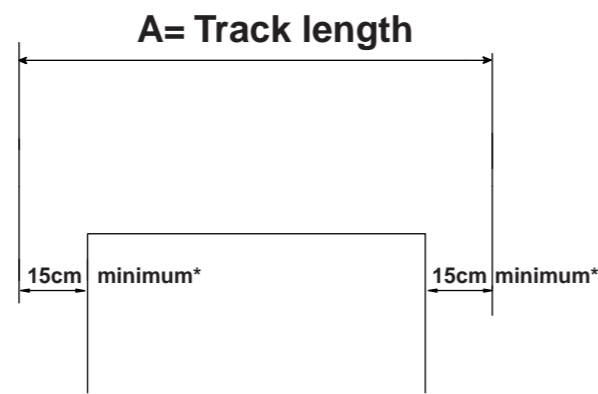

*For larger windows and thicker curtains, this dimension can be increased so the curtains don't obstruct the window when open.

02 Cut to size. Go to step 03 if no adjustment is required.

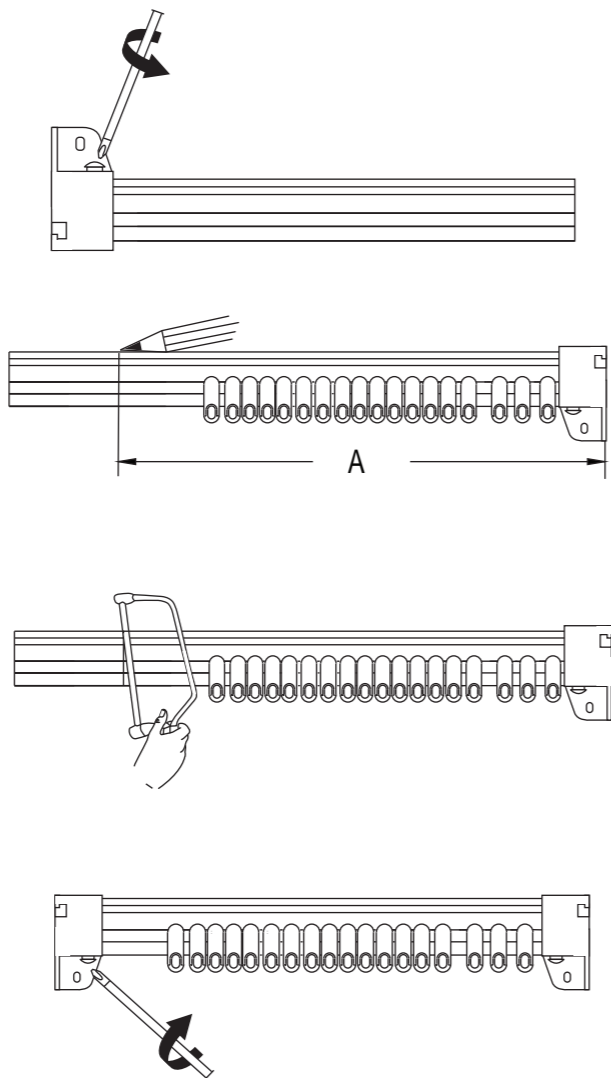

03 [02A]

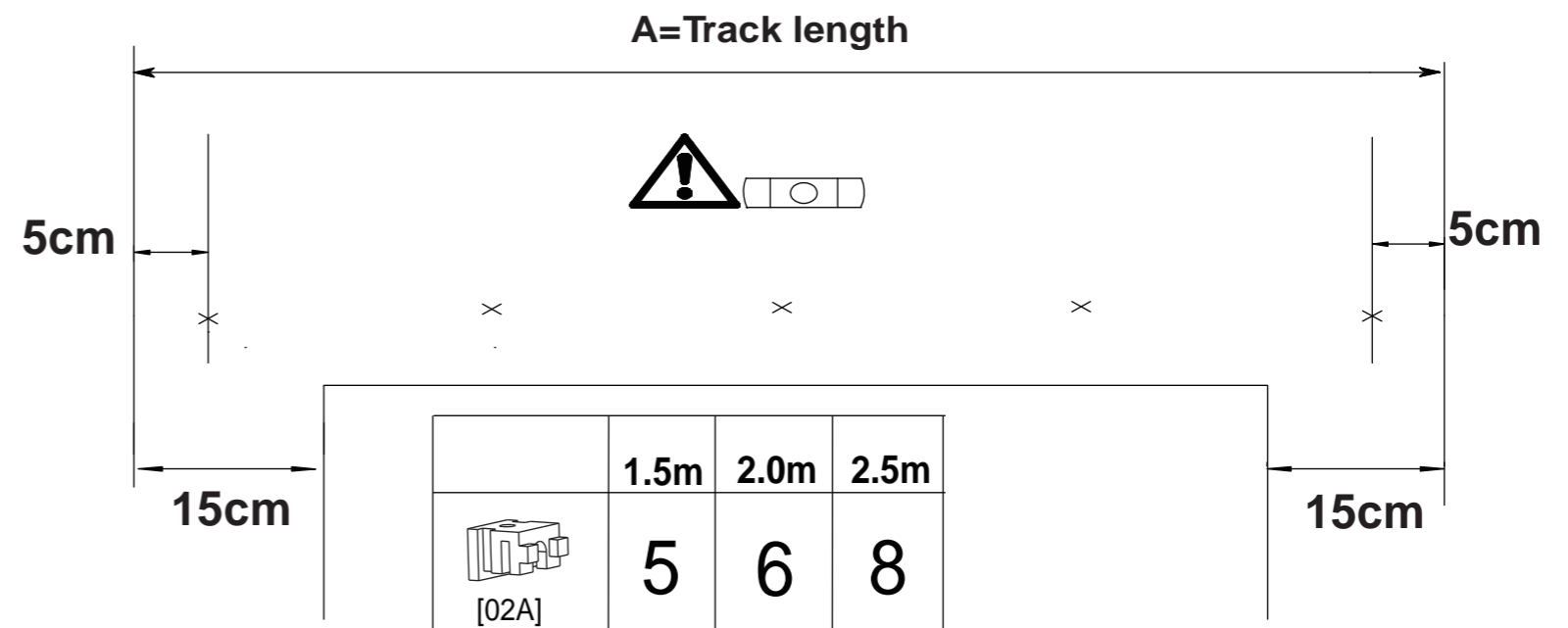

The end brackets must be positioned 5cm in from the end of the track. Then evenly space the remaining brackets between the end brackets. Mark the position on the wall or ceiling ensuring they are level.

04 [05]

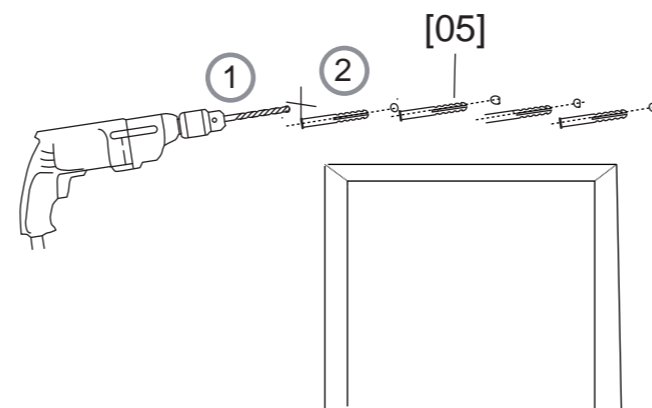

05 [02A] [04]

Wall installation

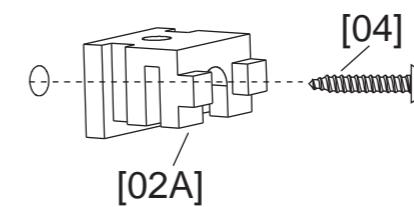

Ceiling or window recess installation

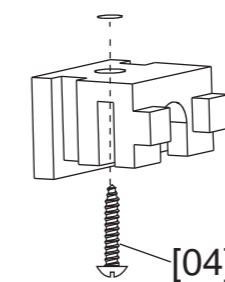

06 [02B] [02A]

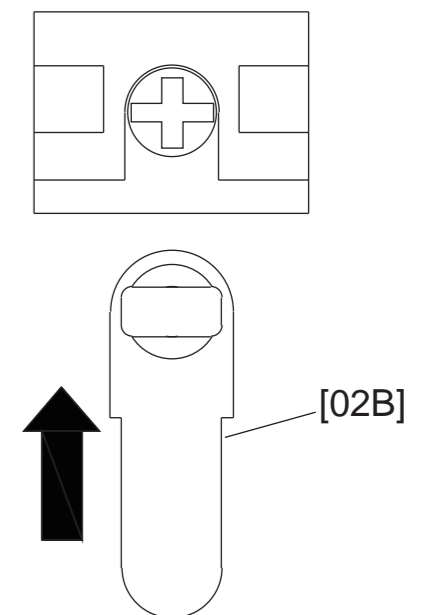

IMPORTANT: RETAIN THIS INFORMATION FOR FUTURE REFERENCE, READ CAREFULLY BEFORE ADJUSTING, INSTALLING AND USING THE PRODUCT.

