

CHAD VALLEY BABY™

Circus Friends™

599/9927

Cradling Bouncer



IMPORTANT! KEEP FOR FUTURE REFERENCE.

Argos

Avebury, 489-499 Avebury Boulevard, Milton Keynes, MK9 2NW

www.argos.co.uk

Customer Helpline: 03456 400 800

5999927



WARNING

FALL HAZARD: Babies have suffered skull fractures falling while in and from bouncers when not used properly.

- Use bouncer **ONLY** on floor
- A child's movement can slide the bouncer. • **NEVER** place the bouncer on countertops, tables, on or near steps or on other elevated surfaces. • **ALWAYS** use on the floor.
- **NEVER** lift or carry baby in bouncer

SUFFOCATION HAZARD: Babies have suffocated when bouncers tipped over on soft surfaces.

- **NEVER** use on a bed, sofa, cushion, or other soft surface.
- **NEVER** leave baby unattended.

To prevent **falls and suffocation:**

- **ALWAYS** use restraints. Adjust to fit snugly.
- **STOP using bouncer when baby starts trying to sit up (approximately 5 months of age).**
 - o **ONLY** use the product when the child weighs more than 3kg and less than 9kg.
- This bouncer is not intended for prolonged periods of sleeping.
- **NEVER** lift bouncer using a toy bar as a handle.
- **NEVER** use as an infant carrier for automobile or airline travel.
- **NEVER** attach any additional strings or straps to product or toy bar

IMPORTANT

- Adult assembly required.
- Please read all instructions before assembly and use of the product.
- Care should be taken in unpacking and assembly.
- Examine product frequently for damaged, missing, or loose parts.
- **DO NOT** use if any parts are missing, damaged, or broken.
- Contact Kids II for replacement parts and instructions if needed. Never substitute parts.
- This product has not been designed for sleeping. Should your child need to sleep, they should be placed in a suitable cot or bed.

Parts List and Drawing

No.	Qty.	Description
1	(1)	Base frame tube
2	(1)	Left base frame member
3	(1)	Right base frame member
4	(1)	Left backrest tube
5	(1)	Right backrest tube
6	(1)	Footrest wire
7	(1)	Seat pad

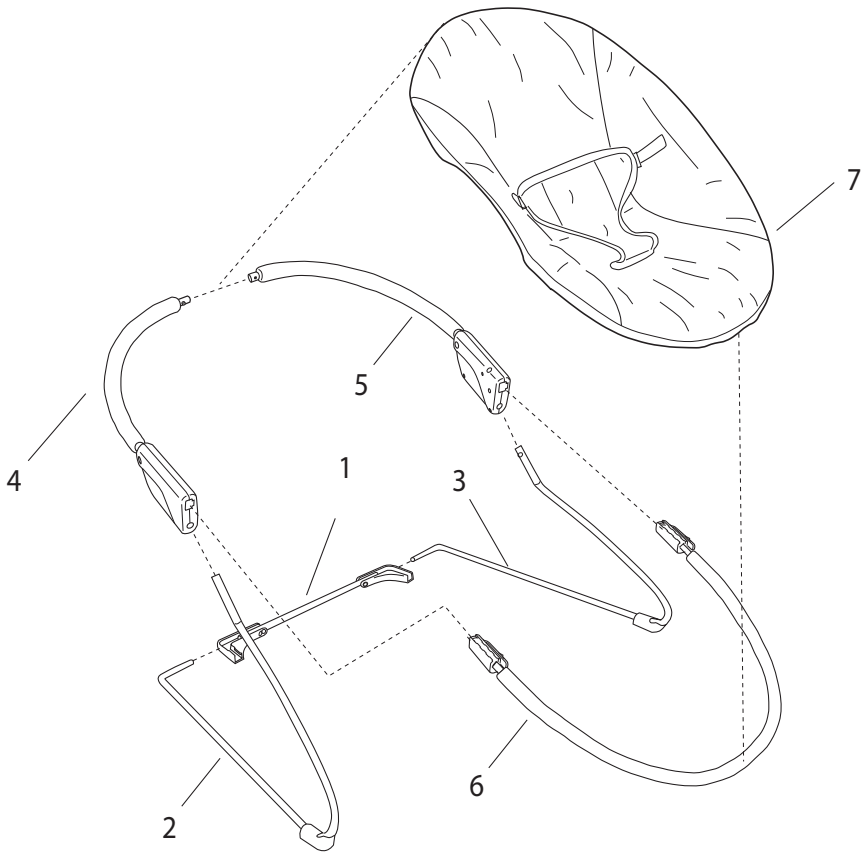

1

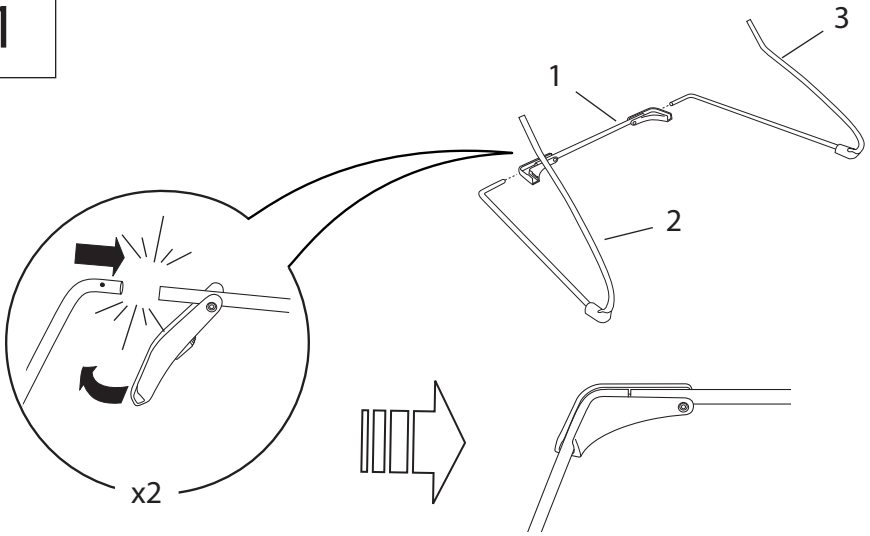

2

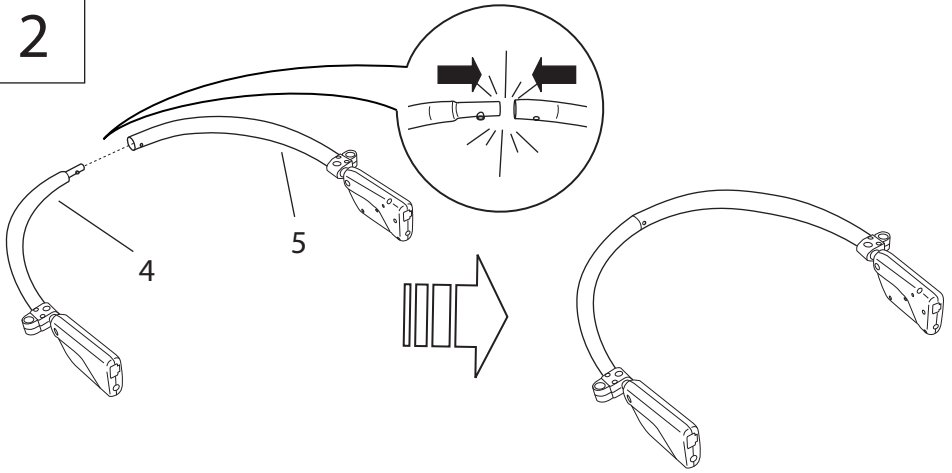

3

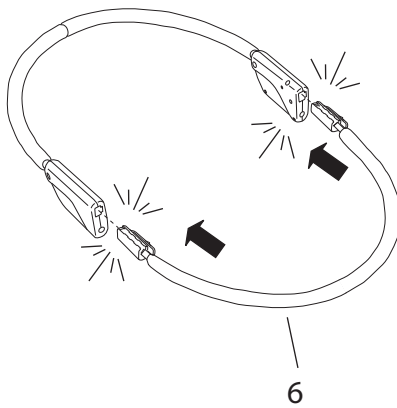

4

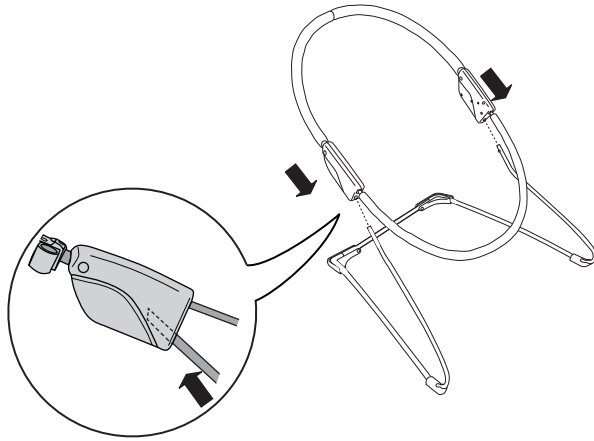

5

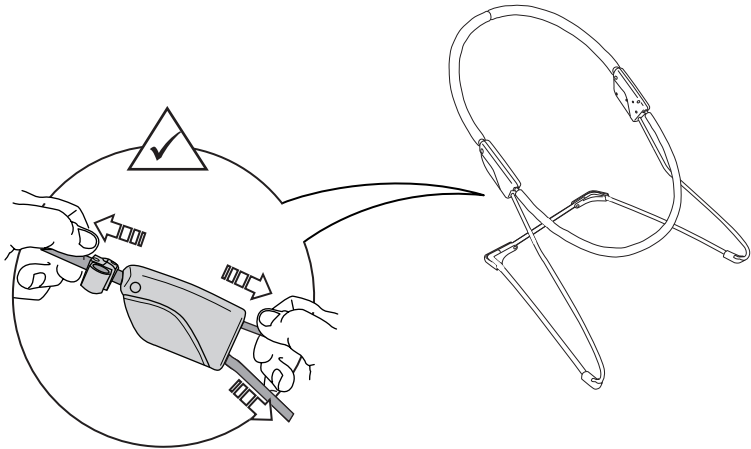

6

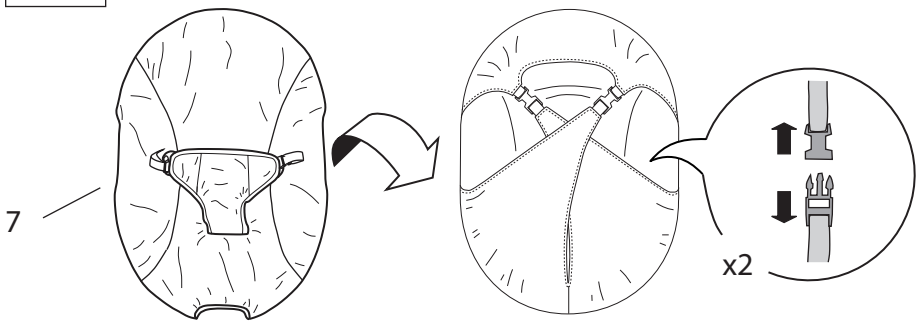

7

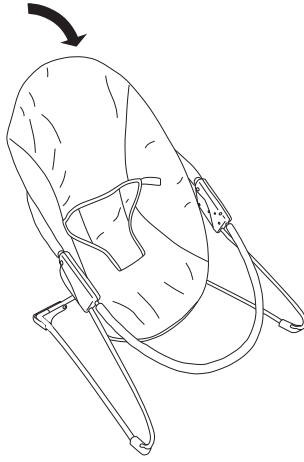

8

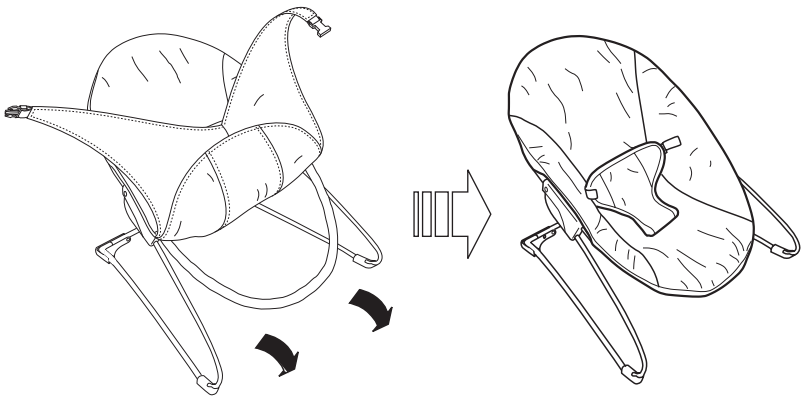

9

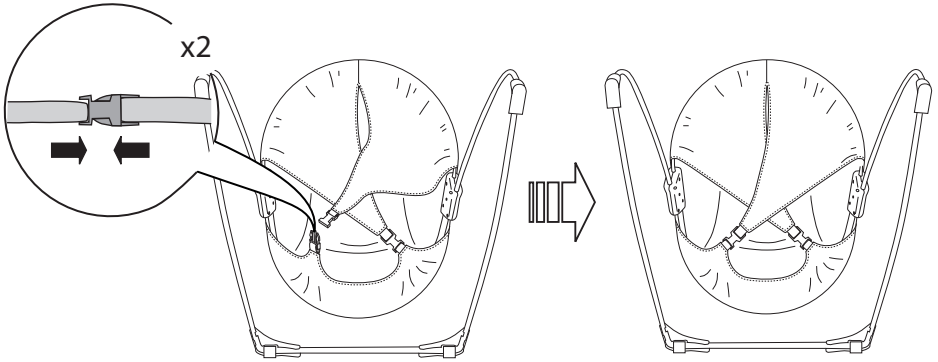

10

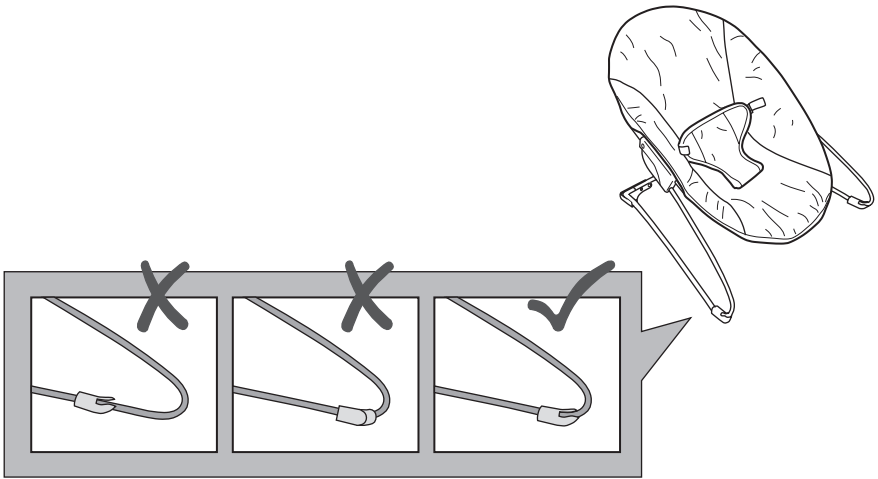

Using the Seat Restraint

1

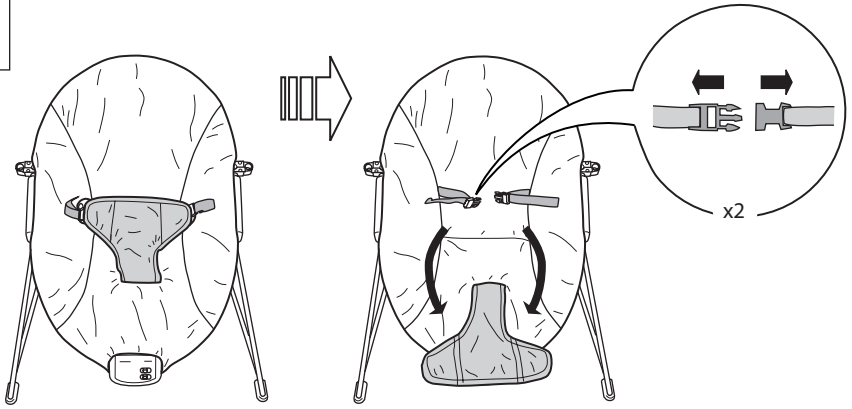

2

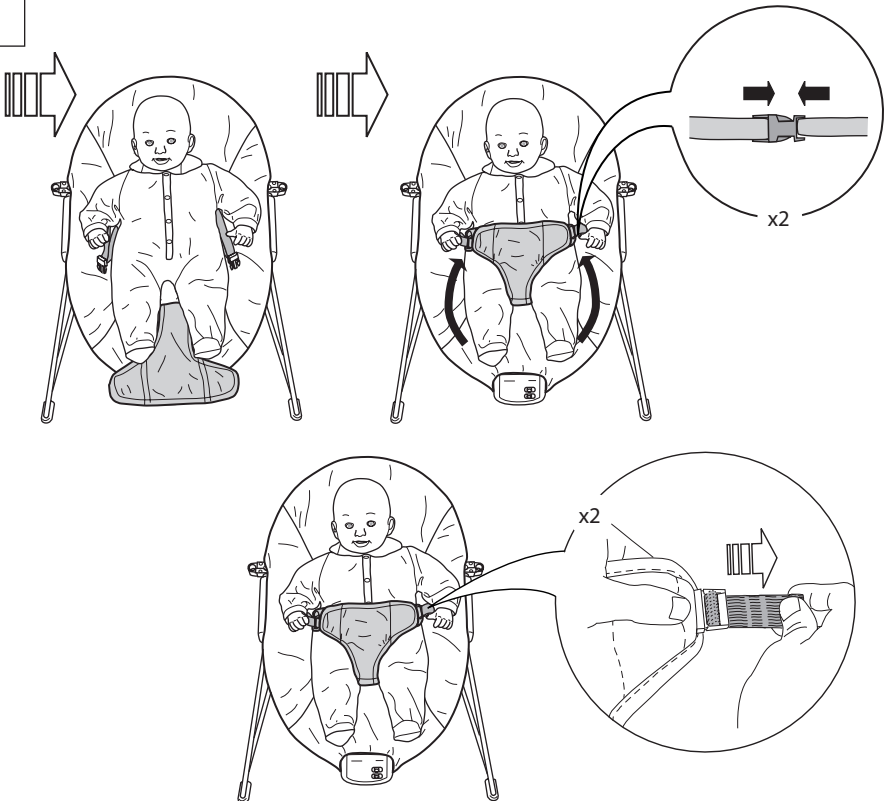

Care and Cleaning

EN **Seat pad** – Remove from frame. Fasten buckles on seat restraint and seat pad. Fasten all hook-and-loop patches to the corresponding patch. Machine wash with cold water, gentle cycle. No bleach. Tumble dry, using low heat.

Toy bar and toys – Wipe clean with a damp cloth and mild soap. Air dry. Do not immerse in water.

Frame – Wipe the metal frame with soft, clean cloth and mild soap.

Storage and Travel

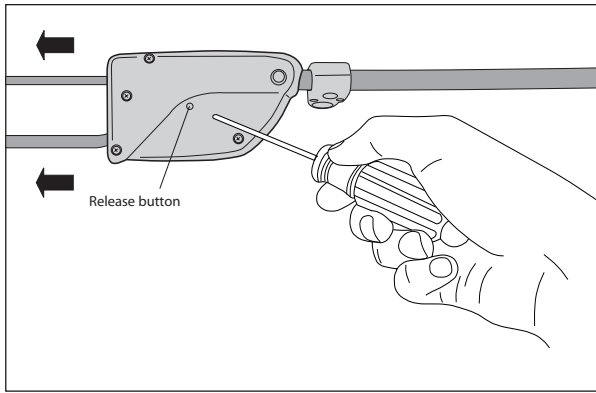

EN **To disassemble the bouncer for storage:**

Use a small Phillips screwdriver to depress the release button on the inside of each connecting hub on the bouncer.

Remove the footrest tube and base frame tubes from each connecting hub.

