

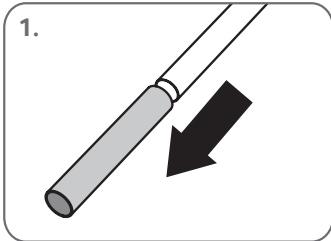

INSTALLATION INSTRUCTIONS:

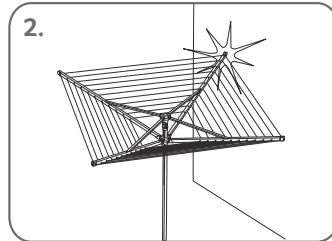

1. Remove the ground socket from the centre pole.



2. Find sufficient room for the airer to rotate completely.

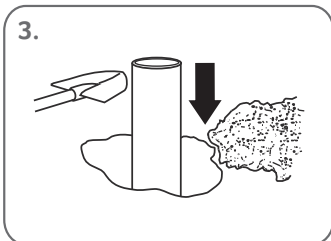

3. Install the ground socket securely into the ground. **Note:** The ground socket should be installed using concrete (not included); a fence post mix is ideal. Make sure the top of the ground socket is flush with the ground.

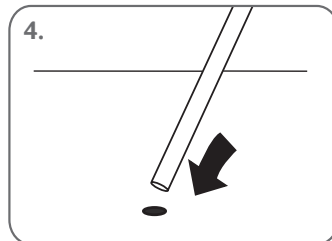

4. Once the concrete has hardened, insert the airer assembly into the ground socket.

Important

Do not allow the pulley cord to hang freely when the airer is in use. Thread the pulley cord through the lines at the top of the airer for safety.

This item is heavy.

Take care during installation.

If in doubt, then a professional tradesperson should be consulted.

This is not a toy. Children should not play unsupervised near this product.

When not in use store safely out of reach of children.

Ensure support for the airer is securely fixed in the ground and supports the airer in an upright position.

Load and unload evenly.

Take care when opening and closing the item to avoid trapping fingers.

Maximum load 50kg.