

# BUSH

## Instruction manual

BFFWX60185W

BFFWX60185G

BFFWX60185B

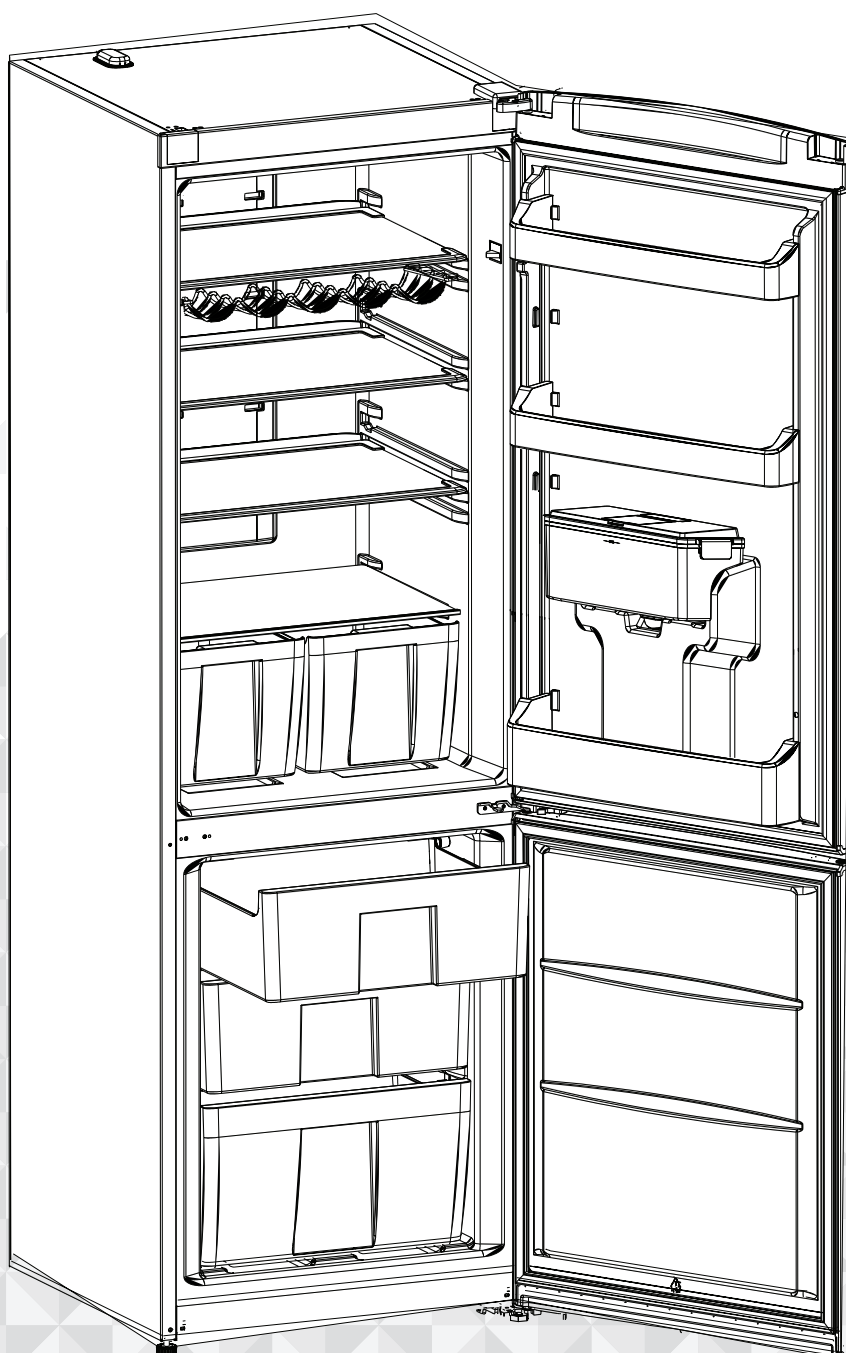



You'll soon be enjoying your new Combi Fridge-Freezer.

It all begins here, with your instructions. Don't worry, there's nothing too technical coming up. Just simple, step-by-step guidance to get you up and running quickly. Sound good? Then let's get started.

## Help and Guidance

We're here to help you get the most from your Combi Fridge-Freezer. Should you require any guidance, a simple solution can often be found online at:

[www.argos-support.co.uk](http://www.argos-support.co.uk)

If you still require further assistance, call one of our experts on 0345 257 7271

If you require any technical guidance or find that your product is not operating as intended, a simple solution can often be found in the **Troubleshooting** section of these instructions,

# Contents

<b>1</b>	<b>Safety information</b>	<b>5</b>	<b>7</b>	<b>Product support</b>	<b>31</b>
	General warnings	6		Help and assistance	34
	Safety warnings	7		Disposal	35
				Guarantee	36
<b>2</b>	<b>Getting to know your Combi Fridge-Freezer</b>	<b>9</b>			
<b>3</b>	<b>Installing your Combi Fridge-Freezer</b>	<b>13</b>			
	Installing and operating your fridge	14			
	Before Using Your Fridge	14			
	Shipment and Repositioning	14			
	Repositioning the door	14			
	Electrical Connection (For UK type plug)	15			
<b>4</b>	<b>Functions</b>	<b>17</b>			
	Display and control panel	18			
	Cooler Set Button	18			
	Sr Alarm	18			
	Operating your fridge	18			
	Cooler temperature settings	18			
	Warnings about temperature adjustments	19			
	Accessoires	19			
	Water dispenser	20			
	Information on No-Frost Technology	22			
<b>5</b>	<b>Using your Combi Fridge-Freezer</b>	<b>23</b>			
	Arranging Food in the Appliance	24			
	Tips for Saving Energy	25			
<b>6</b>	<b>Care and maintenance</b>	<b>27</b>			
	Cleaning	28			
	Defrosting	28			
	Replacing the LED	28			
	Technical specification	29			



If you require any technical guidance or find that your product is not operating as intended, a simple solution can often be found in the **Troubleshooting** section of these instructions,

# Safety information

**1**

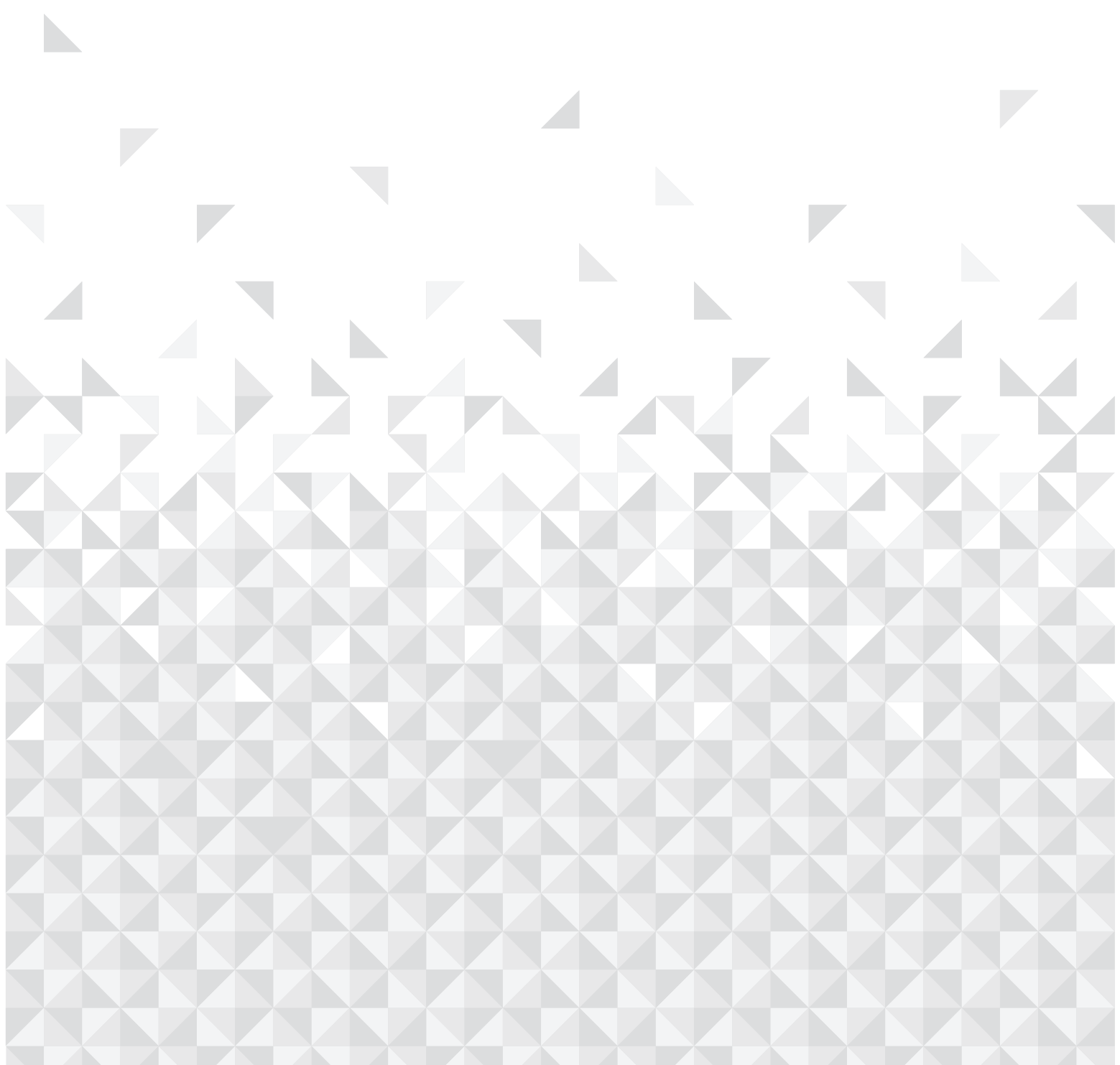



## Safety information

**Important** - Please read these instructions fully before installing or operating

### General warnings

**WARNING:** Keep ventilation openings, in the appliance enclosure or in the built-in structure, clear of obstruction.

**WARNING:** Do not use mechanical devices or other means to accelerate the defrosting process, other than those recommended by the manufacturer.

**WARNING:** Do not use electrical appliances inside the food storage compartments of the appliance, unless they are of the type recommended by the manufacturer.

**WARNING:** Do not damage the refrigerant circuit.

**WARNING:** To avoid a hazard due to the instability of the appliance, it must be fixed in accordance with the instructions.

- If your appliance uses R600a as a refrigerant – you can learn this information from the label on the cooler- you should be careful during shipment and installation to prevent your appliance's cooler elements from being damaged. Although R600a is an environmentally friendly and natural gas. As it is explosive, in the event of a leak due to damage to the cooler elements, move your fridge from open flame or heat sources and ventilate the room where the appliance is located for a few minutes.
  - While carrying and positioning the fridge, do not damage the cooler gas circuit.
  - Do not store explosive substances such as aerosol cans with a flammable propellant in this appliance.
  - This appliance is intended to be used in household and similar applications such as;
    - staff kitchen areas in shops, offices and other working environments
    - farm houses and by clients in hotels, motels and other residential type environments
    - bed and breakfast type environments;
    - catering and similar non-retail applications
- If the socket does not match the refrigerator plug, it must be replaced by the manufacturer, its service agent or similarly qualified persons in order to avoid a hazard.
  - A specially grounded plug has been connected to the power cable of your refrigerator. This plug should be used with a specially grounded socket of 13 amperes. If there is no such socket in your house, please have it installed by an authorized electrician.
  - This appliance can be used by children aged from 8 years and above and persons with reduced physical, sensory or mental capabilities or lack of experience and knowledge if they have been given supervision or instruction concerning use of the appliance in a safe way and understand the hazard involved. Children shall not play with the appliance. Cleaning and user maintenance, shall not be made by children without supervision.
  - If the supply cord is damaged, it must be replaced by the manufacturer, its service agent or similar qualified persons in order to avoid a hazard.



## Safety information

**Important** - Please read these instructions fully before installing or operating

### Old and out-of-order fridges

- If your old fridge has a lock, break or remove the lock before discarding it, because children may get trapped inside it and may cause an accident.
- Old fridges and freezers contain isolation material and refrigerant with CFC. Therefore, take care not to harm environment when you are discarding your old fridge.

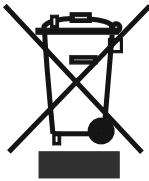

Please ask your municipal authority about the disposal of the WEEE for the reuse, recycle and recovery purposes.

### Notes:

- Please read the instruction manual carefully before installing and using your appliance. We are not responsible for the damage occurred due to misuse.
- Follow all instructions on your appliance and instruction manual, and keep this manual in a safe place to resolve the problems that may occur in the future.
- This appliance is produced to be used in homes and it can only be used in domestic environments and for the specified purposes. It is not suitable for commercial or common use. Such use will cause the guarantee of the appliance to be cancelled and our company will not be responsible for the losses to be occurred.
- This appliance is produced to be used in houses and it is only suitable for cooling / storing foods. It is not suitable for commercial or common use and/or for storing substances except for food. Our company is not responsible for the losses to be occurred in the contrary case.

### Safety warnings

- Do not use multiple receptacles or extension cord.
- Do not plug in damaged, torn or old plugs.
- Do not pull, bend or damage the cord.
- This appliance is designed for use by adults, do not allow children to play with the appliance or let them hang off the door.
- Do not plug-in or out the plug from the receptacle with wet hands to prevent electrocution!
- Do not place glass bottles or beverage cans in the freezer department. Bottles or cans may explode.
- Do not place explosive or flammable material in your fridge for your safety. Place drinks with higher alcohol amount vertically and by closing their necks tightly in the fridge department.
- When taking ice made in the freezer department, do not touch it, ice may cause ice burns and/or cuts.
- Do not touch frozen goods with wet hands! Do not eat ice-cream and ice cubes immediately after you have taken them out of the freezer department!
- Do not re-freeze frozen goods after they have melted. This may cause health issues like food poisoning.
- Do not cover the body or top of fridge with lace. This affects the performance of your fridge.
- Fix the accessories in the fridge during transportation to prevent damage to accessories.



If you require any technical guidance or find that your product is not operating as intended, a simple solution can often be found in the **Troubleshooting** section of these instructions,



Getting to know your Combi  
Fridge-Freezer

2

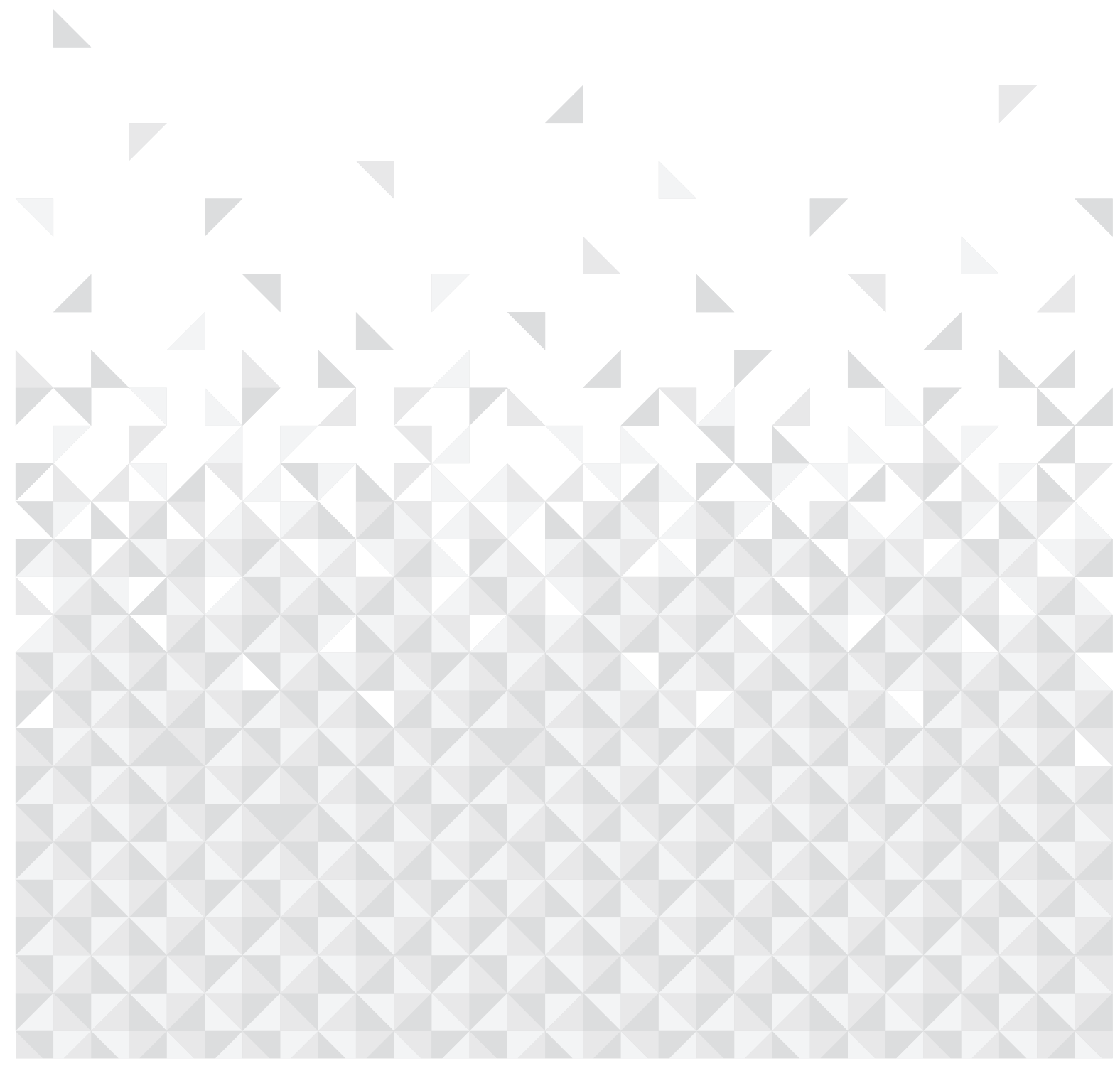

## Getting to know your Combi Fridge-Freezer

You'll be up and running in no time

### Ready? Let's begin...

Please read these instructions carefully. They contain important information which will help you get the best from your Combi Fridge-Freezer and ensure safe

and correct installation and operation.

If you require any further assistance, our technical experts are happy to help. For full details, refer to the product support section at the end of these instructions.

# Getting to know your Combi Fridge-Freezer

You'll be up and running in no time

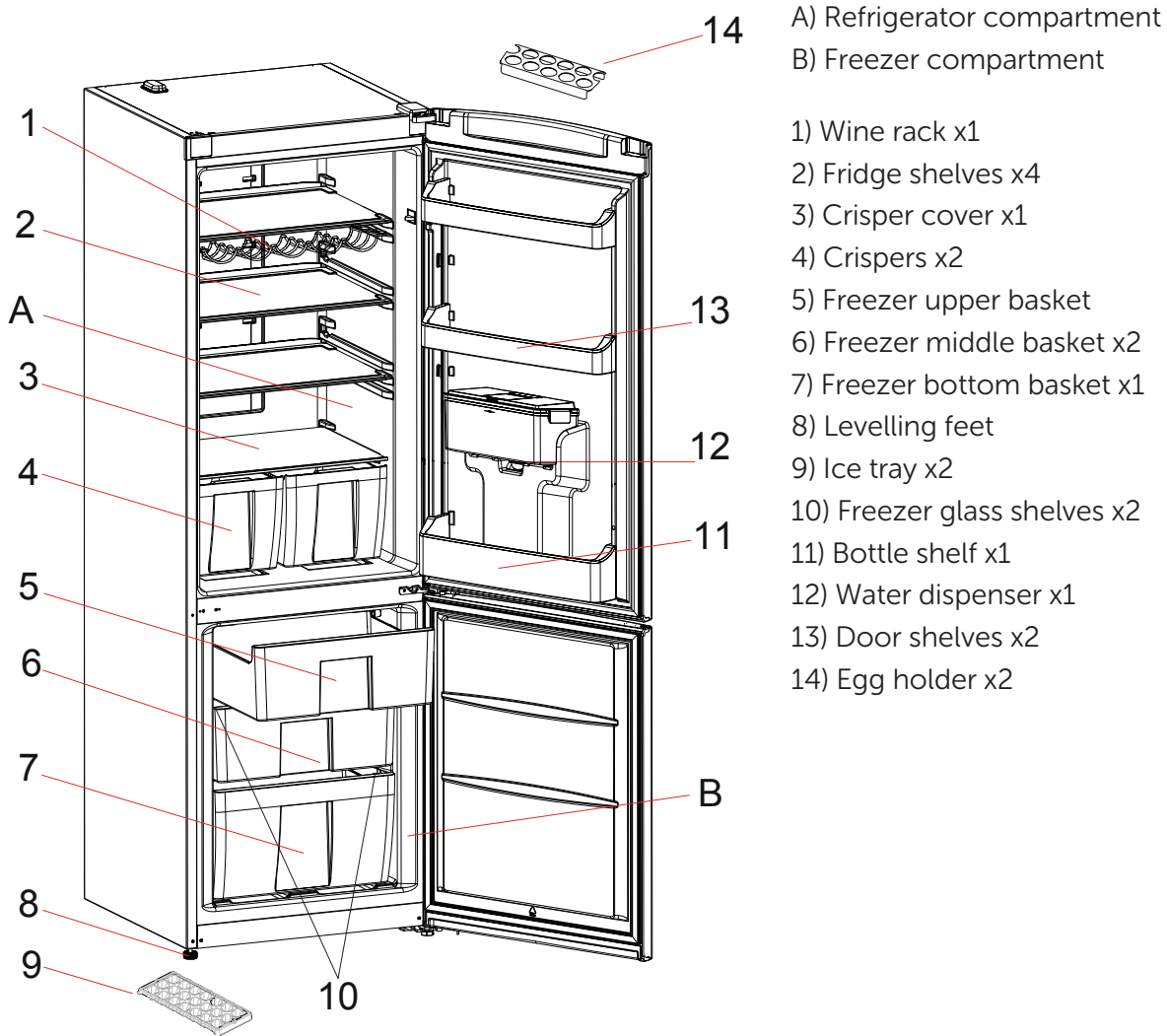



If you require any technical guidance or find that your product is not operating as intended, a simple solution can often be found in the **Troubleshooting** section of these instructions,

# Installing your Combi Fridge-Freezer

# 3

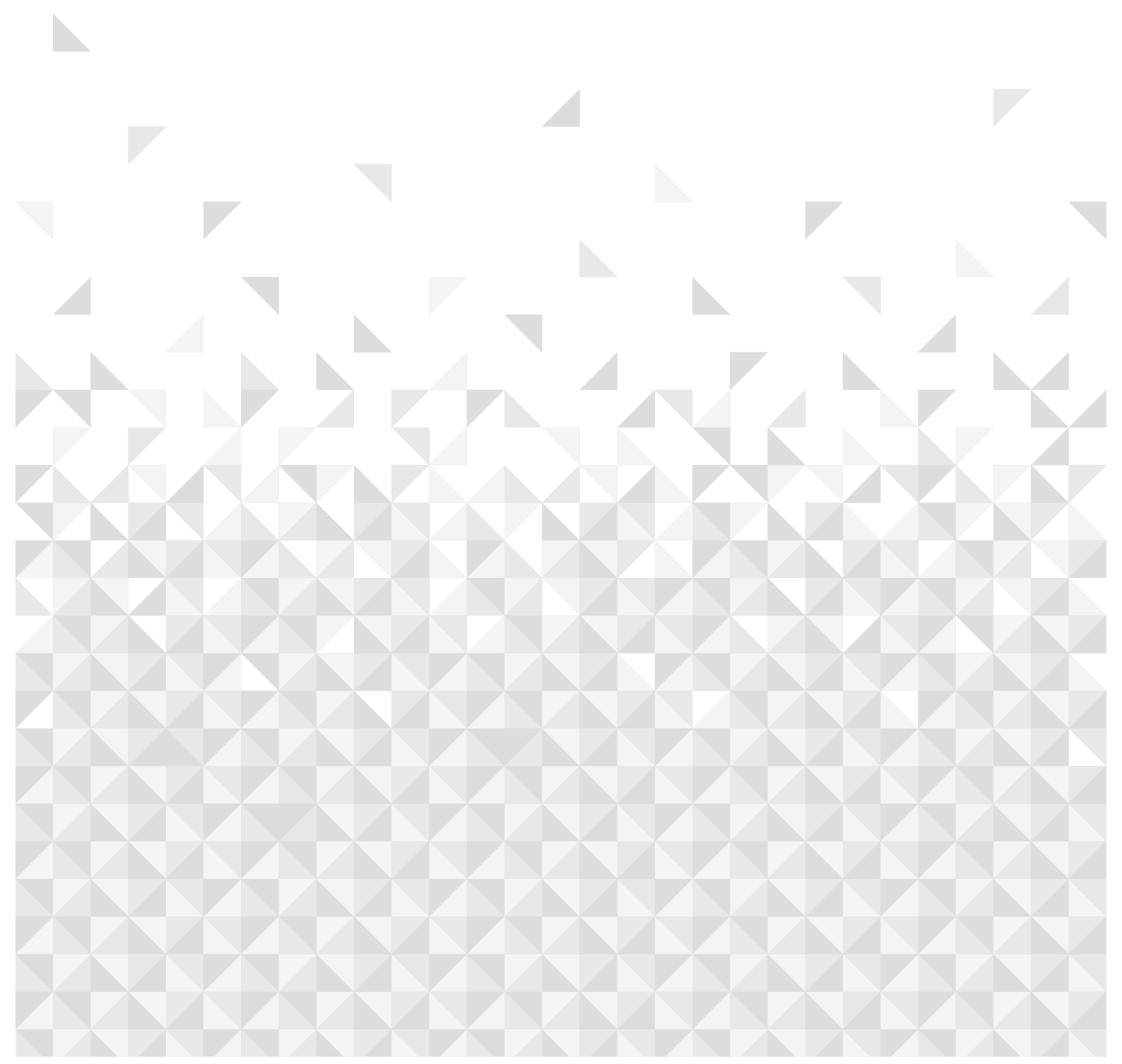

# Installing your Combi Fridge-Freezer

## Bringing it all together

### Installing and operating your fridge

Before starting to use your fridge, you should pay attention to the following points:

- Operating voltage for your fridge is 220-240 V at 50Hz.
- We do not take the responsibility of the damages that occur due to ungrounded usage.
- Do not place your appliance in direct sunlight.
- Your appliance should be at least 50 cm away from stoves, gas ovens and heater cores, and should be at least 5 cm away from electrical ovens.
- Your fridge should never be used outdoors or left under the rain.
- When your fridge is placed next to a deep freezer, there should be at least 2 cm between them to prevent humidity on the outer surface.
- Do not place anything on your fridge, and install your fridge in a suitable place so that at least 15 cm is available on the upper side.
- The adjustable front legs should be stabilized in an appropriate height to allow your fridge to operate in a stable and proper way. You can adjust the legs by turning them clockwise (or in the opposite direction). This should be done before placing food in the fridge.
- Before using your fridge, wipe all parts with warm water added with a tea spoonful of sodium bicarbonate, and then rinse with clean water and dry. Place all parts after cleaning.
- Install the distance adjustment plastic (the part with black vanes at the rear) by turning it 90° as shown in the figure to prevent the condenser from touching the wall.
- Refrigerator should be placed against a wall with a free distance not exceeding 75 mm.

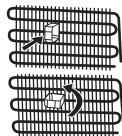

### Before Using Your Fridge

- Before switching on your appliance for the first time, ensure it is positioned in its desired final location and is in its upright position for at least 3 hours before plugging in and switching on the power. Otherwise you may damage the compressor.
- You may experience an odour from the appliance when it is operated for the first time. This is normal and will fade when your appliance starts to cool.

### Shipment and Repositioning

- Original package and foam may be kept for retransportation (optionally).
- You should fasten your fridge with thick package bands or strong cords and follow the instructions for transportation on the package for retransportation.
- Remove movable parts (shelves, accessories, vegetable bins etc.) or fix them into the fridge against shocks using bands during repositioning and transportation.

Carry your fridge in the upright position.

### Repositioning the door

- It is not possible to change the opening direction of your fridge door, if the door handles on your fridge are installed from the front surface of the door.
- It is possible to change the opening direction of the door on models without any handles.
- If the door opening direction of your fridge may be changed, you should contact the nearest Authorised Service to have the opening direction changed.

# Installing your Combi Fridge-Freezer

## Bringing it all together

### Electrical Connection (For UK type plug)

For your safety please read the following information

**Warning:** This appliance must be earthed.

This appliance operates from 220-240 volts and should be protected by a 13 amp fuse in the plug.

The appliance is supplied with a standard 13 amp 3-pin mains plug fitted with a 13-amp fuse.

Should the fuse require replacement, it must be replaced with a fuse rated at 13 amp and approved to BS1362.

If the mains plug which is fitted is unsuitable for the socket outlet in your home or is removed for any other reason, please follow the instructions below on how to wire a 13 amp 3 pin plug.

The wires in the mains lead on this appliance are coloured in accordance with the following code:

**Green and Yellow – Earth**

**Blue – Neutral**

**Brown – Live**

As the colours may not correspond with the markings identifying the terminals in your plug proceed as follows.

The green and yellow wire must be connected to the terminal in the plug which is marked with the letter E or with the earth symbol or coloured green and yellow.

The blue wire must be connected to the terminal marked N.

The brown wire must be connected to the terminal marked L.

You must make sure the lead is firmly secured under the cord clamp.

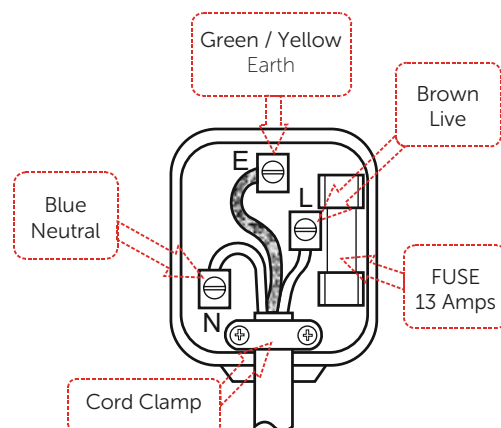



If you require any technical guidance or find that your product is not operating as intended, a simple solution can often be found in the **Troubleshooting** section of these instructions,



# Functions 4

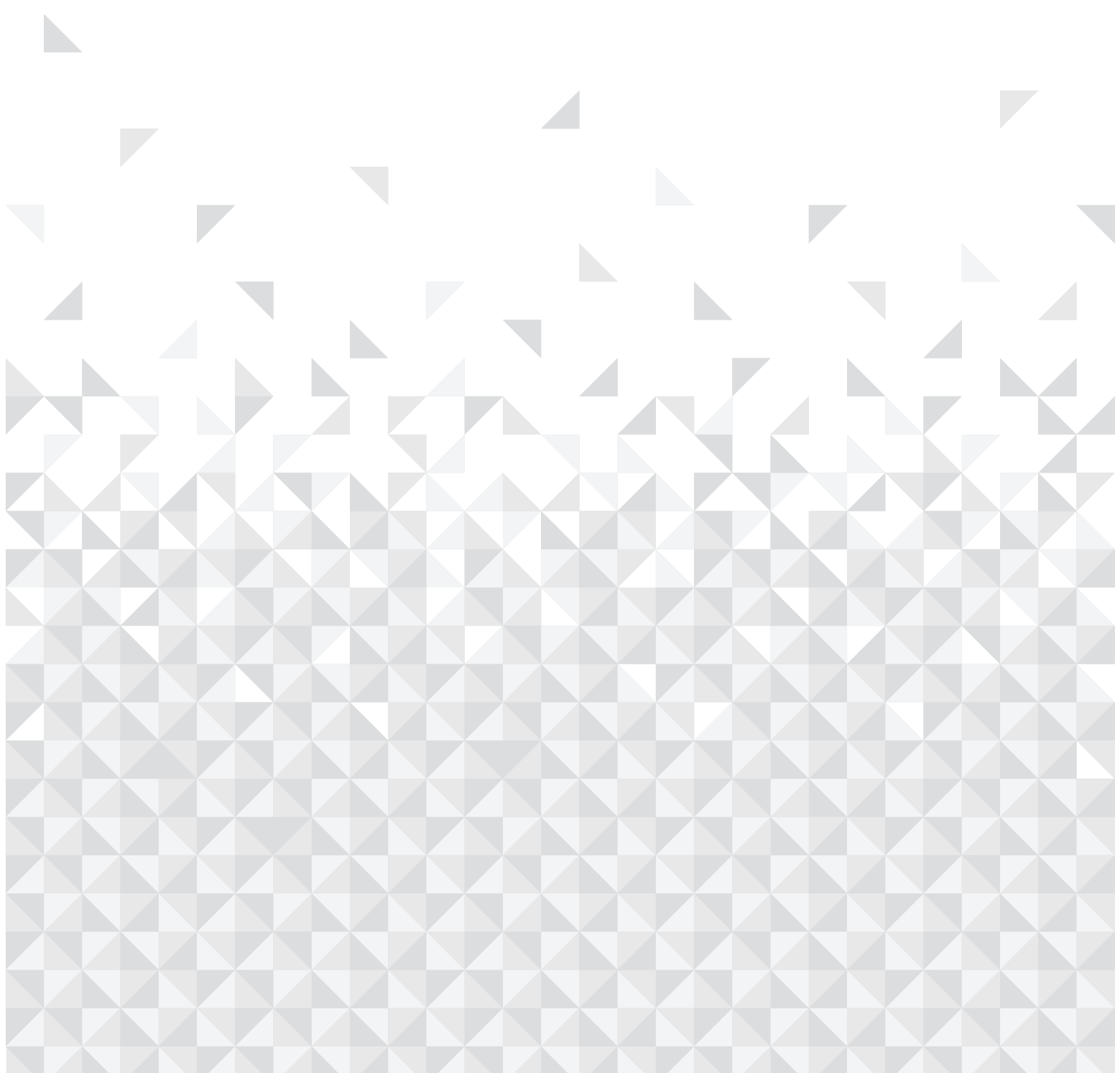

## Functions

Simple everyday use

### Display and control panel

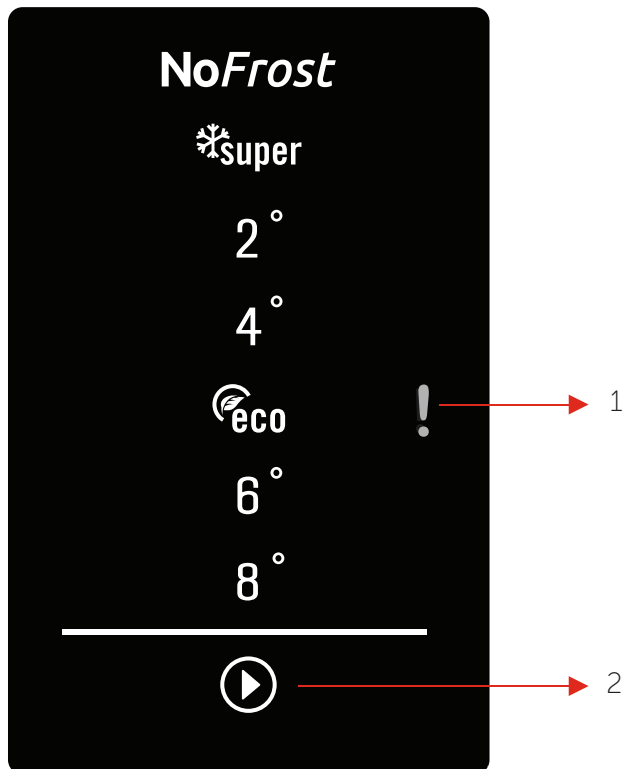

1. Sr Alarm Indicator
2. Cooler Set Button

### Display and control panel

#### Cooler Set Button

It is cooler set button. The temperature of cooler compartment can be changed by this button. Super cool and economy mode can be activated by this button.

#### Sr Alarm

Sr Alarm will light red and sound alarm will be released if any problem occurs.

### Operating your fridge

#### Super cool mode

How would it be used?

- Push cooler set button until super cool symbol lights. Buzzer will sound beep beep. Mode will be set.

During this mode:

- Super cool mode can be cancelled by the same operation of selecting.

**Note:** Super cool mode will be automatically cancelled after 6 hours depending on the environmental temperature or when the refrigerator sensor reaches a sufficiently low temperature.

#### Economy mode

How would it be used?

- Push cooler set button until economy symbol lights.
- If no pressed any button for 1 sec. When mode is set, buzzer will sound beep beep.
- To cancel, you will just need to press on Cooler Set Button.

#### Cooler temperature settings

- Initial temperature value for cooler setting indicator is +4°C.
- Press cooler set button once
- When you first push this button, the last value appears on the setting indicator of the cooler.
- Whenever you press on this button, lower temperature will be set. (+8°C, +6°C, economy, +4°C, +2°C, super cool)
- When you push the cooler set button until supercool symbol appears on the cooler setting indicator, and if you do not push any button in 1 seconds super cool will flash.
- If you continue to press, it will restart from +8°C.

If you require any technical guidance or find that your product is not operating as intended, a simple solution can often be found in the **Troubleshooting** section of these instructions,

## Functions

Simple everyday use

## Warnings about temperature adjustments

- Your temperature adjustments will not be deleted when an energy breakdown occurs.
- It is not recommended that you operate your fridge in environments colder than 10°C in terms of its efficiency.
- This equipment is designed for use at an ambient temperature within the 16°C - 43°C range.
- Temperature adjustments should be made according to the frequency of door openings and the quantity of food kept inside the fridge.
- Do not pass to another adjustment before completing an adjustment.
- Your fridge should be operated up to 24 hours according to the ambient temperature without interruption after being plugged in to be completely cooled. Do not open doors of your fridge frequently and do not place much food inside it in this period.
- A 5 minute delaying function is applied to prevent damage to the compressor of your fridge, when you take the plug off and then plug it on again to operate it or when an energy breakdown occurs. Your fridge will start to operate normally after 5 minutes.
- Your fridge is designed to operate in the ambient temperature intervals stated in the standards, according to the climate class stated in the information label. We do not recommend operating your fridge out of stated temperatures value limits in terms of cooling effectiveness.

Climate Class	Ambient Temperature °C
T	Between 16 and 43 (°C)
ST	Between 16 and 38 (°C)
N	Between 16 and 32 (°C)
SN	Between 10 and 32 (°C)

## Accessoires

### Ice tray

- To remove ice tray; pull the upper freezer box out as far as possible and then pull the ice box out.
- Fill 3/4 full of water and place the ice tray in freezer.

**Note:** While placing the ice tray in the freezer, place in a horizontal position. Otherwise the water in the ice box can be spill.

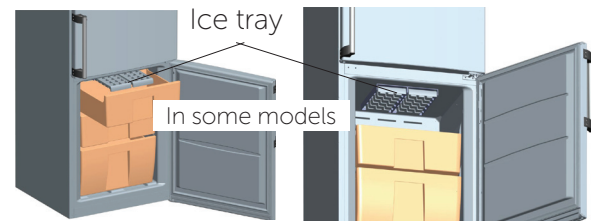

### Freezer box

The freezer box allows foods are maintained more regularly.

#### Removing The freezer box;

- Pull the box out as far as possible
  - Pull the front of box up and out.
- ! Make the inverse of the same operation for the resetting the sliding compartment.

**Note:** Always keep the handle of box while removing the box.

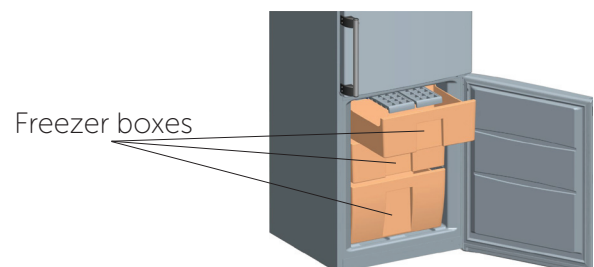

## Functions

Simple everyday use

## Water dispenser

### Mounting of the water tank group

- Place the water tank in the details of the door plastic pitched in the direction of the arrow.
- After inclined to mount the water tank, push it down to place to the details of door plastics properly.
- Add your drinks with the help of water tank top cover.
- Uphold the side locking covers to detach the water tank cover.
- To serve your drink press valve lever slightly.

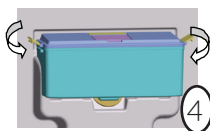
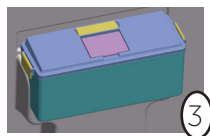
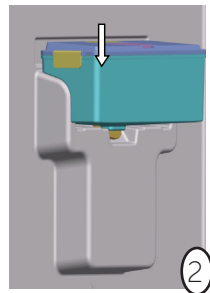
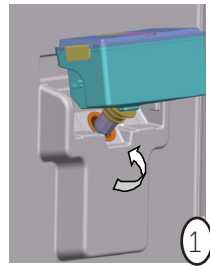

# Functions

## Simple everyday use

### Filling the water tank

- Remove the top cover of the water tank.
- Fill up the tank with water.
- Mount back the top cover of the water tank.

### Attention

- Only use water in the water dispenser.
- If you leave water in the tank for a long time it could generate an odour. If this happens, clean the tank before using again.
- Clean up the water tank before using it for the first time.

### Cleaning the Water Tank

- Lift the water tank.
- Remove the tank cover with upholding the side locking covers.
- Clean up the tank with warm water and reassemble the pieces you removed.

### Stowing the Water Tank

- Install the water tank as shown.
- Be careful about the tap and the hole match each other while installing.
- Water flow can appear unwillingly if the tank have not taken its place properly. Also check the gaskets are assembled properly.

### Drip Tray

During the usage of dispenser the water splashes around the glass piles up in the drip tray. In order to clean it remove the tray. After the cleaning you can mount it on.

### Filter detail

Filter is designed to prevent any food odours in the refrigerator from reaching the water tank. Please apply to authorized service centre to open this cover and to change the filter.

### ATTENTION:

PLEASE HOLD THE GLASS FOR ONE SECOND LONGER AFTER DISTRIBUTION TO AVOID DRIPS.

(Visual and text descriptions on the accessories section may vary according which model you have.)

## Functions

Simple everyday use

### Information on No-Frost Technology

No-frost refrigerators differ from other static refrigerators in the way they work. In static fridges, the humidity entering the fridge due to door openings and the humidity inherent in food causes freezing in the freezer compartment. To defrost the frost and ice in the freezer compartment, you are periodically required to turn off the appliance, place the food that needs to be kept frozen in a separately cooled container, and remove the ice gathered in the freezer compartment.

It is completely different in no-frost fridges. Dry and cold air is blown into the fridge and freezer compartments continuously and evenly from several points via a blower fan. Cold air dispersed continuously and evenly between the shelves cools all of your food equally and uniformly, thus preventing humidity and freezing.

Therefore your no-frost fridge allows you ease of use, in addition to its huge capacity and stylish appearance.

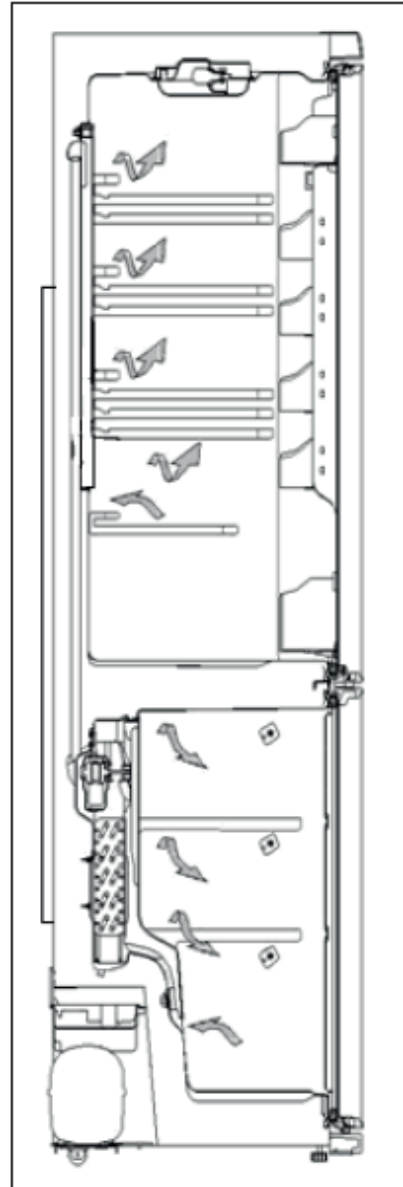

# Using your Combi Fridge-Freezer

# 5

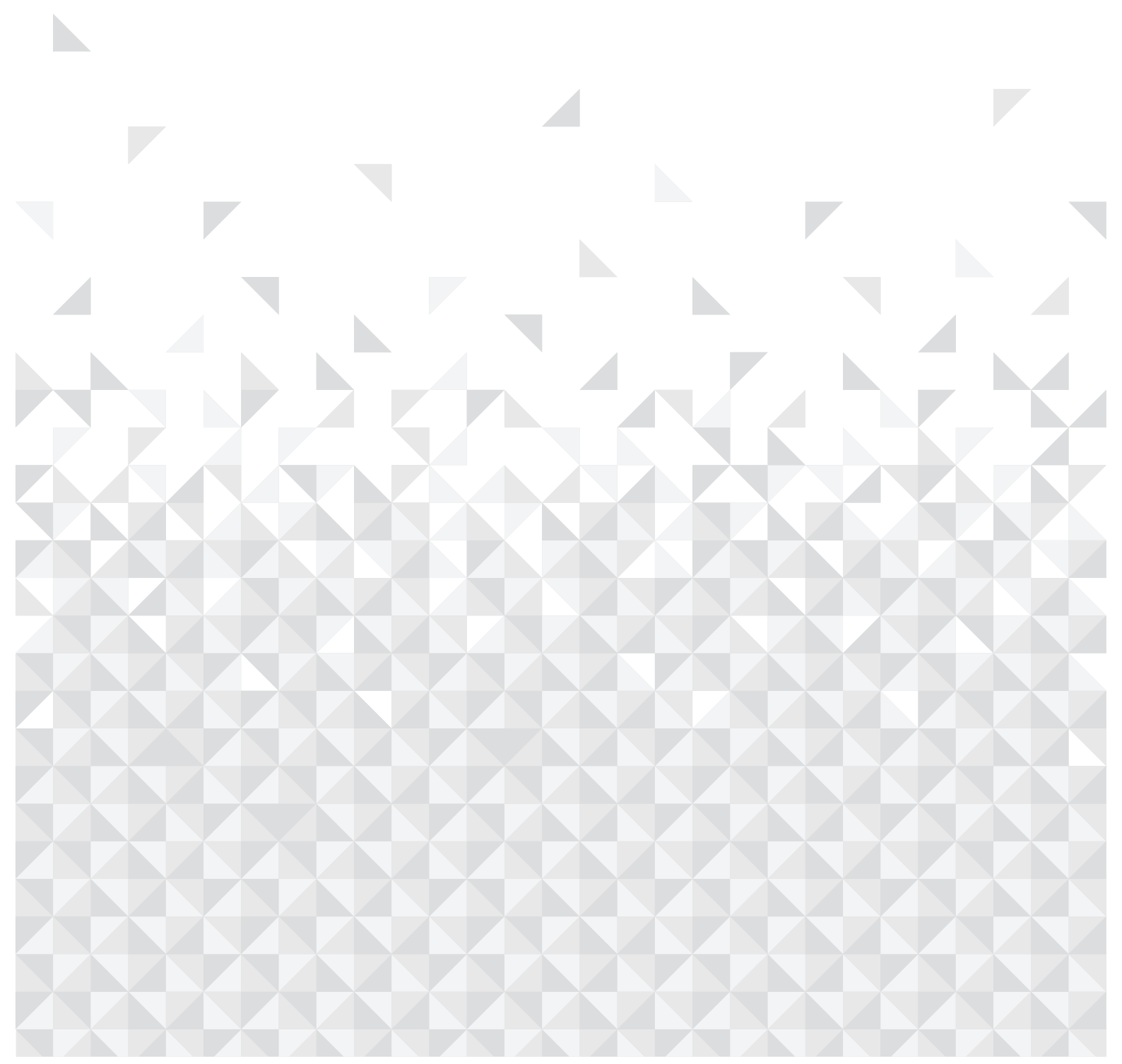

# Using your Combi Fridge-Freezer

## Getting the most from your appliance

### Arranging Food in the Appliance

#### Fridge Compartment

- To prevent humidity and odor forming, the food should be placed in the refrigerator in closed or covered containers.
- Hot foods and drinks should be cooled to room temperatures before being placed in the refrigerator.
- Please do not place packaged food and containers against the lamp or cover of the cooling compartment.
- Fruits and vegetables may be placed directly in the vegetable holder without being wrapped separately.
- Some recommendations have been specified below for the placement and storage of your food in the cooling compartment.

**NOTE:** Potatoes, onions and garlic should not be stored in the refrigerator. Meat should never be refrozen after it is thawed.

#### Freezer compartment

- Use the deep freeze compartment of your refrigerator for storing the frozen food for a long time and for producing ice.
- To get maximum capacity from your freezer compartment, please just use the glass shelves for upper and middle section. For bottom section, please use lower basket.
- Place the food you would like to freeze initially in the upper shelf of the deep freeze section. You may place your food next to the other frozen foods after they are frozen (for at least 24 hours).
- It is recommended to keep thermostat set at level 5.
- It is recommended that the food which is being newly frozen be kept separate from the already frozen food.
- Do not refreeze the frozen food once it is thawed. It may pose a danger to your health
- Do not place hot meals in your deep freeze until they cool down. You could cause the

other food frozen beforehand in the deep freeze compartment to become spoiled.

- As you buy frozen food, make sure it was frozen under appropriate conditions and that the packaging is not torn.
- While storing frozen food, the storage conditions on the package should be observed. If there are no instructions, the food has to be consumed in the shortest period of time.
- Frozen food has to be transported before it thaws and it should be placed in the fast freezing shelf as soon as possible. Please do not use the baskets for fast freezing purposes.
- The storage durations of frozen food depend on the environmental temperatures, the frequent opening and closing of the doors, temperature settings, food types, and the period of time that has elapsed from when the food was acquired to the time it entered the freezer. Always abide by the instructions on the package and never exceed the storage duration.
- During power cuts, please do not open the door of the deep freeze compartment. Your refrigerator will preserve your frozen food in the ambient temperature of 25 °C for about 13 hours. This preservation time period decreases the higher the ambient temperatures are. During extended power cuts, you should not refreeze your food and should be disposed of accordingly.

Note:

- Frozen foods, when thawed, should be cooked just like fresh foods. Once food is thawed, it must NEVER be re-frozen.
- Food in liquid form should be frozen in suitable plastic sealed containers. Other food types can also be frozen in suitable plastic sealed containers or alternatively freezer bags.

**Important note:**

- Frozen foods, when thawed, should be cooked just like fresh foods. If they are not cooked after being thawed they must NEVER



# Using your Combi Fridge-Freezer

## Getting the most from your appliance

be re-frozen.

- The taste of some spices found in cooked dishes (anise, basilica, watercress, vinegar, assorted spices, ginger, garlic, onion, mustard, thyme, marjoram, black pepper, etc.) changes and they assume a strong taste when they are stored for a long period. Therefore, the frozen food should be added little amount of spices or the desired spice should be added after the food has been thawed.
- The storage period of food is dependent on the oil used. The suitable oils are margarine, olive oil and butter and the unsuitable oils are peanut oil and lard oil.
- The food in liquid form should be frozen in plastic cups and the other food should be frozen in plastic folios or bags.

## Tips for Saving Energy

1. Install the appliance in a cool, well ventilated room, but not in direct sunlight or near heat sources (radiators, cooker, etc....).
2. Allow warm food and drinks to cool down before placing in the appliance.
3. When thawing frozen food, place it in the refrigerator compartment. The frozen food will help to cool the refrigerator compartment when it is thawing.
4. When placing liquids in the appliance they must be covered.
5. When placing food and drinks, open the appliance door as briefly as possible.
6. Keep closed the covers of any different temperature compartments in the appliance (crisper, chiller ...etc ).
7. Door seals should be kept clean and undamaged.

# Using your Combi Fridge-Freezer

Getting the most from your appliance

## Parts Of The Water Dispenser

### (A) FRONT TANK GROUP

- 1) Top cover of the water dispenser
- 2) Valve lever
- 3) Drip tray
- 4) Water dispenser casing

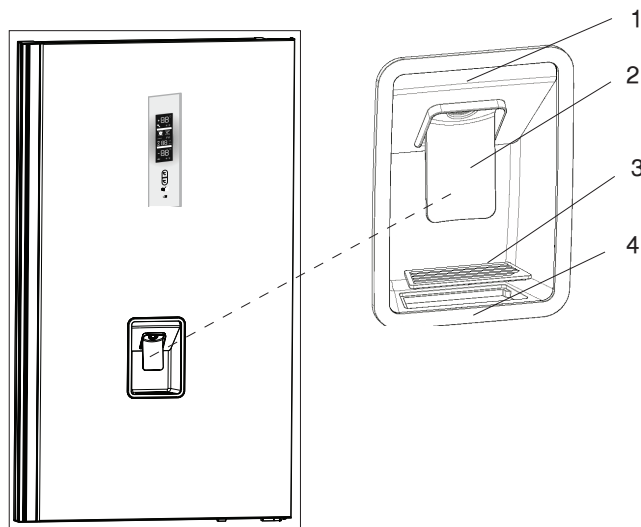

### (B) WATER TANK GROUP

- 5) Filter cover
- 6) Top cover of the water tank
- 7) Tank cover
- 8) Water tank
- 9) Gasket ring
- 10) Tap detail
- 11) Side Locking covers

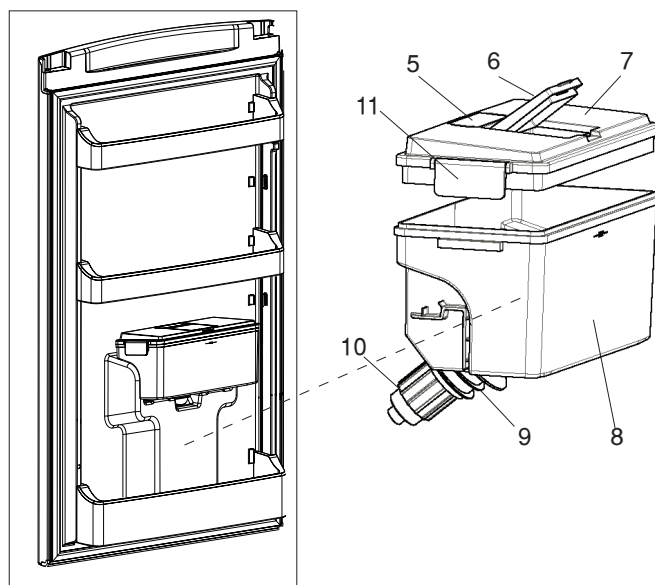

If you require any technical guidance or find that your product is not operating as intended, a simple solution can often be found in the Troubleshooting section of these instructions,

# Care and maintenance

# 6

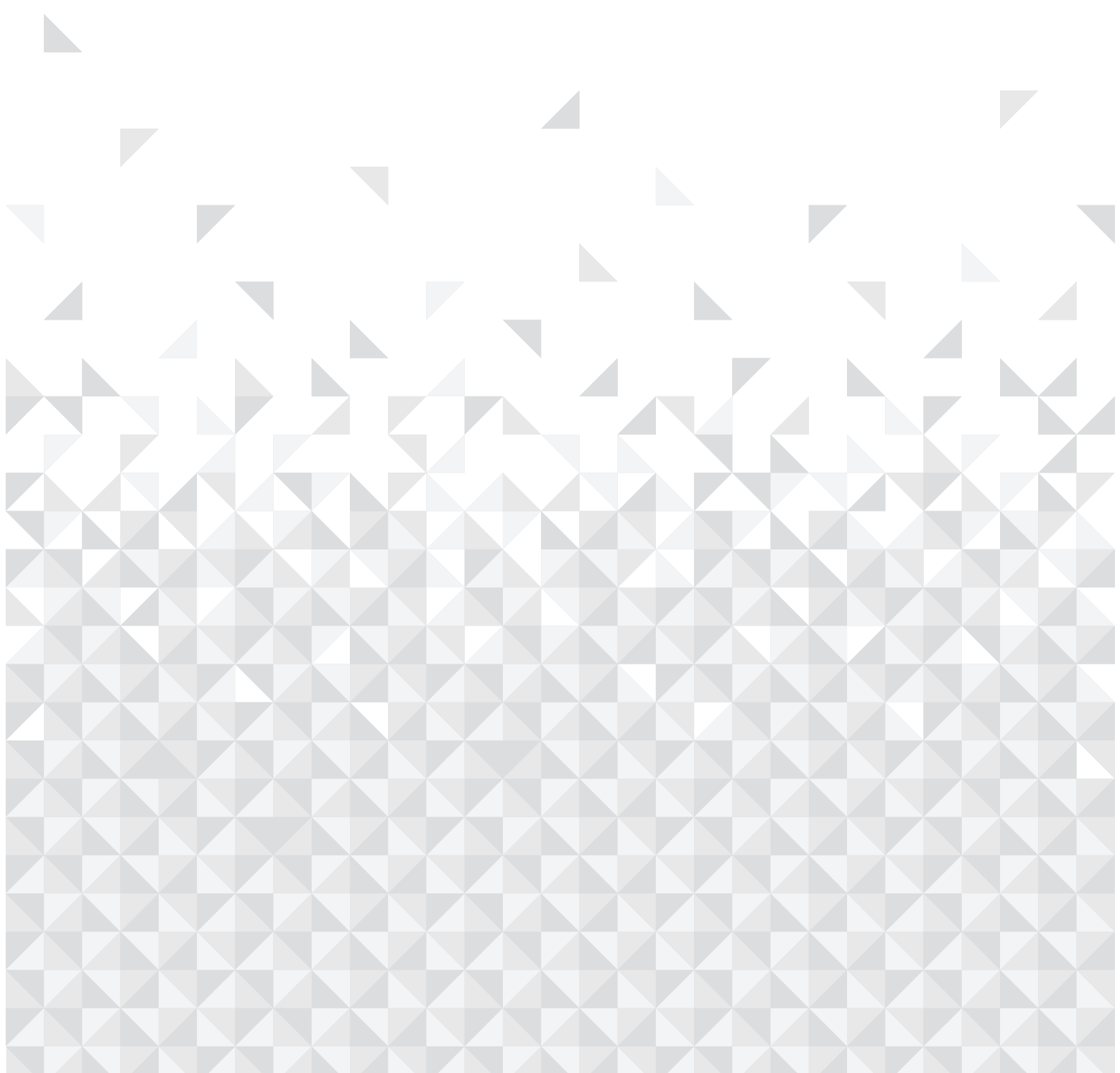

## Care and maintenance

### Looking after your appliance

#### Cleaning

- Make sure you unplug the fridge before starting to clean it.
- Do not pour water directly over your appliance.
- You can wipe the inner and outer sides with a soft cloth or a sponge using warm soapy water.
- Remove parts individually and clean by hand with soapy water. Do not place in dishwashers.
- Never use flammable, explosive or corrosive material for cleaning your appliance
- You should clean the condenser periodically to keep your appliance running efficiently.

Make sure your appliance is unplugged before cleaning.

#### Defrosting

- Your refrigerator performs fully automatic defrosting. The water formed as a result of defrosting passes through the water collection spout, flows into the vaporization container behind your refrigerator and evaporates by itself in there.
- Make sure you have disconnected the plug of your refrigerator before cleaning the drainage tray.
- Remove the drainage tray from its position by unscrewing the screws as indicated. Clean it with soapy water periodically to avoid odours and smells.

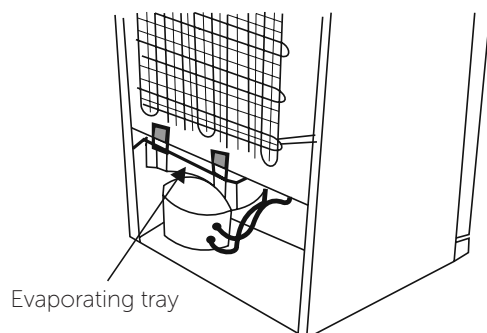

#### Replacing the LED

Contact the Bush helpline.

## Care and maintenance

Looking after your appliance

## Technical specification

Supplier's name or trademark	<b>BUSH</b> <i>Classic</i>
Model / Item	BFFWX60185G BFFWX60185W BFFWX60185B
Type of appliance	GT/N3664EGKSFLATYSU
Energy efficiency class	A+
Voltage	220-240V / 50 Hz
Energy consumption	0.836 kWh/24h - 305 kWh/year
Net storage volume of fresh food	231 lt.
Net storage volume of frozen food	87 lt.
Star rating of frozen food storage compartment	4 (****)
Power cut failure safe storage	13 hours (25°C)
Freezing capacity	4.2 Kg
Climate class	T/N (16°C - 43°C)
Size (mm) (W x D x H)	595 x 633 x 1855
Noise	45 dB (A)

We apologise for any inconvenience caused by minor change or inconsistencies in these instructions that may occur as a result of product improvements and development.





If you require any technical guidance or find that your product is not operating as intended, a simple solution can often be found in the **Troubleshooting** section of these instructions,

Product support

7

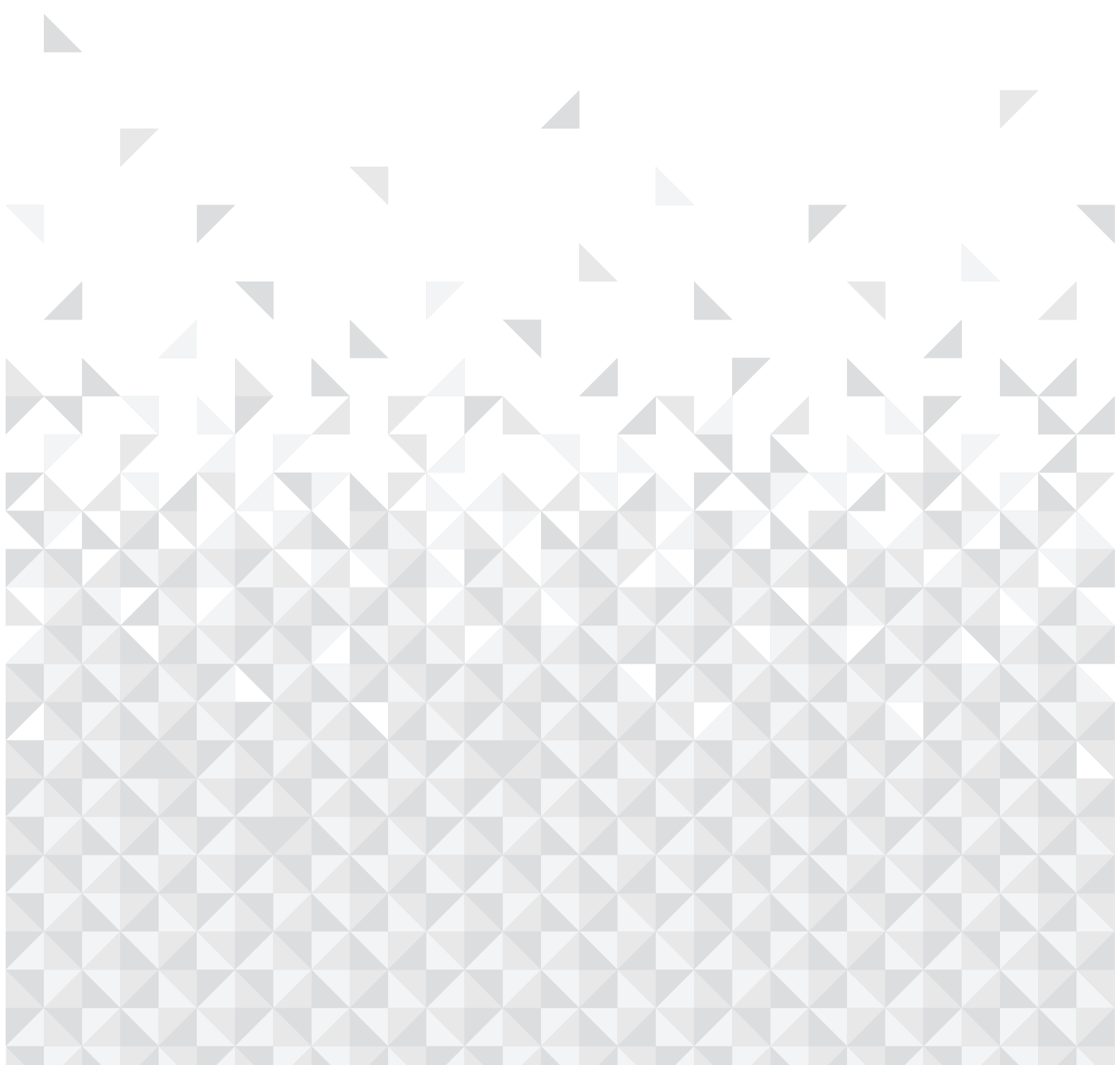

## Product support

Help is always at hand

### Check Warnings;

Your fridge warns you if the temperatures for cooler and freezer are in improper levels or when a problem occurs in the appliance.

ERROR TYPE	Sr
MEANING	"Failure Warning"
WHY	There is/are some part(s) Out of order or there is a failure in cooling process
WHAT TO DO	Contact the Bush helpline for assistance as soon as possible.

### If your fridge is not operating;

- Is there a power failure?
- Is the plug connected to the socket correctly?
- Is the fuse of the socket to which the plug is connected or the main fuse blown?
- Is there any failure at the socket? To check this, plug your refrigerator to a socket this is surely operating.

### If your fridge is not cooling enough;

- Is the temperature adjustment right?
- Is the door of your fridge opened frequently and left open for a long while?
- Is the door of fridge closed properly?
- Did you put a dish or food on your fridge so that it contacts the rear wall of your fridge so as to prevent the air circulation?
- Is your fridge filled excessively?
- Is there adequate distance between your fridge and the rear and side walls?
- Is the ambient temperature within the range of values specified in the operating manual?

### If the food in your refrigerator compartment is over cooled

- Is the temperature adjustment right?
- Are there many food recently put inside the freezer compartment? If so, your fridge may over cool the food inside the refrigerator compartment as it will operate longer to cool these food.

### If your fridge is operating too loudly;

To maintain the set cooling level, compressor may be activated from time to time. Noises from your fridge at this time are normal and due to its function. When the required cooling level is reached, noises will be decreased automatically. If the noises persist;

- Is your appliance stable? Are the legs adjusted?
- Is there anything behind your fridge?
- Are the shelves or dishes on the shelves vibrating? Re-place the shelves and/or dishes if this is the case.
- Are the items placed on your fridge vibrating?

### Normal Noises;

#### Cracking (Ice cracking) Noise:

- During automatic defrosting.
- When the appliance is cooled or warmed (due to expansion of appliance material).

**Short cracking:** Heard when the thermostat switches the compressor on/off.

**Compressor noise (Normal motor noise):** This noise means that the compressor operates normally Compressor may cause more noise for a short time when it is activated.

**Bubbling noise and splash:** This noise is caused by the flow of the refrigerant in the tubes of the system.

**Water flow noise:** Normal flow noise of water flowing to the evaporation container during defrosting. This noise can be heard during defrosting.

**Air Blowing Noise (Normal fan noise):** This noise can be heard in No-Frost fridge during normal operation of the system due to the circulation of air.

### If humidity builds up inside the fridge;

- Are all food packed properly? Are the containers dried before placing them in the fridge?
- Are the fridge doors opened frequently? Humidity of the room gets in the fridge when the doors are opened. Humidity build up will be faster when you open the doors more frequently, especially if the humidity of the room is high.



## Product support

Help is always at hand

If the doors are not opened and closed properly;

- Do the food packages prevent closing of the door?
- Are the door compartments, shelves and drawers placed properly?
- Are door gaskets broken or torn?
- Is your fridge on a level surface?

If the edges of fridge cabinet that the door joint contact are warm;

Especially in summer (hot weather), the surfaces that the joint contact may get warmer during the operation of the compressor, this is normal.

About the water dispenser;

If the water flow is abnormal;

- Check that;
- The tank is well installed.
- The tank gaskets are well assembled.

If dripping occurs;

Check that;

- The tap is well assembled.
- The tap gaskets are well assembled.

**IMPORTANT NOTES:**

- In case of a sudden power loss or disconnecting and reconnecting of the plug to the electrical socket, the compressor protective thermal element will be opened as the pressure of the gas in the cooling system of your refrigerator has not yet been balanced. In 4 or 5 minutes, your refrigerator will start to operate; this is normal.
- If you won't be using your refrigerator for a long time (such as on summer holidays), please disconnect the plug from the socket. Clean your refrigerator as described in Chapter 6 of these instructions and leave the door open to prevent any humidification or odour forming.
- If the problem persists after you have followed all the instructions above, please consult to our authorised service agent.

## Product support

Help is always at hand

## Help and assistance

If you require any technical guidance or find that your Combi Fridge-Freezer is not operating as intended, a simple solution can often be found in the **Troubleshooting** section of these instructions or online at [www.argos-support.co.uk](http://www.argos-support.co.uk)

If you still require further assistance, call one of our experts on **0345 257 7271\***. To help give us give you a fast and efficient service please have the following information ready:

Model Ref.	<input type="text"/>	You can find these on the rating plate - a small information panel (usually a sticker or metal plate) on the rear of your appliance
Serial number	<input type="text"/>	
Date of purchase	<input type="text"/>	This will be shown on your receipt

Local call rates applies\*

Lines open 8am-7pm Monday to Saturday and 10am-4pm Sunday.

\*Calls to Argos enquiry lines may attract a charge and set up fee from residential lines depending on your call plan/tariff . Mobile and other providers costs may vary, see [www.bt.com/pricing](http://www.bt.com/pricing) for details.

For Security and training purposes, telephone calls to and from customer service centres maybe recorded and monitored. Calls from Republic of Ireland will attract international call charges.

## Product support

Help is always at hand

### Disposal

- The symbol on the product or on its packaging indicates that this product may not be treated as household waste. Instead it shall be handed over to the applicable collection point for the recycling of electrical and electronic equipment.
- By ensuring this product is disposed of correctly, you will help prevent potential negative consequences for the environment and human health, which could otherwise be caused by inappropriate waste handling of this product.
- For more detailed information about recycling of this product, please contact your local city office, your household waste disposal service or the shop where you purchased the product.

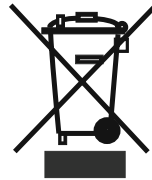

## Product support

Help is always at hand

## Guarantee

# BUSH

Call us now and activate your 12 month guarantee

Thank you for choosing Bush. Your new product is guaranteed against faults and breakdowns for 12 months. Don't forget to register it with us today so we can provide you with our best possible after-sales service and useful updates.

[www.bushregistration.co.uk](http://www.bushregistration.co.uk)

FREEPHONE\*

0800 597 8548

Lines are open 8am - 8pm, 365 days a year. \*Calls may be recorded and monitored.

## Your Bush Guarantee

This product is guaranteed for twelve months from the date of original purchase. Any defect that arises due to faulty materials or workmanship will be repaired free of charge (or if applicable the product will be replaced or the purchase price refunded) where possible during this period by the dealer from who your purchased the unit.

The guarantee is subject to the following provisions:

- The guarantee does not cover accidental damage, misuse, cabinet parts, knobs or consumable items.
- The product must be correctly installed and operated in accordance with the instructions contained in the manual.
- It must be used solely for domestic purposes. The guarantee will be rendered invalid if the product is re-sold or has been damaged by inexpert repair.
- Specifications are subject to change without notice.
- Bush disclaim any liability for loss or damage arising from the breakdown of the product.
- This guarantee is in addition to and does not diminish your statutory or legal rights.

## Important Data Protection Information

If you provide us with information about another person, you confirm that they have appointed you to act for them, to consent to the processing of their personal data including sensitive personal data and that you have informed them of our identity and the purposes (as set out in the Important Data Privacy notice displayed overleaf) for which their personal data will be processed.

You are entitled to ask for a copy of the information we hold about you (for which we may charge a small fee) and to have any inaccuracies in your information corrected.

For quality control and training purposes, we may monitor or record your communications with us.

If your personal details change, if you change your mind about any of your marketing preferences or if you have any queries about how we use your information, please let us know by contacting our Data Protection Officer, Domestic & General, Leicester House 17 Leicester Street, Bedworth, Warwickshire CV12 8JP.

Guarantor: Argos Limited - 489 - 499 Avebury Blvd. - Milton Keynes - MK9 2NW

If you require any technical guidance or find that your product is not operating as intended, a simple solution can often be found in the **Troubleshooting** section of these instructions,



# BUSH

**Contact:**

[www.argos-support.co.uk](http://www.argos-support.co.uk)

Helpline: 0345 257 7271

5219xxxx