

6V Ride On Motorbike

Assembly & User Instructions - Please keep for future reference

483/8797

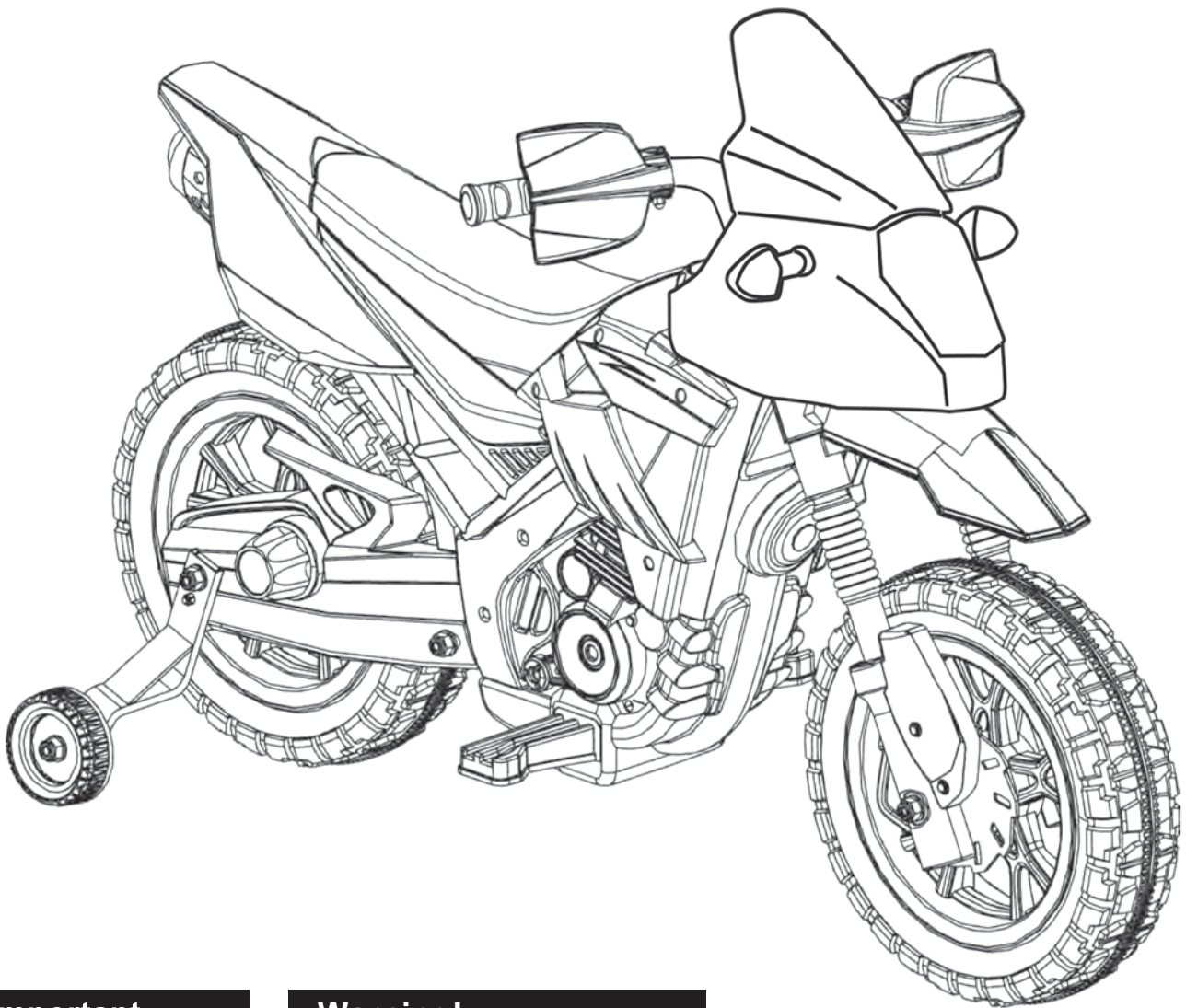

Important

**Age: 3 Years +
Maximum user
weight: 30kg**

Warning!

1. For domestic use only
2. Not to be used in traffic
3. Adult assembly required
4. Protective equipment should be worn

Important – Please read these instructions fully before assembly or use

These instructions contain important information which will help you get the best from your product and ensure safe and correct assembly, use and maintenance.

Table of Contents

	Page
About Your Motorcycle	1
Safety Information	2, 3
Parts	4
Parts Layout	5
Assembly Instructions	6, 7, 8, 9, 10
User Instructions	11
Charging the Battery	12
Trouble Shooting	13
Disposal of Battery	14
Care and Maintenance	15
Contact Information	15

About Your New Motorcycle

Thank you for your purchasing one of our products, we would like your child to enjoy this product for years to come. Keep this point in mind as you read this guide:

Suitable age:	3+ years	Battery:	DC 6V 4 AH x 1
Load Capacity:	Under 30Kg	Size of car:	1100 x 565 x 710 mm
Speed:	3Km/h	Carton size:	800 x 320 x 520 mm
Material:	PP	Optimum Temperature:	Below 40°C
Charger:	Input: shown on the charger	Charging time :	8-12 hours, at most 20 hours
	Output: DC 6V	Fuse:	F5A, Self-resetting
	Current: DC 0.5A	Operating life:	12 to 18 months (Performance may vary.)



Safety Information

Assembly & User Instructions - Please keep for future reference

General safety

- Where products need assembly they must always be assembled by an adult. An adult should review the product prior to use to ensure there are no loose, broken or damaged parts. If the product becomes damaged/ broken stop using immediately.
- Remove protective material and poly bags and dispose of them responsibly before giving the assembled product to your child.
- Remember to retain these instructions for future reference.
- Please contact your retailer for information about end-of-life recycling under the EU WEEE regulations.

Positioning

- Do not allow your child to ride at night or in poor light conditions.
- Do not let your child play near steps, swimming pools / spas or other sources of water, on slopes, on streets or around cars, even if parked on your own property.
- It is prohibited to drive/use this product on the public highway.
- This product is designed to be used on smooth surfaces and should not be used on soft ground or in the rain or snow.

Before use

- Important Information. You must charge and connect the battery before first use. Please refer to 'charging the battery' page 12.

During use

- The toy should be used with caution since skill is required to avoid falls or collisions causing injury to the user or third parties.
- The maximum rider weight capacity for this product is 30Kg do not overload.
- Adult supervision is highly recommended when children play with wheeled toys. Safety is your concern.
- Do not allow the child to ride with bare feet or without suitable footwear.
- Ensure the child keeps clothing, hands, hair, fingers and feet away from moving parts.
- The use of protective gear including approved helmets, gloves and pad is recommended.
- Store this product at room temperature; do not leave it outside.
- Never let any child play with the battery or charger at any time, or let them charge the product.
- Do not use if product is faulty or damaged.
- Do not tamper with the battery or electrical parts inside the product.



Safety Information

Assembly & User Instructions - Please keep for future reference

Charging the 6v battery

- All charging and re-charging must be carried out by an adult.
- Do not attempt to use the product while it is being charged.
- Charging should be carried out under cover and in a well-ventilated area.
- Always ensure the charger is switched off before connecting it to the product/battery.
- Always ensure the charger is plugged into a wall outlet. Do not use an extension.
- Do not charge near sources of potential sparks, fires or flames or where flammable gases, liquids and materials are stored.
- During charging the battery and the charger may get hot.
- Only charge the battery for a maximum time of 8 - 12 hours.
- Do not leave the charger plugged into an outlet or connected to the product/battery once charging is completed.
- Never attempt to recharge a fully charged or partially used battery for an extra boost.
- Do not over-charge; this action will significantly shorten battery life.
- Always ensure that once the battery becomes discharged/flat that you re-charge for the recommended time. Failing to do so will significantly shorten battery life.
- Charging the product below 4oC (40oF) or above 40oC (104oF) will decrease the battery life significantly.
- Only use the charger supplied with the product. The use of other chargers may cause damage to the battery and/or cause explosion.

Charging the 6v battery (contd)

- Battery chargers used with the toy are to be regularly examined for damage to the cord, plug, enclosure and other parts, and in the event of such damage, they must be replaced immediately.
- Only use the battery supplied with this product. The use of other batteries may cause damage to the motor, charger and subsequent wiring, which could lead to fire and/or explosion.
- Exhausted batteries are to be removed from the toy.
- Always ensure that you connect the battery with the correct polarity.
- Never short-circuit the terminals of the battery, or any subsequent wiring.
- Never bypass or bridge a broken/blown fuse or circuit breaker and always replace with the same type/value and model.

Parts

Please check you have all the parts and fittings listed below



1. Vehicle body

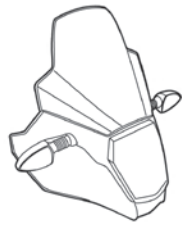

2. Head cover



3. Mudguard



4. Right handle

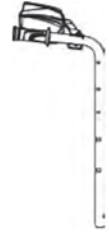

5. Left handle



6. Wheel

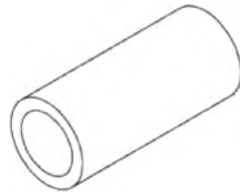

7. Long shaft sleeve
(on front axle)



8. Short shaft sleeve
(on front axle)



9. Front axle
(on vehicle body)

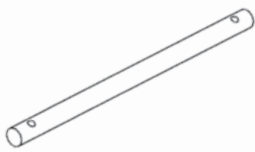

10. Central axis



11. Training wheel (2)

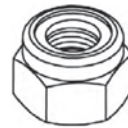

12. M8 Nut (4)
(on front axle)

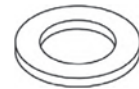

13. M10 Washer (6)
(4 on front axle,
2 on rear axle)



14. M5X30 Bolt (6)
(4 on head cover,
2 on rear axle)



15. M5 Nut (6)
(4 on head cover,
2 on rear axle)



16. Front shockproof
sleeve (2)



17. Back shockproof
sleeve (2)

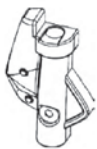

18. Decorative cover (2)

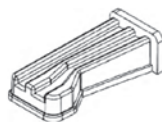

19. Pedal (2)



20. Sound effect box



21. M4X12 screw (6)



22. M4X16 screw (2)



23. M8X122 Bolt



24. M8 Nut



25. Charger



26. Spanner (2)

Assemble together

Parts Layout

Please check you have all the parts and fittings listed below

TOOLS REQUIRED



Screwdriver (not included)



Pliers (not included)



Hammer (not included)

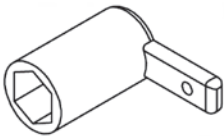

Spanner

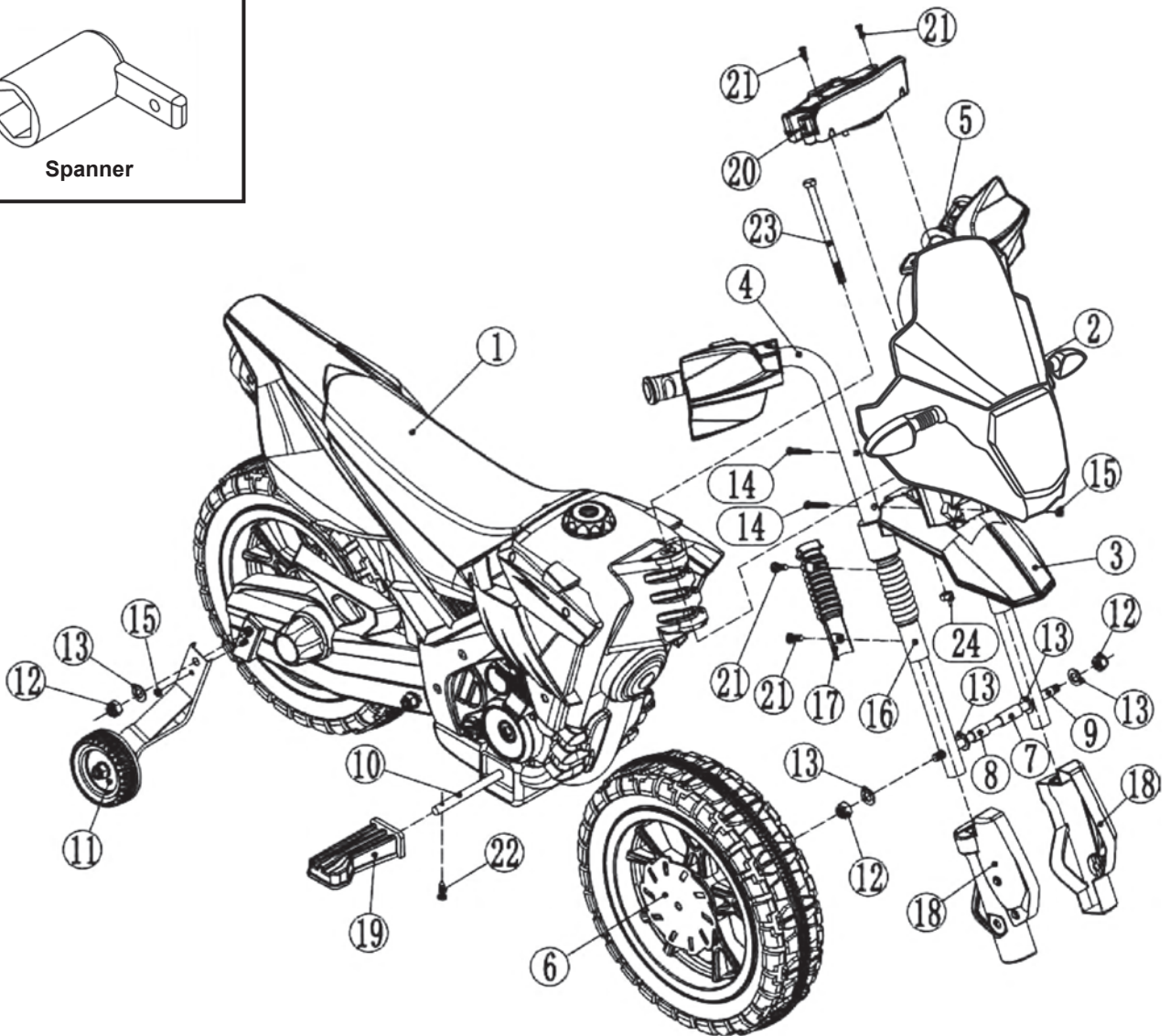

Assembly Instructions

- Your new motorcycle requires adult assembly. Please set aside at least 50 minutes for assembly.
- Please identify all parts before assembly and save all packaging material until assembly is complete to ensure that no parts are discarded.
- Assembly tools required: screwdriver (not included), pliers (not included), hammer (not included) and spanner.

Step 1

Remove nuts (15) and nuts (12) and one washer (13) from the side of the rear axle.

Install the training wheel (11), and then loaded on the washer (13), tighten the nut (12).

Fix another wheel on the other side

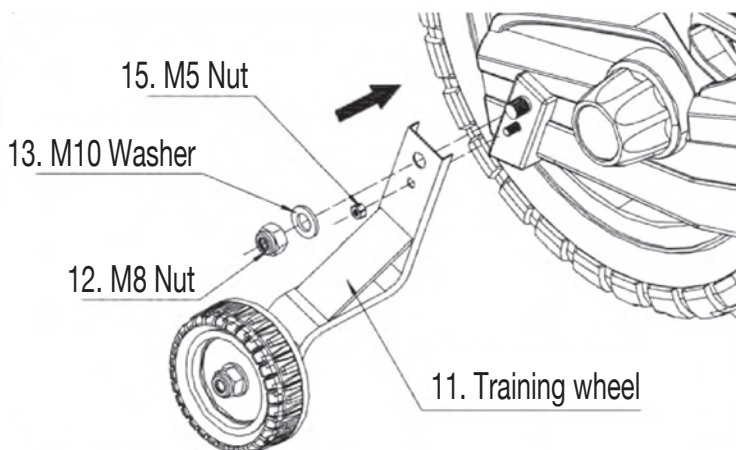

Step 2

As shown in the picture, pass the axel through the body.

Install the pedal (19), and fasten with the screws (22). Repeat this action for both pedals.

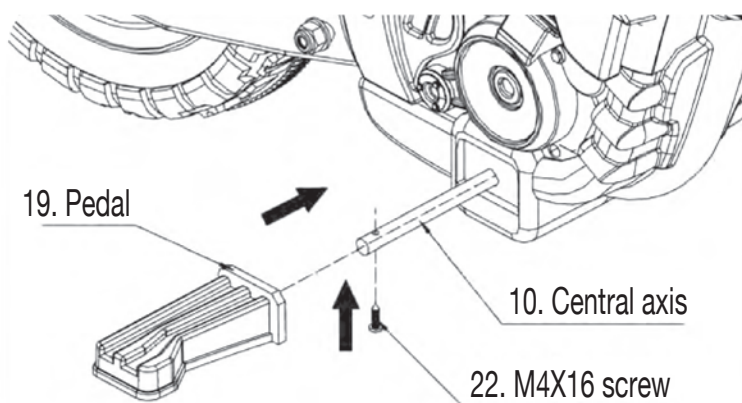

Assembly Instructions

Step 3

Insert the left hand (5) and the right handle (4) in to the mudguard (3) as show in the image.

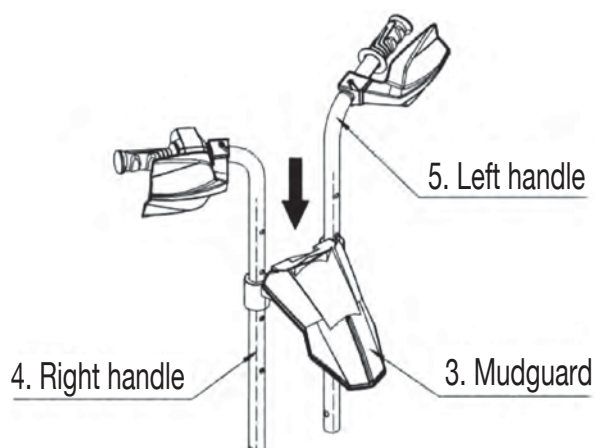

Step 4

As shown in the picture, install the front (16) and back shockproof sleeves (17) and then fasten together with the screws (21) as shown.

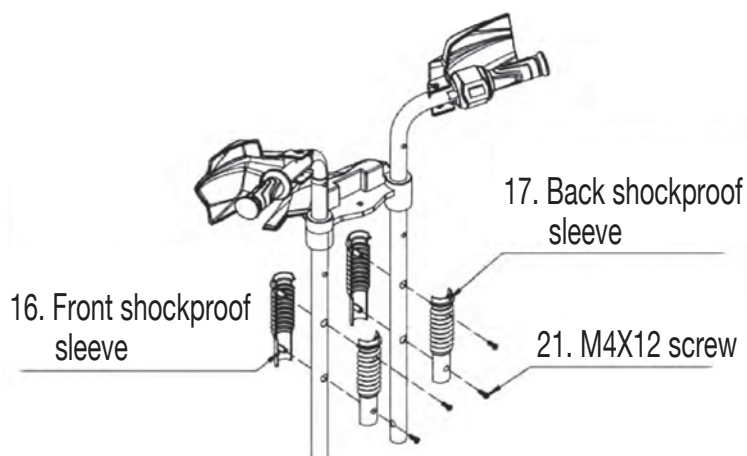

Step 5

Remove the bolt from the head cover (2).

Install the head cover (2) to the corresponding place, and fasten with the bolts (14).

Put the wire plug through the threadingholes.

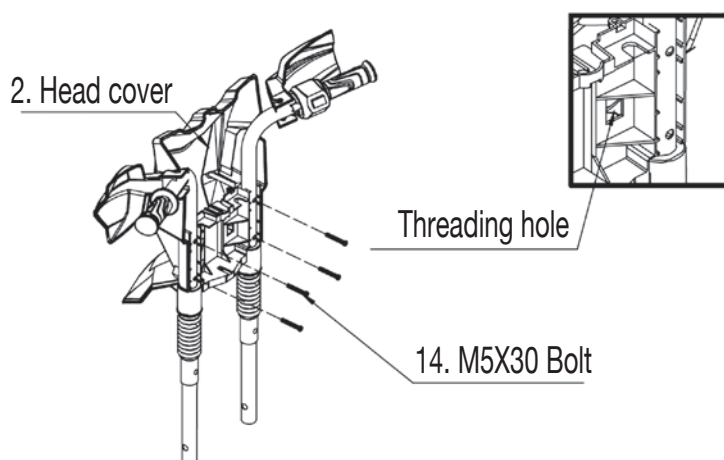

Assembly Instructions

Step 6

Install the decorative cover (18) as shown.

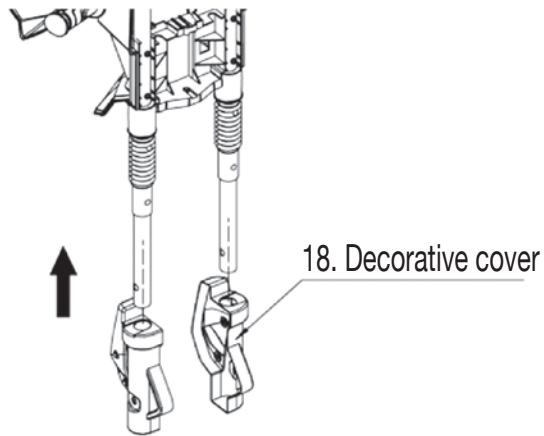

Step 7

Disconnect the front axle parts.

Assemble the wheel (6) and handle bars (5) as shown.

Ensure the position of the washers (13) and shaft sleeve (7,8) follow the illustration.

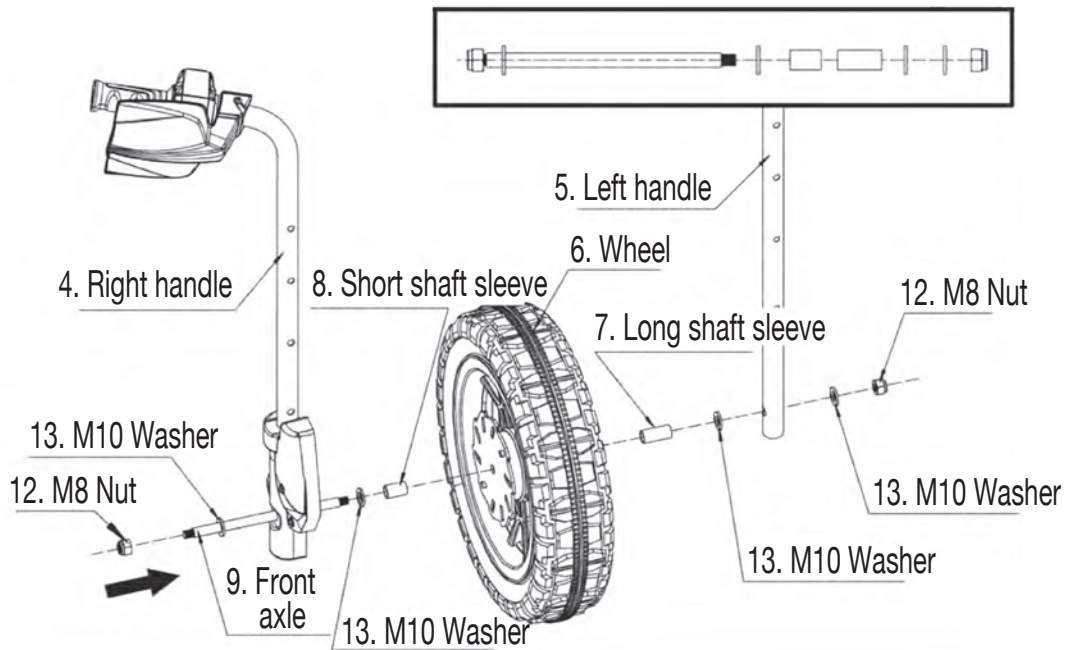

Assembly Instructions

Step 8

Put the bolt through the headstock, as shown in the image, and tighten the nut (12).

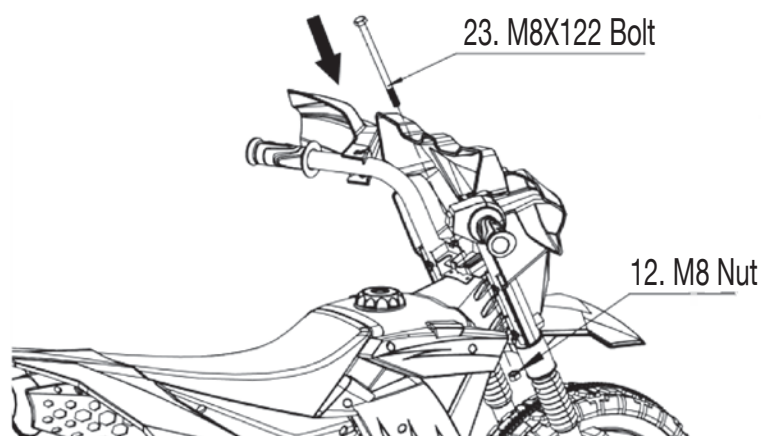

Step 9

Plug the wire connector into the motor connector.

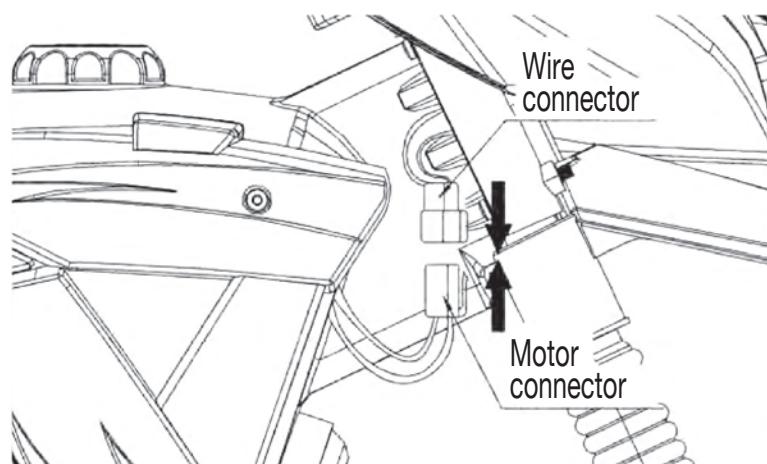

Step 10

Install the sound effect box (20) to the corresponding connection point. Secure in place with the screws (21), as shown.

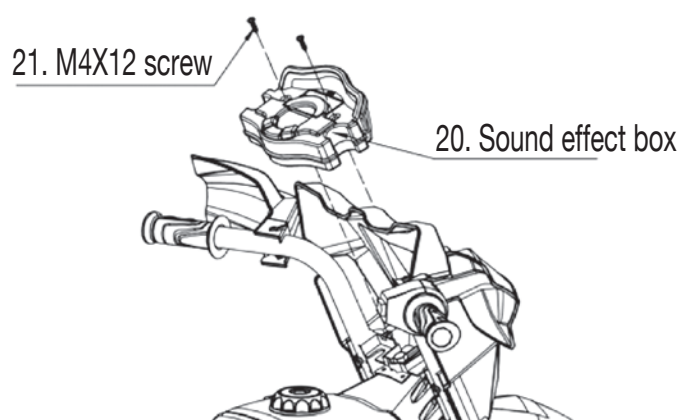

Assembly Instructions

Step 11

Install the Batteries into sound effect box.

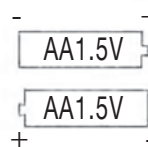
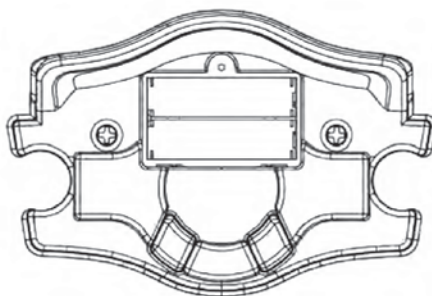

IMPORTANT SUPPLEMENT TO INSTRUCTION MANUAL

If wheels do not run smoothly additional washers can be added to the axel either side of the wheel.

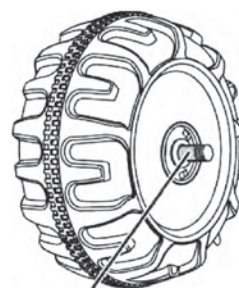

activate

GAP

User Instructions

Using

How To Operate Your Motorcycle

IMPORTANT!

Always stop vehicle when changing the speed or direction to avoid damage to the gear box and motor.

- (1) Press the "Forward Button", to move the vehicle forwards.
- (2) Release "Forward Button", to move the vehicle stops.
- (3) Press one of the buttons on the sounds box to activate sounds

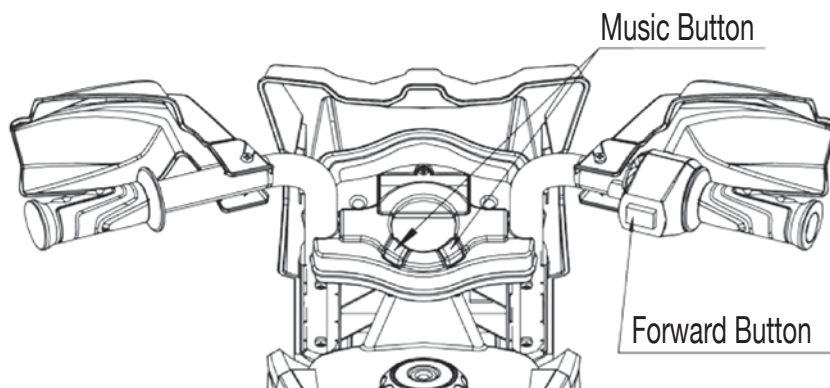

Troubleshooting

PROBLEM: The vehicle does not ren

PROBLEMCAUSE: The battery may low on power.

After each use, or once a month minimum, charge the battery for 8-12 hours. Do not leave the battery on the charger for more than 20 hours.

POSSIBLE CAUSE: Thermal fuse has tripped.

The Vehicle is equipped with a self-resetting fuse. When the Vehicle is overloaded or operated incorrectly; the self-resetting fuse will be cut off for 5-20seconds before becoming operational again.

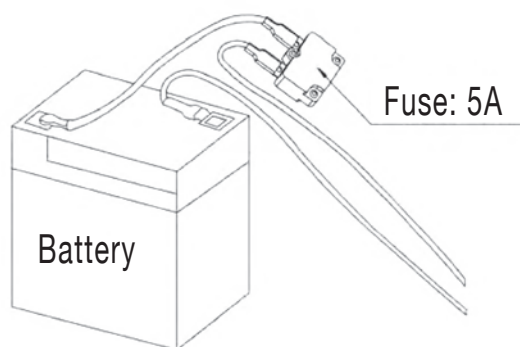

To avoid the fuse cut off the power, follow these guidelines:

DO NOT overload the vehicle, Maximum Weight allowed:30kg

DO NOT tow anything behind the vehicle.

DO NOT drive up steep slopes.

DO NOT drive into fixed objects, which may cause the wheels to spin, causing the motor to overheat.

DO NOT drive in very hot weather, components may overheat.

DO NOT tamper with the electric system, Doing so may create a short circuit, causing the fuse to trip.

POSSIBLE CAUSE: Wheel nuts are loo

If the nuts are not tight, the wheels will not engage the forward gears. Tighten the nut with the nut wrench.

POSSIBLE CAUSE: Battery connector or wires are loose.

Make Sure the battery connectors are firmly plugged in to each other.

POSSIBLE CAUSE: Battery is dead.

Have you properly maintained the battery according to the directions? Is the battery old? Your battery may need to be replaced.

POSSIBLE CAUSE: Electric system is damaged.

Water may have corroded the system, or loose dirt, gravel or sand might have jammed the switch.

POSSIBLE CAUSE: Motor is damaged.

The motor needs professional repair.

■ **PROBLEM:** The battery will not recharge.

POSSIBLE CAUSE: Battery connector or adapter connector is loose.

Make sure the battery connector and adapter connector are firmly plugged together.

POSSIBLE CAUSE: Charger is not plugged in.

Make sure the charger is plugged into the wall outlet and the power flow to the outlet is on.

POSSIBLE CAUSE: Charger is not Working.

Is the charger warm while charging? If not, the charger may be broken and may need to be replaced.

■ **PROBLEM:** The vehicle does not run very long

POSSIBLE CAUSE: Battery may be undercharged.

You may not be charging the battery long enough. After each use, or once a month minimum, charge the battery for 8 to 12 hours. Do not leave the battery on the charger for more than 20 hours.

POSSIBLE CAUSE: Battery is old.

The battery will eventually lose the ability to hold a charge. Depending on the amount of use, and varying conditions, the battery should operate for one to three years.

■ **PROBLEM** Battery buzzes or gurgles when charging.

This is normal and not a cause for concern. It may also be silent when charging, which is also normal.

■ **PROBLEM:** Charger feels warm when recharging battery.

This is normal and not a cause for concern.

Charging the 6v battery

WARNING!

Prevent fire and electric shock:

- Use the only rechargeable battery and charger supplied with your vehicle. NEVER substitute the battery or the charger with another brand. Using another battery or charger may cause a fire or explosion.
- Do not use the battery or charger for any other product. Overheating, fire or explosion could occur.
- NEVER modify the electric circuit system. Tampering with the electric system may cause a shock, fire or explosion or may permanently damage the system.
- Do not allow direct contact between battery terminals. Fire or explosion can occur.
- Do not allow any type of liquid on the battery or its components.
- Explosive gasses are created during charging. Do not charge near heat of flammable materials. Charge the battery in a well-ventilated area ONLY.
- NEVER pick up the battery by the wires or charger. Damage can occur to the battery and may cause a fire. Pick up the battery by the case ONLY.
- Charge the battery in a dry area ONLY.
- Battery posts, terminals and related accessories contain lead and lead compounds, chemicals known to the State of California to cause cancer and reproductive harm. Wash hands after handling.
- Do not open the battery. Battery contains lead acid and other materials that are toxic and corrosive.

Prevent fire and electric shock:

- Do not open the charger. Exposed circuitry inside case may cause electric shock. Only adults may handle or charge the battery. NEVER allow child to handle or charge the battery. Battery is heavy and contains lead acid (electrolyte).
- Do not drop the battery. Permanent damage to the battery could occur or cause serious injury.
- Before charging the battery, check for wear or damage to the battery, charger, its supply cord and the connectors. DO NOT charge the battery if any damage to parts has occurred.
- Do not allow the battery to drain completely. Recharge the battery after each use or once a month if not used regularly.
- Do not charge battery upside down.
- Always secure the battery with the bracket. Battery can fall out and injure a child if vehicle tips over.
- A recommendation for adult supervision of young children.
- The toy should be used with caution since skill is required to avoid falls or collisions causing injury to the user or third parties.
- The charging input socket is BLOW THE SEAT.
- Before the first use, you should charge the battery for 8-12 hours. Do not recharge the battery for more than 20 hours to avoid overheating the charger.
- When the vehicle begins to run slowly, recharge the battery.
- After each use or once a month minimum recharge time as 8 to 12 hours, no more than 20 hours.

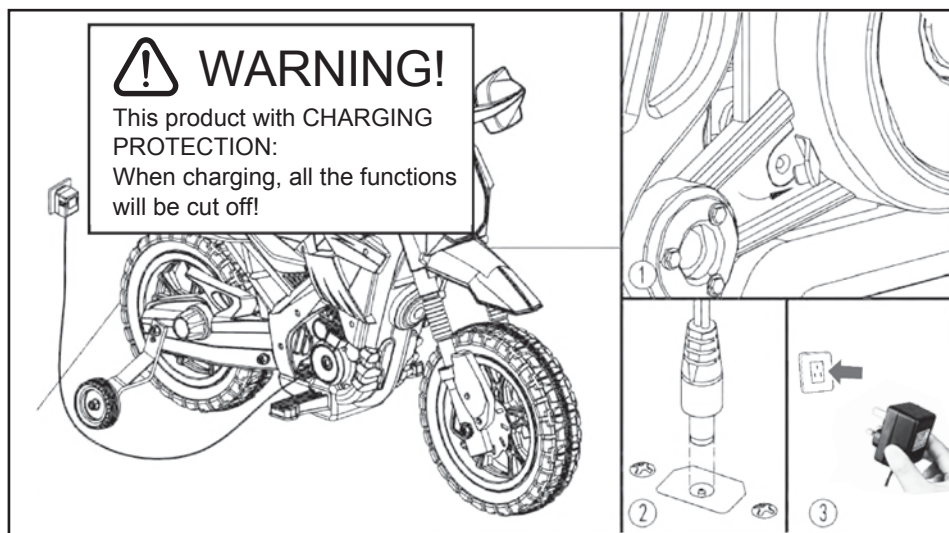

1. Find The charging input socket below the seat;
2. Plug the charger port into the input socket;
3. Plug the charger plug into a wall outlet. The battery will begin charging.

Care and Maintenance

General

- Make sure the plastic parts of the vehicle are not cracked or broken.
- Occasionally use a lightWeight oil to lubricate moving parts Such as Wheels.
- Park the vehicle indoors or cover it with a tarp to protect it from Wet Weather.
- Keep the vehicle away from Sources of heat, such as stoves and heaters. Plastic parts may melt.
- Recharge the battery after each use. Only an adult can handle the battery. Recharge the battery at least once a month when the vehicle Raider is not being used.
- Do not wash the vehicle with a hose. Do not Wash the vehicle with soap and Water. Do not drive the vehicle in rainy or snowy weather. Water will damage the motor, electric system and battery.
- Clean the vehicle with a soft, dry cloth. To restore shine to plastic parts, use a non-Wax furniture polish. Do not use car wax. DO not use abrasive cleaners.
- Do not drive the vehicle in loose dirt, sand or fine gravel which could damage moving parts, motors or the electric system.
- When not using, all the electrical source should be turn off. Turn of the power switch and disconnect the battery

Battery Information

Loosen the battery cover of the sound effect box and remove the cover. Insert two AA 1.5V Batteries (see above photo). Replace battery cover.

- Non-rechargeable batteries are not to be recharged.
- Different types of batteries or new and used batteries are not to be mixed.
- Batteries are to be inserted with the correct polarity.
- Exhausted batteries are to be removed from the toy.
- The supple terminals are not to be short –circuited.
- Rechargeable batteries are only to be charged under adult supervision.
- Rechargeable batteries are to be removed from the toy before being charged.
- Only batteries of the same of equivalent type as recommended are to be used. Do not dispose of batteries in fire; batteries may leak or explode Batteries should be replaced by an adult
- The transformers or battery charger used with the toy are to be regularly examined for damage to the cord, plug, enclosure and other parts, and in the event of such damage, they must not be used until that damage has been repaired.



Disposal and Recycling

Electrical product waste should not be discarded with household waste. Please actively support us in conserving resources and protecting the environment by returning the non-working electrical products to an appropriate disposable/ recycling centre (if available).

Moving the Bike

Care should be taken when moving the bike. Do Not Lift using rear tool box / carrier. Do not attempt to push the bike at any time it is designed to only move under it's own power.



If you need help or have damaged or missing parts, call the **Customer Helpline: +44(0)1253775570**
Produced for Chad Valley Toys. *Country of origin:* Made in China
Address: 489 - 499 Avebury Boulevard, Central Milton Keynes, MK9 2NW.
www.argos.co.uk/chadvalley