

TC Marston White Shake XL Blanket Box

Assembly Instructions – Please keep for future reference

620/9465

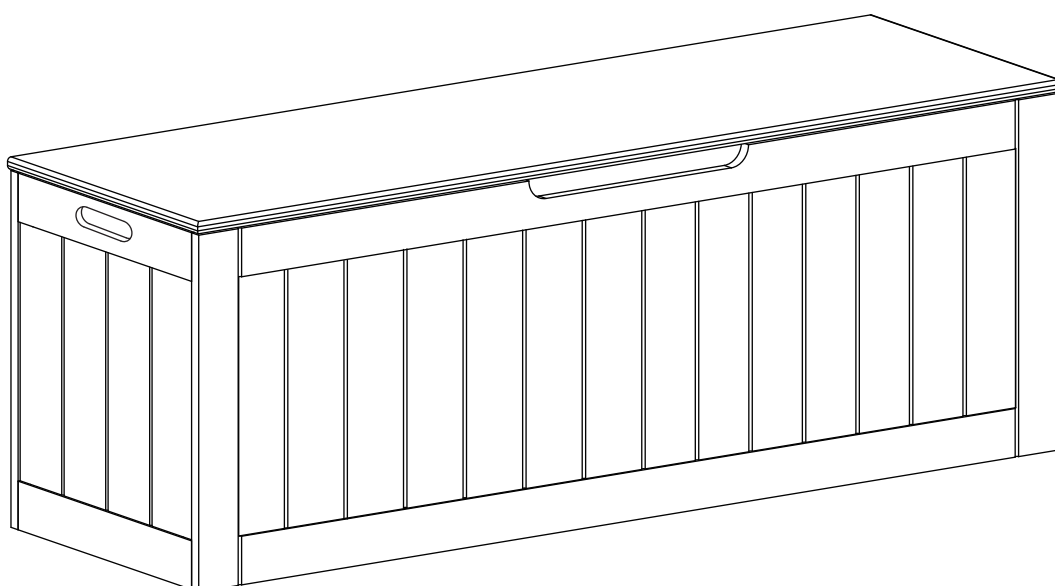

Dimensions

Width - 120cm

Depth - 40cm

Height - 45cm

Important - Please read these instructions fully before starting assembly

If you need help or have damaged or missing parts, call the Customer Helpline: 03456 400800



Safety and care advice

Important - Please read these instructions fully before starting assembly

- Read all instructions before assembling unit. **DO NOT USE THIS UNIT IF THE INSTRUCTIONS CANNOT BE STRICTLY FOLLOWED.**

WARNING -

Failure to follow these warnings and assembly instructions could result in serious injury or death.

- Check you have all the components and tools listed on pages 2 and 3.
- Remove all fittings from the plastic bags and separate them into their groups.
- Keep children and animals away from the work area, small parts could choke if swallowed.
- Make sure you have enough space to layout the parts before starting.
- Do not stand or put weight on the panels, this could cause damage.
- Assemble the unit as close to its final position (in the same room) as possible.

- Assemble on a soft level surface to avoid damaging the unit or your floor.

• **Note:** Only apply the glue once you are sure of the assembly.

- The wall plugs supplied are suitable for solid walls only. It is important that the correct type of fixing is used for your wall, seek professional advice if in doubt.

- Parts of the assembly will be easier with 2 people.

- If using power tools, please follow the safety instructions supplied with the tools.



- We do not recommend the use of power drill/ drivers for inserting screws, as this could damage

the unit. Only use hand screwdrivers.

- **Warning:** Before drilling, check the wall for hidden pipes and cables.

- Dispose of all packaging carefully and responsibly.

Glue safety - Take care when using glue, please follow the advice below

Skin contact: Remove contamination by washing with soap and water. This procedure should also be followed prior to eating and drinking.

Eye contact: Rinse immediately with clean water for 15 minutes and seek medical advice.

If swallowed: Seek medical advice immediately. If possible show product information or label to the medical advisor.

Care and maintenance

- Only clean using a damp cloth and mild detergent, do not use bleach or abrasive cleaners.

- From time to time check that there are no loose screws on this unit.

- This product should not be discarded with household waste. Take to your local authority waste disposal centre.

Note: if required the next page can be cut out and used as a reference throughout the assembly. Keep this page with these instructions for future reference.

Components - Panels

If you have damaged or missing components, call the Customer Helpline: 03456 400800

Please check you have all the panels listed below

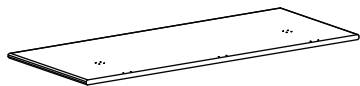

1 Top panel x 1

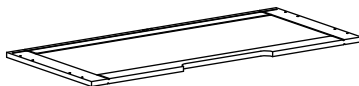

2 Front panel x 1



3 Back panel x 1

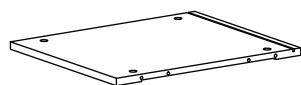

4 Side panel x 2



5 Bottom panel x 1



6 Bottom rail x 1

Components - Fittings

Please check you have all the fittings listed below

Note: The quantities below are the correct amount to complete the assembly. In some cases more fittings may be supplied than are required.



Locking pin x 10



Locking nut x 10



Wooden dowel x 12

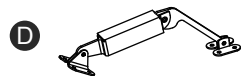

Spring hinge x 2

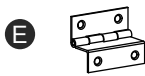

Hinge x 3



12mm Screw x 28

Tools required



Phillips screwdriver
(medium & large)



Straight screwdriver
(medium & large)

Ruler - Use this ruler to help correctly identify the screws

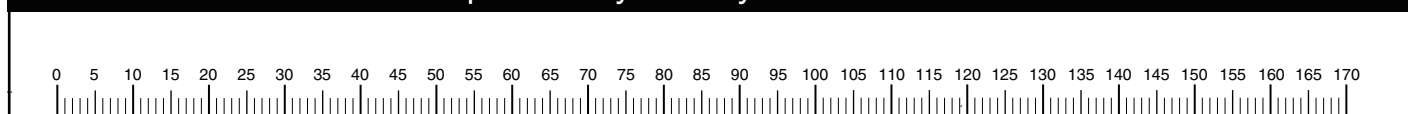

Assembly Instructions

Step 1

Assembling front panel and back panel

Screw locking pin **A** into front panel **2** and back panel **3** as shown

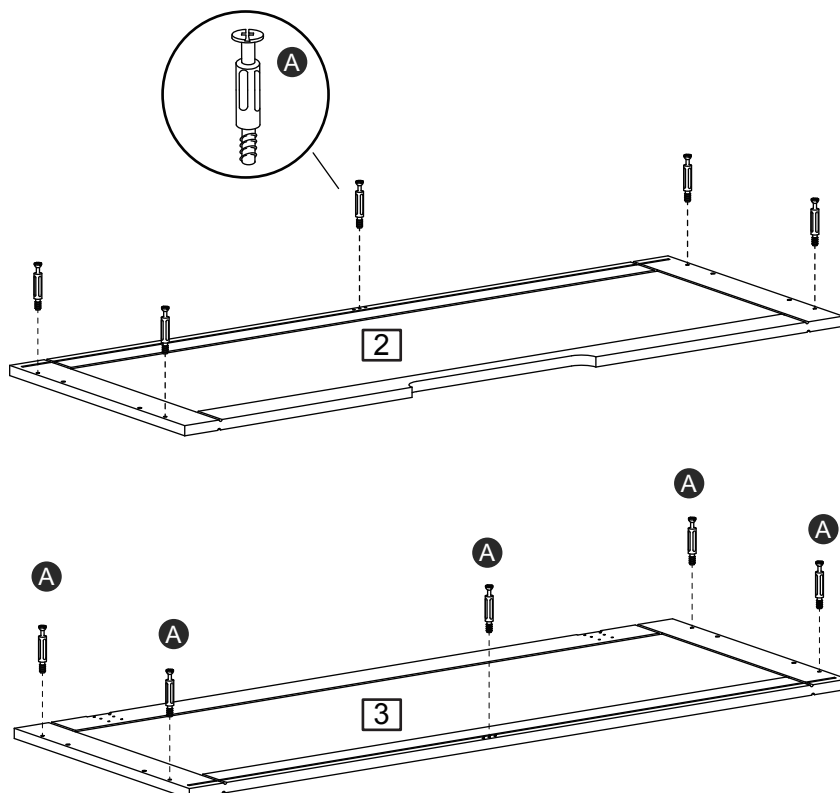

Step 2

Assembling side panel

a:
Insert wooden dowel **C** into front panel and bottom rail **6** as shown.

Attach side panels **4** and bottom rail **6** to front panel **2**.

Insert locking nut **B** into side panel and bottom rail as shown and tighten it with a screwdriver.

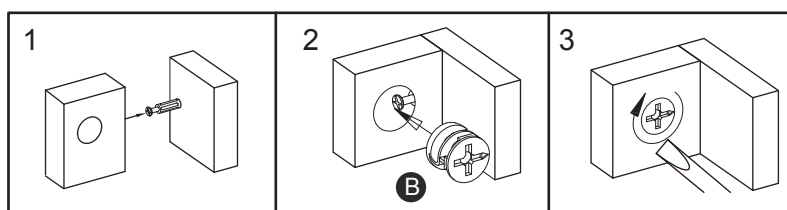
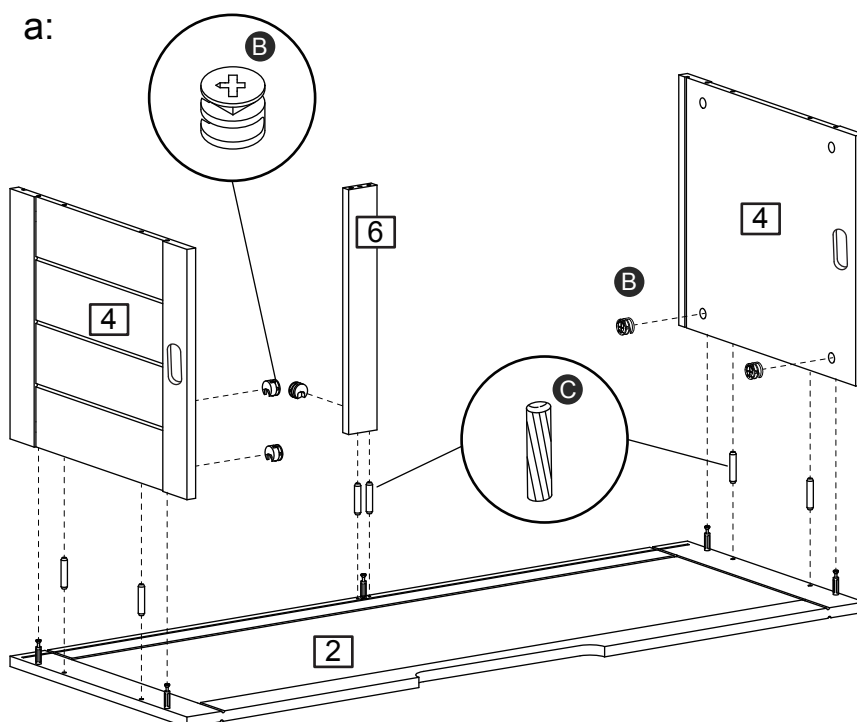

Continued on next page

Assembly Instructions

Step 2 - continued

Assembling side panel

b:
Slide down bottom panel **5** along grooves in side panel and front panel.

Repeat above steps to assemble back panel **3** as shown.

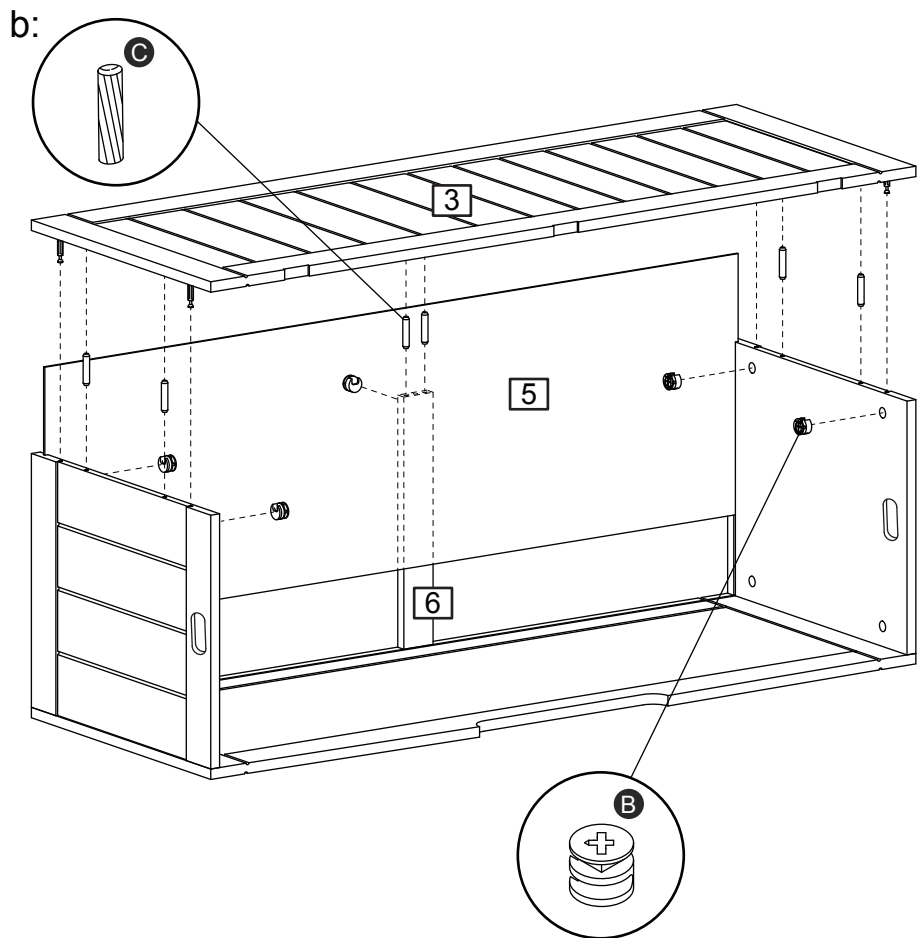

Step 3

Assembling side panel

NOTE: It would be useful to ask someone to help you at this stage.

a:
Fix hinges **E** to top panel using 6 x screw **F** as shown.

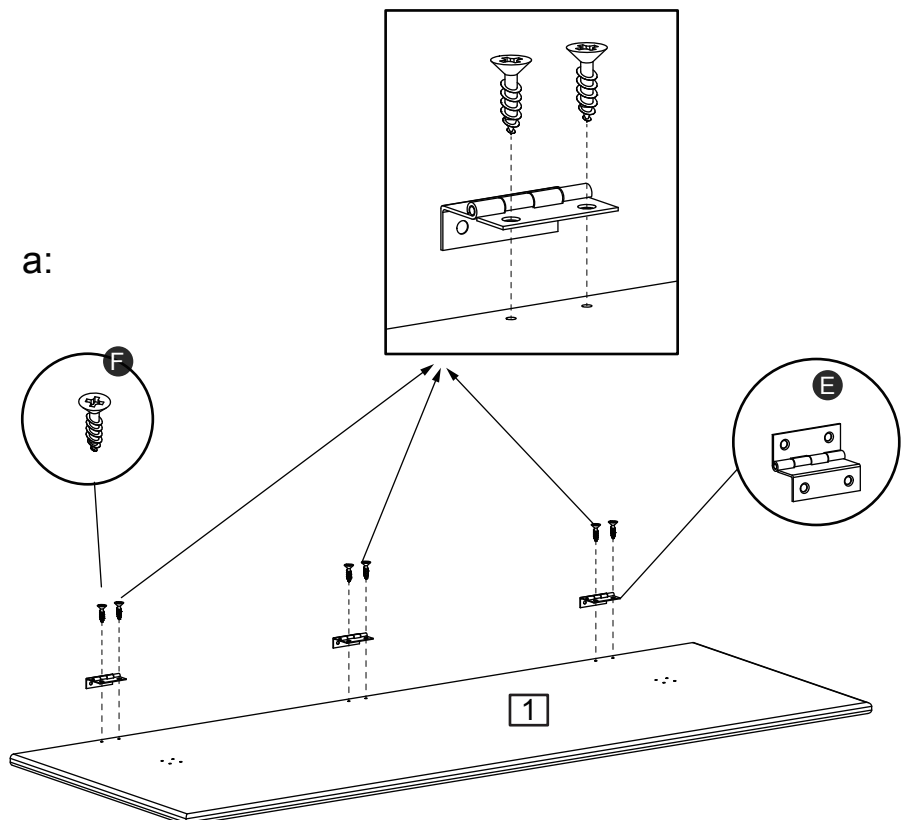

Continued on next page

Assembly Instructions

Step 3 - continued

Assembling side panel

NOTE: It would be useful to ask someone to help you at this stage.

b:
Attach top panel **1** onto the unit with hinge **E** and screw **F** as shown.

b:

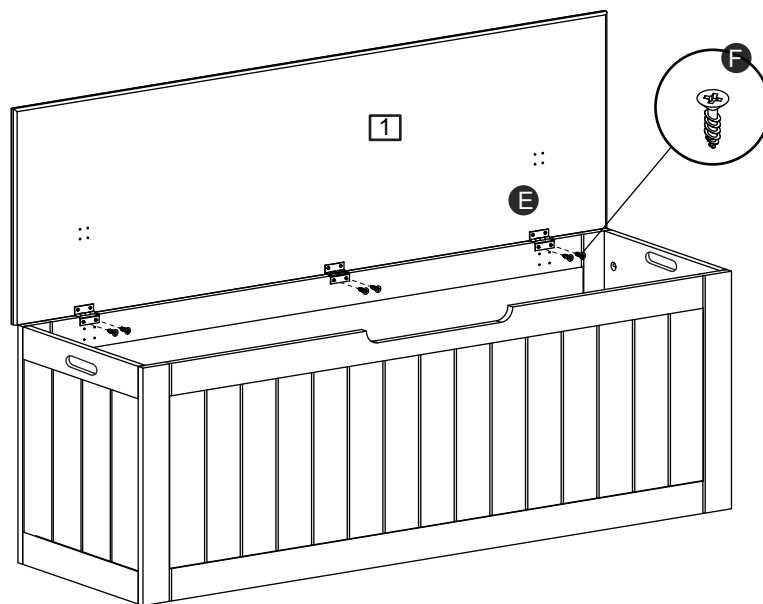

c:
Fix spring hinge **D** to top panel **1** and back panel **3** using 16 x screw **F** as shown.

c:

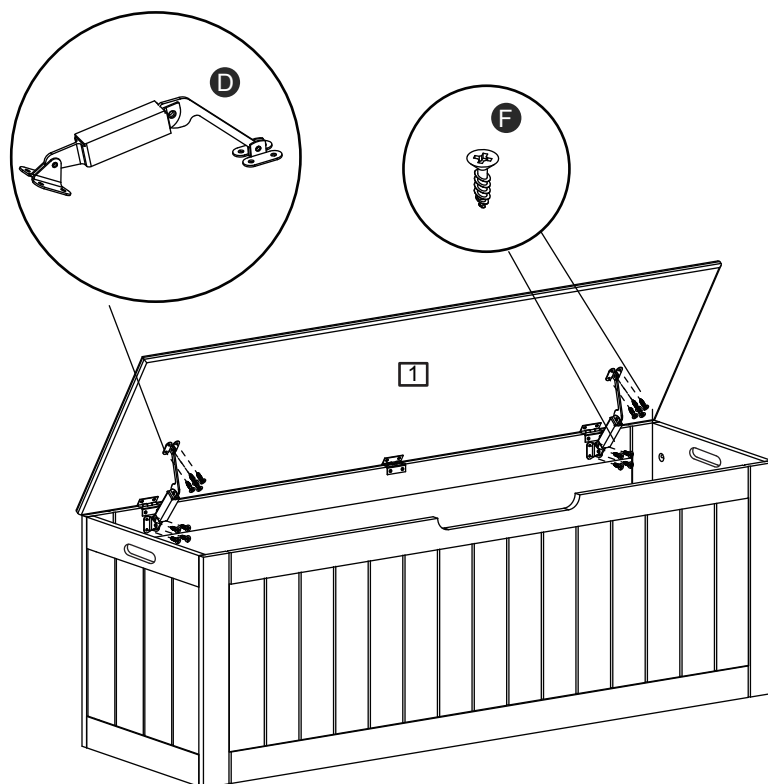

After above assembly, please double check and make sure all screws are firmly fixed before use.

NOTE: If you have damaged or missing components, call the Customer Helpline: 03456 400800
Argos LTD, 489-499 Avebury Boulevard,
Central Milton Keynes, MK9 2NW