

25/28mm metal curtain pole

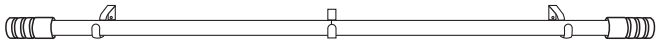

Your Product

Picture	Fitting parts	Up to 1.1m	1.1m to 2m	2m to 3m
A	25mm pole	1	1	2
B	28mm pole	0	1	1
C	Bracket	2	3	3
D	Finial	2	2	2
E	28mm Plastic insert	0	1	2
F	Wall plug	4	6	6
G1	Screw	4	6	6
G2	Allen Key	1	1	1
H1	Allen Screw	2	2	2

You will need

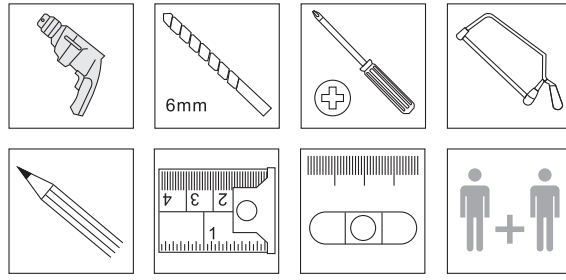

1

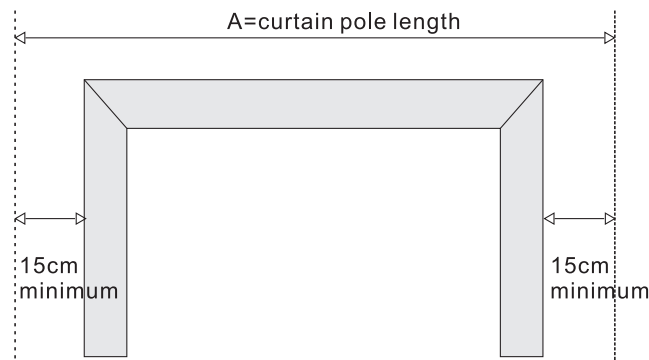

For larger windows and thicker curtains, this dimension can be increased so the curtains don't obstruct the windows when open.

2 Choose the pole and accessories according to the window size.

(1) Up to 1.1m: Use pole A only, this can also be cut to a smaller size if required.

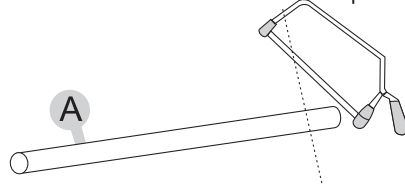

(2) Window from 1.1m to 2m

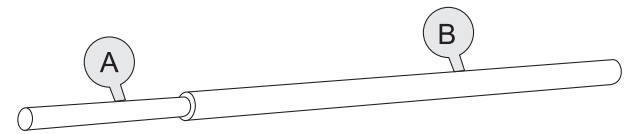

a. Remove one plastic insert from pole B

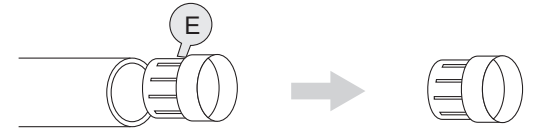

(3) Window from 2m to 3m

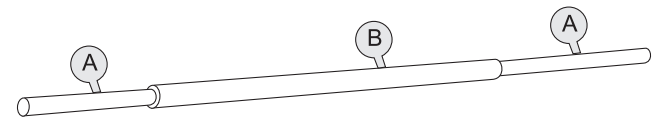

Note: Actual finials may differ from illustration. Wall plugs & screws provided are suitable for solid walls only. For any other type of wall or ceiling ensure correct wall plugs & screws are used. If in doubt, seek professional advice.

IMPORTANT: RETAIN THIS INFORMATION FOR FUTURE REFERENCE. READ CAREFULLY BEFORE ADJUSTING, INSTALLING AND USING THE PRODUCT.

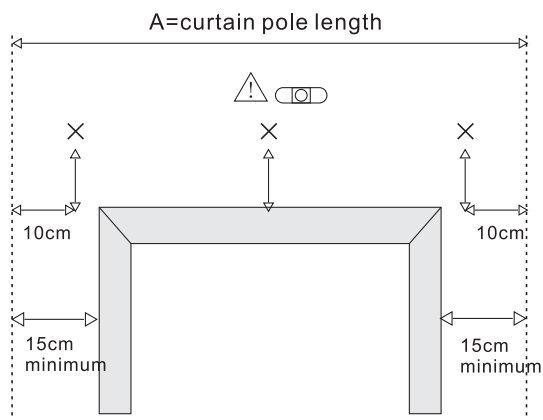
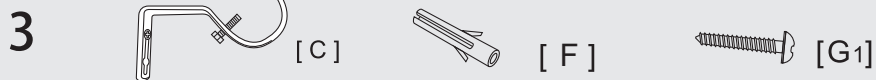

The end brackets must be positioned 10cm in from the end of the pole. If a centre bracket is required, please position this in the centre between the two end brackets. Mark the position on the wall ensuring they are level.

	up to 1.1m	1.1m to 2m	2m to 3m
	2	3	3

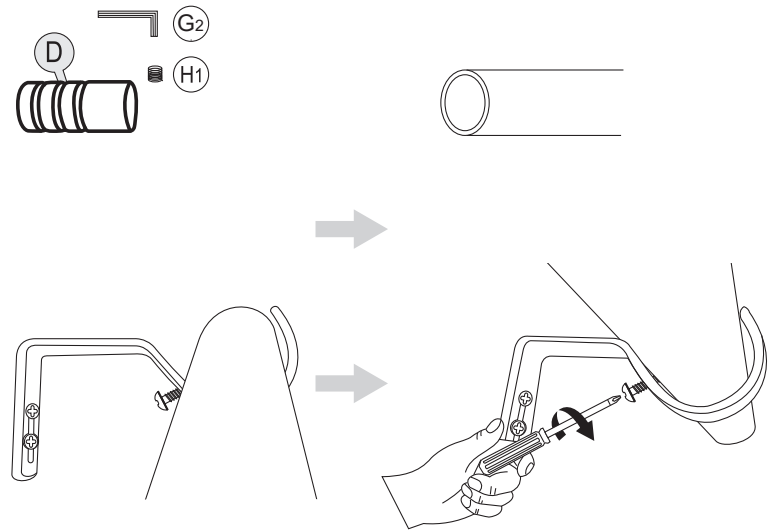
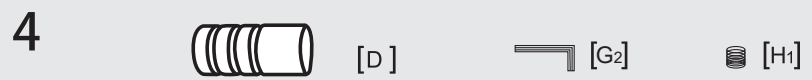
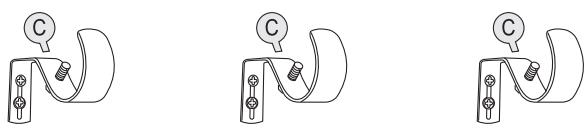
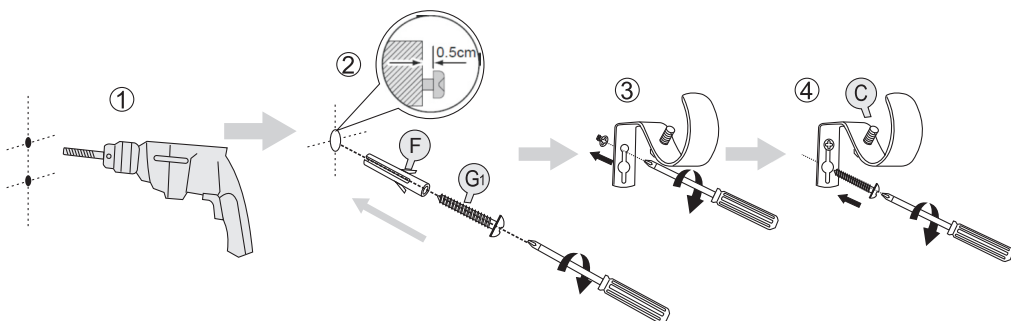

Tighten the bracket screw

Note: Bracket screws to secure the poles are pre-fitted to the brackets, the curtain poles must be secured with the bracket screws.

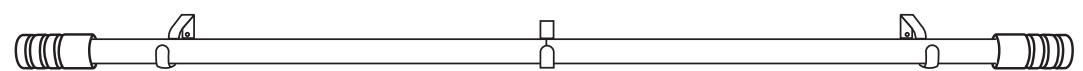

The pole is now ready to accept curtains by slipping hooks through the eyelets

After assembly, wipe the pole with a dry cloth to remove any fingerprints. To maintain the smooth performance of your pole, periodically wipe the pole with furniture polish.

Please note that specifications of fittings may vary from those illustrated. Retain for future reference. Periodically check and re-tighten fixings.

A Guide to

Wall Mounting & Fixings

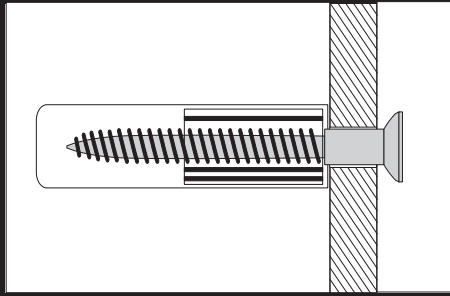

IMPORTANT:

When drilling into walls always check that there are no hidden wires or pipes etc. Make sure that the screws and wall plugs being used are suitable for supporting your unit. Consult a qualified tradesperson if you are unsure.

HINTS:

- 1) General Rule  Always use a larger screw and wall plug if you are not sure.
- 2) Ensure you use the recommended drill bit to match the wall plug and hole size.
- 3) Ensure you drill the hole horizontally, do not force the drill or enlarge the hole.
- 4) Take extra care when drilling high walls, ceilings and ceramic tiles. Ensure the plug is fitting below the ceramic tile to avoid splitting or cracking.
- 5) Ensure wall plugs are well fitted and are a tight fit in the drilled hole.

Types Of Walls

You can use one of the following types of wall plug if your walls are made of brick, breeze block, concrete, stone, wood or plaster board.

No.1 "Standard" Wall Plug General Wall Materials

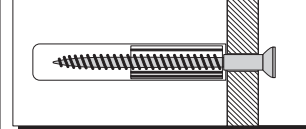

These come in various sizes and are made from plastic or sometimes wood fiber.

No.2 "General Purpose" Wall Plug Aerated / Breeze Block

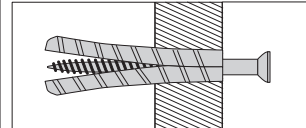

Generally aerated blocks should not be used to support heavy loads, use a specialist fitting in this case.

For light loads, a General Purpose Plug can be used.

No.3 "Shield Anchor" Wall Plug Heavy Loads

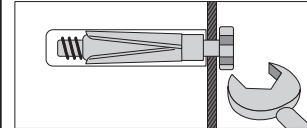

For use with heavier loads such as TV & HiFi Speakers and Satellite Dishes etc.

No.4 "Cavity Fixing" Wall Plug

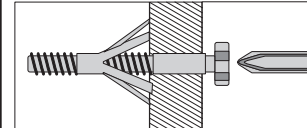

For use with plaster board partitions or hollow wooden doors.

No.5 "Cavity Fixing - Heavy Duty" Wall Plug

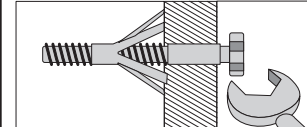

For use when fitting or supporting heavy loads such as shelving, wall cabinets, coat racks.

No.6 "Hammer Fixing" Wall Plug

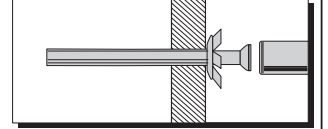

For use with walls stuck with plaster board. The hammer fixing allows it to be fixed to the wall rather than the plaster board. Always check the fixing is secure to the retaining wall.

CARE & MAINTENANCE

SAFETY

Always check the fitting and location to ensure your safety in and around the home.

FITTING

From time to time check the fitting to ensure the wall plugs or screws do not become loose.