

Sparkling Fabric Shade

Assembly Instructions - Please keep for future reference

455/9502

464/5052

457/9317

616/5406

H O
M E
BY ARGOS

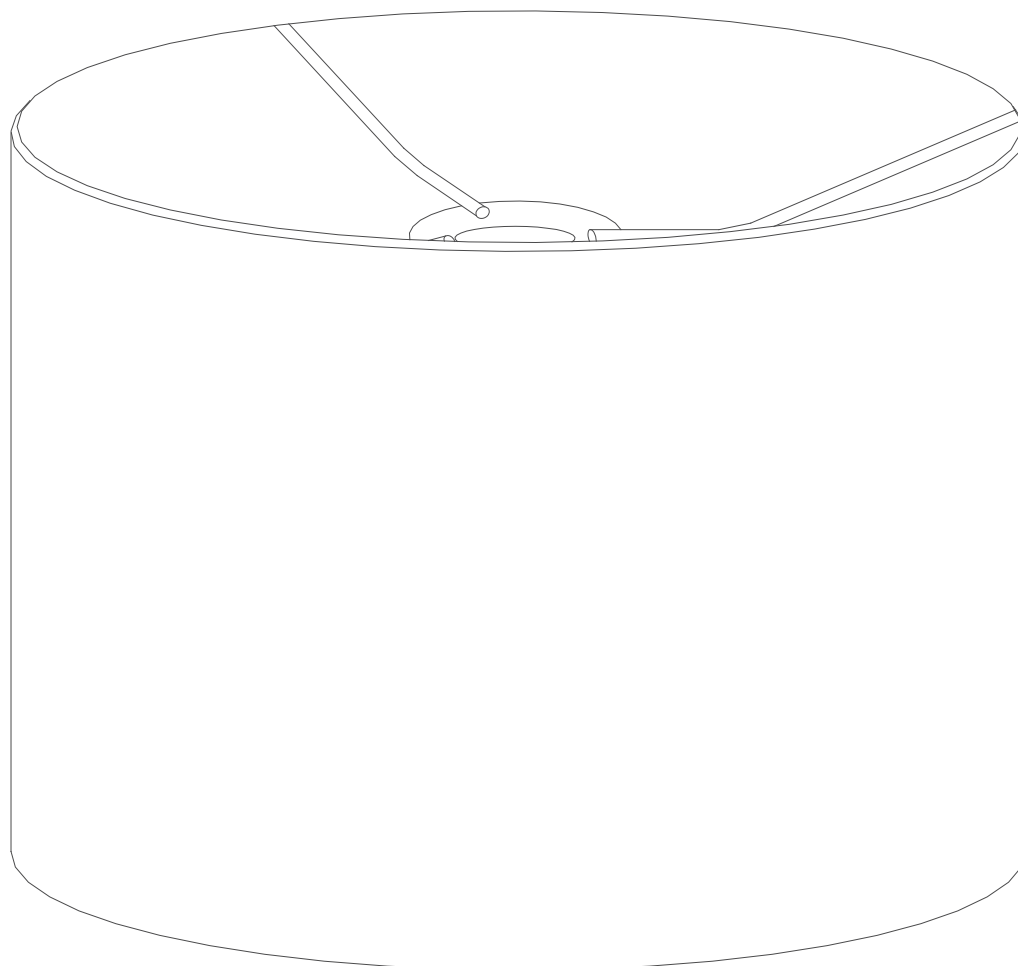

Important - Please read these instructions fully before starting assembly

If you need help or have damaged or missing parts, call the
Customer Helpline: 0345 6400800

Important

- Read these instructions carefully and familiarize yourself with the procedure before assembling the unit.
- Take all the components and fittings out of the plastic bag and separate them into their groups.
- Ensure you have enough space to lay out all the parts before assembly.
- Always be sure to use the correct type and wattage of bulbs as indicated on the fitting. Never exceed the wattage stated.
- To avoid scratching it is recommended that you assemble the unit on a soft level surface.
- When changing the bulb, always switch off at the mains and allow the old bulb to cool down before handling. Dispose of used bulbs carefully.
- The luminaire is designed for indoor use only.



Instructions for use

Installation

1. The shade is designed for ES fitting, for smaller BC fitting, slot the "C" shaped lamp shade reducer ring into the centre hole of the lamp shade.
2. Remove the lower section of the household lamp holder.
3. Place the lamp holder inside the centre of the shade and replace the lower section of the lamp holder.
4. Insert bulb (Max. 60W bulb or energy saving 12W, not included) into the lamp holder ensuring that you do not exceed the maximum wattage stated on the lamp holder.

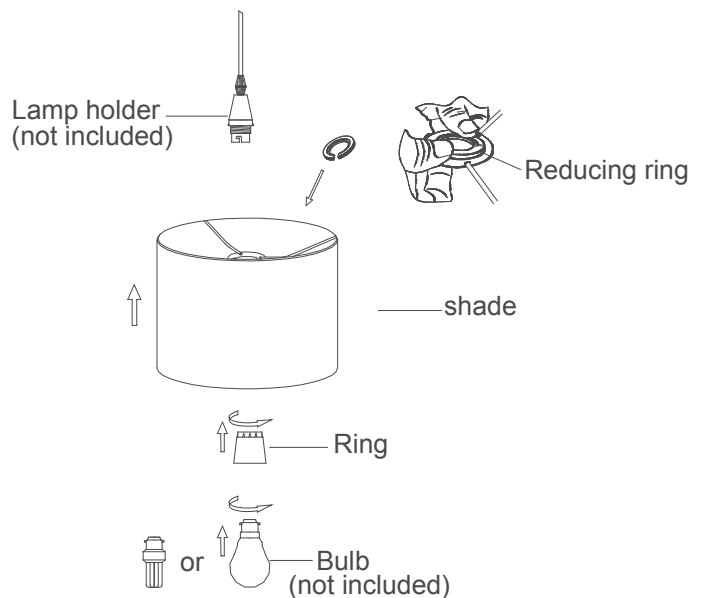

Maintenance

This fitting is designed for indoor use only and must be fitted to a DRY SURFACE as any dampness in plaster or paint can damage the finish. Do not use polish or abrasive cleaner - just a soft dry cloth.

BULB REPLACEMENT

1. Switch off the mains power supply.
2. Before replacing the bulb, allow it to cool down for at least 10 minutes.
3. Never touch the bulb with your fingers directly, cover it with a cloth.
4. Loosen the bulb and remove it from the lamp.
5. Replace a new bulb with same voltage and wattage (Max. 60W).