

CV SLIDE IN SPLASH POOL

Assembly & User Instructions - Please keep for future reference

435/4109



Assembly



Important

Age: 2 + years

The dimension of assembled product: L341 * W213 * H38CM

Important – Please read these instructions fully before assembly or use

These instructions contain important information which will help you get the best from your product and ensure safe and correct assembly, use and maintenance.

303021221648

Safety Information

Important – Please read these instructions fully before assembly or use

OWNER'S MANUAL

WARNING



Never leave your child unattended – drowning hazard.

- Only for domestic use.
- Only for outdoor use.
- Children can drown in very small amounts of water. Empty the pool when not in use.
- Do not install the paddling pool over concrete, asphalt or any other hard surface.
- Place the product on a level surface at least 2 m from any structure or obstruction such as a fence, garage, house, overhanging branches, laundry lines or electrical wires.
- Recommend back towards the sun when playing.
- Modification by the consumer of the original paddling pool (for example the addition of accessories) shall be carried out according to the instructions of the manufacturer.
- Keep assembly and installation instruction for future reference.
- Do not exceed the maximum weight of slide: 144kg / 317lbs.

Preparation

Installation of small swimming pool usually takes only 10 minutes with 1 people

Recommendations regarding placement of the pool:

- It is essential the pool is set up on solid, level ground. If the pool is set up on uneven ground it can cause collapse of the pool and flooding, causing serious personal injury and/or damage to personal property. Setting up on uneven ground will void the warranty and service claims.
- Do not set up on driveways, decks, platforms, gravel or asphalt. Ground should be firm enough to withstand the pressure of the water; mud, sand, soft / loose soil or tar are not suitable.
- The ground must be cleared of all objects and debris including stones and twigs.
- Check with your local city council for by-laws relating to fencing, barriers, lighting and safety requirements and ensure you comply with all laws.

If you need help or have damaged or missing parts, call the Customer Helpline: 0345 6400 800.

Assembly

Warning: Adult assembly required.

1. Open the safety valves and inflate the parts one by one. Be sure to close the valves after inflation. Air pump is not included.

NOTE: Do not over inflate. Do not use an air compressor.

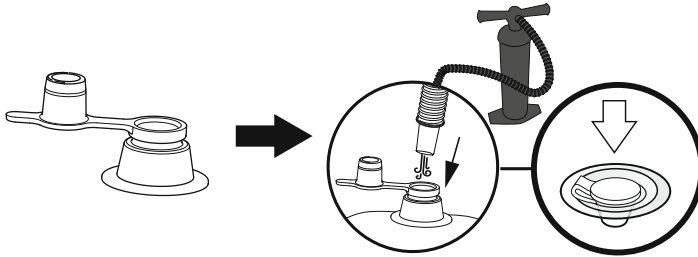

2. Open the water valve to fill water in the water chamber.

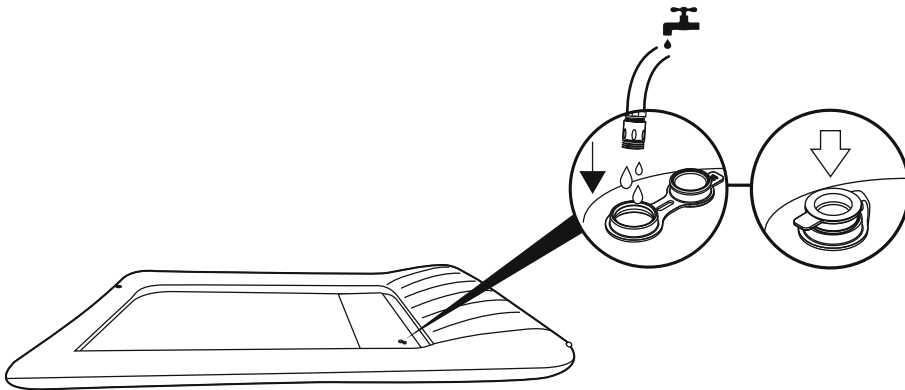

3. Connect your garden hose to the Hose Adapter.

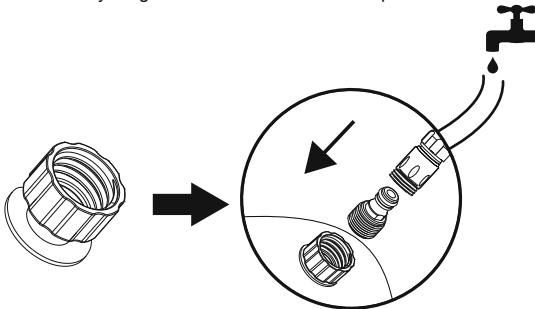

4. Slowly fill the pool to a proper water level.

ATTENTION: Do not leave pool unattended while filling with water.

Empty the pool

1. Check local regulations for specific directions regarding disposal of swimming pool water.
2. Deflate all the air chambers, at the same time push down the wall of the pool to release the water.

NOTE: Drain by adult only!

Pool Maintenance

Warning: If you do not adhere to the maintenance guidelines covered herein, your health might be at risk, especially that of your children.

- Change the water of pools frequently (particularly in hot weather) or when noticeably contaminated, unclean water is harmful to the user's health.
- Please contact your local retailer to obtain chemicals to treat the water in your pool. Be sure to follow the chemical manufacturer's instructions.
- Proper maintenance can maximize the life of your pool.
- See packaging for water capacity.

Cleaning and Storage

1. After use, use a damp cloth to gently clean all surfaces.
NOTE: Never use solvents or other chemicals that may damage the product.
2. Air dry the pool, once pool is completely dry, fold pool carefully and put back to its original packing. If pool is not completely dry, mould may result and will damage the pool.
3. Store in a cool, dry place and out of children's reach.
4. Check the product for damage at the beginning of each season and at regular intervals when in use.

Repair

If a chamber is damaged, use the provided repair patch.

1. Clean area to be repaired.
2. Carefully peel patch.
3. Press patch over area to be repaired.
4. Wait 30 minutes before inflation.



If you need help or have damaged or missing parts, call the **Customer Helpline: 0345 6400 800**.
Produced for Chad Valley Toys Argos Ltd. *Country of origin:* CHINA.
Address: 489-499 Avebury Boulevard, Central Million Keynes, MK9 2NW.
www.argos.co.uk