

Assembly & Operation Instructions

HOME

HOME 50M 4ARM METAL ROTARY AIRER

(LYQ304-50S - 4337054)

Parts Included

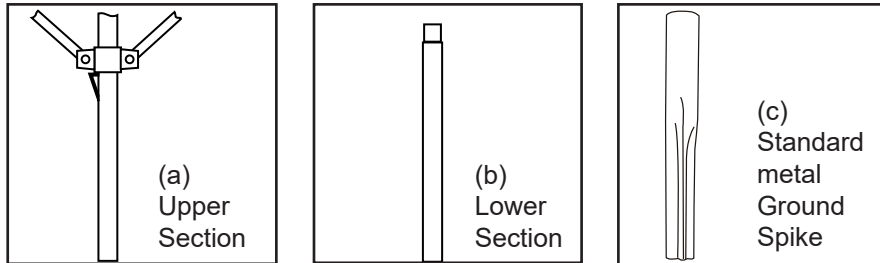

Directions for Use

1. Remove any protective paper / card packaging and recycle.
2. Please remove protective cap on upper section (a) before assembly. Lower section (b) is to be inserted into upper section (a).
3. Establish a suitable location for the airer. Please ensure there is enough room for it to rotate freely when fully open (2.63 meters diameter).
4. Install the ground spike. The spike included is for installation in a concrete mix place. We recommend to follow below steps:
 - a. Dig a hole 20cm square and 40cm deep.
 - b. Partly fill the hole with concrete and place the spike upright in the center.
 - c. Complete filling with concrete and ensure when installing the ground spike that it is firmly located in the vertical position.
 - d. Allow 48 hours for setting before use.

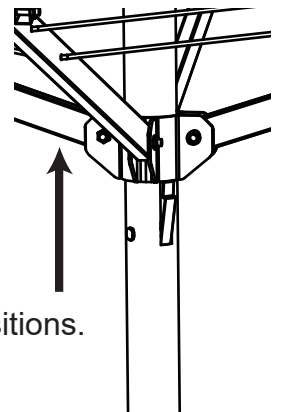

Operation

Operation

3 stage locking system - push progressively upwards for warm weather locking positions.

1. To open, remove Velcro strap and splay the arms away from the rotary. Slide the centre collar upwards until it engages in the first tension position.
2. To change the height of the rotary depress the button positioned on the central pole and locate at your desired height.
3. To close, depress the lift and click locking collar button and bring the arms down to its lowest position.

Note: you can open and close this item at your set / desired operational height.

4. If you are experiencing difficulties opening this product check to ensure lines are not tangled.
5. When both section are left together for long periods, separation may become difficult.

Care Instructions

When not in use we recommend that the airer is covered and securely tied.

If removing from the ground socket for storage please ensure that the airer is covered and kept out of the reach of children.

Wipe Clean with damp cloth.

Warning

Caution: Long cords present a risk of strangulation to children, ensure that the rotary airer is removed from the ground socket and safely stored away from children when not in use.

Do not exceed maximum load (40kg).

Ensure locking mechanism is engaged before use.

Do not use this rotary airer in adverse weather conditions

Please use the Spike or Socket which is provided with your rotary airer.

This is not a children's toy. Do not allow children to play with the product.

Line Tension Clip

Occasionally the line on your rotary ailer might sag, this can be due to a number of factors; weather conditions (lines are more prone to sagging in warmer weather), tangled lines, unevenly spaced lines and the rotary operation not being locked at its highest point. Before you use the line tension clip please ensure you have eliminated all the above factors.

Warning: the line tension clip is there to be used as a last resort to re-tension your rotary washing line.

1) Pinch where arrows indicate and open

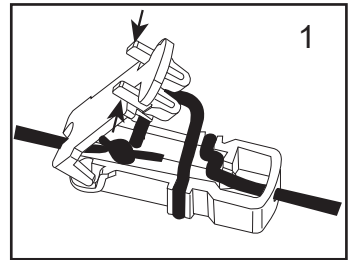

2) Unwind the loose line end
(warning - do not untie the knotted line end)

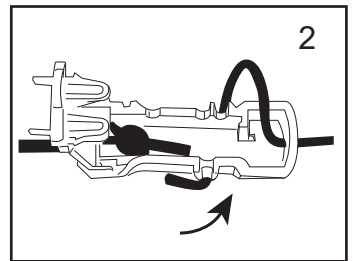

3) Pull the loose line end until it is at your desired tension

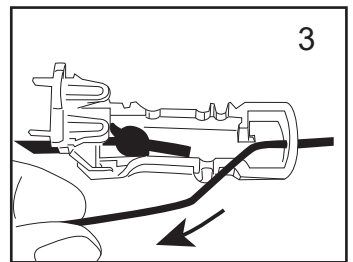

4) Rewind the loose line end

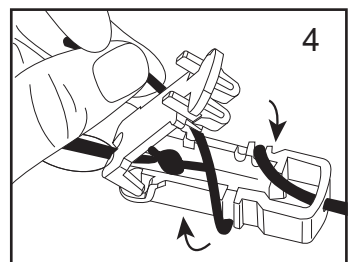

5) Secure by looping end of line back into the clip

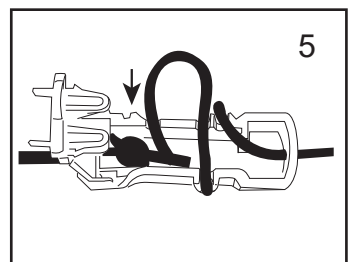

6) Close clip

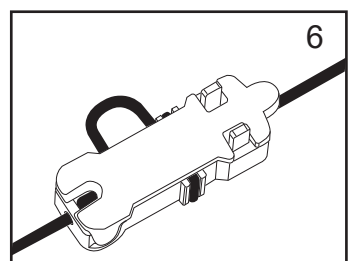

Your line should now be re-tensioned

Customer Support

 0345 640 2020