



HAND MIXER

INSTRUCTION MANUAL



IMPORTANT SAFEGUARDS

Before using the electrical appliance, the following basic precaution should always be followed including the following.

1. Read all the instructions.
2. Before use, check that the voltage of your wall outlet correspond to the rated voltage manner.
3. Do not operate the appliance with a damaged cord or after malfunction or has been damaged in any manner.
4. If the supply cord is damaged, it must be replaced by the manufacturer or its service agent or a similarly qualified person in order to avoid a hazard.
5. Do not let cord hang over edge of table or counter or touch hot surface.
6. The use of accessory attachments not recommended or sold by the appliance manufacturer, may cause hazards or result in fire.
7. Do not immerse the main body, cord or plug in water or other liquid as this would give rise to electric shock.
8. Do not touch hot surface. Use handles or knobs only.
9. Close supervision is necessary when your appliance is being used near children or infirm persons.
10. Do not place an appliance on or near a hot gas or on a heated oven.
11. Never eject beaters or hooks when the appliance is in operation.
12. Ensure fingers are kept well away from moving beaters.
13. Remove beaters or hooks from mixer before washing.
14. Avoid contact with moving parts. Keep hands, hair and clothing as well as cooking utensils away from beaters during operation to reduce the risk of personal injury and/or damage to mixer.

15. Do not operate the appliance for other than its intended use.
16. Do not use outdoors.
17. In case of technical problems, switch off the machine and do not try to repair it yourself, return the appliance to the nearest authorized service facility for examination, repair or electrical or mechanical adjustment. Failure to comply with above-mentioned conditions could affect the safety of the machine.
18. Switch off the appliance before changing accessories or approaching parts which move in use.
19. This appliance is not intended for use by persons (including children) with reduced physical, sensory or mental capabilities, or lack of experience and knowledge, unless they have been given supervision or instruction concerning use of the appliances by a person responsible for their safety.
20. Children should be supervised to ensure that they do not play with the appliance.
21. Save these instructions.
22. Household use only.

KNOW YOUR APPLIANCE

1. Speed selector
2. Eject button
3. Main housing
4. Beaters
5. Cord & Socket

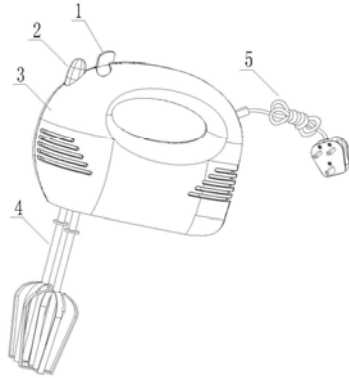

HOW TO USE THE HAND MIXER

1. Before inserting the attachments to the socket, make sure the power cord is unplugged from the power outlet and speed selector is in “0” position.
2. Beaters can be inserted in either socket, as the beaters are identical. Ensure beaters are fully inserted into the sockets or your mixing results may be affected.
3. When using the hooks, please make sure the hook with a ring is inserted in the left hole, the hook without the ring is inserted in the right hole. Otherwise the ingredients will come up to the hooks and beater holes. If this happen, please immediately stop the mixer, unplug, and clean the

hooks before using again.

4. Use hooks if mixing thick sticky flour. Use beaters if beating eggs.
5. Plug into the wall outlet and push the speed selector to desired setting to begin mixing. Always start mixing at low speed and then gradually increase the speed to prevent ingredients splashing out of the bowl.
The max operation period per time shall not exceed 3 minutes and the minimum rest period of 5 minutes shall be maintained between two consecutive cycles.
6. When you have finished mixing, stop the mixer by turning the speed selector to “0” position and unplug the cord from the wall outlet.
7. Refer to the mixing guide list to select a proper speed.
8. Scrape the excess mixture from the beaters by rubber or wooden spatula.
9. Press down the eject button firmly to detach the beaters.

MIXING GUIDE

SPEED	DESCRIPTION
1 FOLD	This is a good starting speed for bulk and dry foods such as flour, butter and potatoes.
2 BLEND	Best speed to start liquid ingredients for mixing salad dressings.
3 MIX	For mixing cakes, cookies and quick breads.

4 CREAM	For creaming butter and sugar. Beating uncooked candy, desserts. etc.
5 WHIP	For beating eggs, cooked icings. Whipping potatoes, whipping cream. etc.

Note : Use hooks if mix thick sticky flour. Use beaters if beat eggs.

CLEANING

1. Unplug the appliance from wall outlet before cleaning.
2. Wipe over the outside surface with a dampened cloth and polish with a soft dry cloth.
3. Wash the beaters in warm soapy water and wipe dry. The beaters may be placed in the dishwasher for easier cleaning. Caution: Never immerse the hand mixer or power cord into water for cleaning.

CONNECTION TO POWER

Before switching on, make sure that the voltage of your electricity supply is the same as that indicated on the rating plate.

MAIN CORD

- This appliance may be fitted with a non-rewirable plug.
- If it is necessary to change the fuse in a non-rewirable plug the fuse cover must be refitted. If the fuse cover is lost or damaged, the plug must not be used until a replacement is obtained.
- It is important that the color of the replacement fuse cover corresponds with the color marking on the base of the plug.
- If the plug has to be changed because it is not suitable for your socket, or becomes damaged, it should be cut off and an appropriate plug fitted following the wiring instructions below.
- The plug removed must be disposed of safely as insertion into a 13A socket is likely to cause an electrical hazard. For your own safety read the following instructions carefully.
- Before attempting to connect this unit to mains. The wires in this mains lead are colored in accordance with the following code:

BLUE = NEUTRAL
BROWN = LIVE

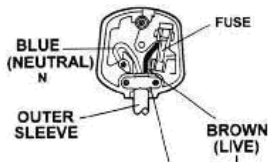

IMPORTANT

- As the colors of the wire in the mains lead of this appliance may not correspond with the colored markings identifying the terminals in your plug, proceed as following:
 - The wire which is colored blue must be connected to the terminal which is marked with the letter N or colored black.
 - The wire which is colored brown must be connected to the terminal which is marked with the letter L or colored red.
 - No connection is to be made to the earth terminal of the plug.
- If a 13 Amp (BS 1363) plug is used, a 3 Amp Fuse must be fitted, or if any other type of Plug is used, a 3 or 5 Amp Fuse must be fitted, either in the Plug or Adaptor, or on the Distribution Board.

DISPOSAL INFORMATION



Waste electrical products should not be disposed of with household waste. Please recycle where facilities exist. Check with your local authority for recycling advice.

GUARANTEE

This product is guaranteed against manufacturing defects for a period of 1 year

This does not cover the product where the fault is due to misuse, abuse, use in contravention of the instructions, or where the product has been the subject of unauthorised modifications or alterations, or has been the subject of commercial use

In the event of a problem with the product within the guarantee period please return it to your nearest Argos store

If the item is shown to have had an inherent defect present at the time of sale, the store will provide you with a replacement

Your statutory rights remain unaffected

**Guarantor; Argos Ltd
489 – 499 Avebury Boulevard
Central Milton Keynes
MK9 2NW**

PRECISION INDUSTRIAL LTD.

ADDRESS:UNIT H,6TH FLOOR,BLOCK F,REGAL COURT NO.8,LONGKOU ZHONG ROAD,
TIAN HE, GUANGZHOU CHINA
TEL:86-20-38465104/38465124/38465114 FAX:86-20-38465671

IDENTITY DECLARATION

Hereby we (**Precision Ind. Ltd.**) declare that the product (**hand mixer**) with model number (**HM-682C**) manufactured by the factory (**Precision Ind. Ltd.**) is identical to the Argos product (421/9529).

The product is fully complied with EN standards for MD, LVD, EMC, Noise, WEEE, RoHS Directives (where applicable). The corresponding testing reports are:

LVD/MD Directive

Standard(s):

(EN60335-2-14/A1 :2008/EN60335-1/A13 :2008/EN62233 :2008)

Laboratory: (TUV SUD)

Testing Report no.: **(64.110.08.1205.03)** Issue Date: (Jul. 6th, 2009)

EMC Directive

Standard(s):

(EN55014-1:2006/EN61000-3-2:2006/EN61000-3-3:1995+A1 :2001+A2 :2005/EN55014-2:1997+A1 :2001)

Laboratory: (TUV SUD)

Testing Report no.: **(64.710.08.368.02)** Issue Date: (Jun. 15th, 2009)

Yours Sincerely

For and on behalf of
PRECISION INDUSTRIAL LIMITED

Connie Cai
Authorized Signature(s)

----- (Signature & Date)

Printed Name : Connie Cai

Position : Sales manager