

# elmley solid oak shoe rack

Assembly Instructions - Please keep for future reference

411/7346

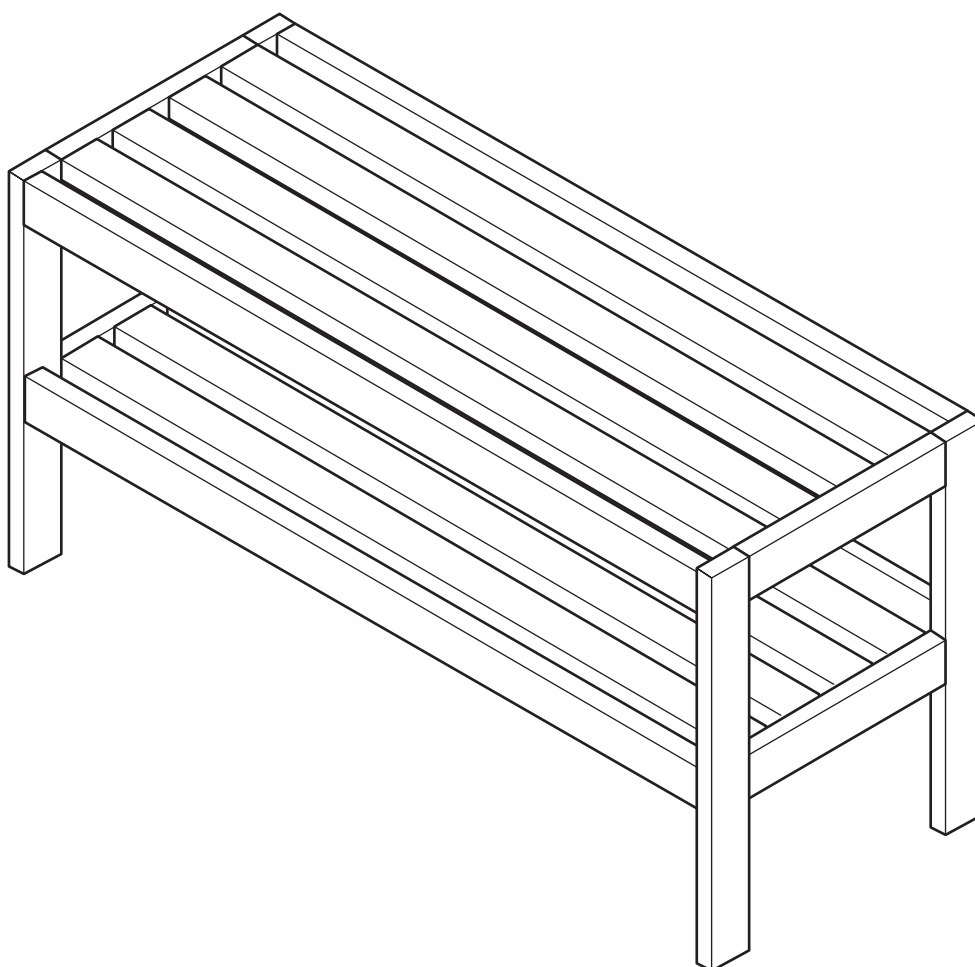

## Dimensions

Width - 82.5 cm  
Depth - 31.8 cm  
Height - 40 cm

**Important** - Please read these instructions fully before starting assembly

If you need help or have damaged or missing parts, call the **Customer Helpline:**  
**Argos = 0345 640 0800**



# Safety and Care Advice

**Important** - Please read these instructions fully before starting assembly

- Check you have all the components and tools listed on the following pages.

- Remove all fittings from the plastic bags and separate them into their groups.

- Keep children and animals away from the work area, small parts could choke if swallowed.

- Make sure you have enough space to layout the parts before starting.

- During assembly do not stand or put weight on the product, this could cause damage.

- Assemble the item as close to its final position (in the same room) as possible.

- Assemble on a soft level surface to avoid damaging the unit or your floor.

- Parts of the assembly will be easier with 2 people.



- We do not recommend the use of power drill/drivers **for inserting screws**, as this could damage the unit. Only use hand screwdrivers.

## Care and maintenance

- Only clean using a damp cloth and mild detergent, do not use bleach or abrasive cleaners.

- From time to time check that

there are no loose screws on this unit.

- This product should not be discarded with household

waste. Take to your local authority waste disposal centre.

## Handy Hints

- Assemble all parts and bolts loosely during assembly, only once the product is complete should you fully tighten the bolts.

- Regularly check and ensure that all bolts and fittings are tightened properly.

# Components - Parts

If you have damaged or missing components, call the  
Customer Helpline: Argos = 0345 640 0800

Please check you have all the parts listed below

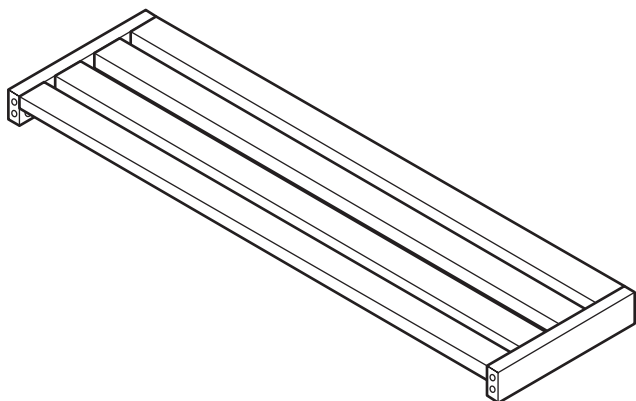

**1** Shelf Frame x 2  
(82.5 x 23.2 x 4.4 cm)

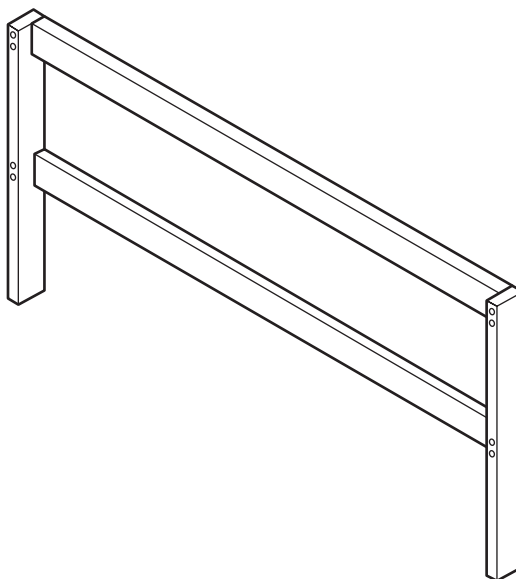

**2** Leg Frame x 2  
(82.5 x 4.4 x 40 cm)

# Components - Fittings

Please check you have all the fittings listed below

Note: The quantities below are the correct amount to complete the assembly. In some cases more fittings may be supplied than are required.



**A**  
Bolt x 8



**B**  
Locking Nut x 8

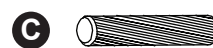

**C**  
Wooden Dowel x 8

## Tools required



Phillips screwdriver

# Assembly Instructions

## Step 1

### Attaching dowels and locking bolts

Insert dowels **C** into holes on leg frames **2** as shown.

Insert bolts **A** into holes on leg frames as shown and fix using a phillips screwdriver.

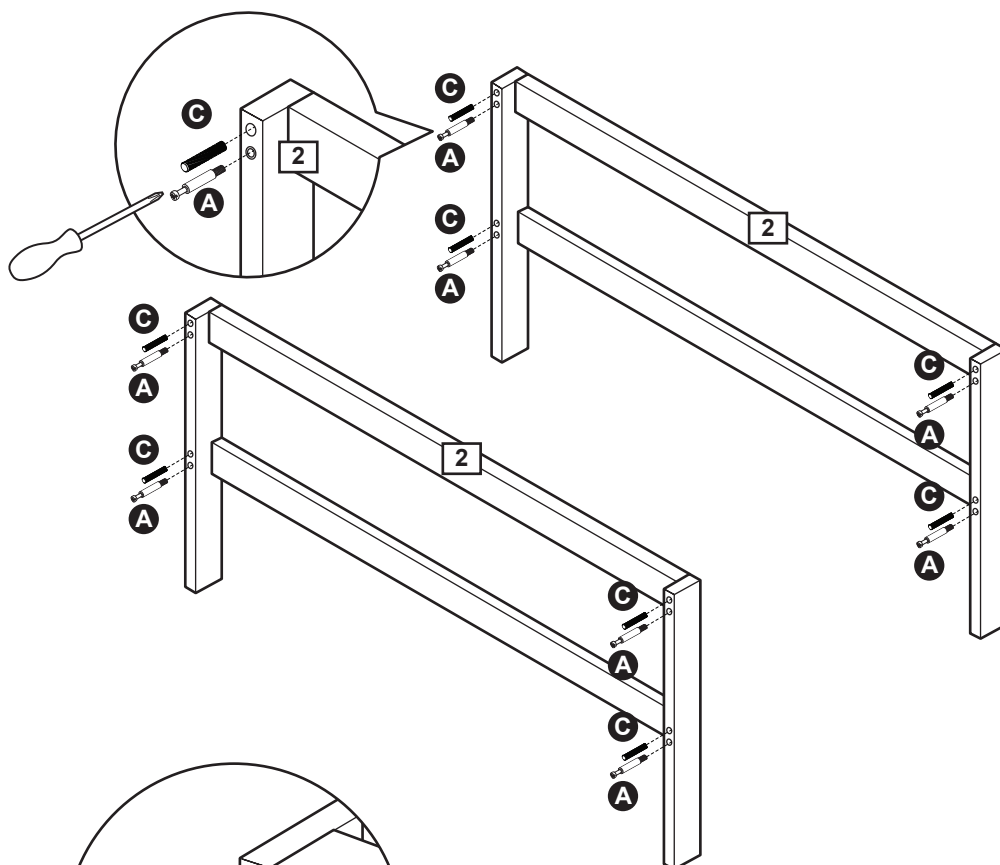

## Step 2

### Attaching shelf frame

Align and insert the dowels **C** and bolts **A** on leg frames **2** into holes on the shelf frames **1** as shown.

Insert the locking nuts **B** into the holes on the shelf frames.

Turn and fix the locking nuts using a phillips screwdriver.

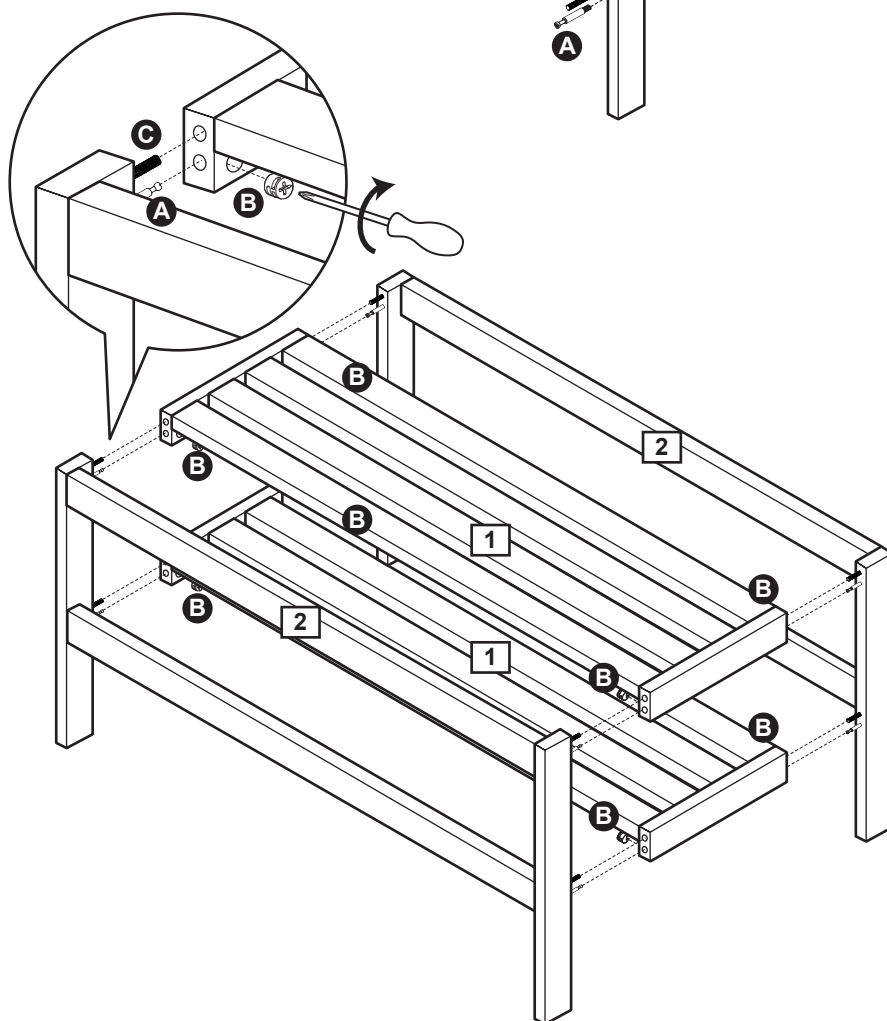

**Assembly is complete.**

If you need help or have damaged or missing parts, call the **Customer Helpline:**  
**Argos = 0345 640 0800**