

VERTICAL BLIND HEADRAIL

Installation Instructions

This product is designed to be used in conjunction with Sandow & Bourne louvres.

Your headrail is manufactured using a high quality metal that can be easily cut to reduce the length if required. This latest safety designed wand control unit allows you to easily draw and rotate the panels to the required side.

TOOLS REQUIRED:

Tape Measure Craft Knife Pencil Scissors Hacksaw Screwdriver Allen Key

PACK CONTENTS:

1 x Headrail - fully assembled with hook units, plastic spacers, end pieces and wand control.

1 x Pack Fixing Brackets - (2 for 4ft Headrail, 3 for 6ft and 8ft Headrail) - see Figure 1 below.

1 x Pack of Fixing Screws and Wall Plugs

1 x Pack of Bottom Weights - (8 for 2ft Headrail, 11 for 3ft Headrail, 15 for 4ft Headrail, 19 for 5ft Headrail, 23 for 6ft Headrail, 27 for 7ft Headrail, 30 for 8ft Headrail) - see Figure 2 below.

1 x Pack of Adjustable Panel Hangers and Retaining Rods (8 for 2ft Headrail, 11 for 3ft Headrail, 15 for 4ft Headrail, 19 for 5ft Headrail, 23 for 6ft Headrail, 27 for 7ft Headrail, 30 for 8ft Headrail) - see Figure 3 below.

1 x Tension Chain

1 x Instructions

Figure 1
Fixing Bracket

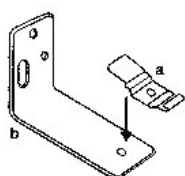

Figure 2
Bottom Weight
& Chain

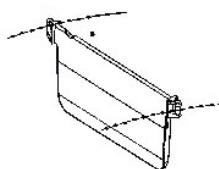

Figure 3
Panel Hanger
with Snap Off Rod

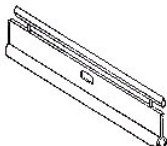

Figure 4
Plastic Stop Ring

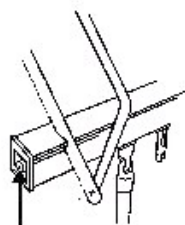

Figure 5
Grub Screw

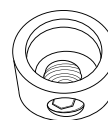
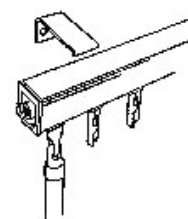

Figure 6
Top Rail with Brackets
Overview



IF ANY PARTS ARE MISSING OR FURTHER HELP IS NEEDED,
PLEASE PHONE 01282 666000

MEASURING GUIDE:

Firstly you must decide whether your blind is to be fitted inside or outside the window recess. If inside the recess, measure the width at the height at which the track is to be fitted. Deduct 1cm from this measurement - this is the length of the headrail. If fitting it outside the recess, add an overlap of approximately 10cm each side of the recess - this is the length of your headrail.

THE HEADRAIL - If you wish to reduce the length please follow the following simple steps.

1. Shorten the headrail at the end with the smaller endcap and white plastic adjustable stop ring; at this end you will see a label marked "cut from this side" on top of the track. - see figure 4 above.
2. Ensure track is gathered at the opposite side prior to cutting.
3. Cut completely through the headrail at the desired length using your hacksaw - make sure the cut is square - see figure 4 above.
4. Take the small off-cut piece of headrail, remove the grub screw, adjustable stop ring, and end cap with an allen key - see figure 5 above.
5. Fit the end cap to your headrail.
6. There is no need to remove any hangers.
7. Secure the endcap with the adjustable stop ring and grub screw - see figure 5 above.

INSTALLING THE HEADRAIL

Fit the headrail using the two piece brackets provided - see figure 1 above. The wand control can be located at either the left or right hand side. When fitting to plaster, use the plastic wall plugs provided.

Fixing to the wall - fasten the two pieces of brackets together - see figure 1a and 1b above - with the machine screw and nut. Screw the brackets to the wall equal distance apart then clip the top of the headrail to the brackets using palm pressure to both sides.

Fixing to the ceiling - screw the bracket 1a to the ceiling at equal distances then clip the top of the headrail to the brackets using palm pressure to both sides.