

USE INSTRUCTIONS

❖ For small valve of inflatable item, it may be pinched with your fingers to open the flapper of valve and allow the air to escape.

For quickly inflating the item with screw valve, unscrew the safe bolt, then inflate directly with the pump. When finishing, screw the safe bolt, then remove the top of the safe bolt for inflating the item fully; For deflation, unscrew the safe bolt to deflate directly.

Technical Data

Model No	HT - 303
Material	ABS
Power	40W
Pressure	0.45PSI
Airflow	300L/Min



Where possible, recycle unwanted materials instead of disposing of them as waste. All parts and package should be sorted, taken to a recycling center and disposed of in an environmentally friendly manner.

Guarantor: Argos Limited
489 - 499 Avebury Boulevard
Central Milton Keynes
MK9 2NW

ELECTRIC 12V PUMP

Read following instructions and warnings before use - please keep for future reference

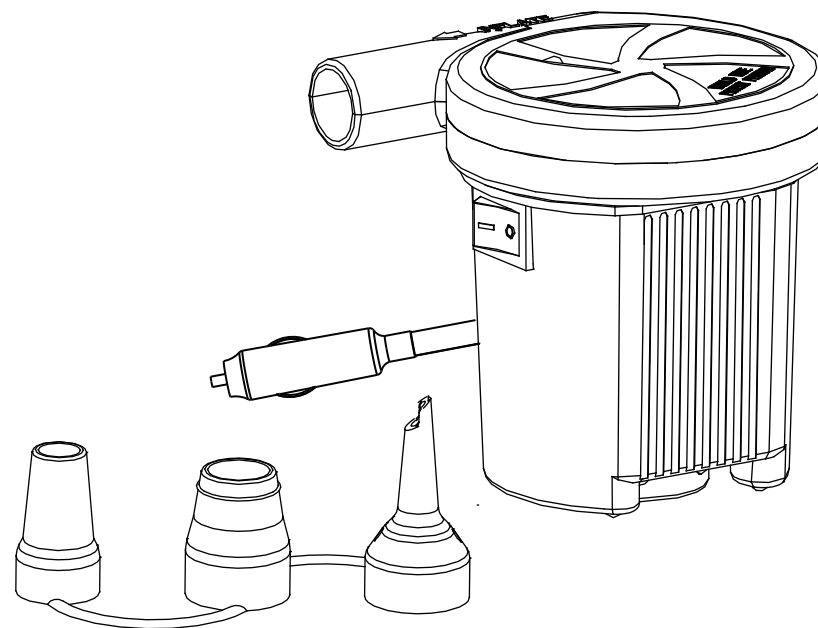

HT - 303 DC: 12V

IMPORTANT

Read these instructions carefully and familiarise yourself with the procedure before use.

IMPORTANT SAFETY INSTRUCTIONS

Read all instruction before use and keep for future reference.

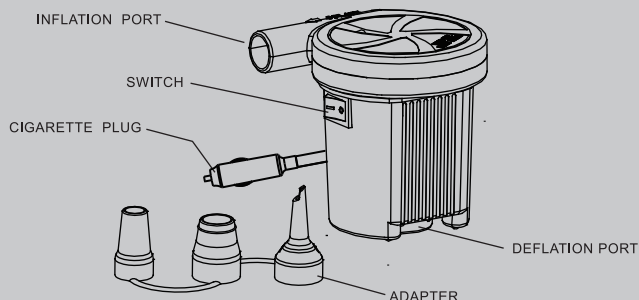

1 IMPORTANT

- ❖ Power supply must be automobile cigarette lighter 12 volt DC.
- ❖ This pump is intended to inflate/deflate items,such as inflatable boat,air mattress,etc.It is not designed for continuous use.Extended operation over 25 minutes can overheat and damage the pump.
- ❖ Keep the air pump out of the reach of children.
- ❖ Do not obstruct the inflation/deflation port and keep them ventilated all the time.
- ❖ For fast inflation and shorten the motor's working time,always use the suitable adapter according to the size of valve of inflatable item

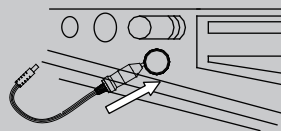

2 WARNING

- ❖ To reduce the risk,contact qualified electrician to repair or replace the damaged cord immediately.
- ❖ Carefully following the instructions on inflatable item when inflating. Never exceed recommended pressuer,otherwise,serious injury might be caused by the bursting item.
- ❖ Never leave pump unattended while the pump is in use.
- ❖ Do not keep/use the pump in wet condition.

USE INSTRUCTIONS

- ❖ Never allow sand,small rocks,etc,to be sucked into inflation/deflation port when using the pump.
- ❖ Never look inside or point the inflation/deflation port toward your eyes when the pump is working.
- ❖ Never attempt to put hand or fingers into the inflation/deflation port at any time

3 TO INFLATE ITEMS

- ❖ Connect cigarette plug to automobile cigarette lighter 12 volt DC
- ❖ Join adapter to inflation port.
then hold pump against valve of inflatable item and switch on for inflation/switch off for stop.(the symbol "-" on the switch means "ON" , "o" means "OFF")
- ❖ The valve of inflatable item should not be obstructed,otherwise,it could overheat and damage the pump.
- ❖ Never use the deflation vent when inflating the item.On large items like inflatable boat, king-size air mattress,the pump should fit directly to the valve of inflatable item for fast inflation. Use the appropriate adapter for small valve, such as single-size air mattress,etc.

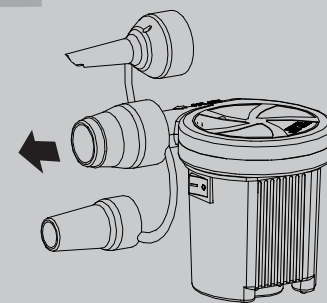

4 TO DEFLATE ITEMS

- ❖ Open the valve of inflatable item.
- ❖ Join adapter to deflation port.
then insert it in the valve and switch on for deflation/switch off for stop.(the symbol "-" on the switch means "ON", "O"means "OFF")
- ❖ The valve of inflatable item should not be obstructed, otherwise,it could overheat and damage the pump.

