

# GUILD

## 12V WET & DRY VACUUM CLEANER

Instruction Manual

G12CV

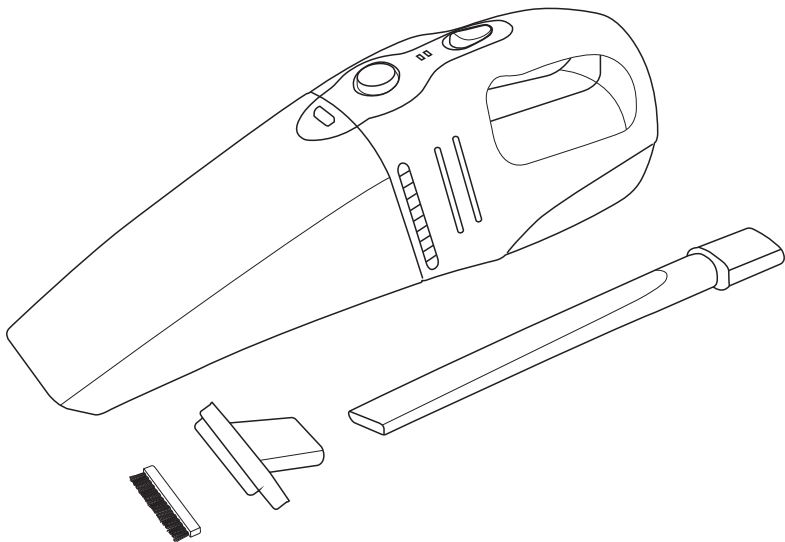

# GUILD

### After Sales Support

UK/Ireland 0345 640 2020

**Important-** please read these instructions fully before operating or maintaining your guild wet/dry vacuum cleaner.

These instructions contain important information that will help you get the best from your Guild wet/dry vacuum cleaner, ensuring it remains safe to operate.

If you require any assistance or have damaged or missing parts, please call the After Sales Helpline on 0345 640 2020

# Safety Instruction

## Warning

To reduce the risk of fire, electrical shock or injury:

**IMPORTANT NOTE** - This product is fitted with a 15amp fuse. Please ensure your vehicle 12v socket fuse within the car fuse box is also fitted with a 15amp fuse (or greater) to avoid damage to the vehicle. Note some older vehicles may have a 10amp fuse in which case this product should not be used.

- Be aware of extended on time as this can flatten the vehicle battery. This can vary per vehicle and battery level. Extended use may deplete the battery level.
- Close supervision is necessary when any appliance is used by or near children. Do not allow this vacuum cleaner to be used as a toy. Keep any plastic bags in the vacuum packing away from children to avoid suffocation or other injuries. Although this vacuum is designed to pick up liquids, only the Suction Nozzle end of the Dirt/Liquid Container should be placed in liquid.
- Do not immerse the entire vacuum in any liquid.
- Do not pick up anything that is burning or smoking, such as a cigarette. Avoid picking up hard, sharp objects with the vacuum. They may damage the vacuum and the Filter.
- Do not use the vacuum to pick up toxic, flammable, or combustible substances/ liquids such as gasoline or operate the vacuum in the presence of explosive or flammable fumes such as alcohol-based cleaning sprays.
- Do not operate the vacuum in areas close to explosive, combustible, or flammable items.
- Do not put any object into the openings. Do not use with any opening blocked. Keep free of dust, lint, hair or anything that may reduce airflow.
- Do not operate the vacuum without the Dirt/Liquid Container or Filter in place. Replace a damaged filter promptly.
- Clean the Dirt/Liquid Container after picking up any perishable food items.
- Do not use on or near hot surfaces.
- This vacuum is intended for domestic use only. The vacuum is not for commercial or industrial use.
- Use only as described in this manual. Use only original manufacturer's accessories and parts. Contact after sales support (0345 640 2020) for after sales support.
- Save this manual for future reference.

# Cleaning Tools

## **CLEANING TOOLS**

### **1. Crevice Tool:**

This tool works as a long reach cleaning wand or a crevice tool. Simply attach the Crevice Tool (part 7) to the Suction Nozzle (part 9). The tool is for cleaning hard to reach areas and tight places.

### **2. Combined Squeegee & Upholstery Brush:**

This tool has a rubber squeegee edge and bristle brush edge. The squeegee side is for picking up liquid spills on hard surfaces like floors, glass, counter tops, etc. The bristle side is for brushing and picking up dirt, dust, and debris from upholstery, carpet, tables, etc. - To separate gently pull apart. To re-connect gently push into place.

# Part List And Technical Specifications

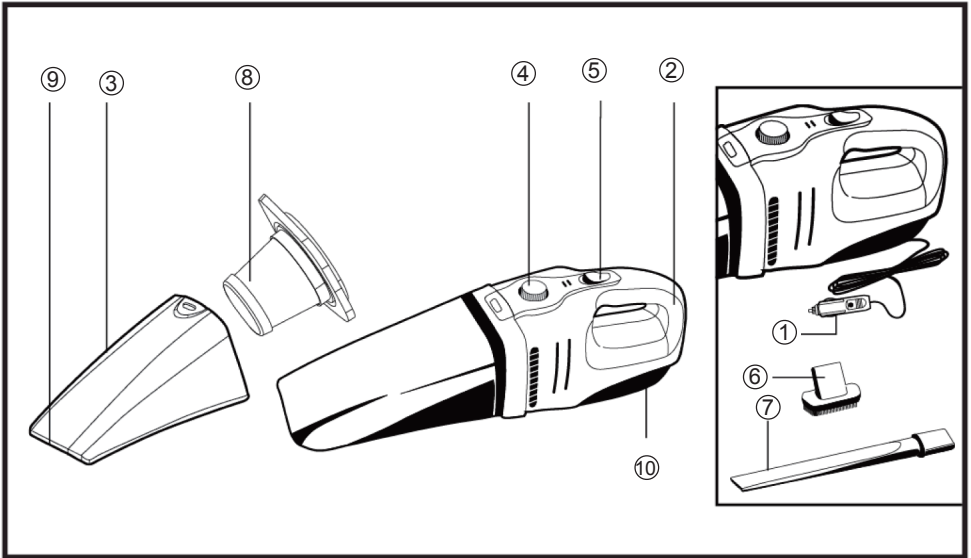

1. Built-in 12V Car Plug (incorporating 15A fuse – refer to Technical specifications)
2. Vacuum Housing
3. Dirt/Liquid Container (175ml maximum capacity)
4. Dirt/Liquid Container Release Button
5. On/Off Switch
6. Combined Squeegee & Upholstery Brush
7. Crevice Tool
8. Filter
9. Suction Nozzle
10. Cord & Plug Compartment

## TECHNICAL SPECIFICATIONS

- Type: Handheld, domestic wet & dry clean-ups  
Car Plug: For standard automotive 12V cigarette lighter socket  
Input: 12V DC  
Max Power: 120W  
Weight: 0.8kg  
Dimensions: H135, D110, L420mm (without Accessories)  
Fuse: 15A Glass Cartridge fuse, 5x20mm, F rated (fast acting)

# Operating And Maintenance

## HOW TO USE

Push the On/Off Switch forward to turn on your vacuum. Backwards to turn off your vacuum.

### Crevice Tool:

- Use for hard to reach areas such as the side of car seats

### Combined Upholstery Brush and Squeegee:

- For wet spills remove the brush by pulling it away from the assembly to give better access to the squeegee
- For dry debris the brush can be left connected to help collect the debris from areas such as car mats

## Running Time

- This product may be used for up to 20 minutes continuously and then allowed to cool for 10 minutes before using again. This protects the motor from damage and prolongs the life of the product.

### 1. Picking up dry debris:

Use your vacuum to pick up dirt, dust, food crumbs, etc. from bare floors, rugs, counters, upholstered furniture, automobile interiors, etc. After dry clean-ups, empty and clean the Dirt/Liquid container before picking up liquid or wet spills.

### 2. Picking up liquids or wet debris:

Use your vacuum to pick up liquid spills and wet debris. For better liquid clean-ups on hard surfaces like counter and glass tops, insert the Squeegee & Upholstery Brush into the Suction Nozzle. Pull the squeegee side through the liquid to assist the clean-up whilst vacuuming to collect the liquid.

The liquid capacity of the Dirt/Liquid Container is 175mL.

Hold the vacuum with the Suction Nozzle pointing vertically down towards the floor, the Dirt/Liquid Container is full when the liquid level is about 3 inches up from the suction end.

After liquid clean-ups, empty the Dirt/Liquid Container and thoroughly clean the Dirt/ Liquid Container, and Filter to prevent the formation of mould and mildew.

## MAINTENANCE

**IMPORTANT:** Never clean the vacuum by completely immersing the vacuum in water! It should be disassembled for cleaning (refer to exploded diagram on page 4).

Proper use and care of your vacuum will extend the life of the vacuum and its accessories. Thoroughly cleaning the Filter after each use will improve performance. Mould or mildew may form in the Dirt/Liquid Container, Filter if they are not properly cleaned.

Make sure that the Filter is dry before you operate the vacuum. The Filter should be replaced periodically as required to provide optimal vacuum performance, or when the Filter has been damaged. Contact after sales support 0345 640 2020 for spare parts.

# Operating And Maintenance

## **Emptying Dirt/Liquid Container:**

Liquids, dirt, and debris (wet or dry) picked up by your vacuum will collect in the Dirt/Liquid Container. To empty the Dirt/Liquid Container, follow these steps:

1. Holding the Dirt/Liquid Container with one hand and the Handle Housing with the other, press the Dirt/Liquid Container Release Button to swing the container away from the housing.

While holding the container over a sink or waste bin, pull the Filter out. Empty contents from the container.

# Operating And Maintenance

As requested (weekly), hand wash the Dirt/Liquid Container, and Filter in warm soapy water. Use only mild soap and detergents. Other detergents, cleaners, or solvents may damage the plastic.

Once the filter is washed / cleaned please allow to dry overnight before replacing and using. To re-insert press the Filter onto the Dirt / Liquid Container (part 3). You may need to press around the edge of the Filter to make it fit properly into the Dirt/Liquid Container.

Place the Dirt/Liquid Container back onto the Handle Housing by placing the lower rear edge of the container against the lower front edge of the housing. The latch at the lower front edge of the housing should fit into the lower latch hole of the container. Swing the container so the upper rear edge of the container is against the upper front edge of the housing. The Dirt/Liquid Container Release Button on the housing will snap into the upper latch hole of the container.

## **Cleaning the Vacuum Housing:**

Clean the vacuum housing with a damp cloth. Do not use detergents, cleaners, or solvents.

Note: Never clean the vacuum by immersing the vacuum in water!

Note: For dry vacuuming make sure that the Filter is dry before you operate the vacuum. If it is not dry the performance may be reduced. The Filter should be replaced periodically to provide optimal vacuum performance, or when the Filter has been damaged.

Note: contact aftersales 0345 640 202 to obtain spare parts.

## **STORAGE**

- Before storing, thoroughly clean the whole machine.
- Store it out of the reach of children, in a stable and secure position, in a cool and dry place, avoid too high and too low temperatures.
- Protect it from exposure to direct sunlight. Keep it in the dark, if possible.
- Don't keep it in plastic bags to avoid humidity build-up.



Waste electrical products should not be disposed of with household waste. Please recycle where facilities exist. Check with your local authority or retailer for recycling advice. This symbol is known as the 'Crossed-out Wheelie Bin Symbol'. When a product is marked with this symbol, it means the product should not be disposed of with your general household waste. Only discard electrical/electronic products in a separate collection scheme which caters for the recovery and recycling of the materials contained within. Your co-operation is vital to ensure the success of these schemes and for the protection of the environment.



In Accordance with essential requirements of the European directives(s)

## Guarantee

This product is selected for **DOMESTIC USE ONLY** and not for business use.

This product is guaranteed against manufacturing defects for a period of 24 months. This does not cover the product where the fault is due to misuse, abuse, use in contravention of the instructions, or where the product has been the subject of unauthorised modifications or alterations, or has been the subject of commercial use. In the event of a problem with the product within the guarantee period please return it to your nearest store. If the item is shown to have an inherent defect present at the time of sale, the store will provide you with a replacement. Your statutory rights remain unaffected.

### **Argos Ltd**

489 - 499 Avebury Boulevard, Central Milton Keynes, MK9 2NW  
[www.argos-support.co.uk](http://www.argos-support.co.uk)

**3370716-ISSUE 0711-19**