

# Assembly & Operation Instructions

## HOME

### HOME LIFT&CLICK ROTARY AIRER 60 METRES

(LYQ287-60D - 3340877 )

#### Parts Included

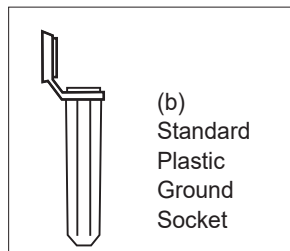
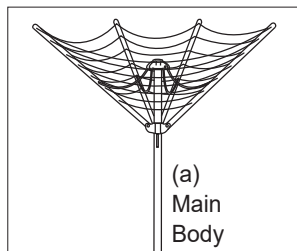

#### Directions for Use

1. Carefully remove all packaging.
2. Please remove protective cap on upper section (a) before assembly.
3. Establish a suitable location for the airer. Please ensure there is enough room for it to rotate freely when fully open (2.84 meters diameter.)
4. Installation of the ground socket. If inserting into semi-firm ground it is recommended that you place a piece of wood over the top to the ground socket and hammer against this. This will prevent damage by ground spike. If inserting into a concrete base we recommend:
  - a. Dig a hole 20cm square and 40cm deep.
  - b. Partly fill the hole with concrete and place the socket upright in the center.
  - c. Complete filling with concrete and ensure when installing the ground socket that it is firmly located in the vertical position.
  - d. Allow 48 hours for setting before use.

#### Operation

Step 1. Insert the airer into the plastic socket.

Step 2. To open, release the arms by unfastening the retaining strap.

Step 3. Push the sliding collar in an upwards direction until you have reached the fixed locking collar on the centre pole. Press and hold the button on the sliding collar, push in an upwards direction over the fixed locking collar and release the button to lock into place. In warmer weather conditions press the button on the sliding collar and push upwards to lock in a higher position to tighten the lines. To unlock, press and hold the button on the sliding collar to unlock and gently slide down the centre pole, to the fully closed position.

Step 4. If the line is too high or too low for comfortable use, you may adjust the height by raising or lowering the hand grip.

#### Care Instructions

If you are experiencing any difficulty to open this airer, please ensure lines are not tangled.

When not in use, we recommend that the airer is covered and securely tied.

If removing from the ground spike for storage, please ensure that the airer is covered and kept out of the reach of children.

#### Warning

Do not overload. Maximum evenly distributed load for this dryer is 6 wash loads or 42kg. Overloading may result in damage of the item.

Ensure locking mechanism is engaged before use.

Caution: Plastic bags can be dangerous, to avoid danger of suffocation keep this bag away from babies and small children. Please retain these instructions for future use.

Caution: Long cords present a risk of strangulation to children, ensure that the rotary airer is removed from the ground socket and safely stored away from children when not in use.

When not in use we recommend that the airer is covered and securely tied.

To clean, simply wipe with damp cloth.

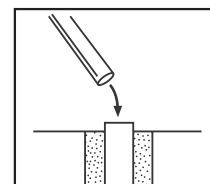

(Step 1)

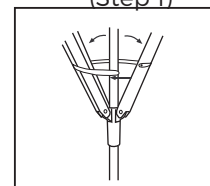

(Step 2)

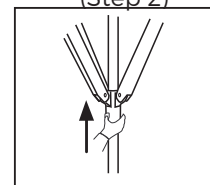

(Step 3)

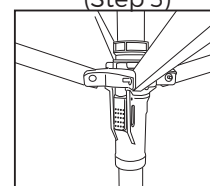

(Step 4)

# Line Tension Clip

Occasionally the line on your rotary ailer might sag, this can be due to a number of factors; weather conditions (lines are more prone to sagging in warmer weather), tangled lines, unevenly spaced lines and the rotary operation not being locked at its highest point. Before you use the line tension clip please ensure you have eliminated all the above factors.

Warning: the line tension clip is there to be used as a last resort to re-tension your rotary washing line.

1) Pull where arrows indicate and open

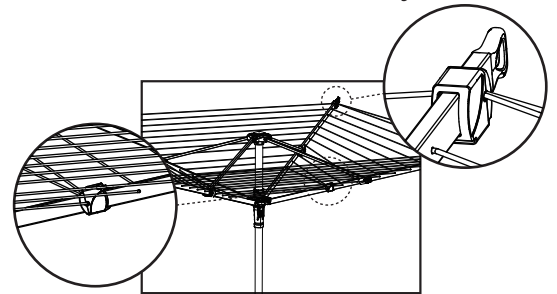

2) Unwind the loose line end  
(warning - do not untie the knotted line end)

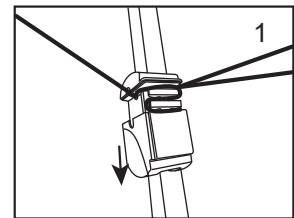

3) Pull the loose line end until it is at your desired tension

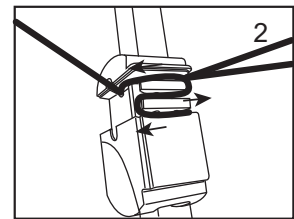

4) Rewind the loose line end

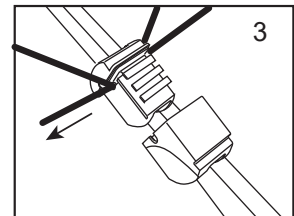

5) Secure by looping end of line back into the clip

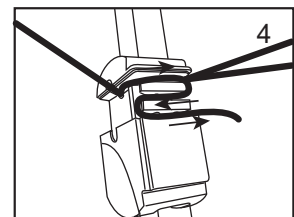

6) Close clip

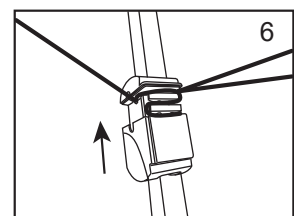
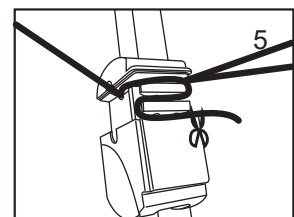

Your line should now be re-tensioned

**Customer Support**

0345 640 2020