

INDY USER GUIDE, TROUBLE SHOOTING & FAQ'S

	<p>Auto Power - On </p> <p>Power - On On Encendido Accensione Liglar Ein Ain- Tænd Virta Päälle Strøm Av Ström Av Bittotnam 开机 電源 - On 전원 켜기 تشغيل</p>	<p>Auto Power - Off </p> <p>Power - Off Off Apagado Spegnimento Dagjar Aus Utstøtt Sluk For Strøm Pós På Bittotnam 关机 電源 - Off 전기 توقف</p>	<p>Charge Case </p> <p>Charge Case Recharger Lühil Estuho De Carga Carica La Custodia Etapa De Carga Hülle Aufladen Opaddatu Opaddatu Lataa Kotelo Ladingseske Ladningsöskhet Naisvoimakas laturip 充电器 充電ケース 케이스를 충전하세요 تحميل</p>	<p>Charge Earbuds </p> <p>Charge Earbuds Recharger Les Ecouteurs Auriculares De Carga Carica Gli Auricolari Cargador Auriculares Kopfhörer Aufladen Opaddatu Örnadoppur Opaddi Hærestöfnar Lataa Napkkuaukko Lada Örnepöglar Ladnja Dronenslador Naisvoimakas laturip 为耳机充电 イヤホン充電 이 헤드셋을 충전하세요 تحميل</p>
<p>Pairing Mode </p> <p>Pairing Mode Mode Couplage Modo De Vinculación Modality Di Accoppiamento Modo Emparelhamento Koppelmoodus Paritrimitevalik Lühivõimalus Sammenkoblingsmodus Paringsäge Parung Compexes 配对模式 ペアリングモード 配对模式 تحميل</p>	<p>Pair New Device </p> <p>"Indy" Pair New Device Coulter Nouvel Appareil Vincular Nuevo Dispositivo Accoppiare Nuovo Dispositivo Emparelhar Novo Dispositivo Mit Newum Gerät Koppeln Newum Apparaat Paren Paridan Ny Etnet Muudosta Uusi Lühivõimal Sammenkoble Ny Etnet Para Ny Etnet Comexesee Hoovoo Vcrpocletna 配对新设备 新しいデバイスをもペアリング 새 기기 적안후기 تحميل</p>	<p>Power - On </p> <p>Power - On On Encendido Accensione Liglar Ein Ain- Tænd Virta Päälle Strøm Av Ström Av Bittotnam 开机 電源 - On 전원 켜기 تشغيل</p>	<p>Power - Off </p> <p>Power - Off Off Apagado Spegnimento Dagjar Aus Utstøtt Sluk For Strøm Pós På Bittotnam 关机 電源 - Off 전기 توقف</p>	<p>Play/Pause </p> <p>Right Side 01 Play/pause Lecture/pause Reproducción/pausar Riprodução/pausa Reproducción/pausa Wecker/pause Altpälden/pausen Asp/pause Tõstetako Spill/pause Spells Up/pause Bocpocneeeeeeetna 播放/暂停 再生 / 一時停止 재정지(시 장치) تحميل</p>
<p>Track Forward </p> <p>Right Side 01 Track Forward Piste Suunkte Adiklar Brano Succesivo Pista Seguinte Nächster Titel Värdnad Nummer Skift Till Näste Musiknummer Kellusa Eberpäin Kestä Spor Nästa Luchspår Последующее Из 1 Трeкa Иззад 下一曲目 次のトラックを再生する 다음 트랙으로 تحميل</p>	<p>Track Back </p> <p>Left Side 02 Track Back Piste Precedente Retroceder Brano Precedente Pista Anterior Vorhergehender Titel Vorlg Nummer Musiknummer Tilbage Kellusa Taakspäin Fornge Spor Byta Till Föregående Spår Последующее Из 1 Трeкa Иззад 上一曲目 前のトラックを再生する 이전 트랙으로 تحميل</p>	<p>Volume Up </p> <p>Right Side 01 Volume Up Volume + Subir Volumen Aumentar Volume Aumentar O Volume Lautstärke Erhöhen Volume Omhoog Sieu Op For Lydstyrken Äänvoimakauden Lisäys Volum Opp Öka Volymen Yükseltmek Ses Gücünü Artırma 音量増大 音量を上上げる 음량 높이기 تحميل</p>	<p>Volume Down </p> <p>Left Side 02 Volume Down Volume - Bajar Volumen Riduzione Volume Diminuir O Volume Lautstärke Senken Volume Omhoog Sieu Ned For Lydstyrken Äänvoimakauden Vähennys Volum Ned Sänka Volymen Yükseltmek Ses Gücünü Azaltma 音量减小 音量を下げる 음량 낮이기 تحميل</p>	<p>Answer/End </p> <p>Right Side 01 Answer/end Responder/fin Responder/colgar Resposta/fin Atender/colgar Ansvaret/bevorden Beantworten/bevordigen Besvar/afslut Vastaus/peetus Svar/afslut Svarslutt/På Ostama/ajonoma 接听/结束 応答 / 終了 전환 받기/받기 تحميل</p>
<p>Clear Paired Device </p> <p>Right Side 01/Left Side 02 "Disconnected Mode" Reset Device Réinitialiser l'Appareil Reiniciar el Dispositivo Ripristina Dispositivo Reinicia o Dispositivo Reiniciala/Vinculering Reset het Apparaat Nõust Etnet Nõusta Laite Nõust Etnet Återställa Etnet Сброс устройства 重置设备 デバイスをリセット 기기 재설정 리셋/재설정</p>				



TROUBLE SHOOTING

PAIRING ISSUES?

Issue: The biggest challenge with truly wireless earbuds is maintaining a paired status between both independent buds. There are times when (due to the capacitive touch sensor technology) the user will accidentally clear one side without the other, this can create a pairing challenge as each side will now be in different search modes when powered on. Easy fix!

Solution:

- 1- Turn the Bluetooth on your (mobile or computer) device OFF
- 2- Power on your Indy buds (they will be in a NON_CONNECTED or non-paired state due to Bluetooth being off on your device)
- 3- Tap the center of EACH bud 4 times (see below diagram). This will automatically power off the ear bud and reset your ear buds. You must complete this action on BOTH ear buds while in this non-connected state.

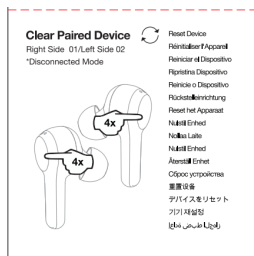

- 4- Next, place the buds back in the case then pull them out to have them power on and start the process of pairing to one another.
- 5- You will hear a voice prompt that will notify you that it is now “Pairing” and one beep indicating the buds have paired together,
- 6- At this time, turn your device’s Bluetooth back on and re-pair it to Indy. In some cases you will want to forget Indy on your device and scan until Indy is identified again and you can select it.

BUDS NOT CHARGING IN CASE/CASE LID NOT CLOSING PROPERLY?

Issue: Not seeing the RED led indicator on the bud when you’ve placed your Indy back in the case

Solution:

- 1- Check to see if any debris is blocking the charging pins at the bottom of the case, or on the bud.
- 2- Check to see if the removable Stability Ear Gel or in-ear gels have been twisted or falling off, this could be keeping the buds from sitting correctly in the case.
- 3- This same issue could also be interfering with your case lid when closing, if you’re having a hard time closing the lid correctly, this is an indicator that buds are not set correctly or the gels are interfering.

FAQ’s

BATTERY & CHARGE:

What is the total charging time for Indy?

- 1 hour for the Earbuds to charge to 100% inside the Case
 - o Note: This product has Rapid Charge. This means that you can charge your earbuds in the case for 10 minutes to get 1.2 hours play time



- 2 hours for the Case to charge to 100%

Can I charge Indy with my PC/Laptop?

- Yes. Almost all USB outputs will work to charge

Does Indy have some sort of fast charge?

- Yes, these earbuds have Rapid Charge technology. You will be able to charge your earbuds in the case for 10 minutes to get 1.2 hours play time

CONNECTION:

What is the Bluetooth range of the Indy?

- You may be able to listen up to 30+ feet (10 meters) away from your paired device, though your connection experience may vary based on your environment.

Can I connect Indy to a computer?

- Yes as well as to a phone, tablet, MP3 player, or anything else with a Bluetooth connection.

Can I use indy with a PS4/Xbox One/Switch?

- PS4: Yes
- Xbox One: No
- Switch: Yes

Which version of Bluetooth does Indy use?

- Bluetooth® version 5.0

Which master earbud?

- The right side earbud is your master earbud

When on a call or listening to my content, will I hear audio in one (the right side master) or both earbuds?

- Indy has stereo calling so you'll hear the caller or your content in both ears.
- You do have the option to use only one ear bud (right side) if you prefer a mono solution
- In addition, the INDY has dual microphones with active noise reduction for improved voice clarity during phone calls

GENERAL QUESTIONS:

Can I use Siri/Google Assistant/Alexa with my Indy?

- Not currently, but we will have an update to incorporate this user feature solution in 2019.

Can I use Indy for sports or working out?

- Yes! Indy area sweat, water, and dust resistant (IP55).

WARRANTY:

PLEASE BE SURE TO REACH OUT TO CUSTOMER SERVICE BEFORE FILING A CLAIM, WE CAN LIKELY HELP YOU QUICKLY TROUBLE SHOOT AND SOLVE YOUR PROBLEM***

What happens if my earbuds break or are lost?

- If it is a manufacturer's defect, Skullcandy has you covered with a 2 Year Limited Warranty.



- If one bud or the charging case is broken or goes missing, please make use of our [Fearless Use™ Promise](#).

Where do I register my Indy Truly Wireless Earbuds?

- You can register your Indy product [here](#) for faster service in the event of loss or damage to your earbuds or the charging case.