

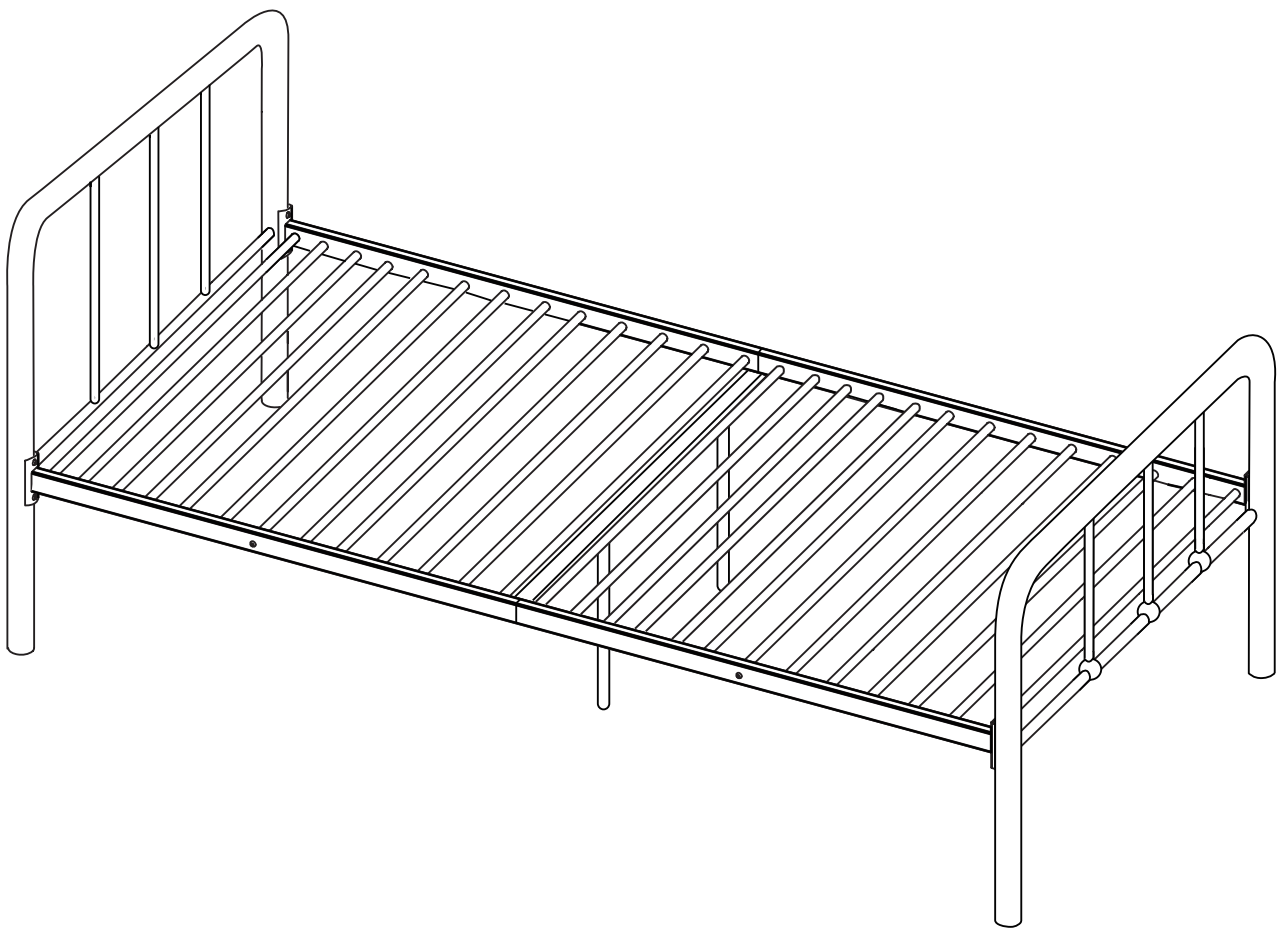

Charlie metal frame



IMPORTANT - Retain these instructions for future reference

Spare Parts

 www.argos-support.co.uk

 Help@ClickSpares.co.uk

 0370 112 1928

Customer Support

 0345 640 2020



Safety and Care Advice

Product Details

Sliver 850/9905 White 849/9785 Green 313/8986 Purple 708/2399 Red 409/8221

IMPORTANT, RETAIN FOR FUTURE REFERENCE: READ CAREFULLY.

- Keep children and animals away from the work area, small parts could choke if swallowed.
- Make sure you have enough space to layout the parts before starting.
- This product has been constructed to be used in the domestic environment only and not for commercial purposes.

- Assemble the item as close to its final position (in the same room) as possible.
- Assemble on a soft level surface to avoid damaging the unit or your floor.

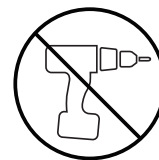

- We do not recommend the use of power drill/drivers for inserting screws as this could damage the unit. Only use hand screwdrivers.
- Parts of the assembly will be easier with 2 people.
- Dispose of all packaging carefully and responsibly.

Care and maintenance

- Only clean using a damp cloth and mild detergent. Do not use abrasive cleaners.
- Use a dry cloth to clean the product, furniture polish is not recommended.
- From time to time check that there are no loose screws, nuts or bolts. If there are please re-tighten.
- This product should not be discarded with household waste. Take to your local authority waste disposal centre.

Additional Guidance

- Assemble all parts and bolts loosely during assembly, only once the product is complete should you fully tighten the bolts.
- Regularly check and ensure that all bolts and fittings are tightened properly.
- This product is tested to meet BS8509:2008 +A1:2011 standards.
- This bed is for children between 6 to 12 years old to use.
- Recommended size of mattress(es): 190cm(L)x90cm(W).
- That children are likely to play, bounce, jump, and climb on beds, therefore the child's bed should not be placed to close other furniture or windows blind cords, curtain pulls or other strings or cord, and should be placed either tight to any wall or have a gap of 300mm between the wall and the side of the bed.
- The bed is designed to be dismantled for storage or transportation.
- Warning: Do not place this child's bed near heat sources, windows and other furniture.
- Warning: Not suitable for children under 4 years.
- Warning: Do not use this child's bed if any part is broken, torn or missing.
- The replacement spare parts can be obtained from www.argos-support.co.uk. Please write email to Help@ClickSpares.co.uk or call #03701121928 if needed.

Fittings (Shown to scale)

Bag 1

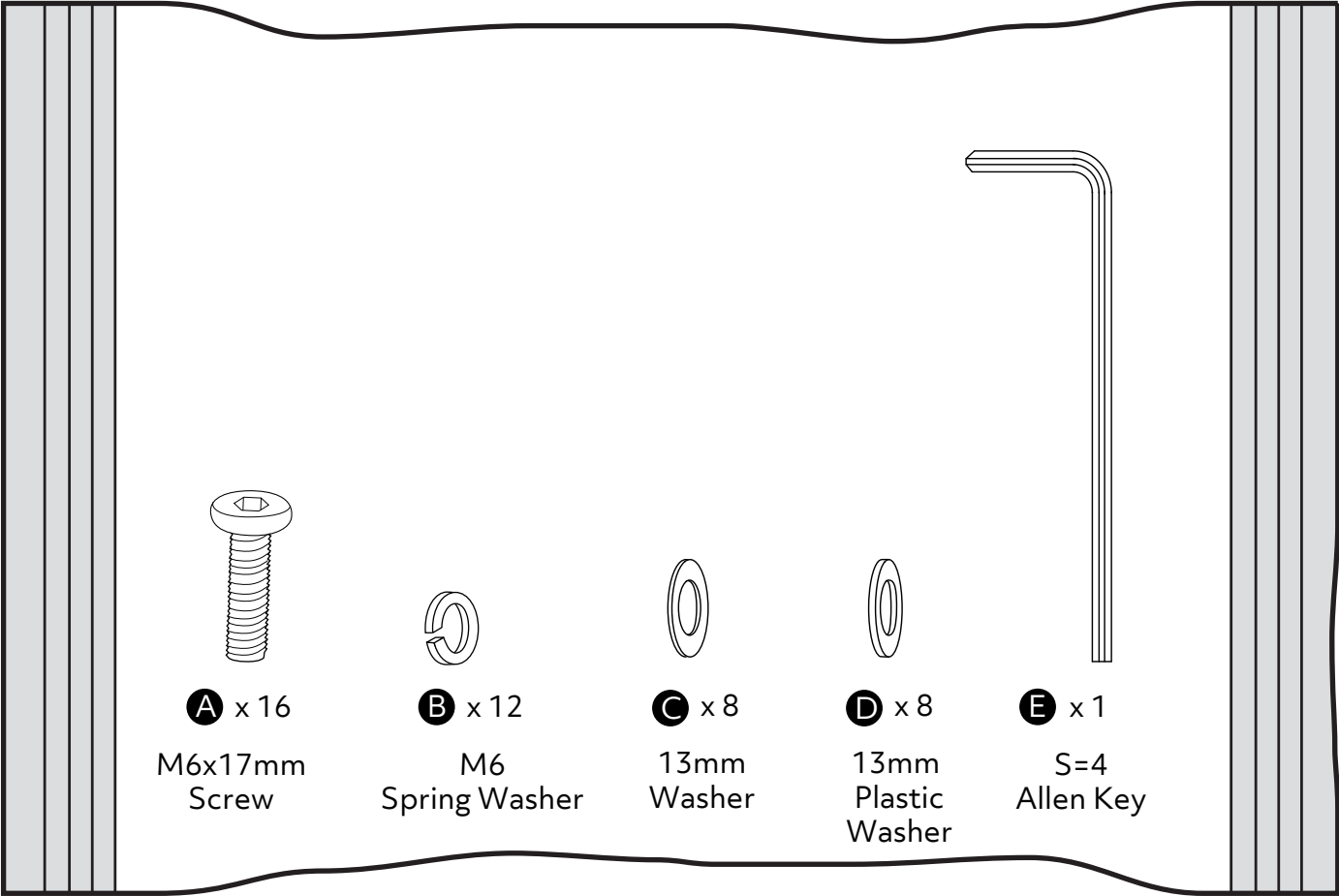

Tools required

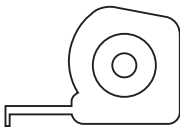

Ruler/tape
measure

Components

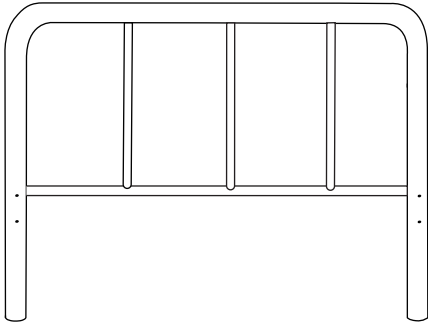

1 HEADBOARD
(965x805mm)

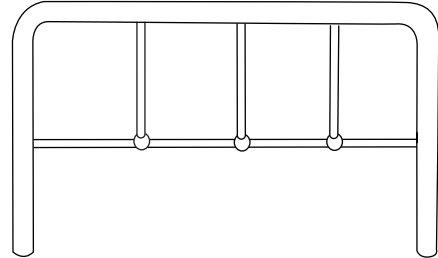

2 FOOTBOARD
(965x545mm)

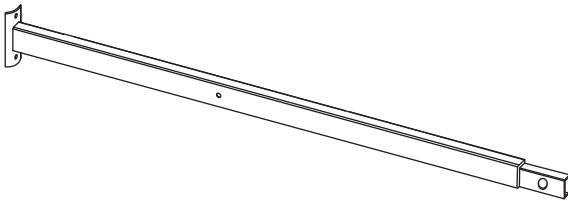

3 SIDE RAIL x2
(970x100mm)

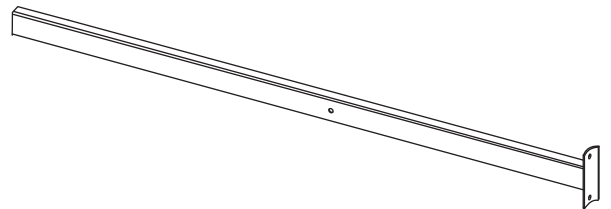

4 SIDE RAIL x2
(965x100mm)

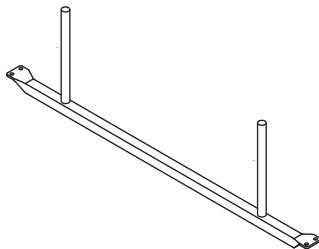

5 METAL RAIL
(25x950mm)



6 METAL SLAT x24
(\varnothing 16x945mm)

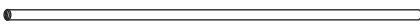

7 METAL SLAT WITH SCR W HOLE x2
(\varnothing 16x945mm)

1

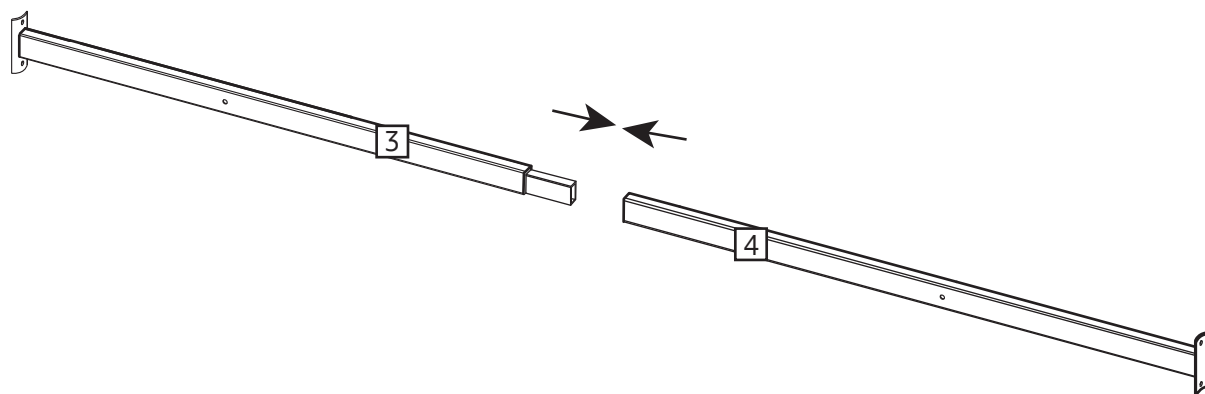

2

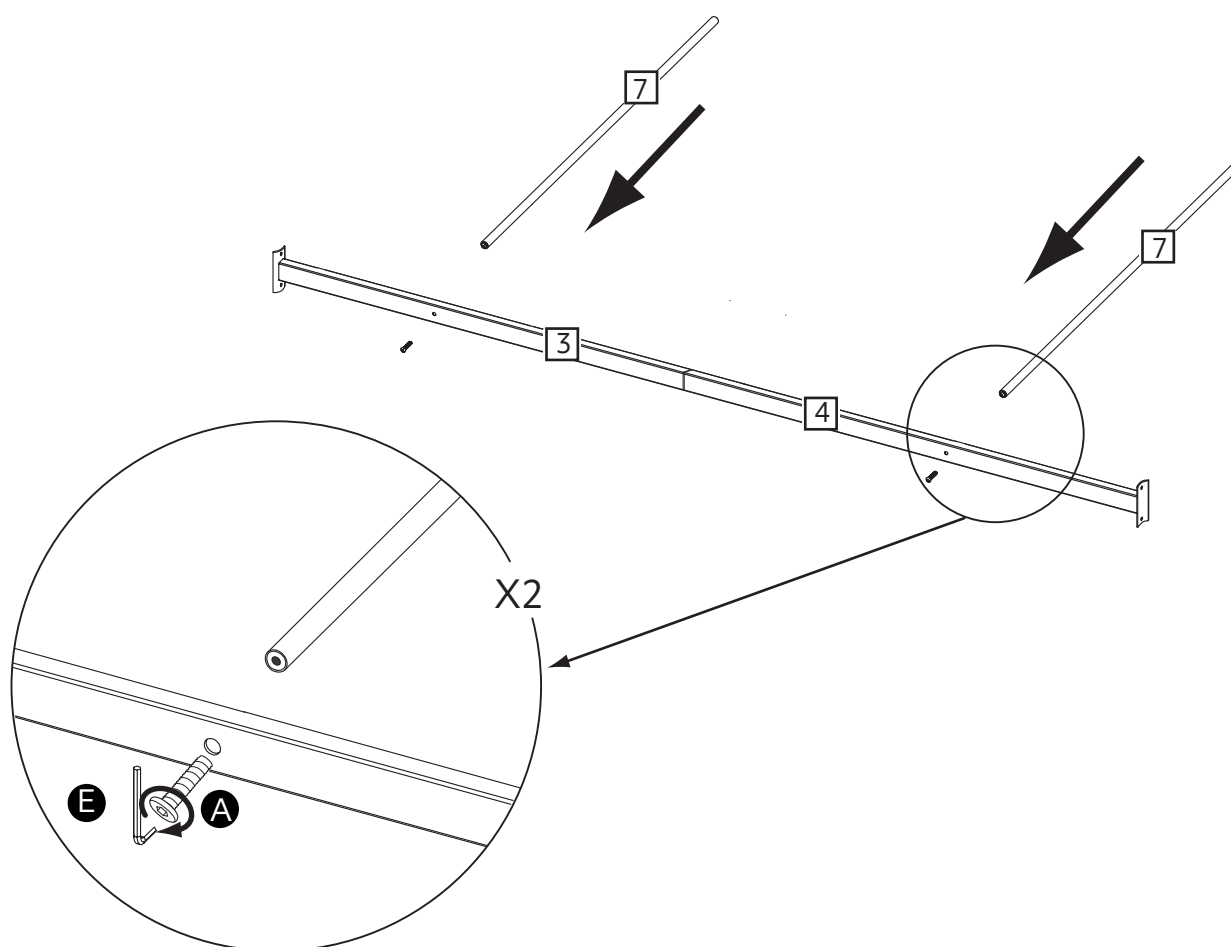
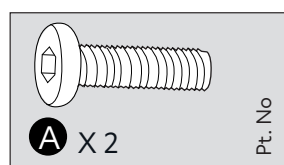

3

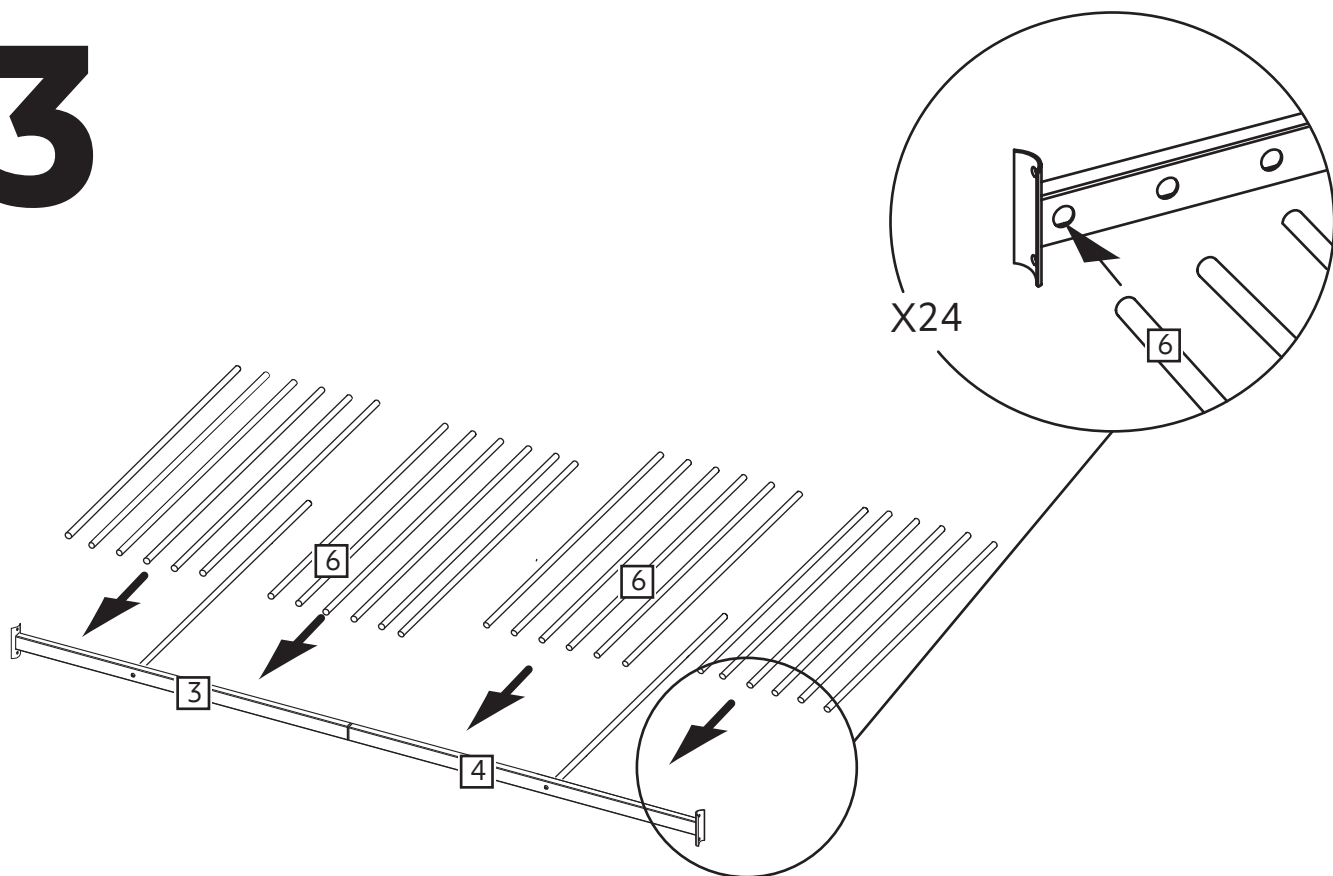

4

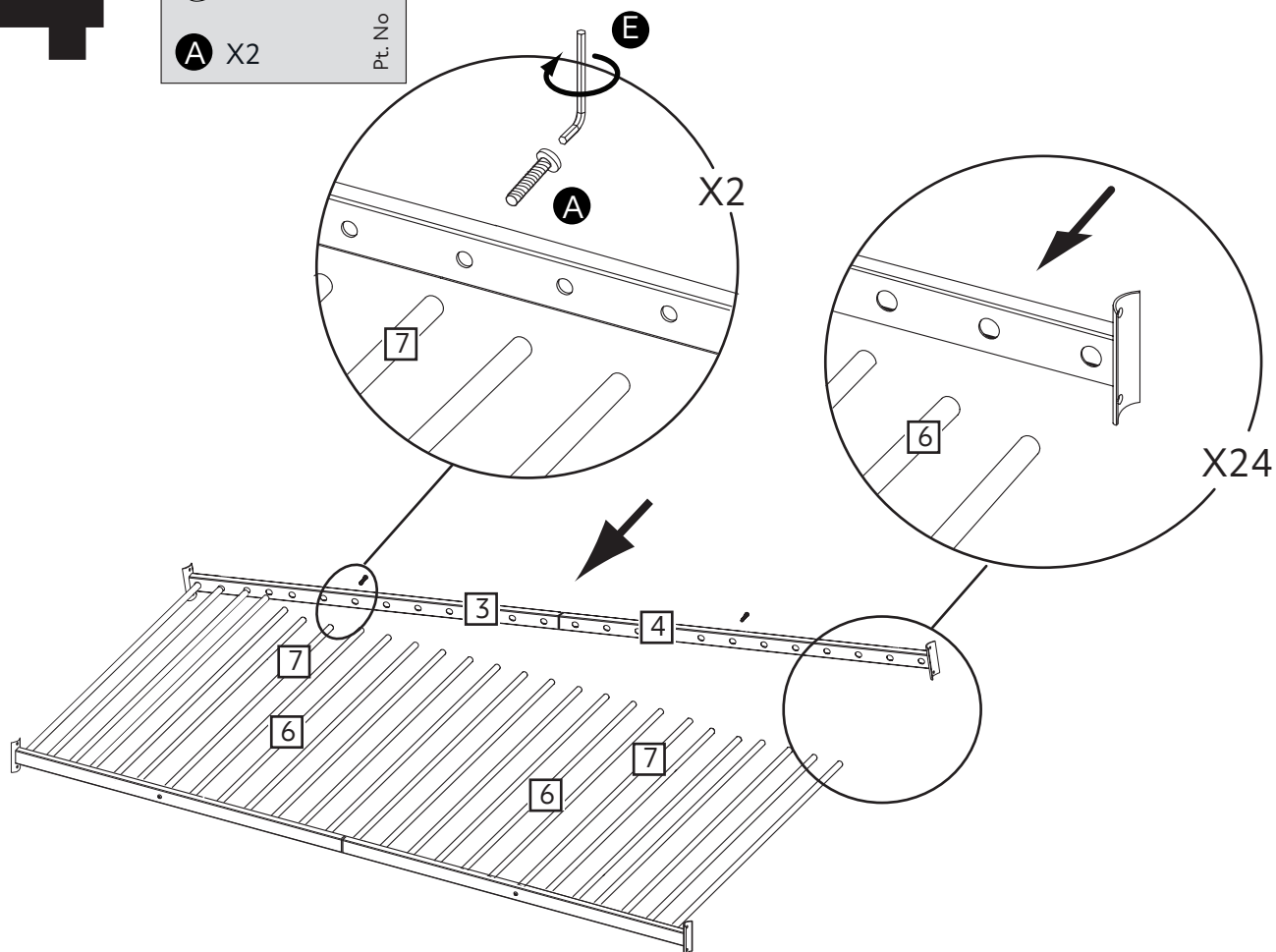
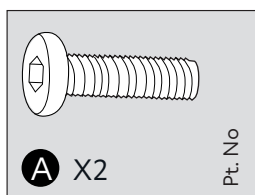

5

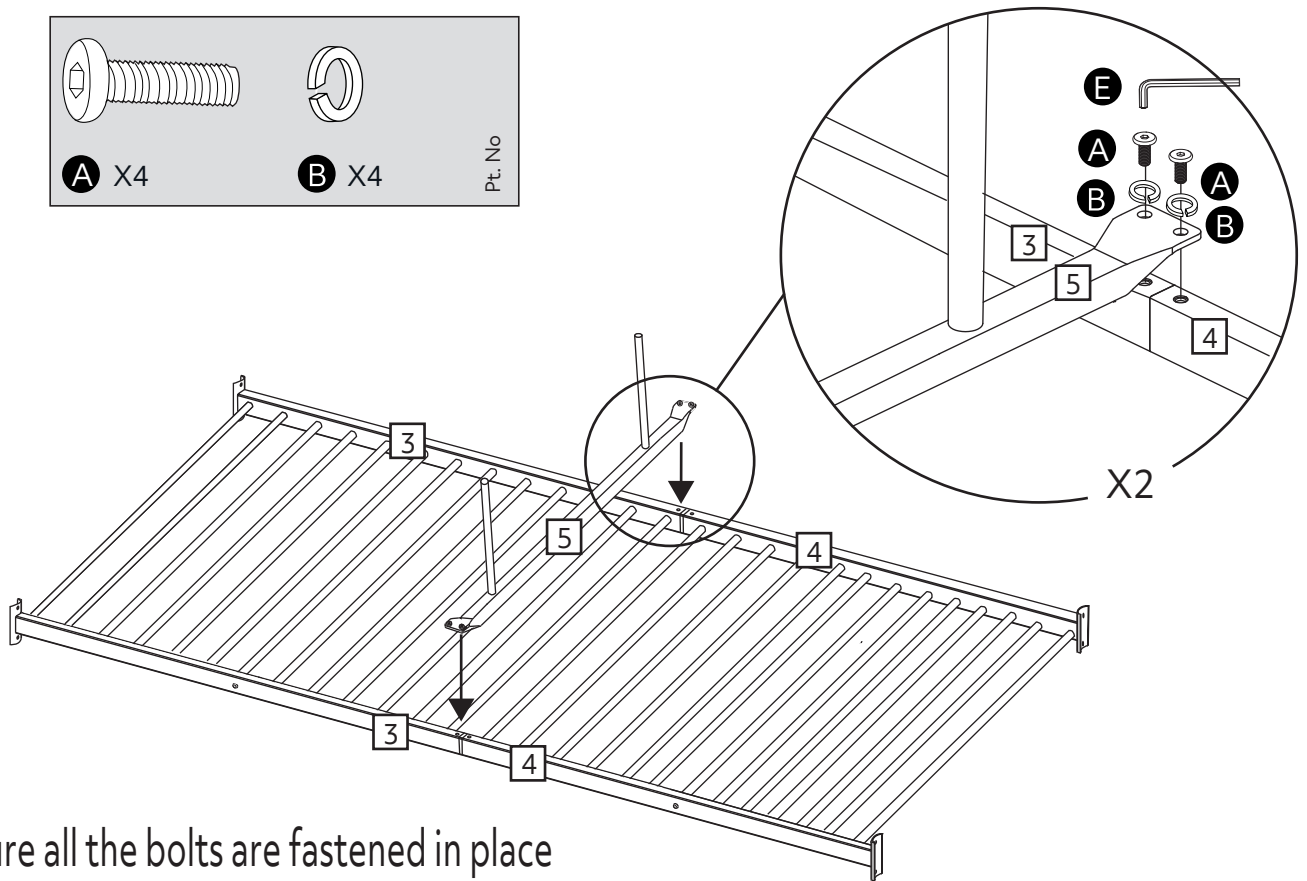
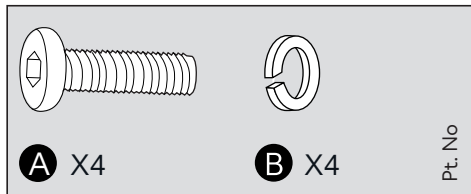

Make sure all the bolts are fastened in place

6

