

3-IN-1 SWING - M008600
TODDLER SWING AGED 6 TO 36 MONTHS
JUNIOR SWING AGED 3 TO 10 YEARS

SAFETY GUIDELINES

Warnings

Only for domestic use. This product has not been designed for commercial use in play centers, nurseries etc. Only suitable for outdoor use.

Toddler swing: For children 6 - 36 months 20kg max.

Junior swing: For children 3 - 10 years 45kg max.

Only one child per seat.

The Harness must be securely fastened at all times during use in Toddler Seat with T-Bar configuration and Toddler Seat without T-Bar configuration

Do not lean or push on the T-Bar

The flat swing seat does not have a back or seat belt. It is not suitable for children under 3 years as they may not be able to balance themselves. For children under 3 years, please use the baby swing seat.

This equipment must be assembled and checked by an adult. Two adults may be required to assemble this product Adult supervision is required at all times.

Before use please check all bolts are tight, secure and intact.

Check all coverings for bolts and sharp edges and replace when required.

Check swing seats, chain, ropes and other means of attachments relevant to your product for evidence of deterioration. Replace when required in accordance with the manufacturers instructions if necessary.

Place the product on level surface at least 2 metres from any structure or obstruction such as a fence, garage, house wall, overhanging branches, laundry line or electrical wires.

The items MUST be anchored firmly into the ground.

DO NOT install the product over concrete, asphalt or any hard surface.

DO NOT orientate the product directly towards the sun.

Leave all fittings finger tight until assembly is complete, for ease of construction. Then tighten firmly.

Children should not wear cycle helmets whilst on this equipment.

Do not allow children to stand on any swing seats, glider seats or slide chutes relevant to your product.

Do not allow the children to jump or climb off any moving equipment.

Do not twist swing ropes or wrap them over the top bar.

Do not allow loose, hooded or baggy clothes to be worn as children can get trapped and may be unable to free themselves.

Do not allow children to climb on parts of this equipment not intended for this purpose.

Do not allow children to wander into the play area whilst the equipment is in use.

Glider and swings must not exceed an angle of 60 degrees from the ground.

Regularly check the item for wear and damage, removing the item from use when necessary until replacement parts are fitted.

Failure to assemble and maintain this item as per instruction may cause injury to the user.

Please keep the instructions in a safe place for future reference.

The minimum clearance between the junior swing seat and ground level should be 350mm, the baby seat and ground should be 200mm.

Please contact our customer services department if you have any problems.

Inspect all parts of this product every 6 months following purchase. If any parts look worn or you find any problems, please contact us for replacements and do not use product until problem has been corrected. Hedstrom recommends replacing the plastic swing rope clamps every 2 years even if there is no sign of deterioration.

Do not modify this item

Conforms to EN71

Made in China to European Standards

SWING PARTS LIST



1 CENTRE BAR



2 "LEFT-HAND" TYPE TOP LEG (X2)



3 "RIGHT-HAND" TYPE TOP LEG (X2)



4 BOTTOM LEG (X4)



5 SIDE STAY BAR (X2)

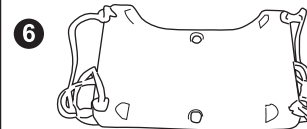

6 SWING SEAT

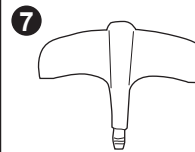

7 T-BAR

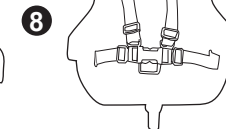

8 BACKREST WITH ATTACHED HARNESS AND BUCKLE



9 CROTCH HARNESS



10 PLASTIC BOLTS



11 GROUND PEG (X4)



F1 M8 U-BOLT (X2)



F2 42MM SOCKET HEAD M6 BOLT (X4)



F3 52MM SOCKET HEAD M6 BOLT (X4)



12 SPANNER (X1)



13 ALLEN KEY (X1)

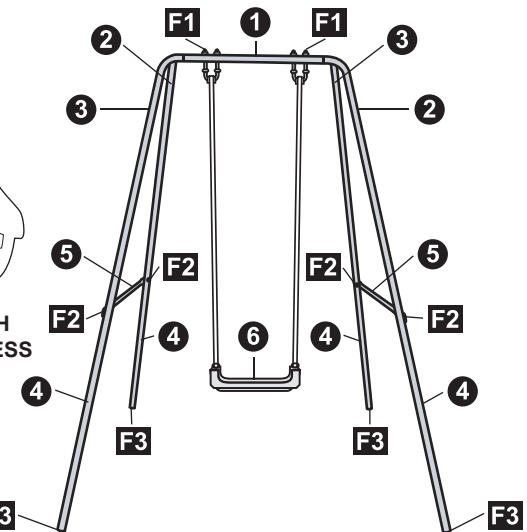

IMPORTANT: Make sure you read the safety notice on the front page and always supervise children while they are playing on the equipment. Once assembly is completed carefully check equipment. In the unlikely event that you do find any problems, please contact us. Do not allow children to use this product until the problem has been corrected.

STEP 1
Frame & Swing Assembly

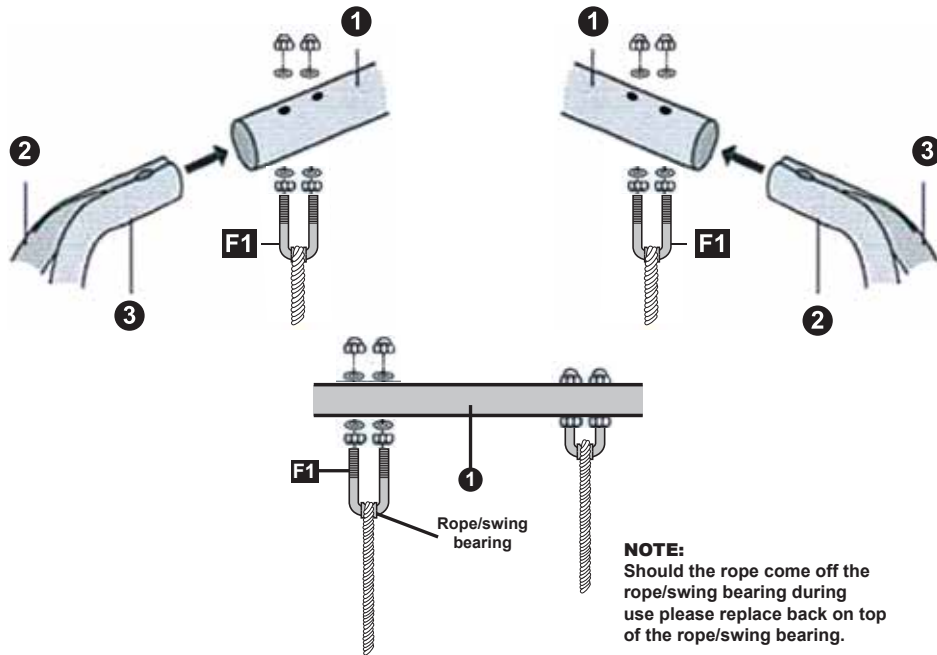

STEP 2
Frame & Swing Assembly

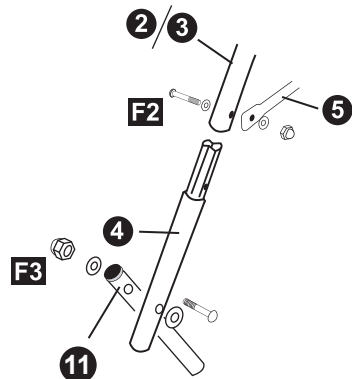
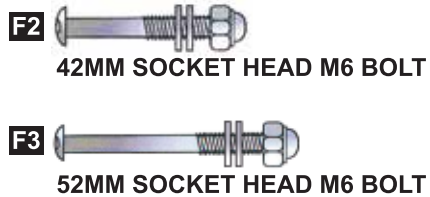

WARNING: THE CHILD MUST BE SECURELY FASTENED TO THE SEAT WITH THE HARNESS IMMEDIATELY TO AVOID INJURY

STEP 3
Toddler Seat with T-Bar (for Children 6-36 Months)

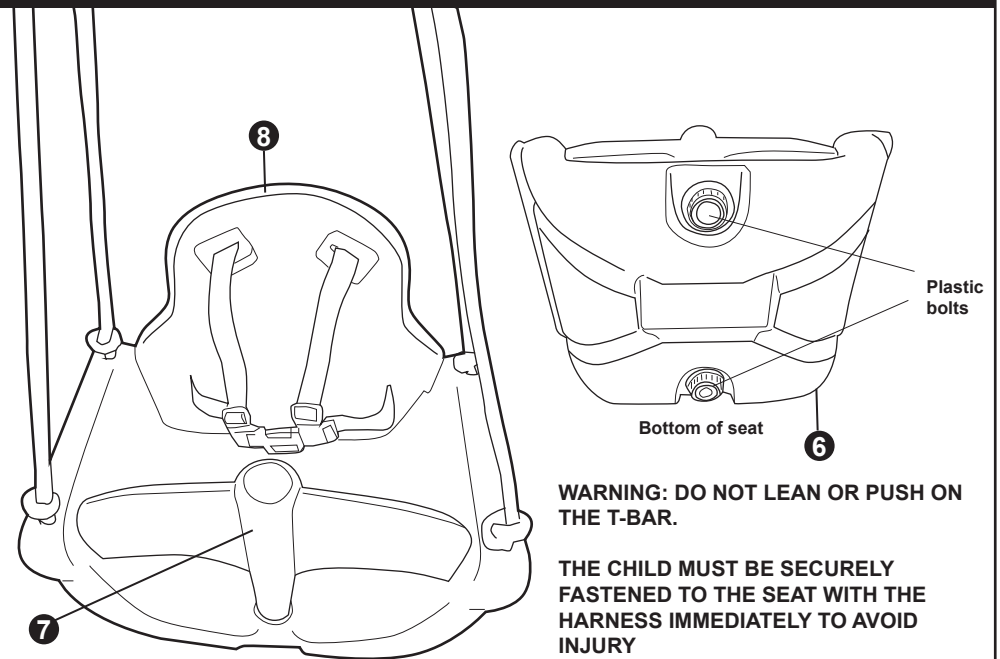

1. Insert backrest into the circle hole of the seat and tighten with the bolt.
2. Insert the T-bar into the square hole of the seat and tighten with bolt.

WARNING: DO NOT OVER TIGHTEN PLASTIC BOLTS

STEP 4
Fasten the seat harness attached to the seat

TAKE CARE WHEN SEATING YOUR CHILD! THE CHILD MUST BE SECURED TO THE SEAT IMMEDIATELY TO AVOID ANY INJURY.

To fasten push left and right hand side clips into the harness until they click into place.

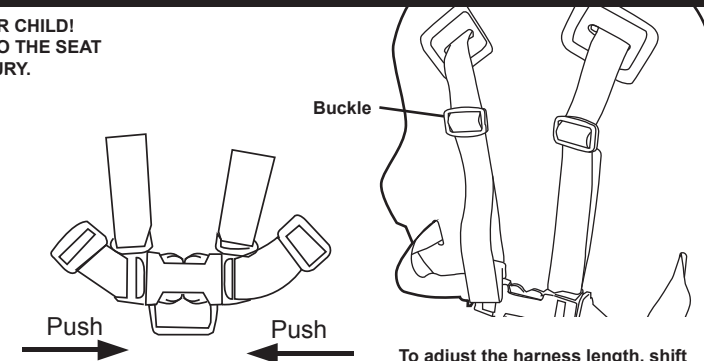

WARNING: HARNESS MUST BE FASTENED SECURELY AT ALL TIMES DURING USE IN THE TODDLER SEAT

To adjust the harness length, shift the buckle up/down.

WARNING: THE CHILD MUST BE SECURELY FASTENED TO THE SEAT WITH THE HARNESS IMMEDIATELY TO AVOID INJURY

STEP 5

Toddler Seat without T-Bar (for children 6-36 months)

WARNING: DO NOT OVER TIGHTEN PLASTIC BOLTS

1. Plastic bolts
6. Bottom of seat
8. Crotch harness
9. Square hole

THE CHILD MUST BE SECURELY FASTENED TO THE SEAT WITH THE HARNESS IMMEDIATELY TO AVOID INJURY

TO REMOVE THE T-BAR
1. Press the seat base around the plastic bolt down.
2. Then unscrew the plastic bolt.

TO ATTACH THE CROTCH HARNESS
1. Place the crotch harness into the square hole and tighten with the bolt.

STEP 6

Fasten the seat harness with crotch harness

TAKE CARE WHEN SEATING YOUR CHILD! THE CHILD MUST BE SECURED TO THE SEAT IMMEDIATELY TO AVOID ANY INJURY.

Remove buckle, please keep in a safe place so you can convert the swing again.

To Close Harness:
Push, Pull, Push, Push

To Open Harness:
Push, Push, Pull, Pull, Push, Push

To adjust the harness length, shift the buckle up/down.

Crotch Harness, Buckle

To fasten push left and right hand side clips into the harness until they click into place.

WARNING: HARNESS MUST BE FASTENED SECURELY AT ALL TIMES DURING USE IN THE TODDLER SEAT

STEP 7

Junior Swing Seat (for Children 3-10 years)

WARNING: DO NOT OVER TIGHTEN PLASTIC BOLTS

1. Plastic bolts
6. Bottom of seat

TO REMOVE THE BACKREST AND CROTCH HARNESS
1. Press the seat base around the plastic bolt down.
2. Then unscrew the plastic bolt.
3. Remove backrest and crotch harness

NOTE: Please keep backrest and crotch harness and plastic bolts in a safe place so you can convert the swing again.

STEP 8

Anchoring the swing to the ground

IMPORTANT: For safety reasons the swing MUST be anchored into the ground and concreted. If you are uncertain about this procedure telephone our helpline number.

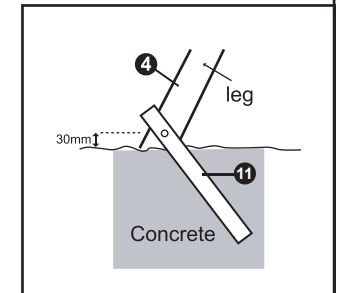
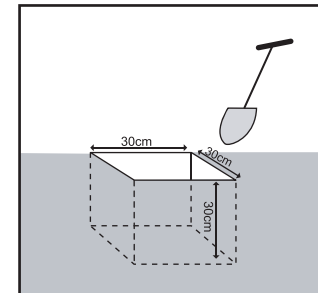
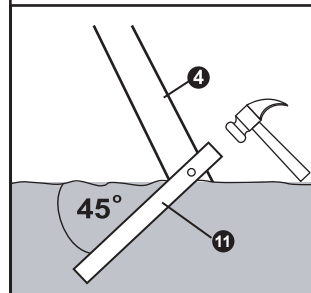

PLACING YOUR CHILD INTO THE SWING SAFELY

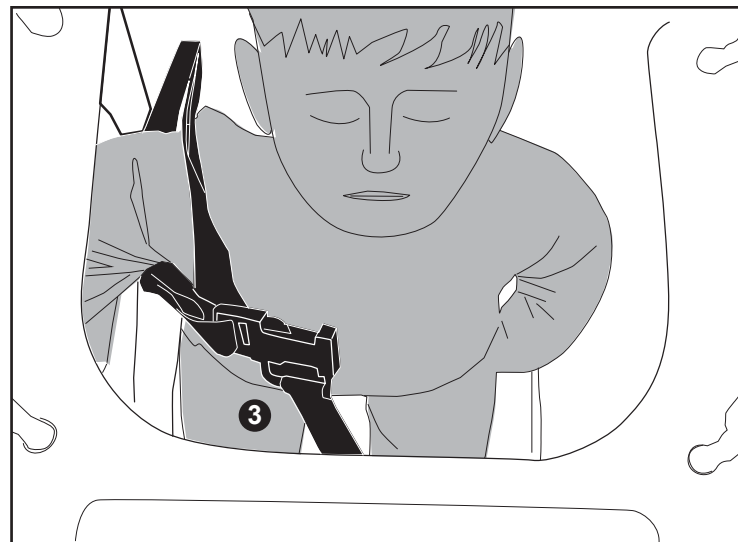
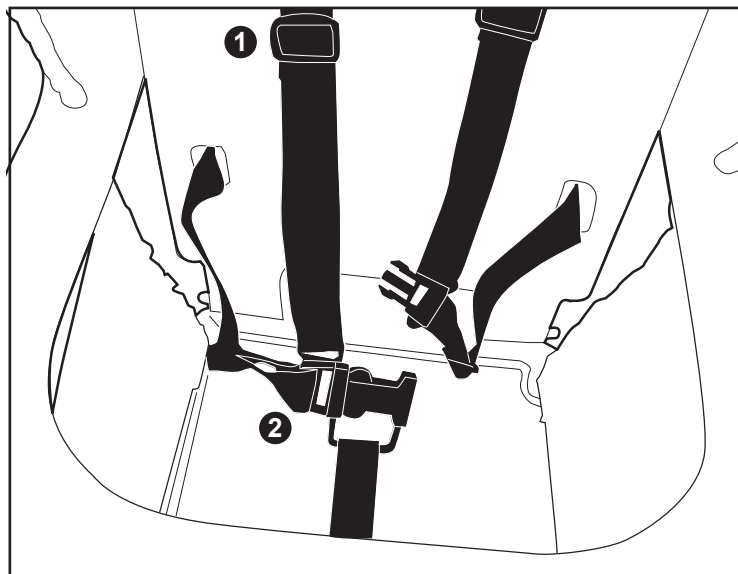

1. Firstly please loosen the harness
2. Next buckle one side of the harness
3. Then place your child into the swing with their legs through the crotch strap (this will prevent them from sliding out)
4. Next buckle the other side of the harness
5. Finally adjust and tighten the harness.

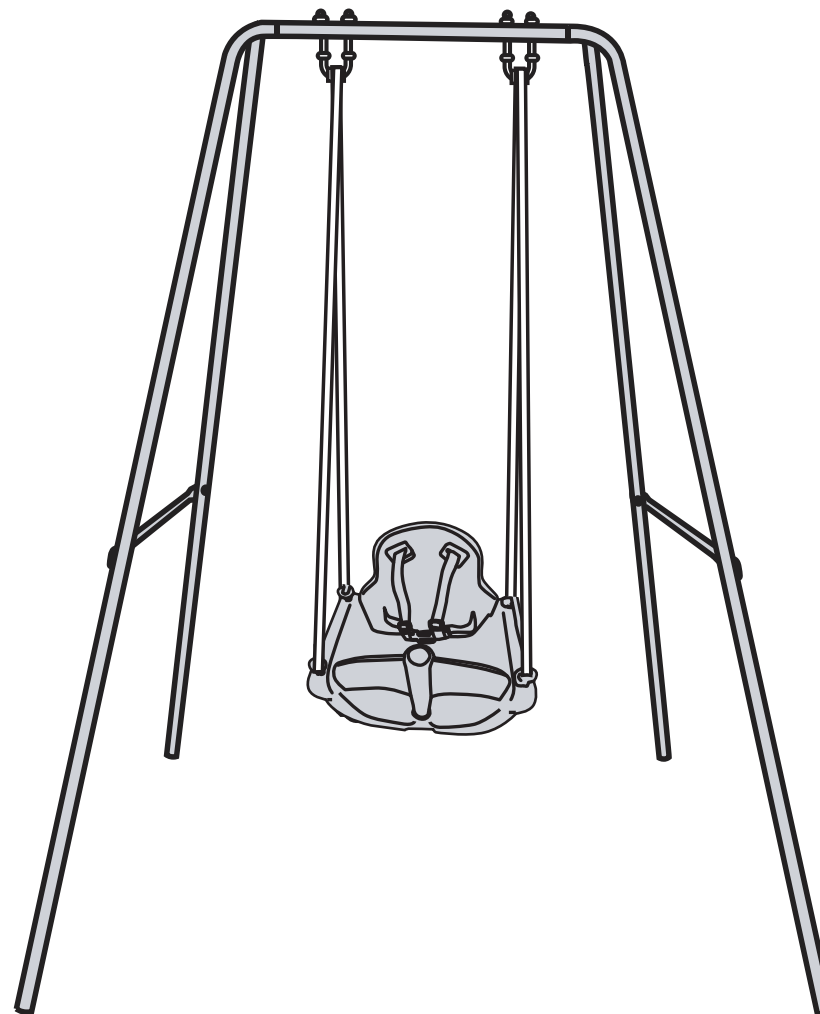

MV Sports & Leisure Ltd.
35 Tameside Drive
Castle Bromwich
Birmingham B35 7AG
United Kingdom

CUSTOMER SERVICES
MV has taken great care to ensure that this item has reached you in good condition. Should you have a query, please contact customer.services@mvsports.com where your query will be dealt with promptly. Alternatively, you can call on 0121 748 8017.



This mark denotes compliance with the standards laid down by the E.C. (European Community).
It is in your best interest to keep a note of our name and address for future reference. If you have any complaints or find this product to be faulty, in order to avoid any delay, please contact the distributor at the address shown.